

Table C2a. PCB Soil Analytical Results - Wabash Parcel

Site Investigation Report
Former Wabash Alloys Facility
Oak Creek, Wisconsin

Sample Location	Sample Depth (ft)	Sample Date	Aroclor, Total (mg/kg)	Aroclor-1016 (mg/kg)	Aroclor-1221 (mg/kg)	Aroclor-1232 (mg/kg)	Aroclor-1242 (mg/kg)	Aroclor-1248 (mg/kg)	Aroclor-1254 (mg/kg)	Aroclor-1260 (mg/kg)
Groundwater Pathway RCL			0.0094	--	--	--	--	--	--	--
Non-Industrial Direct Contact RCL			1.0	3.93	0.159	0.159	0.222	0.222	0.222	0.222
Soil Under TSCA Floor Slab Samples										
PS01 S6	0-0.5	05/30/13	< 0.0027	< 0.0084	< 0.0072	< 0.008	< 0.005	< 0.0061	< 0.005	< 0.0027
PS01 S7	0-0.5	05/30/13	0.48	< 0.0087	< 0.0074	< 0.0082	< 0.0052	< 0.0062	0.48	< 0.0028
PS07 S1	0-0.5	05/30/13	0.46	< 0.0087	< 0.0074	< 0.0082	< 0.0052	< 0.0062	0.46	< 0.0028
PS07 S2	0-0.5	05/30/13	< 0.0027	< 0.0082	< 0.007	< 0.0078	< 0.0049	< 0.0059	< 0.0049	< 0.0027
PS08 S3	0-0.5	05/30/13	0.082	< 0.0088	< 0.0075	< 0.0083	< 0.0052	< 0.0063	0.082	< 0.0028
PS08 S4	0-0.5	05/30/13	0.095	< 0.0085	< 0.0072	< 0.008	< 0.005	< 0.0061	0.095	< 0.0027
PS09 S5	0-0.5	05/30/13	0.17	< 0.0087	< 0.0074	< 0.0082	< 0.0051	0.072	0.1	< 0.0028
Transformer Area Samples										
SS-1*	0-0.5	10/22/10	0.982	< 0.0246	< 0.0246	< 0.0246	< 0.0246	< 0.0246	0.76	0.221
SS-2*	0-0.5	10/22/10	1.64	< 0.0403	< 0.0403	< 0.0403	< 0.0403	< 0.0403	1.32	0.327
SS-3*	0-0.5	10/22/10	10.5	< 0.517	< 0.517	< 0.517	< 0.517	< 0.517	9.11	1.34
SS-4*	0-0.5	10/22/10	0.21	< 0.0261	< 0.0261	< 0.0261	< 0.0261	< 0.0261	0.0853	0.125
Sidewall Central*	0.5-2.5	11/01/12	3.0	< 0.0092	< 0.0078	< 0.0087	< 0.0055	0.54	1.4	1.1
Sidewall E	0.5-2	11/28/12	0.25	< 0.0081	< 0.0069	< 0.0077	< 0.0048	< 0.0058	0.25	< 0.0026
Sidewall East	0.5-1	11/01/12	0.55	< 0.0094	< 0.008	< 0.0089	< 0.0056	0.036	0.42	0.093
Sidewall NE	0.5-2.5	11/28/12	0.29	< 0.0086	< 0.0073	< 0.0081	< 0.0051	< 0.0061	0.21	0.085
Sidewall Northeast*	0.5-1	11/01/12	1.8	< 0.0093	< 0.0079	< 0.0088	< 0.0055	< 0.0066	1.8	< 0.003
Sidewall Northwest	0-3	11/01/12	0.35	< 0.0094	< 0.008	< 0.0089	< 0.0056	< 0.0068	0.15	0.21
Sidewall NW	0.5-3	11/28/12	0.67	< 0.0081	< 0.0069	< 0.0077	< 0.0048	< 0.0058	0.55	0.12
Base Central	2-2.5	11/01/12	0.015	< 0.0093	< 0.0079	< 0.0088	< 0.0055	< 0.0067	0.015	< 0.003
Base East	1-1.5	11/01/12	0.085	< 0.0088	< 0.0075	< 0.0083	< 0.0052	< 0.0063	0.085	< 0.0028
Base NE	2-2.5	11/28/12	0.015	< 0.0094	< 0.008	< 0.0089	< 0.0056	< 0.0067	0.015	< 0.0031
Base Northwest*	3-3.5	11/01/12	0.89	< 0.0091	< 0.0077	< 0.0086	< 0.0054	0.075	0.55	0.27
Base NW	3-3.5	11/28/12	< 0.0027	< 0.0083	< 0.0071	< 0.0079	< 0.005	< 0.006	< 0.005	< 0.0027
Depot Road Samples										
B-55	0-2	02/04/13	< 0.0093	< 0.0067	< 0.0083	< 0.0082	< 0.0062	< 0.0075	< 0.0041	< 0.0093
	14-15	02/04/13	< 0.0093	< 0.0067	< 0.0083	< 0.0082	< 0.0062	< 0.0074	< 0.0041	< 0.0093
B-57	0-2	02/04/13	< 0.0096	< 0.0069	< 0.0086	< 0.0085	< 0.0064	< 0.0077	< 0.0042	< 0.0096
	8-10	02/04/13	< 0.0094	< 0.0068	< 0.0085	< 0.0084	< 0.0063	< 0.0076	< 0.0041	< 0.0094
B-59	0-2	02/04/13	< 0.0099	< 0.0072	< 0.0089	< 0.0088	< 0.0067	< 0.008	< 0.0044	< 0.0099
	6-8	02/04/13	< 0.0093	< 0.0067	< 0.0084	< 0.0083	< 0.0062	< 0.0075	< 0.0041	< 0.0093
B-62	0-2	02/04/13	< 0.0086	< 0.0062	< 0.0077	< 0.0076	< 0.0057	< 0.0069	< 0.0038	< 0.0086
	11-12	02/04/13	< 0.0096	< 0.0069	< 0.0086	< 0.0085	< 0.0064	< 0.0077	< 0.0042	< 0.0096

Original by: RJG 9/23/13, Checked by: NDK 9/30/13

- Notes: 1. (T) Sample submitted by Beazer at same interval as Connell sample.
* Sample was excavated during the Transformer Area excavation in 2012.

Table C3a. Metals and Cyanide Soil Analytical Results - Wabash Parcel

Site Investigation Report
Former Wabash Alloys Facility
Oak Creek, Wisconsin

Sample Location	Sample Depth (ft)	Sample Date	Aluminum, Total (mg/kg)	Arsenic, Total (mg/kg)	Barium, Total (mg/kg)	Cadmium, Total (mg/kg) ⁽²⁾	Chromium, Total (mg/kg) ⁽³⁾	Copper, Total (mg/kg)	Lead, Total (mg/kg)	Mercury, Total (mg/kg)	Nickel, Total (mg/kg)	Selenium, Total (mg/kg)	Silver, Total (mg/kg)	Zinc, Total (mg/kg)	Cyanide (mg/kg) ⁽⁴⁾
Groundwater Pathway RCL			601	0.584	165	0.752	360,000	91.6	27	0.208	13.0	0.52	0.85	NE	4.04
Non-Industrial Direct Contact RCL			77,500	8 ⁽¹⁾	15,300	70.2	100,000	3,130	400	3.13	1,550	391	391	23,500	26.4
B-99	2-4	02/13/13	7,750	2.8	42.1	0.21	12.1	4.9	9.4	0.023	6.6	< 0.67	< 0.24	45.1	--
B103	2-4	02/20/13	19,000	10.5	89.9	0.88	33.4	34	26.9	0.047	27.1	< 0.70	< 0.25	125	--
B115	2-4	02/19/13	11,500	6.5	64	0.54	39.4	24.4	42.6	0.24	16.9	< 0.63	< 0.23	87.1	--
B117	4-6	05/09/13	12,900	4.7	50.3	0.3	19.9	16.7	8.8	0.64	16.5	< 0.61	< 0.22	38.7	--
	10-12	05/09/13	13,000	5.3	44.4	0.32	19.5	17.1	8.4	0.013	19.7	< 0.64	< 0.23	46.1	--
MW804	8-10	05/09/13	6,690	3.6	25.2	0.22	10.8	13.3	4.4	0.11	10.5	< 0.59	< 0.21	31.5	--
MW805	8-10	05/09/13	16,700	5.7	57.8	0.36	25.2	19.2	7.6	0.036	24.8	< 0.60	< 0.22	52.5	--
SB701	0-2	05/06/13	6,330	5.6	28	0.26	11	11.4	4.7	0.0093	14.1	< 0.7	< 0.25	29.5	--
SB702	2-4	05/06/13	14,800	4.9	74.8	0.29	21.7	20.8	5.4	0.011	19.8	< 0.66	< 0.24	33.8	--
SB703	0-2	05/06/13	3,280	3.4	10.1	0.32	7.6	11.9	6.6	0.0077	7.1	< 0.58	< 0.21	51.2	--
SB705	2-4	05/06/13	1,410	< 4.7	3.6	0.082	2.5	2.4	2.1	< 0.0019	1.7	< 0.52	< 0.19	2.2	--
SB707	0-2	05/06/13	49,200	15.7	78.3	18	514	1930	231	0.098	1580	10.5	1.9	1450	--
SB708	2-4	05/06/13	1,750	1.8	9.7	0.11	4.2	7.2	2.4	< 0.002	1.6	< 0.51	< 0.18	8.6	--
SB709	0-2	05/06/13	25,400	5.9	107	2.1	44.3	277	66.2	0.068	49	< 0.71	< 0.25	274	--
SB719	0-2	05/07/13	6,280	2.4	17.2	0.70	10.6	129	26.3	0.0095	9.2	< 0.59	< 0.21	103	--
SB721	0-2	05/07/13	13,100	6.9	48.6	3.7	68.2	462	179	0.093	29.1	1.7	0.63	716	--
	0-2	05/08/13	13,700	7.0	52	0.39	23.7	20.3	8.1	0.020	21	< 0.59	< 0.21	55.9	--
SB722	0-2	05/07/13	45,200	4.9	86.2	8.3	89.4	1460	331	0.064	155	< 0.57	1.3	1530	--
SB724	0-2	05/07/13	14,800	19.3	75.1	0.68	24.7	33.9	56.1	0.12	21.1	< 0.67	< 0.24	254	--
SB725	2-4	05/08/13	15,100	6.9	71.7	0.54	66.1	25.8	21.7	0.11	16.2	< 0.71	< 0.25	76.6	--
	6-8	05/08/13	12,000	5.2	42.8	0.33	18	20.9	8.9	0.011	20.6	< 0.66	< 0.24	52.2	--
SB726	2-4	05/08/13	12,900	6.3	60.2	0.62	291	24.4	21.6	0.25	21	< 0.71	< 0.26	76.6	--
SB729	2-4	05/08/13	11,900	4.0	52.7	0.32	25.9	10.2	11.8	0.037	13.7	< 0.66	< 0.24	65.2	--
SB730	0-2	05/08/13	12,900	5.5	48.2	0.38	23.8	18.2	7.4	0.017	18.4	< 0.59	< 0.21	51.2	--
SS-1*	0-0.5	10/22/10	--	15.9	63.9	5.8	268	--	183	0.28	--	2.7	1.9	--	--
SS-2*	0-0.5	10/22/10	--	5.3	116	5.7	111	--	125	0.35	--	2.9	0.64	--	--
SS-3*	0-0.5	10/22/10	--	5.6	154	8.1	587	--	305	0.37	--	4.3	0.90	--	--
SS-4*	0-5	10/22/10	--	2.0	15.9	0.41	13.6	--	13.7	0.023	--	0.25	< 0.046	--	1.9
Chlorine Pit East Base	9-10	08/27/13	14,100	4.7	54.8	0.31	22	21.3	7.1	0.009	20.2	< 0.71	< 0.26	37.5	--
Chlorine Pit Side North	5-8	08/27/13	12,600	5.9	70.1	0.35	20.5	18.8	7.5	0.010	19.8	< 0.62	< 0.22	42	--
Chlorine Pit Side South	6-8	08/27/13	12,100	5.0	48.6	0.30	18.2	17.6	7.0	0.016	17.2	< 0.66	< 0.24	40.9	--
Chlorine Pit West Base	9-10	08/27/13	8,740	3.9	36.3	0.28	14.1	16.2	5.3	0.0065	12.4	< 0.61	< 0.22	32.8	--
Ladle Pit 1	10-11	07/08/13	12,000	4.9	29.7	4.8	19.8	23.5	20.5	0.035	20.5	< 0.72	< 0.26	130	--
Ladle Pit 2	10-11	07/08/13	12,800	5.6	39.4	0.38	18.8	20.7	9.4	0.015	19.5	< 0.60	< 0.21	50.5	--
Ladle Pit 3	10-11	07/09/13	17,200	6.7	62.7	0.43	25.5	27.6	9.7	0.024	24.8	< 0.70	< 0.25	50.9	--
Ladle Pit 4	10-11	07/09/13	28,800	6.1	88.9	0.73	42.7	39.8	13.5	0.041	43.2	< 0.72	0.28	89.1	--
Ladle Pit 5	10-11	07/09/13	19,000	5.8	68.6	0.70	29.4	118	19.7	0.33	26.4	< 0.69	0.33	132	--
Ladle Pit 6	10-11	07/09/13	21,600	7.9	75.6	0.53	31	47.2	13.1	0.025	31	< 0.80	< 0.29	56	--
Ladle Pit 7A	8-9	07/09/13	20,100	4.8	74.9	0.43	28	25	11.3	0.021	24.5	< 0.67	< 0.24	57.6	--
Ladle Pit 7B	8-9	07/09/13	21,600	6.6	68.8	0.48	31.7	27.2	11	0.036	27.6	< 0.67	< 0.24	58	--
Depot Road Samples															
OC-GP1	8-10	07/13/01	--	3.2	61	< 1.2	20	--	8.0	0.022	--	< 2.5	< 3.0	--	--
OC-GP2	8-10	07/23/01	--	3.7	29	< 1.2	12	--	6.1	< 0.02	--	< 2.5	< 3.0	--	--
OC-GP3	8-10	07/23/01	--	3.9	54	< 1.2	24	--	8.5	0.023	--	< 2.5	< 3.0	--	--

Original by: RJG 9/23/13, Checked by: NDK 9/30/13

- Notes:
1. WDNR background Concentration for Arsenic.
 2. Cadmium (Diet) Non Industrial Direct Contact RCL was used.
 3. Total Chromium Non-Industrial Direct Contact RCL and Chromium(III) Groundwater Pathway RCL was used.
 4. Cyanide (CN-) Non-Industrial Direct Contact RCL and Free Cyanide Groundwater Pathway RCL was used.
 5. NE - Not Established
- * Sample was excavated during the Transformer Area excavation in 2012.



Jun 13, 2014, 3:08pm, PLOTTED BY: rhopkins, SAVED BY: rhopkins
 I:\ACADATA\Projects\201095\61-1\FIG C1_2095-61-BC1C-Arsenic 0-4.dwg Layout1
 XREFS: \2095-61-BASEMAP.dwg

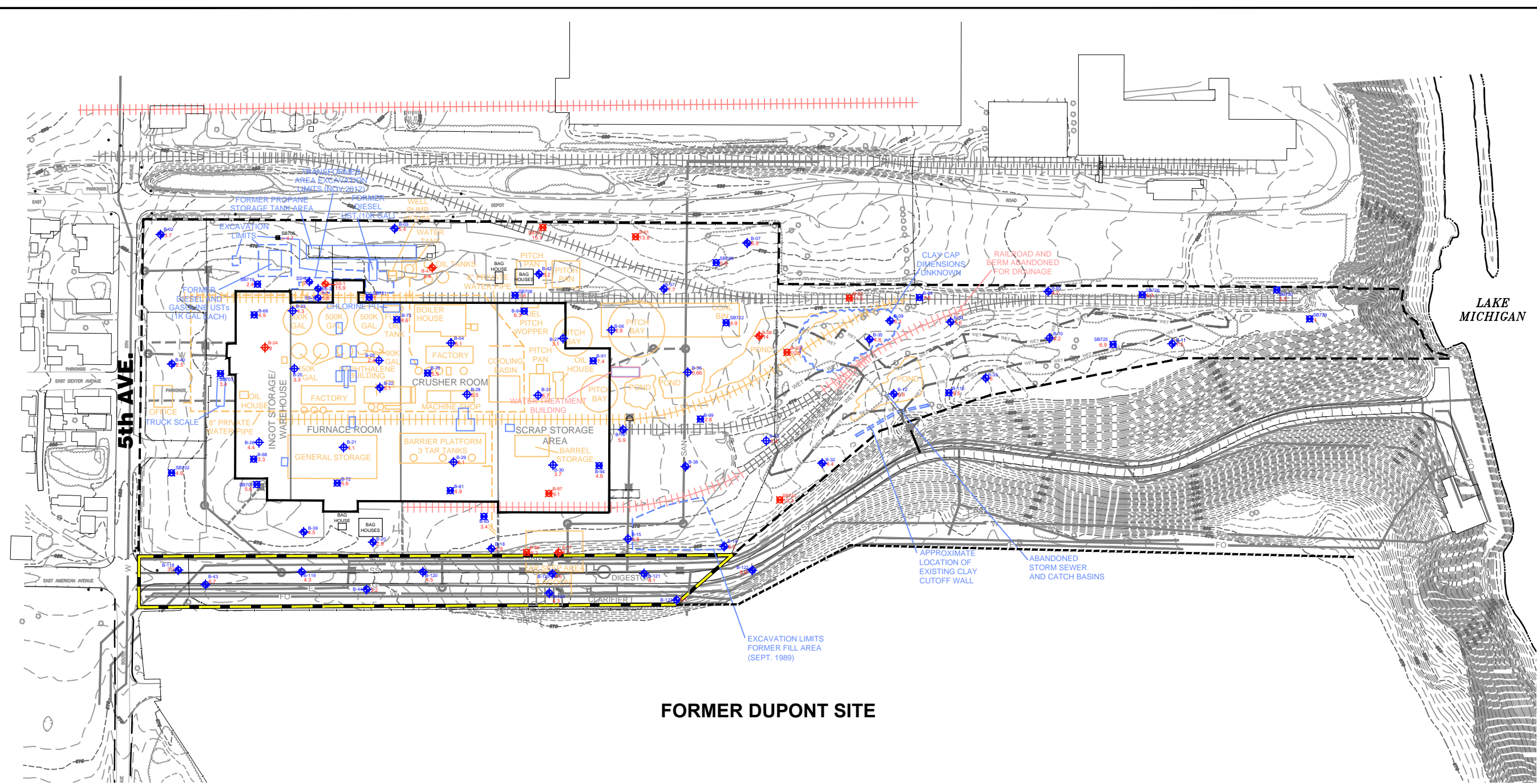

FORMER DUPONT SITE

	WABASH PARCEL PROPERTY BOUNDARY (CONNELL AND BEAZER VPLE)		EXISTING MONITORING WELL/PIEZOMETER		ABANDONED STRUCTURE
	CITY PARCEL PROPERTY BOUNDARY (BEAZER VPLE)		SOIL BORING (2010 AND 2011)		FORMER TAR PLANT STRUCTURES
	UTILITY CORRIDOR PROPERTY BOUNDARY (BEAZER VPLE)		SOIL BORING LOCATION (2012)		PAST REMEDIAL ACTIVITIES
	WETLAND BOUNDARY		SOIL BORING LOCATION (2013)		FORMER PITS OR TANKS, WABASH
	RAILROAD RAIL LINE		SURFACE SOIL LOCATION (2012)		FORMER WASTEWATER TREATMENT PLANT STRUCTURES
	SANITARY		SAMPLE LOCATION ABOVE WDNR BACKGROUND CONCENTRATION RCL OF 8 mg/kg AND GROUNDWATER PATHWAY RCL		
	ABANDONED SANITARY		SAMPLE LOCATION ABOVE THE GROUNDWATER PATHWAY RCL OF 0.584 mg/kg		
	STORM SEWER		10.5		
	ASSUMED STORM SEWER		MAXIMUM ARSENIC CONCENTRATION AT EACH LOCATION IN mg/kg FOR THE DEFINED DEPTH INTERVAL		
	NATURAL GAS				
	WATER MAIN				
	ELECTRICAL				
	FIBER OPTIC				
	MANHOLE				
	INLET/CATCH BASIN				

- SOURCE NOTES:**
- TETRA TECH FIGURE 14, EXTENT OF SOIL EXCEEDING INDUSTRIAL DIRECT CONTACT RCL, DATED 2/16/12, 4436D-REVISED-OAK CREEK.DWG.
 - TETRA TECH FIGURE 11, PROPOSED INVESTIGATION/SAMPLING LOCATIONS, DATED 11/20/12, FIGURE 11 - PROPOSED INVESTIGATION-SAMPLING LOCATIONS.DWG.
 - TETRA TECH FIGURE 1, SITE LAYOUT, DATED 06/07/13, SITE LAYOUT.DWG.
 - WETLAND BOUNDARY DELINEATED BY HEY & ASSOCIATES AND FIELD LOCATED BY NATURAL RESOURCE TECHNOLOGY, INC. JUNE 2013

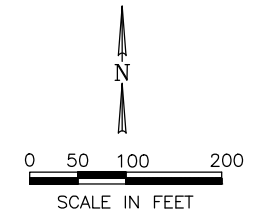

ARSENIC SOIL CONCENTRATIONS
0-4 FEET BGS
 SITE INVESTIGATION REPORT
 FORMER WABASH ALLOYS
 9100 SOUTH 5TH AVENUE
 OAK CREEK, WISCONSIN



PROJECT NO.
 2095/6.1
 FIGURE NO.
 C1

DRAWN BY: RLH/NWD	DATE: 01/10/14
CHECKED BY: RJG	DATE: 01/10/14
APPROVED BY: JAZ	DATE: 01/13/14
DRAWING NO: FIG C1_2095-61-BC1C-ARSENIC 0-4	
REFERENCE: SEE INFO BLOCK	

Jun 13, 2014 3:21pm PLOTTED BY: rthopkins SAVED BY: rthopkins
 I:\ACADATA\Projects\20\2095\6-1\FIG C11_2095-61-BC11C-Nickel 0-4.dwg Layout1
 XREFS: \2095-61-BASEMAP.dwg

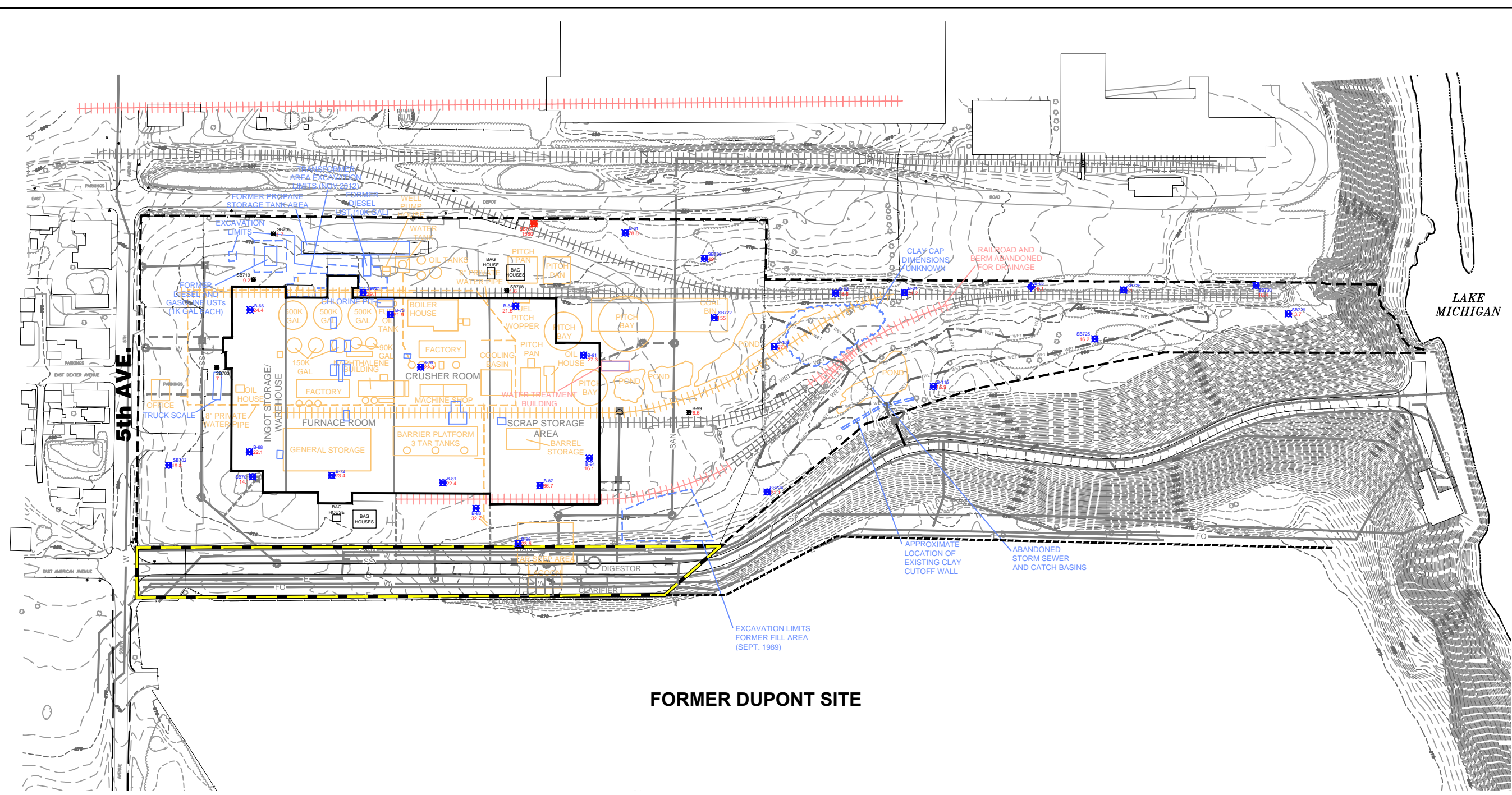

FORMER DUPONT SITE

	WABASH PARCEL PROPERTY BOUNDARY (CONNELL AND BEAZER VPLE)		SOIL BORING LOCATION (2012)		FORMER TAR PLANT STRUCTURES
	CITY PARCEL PROPERTY BOUNDARY (BEAZER VPLE)		SOIL BORING LOCATION (2013)		PAST REMEDIAL ACTIVITIES
	UTILITY CORRIDOR PROPERTY BOUNDARY		SAMPLE LOCATION ABOVE THE NON-INDUSTRIAL DIRECT CONTACT RCL OF 1,550 mg/kg AND GROUNDWATER PATHWAY RCL		FORMER PITS OR TANKS, WABASH
	WETLAND BOUNDARY		SAMPLE LOCATION ABOVE THE GROUNDWATER PATHWAY RCL OF 13.0 mg/kg		FORMER WASTEWATER TREATMENT PLANT STRUCTURES
	RAILROAD RAIL LINE		MAXIMUM NICKEL CONCENTRATION AT EACH LOCATION IN mg/kg FOR THE DEFINED DEPTH INTERVAL		ABANDONED STRUCTURE
	SANITARY				
	ABANDONED SANITARY				
	STORM SEWER				
	ASSUMED STORM SEWER				
	NATURAL GAS				
	WATER MAIN				
	ELECTRICAL				
	FIBER OPTIC				
	MANHOLE				
	INLET/CATCH BASIN				

SOURCE NOTES:
 1. TETRA TECH FIGURE 14, EXTENT OF SOIL EXCEEDING INDUSTRIAL DIRECT CONTACT RCL, DATED 2/16/12, 4436D-REVISED-OAK CREEK.DWG.
 2. TETRA TECH FIGURE 11, PROPOSED INVESTIGATION/SAMPLING LOCATIONS, DATED 11/20/12, FIGURE 11 - PROPOSED INVESTIGATION-SAMPLING LOCATIONS.DWG.
 3. TETRA TECH FIGURE 1, SITE LAYOUT, DATED 06/07/13, SITE LAYOUT.DWG.
 4. WETLAND BOUNDARY DELINEATED BY HEY & ASSOCIATES AND FIELD LOCATED BY NATURAL RESOURCE TECHNOLOGY, INC. JUNE 2013

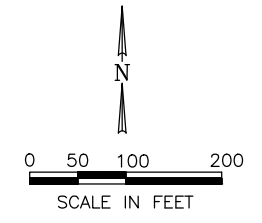

NICKEL SOIL CONCENTRATIONS
0-4 FEET BGS
 SITE INVESTIGATION REPORT
 FORMER WABASH ALLOYS
 9100 SOUTH 5TH AVENUE
 OAK CREEK, WISCONSIN



PROJECT NO.
 2095/6.1
 FIGURE NO.
 C11

DRAWN BY: RLH/NWD	DATE: 01/10/14
CHECKED BY: RJG	DATE: 01/10/14
APPROVED BY: JAZ	DATE: 01/13/14
DRAWING NO: FIG C11_2095-61-BC11C-NICKEL 0-4	
REFERENCE: SEE INFO BLOCK	

Jun 13, 2014 3:24pm PLOTTED BY: rhopkins SAVED BY: rhopkins
 I:\ACADATA\Projects\2012095\61-1\FIG C13_2095-61-BC13C-Metals 4 Plus.dwg Layout1
 XREFS: .\2095-61-BASEMAP.dwg

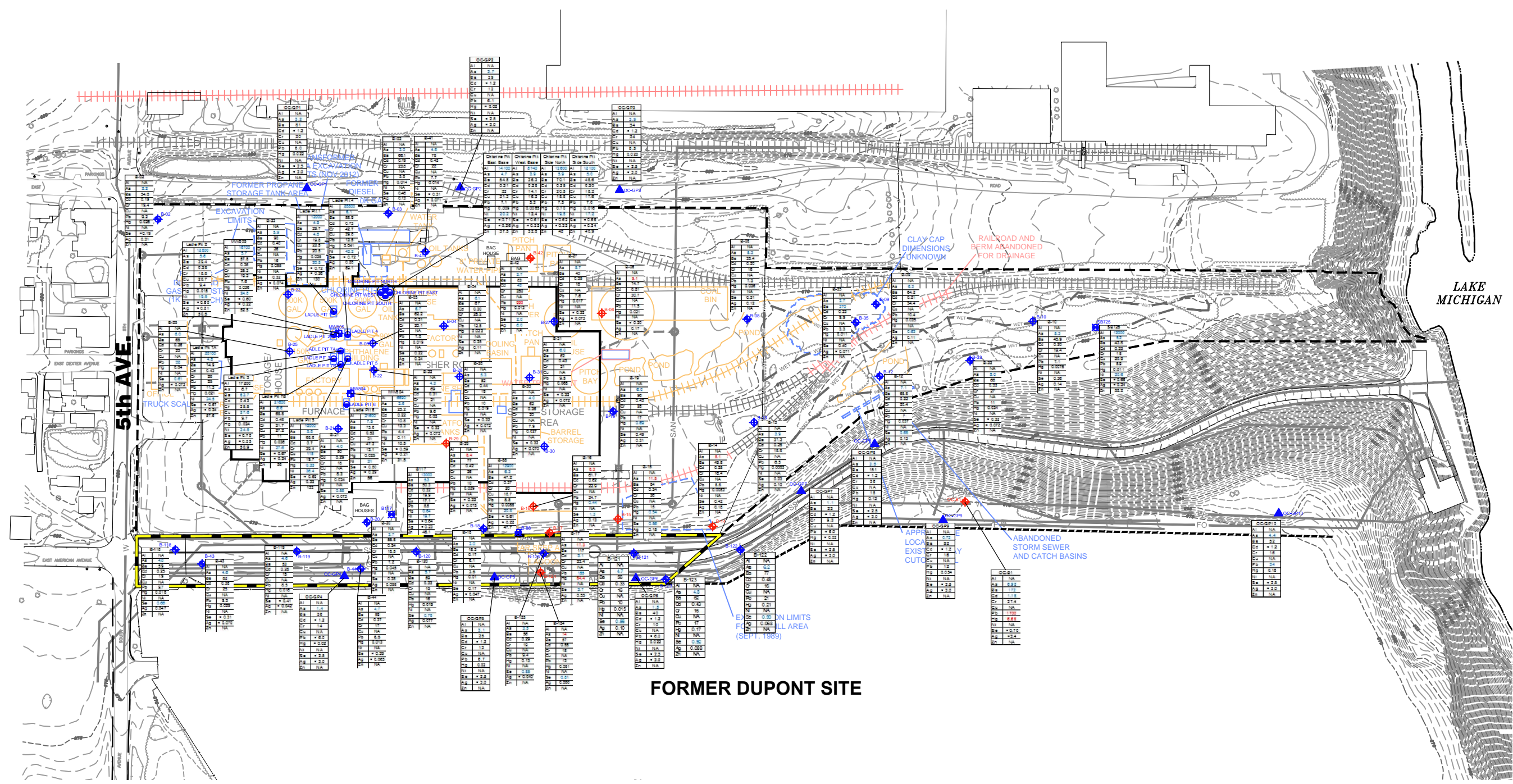

FORMER DUPONT SITE

<ul style="list-style-type: none"> --- WABASH PARCEL PROPERTY BOUNDARY (CONNELL AND BEAZER VPLE) --- CITY PARCEL PROPERTY BOUNDARY (BEAZER VPLE) --- UTILITY CORRIDOR PROPERTY BOUNDARY --- WET WETLAND BOUNDARY --- RAILROAD RAIL LINE --- SAN SANITARY --- ABANDONED SANITARY --- SS STORM SEWER --- ASSUMED STORM SEWER --- G NATURAL GAS --- W WATER MAIN --- E ELECTRICAL --- FO FIBER OPTIC --- MANHOLE --- INLET/CATCH BASIN 	<ul style="list-style-type: none"> ◆ B-01 EXISTING MONITORING WELL/PIEZOMETER ◆ SOIL BORING (2010 AND 2011) ◆ S8808 SOIL BORING LOCATION (2012) ◆ S8700 SOIL BORING LOCATION (2013) ◆ SS-4 SURFACE SOIL LOCATION (2012) ◆◆◆◆ SAMPLE LOCATION ABOVE THE NON-INDUSTRIAL DIRECT CONTACT RCL AND GROUNDWATER PATHWAY RCL ◆◆◆◆ SAMPLE LOCATION ABOVE THE GROUNDWATER PATHWAY RCL 	<ul style="list-style-type: none"> □ ABANDONED STRUCTURE □ FORMER TAR PLANT STRUCTURES □ PAST REMEDIAL ACTIVITIES □ FORMER PITS OR TANKS, WABASH □ FORMER WASTEWATER TREATMENT PLANT STRUCTURES
--	--	--

KEY	Metals	DC-RCL	GW-RCL
Aluminum	Al	77,500	601
Arsenic	As	8*	0.584
Barium	Ba	15,300	165
Cadmium	Cd	70.2	0.752
Chromium	Cr	100,000	360.00
Copper	Cu	3,130	91.6
Lead	Pb	400	27
Mercury	Hg	3.13	0.208
Nickel	Ni	1,550	13
Selenium	Se	391	0.52
Silver	Ag	391	0.85
Zinc	Zn	23,500	NE

- DC-RCL - Non-Industrial Direct Contact Residual Contaminant Level
 GW-RCL - Groundwater Pathway Residual Contaminant Level
 * - WDNR Background Concentration Value
 NE - No Groundwater Pathway Standard
 NA - Not Analyzed
- TABLES CONTAIN MAXIMUM CONCENTRATION AT EACH LOCATION IN mg/kg FOR EACH COMPOUND, FOR GREATER THAN 4 FEET.
 - CHROMIUM III WAS USED FOR DIRECT CONTACT AND THE TOTAL CHROMIUM WAS USED FOR GROUNDWATER PATHWAY.

- SOURCE NOTES:**
- TETRA TECH FIGURE 14, EXTENT OF SOIL EXCEEDING INDUSTRIAL DIRECT CONTACT RCL, DATED 2/16/12, 4436D-REVISED-OAK CREEK.DWG.
 - TETRA TECH FIGURE 11, PROPOSED INVESTIGATION/SAMPLING LOCATIONS, DATED 11/20/12, FIGURE 11 - PROPOSED INVESTIGATION-SAMPLING LOCATIONS.DWG.
 - TETRA TECH FIGURE 1, SITE LAYOUT, DATED 06/07/13, SITE LAYOUT.DWG.
 - WETLAND BOUNDARY DELINEATED BY HEY & ASSOCIATES AND FIELD LOCATED BY NATURAL RESOURCE TECHNOLOGY, INC. JUNE 2013

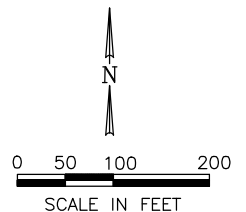

DRAWN BY: RLH/NWD	DATE: 01/10/14
CHECKED BY: RJG	DATE: 01/10/14
APPROVED BY: JAZ	DATE: 01/13/14
DRAWING NO: FIG C13_2095-61-BC13C-METALS 4 PLUS	
REFERENCE: SEE INFO BLOCK	

METALS SOIL CONCENTRATIONS
4+ FEET BGS
 SITE INVESTIGATION REPORT
 FORMER WABASH ALLOYS
 9100 SOUTH 5TH AVENUE
 OAK CREEK, WISCONSIN



PROJECT NO.
2095/6.1

FIGURE NO.
C13

Jun 13, 2014, 3:06pm, PLOTTED BY: rhopkins, SAVED BY: rhopkins
 I:\ACADATA\Projects\20\2095\61\FIG C14_2095-61-BC14C-total PCB 0-4.dwg Layout1
 XREFS: \2095-61-BASEMAP.dwg

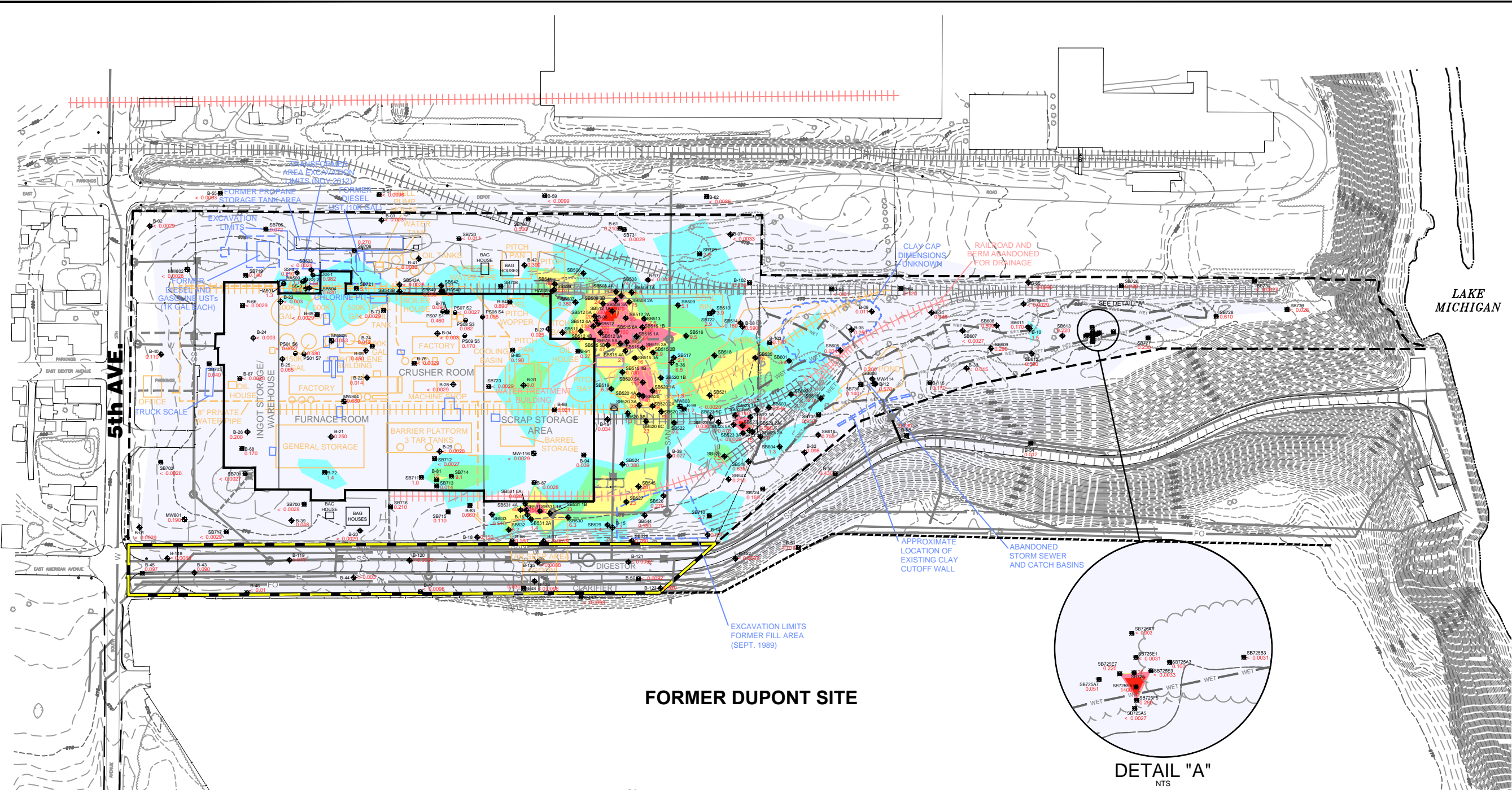

FORMER DUPONT SITE

	WABASH PROPERTY BOUNDARY (CONNELL AND BEAZER VPLE)		EXISTING MONITORING WELL/PIEZOMETER		ABANDONED STRUCTURE
	CITY PARCEL PROPERTY BOUNDARY (BEAZER VPLE)		SOIL BORING LOCATION (2010 AND 2011)		FORMER TAR PLANT STRUCTURES
	UTILITY CORRIDOR PROPERTY BOUNDARY		SOIL BORING LOCATION (2012)		PAST REMEDIAL ACTIVITIES
	WETLAND BOUNDARY		SOIL BORING LOCATION (2013)		FORMER PITS OR TANKS, WABASH
	RAILROAD RAIL LINE		HAND AUGER LOCATION (2012)		FORMER WASTEWATER TREATMENT PLANT STRUCTURES
	SANITARY		SURFACE SOIL LOCATION (2012)		
	ABANDONED SANITARY		EXCAVATION BASE SAMPLE (2013)		
	STORM SEWER		MAXIMUM TOTAL PCB CONCENTRATION AT EACH LOCATION IN mg/kg FOR THE DEFINED DEPTH INTERVAL		
	ASSUMED STORM SEWER				
	NATURAL GAS				
	WATER MAIN				
	ELECTRICAL				
	FIBER OPTIC				
	MANHOLE				
	INLET/CATCH BASIN				

TOTAL PCB CONCENTRATIONS TABLE

MINIMUM CONCENTRATION	MAXIMUM CONCENTRATION	COLOR
0	1	White
1	5	Light Blue
5	10	Light Green
10	50	Yellow
50	500	Orange
500	1400	Red

NOTES:
 1. IF A CONCENTRATION WAS NON-DETECT, HALF THE DETECTION LIMIT WAS USED TO CALCULATE THE COLOR MAP.

SOURCE NOTES:
 1. TETRA TECH FIGURE 14, EXTENT OF SOIL EXCEEDING INDUSTRIAL DIRECT CONTACT RCL, DATED 2/16/12, 4436D-REVISED-OAK CREEK.DWG.
 2. TETRA TECH FIGURE 11, PROPOSED INVESTIGATION/SAMPLING LOCATIONS, DATED 11/20/12, FIGURE 11 - PROPOSED INVESTIGATION-SAMPLING LOCATIONS.DWG.
 3. TETRA TECH FIGURE 1, SITE LAYOUT, DATED 06/07/13, SITE LAYOUT.DWG.
 4. WETLAND BOUNDARY DELINEATED BY HEY & ASSOCIATES AND FIELD LOCATED BY NATURAL RESOURCE TECHNOLOGY, INC. JUNE 2013

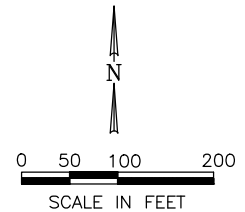

DRAWN BY: RLH/NWD	DATE: 01/10/14
CHECKED BY: RJG	DATE: 01/10/14
APPROVED BY: JAZ	DATE: 01/13/14
DRAWING NO: FIG C14_2095-61-BC14C-TOTAL PCB 0-4	
REFERENCE: SEE INFO BLOCK	

TOTAL PCB SOIL CONCENTRATIONS
0-4 FEET BGS
 SITE INVESTIGATION REPORT
 FORMER WABASH ALLOYS
 9100 SOUTH 5TH AVENUE
 OAK CREEK, WISCONSIN



PROJECT NO.
2095/6.1

FIGURE NO.
C14

Jun 13, 2014, 2:52pm, PLOTTED BY: rhopkins, SAVED BY: rhopkins
 I:\ACADData\Projects\2012095\6-1\FIG C15_2095-61-BC15C-total PCB 4-8.dwg Layout1
 XREFS: Y:\ACADData\Projects\2012095\6-1\2095-61-BASEMAP.dwg

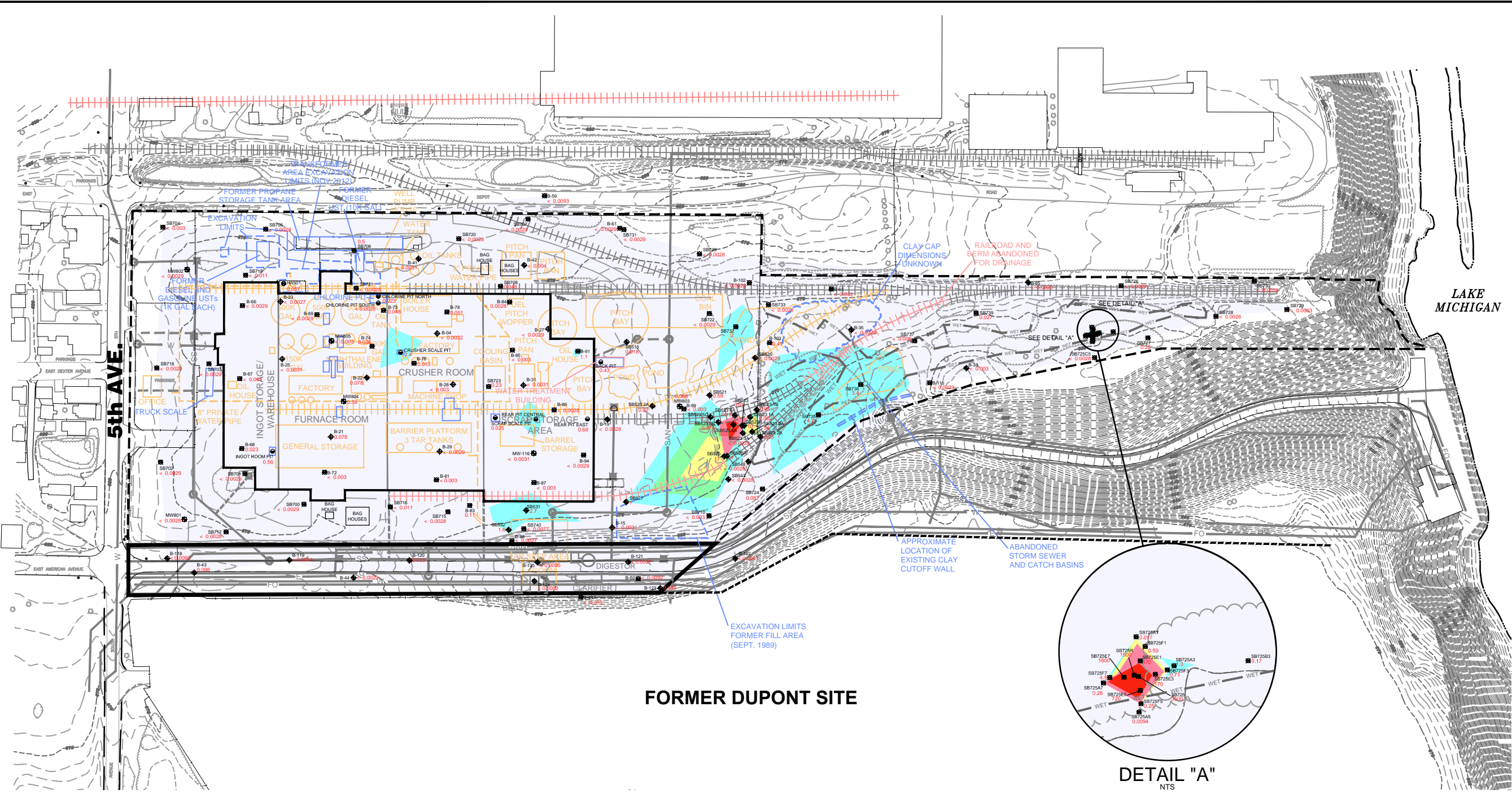

FORMER DUPONT SITE

	WABASH PARCEL PROPERTY BOUNDARY (CONNELL AND BEAZER VP/LE)		EXISTING MONITORING WELL/PIEZOMETER		ABANDONED STRUCTURE
	CITY PARCEL PROPERTY BOUNDARY (BEAZER VP/LE)		SOIL BORING (2010 AND 2011)		FORMER TAR PLANT STRUCTURES
	UTILITY CORRIDOR PROPERTY BOUNDARY		SOIL BORING LOCATION (2012)		PAST REMEDIAL ACTIVITIES
	WETLAND BOUNDARY		SOIL BORING LOCATION (2013)		FORMER PITS OR TANKS, WABASH
	RAILROAD RAIL LINE		HAND AUGER LOCATION (2012)		FORMER WASTEWATER TREATMENT PLANT STRUCTURES
	SANITARY		SURFACE SOIL LOCATION (2012)		
	ABANDONED SANITARY		EXCAVATION BASE SAMPLE (2013)		
	STORM SEWER				
	ASSUMED STORM SEWER				
	NATURAL GAS				
	WATER MAIN				
	ELECTRICAL				
	FIBER OPTIC				
	MANHOLE				
	INLET/CATCH BASIN				

MINIMUM CONCENTRATION	MAXIMUM CONCENTRATION	COLOR
0	1	White
1	5	Light Blue
5	10	Light Green
10	50	Yellow
50	500	Orange
500	3500	Red

NOTES:
 1. IF A CONCENTRATION WAS NON-DETECT, HALF THE DETECTION LIMIT WAS USED TO CALCULATE THE COLOR MAP.

SOURCE NOTES:
 1. TETRA TECH FIGURE 14, EXTENT OF SOIL EXCEEDING INDUSTRIAL DIRECT CONTACT RCL, DATED 2/16/12, 4436D-REVISED-OAK CREEK.DWG.
 2. TETRA TECH FIGURE 11, PROPOSED INVESTIGATION/SAMPLING LOCATIONS, DATED 11/20/12, FIGURE 11 - PROPOSED INVESTIGATION-SAMPLING LOCATIONS.DWG.
 3. TETRA TECH FIGURE 1, SITE LAYOUT, DATED 06/07/13, SITE LAYOUT.DWG.
 4. WETLAND BOUNDARY DELINEATED BY HEY & ASSOCIATES AND FIELD LOCATED BY NATURAL RESOURCE TECHNOLOGY, INC. JUNE 2013

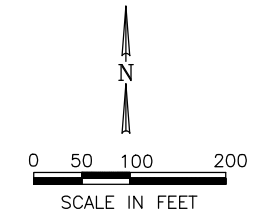

DRAWN BY: RLH/NWD	DATE: 01/10/14
CHECKED BY: RJG	DATE: 01/10/14
APPROVED BY: JAZ	DATE: 01/13/14
DRAWING NO: FIG C15_2095-61-BC15C-TOTAL PCB 4-8	
REFERENCE: SEE INFO BLOCK	

TOTAL PCB SOIL CONCENTRATIONS
4-8 FEET BGS
 SITE INVESTIGATION REPORT
 FORMER WABASH ALLOYS
 9100 SOUTH 5TH AVENUE
 OAK CREEK, WISCONSIN



PROJECT NO.
 2095/6.1
 FIGURE NO.
 C15

Jun 13, 2014, 4:02pm, PLOTTED BY: rhopkins, SAVED BY: rhopkins
 I:\ACADData\Projects\20\2095\6-1\FIG C16_2095-61-BC16C-total PCB 8-12.dwg Layout1
 XREFS: Y:\ACADData\Projects\20\2095\6-1\2095-61-BASEMAP.dwg

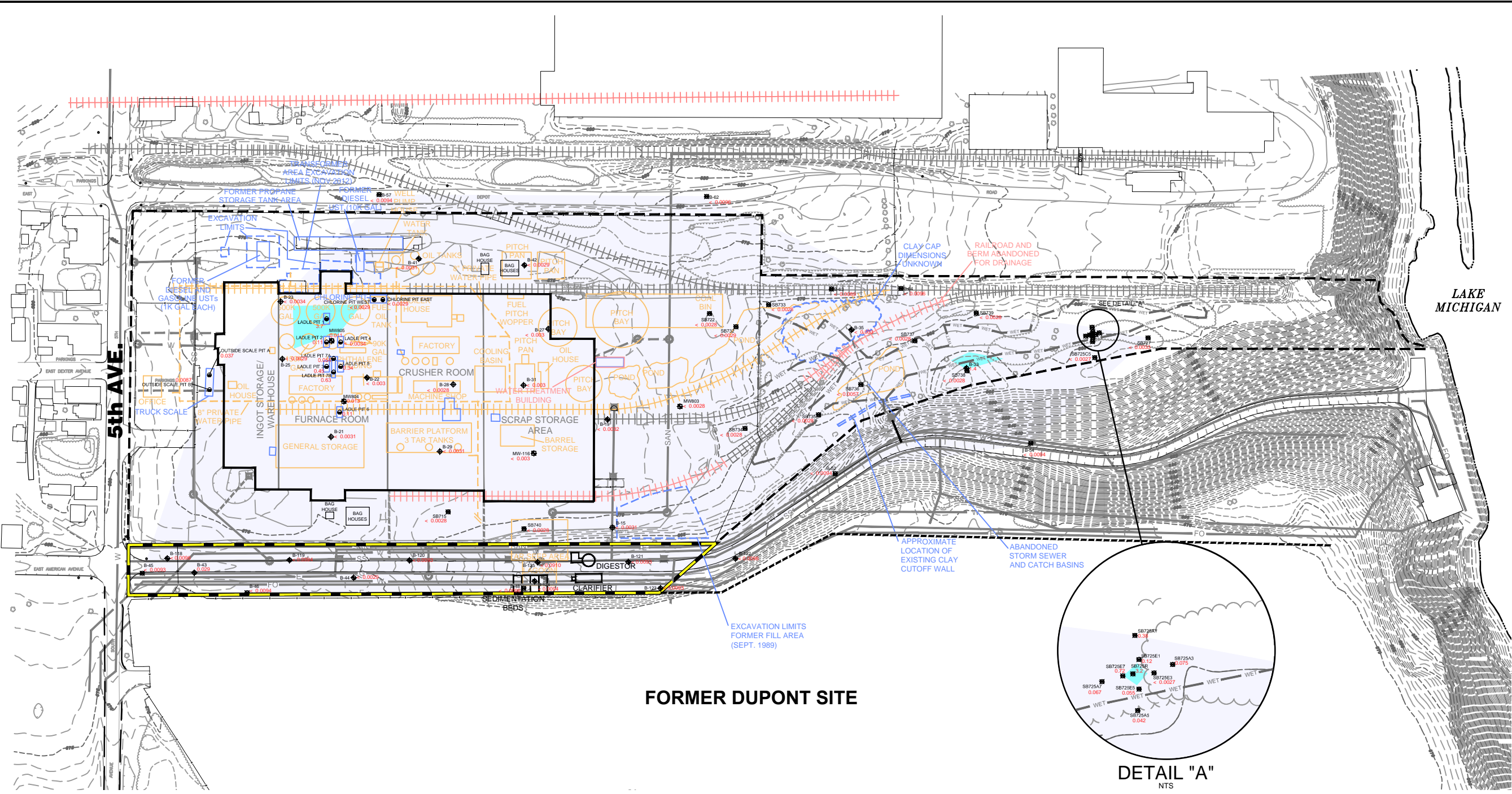

FORMER DUPONT SITE

	WABASH PARCEL PROPERTY BOUNDARY (CONNELL AND BEAZER VPLE)		EXISTING MONITORING WELL/PIEZOMETER		ABANDONED STRUCTURE
	CITY PARCEL PROPERTY BOUNDARY (BEAZER VPLE)		SOIL BORING (2010 AND 2011)		FORMER TAR PLANT STRUCTURES
	UTILITY CORRIDOR PROPERTY BOUNDARY		SOIL BORING LOCATION (2012)		PAST REMEDIAL ACTIVITIES
	WETLAND BOUNDARY		SOIL BORING LOCATION (2013)		FORMER PITS OR TANKS, WABASH
	RAILROAD RAIL LINE		EXCAVATION BASE SAMPLE (2013)		FORMER WASTEWATER TREATMENT PLANT STRUCTURES
	SANITARY		MAXIMUM TOTAL PCB CONCENTRATION AT EACH LOCATION IN mg/kg FOR THE DEFINED DEPTH INTERVAL		
	ABANDONED SANITARY				
	STORM SEWER				
	ASSUMED STORM SEWER				
	NATURAL GAS				
	WATER MAIN				
	ELECTRICAL				
	FIBER OPTIC				
	MANHOLE				
	INLET/CATCH BASIN				

TOTAL PCB CONCENTRATIONS TABLE

MINIMUM CONCENTRATION	MAXIMUM CONCENTRATION	COLOR
0	1	
1	5	

NOTES:

- IF A CONCENTRATION WAS NON-DETECT, HALF THE DETECTION LIMIT WAS USED TO CALCULATE THE COLOR MAP.

SOURCE NOTES:

- TETRA TECH FIGURE 14, EXTENT OF SOIL EXCEEDING INDUSTRIAL DIRECT CONTACT RCL, DATED 2/16/12, 4436D-REVISED-OAK CREEK.DWG.
- TETRA TECH FIGURE 11, PROPOSED INVESTIGATION/SAMPLING LOCATIONS, DATED 11/20/12, FIGURE 11 - PROPOSED INVESTIGATION-SAMPLING LOCATIONS.DWG.
- TETRA TECH FIGURE 1, SITE LAYOUT, DATED 06/07/13, SITE LAYOUT.DWG.
- WETLAND BOUNDARY DELINEATED BY HEY & ASSOCIATES AND FIELD LOCATED BY NATURAL RESOURCE TECHNOLOGY, INC. JUNE 2013

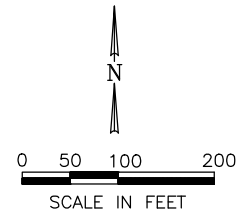

DRAWN BY: RLH/NWD	DATE: 01/10/14
CHECKED BY: RJG	DATE: 01/10/14
APPROVED BY: JAZ	DATE: 01/13/14
DRAWING NO: FIG C16_2095-61-BC16C-TOTAL PCB 8-12	
REFERENCE: SEE INFO BLOCK	

TOTAL PCB SOIL CONCENTRATIONS
8-12 FEET BGS
 SITE INVESTIGATION REPORT
 FORMER WABASH ALLOYS
 9100 SOUTH 5TH AVENUE
 OAK CREEK, WISCONSIN



PROJECT NO.
2095/6.1

FIGURE NO.
C16

Jun 13, 2014, 4:04pm PLOTTED BY: rhopkins SAVED BY: rhopkins
 I:\ACADdata\Projects\20\2095\6-1\FIG C17_2095-61-BC17C-total PCB 12-16.dwg Layout1
 XREFS: \2095-61-BASEMAP.dwg

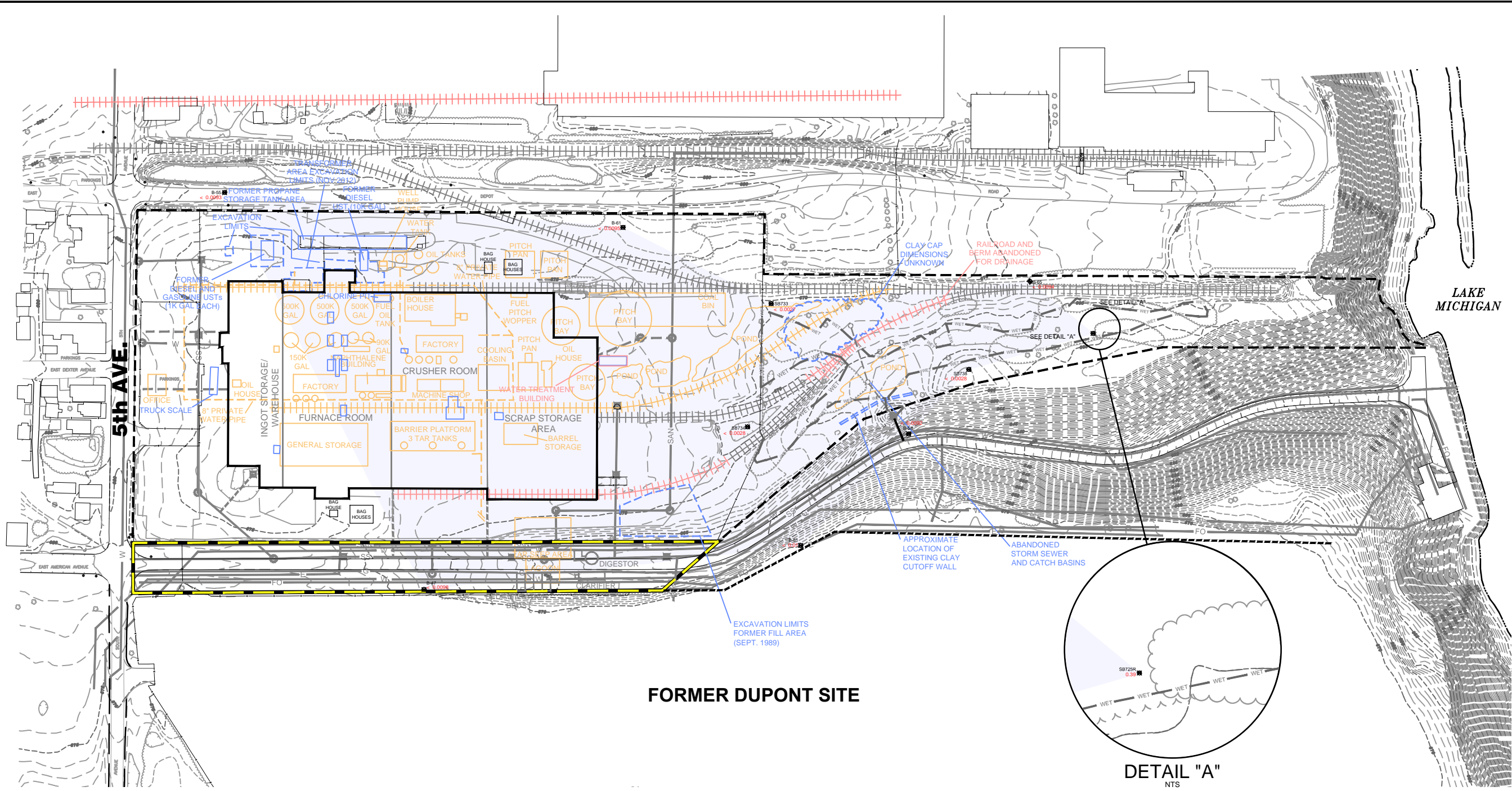

FORMER DUPONT SITE

	WABASH PARCEL PROPERTY BOUNDARY (CONNELL AND BEAZER VPLE)		SOIL BORING LOCATION (2013)		ABANDONED STRUCTURE
	CITY PARCEL PROPERTY BOUNDARY (BEAZER VPLE)		MAXIMUM TOTAL PCB CONCENTRATION AT EACH LOCATION IN mg/kg FOR THE DEFINED DEPTH INTERVAL		FORMER TAR PLANT STRUCTURES
	UTILITY CORRIDOR PROPERTY BOUNDARY				PAST REMEDIAL ACTIVITIES
	WETLAND BOUNDARY				FORMER PITS OR TANKS, WABASH
	RAILROAD RAIL LINE				FORMER WASTEWATER TREATMENT PLANT STRUCTURES
	SANITARY				
	ABANDONED SANITARY				
	STORM SEWER				
	ASSUMED STORM SEWER				
	NATURAL GAS				
	WATER MAIN				
	ELECTRICAL				
	FIBER OPTIC				
	MANHOLE				
	INLET/CATCH BASIN				

TOTAL PCB CONCENTRATIONS TABLE		
MINIMUM CONCENTRATION	MAXIMUM CONCENTRATION	COLOR
0	1	

NOTES:
 1. IF A CONCENTRATION WAS NON-DETECT, HALF THE DETECTION LIMIT WAS USED TO CALCULATE THE COLOR MAP.

SOURCE NOTES:
 1. TETRA TECH FIGURE 14, EXTENT OF SOIL EXCEEDING INDUSTRIAL DIRECT CONTACT RCL, DATED 2/16/12, 4436D-REVISED-OAK CREEK.DWG.
 2. TETRA TECH FIGURE 11, PROPOSED INVESTIGATION/SAMPLING LOCATIONS, DATED 11/20/12, FIGURE 11 - PROPOSED INVESTIGATION-SAMPLING LOCATIONS.DWG.
 3. TETRA TECH FIGURE 1, SITE LAYOUT, DATED 06/07/13, SITE LAYOUT.DWG.
 4. WETLAND BOUNDARY DELINEATED BY HEY & ASSOCIATES AND FIELD LOCATED BY NATURAL RESOURCE TECHNOLOGY, INC. JUNE 2013

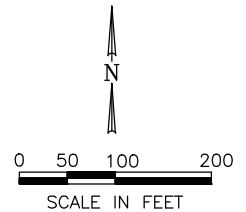

DRAWN BY: RLH/NWD	DATE: 01/10/14
CHECKED BY: RJG	DATE: 01/10/14
APPROVED BY: JAZ	DATE: 01/13/14
DRAWING NO: FIG C17_2095-61-BC17C-TOTAL PCB 12-16	
REFERENCE: SEE INFO BLOCK	

TOTAL PCB SOIL CONCENTRATIONS
12-16 FEET BGS
 SITE INVESTIGATION REPORT
 FORMER WABASH ALLOYS
 9100 SOUTH 5TH AVENUE
 OAK CREEK, WISCONSIN



PROJECT NO.
 2095/6.1
 FIGURE NO.
 C17