

From: Haak, Daniel <DHaak@trccompanies.com>
Sent: Friday, October 11, 2019 10:06 AM
To: Femal, Kristina A - DNR
Cc: Krueger, Sarah E - DNR; VanPrice, Kathie - DOT
Subject: RE: BRRTS 02-20-554881_Excavation Management Plan STH 23-Tynan Property_Fond du Lac County (WisDOT ID# 1440-15-01)
Attachments: Z3601240000-001_Specials_Rev_9-30-19.docx; DOC100219.pdf

Follow Up Flag: Follow up
Flag Status: Completed

Kristina

As discussed, concurrent with highway construction, we plan to complete two shallow excavations (up 3 feet depth at locations shown on attached). For confirmation sampling we plan to collect up to 4 base samples for PAHs and lead from each excavation.

For the attached special provisions, I estimate 150 tons of contaminated soil will require landfill disposal.

Let me know if you have any questions.

Thanks

Dan

From: Femal, Kristina A - DNR <Kristina.Femal@wisconsin.gov>
Sent: Friday, October 11, 2019 9:43 AM
To: Haak, Daniel <DHaak@trccompanies.com>
Cc: Krueger, Sarah E - DNR <sarah.krueger@wisconsin.gov>
Subject: RE: BRRTS 02-20-554881_Excavation Management Plan STH 23-Tynan Property_Fond du Lac County (WisDOT ID# 1440-15-01)

Hi Dan,

Kathie mentioned that she spoke to you earlier this week, so I'm just following up to see what decision has been made regarding the Tynan confirmation sampling. Please let us know.

Warm Regards,
Kristina

We are committed to service excellence.

Visit our survey at <http://dnr.wi.gov/customersurvey> to evaluate how I did.

Kristina Femal

Phone: (920) 662-5431

Kristina.Femal@wisconsin.gov

From: Haak, Daniel <DHaak@trccompanies.com>
Sent: Monday, September 30, 2019 11:43 AM

To: Femal, Kristina A - DNR <Kristina.Femal@wisconsin.gov>

Cc: VanPrice, Kathie - DOT <Kathie.VanPrice@dot.wi.gov>

Subject: RE: BRRTS 02-20-554881_Excavation Management Plan STH 23-Tynan Property_Fond du Lac County (WisDOT ID# 1440-15-01)

Kristina,

Per our conversation, I've revised the special provisions (attached with red-line edits) to account for elevated lab results. Also, we discussed that excavated soil at and around B-3 will be landfilled due to the PAHs detected. It appears that the cut at this location will be minor and as such I estimate up to 100 tons of PAH-impacted soil will require landfill disposal.

Thanks

Dan

From: Femal, Kristina A - DNR <Kristina.Femal@wisconsin.gov>

Sent: Thursday, September 26, 2019 2:23 PM

To: Haak, Daniel <DHaak@trccompanies.com>

Cc: Voit, Angela <AVoit@trccompanies.com>

Subject: RE: BRRTS 02-20-554881_Excavation Management Plan STH 23-Tynan Property_Fond du Lac County (WisDOT ID# 1440-15-01)

Hi Daniel,

I'm reviewing the soil management plan Angela submitted on 9/4 and just have a few quick questions. Forgive me if I'm overlooking the obvious, but in Figure 2, the Boring Location Map, what are the black boxes supposed to represent? Also, could you send a map that illustrates exactly where soil will be excavated? Thanks!

Warm Regards,
Kristina

We are committed to service excellence.

Visit our survey at <http://dnr.wi.gov/customersurvey> to evaluate how I did.

Kristina Femal

Phone: (920) 662-5431

Kristina.Femal@wisconsin.gov

From: Haak, Daniel <DHaak@trccompanies.com>

Sent: Thursday, September 12, 2019 12:16 PM

To: Femal, Kristina A - DNR <Kristina.Femal@wisconsin.gov>

Subject: RE: BRRTS 02-20-554881_Excavation Management Plan STH 23-Tynan Property_Fond du Lac County (WisDOT ID# 1440-15-01)

Kristina,

Since this site has a long history, let me know if you want to discuss sometime.

Thanks

Dan

Daniel Haak, P.E. (WI)
Senior Project Manager



708 Heartland Trail, Suite 3000, Madison, WI 53717
T 608.826.3628 | F 608.826.3941 | C 608.886.7423
[LinkedIn](#) | [Twitter](#) | [Blog](#) | [TRCcompanies.com](#)

Please note that our domain name and email addresses have changed

From: Voit, Angela <AVoit@trccompanies.com>
Sent: Wednesday, September 4, 2019 11:29 AM
To: kristina.femal@wisconsin.gov
Cc: VanPrice, Kathie - DOT <kathie.vanprice@dot.wi.gov>; Haak, Daniel <DHaak@trccompanies.com>; Bergmann, Bryan <BBergmann@trccompanies.com>
Subject: BRRTS 02-20-554881_Excavation Management Plan STH 23-Tynan Property_Fond du Lac County (WisDOT ID# 1440-15-01)

Below is the link to the Excavation Management Plan for STH 23-Tynan Property in Fond du Lac County (BRRTS# 02-20-554881 and WisDOT ID# 1440-15-01). This has been uploaded to the WDNR RR Submittal Portal and a hard copy will also be sent to you.

Please click the following link to download your file:

https://adhocftp.trccompanies.com:443/AHT/AHT_UI/public/#/password?package=7%2bKwtovKAYQbM7pAI9GWIHhjRvtMpto9%2b6I5uY%2bQcY9c48mdZOMAEcds01dnehaoA%2fvhuRleZI94nbKApStVo%2fR59SDsJKhHU98Bjppqd%2fk%3d

Angie Voit
Senior Project Coordinator



708 Heartland Trail, Suite 3000, Madison, WI 53717
T 608.444.3509 | avoit@trccompanies.com
[LinkedIn](#) | [Twitter](#) | [Blog](#) | [TRCcompanies.com](#)

240L.DWG
 J:\1095301\109530101.dwg
 Operator Name: metza
 9/29/2008 10:10:58 AM Thursday, October 22, 2008 12:28 PM metza

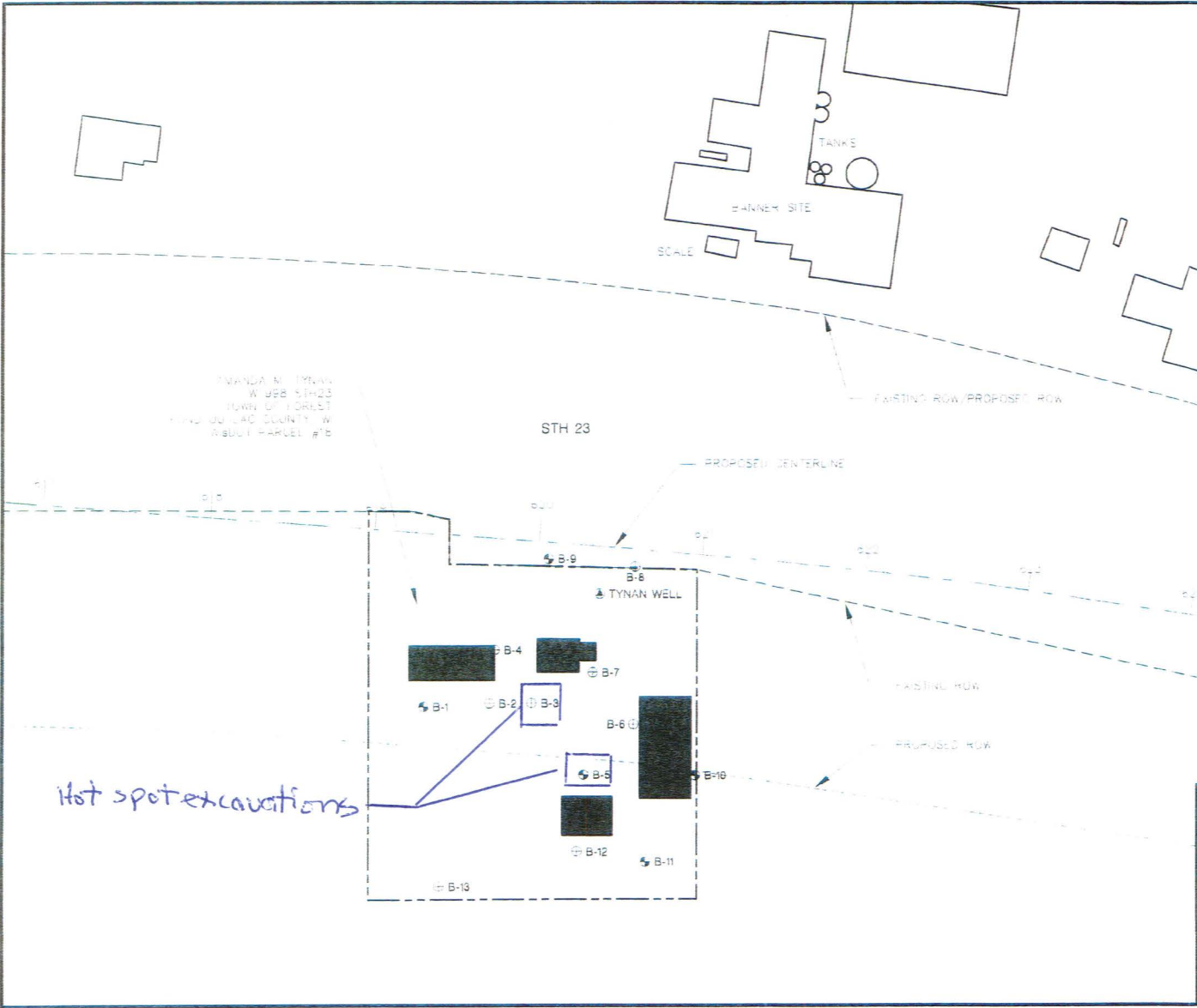

LEGEND	
⊕ B-8	BORING (SOIL SAMPLES COLLECTED)
⊕ B-9	BORING (SOIL AND GROUNDWATER SAMPLES COLLECTED)
▲ TYNAN WELL	PRIVATE WELL (GROUNDWATER SAMPLE COLLECTED)
---	EXISTING ROW
- - -	PROPOSED ROW
---	PROPERTY LINE

NOTES

1. BASE MAP PROVIDED BY WisDOT

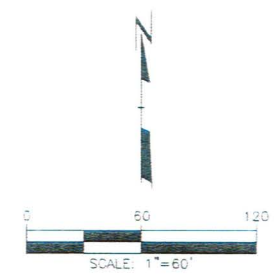

PROJECT:			
WisDOT STH 23 -TYNAN PROPERTY WisDOT ID# 1440-15-01			
SHEET TITLE:			
FIGURE 2 BORING LOCATION MAP			
DRAWN BY:	METZA	SCALE:	PROJ. NO: 10953.01
CHECKED BY:	WALTERM	AS SHOWN	FILE NO: 109530101.DWG
APPROVED BY:	HAKKD	DATE PRINTED:	
DATE:	OCTOBER 2008		
744 Heartland Trage Madison, WI 53717-1934 P.O. Box 6923 53708-8923 Phone: 608-631-4444 Fax: 608-631-3334			

**Special Provisions for the Management of
Contaminated Material**

**STH 23
Project I.D. #1440-15-01**

Fond du Lac County, Wisconsin

**Prepared by
TRC Environmental Corporation
Madison, Wisconsin**

Revised September 30, 2019

1. Excavation, Hauling, and Disposal of Contaminated Material, Item _____.

A Description

A.1 General

This special provision describes excavating, loading, hauling, and disposing of contaminated material at a DNR approved landfill facility. The closest DNR approved landfill facilities are:

Advanced Disposal Glacier Ridge Landfill
N7296 Hwy V
Horicon, Wisconsin 53032

Waste Management Solutions Valley Trail Landfill
N9101 Willard Road
Berlin, Wisconsin 54923

Perform this work in accordance with section 205 of the standard specifications and with pertinent parts of Chapters NR 700-754 of the Wisconsin Administrative Code, as supplemented herein. Per NR 718.07, a solid waste collection and transportation service-operating license is required under NR 502.06 for each vehicle used to transport contaminated material.

A.2 Notice to the Contractor – Contaminated Material Location(s)

The department completed testing for soil and groundwater contamination for locations within this project where excavation is required. Testing indicated that contaminated material is present at the following location(s):

- Station 619+30 to Station 620+40, from 70 feet right of the reference line to construction limits on the right.

Contaminated soils and/or groundwater and/or underground storage tanks (USTs) may be encountered at other locations within the construction limits. If contaminated soils and/or groundwater and/or USTs are encountered elsewhere on the project, terminate excavation activities in the area and notify the engineer. Contaminated soil and/or groundwater at other locations shall be managed by the contractor under this contract. USTs will be removed by others.

For further information regarding previous investigation and remediation activities at these sites contact:

Name: Kathie VanPrice
Wisconsin DOT, Northeast Region

Address: 944 Vanderperren Way
Green Bay, WI 54324
Phone: (920) 492-7175
Fax: (920) 492-5640
E-mail: Kathie.VanPrice@dot.wi.gov

Name: Dan Haak
TRC Environmental Corporation
Address: 708 Heartland Trail, Ste 3000
Madison, WI 53717
Phone: (608) 826-3628
Fax: (608) 826-3941
E-mail: DHaak@trccompanies.com

A.3 Coordination

Coordinate work under this contract with the environmental consultant retained by the department:

Consultant: TRC Environmental Corporation
Address: 708 Heartland Trail, Suite 3000, Madison, WI 53717
Fax: (608) 826-3941
Contact: Dan Haak
Phone: (608) 826-3628 (office), (608) 886-7423 (mobile)
E-mail: DHaak@trccompanies.com

The role of the environmental consultant will be limited to:

1. Determining the location and limits of contaminated material to be excavated based on analytical results from previous investigations, visual observations, and field screening of material that is excavated;
2. Identifying contaminated materials to be hauled to the landfill facility;
3. Documenting that activities associated with management of contaminated material are in conformance with the contaminated material management methods for this project as specified herein; and
4. Obtaining the necessary approvals for disposal of contaminated material from the landfill facility.

Provide at least a 14-calendar day notice of the preconstruction conference date to the environmental consultant. At the preconstruction conference, provide a schedule for all excavation activities in the areas of contamination to the environmental consultant. Also notify the environmental consultant at least three calendar days prior to commencement of excavation activities in each of the contaminated areas.

Identify the DNR approved landfill facility that will be used for disposal of contaminated materials, and provide this information to the environmental consultant no later than 30 calendar days prior to commencement of excavation activities in the contaminated areas or at the preconstruction conference, whichever comes first. The environmental consultant

will be responsible for obtaining the necessary approvals for disposal of contaminated materials from the landfill facility.

Coordinate with the environmental consultant to ensure that the environmental consultant is present during excavation activities in the contaminated areas. Perform excavation work in each of the contaminated areas on a continuous basis until excavation work is completed. Do not transport contaminated soil or pump contaminated groundwater offsite without prior approval from the environmental consultant.

A.4 Protection of Groundwater Monitoring Wells

Groundwater monitoring wells are not expected to be present within the construction limits. If encountered, protect all groundwater monitoring wells to maintain their integrity. Adjust wells that do not conflict with utilities, structures, curb and gutter, etc. to be flush with the final grade. For wells that conflict with the previously mentioned items, notify the environmental consultant, and coordinate with the environmental consultant the abandonment or adjustment of the wells by others. The environmental consultant will provide maps indicating the locations of all known monitoring wells, if requested by the contractor.

A.5 Excavation Management Plan Approval

The excavation management plan for this project has been designed to minimize the off-site disposal of contaminated material. The excavation management plan, including these special provisions, has been developed in cooperation with the WDNR. The WDNR's concurrence letter is on file at the Wisconsin Department of Transportation. For further information regarding the investigations, including waste characterization within the project limits, contact Kathie VanPrice with the department, at (920) 492-7172.

A.6 Health and Safety Requirements for Workers Remediating Contamination

Supplement subsection 107.1 of the standard specifications with the following:

During excavation activities, expect to encounter material contaminated with metals or petroleum related products. Site workers taking part in activities that will result in the reasonable probability of exposure to safety and health hazards associated with hazardous materials shall have completed health and safety training that meets the Occupational Safety and Health Administration (OSHA) requirements for Hazardous Waste Operations and Emergency Response (HAZWOPER), as provided in 29 CFR 1910.120.

Prepare a site-specific Health and Safety Plan, and develop, delineate and enforce the health and safety exclusion zones for each contaminated site location as required by 29 CFR 1910.120. Submit the site-specific health and safety plan and written documentation of up-to-date OSHA training to the engineer prior to the start of work.

Disposal of contaminated material at the landfill facility is subject to the facility's safety policies, which include as a minimum:

1. No smoking is allowed on-site.
2. Maximum speed limit of 15 mph on access roads and 5 mph while in active area.

3. All persons entering the active area must wear the following personal protective equipment: hard hats, high visibility clothing, steel toed work boots, safety glasses, and seat belts.
4. Minimum requirement for spacing is as follows:
 - a. A minimum 15 foot Safety Zone is required between landfill equipment and all personnel at all times.
 - b. Do not back up directly behind the compactor or dozer.
 - c. Trucks must yield the right-of-way to landfill equipment.
 - d. 15 feet required between trucks.
5. Only the driver can exit the truck and must stay within 4 feet of the truck. Use of Spotter is prohibited. Helper (if any), must remain in vehicle while unloading.
6. Tailgates of all vehicles may only be opened while in the active area and must be closed prior to exiting the active area.
7. Cleaning out vehicles must be done in designated area, not in the active area. Vehicles must be properly locked out / tagged out in accordance with OSHA during the clean out process.
8. No scavenging is allowed.
9. Horseplay is prohibited.

Violation of the landfill's safety policy will result in a verbal or written warning explaining this policy and may result in the loss of dumping privileges.

Immediately report all accidents and injuries at the disposal facility to landfill management.

B (Vacant)

C Construction

Supplement subsection 205.3 of the standard specification with the following:

Control operations in the contaminated areas to minimize the quantity of contaminated material excavated.

The environmental consultant will periodically evaluate material excavated from the contaminated areas to determine if the material will require offsite disposal. The environmental consultant will evaluate excavated material based on field screening results, visual observations, and soil analytical results from previous environmental investigations. Assist the environmental consultant in collecting samples for evaluation using excavation equipment. The sampling frequency shall be a maximum of one sample for every 20 cubic yards excavated.

On the basis of the results of such field-screening, the material will be designated for disposal as follows:

- Excavation Common consisting of clean soil and/or clean construction and demolition fill (such as clean soil, boulders, concrete, reinforced concrete, bituminous pavement, bricks, building stone, and unpainted or untreated wood), which under NR 500.08 are exempt materials, or
- Low-level contaminated material (no laboratory analytical evidence of contamination, PID readings less than 10 ppm, and no observation of staining or petroleum odor) for reuse as fill within the construction limits, or
- Contaminated soil (laboratory analytical evidence of contamination, significant petroleum odor, staining, and/or PID readings greater than 10 ppm) for off-site treatment and disposal at the WDNR-licensed landfill facility, or
- Potentially contaminated material for temporary stockpiling and additional characterization prior to disposal

Some material may require additional characterization prior to disposal. Provide for the temporary stockpiling of up to 100 cubic yards of contaminated soil on-site that requires additional characterization. Construct and maintain a temporary stockpile of the material in accordance with NR 718.05(3), including, but not limited to, placement of the contaminated soil/fill material on an impervious surface and covering the stockpile with impervious material to prevent infiltration of precipitation. The Department's environmental consultant will collect representative samples of the stockpiled material, laboratory-analyze the samples, and advise the contractor, within 10 business days of the construction of the stockpile, of disposal requirements. The stockpiled material shall be disposed either at the WDNR-licensed disposal facility by the contractor or, if characterized as hazardous waste, by the Department. As an alternative to temporarily stockpiling contaminated soil/fill material that requires additional characterization, the contractor has the option of suspending excavation in those areas where such soil is encountered until such time as characterization is completed.

Directly load and haul materials designated by the environmental consultant for offsite disposal to the WDNR-licensed landfill facility. Verify that vehicles used to transport contaminated material are licensed for such activity in accordance with applicable state and federal regulations. Use loading and hauling practices that are appropriate to prevent any spills or releases of contaminated materials or residues. Prior to transport, sufficiently dewater materials designated for off-site disposal so as not to contain free liquids.

When material is encountered outside the above-identified limits of known contamination that appears to have been impacted with petroleum or chemical products, or when other obvious potentially contaminated materials are encountered or material exhibits characteristics of industrial-type wastes, such as fly ash, foundry sand, and cinders, or when underground storage tanks are encountered, suspend excavation in that area and notify the engineer.

D Measurement

The department will measure Excavation, Hauling, and Disposal of Contaminated Material in tons of contaminated material accepted by the landfill facility as documented by weight tickets generated by the landfill facility. Load tickets must be delivered to the engineer within 10 business days of the date on which the soil was accepted by the bioremediation facility. The Management of Contaminated Groundwater is considered incidental to the other items in the contract.

E Payment

The department will pay for measured quantities at the contract unit price under the following bid item:

ITEM NUMBER	DESCRIPTION	UNIT
205.0501.S	Excavation, Hauling, and Disposal of Contaminated Material	Ton

Payment is full compensation for excavating, segregating, loading, hauling, and disposal of contaminated material; obtaining solid waste collection and transportation service operating licenses; assisting in the collection of samples for field evaluation; dewatering of materials prior to transport, if necessary; and for furnishing all labor, tools, equipment, and incidentals necessary to complete the work.

205-003 (20080902)