

GIS REGISTRY

Cover Sheet

March, 2010
(RR 5367)

Source Property Information

BRRTS #:

ACTIVITY NAME:

PROPERTY ADDRESS:

MUNICIPALITY:

PARCEL ID #:

CLOSURE DATE:

FID #:

DATCP #:

COMM #:

*WTM COORDINATES:

X: **Y:**

** Coordinates are in
WTM83, NAD83 (1991)*

WTM COORDINATES REPRESENT:

- Approximate Center Of Contaminant Source
- Approximate Source Parcel Center

Please check as appropriate: (BRRTS Action Code)

Contaminated Media:

Groundwater Contamination > ES (236)

Contamination in ROW

Off-Source Contamination

*(note: for list of off-source properties
see "Impacted Off-Source Property" form)*

Soil Contamination > *RCL or **SSRCL (232)

Contamination in ROW

Off-Source Contamination

*(note: for list of off-source properties
see "Impacted Off-Source Property" form)*

Land Use Controls:

N/A (Not Applicable)

Soil: maintain industrial zoning (220)

*(note: soil contamination concentrations
between non-industrial and industrial levels)*

Structural Impediment (224)

Site Specific Condition (228)

Cover or Barrier (222)

*(note: maintenance plan for
groundwater or direct contact)*

Vapor Mitigation (226)

Maintain Liability Exemption (230)

*(note: local government unit or economic
development corporation was directed to
take a response action)*

Monitoring Wells:

Are all monitoring wells properly abandoned per NR 141? (234)

Yes No N/A

** Residual Contaminant Level*

***Site Specific Residual Contaminant Level*

This Adobe Fillable form is intended to provide a list of information that is required for evaluation for case closure. It is to be used in conjunction with Form 4400-202, Case Closure Request. The closure of a case means that the Department has determined that no further response is required at that time based on the information that has been submitted to the Department.

NOTICE: Completion of this form is mandatory for applications for case closure pursuant to ch. 292, Wis. Stats. and ch. NR 726, Wis. Adm. Code, including cases closed under ch. NR 746 and ch. NR 726. The Department will not consider, or act upon your application, unless all applicable sections are completed on this form and the closure fee and any other applicable fees, required under ch. NR 749, Wis. Adm. Code, Table 1 are included. It is not the Department's intention to use any personally identifiable information from this form for any purpose other than reviewing closure requests and determining the need for additional response action. The Department may provide this information to requesters as required by Wisconsin's Open Records law [ss. 19.31 - 19.39, Wis. Stats.].

BRRTS #: PARCEL ID #:
ACTIVITY NAME: WTM COORDINATES: X: Y:

CLOSURE DOCUMENTS (the Department adds these items to the final GIS packet for posting on the Registry)

- Closure Letter**
- Maintenance Plan** (if activity is closed with a land use limitation or condition (land use control) under s. 292.12, Wis. Stats.)
- Continuing Obligation Cover Letter** (for property owners affected by residual contamination and/or continuing obligations)
- Conditional Closure Letter**
- Certificate of Completion (COC)** (for VPLE sites)

SOURCE LEGAL DOCUMENTS

- Deed:** The most recent deed as well as legal descriptions, for the **Source Property** (where the contamination originated). Deeds for other, off-source (off-site) properties are located in the **Notification** section.
Note: If a property has been purchased with a land contract and the purchaser has not yet received a deed, a copy of the land contract which includes the legal description shall be submitted instead of the most recent deed. If the property has been inherited, written documentation of the property transfer should be submitted along with the most recent deed.
- Certified Survey Map:** A copy of the certified survey map or the relevant section of the recorded plat map for those properties where the legal description in the most recent deed refers to a certified survey map or a recorded plat map. (lots on subdivided or platted property (e.g. lot 2 of xyz subdivision)).
Figure #: **Title: Property Map, CSM Volume 24, page 63, April 14, 2010**
- Signed Statement:** A statement signed by the Responsible Party (RP), which states that he or she believes that the attached legal description accurately describes the correct contaminated property.

MAPS (meeting the visual aid requirements of s. NR 716.15(2)(h))

- Maps must be no larger than 11 x 17 inches unless the map is submitted electronically.
- Location Map:** A map outlining all properties within the contaminated site boundaries on a U.S.G.S. topographic map or plat map in sufficient detail to permit easy location of all parcels. If groundwater standards are exceeded, include the location of all potable wells within 1200 feet of the site.
Note: Due to security reasons municipal wells are not identified on GIS Packet maps. However, the locations of these municipal wells must be identified on Case Closure Request maps.
Figure #: 1 **Title: Skana Location**
 - Detailed Site Map:** A map that shows all relevant features (buildings, roads, individual property boundaries, contaminant sources, utility lines, monitoring wells and potable wells) within the contaminated area. This map is to show the location of all contaminated public streets, and highway and railroad rights-of-way in relation to the source property and in relation to the boundaries of groundwater contamination exceeding a ch. NR 140 Enforcement Standard (ES), and/or in relation to the boundaries of soil contamination exceeding a Residual Contaminant Level (RCL) or a Site Specific Residual Contaminant Levels (SSRCL) as determined under s. NR 720.09, 720.11 and 720.19.
Figure #: 4 **Title: PCB BRRTS area case #555268**
 - Soil Contamination Contour Map:** For sites closing with residual soil contamination, this map is to show the location of all contaminated soil and a single contour showing the horizontal extent of each area of contiguous residual soil contamination that exceeds a Residual Contaminant Level (RCL) or a Site Specific Residual Contaminant Level (SSRCL) as determined under s. NR 720.09, 720.11 and 720.19.
Figure #: **Title:**

BRRTS #: 02-36-555268

ACTIVITY NAME: Skana (K&V) North Mound (PCB)

MAPS (continued)

Geologic Cross-Section Map: A map showing the source location and vertical extent of residual soil contamination exceeding a Residual Contaminant Level (RCL) or a Site Specific Residual Contaminant Level (SSRCL). If groundwater contamination exceeds a ch. NR 140 Enforcement Standard (ES) when closure is requested, show the source location and vertical extent, water table and piezometric elevations, and locations and elevations of geologic units, bedrock and confining units, if any.

Figure #: **Title:**

Figure #: **Title:**

Groundwater Isoconcentration Map: For sites closing with residual groundwater contamination, this map shows the horizontal extent of all groundwater contamination exceeding a ch. NR140 Preventive Action Limit (PAL) and an Enforcement Standard (ES). Indicate the direction and date of groundwater flow, based on the most recent sampling data.

Note: This is intended to show the total area of contaminated groundwater.

Figure #: 5 **Title: North 3rd of Figure 5, PCB Contour**

Groundwater Flow Direction Map: A map that represents groundwater movement at the site. If the flow direction varies by more than 20° over the history of the site, submit 2 groundwater flow maps showing the maximum variation in flow direction.

Figure #: 6 **Title: Groundwater contours August 27, 2011**

Figure #: **Title:**

TABLES (meeting the requirements of s. NR 716.15(2)(h)(3))

Tables must be no larger than 11 x 17 inches unless the table is submitted electronically. Tables must not contain shading and/or cross-hatching. The use of **BOLD** or *ITALICS* is acceptable.

Soil Analytical Table: A table showing remaining soil contamination with analytical results and collection dates.

Note: This is one table of results for the contaminants of concern. Contaminants of concern are those that were found during the site investigation, that remain after remediation. It may be necessary to create a new table to meet this requirement.

Table #: 2 **Title: Pre- and Post-excavation VSR soil samples**

Groundwater Analytical Table: Table(s) that show the most recent analytical results and collection dates, for all monitoring wells and any potable wells for which samples have been collected.

Table #: 1 **Title: PCBs in Groundwater**

Water Level Elevations: Table(s) that show the previous four (at minimum) water level elevation measurements/dates from all monitoring wells. If present, free product is to be noted on the table.

Table #: **Title:**

IMPROPERLY ABANDONED MONITORING WELLS

For each monitoring well not properly abandoned according to requirements of s. NR 141.25 include the following documents.

Note: If the site is being listed on the GIS Registry for only an improperly abandoned monitoring well you will only need to submit the documents in this section for the GIS Registry Packet.

Not Applicable

Site Location Map: A map showing all surveyed monitoring wells with specific identification of the monitoring wells which have not been properly abandoned.

Note: If the applicable monitoring wells are distinctly identified on the Detailed Site Map this Site Location Map is not needed.

Figure #: **Title:**

Well Construction Report: Form 4440-113A for the applicable monitoring wells.

Deed: The most recent deed as well as legal descriptions for each property where a monitoring well was not properly abandoned.

Notification Letter: Copy of the notification letter to the affected property owner(s).

BRRTS #: 02-36-555268

ACTIVITY NAME: Skana (K&V) North Mound (PCB)

NOTIFICATIONS

Source Property

Not Applicable

Letter To Current Source Property Owner: If the source property is owned by someone other than the person who is applying for case closure, include a copy of the letter notifying the current owner of the source property that case closure has been requested.

Return Receipt/Signature Confirmation: Written proof of date on which confirmation was received for notifying current source property owner.

Off-Source Property

Group the following information per individual property and label each group according to alphabetic listing on the "Impacted Off-Source Property" attachment.

Not Applicable

Letter To "Off-Source" Property Owners: Copies of all letters sent by the Responsible Party (RP) to owners of properties with groundwater exceeding an Enforcement Standard (ES), and to owners of properties that will be affected by a land use control under s. 292.12, Wis. Stats.

Note: Letters sent to off-source properties regarding residual contamination must contain standard provisions in Appendix A of ch. NR 726.

Number of "Off-Source" Letters:

Return Receipt/Signature Confirmation: Written proof of date on which confirmation was received for notifying any off-source property owner.

Deed of "Off-Source" Property: The most recent deed(s) as well as legal descriptions, for all affected deeded **off-source property(ies)**. This does not apply to right-of-ways.

Note: If a property has been purchased with a land contract and the purchaser has not yet received a deed, a copy of the land contract which includes the legal description shall be submitted instead of the most recent deed. If the property has been inherited, written documentation of the property transfer should be submitted along with the most recent deed.

Letter To "Governmental Unit/Right-Of-Way" Owners: Copies of all letters sent by the Responsible Party (RP) to a city, village, municipality, state agency or any other entity responsible for maintenance of a public street, highway, or railroad right-of-way, within or partially within the contaminated area, for contamination exceeding a groundwater Enforcement Standard (ES) and/or soil exceeding a Residual Contaminant Level (RCL) or a Site Specific Residual Contaminant Level (SSRCL).

Number of "Governmental Unit/Right-Of-Way Owner" Letters:



January 20, 2012

(sent via email to Ken.Kazmierczak@skanaaluminum.com)

Kenneth Kazmierczak CFO, VP Administration
Skana Aluminum Company
PO Box 1477
Manitowoc, WI 54220

KEEP THIS DOCUMENT WITH YOUR PROPERTY RECORDS

SUBJECT: Final Case Closure
Skana Aluminum (K&V) North Mound (PCB)
Northeast of Rolling Mill at 2009 Mirro Drive, Manitowoc Wisconsin
WDNR Environmental Repair Activity # 02-36-555268, VPLE #06-36-556282

Dear Mr. Kazmierczak:

The Department considers this case closed and no further investigation or remediation is required at this time. Based on the correspondence and data provided, it appears that your case meets the closure requirements in ch. NR 726, Wisconsin Administrative Code.

On December 2, 2011, the Northeast Region Closure Committee reviewed your request for closure of the case described above. The Committee reviews environmental remediation cases for compliance with state rules and statutes to maintain consistency in the closure of these cases. On December 6, 2011, you were notified that the Closure Committee had granted conditional closure to this case.

On January 9, 2012, the Department received information or documentation indicating that you have complied with the requirements for final closure. The following documents were submitted.

- NR 141 Wis. Adm Code Monitoring well abandonment forms for wells MW22, MW23, MW24, MW3.1 and MW3.2
- Post Excavation Field Diagram showing base and sidewall soil sample collection sites

GIS Registry

The conditions of case closure set out below in this letter require that this site be listed on the Remediation and Redevelopment Program's GIS Registry. The specific reason is summarized below:

- Groundwater impacted by residual polychlorinated biphenyl (PCB) contamination greater than enforcement standards set forth in ch. NR140, Wis. Adm. Code, is present on this property, specifically as measured in groundwater at the location of the former monitoring well MW-23, as shown on the **attached map**.

This letter and information that was submitted with your closure request application will be included on the GIS Registry. To review the sites on the GIS Registry web page, visit the RR Sites Map page at: <http://dnr.wi.gov/org/aw/rr/gis/index.htm>. If the property is listed on the GIS Registry because of remaining

contamination and you intend to construct or reconstruct a well, you will need prior Department approval in accordance with s. NR 812.09(4) (w), Wis. Adm. Code. To obtain approval, Form 3300-254 needs to be completed and submitted to the DNR Drinking and Groundwater program's regional water supply specialist. This form can be obtained on-line <http://dnr.wi.gov/org/water/dwg/3300254.pdf> or at the web address listed above for the GIS Registry.

We appreciate your efforts to restore the environment at this site and enroll the property in the Voluntary Party Liability Exemption (VPLE) process. Your Certificate of Completion will be issued in the next several weeks. If you have any questions regarding this closure decision or anything outlined in this letter, please contact Annette Weissbach at 920-662-5165.

Sincerely,



Bruce Urban Air and Waste Division Leader
Northeast Region

Attach: Remaining groundwater contamination map

e-cc: Paul Kuplic – paulk@communitybankandtrust.com
James Bolger – JBI Inc., jim@jbidata.com
Michael Hebert – ECT, Inc., MHebert@ectinc.com
Michael Prager – RR/5

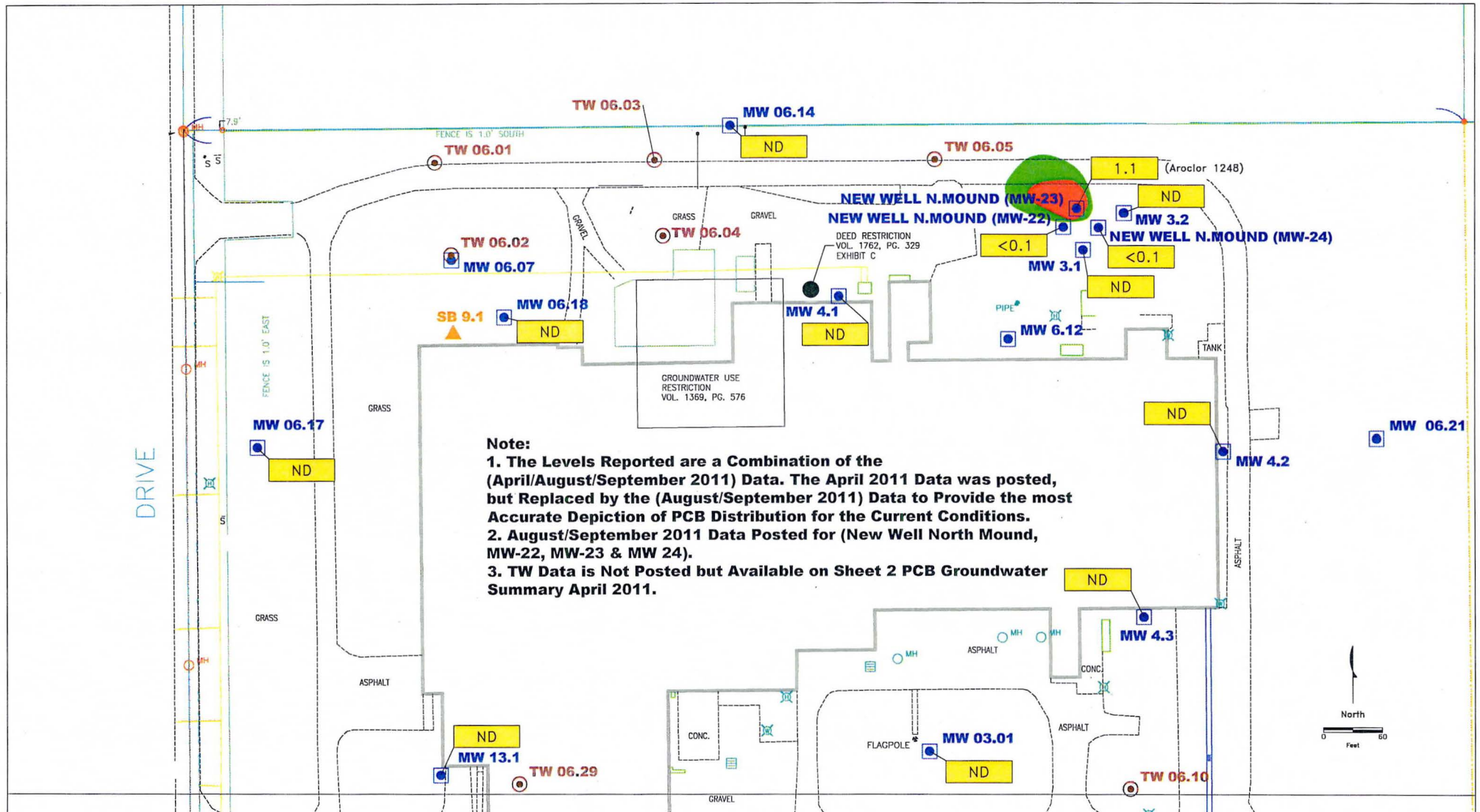

**North 3rd of Figure 5
PCB contour September 2011**

State of Wisconsin
DEPARTMENT OF NATURAL RESOURCES
Northeast Region Headquarters
2984 Shawano Avenue
Green Bay WI 54313-6727

Scott Walker, Governor
Cathy Stepp, Secretary
Jean Romback-Bartels, Regional Director
Telephone 920-662-5100
FAX 920-662-5413
TTY Access via relay - 711

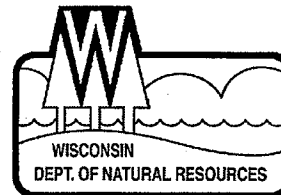

December 6, 2011

VPLE #06-36-556282

(sent via email to Ken.Kazmierczak@skanaaluminum.com)

Kenneth Kazmierczak CFO, VP Administration
Skana Aluminum Company
PO Box 1477
Manitowoc, WI 54220

Subject: Conditional Closure Decision with Requirements to Achieve Final Closure
Skana Aluminum (K&V) North Mound (PCB)
Northeast of Rolling Mill at 2009 Mirro Drive, Manitowoc Wisconsin
WDNR Environmental Repair Activity # 02-36-55528

Dear Mr. Kazmierczak:

On December 2, 2011, the Northeast Region Closure Committee reviewed your request for closure of the case described above. The Committee reviews environmental remediation cases for compliance with state rules and statutes to maintain consistency in the closure of these cases. After careful review of the closure request, the Closure Committee has determined that the PCB contamination at the previously identified North Mound appears to have been investigated and remediated to the extent practicable under site conditions.

You should be aware that PCB contaminated groundwater above the ch. NR 140 Wis Adm. Code Enforcement Standard remains at monitoring well location MW-23.

A site specific closure letter will be written once the conditions in this letter are met. Furthermore, since you are enrolled in Wisconsin's Voluntary Party Liability Exemption Process, a Certificate of Completion (COC) will be issued for the Property after all contamination cases on the property are closed. As we discussed on the phone on November 28th, Skana will be relying on natural attenuation to restore groundwater quality as part of this Closure. Because you will receive a COC prior to achieving compliance with the groundwater enforcement standards, Skana will be paying an environmental insurance fee. This insurance fee is in addition to the required VPLE application and oversight fees.

The PCB contamination at the former North Mound has been addressed to Department standards in accordance with s. NR 726.05, Wis. Adm. Code and will be closed if the following conditions are satisfied:

MONITORING WELL ABANDONMENT

The monitoring wells at the site must be properly abandoned in accordance with ch. NR 141, Wis. Adm. Code. Documentation of well abandonment must be submitted to me on Form 3300-005, found at <http://dnr.wi.gov/org/water/dwg/gw/> or provided by the Department of Natural Resources. Any remaining purge water and investigative wastes generated as part of site investigation must be disposed of or treated in accordance with Department of Natural Resources' rules. Please confirm in the cover letter submitted with the abandonment forms that all remaining purge waters and investigative wastes have been properly addressed.

POST EXCAVATION SOIL SAMPLING MAP

Please have your consultant submit a figure or map that visually displays where in the excavation bottom and sidewalls, the VSR samples were collected. It would be possible to use **Figure 3 – Section Grid** as a base map.

When the above conditions have been satisfied, please submit the appropriate documentation to verify that applicable conditions have been met, and your case will be closed. The North Mound PCB site will be listed on the Department's Remediation and Redevelopment GIS Registry. Information that was submitted with your closure request application will be included on the GIS Registry. To review the site on the GIS Registry web page, visit the RR Sites Map page at: <http://dnr.wi.gov/org/aw/rr/gis/index.htm>.

We appreciate your efforts to restore the environment at this site. If you have any questions regarding this letter, please contact me at 920-662-5165.

Sincerely,

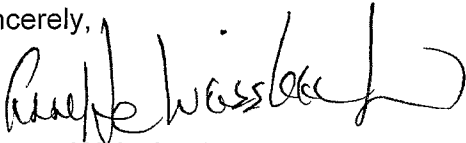

Annette Weissbach
Hydrogeologist
Remediation & Redevelopment Program

e-cc: James Bolger – JBI Inc., jim@jbidata.com
Michael Hebert – Environmental Consulting & Technology, Inc., MHebert@ectinc.com
Michael Prager – RR/5

BRRTS #: 02-36-555268

FID #: 436106110

SITE NAME: SKANA (K&V) - N MOUND (PCB)

Associated VPLE Site

To view the Certificate of Completion (COC) for this site click on the link below:

BRRTS #

SITE NAME

06-36-556282

[SKANA ALUMINUM CO \(VPLE\)](#)

State Bar of Wisconsin Form 3-2003
QUIT CLAIM DEED

DOC# 1081280

Document Name



VOL 2550 PG 286

THIS DEED, made between Michael S. Polsky as Receiver for Koenig & Vits, Inc.

("Grantor," whether one or more), and Skana Aluminum Company, a Wisconsin corporation

("Grantee," whether one or more).

Grantor quit claims to Grantee the following described real estate, together with the rents, profits, fixtures and other appurtenant interests, in Manitowoc

County, State of Wisconsin ("Property") (if more space is needed, please attach addendum):

STATE OF WI - MTWC CO
PRESTON JONES REG/DEEDS
RECEIVED FOR RECORD
04/30/2010 3:00:16 PM

Recording Area 13+6075 dld
Name and Return Address Titte Trends, Inc.
Godfrey & Kahn S.C. TK-6265
Attorney Charles Vogel
700 N. Water Street
Milwaukee, WI 53202-3590

052-809-401-010.00, 052-809-102-011.00,
052-809-103-011.00, 009-109-013-002.00

Parcel Identification Number (PIN)

This is not homestead property.
(is) (is not)

TRANSFER
\$ 1075.00
FEE

See legal description attached.

WS-7

Dated April 14, 2010.

Michael S. Polsky as Receiver for Koenig & Vits, Inc.

* (SEAL) [Signature] (SEAL)
* Michael S. Polsky, Receiver

* (SEAL) _____ (SEAL)
* _____

AUTHENTICATION

Signature(s) _____

authenticated on _____

ACKNOWLEDGMENT

STATE OF Wisconsin)

Milwaukee) ss. COUNTY)

Personally came before me on April 14, 2010,
the above-named Michael S. Polsky as Receiver for Koenig & Vits, Inc.

me known to be the person(s) who executed the foregoing instrument and acknowledged the same.

* Cathy J. Beyer
Notary Public, State of Wisconsin
commission (is permanent) (expires: December 16, 2012)

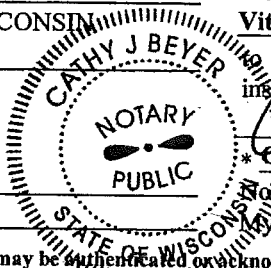

TITLE: MEMBER STATE BAR OF WISCONSIN
(If not, _____
authorized by Wis. Stat. § 706.06)

THIS INSTRUMENT DRAFTED BY:
Michael R. Stein, Esq.
Beck, Chaet, Bamberger & Polsky, S.C.

(Signatures may be authenticated or acknowledged. Both are not necessary.)

NOTE: THIS IS A STANDARD FORM. ANY MODIFICATION TO THIS FORM SHOULD BE CLEARLY IDENTIFIED.

QUIT CLAIM DEED

©2003 STATE BAR OF WISCONSIN

FORM NO. 3-2003

*Type name below signatures.

PROPERTY MAP

NW CORNER
SEC. 9
(PK. NAIL)

CITY LIMITS

N½ - NW¼ - NE¼
FARMS FIELD

S½ - NW¼ - NE¼

PARCEL 2
2,487,341 SF = 57.101 AC

SW¼ - NE¼

FOR Skana Aluminum Company and Chicago Title Insurance Company

Metes and Bounds description of Parcel 1:
All that part of the Southeast Quarter (SE 1/4) of Section Nine (9), Township
Northwest (19) North, Range Twenty-four
(24) East, 3rd Meridian of Chicago and
Northwestern, County of Manitowish, State
of Wisconsin, County of Manitowish,
City of Manitowish, County of
Manitowish, State of Wisconsin.
EXCEPTING therefrom that part of a
Certified Survey recorded in Volume 24 of
Certified Survey Maps, Page 63, as
documented No. 887183.
EXCEPTING a portion conveyed for street
purposes in Volume 1995, Page 230, as Document
No. 89532, and in Vol. 210, Page 231, as Document
No. 89533.

Metes and Bounds description of Parcel 2:
That part of the SW 1/4 of the
Northwest Quarter (NW 1/4) and South 1/2
of the Northwest Quarter (NE 1/4) of
Section 9, Township North (19) North,
Range Twenty-four (24) East, in the City
of Manitowish, County of Manitowish, State
of Wisconsin.
EXCEPTING a portion conveyed for street
purposes in Vol. 210, Page 230, as Document No.
89532.

CSM Volume 24 page 63
April 14, 2010

TOWN OF MANITOWOC

SE¼ - NE¼

NE CORNER
SEC. 9
(PK. NAIL)

CENTER OF
SECTION 9
(COVERED X ON NW 1/4)

DRIVE
MIRRO

DRIVE
WOODLAND

DRIVE
WOODLAND

DRIVE
WOODLAND

DRIVE
WOODLAND

DRIVE
WOODLAND

DRIVE
WOODLAND

DRIVE
WOODLAND

DRIVE
MIRRO

DRIVE
MIRRO

DRIVE
MIRRO

DRIVE
MIRRO

DRIVE
MIRRO

DRIVE
MIRRO

DRIVE
MIRRO

DRIVE
MIRRO

DRIVE
MIRRO

DRIVE
MIRRO

DRIVE
MIRRO

DRIVE
MIRRO

DRIVE
MIRRO

DRIVE
MIRRO

DRIVE
MIRRO

DRIVE
MIRRO

DRIVE
MIRRO

DRIVE
MIRRO

DRIVE
MIRRO

DRIVE
MIRRO

DRIVE
MIRRO

DRIVE
MIRRO

DRIVE
MIRRO

DRIVE
MIRRO

DRIVE
MIRRO

DRIVE
MIRRO

DRIVE
MIRRO

DRIVE
MIRRO

DRIVE
MIRRO

DRIVE
MIRRO

DRIVE
MIRRO

DRIVE
MIRRO

DRIVE
MIRRO

DRIVE
MIRRO

DRIVE
MIRRO

DRIVE
MIRRO

DRIVE
MIRRO

DRIVE
MIRRO

DRIVE
MIRRO

DRIVE
MIRRO

DRIVE
MIRRO

DRIVE
MIRRO

DRIVE
MIRRO

DRIVE
MIRRO

DRIVE
MIRRO

DRIVE
MIRRO

DRIVE
MIRRO

DRIVE
MIRRO

DRIVE
MIRRO

DRIVE
MIRRO

DRIVE
MIRRO

DRIVE
MIRRO

DRIVE
MIRRO

DRIVE
MIRRO

DRIVE
MIRRO

DRIVE
MIRRO

DRIVE
MIRRO

DRIVE
MIRRO

DRIVE
MIRRO

DRIVE
MIRRO

DRIVE
MIRRO

DRIVE
MIRRO

DRIVE
MIRRO

DRIVE
MIRRO

DRIVE
MIRRO

DRIVE
MIRRO

DRIVE
MIRRO

DRIVE
MIRRO

DRIVE
MIRRO

DRIVE
MIRRO

DRIVE
MIRRO

DRIVE
MIRRO

DRIVE
MIRRO

DRIVE
MIRRO

DRIVE
MIRRO

DRIVE
MIRRO

DRIVE
MIRRO

DRIVE
MIRRO

DRIVE
MIRRO

DRIVE
MIRRO

DRIVE
MIRRO

DRIVE
MIRRO

DRIVE
MIRRO

DRIVE
MIRRO

DRIVE
MIRRO

DRIVE
MIRRO

DRIVE
MIRRO

DRIVE
MIRRO

DRIVE
MIRRO

DRIVE
MIRRO

DRIVE
MIRRO

DRIVE
MIRRO

DRIVE
MIRRO

DRIVE
MIRRO

DRIVE
MIRRO

DRIVE
MIRRO

DRIVE
MIRRO

DRIVE
MIRRO

DRIVE
MIRRO

DRIVE
MIRRO

DRIVE
MIRRO

DRIVE
MIRRO

DRIVE
MIRRO

DRIVE
MIRRO

DRIVE
MIRRO

DRIVE
MIRRO

DRIVE
MIRRO

DRIVE
MIRRO

DRIVE
MIRRO

DRIVE
MIRRO

DRIVE
MIRRO

DRIVE
MIRRO

DRIVE
MIRRO

DRIVE
MIRRO

DRIVE
MIRRO

DRIVE
MIRRO

DRIVE
MIRRO

DRIVE
MIRRO

DRIVE
MIRRO

DRIVE
MIRRO

DRIVE
MIRRO

DRIVE
MIRRO

DRIVE
MIRRO

DRIVE
MIRRO

DRIVE
MIRRO

DRIVE
MIRRO

DRIVE
MIRRO

DRIVE
MIRRO

DRIVE
MIRRO

DRIVE
MIRRO

DRIVE
MIRRO

DRIVE
MIRRO

DRIVE
MIRRO

DRIVE
MIRRO

DRIVE
MIRRO

DRIVE
MIRRO

DRIVE
MIRRO

DRIVE
MIRRO

DRIVE
MIRRO

DRIVE
MIRRO

DRIVE
MIRRO

DRIVE
MIRRO

DRIVE
MIRRO

DRIVE
MIRRO

DRIVE
MIRRO

DRIVE
MIRRO

DRIVE
MIRRO

DRIVE
MIRRO

DRIVE
MIRRO

DRIVE
MIRRO

DRIVE
MIRRO

DRIVE
MIRRO

DRIVE
MIRRO

DRIVE
MIRRO

DRIVE
MIRRO

DRIVE
MIRRO

DRIVE
MIRRO

DRIVE
MIRRO

DRIVE
MIRRO

DRIVE
MIRRO

DRIVE
MIRRO

DRIVE
MIRRO

DRIVE
MIRRO

DRIVE
MIRRO

DRIVE
MIRRO

DRIVE
MIRRO

DRIVE
MIRRO

DRIVE
MIRRO

DRIVE
MIRRO

DRIVE
MIRRO

DRIVE
MIRRO

DRIVE
MIRRO

DRIVE
MIRRO

DRIVE
MIRRO

DRIVE
MIRRO

DRIVE
MIRRO

DRIVE
MIRRO

DRIVE
MIRRO

DRIVE
MIRRO

DRIVE
MIRRO

DRIVE
MIRRO

DRIVE
MIRRO

DRIVE
MIRRO

DRIVE
MIRRO

DRIVE
MIRRO

DRIVE
MIRRO

DRIVE
MIRRO

DRIVE
MIRRO

DRIVE
MIRRO

DRIVE
MIRRO

DRIVE
MIRRO

DRIVE
MIRRO

DRIVE
MIRRO

DRIVE
MIRRO

DRIVE
MIRRO

DRIVE
MIRRO

DRIVE
MIRRO

DRIVE
MIRRO

DRIVE
MIRRO

DRIVE
MIRRO

DRIVE
MIRRO

DRIVE
MIRRO

DRIVE
MIRRO

DRIVE
MIRRO

DRIVE
MIRRO

DRIVE
MIRRO

DRIVE
MIRRO

DRIVE
MIRRO

DRIVE
MIRRO

DRIVE
MIRRO

DRIVE
MIRRO

DRIVE
MIRRO

DRIVE
MIRRO

DRIVE
MIRRO

DRIVE
MIRRO

DRIVE
MIRRO

DRIVE
MIRRO

DRIVE
MIRRO

DRIVE
MIRRO

DRIVE
MIRRO

DRIVE
MIRRO

DRIVE
MIRRO

DRIVE
MIRRO

DRIVE
MIRRO

DRIVE
MIRRO

DRIVE
MIRRO

DRIVE
MIRRO

DRIVE
MIRRO

DRIVE
MIRRO

DRIVE
MIRRO

DRIVE
MIRRO

DRIVE
MIRRO

DRIVE
MIRRO

DRIVE
MIRRO

DRIVE
MIRRO

DRIVE
MIRRO

DRIVE
MIRRO

DRIVE
MIRRO

DRIVE
MIRRO

DRIVE
MIRRO

DRIVE
MIRRO

DRIVE
MIRRO

DRIVE
MIRRO

DRIVE
MIRRO

DRIVE
MIRRO

DRIVE
MIRRO

DRIVE
MIRRO

DRIVE
MIRRO

DRIVE
MIRRO

DRIVE
MIRRO

DRIVE
MIRRO

DRIVE
MIRRO

DRIVE
MIRRO

DRIVE
MIRRO

DRIVE
MIRRO

DRIVE
MIRRO

DRIVE
MIRRO

DRIVE
MIRRO

DRIVE
MIRRO

DRIVE
MIRRO

DRIVE
MIRRO

DRIVE
MIRRO

DRIVE
MIRRO

DRIVE
MIRRO

DRIVE
MIRRO

DRIVE
MIRRO

DRIVE
MIRRO

DRIVE
MIRRO

DRIVE
MIRRO

SIGNED STATEMENT / CERTIFICATION

The purpose of this certification is to verify that the provided legal description for each of the contaminated properties has been submitted. The signatory is not required to attest to the accuracy of the attached legal description.

I, Kenneth J. Kazmierczak, Agent of or Responsible Party (RP) for the site investigation and remediation at the Skana Aluminum Company property located at 2009 Mirro Drive, Manitowoc, Wisconsin (WDNR BRRTS: #02-36-544601, #02-36-550138, and #02-36-555268), do hereby certify that to the best of my knowledge the legal description has been attached for each property that is within, or partially within, the contaminant site boundary.

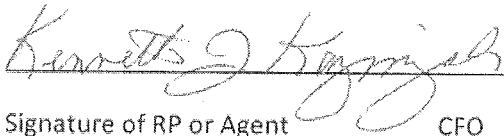

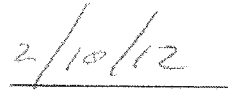

Signature of RP or Agent CFO

Figure 1 – Skana Location

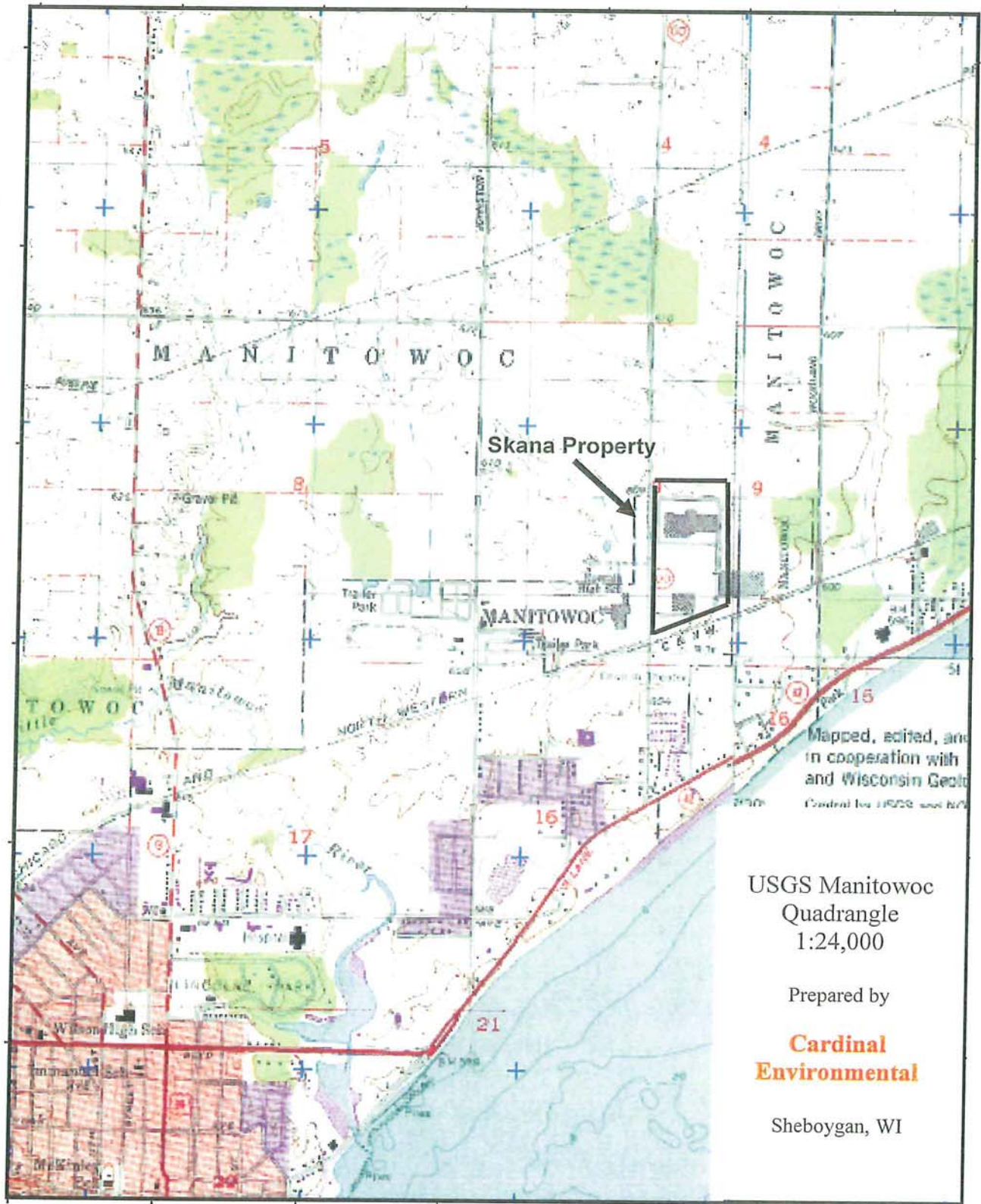

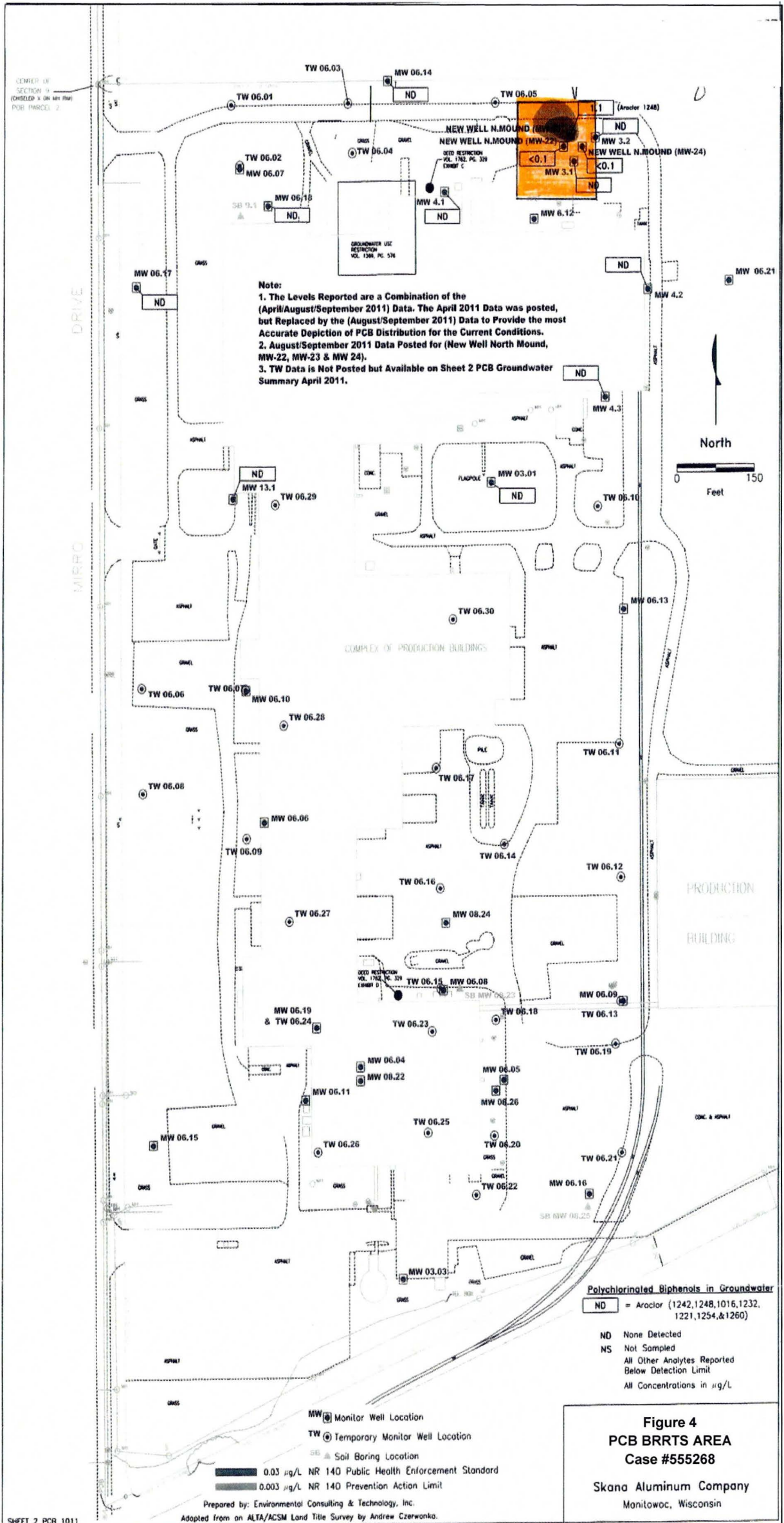

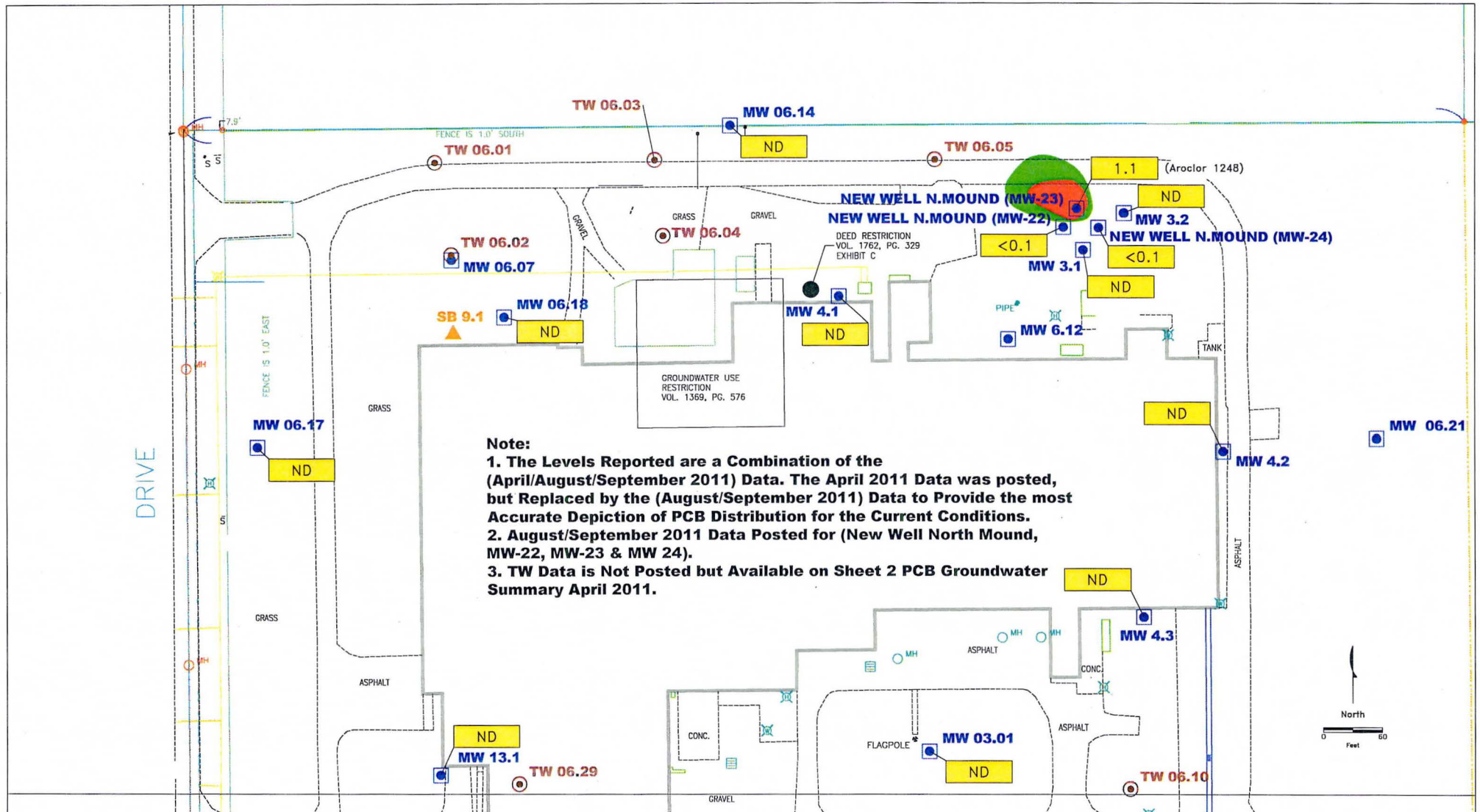

**North 3rd of Figure 5
PCB contour September 2011**

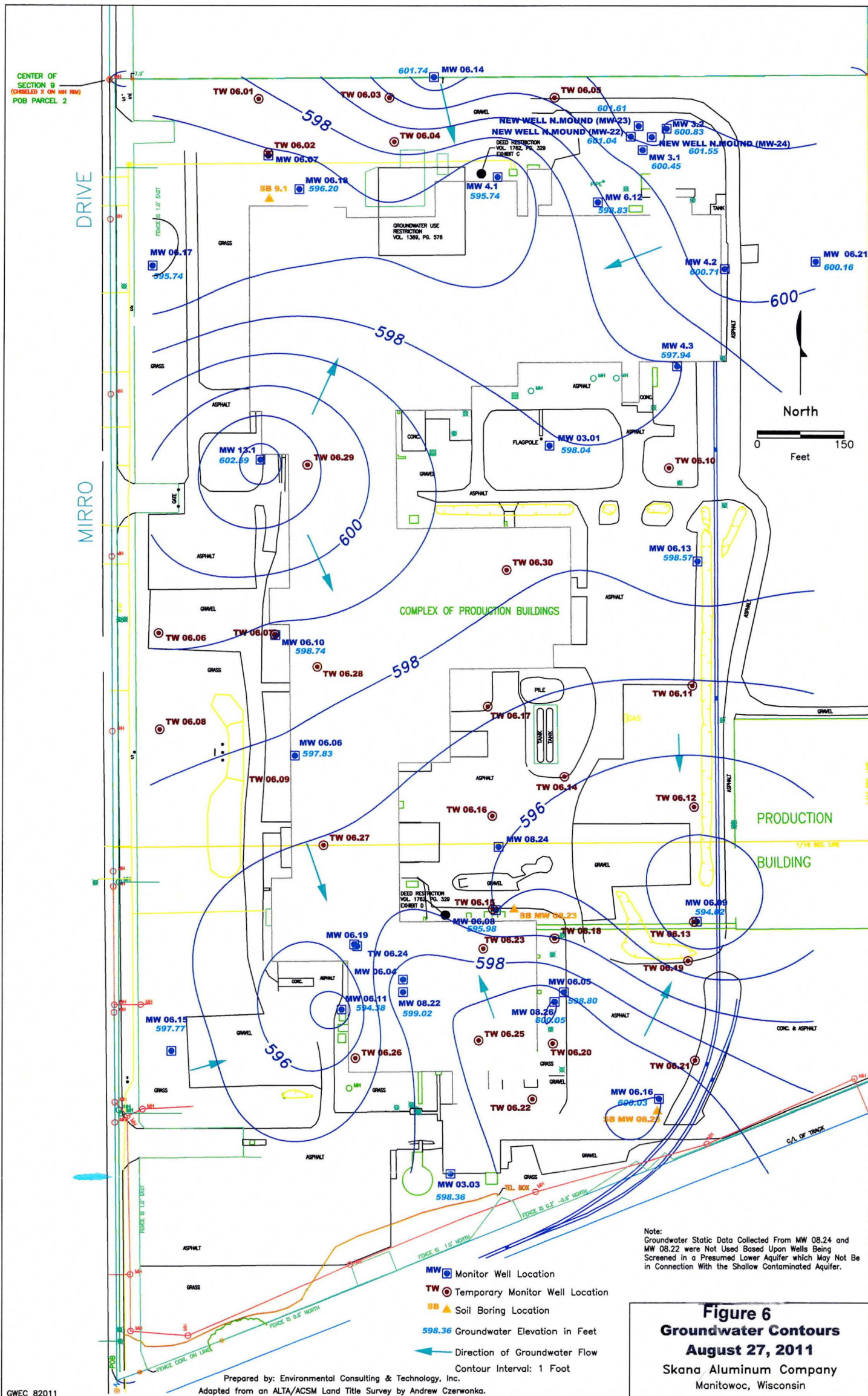

CENTER OF SECTION 8 (DASHED X ON MH MM) POB PARCEL 2

DRIVE

MIRRO

COMPLEX OF PRODUCTION BUILDINGS

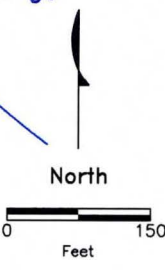

- MW [Symbol] Monitor Well Location
- TW [Symbol] Temporary Monitor Well Location
- SB [Symbol] Soil Boring Location
- 598.36 Groundwater Elevation in Feet
- [Arrow] Direction of Groundwater Flow
- Contour Interval: 1 Foot

Note:
Groundwater Static Data Collected From MW 08.24 and MW 08.22 were Not Used Based Upon Wells Being Screened in a Presumed Lower Aquifer which May Not Be in Connection With the Shallow Contaminated Aquifer.

Table 2 – Pre- and Post Excavation (VSR) Soil Samples

Grid Location	Layer	Depth	Matrix	Pre-excavation PCB Concentration (ppm)	Limit of Detection (ppm)	Post-excavation PCB Concentration (ppm)	Limit of Detection (ppm)
1	A	0 – 4 ft.	Soil	ND	0.0073		
	B	4 – 8 ft.	Soil	ND	0.0076		
	C	8 – 12 ft.	Soil	ND	0.0075		
2	A	0 – 4 ft.	Soil	197.0	3.710	ND / ND / ND	0.390 – 0.420
	B	4 – 8 ft.	Soil	<i>2.910</i>	0.0367	ND / ND / ND	0.390 – 0.420
	C	8 – 12 ft.	Soil	0.287	0.0077		
3	A	0 – 4 ft.	Soil	0.452	0.0074		
	B	4 – 8 ft.	Soil	0.604	0.0077		
	C	8 – 12 ft.	Soil	ND	0.0070		
4	A	0 – 4 ft.	Soil	ND	0.0074		
	B	4 – 8 ft.	Soil	ND	0.0074		
	C	8 – 12 ft.	Soil	ND	0.0071		
5	A	0 – 4 ft.	Soil	33.2	0.0072		
	B	4 – 8 ft.	Soil	<i>1.130</i>	0.0075	ND / ND	0.390 – 0.420
	C	8 – 12 ft.	Soil	0.132	0.0072		
6	A	0 – 4 ft.	Soil	0.143	0.0074		
	B	4 – 8 ft.	Soil	0.121	0.0073		
	C	8 – 12 ft.	Soil	ND	0.0073		
7	A	0 – 4 ft.	Soil	ND	0.0074		
	B	4 – 8 ft.	Soil	ND	0.0073		
	C	8 – 12 ft.	Soil	ND	0.0072		
8	A	0 – 4 ft.	Soil	156.0	0.730	ND / ND / ND	0.390 – 0.420
	B	4 – 8 ft.	Soil	0.127	0.0072	ND / ND	0.390 – 0.420
	C	8 – 12 ft.	Soil	0.081	0.0073	ND	0.390 – 0.420
9	A	0 – 4 ft.	Soil	486.0	3.650	ND / ND / ND / ND	0.390 – 0.420
	B	4 – 8 ft.	Soil	54.50	0.375	ND / ND / ND	0.390 – 0.420
	C	8 – 12 ft.	Soil	<i>1.580</i>	0.0072	ND / ND / ND / ND	0.390 – 0.420
10	C	8 – 12 ft.	Soil	ND	0.0073		
	D	12 – 16 ft.	Soil	0.652	0.0078		
11	C	8 – 12 ft.	Soil	ND	0.0075		

Bold = TSCA Waste - >50<500

Italics = >Wisconsin Soil Limit – 1 ppm

Table 1 - PCB's in Groundwater

Nov-10 Aug -11 Nov-10 Aug -11 Nov-10 Aug -11

Compound	Units	NR 140 PHES	NR 140 PAL	MW-22		MW-23		MW-24	
				Nov-10	Aug -11	Nov-10	Aug -11	Nov-10	Aug -11
Aroclor 1242	µg/L	0.03	<i>0.003</i>	ND	<0.1	ND	<0.1	ND	<0.1
Aroclor 1248	µg/L	0.03	<i>0.003</i>	1.70	<0.1	<0.1	1.1	<0.1	<0.1
Aroclor 1016	µg/L	0.03	<i>0.003</i>	ND	<0.1	ND	<0.1	ND	<0.1
Aroclor 1232	µg/L	0.03	<i>0.003</i>	ND	<0.1	ND	<0.1	ND	<0.1
Aroclor 1221	µg/L	0.03	<i>0.003</i>	ND	<0.1	ND	<0.1	ND	<0.1
Aroclor 1254	µg/L	0.03	<i>0.003</i>	ND	<0.1	ND	<0.1	ND	<0.1
Aroclor 1260	µg/L	0.03	<i>0.003</i>	ND	<0.1	ND	<0.1	ND	<0.1