

## State of Wisconsin \ DEPARTMENT OF NATURAL RESOURCES

Jim Doyle, Governor  
Matthew J. Frank, Secretary  
Ronald W. Kazmierczak, Regional Director

Northeast Region Headquarters  
2984 Shawano Ave.  
Green Bay, Wisconsin 54313-6727  
Telephone 920-662-5100  
FAX 920-662-5413  
TTY Access via relay - 711

September 1, 2010

Ms. Sharlene TeBeest  
WI DOT - Equity & Env Services  
4802 Sheboygan Ave, Rm 451  
Madison, WI 53707-7965

Subject: Reported Contamination at **White Property - WI DOT, WI**  
WDNR BRRTS Activity # **03-45-555892**

Dear Ms. TeBeest:

On August 16, 2010, Dan Haak, of RMT Inc, notified the Wisconsin Department of Natural Resources ("WDNR") that petroleum contamination had been detected at the site described above.

Based on the information that has been submitted to the WDNR regarding this site, we believe you are responsible for investigating and restoring the environment at the above-described site under Section 292.11, Wisconsin Statutes, known as the hazardous substances spills law.

This letter describes the legal responsibilities of a person who is responsible under Section 292.11, explains what you need to do to investigate and clean up the contamination, and provides you with information about cleanups, environmental consultants, possible financial assistance, and working cooperatively with the WDNR, Department of Commerce ("Commerce") or the Department of Agriculture, Trade and Consumer Protection.

### **Legal Responsibilities:**

Your legal responsibilities are defined both in statute and in administrative codes. The hazardous substances spill law, Section 292.11 (3) Wisconsin Statutes, states:

- **RESPONSIBILITY.** A person who possesses or controls a hazardous substance which is discharged or who causes the discharge of a hazardous substance shall take the actions necessary to restore the environment to the extent practicable and minimize the harmful effects from the discharge to the air, lands, or waters of the state.

Wisconsin Administrative Code chapters NR 700 through NR 749 establish requirements for emergency and interim actions, public information, site investigations, design and operation of remedial action systems, and case closure. Wisconsin Administrative Code chapter NR 140 establishes groundwater standards for contaminants that reach groundwater.

Activity Name: White Property – WI DOT  
BRRTS #: 03-45-555892  
RP: Sharlene TeBeest – WI DOT

2

September 1, 2010

### **Steps to Take:**

The longer contamination is left in the environment, the farther it can spread and the more it may cost to clean up. Quick action may lessen damage to your property and neighboring properties and reduce your costs in investigating and cleaning up the contamination. To ensure that your cleanup complies with Wisconsin's laws and administrative codes, you should hire a professional environmental consultant who understands what needs to be done. These are the first steps to take:

1. Within the next **30 days**, by October 1, 2010, you should submit written verification (such as a letter from the consultant) that you have hired an environmental consultant. If you do not take action within this time frame, the WDNR may initiate enforcement action against you.
2. Within the next **60 days**, by November 1, 2010, your consultant should submit a work plan and schedule for the investigation. The consultant must comply with the requirements in the NR 700 Wis. Adm. Code rule series and should adhere to current WDNR technical guidance documents.

In addition, within 30 days of completion of the site investigation, your consultant should submit a site investigation report to the department or other agency with administrative authority.

For sites with petroleum contamination, when your investigation has established the degree and extent of contamination, your consultant will be able to determine whether the Department of Commerce or the WDNR has authority over the case. For agrichemicals, your case will be transferred to the Department of Agriculture, Trade and Consumer Protection for oversight.

Sites where discharges to the environment have been reported are entered into the Bureau for Remediation and Redevelopment Tracking System ("BRRTS"), a version of which appears on the WDNR's internet site. You may view the information related to your site at any time (<http://botw.dnr.state.wi.us/botw/Welcome.do>) and use the feedback system to alert us to any errors in the data.

If you want a formal written response from the department on a specific submittal, please be aware that a review fee is required in accordance with ch. NR 749, Wis. Adm. Code. If a fee is not submitted with your reports, you should proceed under the advice of your consultant to complete the site investigation and cleanup to maintain your compliance with the spills law and chapters NR 700 through NR 749. **Do not delay the investigation of your site by waiting for an agency response.** We have provided detailed technical guidance to environmental consultants. Your consultant is expected to know our technical procedures and administrative rules and should be able to answer your questions on meeting cleanup requirements.

All correspondence regarding this site should be sent to:

Elizabeth Victor  
Remediation and Redevelopment Program  
Wisconsin Department of Natural Resources  
625 E County Rd Y Suite 700  
Oshkosh, WI 54901-9731  
elizabeth.victor@wisconsin.gov

Unless otherwise requested, please send only one hard copy of plans and reports. In addition to the paper copy, an electronic copy may also be submitted to assist the WDNR with site evaluation and discussions. A hard copy of any attachments sent electronically must be submitted for the information to be included in the site file, regardless of size. To speed processing, correspondence should reference the BRRTS and FID numbers (if assigned) shown at the top of this letter.

Activity Name: White Property – WI DOT  
BRRTS #: 03-45-555892  
RP: Sharlene TeBeest – WI DOT

3

September 1, 2010

**Additional Information for Site Owners:**

We encourage you to visit our website at <http://dnr.wi.gov/org/aw/rr>, where you can find information on selecting a consultant, financial assistance and understanding the cleanup process. You will also find information there about liability clarification letters, post-cleanup liability and more.

Information to help you select a consultant, materials on controlling costs, understanding the cleanup process, and choosing a site cleanup method are enclosed. In addition, *Fact Sheet 2 – Voluntary Party Remediation and Exemption from Liability* is enclosed and provides information on obtaining protection of limited liability under s. 292.15, Wis. Stats.

If you have questions, call **Elizabeth Victor, (920) 303-5424** for more information or visit the RR web site at the address above.

Thank you for your cooperation.

Sincerely,

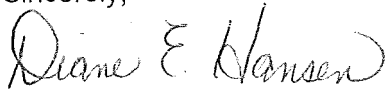

Diane E. Hansen  
Environmental Program Associate  
Remediation & Redevelopment Program

- Enclosures:
1. Remediation & Redevelopment Program
  2. Environmental Contamination – The Basics
  3. Selecting an Environmental Consultant
  4. Environmental Services Contractor List
  5. Fact Sheet 2, VPLE
  6. CLEAN – Pub-RR-788
  7. Information about PECFA

cc: Dan Haak, RMT, Inc, 744 Heartland Trail, Madison, WI 53717  
Elizabeth Victor - DNR, Oshkosh

Attach. Excavation Area Map  
Soil Analytical Results Table

**PLQI DATA**

Drawing Name: x  
Operator Name: x  
Scale: x

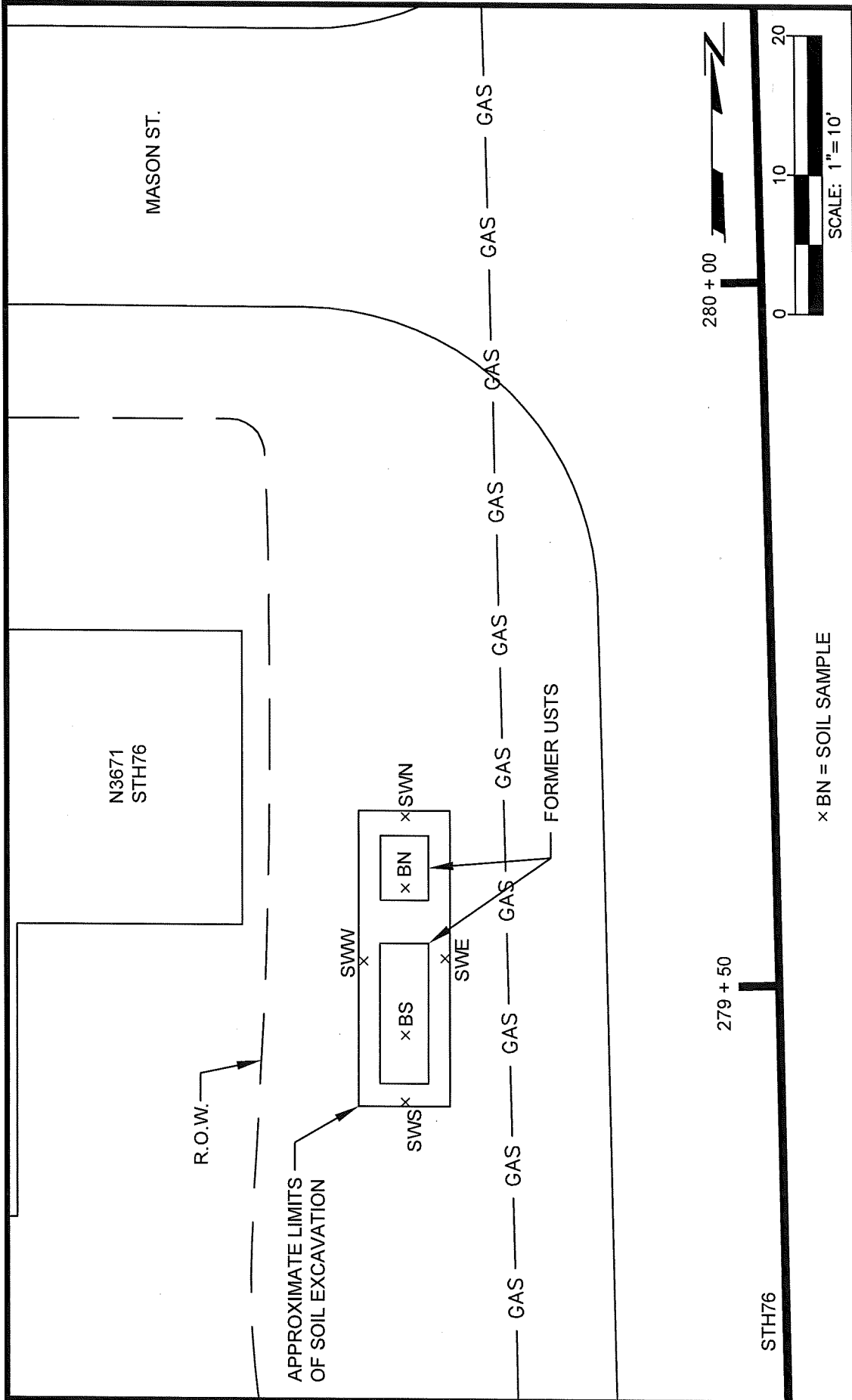

DRAWN BY:	FITZGERALD
APPROVED BY:	HAAK
PROJECT NO.	06343.01.001
FILE NO.	63430101.DWG
DATE:	AUGUST 2010

**WISDOT - STH76 STEPHENSVILLE  
ID# 6617-07-74**

**SITE PLAN**



Table 1  
 Summary of Preliminary (8/16/10) Soil Analytical Results  
 STH 76, Stephenville – WisDOT Project ID #6517-07-74  
 August 6, 2010

Preliminary

ANALYTE	NR 720 RCL	NR 746 STANDARD	SOIL SAMPLE ID AND DEPTH (feet bgs)						
			SWN	SWE	SWS	SWW	BN	BS	WC
			3	3	3	3	8	8	--
PID	--	--	119	279	29	3	472	7	> 2,000
DRO (mg/kg)	100	--	344	363	< 1.2	< 1.0	330	< 1.0	4.2
GRO (mg/kg)	100	--	2,890	4,210	< 3.1	4.8	1,890	< 2.9	240
1,2,4-Trimethylbenzene (µg/kg)	--	83,000	72,200	<b>173,000</b>	< 25.0	68.5 J	77,900	< 25.0	8,540
1,3,5-Trimethylbenzene (µg/kg)	--	11,000	<b>44,500</b>	<b>86,800</b>	< 25.0	82.8	<b>31,100</b>	< 25.0	4,920
Benzene (µg/kg)	5.5	8,500 / 1,100 <sup>(1)</sup>	< 625	< 1,000	< 25.0	< 25.0	< 500	< 25.0	< 50.0
Ethylbenzene (µg/kg)	2,900	4,600	<b>17,700</b>	<b>20,600</b>	< 25.0	< 25.0	<b>27,100</b>	< 25.0	861
MTBE (µg/kg)	--	--	< 625	< 1,000	< 25.0	< 25.0	< 500	< 25.0	< 50.0
Naphthalene (µg/kg)	400 <sup>(2)</sup>	2,700	<b>17,500 B</b>	<b>19,400 B</b>	< 25.0	48.3 J, B	<b>12,000 B</b>	< 25.0	1,930 B
Toluene (µg/kg)	1,500	38,000	11,000	4,790	< 25.0	< 25.0	32,200	< 25.0	83.1 J
Total xylenes (µg/kg)	4,100	42,000	<b>130,000</b>	<b>93,200</b>	< 75.0	< 75.0	<b>155,000</b>	< 75.0	7,500
Lead (µg/kg)	50	--	NA	NA	NA	NA	NA	NA	NR

**Notes:**

RCLs = Wisconsin Administrative Code Chapter NR 720 generic Residual Contaminant level. RCL for lead is non-industrial standard.  
 bgs = below ground surface.  
 PID = photoionization detector.  
 DRO - diesel range organics.  
 GRO = gasoline range organics.  
 -- = no RCL established.  
 NA = not analyzed.  
 NR = Laboratory analytical results not yet received.  
 B = Analyte was detected in the associated method blank.  
 J = estimated concentration above the adjusted method detection limit and below the adjusted reporting limit.  
*ITALICS* values exceed NR 720 RCL.  
**BOLD** values exceed NR 746 Standard.

Prepared by: MDW 08/16/10

Checked by: DJH 08/16/10

**Footnotes:**

<sup>(1)</sup> 1,100 applies to the top 4 ft of soil per NR 746 Direct Contact Standard.  
<sup>(2)</sup> RR-519-97 groundwater pathway RCL for naphthalene.