

**State of Wisconsin**  
**DEPARTMENT OF NATURAL RESOURCES**  
101 S. Webster Street  
Box 7921  
Madison WI 53707-7921

**Scott Walker, Governor**  
**Cathy Stepp, Secretary**  
Telephone 608-266-2621  
Toll Free 1-888-936-7463  
TTY Access via relay - 711



December 21, 2012

John Wagner  
Blue Top Shell  
PO Box 28  
Antigo, WI 54409

**SUBJECT:** No Further Action  
Blue Top Shell, 3449 Church Street, Stevens Point, WI  
BRRTS# 03-50-559755

Dear Mr. Wagner:

On December 10, 2012, the Wisconsin Department of Natural Resources received the request for No Further Action for the above-mentioned property. I have reviewed the document and concur that the environment has been restored to the extent practicable as provided in ch. NR 708.09, Wis. Adm. Code. Therefore, the immediate action in response to a release has been completed and the Department of Natural Resources is requiring no further action at this time.

We appreciate your efforts to protect and restore the environment at this site. If you have any questions regarding this No Further Action determination, please contact me in Wisconsin Rapids at (715) 252-2873.

Sincerely,

Dave Rozeboom  
Hydrogeologist  
Bureau for Remediation & Redevelopment

Enclosure

cc: Andrew Delforge, REI



CIVIL & ENVIRONMENTAL  
ENGINEERING, SURVEYING

4080 N. 20th Ave / Wausau, WI 54401

Tel: 715.675.9784 / Fax: 715.675.4060

E-MAIL: mail@REIengineering.com

## LETTER OF TRANSMITTAL

03-50-559755

Check Remit  
12-18-12

TO: Dave Rozeboom

WDNR

473 Griffith Avenue

Wisconsin Rapids, WI 54494

ATTENTION:

DATE: December 7, 2012

PROJECT: Blue Top Shell

LOCATION: 3449 Church Street, Stevens Point

RE: NFA fee

We are sending you:

☒ Herewith

☐ Delivered by Hand

☐ Under Separate Cover

Via

the following items:

☐ Plans

☐ Specifications

☐ Shop Drawings

☐ Samples

☐ Subcontract

☐ Change Order

☐

Copies	Date or No.	Description
1	0072167	Check for \$250 NFA

These are transmitted as indicated below:

☒ For Your Use

☐ Approved as Noted

☐ Return \_\_\_\_\_ Signed Documents

☐ For Approval

☐ Approved for Construction

☐ Submit \_\_\_\_\_ Copies for \_\_\_\_\_

☐ For Bids Due \_\_\_\_\_

☐ Return for Corrections

☐ Resubmit \_\_\_\_\_ Copies for \_\_\_\_\_

☐ As Requested

☐ For Signature & Return

☐ For Review & Comment

☐

Remarks: Thanks for the quick review, let me know if you need anything else.

IF ENCLOSURES ARE NOT AS INDICATED,  
PLEASE NOTIFY US AT ONCE.

SIGNED: \_\_\_\_\_

Andrew R. Delforge

PRINT NAME

## Rozeboom, David B - DNR

---

**From:** Rozeboom, David B - DNR  
**Sent:** Thursday, December 06, 2012 3:30 PM  
**To:** 'Andy Delforge'  
**Subject:** Blue Top Shell

Hi Andy-

I received the No Further Action request for the Blue Top Shell. For an official NFA determination I will need to request a \$250 fee. I also need you to fill out a release notification.

Once these items are received I can process in short order.

Thanks,

Dave Rozeboom  
Hydrogeologist  
WI Department of Natural Resources  
473 Griffith Avenue, Wisconsin Rapids, WI 54494  
Phone: (715) 421-7873 / Fax: (715) 421-7830  
E-Mail: [David.Rozeboom@wi.gov](mailto:David.Rozeboom@wi.gov)

03-50-559755

# Notification For Hazardous Substance Discharge (Non-Emergency Only)

Form 4400-225 (05/12) Page 1 of 2

**Emergency Discharges / Spills should be reported via the 24-Hour Hotline: 1-800-943-0003**

**Notice: Hazardous substance discharges must be reported immediately** according to s. 292.11 Wis. Stats. Non-emergency hazardous substance discharges may be reported by telefaxing or e-mailing a completed report to the Department, or calling or visiting a Department office in person. If you choose to notify the Department by telefax or by email, you should use this form to be sure that all necessary information is included. However, use of this form is not mandatory. Under s. 292.99, Wis. Stats., the penalty for violating the reporting requirements of ch. 292 Wis. Stats., shall be no less than \$10 nor more than \$5000 for each violation. Each day of continued violation is a separate offense. It is not the Department's intention to use any personally identifiable information from this form for any purpose other than program administration. However, information submitted on this form may also be made available to requesters under Wisconsin's Open Records Law (ss. 19.31 – 19.39, Wis. Stats.).

Confirmatory laboratory data should be included with this form, to assist the DNR in processing this Hazardous Substance Release Notification.

Complete this form. **TYPE or PRINT LEGIBLY.** NOTIFY appropriate DNR region (see next page) **IMMEDIATELY** upon discovery of a potential release from (check one):

- ☒ Underground Petroleum Storage Tank System (additional information may be required for Item 6 below)  
☐ Aboveground Petroleum Storage Tank System  
☐ Dry Cleaner Facility  
☐ Other - Describe: FID 750088240

ATTN DNR: **R & R Program Associate**

Date DNR Notified: 12/07/2012

## 1. Discharge Reported By

Name Andrew Delforge	Firm REI Engineering, Inc.	Phone No. (include area code) (715) 675-9784
Mailing Address 4080 North 20th Avenue, Wausau, WI 54401		Email Address adelforge@reiengineering.com

## 2. Site Information

Name of site at which discharge occurred. Include local name of site/business, not responsible party name, unless a residence/vacant property. Blue Top Shell

Location: Include street address, not PO Box. If no street address, describe as precisely as possible, i.e., 1/4 mile NW of CTHs 60 & 123 on E side of CTH 60. 3449 Church Street

Municipality: (City, Village, Township) Specify municipality in which the site is located, not mailing address/city.

Stevens Point

County: Portage	Legal Description: ____ 1/4 ____ 1/4 Sec ____ Tn ____ Range ____ <input type="radio"/> E <input type="radio"/> W	WTM: X 554864 Y 447336
--------------------	---	---------------------------

## 3. Responsible Party (RP) and/or RP Representative

Responsible Party Name: Business or owner name that is responsible for cleanup. If more than one, list all. Attach additional pages as necessary.

Wagner Oil

- ☐ Reported in compliance with s. 292.11(2), Wis. Stats., by a local government exempt from liability under s. 292.11(9)(e), Wis. Stats.  
For more information see <http://dnr.wi.gov/org/aw/rr/lgu/liability.htm>.

Contact Person Name (if different) John Wagner	Phone Number (715) 623-5386	Email Address johnw@wagner-oil.com	
Mailing Address P.O. Box 28	City Antigo	State WI	ZIP Code 54409

Property owner if Different From RP: Business or owner name that is responsible for cleanup. If more than one, list all. Attach additional pages as necessary. M & J Hintz Properties, LLC

Contact Person Name (if different) Crystal Fletcher	Phone Number (715) 341-6855	Email Address	
Mailing Address 3449 Church Street	City Stevens Point	State WI	ZIP Code 54481

(continued)

# Notification For Hazardous Substance Discharge (Non-Emergency Only)

Form 4400-225 (05/12) Page 2 of 2

## 4. Hazardous Substance Information

Identify hazardous substance discharged (check all that apply):

- |  |   |   |
|--|---|---|
| <input type="checkbox"/> VOC's                   | <input type="checkbox"/> Diesel                 | <input type="checkbox"/> PERC (Dry Cleaners)                |
| <input type="checkbox"/> PAH's                   | <input type="checkbox"/> Fuel Oil               | <input type="checkbox"/> RCRA Hazardous Waste               |
| <input type="checkbox"/> Metals (specify): _____ | <input checked="" type="checkbox"/> Gasoline    | <input type="checkbox"/> Leachate                           |
| <input type="checkbox"/> Arsenic                 | <input type="checkbox"/> Hydraulic Oil          | <input type="checkbox"/> Fertilizer                         |
| <input type="checkbox"/> Chromium                | <input type="checkbox"/> Jet Fuel               | <input type="checkbox"/> Pesticide/Herbicide/Insecticide(s) |
| <input type="checkbox"/> Cyanide                 | <input type="checkbox"/> Mineral Oil            | <input type="checkbox"/> Other (specify): _____             |
| <input type="checkbox"/> Lead                    | <input type="checkbox"/> Waste Oil              | <input type="checkbox"/> Unknown                            |
| <input type="checkbox"/> PCB's                   | <input type="checkbox"/> Petroleum-Unknown Type |   |

## 5. Impacts to the Environment Information

Enter "K" for known/confirmed or "P" for potential for all that apply.

- |   |  |  |
|---|--|--|
| <input type="checkbox"/> Air Contamination                            | <input type="checkbox"/> Sanitary Sewer Contamination  | <input checked="" type="checkbox"/> Soil Contamination |
| <input type="checkbox"/> Co-Contamination (Petroleum & Non-Petroleum) | <input type="checkbox"/> Contamination in Right of Way | <input type="checkbox"/> Storm Sewer Contamination     |
| <input type="checkbox"/> Contamination Within 1 Meter of Bedrock      | <input type="checkbox"/> Fire Explosion Threat         | <input type="checkbox"/> Surface Water Contamination   |
| <input type="checkbox"/> Contaminated Private Well                    | <input type="checkbox"/> Free Product                  | <input type="checkbox"/> Within 100 ft of Private Well |
| <input type="checkbox"/> Contaminated Public Well                     | <input type="checkbox"/> Groundwater Contamination     | <input type="checkbox"/> Within 1000 ft of Public Well |
| <input type="checkbox"/> Contamination in Fractured Bedrock           | <input type="checkbox"/> Off-Site Contamination        |  |
|   | <input type="checkbox"/> Other (specify): _____        |  |

Contamination was discovered as a result of:

- |  |  |   |
|--|--|---|
| <input type="checkbox"/> Tank closure assessment | <input type="checkbox"/> Site assessment | <input checked="" type="checkbox"/> Other - Describe: <u>WDSPS Petroleum inspection</u> |
| Date <input type="text"/>                        | Date <input type="text"/>                | Date <input type="text" value="11/05/2012"/>  |

Lab results: ☐ Lab results will be faxed upon receipt ☒ Lab results are attached

Additional Comments: Include a brief description of immediate actions taken to halt the release and contain or cleanup hazardous substances that have been discharged.

Soil Contamination in submersible pit due to leaking pump. Leak repaired and contaminated soil in pit excavated and disposed at Lincoln Co. Landfill. Confirmation sampling conducted.

## 6. Federal Energy Act Requirements (Section 9002(d) of the Solid Waste Disposal Act (SWDA))

For all confirmed releases from UST's occurring after 9/30/2007 please provide the following information:

- | Source   | Cause   |
|--|---|
| <input type="checkbox"/> Tank                                | <input type="checkbox"/> Spill                                    |
| <input type="checkbox"/> Piping                              | <input type="checkbox"/> Overfill                                 |
| <input type="checkbox"/> Dispenser                           | <input type="checkbox"/> Corrosion                                |
| <input checked="" type="checkbox"/> Submersible Turbine Pump | <input checked="" type="checkbox"/> Physical or Mechanical Damage |
| <input type="checkbox"/> Delivery Problem                    | <input type="checkbox"/> Installation Problem                     |
| <input type="checkbox"/> Other (specify): _____              | <input type="checkbox"/> Other (does not fit any of above)        |
|  | <input type="checkbox"/> Unknown                                  |

☐ Does not apply.

Contact information to report non-emergency releases in DNR's five regions are as follows:

**Northeast Region (FAX: 920-662-5197); Attention -- R&R Program Associate: DNRRRNER@wisconsin.gov**

Brown, Calumet, Door, Fond du Lac (except City of Waupun - see South Central Region), Green Lake, Kewaunee, Manitowoc, Marinette, Marquette, Menominee, Oconto, Outagamie, Shawano, Sheboygan, Waupaca, Waushara, Winnebago counties

**Northern Region (FAX: 715-623-6773); Attention -- R&R Program Associate: DNRRRNOR@wisconsin.gov**

Ashland, Barron, Bayfield, Burnett, Douglas, Forest, Florence, Iron, Langlade, Lincoln, Oneida, Polk, Price, Rusk, Sawyer, Taylor, Vilas, Washburn counties

**South Central Region (FAX: 608-273-5610); Attention -- R&R Program Associate: DNRRRSCR@wisconsin.gov**

Columbia, Dane, Dodge, Fond du Lac (City of Waupun only), Grant, Green, Iowa, Jefferson, Lafayette, Richland, Rock, Sauk, Walworth counties

**Southeast Region (FAX: 414-263-8550); Attention -- R&R Program Associate: DNRRRSER@wisconsin.gov**

Kenosha, Milwaukee, Ozaukee, Racine, Washington, Waukesha counties

**West Central Region (FAX: 715-839-6076); Attention -- R&R Program Associate: DNRRRWCR@wisconsin.gov**

Adams, Buffalo, Chippewa, Clark, Crawford, Dunn, Eau Claire, Jackson, Juneau, LaCrosse, Marathon, Monroe, Pepin, Pierce, Portage, St. Croix, Trempealeau, Vernon, Wood counties



# Notification For Hazardous Substance Discharge (Non-Emergency Only)

Form 4400-225 (05/12) Page 1 of 2

**Emergency Discharges / Spills should be reported via the 24-Hour Hotline: 1-800-943-0003**

**Notice: Hazardous substance discharges must be reported immediately** according to s. 292.11 Wis. Stats. Non-emergency hazardous substance discharges may be reported by telefaxing or e-mailing a completed report to the Department, or calling or visiting a Department office in person. If you choose to notify the Department by telefax or by email, you should use this form to be sure that all necessary information is included. However, use of this form is not mandatory. Under s. 292.99, Wis. Stats., the penalty for violating the reporting requirements of ch. 292 Wis. Stats., shall be no less than \$10 nor more than \$5000 for each violation. Each day of continued violation is a separate offense. It is not the Department's intention to use any personally identifiable information from this form for any purpose other than program administration. However, information submitted on this form may also be made available to requesters under Wisconsin's Open Records Law (ss. 19.31 – 19.39, Wis. Stats.).

Confirmatory laboratory data should be included with this form, to assist the DNR in processing this Hazardous Substance Release Notification.

Complete this form. **TYPE or PRINT LEGIBLY.** NOTIFY appropriate DNR region (see next page) **IMMEDIATELY** upon discovery of a potential release from (check one):

- ☒ Underground Petroleum Storage Tank System (additional information may be required for Item 6 below)
- ☐ Aboveground Petroleum Storage Tank System
- ☐ Dry Cleaner Facility
- ☐ Other - Describe: \_\_\_\_\_

ATTN DNR: **R & R Program Associate**

Date DNR Notified: **12/07/2012**

## 1. Discharge Reported By

Name <b>Andrew Delforge</b>	Firm <b>REI Engineering, Inc.</b>	Phone No. (include area code) <b>(715) 675-9784</b>
Mailing Address <b>4080 North 20th Avenue, Wausau, WI 54401</b>		Email Address <b>adelforge@reiengineering.com</b>

## 2. Site Information

Name of site at which discharge occurred. Include local name of site/business, not responsible party name, unless a residence/vacant property. **Blue Top Shell**

Location: Include street address, not PO Box. If no street address, describe as precisely as possible, i.e., 1/4 mile NW of CTHs 60 & 123 on E side of CTH 60. **3449 Church Street**

Municipality: (City, Village, Township) Specify municipality in which the site is located, not mailing address/city.

**Stevens Point**

County: <b>Portage</b>	Legal Description: <b>1/4 1/4 Sec Tn Range</b>	WTM: <b>X 554864 Y 447336</b>
---------------------------	---	----------------------------------

## 3. Responsible Party (RP) and/or RP Representative

Responsible Party Name: Business or owner name that is responsible for cleanup. If more than one, list all. Attach additional pages as necessary.

**Wagner Oil**

- ☐ Reported in compliance with s. 292.11(2), Wis. Stats., by a local government exempt from liability under s. 292.11(9)(e), Wis. Stats.  
☐ For more information see <http://dnr.wi.gov/org/aw/rr/lgu/liability.htm>.

Contact Person Name (if different) <b>John Wagner</b>	Phone Number <b>(715) 623-5386</b>	Email Address <b>johnw@wagner-oil.com</b>	
Mailing Address <b>P.O. Box 28</b>	City <b>Antigo</b>	State <b>WI</b>	ZIP Code <b>54409</b>

Property owner if Different From RP: Business or owner name that is responsible for cleanup. If more than one, list all. Attach additional pages as necessary. **M & J Hintz Properties, LLC**

Contact Person Name (if different) <b>Crystal Fletcher</b>	Phone Number <b>(715) 341-6855</b>	Email Address	
Mailing Address <b>3449 Church Street</b>	City <b>Stevens Point</b>	State <b>WI</b>	ZIP Code <b>54481</b>

(continued)



**Notification For Hazardous Substance Discharge  
(Non-Emergency Only)**

Form 4400-225 (05/12) Page 2 of 2

**4. Hazardous Substance Information**

Identify hazardous substance discharged (check all that apply):

- |  |   |   |
|--|---|---|
| <input type="checkbox"/> VOC's                   | <input type="checkbox"/> Diesel                 | <input type="checkbox"/> PERC (Dry Cleaners)                |
| <input type="checkbox"/> PAH's                   | <input type="checkbox"/> Fuel Oil               | <input type="checkbox"/> RCRA Hazardous Waste               |
| <input type="checkbox"/> Metals (specify): _____ | <input checked="" type="checkbox"/> Gasoline    | <input type="checkbox"/> Leachate                           |
| <input type="checkbox"/> Arsenic                 | <input type="checkbox"/> Hydraulic Oil          | <input type="checkbox"/> Fertilizer                         |
| <input type="checkbox"/> Chromium                | <input type="checkbox"/> Jet Fuel               | <input type="checkbox"/> Pesticide/Herbicide/Insecticide(s) |
| <input type="checkbox"/> Cyanide                 | <input type="checkbox"/> Mineral Oil            | <input type="checkbox"/> Other (specify): _____             |
| <input type="checkbox"/> Lead                    | <input type="checkbox"/> Waste Oil              | <input type="checkbox"/> Unknown                            |
| <input type="checkbox"/> PCB's                   | <input type="checkbox"/> Petroleum-Unknown Type |   |

**5. Impacts to the Environment Information**

Enter "K" for known/confirmed or "P" for potential for all that apply.

- |   |  |  |
|---|--|--|
| <input type="checkbox"/> Air Contamination                            | <input type="checkbox"/> Sanitary Sewer Contamination  | <input checked="" type="checkbox"/> Soil Contamination |
| <input type="checkbox"/> Co-Contamination (Petroleum & Non-Petroleum) | <input type="checkbox"/> Contamination in Right of Way | <input type="checkbox"/> Storm Sewer Contamination     |
| <input type="checkbox"/> Contamination Within 1 Meter of Bedrock      | <input type="checkbox"/> Fire Explosion Threat         | <input type="checkbox"/> Surface Water Contamination   |
| <input type="checkbox"/> Contaminated Private Well                    | <input type="checkbox"/> Free Product                  | <input type="checkbox"/> Within 100 ft of Private Well |
| <input type="checkbox"/> Contaminated Public Well                     | <input type="checkbox"/> Groundwater Contamination     | <input type="checkbox"/> Within 1000 ft of Public Well |
| <input type="checkbox"/> Contamination in Fractured Bedrock           | <input type="checkbox"/> Off-Site Contamination        |  |
|   | <input type="checkbox"/> Other (specify): _____        |  |

Contamination was discovered as a result of:

- ☐ Tank closure assessment    ☐ Site assessment    ☒ Other - Describe: WDSPS Petroleum inspection

Date     Date     Date

Lab results:    ☐ Lab results will be faxed upon receipt    ☒ Lab results are attached

Additional Comments: Include a brief description of immediate actions taken to halt the release and contain or cleanup hazardous substances that have been discharged.

Soil Contamination in submersible pit due to leaking pump. Leak repaired and contaminated soil in pit excavated and disposed at Lincoln Co. Landfill. Confirmation sampling conducted.

**6. Federal Energy Act Requirements (Section 9002(d) of the Solid Waste Disposal Act (SWDA))**

For all confirmed releases from UST's occurring after 9/30/2007 please provide the following information:

- | Source   | Cause   |
|--|---|
| <input type="checkbox"/> Tank                                | <input type="checkbox"/> Spill                                    |
| <input type="checkbox"/> Piping                              | <input type="checkbox"/> Overfill                                 |
| <input type="checkbox"/> Dispenser                           | <input type="checkbox"/> Corrosion                                |
| <input checked="" type="checkbox"/> Submersible Turbine Pump | <input checked="" type="checkbox"/> Physical or Mechanical Damage |
| <input type="checkbox"/> Delivery Problem                    | <input type="checkbox"/> Installation Problem                     |
| <input type="checkbox"/> Other (specify): _____              | <input type="checkbox"/> Other (does not fit any of above)        |
|  | <input type="checkbox"/> Unknown                                  |

☐ Does not apply.

Contact information to report non-emergency releases in DNR's five regions are as follows:

**Northeast Region (FAX: 920-662-5197); Attention -- R&R Program Associate: DNRNRNER@wisconsin.gov**

Brown, Calumet, Door, Fond du Lac (except City of Waupun - see South Central Region), Green Lake, Kewaunee, Manitowoc, Marinette, Marquette, Menominee, Oconto, Outagamie, Shawano, Sheboygan, Waupaca, Waushara, Winnebago counties

**Northern Region (FAX: 715-623-6773); Attention -- R&R Program Associate: DNRNRNOR@wisconsin.gov**

Ashland, Barron, Bayfield, Burnett, Douglas, Forest, Florence, Iron, Langlade, Lincoln, Oneida, Polk, Price, Rusk, Sawyer, Taylor, Vilas, Washburn counties

**South Central Region (FAX: 608-273-5610); Attention -- R&R Program Associate: DNRNRSCR@wisconsin.gov**

Columbia, Dane, Dodge, Fond du Lac (City of Waupun only), Grant, Green, Iowa, Jefferson, Lafayette, Richland, Rock, Sauk, Walworth counties

**Southeast Region (FAX: 414-263-8550); Attention -- R&R Program Associate: DNRNRSER@wisconsin.gov**

Kenosha, Milwaukee, Ozaukee, Racine, Washington, Waukesha counties

**West Central Region (FAX: 715-839-6076); Attention -- R&R Program Associate: DNRNRWCR@wisconsin.gov**

Adams, Buffalo, Chippewa, Clark, Crawford, Dunn, Eau Claire, Jackson, Juneau, LaCrosse, Marathon, Monroe, Pepin, Pierce, Portage, St. Croix, Trempealeau, Vernon, Wood counties



December 3, 2012

**Wagner Oil**  
Attn: John Wagner  
PO Box 28  
Antigo, WI 54409



**Subject:**

Blue Top Shell  
3449 Church Street  
Stevens Point, WI 54481

**Dear John,**

This letter and enclosed information is in response to the State Order from Mr. Wayne Santroch of the Wisconsin Department of Safety and Professional Services. The Flammable and Combustible Liquid System Inspection Report dated November 5, 2012 documented a leak in the submersible within the premium unleaded submersible pit. Soil was noted to be impacted. The Blue Top Shell (formerly Blue Top EZ Mart) site was previously investigated and was closed with a GIS registry in 2000 (BRRTS #03-50-000260). The site location is shown on Figure 1.

The leak was repaired, and REI Engineering, Inc. (REI) personnel were on site on November 8, 2012 to inspect the area of contamination and collect soil samples within the submersible pit. The site layout is shown on Figure 2. Soil within the pit was hand dug to determine the depth of contamination. One (1) soil sample from the surficial, impacted soil (LF-1) was analyzed for Gasoline Range Organics (GRO), Petroleum Volatile Organic Compounds (PVOCs) and naphthalene. The results of soil sampling indicate that soils within the sump pit were impacted by gasoline. Sample LF-1 contained NR 720 RCL exceedances for ethylbenzene, toluene, xylenes, naphthalene, and GRO. The results are summarized on Table 1. The complete analytical report is included in Attachment A.

Field screening and olfactory observation indicated that the gasoline contamination was limited to the top six (6) inches of silty sand and gravel backfill within the sump pit. Approximately 1/3 cubic yard of contaminated soil was excavated from the submersible pit and containerized in a DOT approved drum. Photographs of the submersible pit before and after excavation are shown in Attachment B. Excavated soil was transported to the Lincoln County Landfill for treatment in the commercial biopile. Approximately 0.30 tons of contaminated soil were excavated. The soil disposal documentation is included in Attachment C.

Following excavation, no soil was present above the premium unleaded gasoline Underground Storage Tank (UST) in the submersible pit. A soil sample was collected on the edge of the sump, above the UST at the approximate location shown on Figure 2 and in the photograph in Attachment B. Soil sample S-1 was non-detect for all GRO, PVOCs and naphthalene. The results of sampling are summarized on Table 1. The complete analytical report is included in Attachment A.



**RESPONSIVE. EFFICIENT. INNOVATIVE.**

4080 N. 20th Avenue Wausau, WI 54401  
715-675-9784 [www.REIengineering.com](http://www.REIengineering.com)

f:\reiproj\6200-6199\6222\reports\ust\6222ustall.docx



Wagner Oil  
Attn: John Wagner  
December 3, 2012

Based on the results of sampling following excavation, all soil contamination exceeding the NR 720 RCL associated with this release has been removed and no further action appears necessary. Thank you for your assistance with this project. Please contact me if you have questions or comments at (715) 675-9784 or [adelforge@reiengineering.com](mailto:adelforge@reiengineering.com).

Sincerely,  
REI Engineering, Inc.



Andrew R. Delforge, P.G.  
Hydrogeologist/Project Manager

CC: Wayne Santroch, Wisconsin Department of Safety and Professional Services, 2715 Post Road,  
Stevens Point, WI 54481  
Mr. Dave Rozeboom, WDNR, 473 Griffith Avenue, Wisconsin Rapids, WI 54494

**Table 1**  
**Soil Analytical Results**  
**Blue Top Shell**  
**3449 Church Street**  
**Stevens Point, WI 54481**

<i>Date--&gt;</i>				<i>11/8/12</i>	<i>11/8/12</i>
<i>Sample--&gt;</i>				<i>LF-1</i>	<i>S-1</i>
<i>Sample Depth--(Feet)&gt;</i>				<i>0.5</i>	<i>1.5</i>
<i>PID (Instrument Units)&gt;</i>				<i>521</i>	<i>0</i>
<b>PVOCs (ug/kg)</b>	<b>RCL</b>	<b>Table 1</b>	<b>Table 2</b>		
Benzene	5.5	8,500	1,100	<200	<25.0
Ethylbenzene	2,900	4,600	NS	<b>7,250</b>	<25.0
Toluene	1,500	38,000	NS	<b>3,070</b>	<25.0
Xylenes (Total)	4,100	42,000	NS	<b>31,100</b>	<75
1,2,4-Trimethylbenzene	NS	83,000	NS	44,400	<25.0
1,3,5-Trimethylbenzene	NS	11,000	NS	13,900	<25.0
Methly tert Butyl Ether	NS	NS	NS	<200	<25.0
Naphthalene	400	2,700	NS	<b>21,300</b>	<25.0
<b>GRO (mg/kg)</b>	100	NS	NS	<b>757</b>	<2.6

Table 1 - NR 746 Table 1 Value - Free Product in Soil Pores

Table 2 - NR 746 Table 2 Value - Direct Contact Risk

< - Concentration below listed laboratory detection limit

RCL exceedences are bold

**Bold**

Table 1 Exceedances are outlined in bold

**Bold**

Table 2 Exceedances are italic

*italic*

PVOCs - Petroleum Volatile Organic Compounds

DRO - Diesel Range Organics

NS - No Standard

NA - Not Analyzed

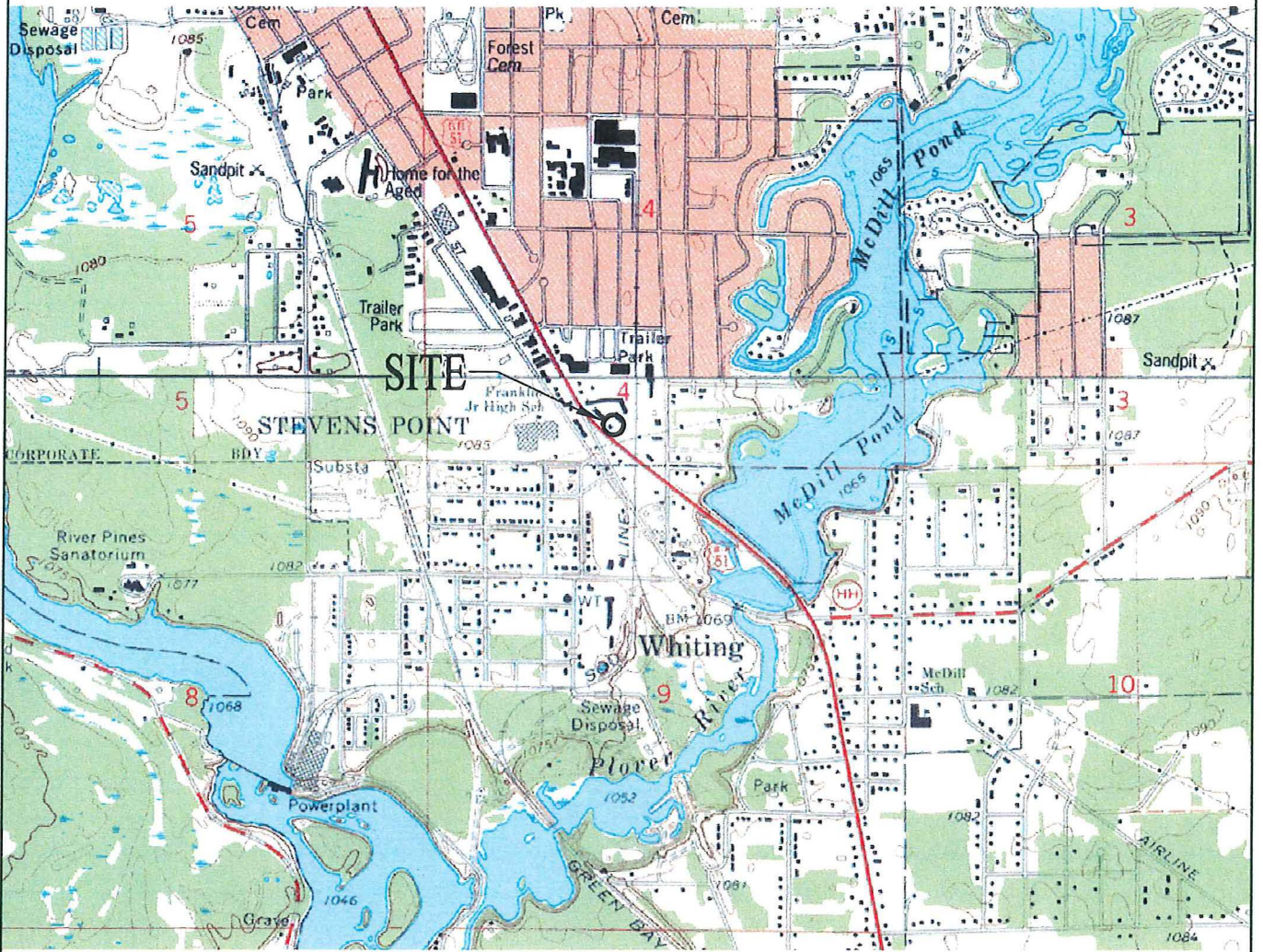

SCALE 1:24000



CONTOUR INTERVAL 5 FEET  
NATIONAL GEODETIC VERTICAL DATUM OF 1929



QUADRANGLE LOCATION



UTM GRID AND 1970 MAGNETIC NORTH  
DECLINATION AT CENTER OF SHEET

**WHITING, WIS.**

NE/4 WHITING 15' QUADRANGLE

44089-D5-TF-024

PHOTOINSPECTED 1976

1970

DMA 3072 I NE-SERIES V861

REI Engineering, INC.

BLUE TOP SHELL  
3449 CHURCH STREET  
STEVENS POINT, WI 54481

FIGURE 1 : SITE VICINITY MAP

PROJECT NO.

6222

DRAWN BY:

GSW

DATE:

11/29/12

DRAWING FILE: J:\DRAFTING\6222-BLUE TOP\DWG\6222-VICN.DWG LAYOUT: VICN PLOTTED: NOV 29, 2012 - 4:04PM PLOTTED BY: GREGW



DRAWING FILE: J:\DRAFTING\6222\_BLUE TOP\DWG\6222-SITE.DWG LAYOUT: SITE PLOTTED: DEC 03, 2012 - 1:21PM PLOTTED BY: GREGW

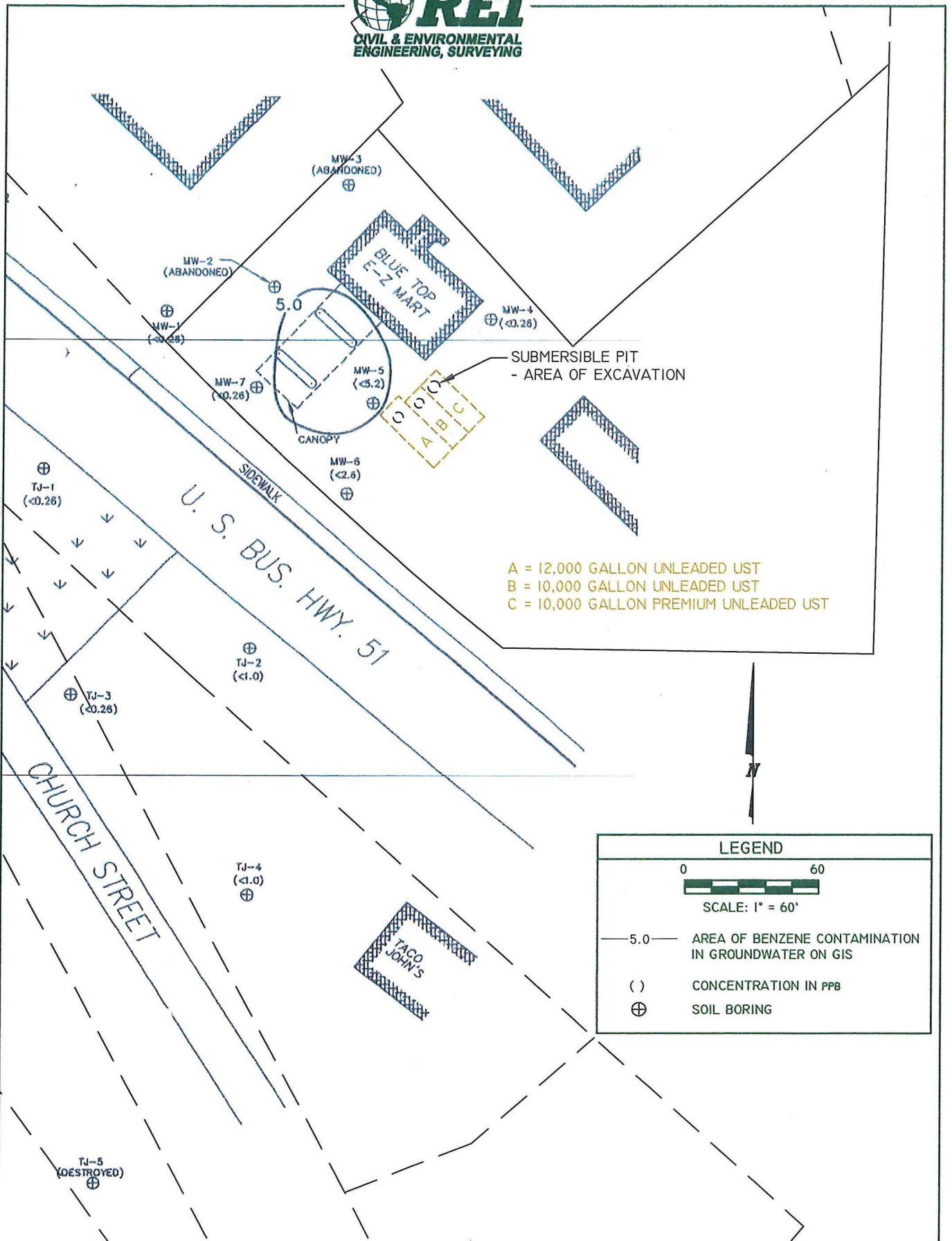

REI Engineering, INC.

BLUE TOP SHELL  
3449 CHURCH STREET  
STEVENS POINT, WI 54481

FIGURE 2 : SITE MAP

PROJECT NO.

6222

DRAWN BY:

GSW

DATE:

11/29/12



## **ATTACHMENT A**

### **SOIL ANALYTICAL REPORT**

November 28, 2012

Andy Delforge  
REI  
4080 North 20th Avenue  
Wausau, WI 54401

RE: Project: 6222 WAGNER SHELL  
Pace Project No.: 4070400

Dear Andy Delforge:

Enclosed are the analytical results for sample(s) received by the laboratory on November 10, 2012. The results relate only to the samples included in this report. Results reported herein conform to the most current TNI standards and the laboratory's Quality Assurance Manual, where applicable, unless otherwise noted in the body of the report.

If you have any questions concerning this report, please feel free to contact me.

Sincerely,



Brian Basten

brian.basten@pacelabs.com  
Project Manager

Enclosures



## REPORT OF LABORATORY ANALYSIS

This report shall not be reproduced, except in full,  
without the written consent of Pace Analytical Services, Inc..

## CERTIFICATIONS

Project: 6222 WAGNER SHELL  
Pace Project No.: 4070400

---

### Green Bay Certification IDs

1241 Bellevue Street, Green Bay, WI 54302  
Florida/NELAP Certification #: E87948  
Illinois Certification #: 200050  
Kentucky Certification #: 82  
Louisiana Certification #: 04168  
Minnesota Certification #: 055-999-334

New York Certification #: 11888  
North Carolina Certification #: 503  
North Dakota Certification #: R-150  
South Carolina Certification #: 83006001  
US Dept of Agriculture #: S-76505  
Wisconsin Certification #: 405132750

---

## REPORT OF LABORATORY ANALYSIS

Page 2 of 10

This report shall not be reproduced, except in full,  
without the written consent of Pace Analytical Services, Inc..



Pace Analytical Services, Inc.  
1241 Bellevue Street - Suite 9  
Green Bay, WI 54302  
(920)469-2436

## SAMPLE SUMMARY

Project: 6222 WAGNER SHELL  
Pace Project No.: 4070400

Lab ID	Sample ID	Matrix	Date Collected	Date Received
4070400001	LF	Solid	11/08/12 11:00	11/10/12 07:55
4070400002	CSS	Solid	11/08/12 12:00	11/10/12 07:55

## REPORT OF LABORATORY ANALYSIS

Page 3 of 10

This report shall not be reproduced, except in full,  
without the written consent of Pace Analytical Services, Inc..





Pace Analytical Services, Inc.  
1241 Bellevue Street - Suite 9  
Green Bay, WI 54302  
(920)469-2436

## SAMPLE ANALYTE COUNT

Project: 6222 WAGNER SHELL

Pace Project No.: 4070400

Lab ID	Sample ID	Method	Analysts	Analytes Reported	Laboratory
4070400001	LF	WI MOD GRO	PMS	11	PASI-G
		ASTM D2974-87	MAV	1	PASI-G
4070400002	CSS	WI MOD GRO	PMS	11	PASI-G
		ASTM D2974-87	MAV	1	PASI-G

## REPORT OF LABORATORY ANALYSIS

Page 4 of 10

This report shall not be reproduced, except in full,  
without the written consent of Pace Analytical Services, Inc..

## ANALYTICAL RESULTS

Project: 6222 WAGNER SHELL

Pace Project No.: 4070400

Sample: LF Lab ID: 4070400001 Collected: 11/08/12 11:00 Received: 11/10/12 07:55 Matrix: Solid

Results reported on a "dry-weight" basis

Parameters	Results	Units	LOQ	LOD	DF	Prepared	Analyzed	CAS No.	Qual
<b>WIGRO GCV</b> Analytical Method: WI MOD GRO Preparation Method: TPH GRO/PVOC WI ext.									
Benzene	<200	ug/kg	480	200	8	11/14/12 07:02	11/14/12 16:44	71-43-2	W
Ethylbenzene	7250	ug/kg	525	219	8	11/14/12 07:02	11/14/12 16:44	100-41-4	
Gasoline Range Organics	757	mg/kg	21.9	21.9	8	11/14/12 07:02	11/14/12 16:44		
Methyl-tert-butyl ether	<200	ug/kg	480	200	8	11/14/12 07:02	11/14/12 16:44	1634-04-4	W
Naphthalene	21300	ug/kg	525	219	8	11/14/12 07:02	11/14/12 16:44	91-20-3	
Toluene	3070	ug/kg	525	219	8	11/14/12 07:02	11/14/12 16:44	108-88-3	
1,2,4-Trimethylbenzene	44400	ug/kg	525	219	8	11/14/12 07:02	11/14/12 16:44	95-63-6	
1,3,5-Trimethylbenzene	13900	ug/kg	525	219	8	11/14/12 07:02	11/14/12 16:44	108-67-8	
m&p-Xylene	19500	ug/kg	1050	438	8	11/14/12 07:02	11/14/12 16:44	179601-23-1	
o-Xylene	11600	ug/kg	525	219	8	11/14/12 07:02	11/14/12 16:44	95-47-6	
<b>Surrogates</b>									
a,a,a-Trifluorotoluene (S)	129 %		80-120		8	11/14/12 07:02	11/14/12 16:44	98-08-8	S7
<b>Percent Moisture</b> Analytical Method: ASTM D2974-87									
Percent Moisture	8.6 %		0.10	0.10	1		11/27/12 16:36		



Pace Analytical Services, Inc.  
1241 Bellevue Street - Suite 9  
Green Bay, WI 54302  
(920)469-2436

## ANALYTICAL RESULTS

Project: 6222 WAGNER SHELL

Pace Project No.: 4070400

Sample: CSS Lab ID: 4070400002 Collected: 11/08/12 12:00 Received: 11/10/12 07:55 Matrix: Solid

Results reported on a "dry-weight" basis

Parameters	Results	Units	LOQ	LOD	DF	Prepared	Analyzed	CAS No.	Qual
<b>WIGRO GCV</b> Analytical Method: WI MOD GRO Preparation Method: TPH GRO/PVOC WI ext.									
Benzene	<25.0	ug/kg	60.0	25.0	1	11/14/12 07:02	11/14/12 20:09	71-43-2	W
Ethylbenzene	<25.0	ug/kg	60.0	25.0	1	11/14/12 07:02	11/14/12 20:09	100-41-4	W
Gasoline Range Organics	<2.6	mg/kg	2.6	2.6	1	11/14/12 07:02	11/14/12 20:09		
Methyl-tert-butyl ether	<25.0	ug/kg	60.0	25.0	1	11/14/12 07:02	11/14/12 20:09	1634-04-4	W
Naphthalene	<25.0	ug/kg	60.0	25.0	1	11/14/12 07:02	11/14/12 20:09	91-20-3	W
Toluene	<25.0	ug/kg	60.0	25.0	1	11/14/12 07:02	11/14/12 20:09	108-88-3	W
1,2,4-Trimethylbenzene	<25.0	ug/kg	60.0	25.0	1	11/14/12 07:02	11/14/12 20:09	95-63-6	W
1,3,5-Trimethylbenzene	<25.0	ug/kg	60.0	25.0	1	11/14/12 07:02	11/14/12 20:09	108-67-8	W
m&p-Xylene	<50.0	ug/kg	120	50.0	1	11/14/12 07:02	11/14/12 20:09	179601-23-1	W
o-Xylene	<25.0	ug/kg	60.0	25.0	1	11/14/12 07:02	11/14/12 20:09	95-47-6	W
<b>Surrogates</b>									
a,a,a-Trifluorotoluene (S)	99 %		80-120		1	11/14/12 07:02	11/14/12 20:09	98-08-8	
<b>Percent Moisture</b> Analytical Method: ASTM D2974-87									
Percent Moisture	3.4	%	0.10	0.10	1		11/27/12 16:36		

## QUALITY CONTROL DATA

Project: 6222 WAGNER SHELL

Pace Project No.: 4070400

QC Batch: GCV/9320

Analysis Method: WI MOD GRO

QC Batch Method: TPH GRO/PVOC WI ext.

Analysis Description: WIGRO Solid GCV

Associated Lab Samples: 4070400001, 4070400002

METHOD BLANK: 711936

Matrix: Solid

Associated Lab Samples: 4070400001, 4070400002

Parameter	Units	Blank Result	Reporting Limit	Analyzed	Qualifiers
1,2,4-Trimethylbenzene	ug/kg	<25.0	60.0	11/14/12 09:52	
1,3,5-Trimethylbenzene	ug/kg	<25.0	60.0	11/14/12 09:52	
Benzene	ug/kg	<25.0	60.0	11/14/12 09:52	
Ethylbenzene	ug/kg	<25.0	60.0	11/14/12 09:52	
Gasoline Range Organics	mg/kg	<2.5	2.5	11/14/12 09:52	
m&p-Xylene	ug/kg	<50.0	120	11/14/12 09:52	
Methyl-tert-butyl ether	ug/kg	<25.0	60.0	11/14/12 09:52	
Naphthalene	ug/kg	<25.0	60.0	11/14/12 09:52	
o-Xylene	ug/kg	<25.0	60.0	11/14/12 09:52	
Toluene	ug/kg	<25.0	60.0	11/14/12 09:52	
a,a,a-Trifluorotoluene (S)	%	97	80-120	11/14/12 09:52	

LABORATORY CONTROL SAMPLE & LCSD: 711937

711938

Parameter	Units	Spike Conc.	LCS Result	LCSD Result	LCS % Rec	LCSD % Rec	% Rec Limits	RPD	Max RPD	Qualifiers
1,2,4-Trimethylbenzene	ug/kg	1000	1000	994	100	99	80-120	1	20	
1,3,5-Trimethylbenzene	ug/kg	1000	1000	991	100	99	80-120	1	20	
Benzene	ug/kg	1000	1030	1010	103	101	80-120	1	20	
Ethylbenzene	ug/kg	1000	982	973	98	97	80-120	1	20	
Gasoline Range Organics	mg/kg	10	10.7	9.9	107	99	80-120	8	20	
m&p-Xylene	ug/kg	2000	1970	1940	99	97	80-120	1	20	
Methyl-tert-butyl ether	ug/kg	1000	991	984	99	98	80-120	1	20	
Naphthalene	ug/kg	1000	984	1000	98	100	80-120	2	20	
o-Xylene	ug/kg	1000	988	977	99	98	80-120	1	20	
Toluene	ug/kg	1000	986	975	99	98	80-120	1	20	
a,a,a-Trifluorotoluene (S)	%				100	100	80-120			





Pace Analytical Services, Inc.  
1241 Bellevue Street - Suite 9  
Green Bay, WI 54302  
(920)469-2436

## QUALITY CONTROL DATA

Project: 6222 WAGNER SHELL

Pace Project No.: 4070400

QC Batch: PMST/7957

Analysis Method: ASTM D2974-87

QC Batch Method: ASTM D2974-87

Analysis Description: Dry Weight/Percent Moisture

Associated Lab Samples: 4070400001, 4070400002

SAMPLE DUPLICATE: 718221

Parameter	Units	4070802001 Result	Dup Result	RPD	Max RPD	Qualifiers
Percent Moisture	%	15.2	15.6	3	10	

## QUALIFIERS

Project: 6222 WAGNER SHELL  
Pace Project No.: 4070400

---

### DEFINITIONS

DF - Dilution Factor, if reported, represents the factor applied to the reported data due to changes in sample preparation, dilution of the sample aliquot, or moisture content.

ND - Not Detected at or above adjusted reporting limit.

J - Estimated concentration above the adjusted method detection limit and below the adjusted reporting limit.

MDL - Adjusted Method Detection Limit.

PRL - Pace Reporting Limit.

RL - Reporting Limit.

S - Surrogate

1,2-Diphenylhydrazine (8270 listed analyte) decomposes to Azobenzene.

Consistent with EPA guidelines, unrounded data are displayed and have been used to calculate % recovery and RPD values.

LCS(D) - Laboratory Control Sample (Duplicate)

MS(D) - Matrix Spike (Duplicate)

DUP - Sample Duplicate

RPD - Relative Percent Difference

NC - Not Calculable.

SG - Silica Gel - Clean-Up

U - Indicates the compound was analyzed for, but not detected.

N-Nitrosodiphenylamine decomposes and cannot be separated from Diphenylamine using Method 8270. The result reported for each analyte is a combined concentration.

Pace Analytical is TNI accredited. Contact your Pace PM for the current list of accredited analytes.

TNI - The NELAC Institute.

### LABORATORIES

PASI-G Pace Analytical Services - Green Bay

### ANALYTE QUALIFIERS

S7 Surrogate recovery outside control limits (not confirmed by re-analysis).

W Non-detect results are reported on a wet weight basis.

### QUALITY CONTROL DATA CROSS REFERENCE TABLE

Project: 6222 WAGNER SHELL

Pace Project No.: 4070400

Lab ID	Sample ID	QC Batch Method	QC Batch	Analytical Method	Analytical Batch
4070400001	LF	TPH GRO/PVOC WI ext.	GCV/9320	WI MOD GRO	GCV/9322
4070400002	CSS	TPH GRO/PVOC WI ext.	GCV/9320	WI MOD GRO	GCV/9322
4070400001	LF	ASTM D2974-87	PMST/7957		
4070400002	CSS	ASTM D2974-87	PMST/7957		

(Please Print Clearly)

UPPER MIDWEST REGION

Page 1 of

MN: 612-607-1700 WI: 920-469-2436

Company Name: RRT Engineering  
 Branch/Location: Wausau  
 Project Contact: Andy DeFarge  
 Phone: 715-675-9784  
 Project Number: 6222  
 Project Name: Wagner Steel  
 Project State: WI  
 Sampled By (Print): Adam Schenckman  
 Sampled By (Sign): [Signature]  
 PO #:   
 Regulatory Program:



## CHAIN OF CUSTODY

\*Preservation Codes  
 A=None B=HCL C=H2SO4 D=HNO3 E=DI Water F=Methanol G=NaOH  
 H=Sodium Bisulfate Solution I=Sodium Thiosulfate J=Other

FILTERED?  
(YES/NO)PRESERVATION  
(CODE)\*

T/A

Pick  
Letter

Analyses Requested

N N N

F F A

GRO PVOCLN Total Solids

## Data Package Options

(billable)

- ☐ EPA Level III  
☐ EPA Level IV

## MS/MSD

- ☐ On your sample  
 (billable)  
☐ NOT needed on  
 your sample

## Matrix Codes

A = Air W = Water  
 B = Biota DW = Drinking Water  
 C = Charcoal GW = Ground Water  
 O = Oil SW = Surface Water  
 S = Soil WW = Waste Water  
 SI = Sludge WP = Wipe

PACE LAB #

CLIENT FIELD ID

COLLECTION

DATE

TIME

MATRIX

001

LF

11/8/12

11:00

S

002

LSS

11/8/12

12:00

S

Rush Turnaround Time Requested - Prelims  
 (Rush TAT subject to approval/surcharge)  
 Date Needed:

Transmit Prelim Rush Results by (complete what you want):

Email #1:

Email #2:

Telephone:

Fax:

Samples on HOLD are subject to  
 special pricing and release of liability

Relinquished By:

Date/Time:

Relinquished By:

Date/Time:

Relinquished By:

Date/Time:

Relinquished By:

Date/Time:

Relinquished By:

Date/Time:

Received By:

Date/Time:

Received By:

Date/Time:

Received By:

Date/Time:

Received By:

Date/Time:

Received By:

Date/Time:

Quote #:

Mail To Contact:

Mail To Company:

Mail To Address:

Invoice To Contact:

Invoice To Company:

Invoice To Address:

Invoice To Phone:

CLIENT  
COMMENTSLAB COMMENTS  
(Lab Use Only)

Profile #

PACE Project No.

Receipt Temp = 20 °C

Sample Receipt pH  
OK / AdjustedCooler Custody Seal  
Present / Not Present  
Intact / Not Intact





# Sample Condition Upon Receipt

Client Name: REI

Project # 4070405

Courier: ☐ Fed Ex ☐ UPS ☐ USPS ☐ Client ☒ Commercial ☐ Pace

Other Waltra

Tracking #: 262266

Custody Seal on Cooler/Box Present: ☐ yes ☒ no Seals intact: ☐ yes ☒ no

Custody Seal on Samples Present: ☐ yes ☒ no Seals intact: ☐ yes ☒ no

Packing Material: ☐ Bubble Wrap ☒ Bubble Bags ☐ None Other

Thermometer Used NA Type of Ice: ☒ Wet ☐ Blue ☐ Dry ☐ None

☒ Samples on Ice, cooling process has begun.

Cooler Temperature 20 Biological Tissue is Frozen: ☐ yes ☒ no

Temp Blank Present: ☐ yes ☒ no

Temp should be above freezing to 6°C for all sample except Biota.

Biota Samples should be received ≤ 0°C.

Comments:

Person examining contents:

Date: 11-10-12

Initials: BF

Chain of Custody Present:	<input type="checkbox"/> Yes <input checked="" type="checkbox"/> No <input type="checkbox"/> N/A	1.
Chain of Custody Filled Out:	<input checked="" type="checkbox"/> Yes <input type="checkbox"/> No <input type="checkbox"/> N/A	2.
Chain of Custody Relinquished:	<input checked="" type="checkbox"/> Yes <input type="checkbox"/> No <input type="checkbox"/> N/A	3.
Sampler Name & Signature on COC:	<input checked="" type="checkbox"/> Yes <input type="checkbox"/> No <input type="checkbox"/> N/A	4.
Samples Arrived within Hold Time:	<input checked="" type="checkbox"/> Yes <input type="checkbox"/> No <input type="checkbox"/> N/A	5.
Short Hold Time Analysis (<72hr):	<input checked="" type="checkbox"/> Yes <input type="checkbox"/> No <input type="checkbox"/> N/A	6.
Rush Turn Around Time Requested:	<input type="checkbox"/> Yes <input checked="" type="checkbox"/> No <input type="checkbox"/> N/A	7.
Sufficient Volume:	<input checked="" type="checkbox"/> Yes <input type="checkbox"/> No <input type="checkbox"/> N/A	8.
Correct Containers Used:	<input checked="" type="checkbox"/> Yes <input type="checkbox"/> No <input type="checkbox"/> N/A	9.
-Pace Containers Used:	<input checked="" type="checkbox"/> Yes <input type="checkbox"/> No <input type="checkbox"/> N/A	
Containers Intact:	<input checked="" type="checkbox"/> Yes <input type="checkbox"/> No <input type="checkbox"/> N/A	10.
Filtered volume received for Dissolved tests	<input type="checkbox"/> Yes <input type="checkbox"/> No <input checked="" type="checkbox"/> N/A	11.
Sample Labels match COC:	<input checked="" type="checkbox"/> Yes <input type="checkbox"/> No <input type="checkbox"/> N/A	12.
-Includes date/time/ID/Analysis Matrix:		
All containers needing preservation have been checked.	<input type="checkbox"/> Yes <input type="checkbox"/> No <input checked="" type="checkbox"/> N/A	13.
All containers needing preservation are found to be in compliance with EPA recommendation.	<input type="checkbox"/> Yes <input type="checkbox"/> No <input checked="" type="checkbox"/> N/A	
exceptions: VOA, coliform, TOC, O&G, WI-DRO (water)	<input type="checkbox"/> Yes <input type="checkbox"/> No	Initial when completed
		Lot # of added preservative
Samples checked for dechlorination:	<input type="checkbox"/> Yes <input type="checkbox"/> No <input checked="" type="checkbox"/> N/A	14.
Headspace in VOA Vials (>6mm):	<input type="checkbox"/> Yes <input type="checkbox"/> No <input checked="" type="checkbox"/> N/A	15.
Trip Blank Present:	<input type="checkbox"/> Yes <input checked="" type="checkbox"/> No <input type="checkbox"/> N/A	16.
Trip Blank Custody Seals Present	<input type="checkbox"/> Yes <input type="checkbox"/> No <input checked="" type="checkbox"/> N/A	
Pace Trip Blank Lot # (if purchased):		

Client Notification/ Resolution:

Field Data Required?

Y / N

Person Contacted:

Date/Time:

Comments/ Resolution:

Project Manager Review:

Date:

11-10-12

Note: Whenever there is a discrepancy affecting North Carolina compliance samples, a copy of this form will be sent to the North Carolina DEHNR Certification Office (i.e. out of hold, incorrect preservative, out of temp, incorrect containers)

## **ATTACHMENT B**

### **PHOTOGRAPHS**



Submersible pit and impacted soil



Submersible pit location



Excavating soil and sediment from submersible pit



Soil excavated to top of tank

## **ATTACHMENT C**

### **SOIL DISPOSAL DOCUMENTATION**



**LINCOLN COUNTY LANDFILL 715-536-9636**

N4750 Landfill Lane, Merrill, WI 54452

**OPERATING HOURS:**

Monday-Friday

SUMMER (May 1 - Sept. 30) 7:00 am - 4:00 pm

WINTER (Oct. 1 - Apr. 30) 8:00 am - 4:00 pm

1st and 3rd Sat. 8:00 am - Noon

DATE: 11/27/2012

Time In: 01:15 PM

TICKET #: 155865

Time Out: 01:30 PM

Vehicle #:

BILL TO: R.E.I.

HAULER : R.E.I.

JOB : 12-63 B - 6222 Blue Top Shell - St Point

\$23.00 ton exempt (CON31) 0.30 tn

Gross: 7680

Tare: 7080

Net Weight: 600

Scale Notes:

Charge Transaction

HAVE A NICE DAY!

Customer Signature \_\_\_\_\_

Weighed By: Administrator

I certify that the waste in this vehicle complies with the Wisconsin Recycling law and the landfill bans. I also agree to pay 1.5% per month Late payment charge after 30 days.