



Excellence through experience™

709 Gillette St., Ste #3 ♦ La Crosse, WI 54603 ♦ 1-800-552-2932 ♦ Fax (608) 781-8893 Email: rona@metcohq.com ♦ www.metcohq.com

December 15, 2016

Alex Edler
Wisconsin Department of Natural Resources
2984 Shawano Ave
Green Bay, WI 54313

Subject: Keller Property – Bid Deferment/Variance Request for Capping Project and additional groundwater monitoring.
BRRTS #: 02-38-560993, PECFA #: 54143-9999-02

Dear Mr. Edler,

A Bid Deferment request is being submitted for additional soil sampling and groundwater monitoring at the subject property located at 102 Water Street in Marinette, Wisconsin. The cost estimate will include: [1] Geoprobe project with four borings to 4 feet below ground surface (bgs) and convert one to a temporary monitoring well west of monitoring well MW-3 in the marsh area, collect a soil sample in the top four feet for Lead, PVOC, and Naphthalene analysis from each boring, [2] Conduct a round of groundwater monitoring from all six site monitoring wells and the new temp well all for PVOC and PAH analysis, and [3] Report. The cost estimate is as follows:

Access Permission	\$ 401.94
Geoprobe Project	\$1,095.89
Groundwater Monitoring	\$1,135.26
Laboratory Analysis	\$ 956.44
Letter Report	\$1,039.29
Change Order Request	<u>\$ 381.78</u>
Total	\$5,010.60

METCO is requesting a bid deferment in the amount of **\$5,010.60** to complete the above workscope. Upon state and client approval of the proposed workscope and budget, METCO will proceed with the project.

Attached is a site map showing the proposed boring/temp well locations and standardized U&C invoice for the above workscope as required.

Should you have any questions, comments, or recommendations please contact me at our La Crosse office (608) 781-8879 or email at jasonp@metcohq.com.

Sincerely,

A handwritten signature in black ink that reads "Jason T. Powell". The signature is fluid and cursive, with a long horizontal stroke at the beginning.

Jason T. Powell
Staff Scientist

Attachments

c: Ken Keller – Client

CITY OF MARINETTE PROPERTY

SLOPE DOWN TO MARSH

FORMER RAILROAD TRACKS - CANADIAN NATIONAL PROPERTY

SITE LAYOUT MAP

KELLER PROPERTY



MARINETTE, WISCONSIN
DRAWN BY: ED
DATE: 01/22/2005



NOTE: INFORMATION BASED ON AVAILABLE DATA ACTUAL CONDITIONS MAY DIFFER

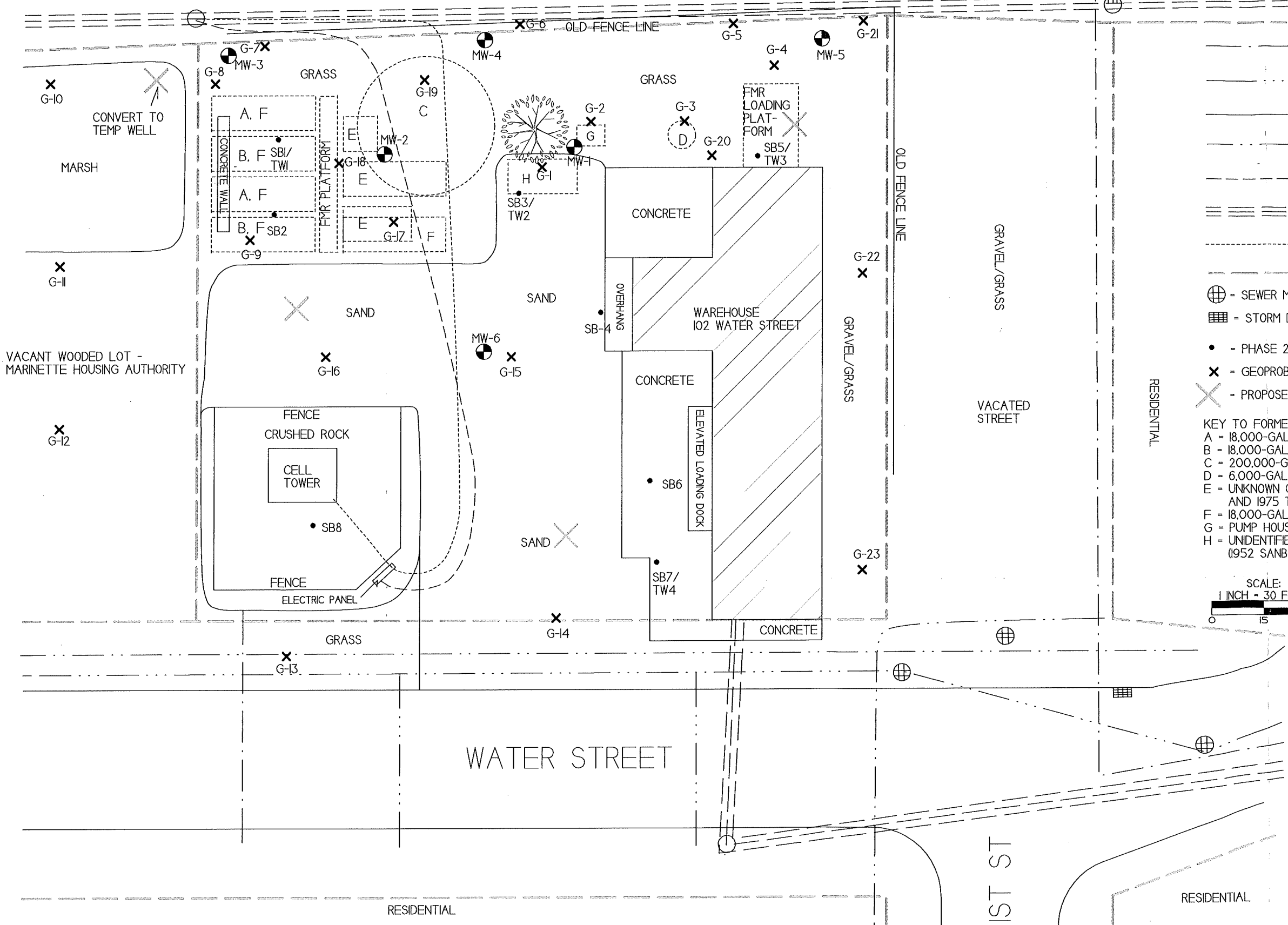

- WATER LINE
- SANITARY SEWER LINE
- STORM SEWER LINE
- NATURAL GAS LINE
- BURIED ELECTRIC LINE
- OVERHEAD UTILITIES
- TELEPHONE/CABLE LINE
- PROPERTY LINE

- ⊕ - SEWER MANHOLE
- ▣ - STORM DRAIN
- - PHASE 2 ESA SOIL BORING LOCATION
- ✕ - GEOPROBE BORING LOCATION
- ✕ - PROPOSED GEOPROBE BORING LOCATION

- KEY TO FORMER ASTS
- A - 18,000-GAL GASOLINE (1921 SANBORN MAP)
 - B - 18,000-GAL KEROSENE (1921 SANBORN MAP)
 - C - 200,000-GAL GASOLINE (1921 AND 1952 SANBORN MAP)
 - D - 6,000-GAL LUBRICATING OIL (1921 AND 1935 SANBORN MAP)
 - E - UNKNOWN CONTENTS (1969 AERIAL PHOTO AND 1975 TAX ASSESSORS RECORDS)
 - F - 18,000-GAL GASOLINE TANK (1952 SANBORN MAP)
 - G - PUMP HOUSE (1952 SANBORN MAP)
 - H - UNIDENTIFIED STRUCTURE/ POSSIBLE LOADING RACK (1952 SANBORN MAP)

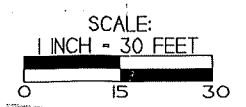

Usual and Customary Standardized Invoice #20
July 2016 - December 2016



RR-061A

PECFA #: 54143-9999-02
 BRRT's #: 02-38-560993
 Site Name: Keller Property
 Site Address: 102 Water St., Marinette, WI

Vendor Name: _____
 Invoice #: _____
 Invoice Date: _____
 Check #: _____

U&C Total \$5,010.60
 Variance to U&C Total \$-
 Grand Total \$5,010.60

TASK	TASK DESCRIPTION	SERVICES	ACTIVITY CODE	ACTIVITY REFERENCE CODE DESCRIPTION	UNIT	MAX UNIT COST	UNITS	TOTAL MAX
1	GW Sampling		GS05	Sample Collection	Well	\$72.45	7	\$507.15
1	GW Sampling		GS25	Primary Mob/Demob	Site	\$628.11	1	\$628.11
6	Letter Report/Addendum		LRA05	Letter Report/Addendum	Letter	\$1,039.29	1	\$1,039.29
12	Direct Push	Consultant	DP05	0 - 24 ft bgs W/ Continuous Soil Sampling	Ft	\$5.36	16	\$85.76
12	Direct Push	Consultant	DP25	Temporary Well Installation	Each	\$49.90	1	\$49.90
12	Direct Push	Commodity	DP35	0 - 24 ft bgs W/ Continuous Soil Sampling	Ft	\$6.93	16	\$110.88
12	Direct Push	Commodity	DP60	Borehole Abandonment	Ft	\$1.26	12	\$15.12
12	Direct Push	Commodity	DP75	Temporary Well Installation	Ft	\$5.25	4	\$21.00
12	Direct Push	Commodity	DP80	Mob/Demob (Includes decon)	Site	\$526.05	1	\$526.05
21	Access Agreements		AA05	Access Agreements	Property	\$401.94	1	\$401.94
33	Schedule Of Laboratory Maximums	Commodity		Laboratory (see task 33 total on Lab Schedule)	Lab Schedule		24	\$956.44
34	Consultant Incremental Mob/Demob		IMD05	Incremental Mob/Demob	Site	\$287.18	1	\$287.18
36	Change Order Request		COR05	Change Order Request (cost cap exceedance requests)	Change Order	\$381.78	1	\$381.78

Variance
 Variance

Usual and Customary Standardized Invoice #20
July 2016 - December 2016



RR-061A

TOTAL LAB CHARGES \$956.44 TASK 33 24 \$956.44 TASK 24 0 \$-

MATRIX REF CODE	REIMBURSABLE ANALYTE	UNITS	MAX COST	SAMPLES	TOTAL	MAX COST	SAMPLES	TOTAL
AIR A1	Benzene	SAMPLE	\$44.94		\$-			
AIR A2	BETX	SAMPLE	\$49.46		\$-			
AIR A3	GRO	SAMPLE	\$46.10		\$-			
AIR A4	VOC's	SAMPLE	\$71.93		\$-			
WATER W1	GRO/PVOC	SAMPLE	\$29.19		\$-			
WATER W2	PVOC	SAMPLE	\$26.99	8	\$215.92			
WATER W3	PVOC + 1,2 DCA	SAMPLE	\$43.79		\$-			
WATER W4	PVOC + Naphthalene	SAMPLE	\$30.35		\$-			
WATER W5	VOC	SAMPLE	\$71.93		\$-			
WATER W6	PAH	SAMPLE	\$72.98	7	\$510.86			
WATER W7	Lead	SAMPLE	\$12.39		\$-			
WATER W8	Cadmium	SAMPLE	\$13.55		\$-			
WATER W9	Hardness	SAMPLE	\$12.39		\$-			
WATER W10	BOD, Total	SAMPLE	\$23.63		\$-			
WATER W11	Nitrate	SAMPLE	\$11.24		\$-			
WATER W12	Total Kjeldahl	SAMPLE	\$20.27		\$-			
WATER W13	Ammonia	SAMPLE	\$16.91		\$-			
WATER W14	Sulfate	SAMPLE	\$10.19		\$-			
WATER W15	Iron	SAMPLE	\$10.19		\$-			
WATER W16	Manganese	SAMPLE	\$10.19		\$-			
WATER W17	Alkalinity	SAMPLE	\$10.19		\$-			
WATER W18	methane	SAMPLE	\$46.10		\$-			
WATER W19	Phosphorous	SAMPLE	\$18.06		\$-			
WATER W20	VOC Method 524.2	SAMPLE	\$176.30		\$-			
WATER W21	EDB Method 504	SAMPLE	\$95.45		\$-			
SOILS S1	GRO	SAMPLE	\$24.78		\$-	\$24.78		\$-
SOILS S2	DRO	SAMPLE	\$30.35		\$-	\$30.35		\$-
SOILS S3	GRO/PVOC	SAMPLE	\$28.14		\$-	\$28.14		\$-
SOILS S4	PVOC	SAMPLE	\$25.83		\$-	\$25.83		\$-
SOILS S5	PVOC + 1,2 DCA + Naphthalene	SAMPLE	\$49.46		\$-	\$49.46		\$-
SOILS S6	PVOC + Naphthalene	SAMPLE	\$36.02	5	\$180.10	\$36.02		\$-
SOILS S7	VOC	SAMPLE	\$71.93		\$-	\$71.93		\$-
SOILS S8	SPLP Extraction VOC only	SAMPLE	\$50.61		\$-	\$50.61		\$-
SOILS S9	PAH	SAMPLE	\$72.98		\$-	\$72.98		\$-
SOILS S10	Lead	SAMPLE	\$12.39	4	\$49.56	\$12.39		\$-
SOILS S11	Cadmium	SAMPLE	\$14.60		\$-			
SOILS S12	Free Liquid	SAMPLE	\$11.24		\$-			
SOILS S13	Flash Point	SAMPLE	\$25.83		\$-			
SOILS S14	Grain Size - dry	SAMPLE	\$42.74		\$-			
SOILS S15	Grain Size - wet	SAMPLE	\$57.33		\$-			
SOILS S16	Bulk Density	SAMPLE	\$13.55		\$-			
SOILS S17	Permeability	SAMPLE	\$41.58		\$-			
SOILS S18	Nitrogen as Total Kjeldahl	SAMPLE	\$20.27		\$-			
SOILS S19	Nitrogen as Ammonia	SAMPLE	\$16.91		\$-			
SOILS S20	% Organic Matter	SAMPLE	\$29.19		\$-			
SOILS S21	TOC as NPOC	SAMPLE	\$57.33		\$-			
SOILS S22	Soil Moisture Content	SAMPLE	\$6.83		\$-			
SOILS S23	Air Filled Porosity	SAMPLE	\$25.83		\$-			
SOILS S24	% Total Solids	SAMPLE	\$6.83		\$-			
SOILS S25	Field Capacity	SAMPLE	\$28.14		\$-			
SOILS S26	TCLP Lead	SAMPLE	\$83.16		\$-			
SOILS S27	Cation Exchange (Ca, MG, & K)	SAMPLE	\$26.99		\$-			
SOILS S28	TCLP Cadmium	SAMPLE	\$83.16		\$-			
SOILS S29	TCLP Benzene	SAMPLE	\$83.16		\$-			
LNAPL LFPS01	Viscosity + Density Interfacial tension I (LNAPL/water [dyne/cm]) Interfacial tension II (LNAPL/air [dyne/cm]) Interfacial tension III (water/air) [dyne/cm]	SAMPLE	\$561.33		\$-			

TASK 24 TOTAL \$-

TASK 33 TOTAL \$956.44