



*Excellence through experience™*

709 Gillette St., Ste #3 ♦ La Crosse, WI 54603 ♦ 1-800-552-2932 ♦ Fax (608) 781-8893 Email: rona@metcohq.com ♦ www.metcohq.com

February 23, 2018

Carrie Stoltz  
Wisconsin Department of Natural Resources  
107 Sutliff Avenue  
Rhineland, WI 54501

**Subject:** Pizza Place Restaurant – Bid Deferment Request for drilling project and additional groundwater monitoring. (Revised)  
BRRTS #: 03-03-562914, PECFA #: 54889-9999-25

Dear Ms. Stoltz,

A bid deferment (using Usual & Customary schedule of charges) is being submitted for a drilling project and additional groundwater monitoring at the subject property located at 225 US Highway 8 & 63 in Turtle Lake, Wisconsin. The cost estimate includes: [1] Drilling Project which will include the installation of two piezometers to approximately 80 feet below ground surface (bgs) with 5-foot well screens with soil sampling for geologic description and field (PID) analysis. [2] Conduct two additional quarterly groundwater monitoring events from the following wells: MW-1, -2, -3, -4, new piezometers PZ-2, PZ-3, and Wild Card LUST site monitoring wells PZ-13 and PZ-14 all for VOC/PVOC, Naphthalene, and Lead analysis. Also collect water levels from Wild Card LUST site wells MW-7, PZ-6, PZ-7, and PZ-11. [3] Waste Disposal, and [4] Prepare Letter Report. The cost estimate is as follows:

Access Agreement	\$ 401.94
Drilling Project	\$10,753.18
Surveying	\$ 220.30
Groundwater Monitoring	\$ 2,953.02
Laboratory Analysis	\$ 767.00
Investigative Waste Disposal	\$ 1,806.85
Letter Report	\$ 1,039.29
Change Order Request	\$ 381.78
<b>Total</b>	<b>\$18,323.36</b>

METCO is requesting a bid deferment in the amount of \$18,323.36 to complete the above activities. Once the state has approved this budget, we will move forward with the project.

Attached is a Site Layout Map with proposed piezometer well locations and draft standardized invoice form for the above workscope as required.

Should you have any questions, comments, or recommendations please contact me at our La Crosse office (608) 781-8879 or email at [jasonp@metcohq.com](mailto:jasonp@metcohq.com).

Sincerely,

A handwritten signature in black ink that reads "Jason T. Powell". The signature is fluid and cursive, with a long horizontal stroke at the beginning.

Jason T. Powell  
Staff Scientist

Attachments

c: Douglas Potvin c/o Janet Diercks POA – Client  
Mike Schradle – Property Owner

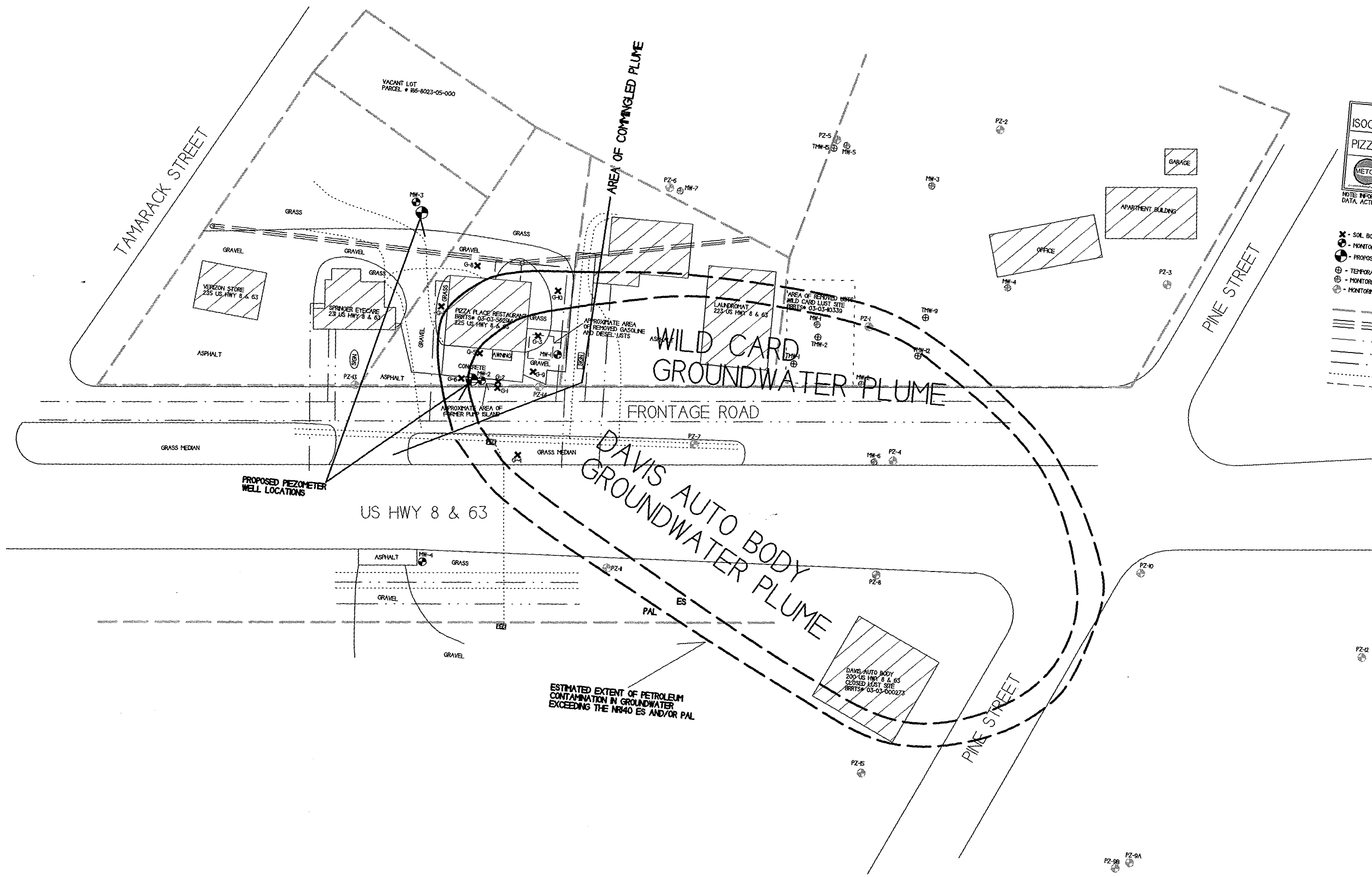

**B.3.b GROUNDWATER ISOCONCENTRATION (9/7/17)**  
**PIZZA PLACE RESTAURANT**

200 GRADE 05 DWS  
 125 GRADE 05 DWS  
 740 GRADE 05 DWS  
 740 GRADE 05 DWS

TURTLE LAKE WISCONSIN  
 DRAWN BY: ED  
 DATE: 12/2/2016

NOTE: INFORMATION BASED ON AVAILABLE DATA. ACTUAL CONDITIONS MAY DIFFER.

SCALE: 1 INCH = 60 FEET

- ✕ - SOIL BORING LOCATION
- ⊙ - MONITORING WELL LOCATION - PIZZA PLACE
- ⊙ - PROPOSED PEZOMETER WELL LOCATION - PIZZA PLACE
- ⊕ - TEMPORARY MONITORING WELL LOCATION - WILD CARD
- ⊙ - MONITORING WELL LOCATION - PERCHED AQUIFER - WILD CARD
- ⊙ - MONITORING WELL LOCATION - DEEP AQUIFER - WILD CARD
- - PROPERTY BOUNDARY
- ==== - OVERHEAD LINES
- - SANITARY SEWER LINE
- - WATER LINE
- - NATURAL GAS LINE
- - PHONE LINE
- - BURIED ELECTRIC LINE

ESTIMATED EXTENT OF PETROLEUM CONTAMINATION IN GROUNDWATER EXCEEDING THE NR140 ES AND/OR PAL

# Usual and Customary Standardized Invoice #23

## January 2018- July 2018



RR-092a

PECFA #: 54889-9999-25  
 BRRTS #: 03-03-562914  
 Site Name: Pizza Place Restaurant  
 Site Address: 225 US Hwy 8 & 63  
Turtle Lake, WI

Vendor Name: \_\_\_\_\_  
 Invoice #: \_\_\_\_\_  
 Invoice Date: \_\_\_\_\_  
 Check #: \_\_\_\_\_

U&C Total \$ 18,323.36  
 Variance to U&C Total \$ -  
 Grand Total \$ 18,323.36

TASK	TASK DESCRIPTION	SERVICES	ACTIVITY CODE	ACTIVITY REFERENCE CODE DESCRIPTION	UNIT	MAX UNIT COST	UNITS	TOTAL MAX
1	GW Sampling		GS05	Sample Collection	Well	\$ 72.45	16	\$ 1,159.20
1	GW Sampling		GS15	Incremental Sample Collection (cadmium & lead)	Well	\$ 26.25	16	\$ 420.00
1	GW Sampling		GS20	Measure Water Levels (for wells not being sampled)	Well	\$ 14.70	8	\$ 117.60
1	GW Sampling		GS25	Primary Mob/Demob	Site	\$ 628.11	2	\$ 1,256.22
4	Waste Disposal	Consultant	WD05	Consultant Coordination	Site	\$ 137.13	1	\$ 137.13
4	Waste Disposal	Commodity	WD10	GW Sample and/or Purge	Drum	\$ 42.11	2	\$ 84.22
4	Waste Disposal	Commodity	WD15	Drill Cuttings	Drum	\$ 108.15	12	\$ 1,297.80
4	Waste Disposal	Commodity	WD25	Primary Mob/Demob	Site	\$ 287.70	1	\$ 287.70
6	Letter Report/Addendum		LRA05	Letter Report/Addendum	Letter	\$ 1,039.29	1	\$ 1,039.29
10	Initial Site Survey	Consultant	IS10	Subsequent Surveys	Well	\$ 110.15	2	\$ 220.30
13.a	Drilling In Unconsolidated Soils - With Soil Sampling	Consultant	DR05	0 - 25 ft bgs	Ft	\$ 5.40	50	\$ 270.00
13.a	Drilling In Unconsolidated Soils - With Soil Sampling	Consultant	DR10	26 - 50 ft bgs	Ft	\$ 5.67	50	\$ 283.50
13.a	Drilling In Unconsolidated Soils - With Soil Sampling	Consultant	DR15	51 - 75 ft bgs	Ft	\$ 7.30	60	\$ 438.00
13.a	Drilling In Unconsolidated Soils - With Soil Sampling	Consultant	DR20	Primary Mob/Demob	Site	\$ 593.04	1	\$ 593.04
13.d	Drilling In Unconsolidated Soils - With Soil Sampling	Commodity	DR45	0 - 25 ft bgs	Ft	\$ 16.70	50	\$ 835.00
13.d	Drilling In Unconsolidated Soils - With Soil Sampling	Commodity	DR50	26 - 50 ft bgs	Ft	\$ 18.38	50	\$ 919.00
13.d	Drilling In Unconsolidated Soils - With Soil Sampling	Commodity	DR55	51 - 75 ft bgs	Ft	\$ 21.53	60	\$ 1,291.80
14	Monitoring Well Installation	Consultant	MWI05	0 - 25 ft bgs	Ft	\$ 3.89	50	\$ 194.50
14	Monitoring Well Installation	Consultant	MWI10	26 - 75 ft bgs	Ft	\$ 2.73	110	\$ 300.30
14	Monitoring Well Installation	Commodity	MWI15	2 inch PVC Casing	Ft	\$ 16.70	160	\$ 2,672.00
14	Monitoring Well Installation	Commodity	MWI20	Well Development	Well	\$ 147.63	2	\$ 295.26
15	Misc. Drilling Activities & Supplies		MDT05	Drill Rig Mob/Demob	Mob/Demob	\$ 963.38	1	\$ 963.38
15	Misc. Drilling Activities & Supplies		MDT10	Well Cover/flushmount	Each	\$ 202.65	2	\$ 405.30
15	Misc. Drilling Activities & Supplies		MDT21	Drum, 55 gal. DOT steel	Each	\$ 55.13	14	\$ 771.82
15	Misc. Drilling Activities & Supplies		MDT25	Commodity Service Provider Per Diem (drilling and direct push)	Person	\$ 203.28	2	\$ 406.56
21	Access Agreements		AA05	Access Agreements	Property	\$ 401.94	1	\$ 401.94
31	Consultant Overnight Per Diem		COPD05	Overnight	Night	\$ 113.72	1	\$ 113.72
33	Schedule Of Laboratory Maximums	Commodity		Laboratory (see task 33 total on Lab Schedule)	Lab Schedule		32	\$ 767.00
36	Change Order Request		COR05	Change Order Request (cost cap exceedance requests)	Change Order	\$ 381.78	1	\$ 381.78
Variance								
Variance								

# Usual and Customary Standardized Invoice #23

## January 2018- July 2018



**TOTAL LAB CHARGES \$ 767.00 TASK 33 32 \$ 767.00 TASK 24 0 \$ -**

MATRIX	REF CODE	REIMBURSABLE ANALYTE	UNITS	MAX COST	SAMPLES	TOTAL	MAX COST	SAMPLES	TOTAL
AIR	A1	Benzene	SAMPLE	\$ 44.94		\$ -			
AIR	A2	BETX	SAMPLE	\$ 49.46		\$ -			
AIR	A3	GRO	SAMPLE	\$ 46.10		\$ -			
AIR	A4	VOC's	SAMPLE	\$ 71.93		\$ -			
WATER	W1	GRO/PVOC	SAMPLE	\$ 29.19		\$ -			
WATER	W2	PVOC	SAMPLE	\$ 26.99		\$ -			
WATER	W3	PVOC + 1,2 DCA	SAMPLE	\$ 43.79		\$ -			
WATER	W4	PVOC + Naphthalene	SAMPLE	\$ 30.35	14	\$ 424.90			
WATER	W5	VOC	SAMPLE	\$ 71.93	2	\$ 143.86			
WATER	W6	PAH	SAMPLE	\$ 72.98		\$ -			
WATER	W7	Lead	SAMPLE	\$ 12.39	16	\$ 198.24			
WATER	W8	Cadmium	SAMPLE	\$ 13.55		\$ -			
WATER	W9	Hardness	SAMPLE	\$ 12.39		\$ -			
WATER	W10	BOD, Total	SAMPLE	\$ 23.63		\$ -			
WATER	W11	Nitrate	SAMPLE	\$ 11.24		\$ -			
WATER	W12	Total Kjeldahl	SAMPLE	\$ 20.27		\$ -			
WATER	W13	Ammonia	SAMPLE	\$ 16.91		\$ -			
WATER	W14	Sulfate	SAMPLE	\$ 10.19		\$ -			
WATER	W15	Iron	SAMPLE	\$ 10.19		\$ -			
WATER	W16	Manganese	SAMPLE	\$ 10.19		\$ -			
WATER	W17	Alkalinity	SAMPLE	\$ 10.19		\$ -			
WATER	W18	methane	SAMPLE	\$ 46.10		\$ -			
WATER	W19	Phosphorous	SAMPLE	\$ 18.06		\$ -			
WATER	W20	VOC Method 524.2	SAMPLE	\$ 176.30		\$ -			
WATER	W21	EDB Method 504	SAMPLE	\$ 95.45		\$ -			
							MAX COST	SAMPLES	TOTAL
SOILS	S1	GRO	SAMPLE	\$ 24.78		\$ -	\$ 24.78		\$ -
SOILS	S2	DRO	SAMPLE	\$ 30.35		\$ -	\$ 30.35		\$ -
SOILS	S3	GRO/PVOC	SAMPLE	\$ 28.14		\$ -	\$ 28.14		\$ -
SOILS	S4	PVOC	SAMPLE	\$ 25.83		\$ -	\$ 25.83		\$ -
SOILS	S5	PVOC + 1,2 DCA + Naphthalene	SAMPLE	\$ 49.46		\$ -	\$ 49.46		\$ -
SOILS	S6	PVOC + Naphthalene	SAMPLE	\$ 36.02		\$ -	\$ 36.02		\$ -
SOILS	S7	VOC	SAMPLE	\$ 71.93		\$ -	\$ 71.93		\$ -
SOILS	S8	SPLP Extraction VOC only	SAMPLE	\$ 50.61		\$ -	\$ 50.61		\$ -
SOILS	S9	PAH	SAMPLE	\$ 72.98		\$ -	\$ 72.98		\$ -
SOILS	S10	Lead	SAMPLE	\$ 12.39		\$ -	\$ 12.39		\$ -
SOILS	S11	Cadmium	SAMPLE	\$ 14.60		\$ -			
SOILS	S12	Free Liquid	SAMPLE	\$ 11.24		\$ -			
SOILS	S13	Flash Point	SAMPLE	\$ 25.83		\$ -			
SOILS	S14	Grain Size - dry	SAMPLE	\$ 42.74		\$ -			
SOILS	S15	Grain Size - wet	SAMPLE	\$ 57.33		\$ -			
SOILS	S16	Bulk Density	SAMPLE	\$ 13.55		\$ -			
SOILS	S17	Permeability	SAMPLE	\$ 41.58		\$ -			
SOILS	S18	Nitrogen as Total Kjeldahl	SAMPLE	\$ 20.27		\$ -			
SOILS	S19	Nitrogen as Ammonia	SAMPLE	\$ 16.91		\$ -			
SOILS	S20	% Organic Matter	SAMPLE	\$ 29.19		\$ -			
SOILS	S21	TOC as NPOC	SAMPLE	\$ 57.33		\$ -			
SOILS	S22	Soil Moisture Content	SAMPLE	\$ 6.83		\$ -			
SOILS	S23	Air Filled Porosity	SAMPLE	\$ 25.83		\$ -			
SOILS	S24	% Total Solids	SAMPLE	\$ 6.83		\$ -			
SOILS	S25	Field Capacity	SAMPLE	\$ 28.14		\$ -			
SOILS	S26	TCLP Lead	SAMPLE	\$ 83.16		\$ -			
SOILS	S27	Cation Exchange (Ca, MG, & K)	SAMPLE	\$ 26.99		\$ -			
SOILS	S28	TCLP Cadmium	SAMPLE	\$ 83.16		\$ -			
SOILS	S29	TCLP Benzene	SAMPLE	\$ 83.16		\$ -			
		Viscosity + Density							
LNAPL	LFPS01	Interfacial tension I (LNAPL/water [dyne/cm])	SAMPLE	\$ 561.33		\$ -			
		Interfacial tension II (LNAPL/air [dyne/cm])							
		Interfacial tension III (water/air [dyne/cm])							
						<b>TASK 33 TOTAL \$</b>	<b>767.00</b>		

MAX COST	SAMPLES	TOTAL
\$ 24.78		\$ -
\$ 30.35		\$ -
\$ 28.14		\$ -
\$ 25.83		\$ -
\$ 49.46		\$ -
\$ 36.02		\$ -
\$ 71.93		\$ -
\$ 50.61		\$ -
\$ 72.98		\$ -
\$ 12.39		\$ -
<b>TASK 24 TOTAL \$ -</b>		