



Excellence through experience™

709 Gillette St., Ste. #3 ♦ La Crosse, WI 54603 ♦ 1-800-552-2932 ♦ Fax (608) 781-8893 Email: rona@metcohq.com ♦ www.metcohq.com

February 6, 2019

Carrie Stoltz
Wisconsin Department of Natural Resources
107 Sutliff Avenue
Rhineland, WI 54501

Subject: Pizza Place Restaurant – Bid Deferment Request for additional soil borings and groundwater monitoring. (Revised)
BRRTS #: 03-03-562914, PECFA #: 54889-9999-25

Dear Ms. Stoltz,

A bid deferment request (using the Usual & Customary Cost Schedule) is being submitted for the subject property located at 225 U.S. Highway 8 & 63 in Turtle Lake, Wisconsin. This workscope will include: [1] Geoprobe Project with five borings to approximately 50 feet below ground surface with continuous sampling for PID readings and geologic description. Six soil samples per boring will be submitted for laboratory analysis (PVOOC and Naphthalene) with one in the top 4 feet, one at the watertable, and the remaining four at depth. [2] Conduct two quarterly rounds of groundwater monitoring from the following wells: MW-1, -2, -3, -4, PZ-2, PZ-3, PZ-13, and PZ-14 for PVOOC and Naphthalene analysis. Also collect water levels from MW-7, PZ-6, PZ-7, and PZ-11. [3] Investigative Waste Disposal following each groundwater sampling event. [4] Prepare Letter Report. Costs for the above work scope are as follows:

Access Agreement	\$ 401.94
Geoprobe Project	\$ 4,904.47
Groundwater Monitoring (2 Rounds)	\$ 2,658.64
Laboratory Analysis (soil & groundwater)	\$ 1,566.20
Waste Disposal	\$ 1,101.68
Letter Report	\$ 1,039.29
Change Order Request	\$ 381.78
Total	\$12,054.00

METCO is requesting a bid deferment in the amount of **\$12,054.00**. Upon state approval of the proposed workscope and budget, METCO will proceed with the project.

Attached are a site layout map with proposed Geoprobe boring locations and standardized invoice as required.

Should you have any questions, comments, or recommendations please contact me at our La Crosse office (608) 781-8879 or email at jasonp@metcohq.com.

Sincerely,

A handwritten signature in black ink that reads "Jason T. Powell". The signature is fluid and cursive, with a long horizontal stroke at the beginning.

Jason T. Powell
Staff Scientist

c: Douglas Potvin c/o Janet Diercks POA – Client

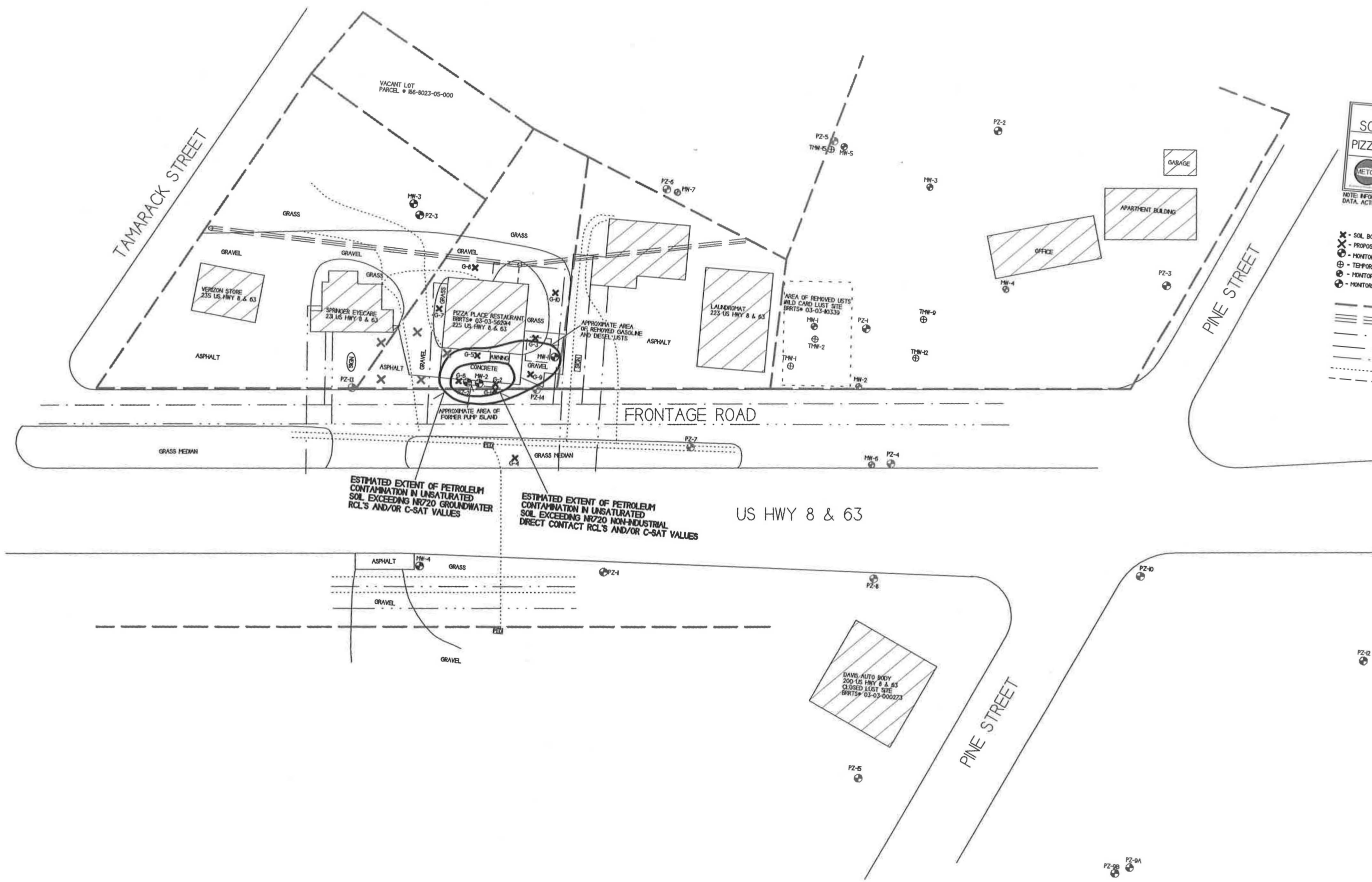

B.2.a
SOIL CONTAMINATION
PIZZA PLACE RESTAURANT

METCA
 225 Calumet St. Ste. 3
 12100 Waukegan, IL 60087
 Tel: (815) 491-3400
 Fax: (815) 491-3401
 E-mail: info@metca.com

TURTLE LAKE
 WISCONSIN
 DRAWN BY: BJD
 DATE: 04/21/08

NOTE: INFORMATION BASED ON AVAILABLE DATA. ACTUAL CONDITIONS MAY DIFFER.

SCALE: 1 INCH = 60 FEET

- ✕ - SOIL BORING LOCATION
 - ⊗ - PROPOSED GEOPROBE BORING LOCATION
 - ⊕ - MONITORING WELL LOCATION - PIZZA PLACE
 - ⊕ - TEMPORARY MONITORING WELL LOCATION - WILD CARD
 - ⊕ - MONITORING WELL LOCATION - PERCHED AQUIFER - WILD CARD
 - ⊕ - MONITORING WELL LOCATION - DEEP AQUIFER - WILD CARD
-
- — — — — PROPERTY BOUNDARY
 - — — — — OVERHEAD LINES
 - — — — — SANITARY SEWER LINE
 - — — — — WATER LINE
 - — — — — NATURAL GAS LINE
 - — — — — PHONE LINE
 - — — — — BURIED ELECTRIC LINE

ESTIMATED EXTENT OF PETROLEUM CONTAMINATION IN UNSATURATED SOIL EXCEEDING NR720 GROUNDWATER RCL'S AND/OR C-SAT VALUES

ESTIMATED EXTENT OF PETROLEUM CONTAMINATION IN UNSATURATED SOIL EXCEEDING NR720 NON-INDUSTRIAL DIRECT CONTACT RCL'S AND/OR C-SAT VALUES

US HWY 8 & 63

Usual and Customary Standardized Invoice #25

January 2019 - June 2019



RR-107a

PECFA #: 54889-9999-25
 BRRTS #: 03-03-562914
 Site Name: Pizza Place Restaurant
 Site Address: 225 US Hwy 8 & 63, Turtle Lake, WI

Vendor Name: _____
 Invoice #: _____
 Invoice Date: _____
 Check #: _____

U&C Total \$ 12,054.00
 Variance to U&C Total \$ -
 Grand Total \$ 12,054.00

TASK	TASK DESCRIPTION	SERVICES	ACTIVITY CODE	ACTIVITY REFERENCE CODE DESCRIPTION	UNIT	MAX UNIT COST	UNITS	TOTAL MAX
1	GW Sampling		GS05	Sample Collection	Well	\$ 72.45	16	\$ 1,159.20
1	GW Sampling		GS20	Measure Water Levels (for wells not being sampled)	Well	\$ 14.70	8	\$ 117.60
1	GW Sampling		GS25	Primary Mob/Demob	Site	\$ 690.92	2	\$ 1,381.84
6	Letter Report/Addendum		LRA05	Letter Report/Addendum	Letter	\$ 1,039.29	1	\$ 1,039.29
4	Waste Disposal	Consultant	WD05	Consultant Coordination	Site	\$ 137.13	2	\$ 274.26
4	Waste Disposal	Commodity	WD10	GW Sample and/or Purge	Drum	\$ 42.11	2	\$ 84.22
4	Waste Disposal	Commodity	WD25	Primary Mob/Demob	Site	\$ 316.47	2	\$ 632.94
12	Direct Push	Consultant	DP05	0 - 24 ft bgs W/ Continuous Soil Sampling	Ft	\$ 5.36	120	\$ 643.20
12	Direct Push	Consultant	DP10	> 24 ft bgs W/ Continuous Soil Sampling	Ft	\$ 5.99	130	\$ 778.70
12	Direct Push	Consultant	DP30	Primary Mob/Demob	Site	\$ 563.31	1	\$ 563.31
12	Direct Push	Commodity	DP35	0 - 24 ft bgs W/ Continuous Soil Sampling	Ft	\$ 6.93	120	\$ 831.60
12	Direct Push	Commodity	DP40	> 24 ft bgs W/ Continuous Soil Sampling	Ft	\$ 9.03	130	\$ 1,173.90
12	Direct Push	Commodity	DP60	Borehole Abandonment	Ft	\$ 1.26	250	\$ 315.00
12	Direct Push	Commodity	DP65	Concrete Penetration	Each	\$ 20.10	1	\$ 20.10
12	Direct Push	Commodity	DP80	Mob/Demob (Includes decon)	Site	\$ 578.66	1	\$ 578.66
15	Misc. Drilling Activities & Supplies		MDT21	Drum, 55 gal. DOT steel	Each	\$ 55.13	2	\$ 110.26
21	Access Agreements		AA05	Access Agreements	Property	\$ 401.94	1	\$ 401.94
33	Schedule Of Laboratory Maximums	Commodity		Laboratory (see task 33 total on Lab Schedule)	Lab Schedule			\$ 1,566.20
36	Change Order Request		COR05	Change Order Request (cost cap exceedance requests)	Change Order	\$ 381.78	1	\$ 381.78

Variance
 Variance

Usual and Customary Standardized Invoice #25

January 2019 - June 2019



RR-107a

TOTAL LAB CHARGES \$ 1,566.20 TASK 33 46 \$ 1,566.20 TASK 24 0 \$ -

MATRIX	REF CODE	REIMBURSABLE ANALYTE	UNITS	MAX COST	SAMPLES	TOTAL	MAX COST	SAMPLES	TOTAL
AIR	A1	Benzene	SAMPLE	\$ 44.94		\$ -			
AIR	A2	BETX	SAMPLE	\$ 49.46		\$ -			
AIR	A3	GRO	SAMPLE	\$ 46.10		\$ -			
AIR	A4	VOC's	SAMPLE	\$ 71.93		\$ -			
WATER	W1	GRO/PVOC	SAMPLE	\$ 29.19		\$ -			
WATER	W2	PVOC	SAMPLE	\$ 26.99		\$ -			
WATER	W3	PVOC + 1,2 DCA	SAMPLE	\$ 43.79		\$ -			
WATER	W4	PVOC + Naphthalene	SAMPLE	\$ 30.35	16	\$ 485.60			
WATER	W5	VOC	SAMPLE	\$ 71.93		\$ -			
WATER	W6	PAH	SAMPLE	\$ 72.98		\$ -			
WATER	W7	Lead	SAMPLE	\$ 12.39		\$ -			
WATER	W8	Cadmium	SAMPLE	\$ 13.55		\$ -			
WATER	W9	Hardness	SAMPLE	\$ 12.39		\$ -			
WATER	W10	BOD, Total	SAMPLE	\$ 23.63		\$ -			
WATER	W11	Nitrate	SAMPLE	\$ 11.24		\$ -			
WATER	W12	Total Kjeldahl	SAMPLE	\$ 20.27		\$ -			
WATER	W13	Ammonia	SAMPLE	\$ 16.91		\$ -			
WATER	W14	Sulfate	SAMPLE	\$ 10.19		\$ -			
WATER	W15	Iron	SAMPLE	\$ 10.19		\$ -			
WATER	W16	Manganese	SAMPLE	\$ 10.19		\$ -			
WATER	W17	Alkalinity	SAMPLE	\$ 10.19		\$ -			
WATER	W18	methane	SAMPLE	\$ 46.10		\$ -			
WATER	W19	Phosphorous	SAMPLE	\$ 18.06		\$ -			
WATER	W20	VOC Method 524.2	SAMPLE	\$ 176.30		\$ -			
WATER	W21	EDB Method 504	SAMPLE	\$ 95.45		\$ -			
SOILS	S1	GRO	SAMPLE	\$ 24.78		\$ -	\$ 24.78		\$ -
SOILS	S2	DRO	SAMPLE	\$ 30.35		\$ -	\$ 30.35		\$ -
SOILS	S3	GRO/PVOC	SAMPLE	\$ 28.14		\$ -	\$ 28.14		\$ -
SOILS	S4	PVOC	SAMPLE	\$ 25.83		\$ -	\$ 25.83		\$ -
SOILS	S5	PVOC + 1,2 DCA + Naphthalene	SAMPLE	\$ 49.46		\$ -	\$ 49.46		\$ -
SOILS	S6	PVOC + Naphthalene	SAMPLE	\$ 36.02	30	\$ 1,080.60	\$ 36.02		\$ -
SOILS	S7	VOC	SAMPLE	\$ 71.93		\$ -	\$ 71.93		\$ -
SOILS	S8	SPLP Extraction VOC only	SAMPLE	\$ 50.61		\$ -	\$ 50.61		\$ -
SOILS	S9	PAH	SAMPLE	\$ 72.98		\$ -	\$ 72.98		\$ -
SOILS	S10	Lead	SAMPLE	\$ 12.39		\$ -	\$ 12.39		\$ -
SOILS	S11	Cadmium	SAMPLE	\$ 14.60		\$ -			
SOILS	S12	Free Liquid	SAMPLE	\$ 11.24		\$ -			
SOILS	S13	Flash Point	SAMPLE	\$ 25.83		\$ -			
SOILS	S14	Grain Size - dry	SAMPLE	\$ 42.74		\$ -			
SOILS	S15	Grain Size - wet	SAMPLE	\$ 57.33		\$ -			
SOILS	S16	Bulk Density	SAMPLE	\$ 13.55		\$ -			
SOILS	S17	Permeability	SAMPLE	\$ 41.58		\$ -			
SOILS	S18	Nitrogen as Total Kjeldahl	SAMPLE	\$ 20.27		\$ -			
SOILS	S19	Nitrogen as Ammonia	SAMPLE	\$ 16.91		\$ -			
SOILS	S20	% Organic Matter	SAMPLE	\$ 29.19		\$ -			
SOILS	S21	TOC as NPOC	SAMPLE	\$ 57.33		\$ -			
SOILS	S22	Soil Moisture Content	SAMPLE	\$ 6.83		\$ -			
SOILS	S23	Air Filled Porosity	SAMPLE	\$ 25.83		\$ -			
SOILS	S24	% Total Solids	SAMPLE	\$ 6.83		\$ -			
SOILS	S25	Field Capacity	SAMPLE	\$ 28.14		\$ -			
SOILS	S26	TCLP Lead	SAMPLE	\$ 83.16		\$ -			
SOILS	S27	Cation Exchange (Ca, MG, & K)	SAMPLE	\$ 26.99		\$ -			
SOILS	S28	TCLP Cadmium	SAMPLE	\$ 83.16		\$ -			
SOILS	S29	TCLP Benzene	SAMPLE	\$ 83.16		\$ -			
		Viscosity + Density							
LNAPL	LFPS01	Interfacial tension I (LNAPL/water [dyne/cm])	SAMPLE	\$ 561.33		\$ -			
		Interfacial tension II (LNAPL/air [dyne/cm])							
		Interfacial tension III (water/air) [dyne/cm]							
						TASK 33 TOTAL	\$	1,566.20	

MAX COST	SAMPLES	TOTAL
\$ 24.78		\$ -
\$ 30.35		\$ -
\$ 28.14		\$ -
\$ 25.83		\$ -
\$ 49.46		\$ -
\$ 36.02		\$ -
\$ 71.93		\$ -
\$ 50.61		\$ -
\$ 72.98		\$ -
\$ 12.39		\$ -
TASK 24 TOTAL		
		\$ -