

# SEYMOUR ENVIRONMENTAL SERVICES, INC.

---

P.O. Box 398, 2531 Dyreson Road, McFarland, Wisconsin 53558  
Telephone: 608-838-9120

September 9, 2019

Janet DiMaggio  
Wisconsin Department of Natural Resources  
3911 Fish Hatchery Road  
Madison, Wisconsin 53711

RE: Budget Request-Rath (BRRTS: 03-22-563937, PECFA #53807-9551-04)  
1304 Saint Rose Road  
Cuba City, Wisconsin 53807

Dear Ms. DiMaggio:

Seymour Environmental Services, Inc. (Seymour) is submitting this budget request for excavation and off-site disposal of accessible contaminated soil at the site. We estimate that up to 450 tons of contaminated soil will require removal. The total budget request is for \$32,362.86. This includes items on the U&C Schedule as well as a variance for the remedial excavation costs.

In June 2019 a Geoprobe™ investigation was initiated at the site. Soil samples were collected from seven direct push borings. Soil samples were collected to a maximum depth of 15 feet where refusal was encountered. No groundwater sampling was performed but we did collect a sample from the private water supply well. Sample analysis shows that soil contamination exceeding the groundwater pathway RCLs is located near the former tanks. In the area of the former tank bed soil contamination extends from 7 feet to 15 feet. The top of the soil contamination becomes deeper away from the tank bed. It appears that ~450 tons of soil containing PVOCs above the groundwater pathway RCL are present at the site. Excavation of the contaminated soil would require moving about 200 tons of overburden.

We recommend conducting remedial excavation to remove the contaminated soils. The results of the Geoprobe™ investigation indicate that the contamination does not extend under the neighboring roads. Based on the distribution of the soil contamination and the presence of a building at the property it may not be possible to excavate all the impacted soil. During the remediation the accessible soil contamination on the source property will be removed. Soil samples will be collected from the sidewalls and the base of the excavation to characterize the presence of any residual contaminant levels and bedrock that is encountered will be described for the presence of fractures, and evidence of contamination in contact with the bedrock. This information will be used to determine whether additional investigation including groundwater sampling is necessary.

We understand that we are required to request a variance to the U&C schedule since the excavation costs exceed \$10,000. A bid for the anticipated soil remediation subcontractor activities was obtained from Wiederholt Enterprises. This bid was used to develop the cost for the proposed soil remediation. Details of the remediation costs for the variance items are summarized in the following table.

Soil Remediation Costs			
ITEM	Amount	Unit Cost	Total
Contractor Mobilization/Signage/Fencing	1	\$1,500	\$1,500.00
Excavate/Load/Haul Contaminated Soil	450 ton	\$25.50	\$11,475.00
Excavation and Stockpile Clean Overburden	200 ton	\$5.75	\$1,150.00
Provide/Compact Backfill	450	10.50	\$4,725.00
Backfill and Compact Stockpiled Soil	200	7.50	\$1,500.00
Gravel Surface and Placement	0 ton	\$14.00	\$0.00
Tipping Fees-Orchard Hills landfill	450 ton	\$14.00	\$6,300.00
Profile Fee			\$100.00
Total Commodity Costs			\$26,750.00
Consultant Oversight (contaminated)	18	94.13	\$1,694.34
Consultant Oversight (overburden)	4	94.13	\$376.52
Total Consultant Cost			\$2,070.86
<b>Total Variance Excavation Cost</b>			<b>\$28,820.86</b>

All other activities needed at the site can be completed for the U&C rates. These include consultant mobilization, confirmation soil sampling, a letter report, cost request and per diem. I also included the cost to conduct a well reconnaissance and to collect another sample from the private well. We will submit the remediation report and include the information about the well reconnaissance once we have the results of the confirmation sampling. Please call me if you have any questions at 608-838-9120 or 608-225-9407 (cell).

Sincerely,  
**Seymour Environmental Services, Inc.**



Robyn Seymour  
 Hydrogeologist

Attachment: U&C Cost Schedule  
 Soil Excavation Bid  
 Proposed Excavation Map

# Usual and Customary Standardized Invoice #26

## July 2019 - December 2019



RR-111a

PECFA #: 53807-9551-04  
 BRRTS #: 03-22-563937  
 Site Name: Rath Property  
 Site Address: 1304 St. Rose Rd., Cuba City

Vendor Name: Seymour  
 Invoice #: Budget Request  
 Invoice Date: 9-Sep-19  
 Check #: \_\_\_\_\_

U&C Total \$ 4,045.51  
 Variance to U&C Total \$ 28,820.86  
 Grand Total \$ 32,866.37

TASK	TASK DESCRIPTION	SERVICES	ACTIVITY CODE	ACTIVITY REFERENCE CODE DESCRIPTION	UNIT	MAX UNIT COST	UNITS	TOTAL MAX
1	GW Sampling		GS05	Sample Collection	Well	\$ 74.62	1	\$ 74.62
1	GW Sampling		GS06	Sample Collection in well w/LNAPL	Well	\$ 90.07		\$ -
1	GW Sampling		GS10	Incremental Sample Collection (natural attenuation)	Well	\$ 49.10		\$ -
1	GW Sampling		GS15	Incremental Sample Collection (cadmium & lead)	Well	\$ 27.04		\$ -
1	GW Sampling		GS20	Measure Water Levels (for wells not being sampled)	Well	\$ 15.14		\$ -
1	GW Sampling		GS25	Primary Mob/Demob	Site	\$ 690.92		\$ -
1	GW Sampling		GS30	Temporary Well Abandonment	Well	\$ 27.80		\$ -
2	O & M Reporting		OMR05	Semi-Annual GW Monitoring (Form 4400-194)	Report	\$ 848.44		\$ -
2	O & M Reporting		OMR10	Semi-Annual GW Monitoring (Form 4400-194) with LNAPL Removal per RR-628	Report	\$ 1,071.66		\$ -
3	LNAPL Assessment & Removal		LAR06	LNAPL Sample Collection (1 per site, unless otherwise directed)	Site	\$ 70.30		\$ -
3	LNAPL Assessment & Removal		LAR10	Primary Mob/Demob	Site	\$ 569.88		\$ -
4	Waste Disposal	Consultant	WD05	Consultant Coordination	Site	\$ 141.24		\$ -
4	Waste Disposal	Commodity	WD10	GW Sample and/or Purge	Drum	\$ 43.37		\$ -
4	Waste Disposal	Commodity	WD15	Drill Cuttings	Drum	\$ 111.39		\$ -
4	Waste Disposal	Commodity	WD17	Landfill Environmental Fee (provide documentation)	ACTUAL COST			
4	Waste Disposal	Commodity	WD20	Free Product	Drum	\$ 122.32		\$ -
4	Waste Disposal	Commodity	WD25	Primary Mob/Demob	Site	\$ 316.47		\$ -
5	Closure Request		CR05	Primary Closure Request	Submittal	\$ 2,781.00		\$ -
5	Closure Request		CR15	Continuing Obligation Packet Submittal (For Source Property)	Packet	\$ 522.58		\$ -
5	Closure Request		CR20	Continuing Obligation Packet Submittal (For off-site Properties)	Per Additional Property	\$ 229.39		\$ -
5	Closure Request		CR25	Closure Request Following SIR	Submittal	\$ 1,287.50		\$ -
5	Closure Request		CR30	PE review and certification of closure packet	Site	\$ 1,129.60		\$ -
6	Letter Report/Addendum		LRA05	Letter Report/Addendum	Letter	\$ 1,070.47	1	\$ 1,070.47

TASK	TASK DESCRIPTION	SERVICES	ACTIVITY CODE	ACTIVITY REFERENCE CODE DESCRIPTION	UNIT	MAX UNIT COST	UNITS	TOTAL MAX
7	Regulatory Correspondence		RC05	Regulatory Correspondence	Letter/Status Update	\$ 132.81		\$ -
8	Well Abandonment	Consultant	WAB05	Coordination	Site	\$ 162.86		\$ -
8	Well Abandonment	Consultant	WAB10	Water column < 30 ft	Ft	\$ 2.60		\$ -
8	Well Abandonment	Consultant	WAB15	Water column > 30 ft (requires pumping [s. NR 141.25 (2) (d)])	Ft	\$ 9.08		\$ -
8	Well Abandonment	Consultant	WAB20	Bentonite Pellets (50lb bag - 1/4" pellet)	Bag	\$ 11.14		\$ -
8	Well Abandonment	Consultant	WAB25	Portland Cement (94lb bag)	Bag	\$ 8.44		\$ -
8	Well Abandonment	Consultant	WAB30	Primary Mob/Demob	Site	\$ 398.48		\$ -
8	Well Abandonment	Consultant	WAB31	Primary Mob/Demob w/ vapor point abandonment	Site	\$ 563.48		\$ -
8	Well Abandonment	Consultant	WAB32	Vapor Point Abandonment	Point	\$ 81.58		\$ -
8	Well Abandonment	Commodity	WAB35	Well Abandonment Mob/Demob	Site	\$ 453.81		\$ -
8	Well Abandonment	Commodity	WAB40	Well Abandonment (2 inch)	Ft	\$ 5.74		\$ -
8	Well Abandonment	Commodity	WAB45	Well Abandonment (4 inch)	Ft	\$ 6.71		\$ -
8	Well Abandonment	Commodity	WAB50	Well Abandonment (6 inch)	Ft	\$ 8.22		\$ -
9	Investigation Workplan Preparation		IWP05	Investigation Workplan Preparation	Report	\$ 1,495.18		\$ -
10	Initial Site Survey	Consultant	IS05	Coordination of Initial Site Survey (features + well elevations)	Survey	\$ 120.70		\$ -
10	Initial Site Survey	Consultant	IS10	Subsequent Surveys	Well	\$ 113.45		\$ -
10	Initial Site Survey	Commodity	IS15	Initial Survey	Survey	\$ 1,206.85		\$ -
11	Potable Well Field Reconnaissance		PWFR05	Potable Well Field Reconnaissance	Site	\$ 601.01	1	\$ 601.01
12	Direct Push	Consultant	DP05	0 - 24 ft bgs W/ Continuous Soil Sampling	Ft	\$ 5.52		\$ -
12	Direct Push	Consultant	DP10	> 24 ft bgs W/ Continuous Soil Sampling	Ft	\$ 6.17		\$ -
12	Direct Push	Consultant	DP15	GW Profiling (No Soil Sampling)	Ft	\$ 2.38		\$ -
12	Direct Push	Consultant	DP20	GW Sample Collection	Each	\$ 37.18		\$ -
12	Direct Push	Consultant	DP25	Temporary Well Installation	Each	\$ 51.40		\$ -
12	Direct Push	Consultant	DP30	Primary Mob/Demob	Site	\$ 563.31		\$ -
12	Direct Push	Commodity	DP35	0 - 24 ft bgs W/ Continuous Soil Sampling	Ft	\$ 7.14		\$ -
12	Direct Push	Commodity	DP40	> 24 ft bgs W/ Continuous Soil Sampling	Ft	\$ 9.30		\$ -
12	Direct Push	Commodity	DP45	GW Profiling (no soil sampling)	Ft	\$ 6.71		\$ -
12	Direct Push	Commodity	DP50	GW Sample Collection (cost for tubing)	Ft	\$ 0.43		\$ -
12	Direct Push	Commodity	DP55	Expendable Drive Point	Each	\$ 14.92		\$ -
12	Direct Push	Commodity	DP60	Borehole Abandonment	Ft	\$ 1.30		\$ -
12	Direct Push	Commodity	DP65	Concrete Penetration	Each	\$ 20.70		\$ -

TASK	TASK DESCRIPTION	SERVICES	ACTIVITY CODE	ACTIVITY REFERENCE CODE DESCRIPTION	UNIT	MAX UNIT COST	UNITS	TOTAL MAX
12	Direct Push	Commodity	DP70	GW Sample Collection	Each	\$ 40.45	\$ -	-
12	Direct Push	Commodity	DP75	Temporary Well Installation	Ft	\$ 5.41	\$ -	-
12	Direct Push	Commodity	DP80	Mob/Demob (Includes decon)	Site	\$ 578.66	\$ -	-
13.a	Drilling In Unconsolidated Soils - With Soil Sampling	Consultant	DR05	0 - 25 ft bgs	Ft	\$ 5.56	\$ -	-
13.a	Drilling In Unconsolidated Soils - With Soil Sampling	Consultant	DR10	26 - 50 ft bgs	Ft	\$ 5.84	\$ -	-
13.a	Drilling In Unconsolidated Soils - With Soil Sampling	Consultant	DR15	51 - 75 ft bgs	Ft	\$ 7.52	\$ -	-
13.a	Drilling In Unconsolidated Soils - With Soil Sampling	Consultant	DR20	Primary Mob/Demob	Site	\$ 652.34	\$ -	-
13.b	Drilling In Unconsolidated Soils - Without Soil And/Or GW Sampling	Consultant	DR25	Consultant Oversight	Ft	\$ 1.63	\$ -	-
13.b	Drilling In Unconsolidated Soils - Without Soil And/Or GW Sampling	Consultant	DR30	Primary Mob/Demob	Site	\$ 555.68	\$ -	-
13.c	Drilling In Bedrock	Consultant	DR35	Consultant Oversight	Ft	\$ 6.39	\$ -	-
13.c	Drilling In Bedrock	Consultant	DR40	Primary Mob/Demob	Site	\$ 652.34	\$ -	-
13.d	Drilling In Unconsolidated Soils - With Soil Sampling	Commodity	DR45	0 - 25 ft bgs	Ft	\$ 17.20	\$ -	-
13.d	Drilling In Unconsolidated Soils - With Soil Sampling	Commodity	DR50	26 - 50 ft bgs	Ft	\$ 18.93	\$ -	-
13.d	Drilling In Unconsolidated Soils - With Soil Sampling	Commodity	DR55	51 - 75 ft bgs	Ft	\$ 22.18	\$ -	-
13.e	Drilling In Unconsolidated Soils - Without Soil And/Or GW Sampling	Commodity	DR60	Drilling in Unconsolidated Soils	Ft	\$ 12.33	\$ -	-
13.f	Drilling In Bedrock	Commodity	DR65	Drilling in Bedrock	Ft	\$ 34.18	\$ -	-
13.f	Drilling In Bedrock	Commodity	DR70	Bedrock Drilling Setup Charge	Each	\$ 166.88	\$ -	-
13.f	Drilling In Bedrock	Commodity	DR75	Air Compressor	Day	\$ 439.20	\$ -	-
14	Monitoring Well Installation	Consultant	MWI05	0 - 25 ft bgs	Ft	\$ 4.01	\$ -	-
14	Monitoring Well Installation	Consultant	MWI10	26 - 75 ft bgs	Ft	\$ 2.81	\$ -	-
14	Monitoring Well Installation	Commodity	MWI15	2 inch PVC Casing	Ft	\$ 17.20	\$ -	-
14	Monitoring Well Installation	Commodity	MWI20	Well Development	Well	\$ 152.06	\$ -	-
14	Monitoring Well Installation	Commodity	MWI25	Mob/Demob (For development of grout or slurry sealed wells	Site	\$ 603.49	\$ -	-
15	Misc. Drilling Activities & Supplies		MDT05	Drill Rig Mob/Demob	Mob/Demob	\$ 1,059.72	\$ -	-
15	Misc. Drilling Activities & Supplies		MDT10	Well Cover/flushmount	Each	\$ 208.73	\$ -	-
15	Misc. Drilling Activities & Supplies		MDT15	Stickup Well Cover	Each	\$ 168.83	\$ -	-

TASK	TASK DESCRIPTION	SERVICES	ACTIVITY CODE	ACTIVITY REFERENCE CODE DESCRIPTION	UNIT	MAX UNIT COST	UNITS	TOTAL MAX
15	Misc. Drilling Activities & Supplies		MDT20	Bumper Guard Posts	Each	\$ 71.38		\$ -
15	Misc. Drilling Activities & Supplies		MDT21	Drum, 55 gal. DOT steel	Each	\$ 56.78		\$ -
15	Misc. Drilling Activities & Supplies		MDT25	Commodity Service Provider Per Diem (drilling and direct push)	Person	\$ 209.38		\$ -
15	Misc. Drilling Activities & Supplies		MDT30	Well Repair	Well	\$ 86.95		\$ -
15	Misc. Drilling Activities & Supplies		MDT35	Borehole Abandonment	Foot	\$ 5.62		\$ -
15	Misc. Drilling Activities & Supplies		MDT40	Concrete Penetration	Each	\$ 75.06		\$ -
15	Misc. Drilling Activities & Supplies		MDT41	Private Utility Locate	ACTUAL COST			\$ -
15	Misc. Drilling Activities & Supplies		MDT45	Padlocks	Each	\$ 8.22		\$ -
16	Hand Auger Boring		HA05	Hand Augering	Boring	\$ 92.69		\$ -
16	Hand Auger Boring		HA10	Primary Mob/Demob	Site	\$ 611.12		\$ -
17	Surface Soil/Sediment/Water Sampling		SSWS05	Sampling	Sample Location	\$ 22.18		\$ -
17	Surface Soil/Sediment/Water Sampling		SSWS10	Primary Mob/Demob	Site	\$ 497.70		\$ -
19	Hydraulic Conductivity Testing		HCT05	Hydraulic Conductivity Testing	Well	\$ 60.35		\$ -
19	Hydraulic Conductivity Testing		HCT10	Primary Mob/Demob	Site	\$ 718.07		\$ -
20	Soil Boring/Monitoring Well Permits		SBMWP05	Soil Boring/Monitoring Well Permit	Permit	\$ 253.50		\$ -
20	Soil Boring/Monitoring Well Permits		SBMWP10	Permit Fee (copy of permit & fee receipt required)	Permit Fee			\$ -
21	Access Agreements		AA05	Access Agreements	Property	\$ 414.00		\$ -
22	Soil Investigation Report		SIR05	Soil Investigation Report	Report	\$ 3,430.85		\$ -
23	Soil And GW Investigation Report		SGIR05	Soil and GW Investigation Report	Report	\$ 5,114.31		\$ -
24	Limited Soil Excavation	Consultant	LSE05	Consultant Oversight for Limited Soil Excavation	Ton	\$ 5.09		\$ -
24	Limited Soil Excavation	Consultant	LSE10	Primary Mob/Demob	Site	\$ 915.11	1	\$ 915.11
24	Limited Soil Excavation	Commodity	LSE13	Laboratory (see task 24 total on Lab Schedule)	Lab Schedule		10	\$ 371.00
24	Limited Soil Excavation	Commodity	LSE15	Limited Soil Excavation	Ton	\$ 61.80		\$ -
24	Limited Soil Excavation	Commodity	LSE16	Landfill Environmental Fee (provide documentation)	ACTUAL COST			\$ -
25	Remediation System Shut Down		SSD05	Permanent	Site	\$ 1,128.33		\$ -
25	Remediation System Shut Down		SSD10	Temporary	Site	\$ 339.16		\$ -
25	Remediation System Shut Down		SSD15	Primary Mob/Demob	Site	\$ 520.91		\$ -
27	Claim Submittal		CS05	Claim Submittal	Claim	\$ 603.48		\$ -
28	Standardized Invoice		SI05	Standardized Invoice	Invoice	\$ 18.17		\$ -
30	Meeting With Regulators		MR05	Meeting with Regulators	Meeting	\$ 359.71		\$ -
31	Consultant Overnight Per Diem		COPD05	Overnight	Night	\$ 125.09	2	\$ 250.18

TASK	TASK DESCRIPTION	SERVICES	ACTIVITY CODE	ACTIVITY REFERENCE CODE DESCRIPTION	UNIT	MAX UNIT COST	UNITS	TOTAL MAX
33	Schedule Of Laboratory Maximums	Commodity		Laboratory (see task 33 total on Lab Schedule)	Lab Schedule			\$ 74.09
34	Consultant Incremental Mob/Demob		IMD05	Incremental Mob/Demob-Water Supply Sampling	Site	\$ 295.80	1	\$ 295.80
35	Cap Maintenance Plan		CMP05	Cap Maintenance Plan	Plan	\$ 329.64		\$ -
36	Change Order Request		COR05	Change Order Request (cost cap exceedance requests)	Change Order	\$ 393.23	1	\$ 393.23
37	Vapor Point Installation & Sampling		VIS05	Installation & Sampling (up to 5 points)	Point	\$ 510.26		\$ -
37	Vapor Point Installation & Sampling		VIS10	Mob/Demob (up to 5 points)	Site	\$ 813.95		\$ -
Variance				Excavation Commodity				\$ 26,750.00
Variance				Excavation Consultant	22	\$ 94.13		\$ 2,070.86

# Usual and Customary Standardized Invoice #26

## July 2019 - December 2019 (Interim)



RR-111a

**TOTAL LAB CHARGES ##### TASK 33 1 \$74.09 TASK 24 10 \$371.00**

MATRIX	REF CODE	REIMBURSABLE ANALYTE	UNITS	MAX COST	SAMPLES	TOTAL	MAX COST	SAMPLES	TOTAL
AIR	A1	Benzene	SAMPLE	\$ 46.29		\$ -			
AIR	A2	BETX	SAMPLE	\$ 50.94		\$ -			
AIR	A3	GRO	SAMPLE	\$ 47.48		\$ -			
AIR	A4	VOC's	SAMPLE	\$ 74.09		\$ -			
WATER	W1	GRO/PVOC	SAMPLE	\$ 30.07		\$ -			
WATER	W2	PVOC	SAMPLE	\$ 27.80		\$ -			
WATER	W3	PVOC + 1,2 DCA	SAMPLE	\$ 45.10		\$ -			
WATER	W4	PVOC + Naphthalene	SAMPLE	\$ 31.26		\$ -			
WATER	W5	VOC	SAMPLE	\$ 74.09	1	\$ 74.09			
WATER	W6	PAH	SAMPLE	\$ 75.17		\$ -			
WATER	W7	Lead	SAMPLE	\$ 12.76		\$ -			
WATER	W8	Cadmium	SAMPLE	\$ 13.96		\$ -			
WATER	W9	Hardness	SAMPLE	\$ 12.76		\$ -			
WATER	W10	BOD, Total	SAMPLE	\$ 24.34		\$ -			
WATER	W11	Nitrate	SAMPLE	\$ 11.58		\$ -			
WATER	W12	Total Kjeldahl	SAMPLE	\$ 20.88		\$ -			
WATER	W13	Ammonia	SAMPLE	\$ 17.42		\$ -			
WATER	W14	Sulfate	SAMPLE	\$ 10.50		\$ -			
WATER	W15	Iron	SAMPLE	\$ 10.50		\$ -			
WATER	W16	Manganese	SAMPLE	\$ 10.50		\$ -			
WATER	W17	Alkalinity	SAMPLE	\$ 10.50		\$ -			
WATER	W18	methane	SAMPLE	\$ 47.48		\$ -			
WATER	W19	Phosphorous	SAMPLE	\$ 18.60		\$ -			
WATER	W20	VOC Method 524.2	SAMPLE	\$ 181.59		\$ -			
WATER	W21	EDB Method 504	SAMPLE	\$ 98.31		\$ -			
							MAX COST	SAMPLES	TOTAL
SOILS	S1	GRO	SAMPLE	\$ 25.52		\$ -	\$ 25.52		\$ -
SOILS	S2	DRO	SAMPLE	\$ 31.26		\$ -	\$ 31.26		\$ -
SOILS	S3	GRO/PVOC	SAMPLE	\$ 28.98		\$ -	\$ 28.98		\$ -
SOILS	S4	PVOC	SAMPLE	\$ 26.60		\$ -	\$ 26.60		\$ -
SOILS	S5	PVOC + 1,2 DCA + Naphthalene	SAMPLE	\$ 50.94		\$ -	\$ 50.94		\$ -
SOILS	S6	PVOC + Naphthalene	SAMPLE	\$ 37.10		\$ -	\$ 37.10	10	\$ 371.00
SOILS	S7	VOC	SAMPLE	\$ 74.09		\$ -	\$ 74.09		\$ -
SOILS	S8	SPLP Extraction VOC only	SAMPLE	\$ 52.13		\$ -	\$ 52.13		\$ -
SOILS	S9	PAH	SAMPLE	\$ 75.17		\$ -	\$ 75.17		\$ -
SOILS	S10	Lead	SAMPLE	\$ 12.76		\$ -	\$ 12.76		\$ -



MATRIX	REF CODE	REIMBURSABLE ANALYTE	UNITS	MAX COST	SAMPLES	TOTAL	MAX COST	SAMPLES	TOTAL
SOILS	S11	Cadmium	SAMPLE	\$ 15.04		\$ -	<b>TASK 24 TOTAL \$ 371.00</b>		
SOILS	S12	Free Liquid	SAMPLE	\$ 11.58		\$ -			
SOILS	S13	Flash Point	SAMPLE	\$ 26.60		\$ -			
SOILS	S14	Grain Size - dry	SAMPLE	\$ 44.02		\$ -			
SOILS	S15	Grain Size - wet	SAMPLE	\$ 59.05		\$ -			
SOILS	S16	Bulk Density	SAMPLE	\$ 13.96		\$ -			
SOILS	S17	Permeability	SAMPLE	\$ 42.83		\$ -			
SOILS	S18	Nitrogen as Total Kjeldahl	SAMPLE	\$ 20.88		\$ -			
SOILS	S19	Nitrogen as Ammonia	SAMPLE	\$ 17.42		\$ -			
SOILS	S20	% Organic Matter	SAMPLE	\$ 30.07		\$ -			
SOILS	S21	TOC as NPOC	SAMPLE	\$ 59.05		\$ -			
SOILS	S22	Soil Moisture Content	SAMPLE	\$ 7.03		\$ -			
SOILS	S23	Air Filled Porosity	SAMPLE	\$ 26.60		\$ -			
SOILS	S24	% Total Solids	SAMPLE	\$ 7.03		\$ -			
SOILS	S25	Field Capacity	SAMPLE	\$ 28.98		\$ -			
SOILS	S26	TCLP Lead	SAMPLE	\$ 85.65		\$ -			
SOILS	S27	Cation Exchange (Ca, MG, & K)	SAMPLE	\$ 27.80		\$ -			
SOILS	S28	TCLP Cadmium	SAMPLE	\$ 85.65		\$ -			
SOILS	S29	TCLP Benzene	SAMPLE	\$ 85.65		\$ -			
		Viscosity + Density							
LNAPL	LFPS01	Interfacial tension I (LNAPL/water [dyne/cm])	SAMPLE	\$ 578.17		\$ -			
		Interfacial tension II (LNAPL/air [dyne/cm])							
		Interfacial tension III (water/air [dyne/cm])							
						<b>TASK 33 TOTAL \$ 74.09</b>			

**BID ESTIMATE SHEET**

**Rath Property-Cuba City, Wisconsin**

**Excavation and Removal of Petroleum-Contaminated Soil**

<u>ITEM</u>	<u>UNIT COST</u>	<u>ESTIMATED TOTAL</u>
<b>PECFA-ELIGIBLE ITEMS</b>		
Mobilization/signage/fencing (lump sum per mobilization = \$ <u>1500</u> )	(lump sum)	\$ <u>1500.00</u>
Excavate/load soil/haul soil (per ton = \$ <u>25.50</u> )	(450 tons)	\$ <u>11475.00</u>
Excavate and stockpile clean soil onsite (per ton = \$ <u>5.75</u> )	(200 tons)	\$ <u>1150.00</u>
Provide backfill soil material (source of your choice)/compact (per ton = \$ <u>10.50</u> )	(450 tons)	\$ <u>4725.00</u>
Backfill and compact stockpiled soil (per ton = \$ <u>7.50</u> )	(200 tons)	\$ <u>1500.00</u>
Provide and Place Gravel (per ton = \$ <u>14.00</u> )	(0 tons)	\$ _____
<b>Total Eligible Site Work Cost \$</b>		<b><u>\$20350.00</u></b>

Wiederholt Enterprises, LLC

Tim Wiederholt      9-5-19  
Tim Wiederholt                      Date

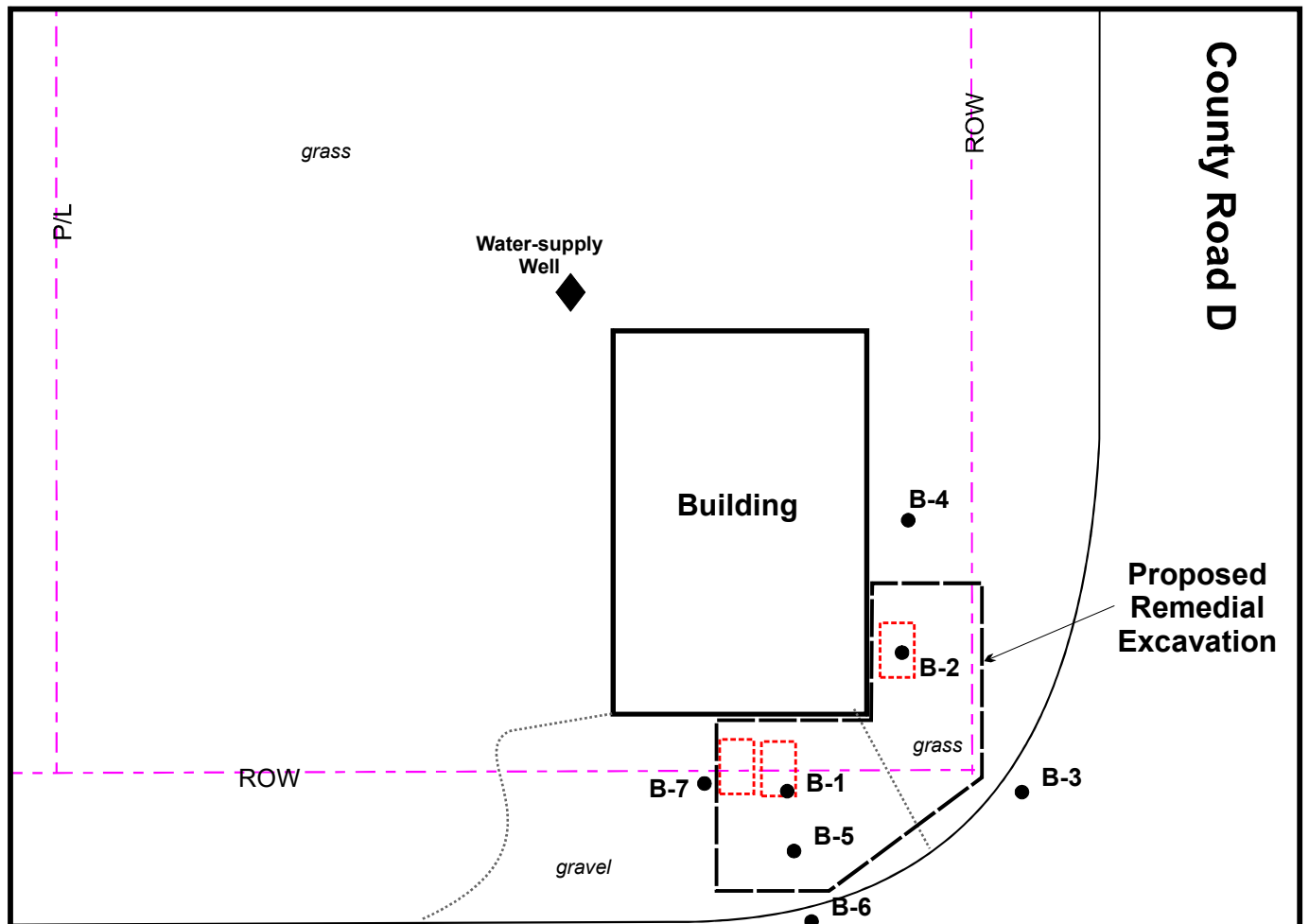

**Saint Rose Road**

**County Road D**

**Proposed Remedial Excavation**

**LEGEND**

- B-1** ● - Geoprobe Boring (June 2019)
- ◆ - Water Supply Well

N

0      20'      40'

1 INCH = 20 FEET  
SCALE IS APPROXIMATE

FILE/PATH: D:\PROJECTS\RATH\  
Layout-samples.cdr

DATE: 07/23/2019

PREPARED: MDF      APPROVED:

SOURCE:  
Grant County Public Mapping  
Field Measurements

**SEYMOUR  
ENVIRONMENTAL  
SERVICES, INC.**

**PROPOSED REMEDIAL EXCAVATION  
RATH PROPERTY  
1304 Saint Rose Road  
Cuba City, Wisconsin**

**FIGURE  
A**