

November 11, 2019

PECFA #: 53807-9551-04  
BRRTs #:03-22-563937

Ms. Janet DiMaggio  
Wisconsin Department of Natural Resources  
3911 Fish Hatchery Road  
Madison, Wisconsin 53711

RE: Budget Request Groundwater Investigation - Rath Property  
1304 St. Rose Road  
Cuba City, Wisconsin 53807

Dear Ms. DiMaggio:

I am requesting budget for additional activities at the Richard Rath property in Cuba City, Wisconsin. We conducted a soil investigation. You approved a budget for the excavation of ~450 tons of contaminated soil from the site, which was recently conducted, although we were not able to remove as much contaminated soil as hoped due to the presence of utilities and the fragile foundation of the building. We plan to install three monitoring wells at the site to evaluate the impact of the petroleum release on groundwater quality. One of the wells will be installed in the source area along the south side of the building, another well will be installed between the source area and the water supply well. A third well will be installed to the north. The proposed well locations are shown on Figure 1.

We anticipate installing the monitoring wells to a depth of 80 feet since nearby water supply wells show groundwater is present at ~70 feet below grade. Drilling for the wells will extend through the soil and into the bedrock which is present at a depth of ~10 feet. No soil sampling is proposed during the well installation since the soil impacts were determined previously.

The budget request includes costs to install 3 monitoring wells to an estimated depth of 80 feet, survey the well network, conduct a well reconnaissance, test the hydraulic conductivity, dispose of investigative wastes, and perform 2 rounds of post-remedial monitoring. We have included the costs to collect groundwater samples from the three monitoring wells, the private well at the site, and the cost for one QA/QC sample per event. The analytical costs are for full VOCs from the monitoring wells and QA/QC for the first round and PVOC + naphthalene during the second round, the water supply well will be analyzed for VOCs both rounds. We will sample for PAHs from the monitoring wells (3 total) during the first round.

A site investigation report will be generated after the initial round of groundwater sampling has been conducted so we can discuss the need for any additional site work or possible closure. The costs for the completed Site Investigation report and a follow up letter report are included in the budget request.

We are requesting an additional \$35,739.28 to conduct the activities described above. The costs are included on the attached U&C standardized invoice. Please feel free to call Mark Fryman or me at 838-9120.

Sincerely,  
Seymour Environmental Services



Robyn Seymour  
Hydrogeologist

Enclosures: U&C Cost Table  
Figure

# Usual and Customary Standardized Invoice #26

## July 2019 - December 2019



RR-111a

PECFA #: 53807-9551-04  
 BRRTS #: 03-22-563937  
 Site Name: Rath Property  
 Site Address: 1304 St. Rose Rd., Cuba City

Vendor Name: Seymour  
 Invoice #: Cost Request  
 Invoice Date: 31-Oct-19  
 Check #: \_\_\_\_\_

U&C Total \$ 35,739.28  
 Variance to U&C Total \$ -  
 Grand Total \$ 35,739.28

TASK	TASK DESCRIPTION	SERVICES	ACTIVITY CODE	ACTIVITY REFERENCE CODE DESCRIPTION	UNIT	MAX UNIT COST	UNITS	TOTAL MAX
1	GW Sampling		GS05	Sample Collection	Well	\$ 74.62	8	\$ 596.96
1	GW Sampling		GS25	Primary Mob/Demob	Site	\$ 690.92	2	\$ 1,381.84
4	Waste Disposal	Consultant	WD05	Consultant Coordination	Site	\$ 141.24	3	\$ 423.72
4	Waste Disposal	Commodity	WD10	GW Sample and/or Purge	Drum	\$ 43.37	5	\$ 216.85
4	Waste Disposal	Commodity	WD15	Drill Cuttings	Drum	\$ 111.39	20	\$ 2,227.80
4	Waste Disposal	Commodity	WD25	Primary Mob/Demob	Site	\$ 316.47	4	\$ 1,265.88
6	Letter Report/Addendum		LRA05	Letter Report/Addendum	Letter	\$ 1,070.47	1	\$ 1,070.47
10	Initial Site Survey	Commodity	IS15	Initial Survey	Survey	\$ 1,206.85	1	\$ 1,206.85
11	Potable Well Field Reconnaissance		PWFR05	Potable Well Field Reconnaissance	Site	\$ 601.01	1	\$ 601.01
13.b	Drilling In Unconsolidated Soils - Without Soil And/Or GW Sampling	Consultant	DR25	Consultant Oversight	Ft	\$ 1.63	30	\$ 48.90
13.c	Drilling In Bedrock	Consultant	DR35	Consultant Oversight	Ft	\$ 6.39	210	\$ 1,341.90
13.c	Drilling In Bedrock	Consultant	DR40	Primary Mob/Demob	Site	\$ 652.34	1	\$ 652.34
13.e	Drilling In Unconsolidated Soils - Without Soil And/Or GW Sampling	Commodity	DR60	Drilling in Unconsolidated Soils	Ft	\$ 12.33	30	\$ 369.90
13.f	Drilling In Bedrock	Commodity	DR65	Drilling in Bedrock	Ft	\$ 34.18	210	\$ 7,177.80
13.f	Drilling In Bedrock	Commodity	DR70	Bedrock Drilling Setup Charge	Each	\$ 166.88	1	\$ 166.88
13.f	Drilling In Bedrock	Commodity	DR75	Air Compressor	Day	\$ 439.20	5	\$ 2,196.00
14	Monitoring Well Installation	Consultant	MWI05	0 - 25 ft bgs	Ft	\$ 4.01	75	\$ 300.75
14	Monitoring Well Installation	Consultant	MWI10	26 - 75 ft bgs	Ft	\$ 2.81	165	\$ 463.65
14	Monitoring Well Installation	Commodity	MWI15	2 inch PVC Casing	Ft	\$ 17.20	240	\$ 4,128.00
14	Monitoring Well Installation	Commodity	MWI20	Well Development	Well	\$ 152.06	3	\$ 456.18
14	Monitoring Well Installation	Commodity	MWI25	Mob/Demob (For development of grout or slurry sealed wells	Site	\$ 603.49	1	\$ 603.49

TASK	TASK DESCRIPTION	SERVICES	ACTIVITY CODE	ACTIVITY REFERENCE CODE DESCRIPTION	UNIT	MAX UNIT COST	UNITS	TOTAL MAX
15	Misc. Drilling Activities & Supplies		MDT05	Drill Rig Mob/Demob	Mob/Demob	\$ 1,059.72	1	\$ 1,059.72
15	Misc. Drilling Activities & Supplies		MDT10	Well Cover/flushmount	Each	\$ 208.73	3	\$ 626.19
15	Misc. Drilling Activities & Supplies		MDT21	Drum, 55 gal. DOT steel	Each	\$ 56.78	23	\$ 1,305.94
15	Misc. Drilling Activities & Supplies		MDT25	Commodity Service Provider Per Diem (drilling and direct push)	Person	\$ 209.38	8	\$ 1,675.04
15	Misc. Drilling Activities & Supplies		MDT45	Padlocks	Each	\$ 8.22	3	\$ 24.66
19	Hydraulic Conductivity Testing		HCT05	Hydraulic Conductivity Testing	Well	\$ 60.35	1	\$ 60.35
19	Hydraulic Conductivity Testing		HCT10	Primary Mob/Demob	Site	\$ 718.07	1	\$ 718.07
23	Soil And GW Investigation Report		SGIR05	Soil and GW Investigation Report	Report	\$ 5,114.31		\$ 1,683.46
31	Consultant Overnight Per Diem		COPD05	Overnight	Night	\$ 125.09	4	\$ 500.36
33	Schedule Of Laboratory Maximums	Commodity		Laboratory (see task 33 total on Lab Schedule)	Lab Schedule			\$ 795.09
36	Change Order Request		COR05	Change Order Request (cost cap exceedance requests)	Change Order	\$ 393.23	1	\$ 393.23
	Variance							
	Variance							

# Usual and Customary Standardized Invoice #26

## July 2019 - December 2019 (Interim)



RR-111a

**TOTAL LAB CHARGES #REF! TASK 33 13 ##### TASK 24 #REF! #REF!**

MATRIX	REF CODE	REIMBURSABLE ANALYTE	UNITS	MAX COST	SAMPLES	TOTAL	MAX COST	SAMPLES	TOTAL
WATER	W1	GRO/PVOC	SAMPLE	\$ 30.07		\$ -			
WATER	W2	PVOC	SAMPLE	\$ 27.80		\$ -			
WATER	W3	PVOC + 1,2 DCA	SAMPLE	\$ 45.10		\$ -			
WATER	W4	PVOC + Naphthalene	SAMPLE	\$ 31.26	4	\$ 125.04			
WATER	W5	VOC	SAMPLE	\$ 74.09	6	\$ 444.54			
WATER	W6	PAH	SAMPLE	\$ 75.17	3	\$ 225.51			
WATER	W21	EDB Method 504	SAMPLE	\$ 98.31		\$ -	MAX COST	SAMPLES	TOTAL
<b>TASK 33 TOTAL</b>						<b>\$ 795.09</b>			

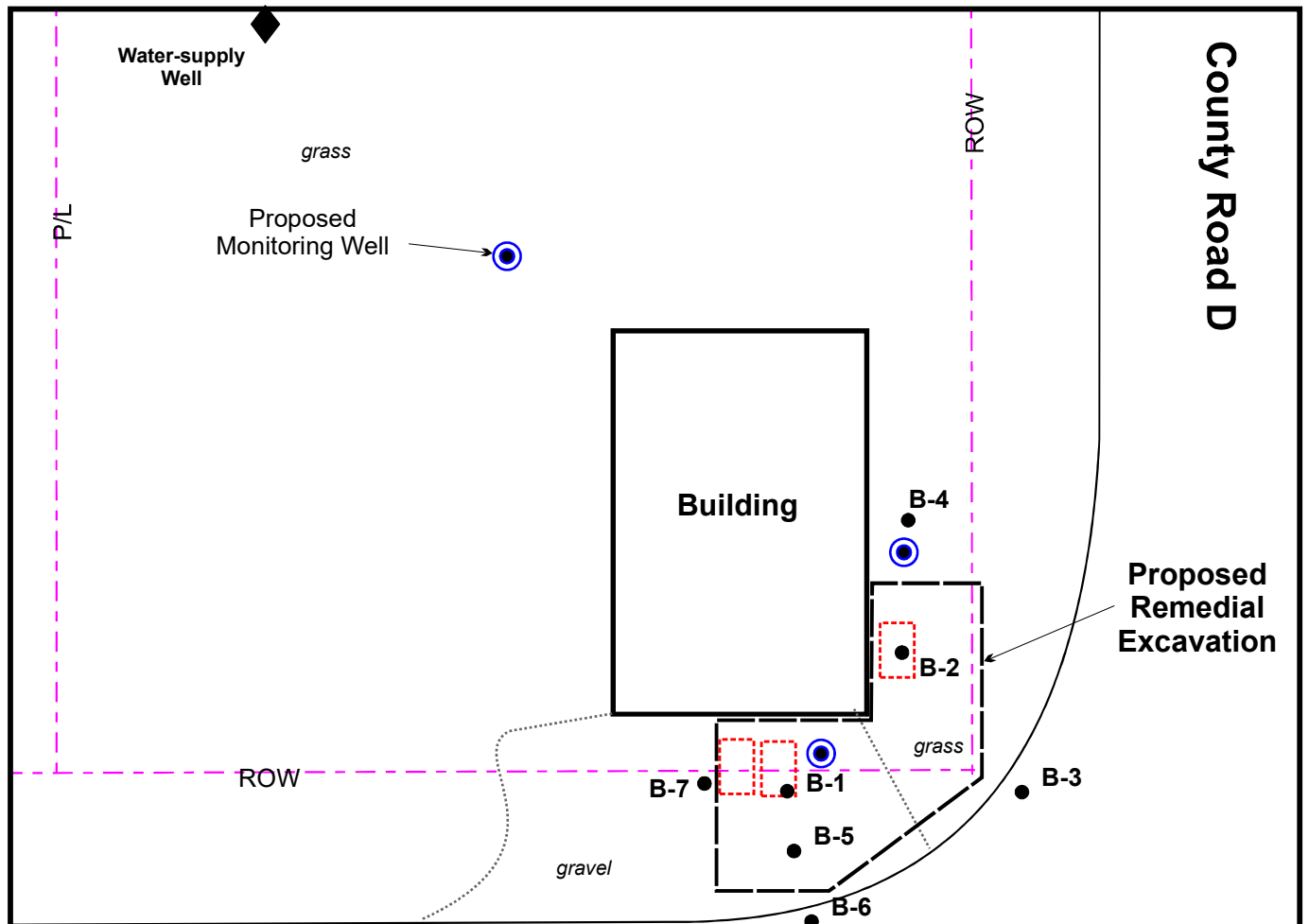

**Saint Rose Road**

**LEGEND**

- B-1** ● - Geoprobe Boring (June 2019)
- ◆ - Water Supply Well

N

0      20'      40'

1 INCH = 20 FEET  
SCALE IS APPROXIMATE

FILE/PATH: D:\PROJECTS\RATH\  
Layout-MWproposed.cdr  
DATE: 10/18/2019  
PREPARED: MDF      APPROVED:  
SOURCE:  
Grant County Public Mapping  
Field Measurements

**SEYMOUR  
ENVIRONMENTAL  
SERVICES, INC.**

**PROPOSED MONITORING WELL LOCATIONS  
RATH PROPERTY  
1304 Saint Rose Road  
Cuba City, Wisconsin**

**FIGURE**

**1**