



January 25, 2022

Steven Davis, Fire Chief
Fire Station 8
314 W. Dayton Street
Madison, WI 53703

Re: Results Notification
Former Day One Formal Wear
3939 Lien Road
Madison, Wisconsin
EnviroForensics, LLC Project #5040

Dear Mr. Davis:

EnviroForensics, LLC. (EnviroForensics) is providing the results of the environmental samples collected from your property located at 3945 Lien Road in Madison, Wisconsin.

Vapor intrusion sampling was performed on December 28 and 29, 2021. The sampling activities are part of an environmental investigation being performed for the former dry cleaners facility located at the adjacent property, 3939 Lien Road, at the direction of the WDNR pursuant to the authority granted to it under State and Federal law. The chemicals of concern for the investigation are the dry cleaning solvent tetrachloroethene (PCE) and its associated breakdown products.

Sampling Results

Two (2) indoor air samples, 5040-3945 Lien-IA-1 and 5040-3945 Lien-IA-2, and two (2) sub-slab vapor samples were collected from 5040-3945 Lien-SSV-1 and 5040-3945 Lien-SSV-2. There were no detections in any of the samples. The sampling locations are depicted on the attached **Figure 1**. Indoor air results and sub-slab vapor samples results are summarized and compared to WDNR standards in the attached **Table 1**.

Document: 5040-0385

January 25, 2022

EnviroForensics, LLC
N16 W23390 Stone Ridge Drive, Suite G
Waukesha, WI 53188
Phone: 262-290-4001 • Fax 317.972.7875



Currently, there does not appear to be a vapor intrusion risk to you building. EnviroForensics recommends another sampling event in February 2022 to confirm the non-detect sampling results. If you have any questions or concerns, please contact us at 414.630.0060.

Sincerely,
EnviroForensics, LLC

Rob Hoverman, LPG
Senior Project Manager
rhoverman@enviroforensics.com.

Attachments: Figure 1 – Site Map
Table 1 – Vapor Intrusion Assessment Results
Laboratory Analytical Reports

Copy: Trevor Bannister, Wisconsin Department of Natural Resources
Suzanne Hanson, MARC Inc.



IA-1	12/28/21
VOCs	ND
IA-2	12/28/21
VOCs	ND
SS-1	12/29/21
VOCs	ND
SS-2	12/29/21
VOCs	ND

SSV-1
IA-1

SSV-2
IA-2

Municipal
City of Madison
Fire Station #8
3945 Lien Rd

Legend

- Property boundary
- IA-1 Indoor air sample
- SS-3 Sub-slab sample

Analytes	Commercial Sub-Slab Vapor Screening Level	Residential Sub-Slab Vapor Screening Level
PCE	1,800	420
TCE	88	21

Notes:

- Bold concentrations exceed laboratory reporting limits
- Results reported in micrograms per meter cubed = $\mu\text{g}/\text{m}^3$
- The vapor risk screening levels for small commercial structures are calculated in accordance with the procedures described in WDNR Publication RR-800 and subsequent guidance
- The vapor risk screening levels for residential structures are calculated in accordance with the procedures described in WDNR Publication RR-800 and subsequent guidance
- The Vapor Risk Screening Levels are based on U.S. E.P.A.'s Regional Screening Levels (RSL's) for non-residential indoor air with an attenuation factor of 0.01 for soil gas below large commercial buildings
- PCE = Tetrachloroethene
- TCE = Trichloroethene
- VOCs = Volatile Organic Compounds
- ND = Not detected

VAPOR INTRUSION ASSESSMENT MAP

Former Day One Formal Wear
3939 Lien Road
Madison, Wisconsin

Date:	7/14/21
Designed:	EB
Drawn:	EB
Checked:	RH
DWG file:	5040-0393

825 North Capitol Avenue • Indianapolis, IN 46204
EnviroForensics.com

Figure	2
Project	5040

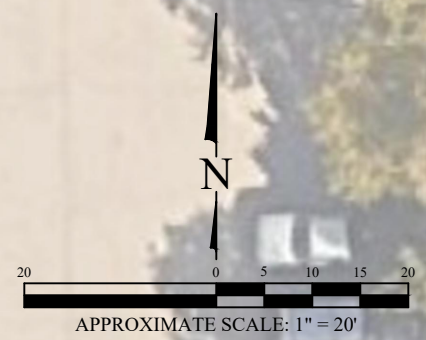

Table 1
 Vapor Intrusion Analytical Results
 MARC East (Former Day One Formal Wear)
 Madison, Wisconsin

Address	Sample Identification	Date Sampled	Tetrachloroethene	Trichloroethene	cis-1,2-Dichloroethene	trans-1,2-Dichloroethene	Vinyl Chloride
INDOOR/ OUTDOOR AIR							
Residential Vapor Action Limit²			42	2.1	NE	NE	1.7
Small Commercial Vapor Action Limit¹			180	8.8	NE	NE	28
3945 Lien Road	IA-1	12/28/21	<3.19	<1.07	<19.8	<39.6	<1.28
	IA-2	12/28/21	<3.19	<1.07	<19.8	<39.6	<1.28
SUB-SLAB VAPOR							
Residential Vapor Risk Screening Level²			1,400	70	NE	NE	57
Small Commercial Vapor Risk Screening Level			6,000	290	NE	NE	930
3945 Lien Road	SSV-1	12/29/21	<39.1	<10.7	<198	<396	<12.8
	SSV-2	12/29/21	<39.1	<10.7	<198	<396	<12.8

Notes:

¹ The vapor risk screening levels for small commercial structures are calculated in accordance with the procedures described in WDNR Publication RR-800 and subsequent guidance

² The vapor risk screening levels for residential structures are calculated in accordance with the procedures described in WDNR Publication RR-800 and subsequent guidance

Samples analyzed according to EPA Method TO-15

All concentrations reported in units in micrograms per cubic meter = µg/m³

Only detected compounds are listed

Bolded values are above method detection limits

Bolded and blue shaded values exceed the residential Vapor Risk Screening Level

Bolded and orange shaded values exceed the small commercial Vapor Risk Screening Level

NE = Not Established

IA = Indoor Air



EnvisionAir
1441 Sadler Circle West Drive
Indianapolis, IN 46239
Ph: 317-351-0885
Fax: 317-351-0882
www.envision-air.com

Mr. Rob Hoverman
Enviroforensics
N16 W. 23390 Stone Ridge Dr
Suite G
Waukesha, WI 53188

January 10, 2022

EnvisionAir Project Number: 2022-2
Client Project Name: 5040 Marc

Dear Mr. Hoverman,

Please find the attached analytical report for the samples received January 4, 2022. All test methods performed were fully compliant with local, state, and federal EPA methods unless otherwise noted. The project was analyzed as requested on the enclosed chain of custody record. Please review the comments section for additional information about your results or Quality Control data.

Feel free to contact me if you have any questions or comments regarding your analytical report or service.

Thank you for your business. EnvisionAir looks forward to working with you on your next project.

Yours Sincerely,

A handwritten signature in black ink that reads "David Norris". The signature is fluid and cursive.

David Norris
Project Manager
EnvisionAir, LLC



EnvisionAir
 1441 Sadlier Circle West Drive
 Indianapolis, IN 46239
 Ph: 317-351-0885
 Fax: 317-351-0882
 www.envision-air.com

Client Name: ENVIROFORENSICS
Project ID: 5040 MARC
Client Project Manager: ROB HOVERMAN
EnvisionAir Project Number: 2022-2

Sample Summary

Canister Pressure / Vacuum

<u>Laboratory Sample Number:</u>	<u>Sample Description:</u>	<u>Matrix:</u>	<u>START</u>	<u>START</u>	<u>End Date</u>	<u>End Time</u>	<u>Date</u>	<u>Time</u>	<u>Initial Field</u>	<u>Final Field</u>	<u>Lab</u>
			<u>Date</u>	<u>Time</u>							
22-7	5040-3945-LIEN-IA-1	A	12/28/21	8:30	12/28/21	16:20	1/4/22	11:50	-28	-6	-6
22-8	5040-3945-LIEN-IA-2	A	12/28/21	8:35	12/28/21	16:35	1/4/22	11:50	-28	-12	-12
22-9	5040-3945-LIEN-SSV -1	A	12/29/21	9:57	12/29/21	10:02	1/4/22	11:50	-30	-3	-3
22-10	5040-3945-LIEN-SSV -2	A	12/29/21	10:04	12/29/21	10:09	1/4/22	11:50	-29	-3	-3



EnvisionAir
1441 Sadler Circle West Drive
Indianapolis, IN 46239
Ph: 317-351-0885
Fax: 317-351-0882
www.envision-air.com

Client Name: ENVIROFORENSICS

Project ID: 5040 MARC

Client Project Manager: ROB HOVERMAN

EnvisionAir Project Number: 2022-2

Analytical Method: TO-15
Analytical Batch: 010522AIR

Client Sample ID: 5040-3945 LIEN-IA-1

Sample Collection START Date/Time: 12/28/21 8:30

Sample Collection END Date/Time: 12/28/21 16:20

Sample Received Date/Time: 1/4/22 11:50

EnvisionAir Sample Number: 22-7

Sample Matrix: AIR

<u>Compounds</u>	<u>Sample Results ug/m³</u>	<u>Reporting Limit ug/m³</u>	<u>Flag</u>
cis-1,2-Dichloroethene	< 19.8	19.8	
Tetrachloroethene	< 3.19	3.19	
trans-1,2-Dichloroethene	< 39.6	39.6	
Trichloroethene	< 1.07	1.07	
Vinyl Chloride	< 1.28	1.28	
4-bromofluorobenzene (surrogate)	117%		
Analysis Date/Time:	1-5-21/21:15		
Analyst Initials	tjg		



EnvisionAir
1441 Sadler Circle West Drive
Indianapolis, IN 46239
Ph: 317-351-0885
Fax: 317-351-0882
www.envision-air.com

Client Name: ENVIROFORENSICS

Project ID: 5040 MARC

Client Project Manager: ROB HOVERMAN

EnvisionAir Project Number: 2022-2

Analytical Method: TO-15
Analytical Batch: 010522AIR

Client Sample ID: 5040-3945 LIEN-IA-2

Sample Collection START Date/Time: 12/28/21 8:35

Sample Collection END Date/Time: 12/28/21 16:35

EnvisionAir Sample Number: 22-8

Sample Received Date/Time: 1/4/22 11:50

Sample Matrix: AIR

<u>Compounds</u>	<u>Sample Results ug/m³</u>	<u>Reporting Limit ug/m³</u>	<u>Flag</u>
cis-1,2-Dichloroethene	< 19.8	19.8	
Tetrachloroethene	< 3.19	3.19	
trans-1,2-Dichloroethene	< 39.6	39.6	
Trichloroethene	< 1.07	1.07	
Vinyl Chloride	< 1.28	1.28	
4-bromofluorobenzene (surrogate)	96%		
Analysis Date/Time:	1-5-21/15:56		
Analyst Initials	tjg		



EnvisionAir
 1441 Sadler Circle West Drive
 Indianapolis, IN 46239
 Ph: 317-351-0885
 Fax: 317-351-0882
 www.envision-air.com

Client Name: ENVIROFORENSICS

Project ID: 5040 MARC

Client Project Manager: ROB HOVERMAN

EnvisionAir Project Number: 2022-2

Analytical Method: TO-15
Analytical Batch: 010522AIR

Client Sample ID: 5040-3945 LIEN-SSV-1

Sample Collection START Date/Time: 12/29/21 9:57
Sample Collection END Date/Time: 12/29/21 10:02
Sample Received Date/Time: 1/4/22 11:50

EnvisionAir Sample Number: 22-9
Sample Matrix: AIR

<u>Compounds</u>	<u>Sample Results ug/m³</u>	<u>Reporting Limit ug/m³</u>	<u>Flag</u>
cis-1,2-Dichloroethene	< 198	198	
Tetrachloroethene	< 31.9	31.9	
trans-1,2-Dichloroethene	< 396	396	
Trichloroethene	< 10.7	10.7	
Vinyl Chloride	< 12.8	12.8	
4-bromofluorobenzene (surrogate)	101%		
Analysis Date/Time:	1-5-21/18:48		
Analyst Initials	tjg		



EnvisionAir
1441 Sadler Circle West Drive
Indianapolis, IN 46239
Ph: 317-351-0885
Fax: 317-351-0882
www.envision-air.com

Client Name: ENVIROFORENSICS

Project ID: 5040 MARC

Client Project Manager: ROB HOVERMAN

EnvisionAir Project Number: 2022-2

Analytical Method: TO-15
Analytical Batch: 010522AIR

Client Sample ID: 5040-3945 LIEN-SSV-2

Sample Collection START Date/Time: 12/29/21 10:04

Sample Collection END Date/Time: 12/29/21 10:09

EnvisionAir Sample Number: 22-10

Sample Received Date/Time: 1/4/22 11:50

Sample Matrix: AIR

<u>Compounds</u>	<u>Sample Results ug/m³</u>	<u>Reporting Limit ug/m³</u>	<u>Flag</u>
cis-1,2-Dichloroethene	< 198	198	
Tetrachloroethene	< 31.9	31.9	
trans-1,2-Dichloroethene	< 396	396	
Trichloroethene	< 10.7	10.7	
Vinyl Chloride	< 12.8	12.8	
4-bromofluorobenzene (surrogate)	95%		
Analysis Date/Time:	1-5-21/19:40		
Analyst Initials	tjg		

TO-15 Quality Control Data

EnvisionAir Batch Number: 010522AIR

<u>Method Blank (MB):</u>	<u>MB Results (ppbv)</u>	<u>Reporting Limit (ppbv)</u>	<u>Flags</u>
cis-1,2-Dichloroethene	< 5	5	
Tetrachloroethene	< 0.47	0.47	
trans-1,2-Dichloroethene	< 10	10	
Trichloroethene	< 0.2	0.2	
Vinyl Chloride	< 0.5	0.5	
4-bromofluorobenzene (surrogate)	98%		
Analysis Date/Time:	1-5-21/12:22		
Analyst Initials	tjg		

<u>LCS/LCSD</u>	<u>LCS Results (ppbv)</u>	<u>LCSD Results (ppbv)</u>	<u>LCS/D Conc(ppbv)</u>	<u>LCS Rec.</u>	<u>LCSD Rec.</u>	<u>RPD</u>	<u>Flag</u>
Vinyl Chloride	9.98	10.8	10	100%	108%	7.9%	
trans-1,2-Dichloroethene	9.47	9.72	10	95%	97%	2.6%	
cis-1,2-Dichloroethene	10	10.1	10	100%	101%	1.0%	
Trichloroethene	10.1	9.57	10	101%	96%	5.4%	
Tetrachloroethene	9.75	9.67	10	98%	97%	0.8%	
4-bromofluorobenzene (surrogate)	100%	101%					
Analysis Date/Time:	1-5-21/09:30	1-5-21/10:57					
Analyst Initials	tjg	tjg					



EnvisionAir
1441 Sadlier Circle West Drive
Indianapolis, IN 46239
Ph: 317-351-0885
Fax: 317-351-0882
www.envision-air.com

Flag Number

Comments

CHAIN OF CUSTODY RECORD

EnvisionAir | 1441 Sadler Circle West Drive | Indianapolis, IN 46239 | Phone: (317) 351-0885 | Fax: (317) 351-0882

REQUESTED PARAMETERS

TO-15 Full List
TO-15 Short List (Specify in notes)

Sampling Type:
Soil-Gas:
Sub-Slab:
Indoor-Air:

www.envision-air.com

Canister Pressure / Vacuum



Air Sample ID	Media Type (see code above)	Coll. Date (Grab/Comp Start)	Coll. Time (Grab/Comp Start)	Coll. Date (Comp. End)	Coll. Time (Comp. End)	Canister Serial #	Flow Controller Serial #	Initial Field (in. Hg)	Final Field (in. Hg)	Lab Received (in. Hg)	EnvisionAir Sample Number
5040-3945 UENV-1A-1	LC	12/29/21	0830	12/29/21	1030	14059	7435	-28	-6	-6	22-7
5040-3945 UENV-1A-2	V	1	0835	1	1035	11073	4656	-28	-12	-12	22-8
5040-3945 UENV-55V-1	LC	12/29/21	0857	12/29/21	1002	519	0003	-30	-3	-3	22-9
5040-3945 UENV-55V-2	V	1	1004	1	1009	2541	0006	-29	-3	-3	22-10

Comments: START LIST PCE, TCE, CDCE, & DCE & VC

Relinquished by:	Date:	Time:	Received by:	Date:	Time:
<i>[Signature]</i>	12/29/21	0930	<i>[Signature]</i>	14-22	11:50



January 25, 2022

Aldi Inc.
3925 Lien Road
Madison, WI 53704

Re: Results Notification
EnviroForensics, LLC Project #5040

Dear Property Owner:

EnviroForensics, LLC. (EnviroForensics) is providing the results of the environmental samples collected from your property located at 3925 Lien Road in Madison, Wisconsin. Vapor intrusion sampling was performed on December 28 and 29, 2021. The sampling activities are part of an environmental investigation being performed for the former dry cleaners facility located at the adjacent property, 3939 Lien Road, at the direction of the WDNR pursuant to the authority granted to it under State and Federal law. The chemicals of concern for the investigation are the dry cleaning solvent tetrachloroethene (PCE) and its associated breakdown products.

Sampling Results

Three (3) indoor air samples, 5040-3925 Lien-IA-1, 5040-3925 Lien-IA-2 and 5040-3925 Lien-IA-3, and three (3) sub-slab vapor samples were also collected from 5040-3925 Lien-SSV-1, 5040-3925 Lien-SSV-2 and 5040-3925 Lien-SSV-3. There were no detections in any of the samples. The sampling locations are depicted on the attached **Figure 1**. Indoor air results and sub-slab vapor samples results are summarized and compared to WDNR standards in the attached **Table 1**.

Document: 5040-0384

January 25, 2022

EnviroForensics, LLC
N16 W23390 Stone Ridge Drive, Suite G
Waukesha, WI 53188
Phone: 262-290-4001 • Fax 317.972.7875



Currently, there does not appear to be a vapor intrusion risk to you building. EnviroForensics recommends another sampling event in February 2022 to confirm the non-detect sampling results. If you have any questions or concerns, please contact us at 262-510-0612.

Sincerely,
EnviroForensics, LLC

Rob Hoverman, LPG
Senior Project Manager
rhoverman@enviroforensics.com.

Attachments: Figure 1 – Site Map
Table 1 – Vapor Intrusion Assessment Results Summary
Laboratory Analytical Reports

Copy: Trevor Bannister, Wisconsin Department of Natural Resources
Suzanne Hanson, MARC Inc.



IA-1	12/28/21
VOCs	ND
IA-2	12/28/21
VOCs	ND
IA-3	12/28/21
VOCs	ND
SS-1	12/29/21
VOCs	ND
SS-2	12/29/21
VOCs	ND
SS-3	12/29/21
VOCs	ND

Legend

---	Property boundary
IA-1 ▲	Indoor air sample
SS-3 ●	Sub-slab sample

Analytes	Commercial Sub-Slab Vapor Screening Level	Residential Sub-Slab Vapor Screening Level
PCE	1,800	420
TCE	88	21

- Notes:
1. Bold concentrations exceed laboratory reporting limits
 2. Results reported in micrograms per meter cubed = $\mu\text{g}/\text{m}^3$
 3. The vapor risk screening levels for small commercial structures are calculated in accordance with the procedures described in WDNR Publication RR-800 and subsequent guidance
 4. The vapor risk screening levels for residential structures are calculated in accordance with the procedures described in WDNR Publication RR-800 and subsequent guidance
 5. The Vapor Risk Screening Levels are based on U.S. E.P.A.'s Regional Screening Levels (RSL's) for non-residential indoor air with an attenuation factor of 0.01 for soil gas below large commercial buildings
 6. PCE = Tetrachloroethene
 7. TCE = Trichloroethene
 8. VOCs = Volatile Organic Compounds
 9. ND = Not detected

VAPOR INTRUSION ASSESSMENT MAP
 ALDI 3925 LIEN ROAD
 Former Day One Formal Wear
 3939 Lien Road
 Madison, Wisconsin

Date:	1/17/22
Designed:	EB
Drawn:	EB
Checked:	RH
DWG file:	5040-0394

825 North Capitol Avenue • Indianapolis, IN 46204
 EnviroForensics.com

Figure	1
Project	5040

APPROXIMATE SCALE: 1" = 20'

Table 1
Vapor Intrusion Analytical Results
MARC East (Former Day One Formal Wear)
Madison, Wisconsin

Address	Sample Identification	Date Sampled	Tetrachloroethene	Trichloroethene	cis-1,2-Dichloroethene	trans-1,2-Dichloroethene	Vinyl Chloride
INDOOR/ OUTDOOR AIR							
Residential Vapor Action Limit²			42	2.1	NE	NE	1.7
Small Commercial Vapor Action Limit¹			180	8.8	NE	NE	28
3925 Lien Road	IA-1	12/28/21	<3.19	<1.07	<19.8	<39.6	<1.28
	IA-2	12/28/21	<3.19	<1.07	<19.8	<39.6	<1.28
	IA-3	12/28/21	<3.19	<1.07	<19.8	<39.6	<1.28
SUB-SLAB VAPOR							
Residential Vapor Risk Screening Level²			1,400	70	NE	NE	57
Small Commercial Vapor Risk Screening Level			6,000	290	NE	NE	930
3925 Lien Road	SSV-1	12/29/21	<39.1	<10.7	<198	<396	<12.8
	SSV-2	12/29/21	<39.1	<10.7	<198	<396	<12.8
	SSV-3	12/29/21	<39.1	<10.7	<198	<396	<12.8

Notes:

¹ The vapor risk screening levels for small commercial structures are calculated in accordance with the procedures described in WDNR Publication RR-800 and subsequent guidance

² The vapor risk screening levels for residential structures are calculated in accordance with the procedures described in WDNR Publication RR-800 and subsequent guidance

Samples analyzed according to EPA Method TO-15

All concentrations reported in units in micrograms per cubic meter = µg/m³

Only detected compounds are listed

Bolded values are above method detection limits

Bolded and blue shaded values exceed the residential Vapor Risk Screening Level

Bolded and orange shaded values exceed the small commercial Vapor Risk Screening Level

NE = Not Established

IA = Indoor Air



EnvisionAir
1441 Sadler Circle West Drive
Indianapolis, IN 46239
Ph: 317-351-0885
Fax: 317-351-0882
www.envision-air.com

Mr. Rob Hoverman
Enviroforensics
N16 W. 23390 Stone Ridge Dr
Suite G
Waukesha, WI 53188

January 10, 2022

EnvisionAir Project Number: 2022-1
Client Project Name: 5040 Marc

Dear Mr. Hoverman,

Please find the attached analytical report for the samples received January 4, 2022. All test methods performed were fully compliant with local, state, and federal EPA methods unless otherwise noted. The project was analyzed as requested on the enclosed chain of custody record. Please review the comments section for additional information about your results or Quality Control data.

Feel free to contact me if you have any questions or comments regarding your analytical report or service.

Thank you for your business. EnvisionAir looks forward to working with you on your next project.

Yours Sincerely,

A handwritten signature in black ink that reads "David Norris". The signature is written in a cursive, flowing style.

David Norris
Project Manager
EnvisionAir, LLC



EnvisionAir
 1441 Sadler Circle West Drive
 Indianapolis, IN 46239
 Ph: 317-351-0885
 Fax: 317-351-0882
 www.envision-air.com

Client Name: ENVIROFORENSICS
Project ID: 5040 MARC
Client Project Manager: ROB HOVERMAN
EnvisionAir Project Number: 2022-1

Sample Summary

Canister Pressure / Vacuum

<u>Laboratory Sample Number:</u>	<u>Sample Description:</u>	<u>Matrix:</u>	<u>START</u>		<u>START</u>		<u>END</u>		<u>END</u>		<u>Lab</u>	
			<u>Date</u>	<u>Time</u>	<u>Date</u>	<u>Time</u>	<u>Date</u>	<u>Time</u>	<u>Initial Field</u>	<u>Final Field</u>	<u>Received</u>	
			<u>Collected:</u>	<u>Collected:</u>	<u>Collected:</u>	<u>Collected:</u>	<u>Received:</u>	<u>Received:</u>	<u>(in. Hg)</u>	<u>(in. Hg)</u>	<u>(in. Hg)</u>	
22-1	5040-3925 LIEN-IA-1	A	12/28/21	7:05	12/28/21	14:58	1/4/22	11:50	-28	-6	-6	
22-2	5040-3925 LIEN-IA-2	A	12/28/21	7:12	12/28/21	15:07	1/4/22	11:50	-30	-7	-7	
22-3	5040-3925 LIEN-IA-3	A	12/28/21	7:16	12/28/21	14:48	1/4/22	11:50	-27	-4	-4	
22-4	5040-3925 LIEN-SSV-1	A	12/29/21	8:30	12/29/21	8:35	1/4/22	11:50	-30	-4	-4	
22-5	5040-3925 LIEN-SSV-2	A	12/29/21	8:39	12/29/21	8:44	1/4/22	11:50	-28	-4	-4	
22-6	5040-3925 LIEN-SSV-3	A	12/29/21	8:46	12/29/21	8:52	1/4/22	11:50	-28	-5	-5	



EnvisionAir
1441 Sadler Circle West Drive
Indianapolis, IN 46239
Ph: 317-351-0885
Fax: 317-351-0882
www.envision-air.com

Client Name: ENVIROFORENSICS

Project ID: 5040 MARC

Client Project Manager: ROB HOVERMAN

EnvisionAir Project Number: 2022-1

Analytical Method: TO-15
Analytical Batch: 010522AIR

Client Sample ID: 5040-3925 LIEN-IA-1

Sample Collection START Date/Time: 12/28/21 7:05
Sample Collection END Date/Time: 12/28/21 14:28
Sample Received Date/Time: 1/4/22 11:50

EnvisionAir Sample Number: 22-1
Sample Matrix: AIR

<u>Compounds</u>	<u>Sample Results ug/m³</u>	<u>Reporting Limit ug/m³</u>	<u>Flag</u>
cis-1,2-Dichloroethene	< 19.8	19.8	
Tetrachloroethene	< 3.19	3.19	
trans-1,2-Dichloroethene	< 39.6	39.6	
Trichloroethene	< 1.07	1.07	
Vinyl Chloride	< 1.28	1.28	
4-bromofluorobenzene (surrogate)	92%		
Analysis Date/Time:	1-5-21/13:04		
Analyst Initials	tjg		



EnvisionAir
1441 Sadler Circle West Drive
Indianapolis, IN 46239
Ph: 317-351-0885
Fax: 317-351-0882
www.envision-air.com

Client Name: ENVIROFORENSICS

Project ID: 5040 MARC

Client Project Manager: ROB HOVERMAN

EnvisionAir Project Number: 2022-1

Analytical Method: TO-15
Analytical Batch: 010522AIR

Client Sample ID: 5040-3925 LIEN-IA-2

EnvisionAir Sample Number: 22-2
Sample Matrix: AIR

Sample Collection START Date/Time: 12/28/21 7:12
Sample Collection END Date/Time: 12/28/21 15:07
Sample Received Date/Time: 1/4/22 11:50

<u>Compounds</u>	<u>Sample Results ug/m³</u>	<u>Reporting Limit ug/m³</u>	<u>Flag</u>
cis-1,2-Dichloroethene	< 19.8	19.8	
Tetrachloroethene	< 3.19	3.19	
trans-1,2-Dichloroethene	< 39.6	39.6	
Trichloroethene	< 1.07	1.07	
Vinyl Chloride	< 1.28	1.28	
4-bromofluorobenzene (surrogate)	103%		
Analysis Date/Time:	1-5-21/13:49		
Analyst Initials	tjg		



EnvisionAir
 1441 Sadlier Circle West Drive
 Indianapolis, IN 46239
 Ph: 317-351-0885
 Fax: 317-351-0882
 www.envision-air.com

Client Name: ENVIROFORENSICS

Project ID: 5040 MARC

Client Project Manager: ROB HOVERMAN

EnvisionAir Project Number: 2022-1

Analytical Method: TO-15
Analytical Batch: 010522AIR

Client Sample ID: 5040-3925 LIEN-IA-3

Sample Collection START Date/Time: 12/28/21 7:16
Sample Collection END Date/Time: 12/28/21 14:48
Sample Received Date/Time: 1/4/22 11:50

EnvisionAir Sample Number: 22-3
Sample Matrix: AIR

<u>Compounds</u>	<u>Sample Results ug/m³</u>	<u>Reporting Limit ug/m³</u>	<u>Flag</u>
cis-1,2-Dichloroethene	< 19.8	19.8	
Tetrachloroethene	< 3.19	3.19	
trans-1,2-Dichloroethene	< 39.6	39.6	
Trichloroethene	< 1.07	1.07	
Vinyl Chloride	< 1.28	1.28	
4-bromofluorobenzene (surrogate)	99%		
Analysis Date/Time:	1-5-21/14:31		
Analyst Initials	tjg		



EnvisionAir
1441 Sadler Circle West Drive
Indianapolis, IN 46239
Ph: 317-351-0885
Fax: 317-351-0882
www.envision-air.com

Client Name: ENVIROFORENSICS

Project ID: 5040 MARC

Client Project Manager: ROB HOVERMAN

EnvisionAir Project Number: 2022-1

Analytical Method: TO-15
Analytical Batch: 010522AIR

Client Sample ID: 5040-3925 LIEN-SSV-1

Sample Collection START Date/Time: 12/29/21 8:30

Sample Collection END Date/Time: 12/29/21 8:35

EnvisionAir Sample Number: 22-4

Sample Received Date/Time: 1/4/22 11:50

Sample Matrix: AIR

<u>Compounds</u>	<u>Sample Results ug/m³</u>	<u>Reporting Limit ug/m³</u>	<u>Flag</u>
cis-1,2-Dichloroethene	< 198	198	
Tetrachloroethene	< 31.9	31.9	
trans-1,2-Dichloroethene	< 396	396	
Trichloroethene	< 10.7	10.7	
Vinyl Chloride	< 12.8	12.8	
4-bromofluorobenzene (surrogate)	97%		
Analysis Date/Time:	1-5-21/16:39		
Analyst Initials	tjg		



EnvisionAir
 1441 Sadler Circle West Drive
 Indianapolis, IN 46239
 Ph: 317-351-0885
 Fax: 317-351-0882
 www.envision-air.com

Client Name: ENVIROFORENSICS

Project ID: 5040 MARC

Client Project Manager: ROB HOVERMAN

EnvisionAir Project Number: 2022-1

Analytical Method: TO-15
Analytical Batch: 010522AIR

Client Sample ID: 5040-3925 LIEN-SSV-2

Sample Collection START Date/Time: 12/29/21 8:39
Sample Collection END Date/Time: 12/29/21 8:44
Sample Received Date/Time: 1/4/22 11:50

EnvisionAir Sample Number: 22-5
Sample Matrix: AIR

<u>Compounds</u>	<u>Sample Results ug/m³</u>	<u>Reporting Limit ug/m³</u>	<u>Flag</u>
cis-1,2-Dichloroethene	< 198	198	
Tetrachloroethene	< 31.9	31.9	
trans-1,2-Dichloroethene	< 396	396	
Trichloroethene	< 10.7	10.7	
Vinyl Chloride	< 12.8	12.8	
4-bromofluorobenzene (surrogate)	98%		
Analysis Date/Time:	1-5-21/17:22		
Analyst Initials	tjg		



EnvisionAir
1441 Sadler Circle West Drive
Indianapolis, IN 46239
Ph: 317-351-0885
Fax: 317-351-0882
www.envision-air.com

Client Name: ENVIROFORENSICS

Project ID: 5040 MARC

Client Project Manager: ROB HOVERMAN

EnvisionAir Project Number: 2022-1

Analytical Method: TO-15
Analytical Batch: 010522AIR

Client Sample ID: 5040-3925 LIEN-SSV-3

Sample Collection START Date/Time: 12/29/21 8:46

Sample Collection END Date/Time: 12/29/21 8:52

EnvisionAir Sample Number: 22-6

Sample Received Date/Time: 1/4/22 11:50

Sample Matrix: AIR

<u>Compounds</u>	<u>Sample Results ug/m³</u>	<u>Reporting Limit ug/m³</u>	<u>Flag</u>
cis-1,2-Dichloroethene	< 198	198	
Tetrachloroethene	< 31.9	31.9	
trans-1,2-Dichloroethene	< 396	396	
Trichloroethene	< 10.7	10.7	
Vinyl Chloride	< 12.8	12.8	
4-bromofluorobenzene (surrogate)	105%		
Analysis Date/Time:	1-5-21/18:05		
Analyst Initials	tjg		

TO-15 Quality Control Data

EnvisionAir Batch Number: 010522AIR

<u>Method Blank (MB):</u>	<u>MB Results (ppbv)</u>	<u>Reporting Limit (ppbv)</u>	<u>Flags</u>
cis-1,2-Dichloroethene	< 5	5	
Tetrachloroethene	< 0.47	0.47	
trans-1,2-Dichloroethene	< 10	10	
Trichloroethene	< 0.2	0.2	
Vinyl Chloride	< 0.5	0.5	
4-bromofluorobenzene (surrogate)	98%		
Analysis Date/Time:	1-5-21/12:22		
Analyst Initials	tjg		

<u>LCS/LCSD</u>	<u>LCS Results (ppbv)</u>	<u>LCSD Results (ppbv)</u>	<u>LCS/D Conc(ppbv)</u>	<u>LCS Rec.</u>	<u>LCSD Rec.</u>	<u>RPD</u>	<u>Flag</u>
Vinyl Chloride	9.98	10.8	10	100%	108%	7.9%	
trans-1,2-Dichloroethene	9.47	9.72	10	95%	97%	2.6%	
cis-1,2-Dichloroethene	10	10.1	10	100%	101%	1.0%	
Trichloroethene	10.1	9.57	10	101%	96%	5.4%	
Tetrachloroethene	9.75	9.67	10	98%	97%	0.8%	
4-bromofluorobenzene (surrogate)	100%	101%					
Analysis Date/Time:	1-5-21/09:30	1-5-21/10:57					
Analyst Initials	tjg	tjg					



EnvisionAir
1441 Sadler Circle West Drive
Indianapolis, IN 46239
Ph: 317-351-0885
Fax: 317-351-0882
www.envision-air.com

Flag Number

Comments

CHAIN OF CUSTODY RECORD

EnvisionAir | 1441 Saddle Circle West Drive | Indianapolis, IN 46239 | Phone: (317) 351-0885 | Fax: (317) 351-0882

REQUESTED PARAMETERS

Client: EUROFORREST P.O. Number: 2021-0789
 Report: 116W03390 Same Road Project Name or Number: 5040 MAR
 Address: WILKES HA, WI
 Report To: R. Hovsrum Sampled by: R. Hovsrum
 Phone: 714.630.0060 QA/QC Required: (circle if applicable)
 Invoice Address: Level III Level IV
 Reporting Units needed: (circle)
 ug/m³ mg/m³ PPBV PPMV
 Desired TAT: (Please Circle One) Media type: 11C = 1 Liter Canister
 1 day 2 days 3 days Std (5 bus. days) 6LC = 6 Liter Canister
 TB = Tedlar Bag
 TD = Thermal Description Tube

TO-15 Fall List
 TO-15 Short List (Specify in notes)



Sampling Type:
 Soil-Gas:
 Sub-Slab:
 Indoor-Air:

www.envision-air.com

Canister Pressure / Vacuum

Air Sample ID	Media Type (see code above)	Coll. Date (Start/Comp)	Coll. Time (Start/Comp)	Coll. Date (Comp, End)	Coll. Time (Comp, End)		Canister Serial #	Flow Controller Serial #	Initial Field (in. Hg)	Final Field (in. Hg)	Lab Received (in. Hg)	EnvisionAir Sample Number
5040-3925 L1E1-14-1	6LC	12/28/21	705	12/28/21	1458	X	16060	5844	-28	-6	.6	22-1
5040-3925 L1E1-14-2			712		1507		3116	2222	-30	-7	.7	22-2
5040-3925 L1E1-14-3			716		1448		11083	4649	-27	-4	.4	22-3
5040-3925 L1E1-35V-1	1LC	12/29/21	0830 PM	12/29/21	0535		2235	022	-30	-4	.4	22-4
5040-3925 L1E1-35V-2			0839		0844		521	051	-28	-4	.4	22-5
5040-3925 L1E1-35V-3			0846		0852		53944	029	-28	-5	.5	22-6

Comments: SHAFT LIST PCE, TCE, DCE, tDCE, & VC

Relinquished by:	Date	Time	Received by:	Date	Time
<u>[Signature]</u>	12/30/21	930	<u>[Signature]</u>	1-4-22	11:30



January 25, 2022

Jacob Castillo
901 Post Road
Madison, WI 53713

Re: Results Notification
Former Day One Formal Wear
3939 Lien Road
Madison, Wisconsin
EnviroForensics, LLC Project #5040

Dear Mr. Castillo:

EnviroForensics, LLC. (EnviroForensics) is providing the results of the environmental samples collected from your property located at 3939 Lien Road in Madison, Wisconsin (Site). A soil vapor extraction (SVE) system operated at Site from April 13, 2018 until August 7, 2020. The SVE system was shut down because extraction rates were low enough it was not cost effective to operate and the concentrations were well below vapor risk screening criteria. Vapor intrusion sampling was performed on December 28, 2021.

Sampling Results

Two indoor air samples were collected, 5040-3939 Lien-IA-1 and 5040-3939 Lien-IA-2, two (2) sub-slab vapor samples were also collected from 5040-3939 Lien-SS-3 and 5040-3939 Lien-SS-5. There were no detections in any of the samples. The sampling locations are depicted on the attached **Figure 1**. Current and past indoor air and sub-slab vapor samples results are summarized and compared to WDNR standards in the attached **Table 1**.

Document: 5040-0229

January 25, 2022

EnviroForensics, LLC
N16 W23390 Stone Ridge Drive, Suite G
Waukesha, WI 53188
Phone: 262-290-4001 • Fax 317.972.7875



The two (2) previous rounds with the current sample results indicate there is no longer a vapor intrusion risk to your building. EnviroForensics does not recommend further sampling. If you have any questions or concerns, please contact us at 414.630.0060.

Sincerely,
EnviroForensics, LLC

Rob Hoverman, LPG
Senior Project Manager
rhoverman@enviroforensics.com.

Attachments: Figure 1 – Vapor Intrusion Sample Locations
Table 1 – Vapor Intrusion Assessment Results Summary
Laboratory Analytical Reports

Copy: Trevor Bannister, Wisconsin Department of Natural Resources
Suzanne Hanson, MARC Inc.

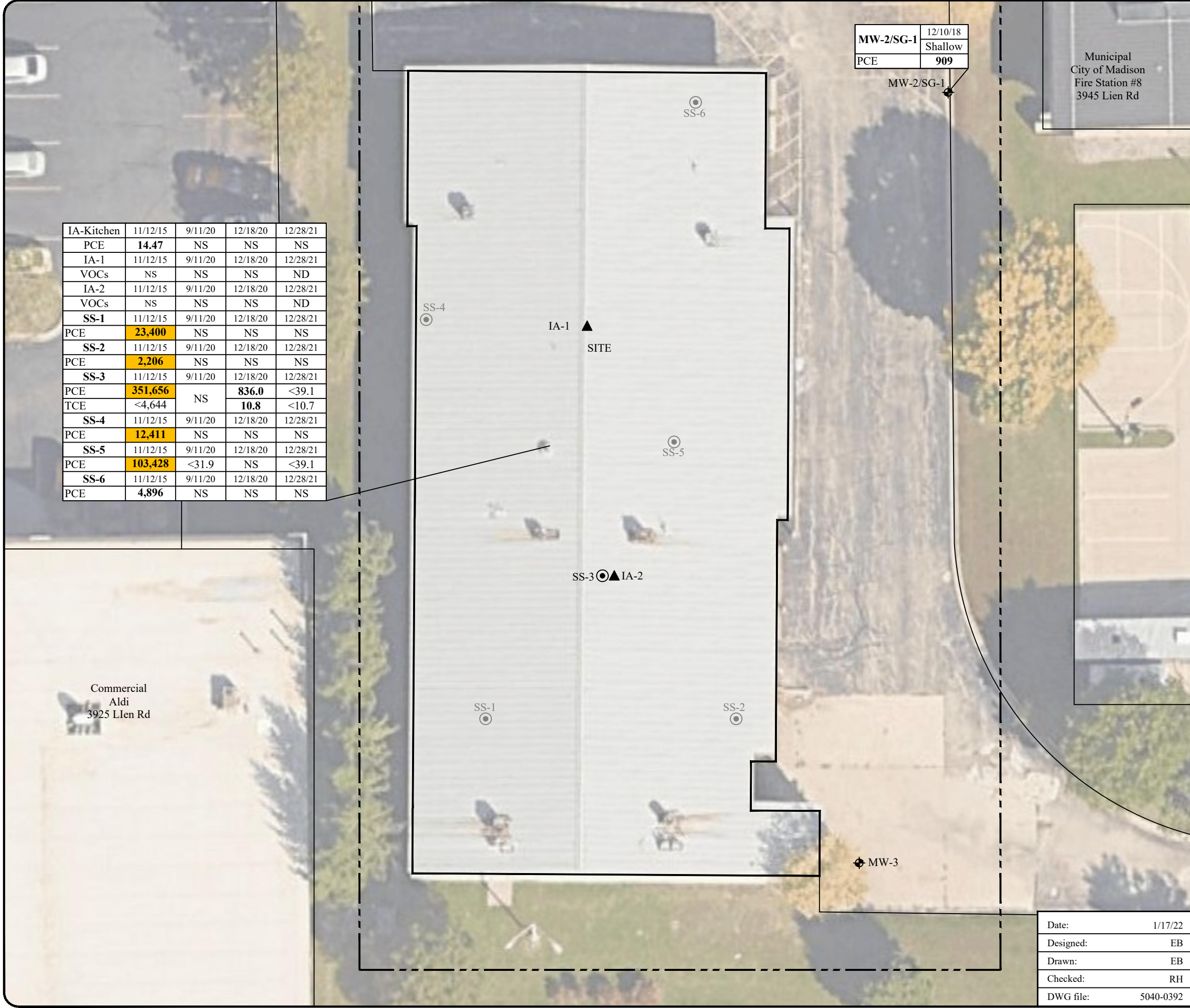

MW-2/SG-1	12/10/18
	Shallow
PCE	909

Municipal
City of Madison
Fire Station #8
3945 Lien Rd

Legend

- Property boundary
- MW-1 Monitoring well
- IA-1 Indoor air sample
- SS-1 Sub-slab sample (By Others)
- SS-3 Sub-slab sample

Analytes	Commercial Sub-Slab Vapor Screening Level	Residential Sub-Slab Vapor Screening Level	Analytes	Commercial Soil Gas Screening Level
PCE	1,800	420	PCE	1,800
TCE	88	21		

IA-Kitchen	11/12/15	9/11/20	12/18/20	12/28/21
PCE	14.47	NS	NS	NS
IA-1	11/12/15	9/11/20	12/18/20	12/28/21
VOCs	NS	NS	NS	ND
IA-2	11/12/15	9/11/20	12/18/20	12/28/21
VOCs	NS	NS	NS	ND
SS-1	11/12/15	9/11/20	12/18/20	12/28/21
PCE	23,400	NS	NS	NS
SS-2	11/12/15	9/11/20	12/18/20	12/28/21
PCE	2,206	NS	NS	NS
SS-3	11/12/15	9/11/20	12/18/20	12/28/21
PCE	351,656	NS	836.0	<39.1
TCE	<4,644	NS	10.8	<10.7
SS-4	11/12/15	9/11/20	12/18/20	12/28/21
PCE	12,411	NS	NS	NS
SS-5	11/12/15	9/11/20	12/18/20	12/28/21
PCE	103,428	<31.9	NS	<39.1
SS-6	11/12/15	9/11/20	12/18/20	12/28/21
PCE	4,896	NS	NS	NS

- Notes:
- Bold, orange shaded concentrations exceed the applicable commercial screening level
 - Bold concentrations exceed laboratory reporting limits
 - Results reported in micrograms per meter cubed = $\mu\text{g}/\text{m}^3$
 - The vapor risk screening levels for small commercial structures are calculated in accordance with the procedures described in WDNR Publication RR-800 and subsequent guidance
 - The vapor risk screening levels for residential structures are calculated in accordance with the procedures described in WDNR Publication RR-800 and subsequent guidance
 - The Vapor Risk Screening Levels are based on U.S. E.P.A.'s Regional Screening Levels (RSL's) for non-residential indoor air with an attenuation factor of 0.01 for soil gas below large commercial buildings
 - PCE = Tetrachloroethene
 - TCE = Trichloroethene
 - VOCs = Volatile Organic Compounds
 - ND = Not detected
 - NS = Not sampled

Commercial
Aldi
3925 Lien Rd

VAPOR INTRUSION ASSESSMENT MAP

Former Day One Formal Wear
3939 Lien Road
Madison, Wisconsin

Date:	1/17/22
Designed:	EB
Drawn:	EB
Checked:	RH
DWG file:	5040-0392



825 North Capitol Avenue • Indianapolis, IN 46204
EnviroForensics.com

Figure	1
Project	5040

Table 1
Vapor Intrusion Sample Results
MARC East (Former Day One Formal Wear)
Madison, Wisconsin

Address	Sample Identification	Date Sampled	Tetrachloroethene	Trichloroethene	cis-1,2-Dichloroethene	trans-1,2-Dichloroethene	Vinyl Chloride
INDOOR/ OUTDOOR AIR							
Residential Vapor Action Limit²			42	2.1	NE	NE	1.7
Small Commercial Vapor Action Limit¹			180	8.8	NE	NE	28
3939 Lien Road	Indoor - Kitchen	11/12/15	14.47	<0.464	<0.342	<0.342	<0.220
	Outdoor	11/12/15	<0.586	<0.464	<0.342	<0.342	<0.220
	IA-1	12/28/21	<3.19	<1.07	<19.8	<39.6	<1.28
	IA-2	12/28/21	<3.19	<1.07	<19.8	<39.6	<1.28
SUB-SLAB VAPOR							
Residential Vapor Risk Screening Level²			1,400	70	NE	NE	57
Small Commercial Vapor Risk Screening Level			6,000	290	NE	NE	930
3939 Lien Road	SS-1	11/12/15	23,444	<464.4	<34.26	<342.65	<220.88
	SS-2	11/12/15	2,206	<23.49	<17.33	<17.33	<11.17
	SS-3	11/12/15	351,656	<4,644	<3,426	<3,426	<2,208
		12/18/20	836.0	10.8	<19.8	<39.6	<1.28
	SS-4	12/28/21	<39.1	<10.7	<198	<396	<12.8
		11/12/15	12,411	<2,349	<1,733	<1,733	<1,117
	SS-5	11/12/15	103,428	<2,349	<1,733	<1,733	<1,117
		09/11/20	<31.9	<10.7	<198	<396	<12.8
SS-6	12/28/21	<39.1	<10.7	<198	<396	<12.8	
SS-6	11/12/15	4,896	<23.49	<17.33	<17.33	<11.17	
Soil Gas Vapor Risk Screening Level¹			18,000	880	NE	NE	2,800
	5040-SG-MW-2	12/10/2018	909	<10.7	<198	<396	<12.8

Notes:

¹ The vapor risk screening levels for small commercial structures are calculated in accordance with the procedures described in WDNR Publication RR-800 and subsequent guidance

² The vapor risk screening levels for residential structures are calculated in accordance with the procedures described in WDNR Publication RR-800 and subsequent guidance

Samples analyzed according to EPA Method TO-15

All concentrations reported in units in micrograms per cubic meter = µg/m3

Only detected compounds are listed

Bolded values are above method detection limits

Bolded and blue shaded values exceed the residential Vapor Risk Screening Level

Bolded and orange shaded values exceed the small commercial Vapor Risk Screening Level

NE = Not Established

IA = Indoor Air



EnvisionAir
1441 Sadler Circle West Drive
Indianapolis, IN 46239
Ph: 317-351-0885
Fax: 317-351-0882
www.envision-air.com

Mr. Rob Hoverman
Enviroforensics
N16 W. 23390 Stone Ridge Dr
Suite G
Waukesha, WI 53188

January 10, 2022

EnvisionAir Project Number: 2022-3
Client Project Name: 5040 Marc

Dear Mr. Hoverman,

Please find the attached analytical report for the samples received January 4, 2022. All test methods performed were fully compliant with local, state, and federal EPA methods unless otherwise noted. The project was analyzed as requested on the enclosed chain of custody record. Please review the comments section for additional information about your results or Quality Control data.

Feel free to contact me if you have any questions or comments regarding your analytical report or service.

Thank you for your business. EnvisionAir looks forward to working with you on your next project.

Yours Sincerely,

A handwritten signature in black ink that reads "David Norris". The signature is fluid and cursive.

David Norris
Project Manager
EnvisionAir, LLC



EnvisionAir
 1441 Sadlier Circle West Drive
 Indianapolis, IN 46239
 Ph: 317-351-0885
 Fax: 317-351-0882
 www.envision-air.com

Client Name: ENVIROFORENSICS
Project ID: 5040 - MARC
Client Project Manager: ROB HOVERMAN
EnvisionAir Project Number: 2022-3

Sample Summary

Canister Pressure / Vacuum

<u>Laboratory Sample Number:</u>	<u>Sample Description:</u>	<u>Matrix:</u>	<u>START</u>	<u>START</u>	<u>End Date</u>	<u>End Time</u>	<u>Date</u>	<u>Time</u>	<u>Initial Field</u>	<u>Final Field</u>	<u>Lab</u>
			<u>Date</u>	<u>Time</u>							
22-11	5040-3939-LIEN-IA-1	A	12/28/21	7:50	12/28/21	15:49	1/4/22	11:50	-29	-1	-1
22-12	5040-3939-LIEN-IA-2	A	12/28/21	7:45	12/28/21	15:18	1/4/22	11:50	-22	-9	-9
22-13	5040-3939-LIEN-SS-5	A	12/28/21	15:35	12/28/21	15:45	1/4/22	11:50	-30	-7	-7
22-14	5040-3939-LIEN-SS-3	A	12/28/21	15:55	12/28/21	16:01	1/4/22	11:50	-30	-4	-4



EnvisionAir
1441 Sadler Circle West Drive
Indianapolis, IN 46239
Ph: 317-351-0885
Fax: 317-351-0882
www.envision-air.com

Client Name: ENVIROFORENSICS

Project ID: 5040 - MARC

Client Project Manager: ROB HOVERMAN

EnvisionAir Project Number: 2022-3

Analytical Method: TO-15
Analytical Batch: 010522AIR

Client Sample ID: 5040-3939 LIEN-IA-1

Sample Collection START Date/Time: 12/28/21 7:50

Sample Collection END Date/Time: 12/28/21 15:49

EnvisionAir Sample Number: 22-11

Sample Received Date/Time: 1/4/22 11:50

Sample Matrix: AIR

<u>Compounds</u>	<u>Sample Results ug/m³</u>	<u>Reporting Limit ug/m³</u>	<u>Flag</u>
cis-1,2-Dichloroethene	< 19.8	19.8	
Tetrachloroethene	< 3.19	3.19	
trans-1,2-Dichloroethene	< 39.6	39.6	
Trichloroethene	< 1.07	1.07	
Vinyl Chloride	< 1.28	1.28	
4-bromofluorobenzene (surrogate)	101%		
Analysis Date/Time:	1-5-21/22:49		
Analyst Initials	tjg		



EnvisionAir
1441 Sadler Circle West Drive
Indianapolis, IN 46239
Ph: 317-351-0885
Fax: 317-351-0882
www.envision-air.com

Client Name: ENVIROFORENSICS

Project ID: 5040 - MARC

Client Project Manager: ROB HOVERMAN

EnvisionAir Project Number: 2022-3

Analytical Method: TO-15
Analytical Batch: 010522AIR

Client Sample ID: 5040-3939 LIEN-IA-2

Sample Collection START Date/Time: 12/28/21 7:45
Sample Collection END Date/Time: 12/28/21 15:18
Sample Received Date/Time: 1/4/22 11:50

EnvisionAir Sample Number: 22-12
Sample Matrix: AIR

<u>Compounds</u>	<u>Sample Results ug/m³</u>	<u>Reporting Limit ug/m³</u>	<u>Flag</u>
cis-1,2-Dichloroethene	< 19.8	19.8	
Tetrachloroethene	< 3.19	3.19	
trans-1,2-Dichloroethene	< 39.6	39.6	
Trichloroethene	< 1.07	1.07	
Vinyl Chloride	< 1.28	1.28	
4-bromofluorobenzene (surrogate)	96%		
Analysis Date/Time:	1-5-21/23:31		
Analyst Initials	tjg		



EnvisionAir
1441 Sadler Circle West Drive
Indianapolis, IN 46239
Ph: 317-351-0885
Fax: 317-351-0882
www.envision-air.com

Client Name: ENVIROFORENSICS

Project ID: 5040 - MARC

Client Project Manager: ROB HOVERMAN

EnvisionAir Project Number: 2022-3

Analytical Method: TO-15
Analytical Batch: 010522AIR

Client Sample ID: 5040-3939 LIEN-SS-5

Sample Collection START Date/Time: 12/28/21 15:35

Sample Collection END Date/Time: 12/28/21 15:45

EnvisionAir Sample Number: 22-13

Sample Received Date/Time: 1/4/22 11:50

Sample Matrix: AIR

<u>Compounds</u>	<u>Sample Results ug/m³</u>	<u>Reporting Limit ug/m³</u>	<u>Flag</u>
cis-1,2-Dichloroethene	< 198	198	
Tetrachloroethene	< 31.9	31.9	
trans-1,2-Dichloroethene	< 396	396	
Trichloroethene	< 10.7	10.7	
Vinyl Chloride	< 12.8	12.8	
4-bromofluorobenzene (surrogate)	98%		
Analysis Date/Time:	1-6-21/05:02		
Analyst Initials	tjg		



EnvisionAir
1441 Sadler Circle West Drive
Indianapolis, IN 46239
Ph: 317-351-0885
Fax: 317-351-0882
www.envision-air.com

Client Name: ENVIROFORENSICS

Project ID: 5040 - MARC

Client Project Manager: ROB HOVERMAN

EnvisionAir Project Number: 2022-3

Analytical Method: TO-15
Analytical Batch: 010522AIR

Client Sample ID: 5040-3939 LIEN-SS-3

Sample Collection START Date/Time: 12/28/21 15:55

Sample Collection END Date/Time: 12/28/21 16:01

EnvisionAir Sample Number: 22-14

Sample Received Date/Time: 1/4/22 11:50

Sample Matrix: AIR

<u>Compounds</u>	<u>Sample Results ug/m³</u>	<u>Reporting Limit ug/m³</u>	<u>Flag</u>
cis-1,2-Dichloroethene	< 198	198	
Tetrachloroethene	< 31.9	31.9	
trans-1,2-Dichloroethene	< 396	396	
Trichloroethene	< 10.7	10.7	
Vinyl Chloride	< 12.8	12.8	
4-bromofluorobenzene (surrogate)	104%		
Analysis Date/Time:	1-6-21/05:42		
Analyst Initials	tjg		

TO-15 Quality Control Data

EnvisionAir Batch Number: 010522AIR

<u>Method Blank (MB):</u>	<u>MB Results (ppbv)</u>	<u>Reporting Limit (ppbv)</u>	<u>Flags</u>
cis-1,2-Dichloroethene	< 5	5	
Tetrachloroethene	< 0.47	0.47	
trans-1,2-Dichloroethene	< 10	10	
Trichloroethene	< 0.2	0.2	
Vinyl Chloride	< 0.5	0.5	
4-bromofluorobenzene (surrogate)	98%		
Analysis Date/Time:	1-5-21/12:22		
Analyst Initials	tjg		

<u>LCS/LCSD</u>	<u>LCS Results (ppbv)</u>	<u>LCSD Results (ppbv)</u>	<u>LCS/D Conc(ppbv)</u>	<u>LCS Rec.</u>	<u>LCSD Rec.</u>	<u>RPD</u>	<u>Flag</u>
Vinyl Chloride	9.98	10.8	10	100%	108%	7.9%	
trans-1,2-Dichloroethene	9.47	9.72	10	95%	97%	2.6%	
cis-1,2-Dichloroethene	10	10.1	10	100%	101%	1.0%	
Trichloroethene	10.1	9.57	10	101%	96%	5.4%	
Tetrachloroethene	9.75	9.67	10	98%	97%	0.8%	
4-bromofluorobenzene (surrogate)	100%	101%					
Analysis Date/Time:	1-5-21/09:30	1-5-21/10:57					
Analyst Initials	tjg	tjg					



EnvisionAir
1441 Sadler Circle West Drive
Indianapolis, IN 46239
Ph: 317-351-0885
Fax: 317-351-0882
www.envision-air.com

Flag Number

Comments

CHAIN OF CUSTODY RECORD

EnvisionAir | 1441 Sadlier Circle West Drive | Indianapolis, IN 46239 | Phone: (317) 351-0885 | Fax: (317) 351-0882

REQUESTED PARAMETERS

Client: EMERSON P.O. Number: 7001-0489
 Report: 116 W 5390 State Road Project Name or Number:
 Address: WARRICK, IN MARC-5040
 Report To: R. HOESEMAN Sampled by: Z. HOESEMAN
 Phone: 317 630 0000 QA/QC Required: (circle if applicable)
 Invoice Address: Reporting Units needed: (circle)
 Level III Level IV
 ug/m³ mg/m³ PPBV PPMV
 Media types: 1LC = 1 Liter Canister
 2LC = 2 Liter Canister
 TD = Tedlar Bag
 TD = Thermal Desorption Tube

TO-15 Full List
 TO-15 Short List (Specify in notes)

Sampling Type:
 Soil-Gas:
 Sub-Slab:
 Indoor-Air:

Canister Pressure / Vacuum

www.envisionair.com



Air Sample ID	Media Type (See code sheet)	Coll. Date (Start)	Coll. Time (Start)	Coll. Date (Comp. End)	Coll. Time (Comp. End)	TO-15 Full List	TO-15 Short List (Specify in notes)	Canister Serial #	Flow Controller Serial #	Initial Field (in. Hg)	Final Field (in. Hg)	Lab Received (in. Hg)	EnvisionAir Sample Number
2040-3739 UICW	1LC	12/26/11	0700	12/26/11	1549	X		4691	0242	-39	-1	-1	22.11
5040-3339 UICW	1LC	12/26/11	0700	12/26/11	1549	X		4665	5592	-32	-4	-9	22.12
2040-3339 UICW-SS.S	1LC	12/26/11	1535	12/26/11	1545	X		2532	128	-30	-3	-7	22.13
2040-3339 UICW-SS.S	1LC	12/26/11	1545	12/26/11	1601	X		2817	0215	-30	-4	-4	22.14

Comments: START LIST: 20. TOL, 200E, 200E, VC

Relinquished by: [Signature] Date: 12/26/11 Time: 9:30 Received by: [Signature] Date: 1/4/12 Time: 11:50