

## Delegation of Signature Authority (DSA) WPDES General Permit Discharge

**Notice:** This Delegation of Signature Authority (DSA) form is authorized by s. NR 205.07(1)(g), Wis. Adm. Code, to delegate signature authority for a Wisconsin Pollutant Discharge Elimination System (WPDES) submittal, which may include a Notice of Intent (NOI or request for coverage), Notice of Termination (NOT), or other permit compliance document. To delegate signature authority, submittal of this completed DSA form to the Department of Natural Resources (Department) is mandatory for any permittee, landowner, responsible executive or municipal officer, manager, partner, or proprietor as specified in s. 283.37(3), Wis. Stats., to be regulated under a WPDES general permit.

Submission of this DSA constitutes notice that the permittee, landowner, responsible executive or municipal officer, manager, partner, or proprietor identified in Section II has authorized the person identified in Section III as a duly authorized representative to sign the WPDES submittal for the landowner, responsible executive or municipal officer, manager, partner, or proprietor. The completed DSA form shall be submitted as an attachment to the WPDES submittal or when there are any changes to the authorized representative with the permitted facility or activity.

**Note:** Submission of a DSA form is not required when the permittee, landowner, responsible executive or municipal officer, manager, partner, or proprietor signs the WPDES submittal.

**Please read all instructions before completing this form, and type or clearly print the information. All necessary information must be provided on this form. Submission of this DSA constitutes notice that the permittee identified in Section II has authorized the person identified in Section III to sign the WPDES submittal on behalf of the permittee. Failure to complete this form correctly will result in the Department's rejection of the WPDES submittal.** Personal information collected will be used for administrative purposes and may be provided to requesters to the extent required by Wisconsin's Open Records law (ss. 19.31 - 19.39, Wis. Stats.).

### Section I: WPDES Submittal Information

- WPDES Permit Type:
- Concentrated Animal Feeding Operation (CAFO) General Permit No. WI-0063274
  - Concentrated Animal Feeding Operation (CAFO) Individual Permit No. \_\_\_\_\_
  - Storm Water Construction Site General Permit No. WI-S067831
  - Storm Water Industrial General Permit No. \_\_\_\_\_
  - Storm Water Municipal (MS4) Permit No. \_\_\_\_\_
  - Storm Water Transportation Construction Activities General Permit No. WI-S066796
  - Storm Water Transportation TS4 General Permit No. WI-S066800
  - Wastewater General Permit No. \_\_\_\_\_

- WPDES Submittal Type:
- MS4 or TS4 Annual Report or other permit compliance document
  - Notice of Intent (NOI)/Permit Application
  - Notice of Termination (NOT)
  - Wastewater Electronic Discharge Monitoring Report (eDMR)
  - CAFO Plans and Specifications
  - Nutrient Management Plans
  - Other: \_\_\_\_\_

### Section II: WPDES Permittee Responsible for Pollutant Discharge

WPDES Permittee (first and last name, title)	Individual, Company, Municipality, Organization, or Entity Name		
Frieseke Rick	Friess Environmental Consulting, Inc.		
Mailing Address	City	State	ZIP Code
6635 North Sidney Place	Milwaukee	WI	53209
Email Address	Phone Number (area code)	Alternative Phone Number	
rfrieseke@fecinc.us	(414) 731-9875	(414) 228-9815	

### Section III: Delegated Signatory Information

Signatory Name (first and last name, title)	Individual, Company, Municipality, Organization, or Entity Name		
Frieseke Rick	Friess Environmental Consulting, Inc.		
Mailing Address	City	State	ZIP Code
6635 North Sidney Place	Milwaukee	WI	53209
Email Address	Phone Number (area code)	Alternative Phone Number	
rfrieseke@fecinc.us	(414) 731-9875	(414) 228-9815	

**Delegation of Signature Authority (DSA)  
WPDES General Permit Discharge**

Form 3400-220 (R 06/19)

Page 2 of 4

**Section IV: Certification & Signature**

This is to notify the Department that as the landowner, responsible executive or municipal officer, manager, partner, or proprietor, I delegate signature authority to the person identified in Section III for signature of the WPDES submittal under a WPDES general permit. I authorize the person identified in Section III pursuant to the delegation of signature authority process set forth in s. NR 205.07(1)(g), Wis. Adm. Code, as a duly authorized representative.

As required by s. NR 205.07(1)(g)2, Wis. Adm. Code, this form should be submitted to the Department with the WPDES submittal. I understand that if there are any changes to this authorization, a new complete DSA form shall be submitted to the Department. I understand that the landowner, responsible executive or municipal officer, manager, partner, or proprietor regulated under a WPDES general permit is the permittee, and as such, I am responsible for compliance with the WPDES General Permit. Further, I authorize the person identified in Section II to create a Wisconsin Management System (WAMS) ID and electronically sign an electronic WPDES submittal on my behalf and submit all required information and attachments, if electronic application or reporting is available.

For this DSA form, the WPDES submittal and all required information and attachments, I certify under penalty of law that these documents and all attachments were prepared under my direction or supervision with a system designed to assure that qualified personnel properly gather and evaluate the information submitted. Based on my inquiry of the person or persons who manage the system, or those persons directly responsible for gathering the information, the information submitted is, to the best of my knowledge and belief, true, accurate, and complete. I am aware that there are significant penalties for submitting false information, including the possibility of fine and imprisonment for knowing violations.

**NOTE:** This form must be signed by a permittee, landowner, responsible executive or municipal officer, manager, partner, or proprietor as described in the instructions of page 3. Failure to properly complete and sign this form will result in its rejection.

Richard Frieske

Printed Name of WPDES Permittee

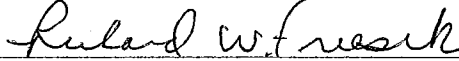
  
Signature of WPDES Permittee

Consultant

Title

10/7/19  
Date Signed

# Delegation of Signature Authority (DSA) WPDES General Permit Discharge

Form 3400-220 (R 06/19)

Page 3 of 4

## Instructions

### Section I: WPDES Submittal Information

Provide the permit type, permit number, and submittal type that the delegated signatory is being granted delegation of signature authority.

### Section II: WPDES Permittee Responsible for Pollutant Discharge

A permittee is defined as a person holding fee title, an easement or interest in the property or responsible executive or municipal officer, manager, partner, or proprietor with authority that allows the person to undertake permitted activities on the property. Please provide the legal name of the person and title that is a landowner, responsible executive or municipal officer, manager, partner, or proprietor regulated under the specified WPDES general permit. Please also provide the legal name of the individual, company, organization, or other entity that is permitted under the specified WPDES general permit. The mailing address and phone number given should be for the landowner, responsible executive or municipal officer, manager, partner, or proprietor.

### Section III: Delegated Signatory Information

Provide the legal name of the person, company, organization, or any other entity and the legal name of the person and/or position who is the delegated signatory to be a duly authorized representative. This person or position must be responsible for the overall operation of the facility or activity regulated by the WPDES general permit. The mailing address and phone number given should be for the person who is delegated signature authority as a duly authorized representative.

### Section IV: Certification & Signature

State regulations (s. 283.37, Wis. Stats) provide for severe penalties for submitting false information on this DSA form. State regulations require this form to be signed as follows:

1. For a corporation, by a principal executive officer of at least the level of vice president or by the principal executive officer's authorized representative responsible for the overall operation of the point source for which a permit is sought.
2. For a limited liability company, by a member or manager.
3. For a partnership, by a general partner.
4. For a sole proprietorship, by the proprietor.
5. For a unit of government, by a principal executive officer, or ranking elected official.

Sign the form, print or type the name of the individual signing the DSA form and the date of signature.

### How to Submit

The completed DSA form must be submitted as an attachment with the WPDES document submitted electronically with the online WPDES submittal identified in Section I.

**CAFO:** The online water permit application and report system can be accessed at the Department's website at: [dnr.wi.gov/permits/water/](http://dnr.wi.gov/permits/water/) or contact the regional CAFO specialist at: <https://dnr.wi.gov/topic/agbusiness/cafo/contacts.html>

**Storm water:** The online water permit application and report system can be accessed at the Department's website at: [dnr.wi.gov/permits/water/](http://dnr.wi.gov/permits/water/).

**Wastewater:** The wastewater online system can be accessed at the Department's website at: [dnr.wi.gov/topic/wastewater/GeneralPermits.html](http://dnr.wi.gov/topic/wastewater/GeneralPermits.html).

Paper mail copies can be sent to the Wisconsin Department of Natural Resources office associated with the county of the facility site or discharge location as listed on page 4. Be sure to note the appropriate water program.

**Delegation of Signature Authority (DSA)  
WPDES General Permit Discharge**

Form 3400-220 (R 06/19)

Page 4 of 4

<b>Northern Region (NOR)</b>			<b>Storm Water Permits:</b>	<b>Wastewater Permits:</b>
Ashland	Forest	Price	WDNR Eau Claire Service Center 1300 W Clairemont Ave Eau Claire, WI 54701 715-839-1636	WDNR NOR Headquarters Attn: Wastewater GP Program 810 W Maple St Spooner, WI 54801 715-635-2101
Barron	Iron	Rusk		
Bayfield	Langlade	Sawyer		
Burnett	Lincoln	Taylor		
Douglas	Oneida	Vilas		
Florence	Polk	Washburn		
<b>Northeast Region (NER)</b>			<b>Storm Water Permits:</b>	<b>Wastewater Permits:</b>
Brown	Manitowoc	Outagamie	WDNR NER Headquarters Attn: Storm Water Program 2984 Shawano Ave Green Bay, WI 54313-6727 920-662-5100	WDNR NER Headquarters Attn: Wastewater GP Program 2984 Shawano Ave Green Bay, WI 54313 920-662-5100
Calumet	Marinette	Shawano		
Door	Marquette	Waupaca		
Fond du Lac	Menominee	Waushara		
Green Lake	Oconto	Winnebago		
Kewaunee	Oneida Reservation			
<b>West Central Region (WCR)</b>			<b>Storm Water Permits:</b>	<b>Wastewater Permits:</b>
Adams	Jackson	Portage	WDNR Eau Claire Service Center 1300 W Clairemont Ave Eau Claire, WI 54701 715-839-1636	WDNR WCR Headquarters Attn: Wastewater GP Program 1300 W Clairemont Ave Eau Claire, WI 54701 715-839-3700
Buffalo	Juneau	St. Croix		
Chippewa	La Crosse	Trempealeau		
Clark	Marathon	Vernon		
Crawford	Monroe	Wood		
Dunn	Pepin			
Eau Claire	Pierce			
<b>South Central Region (SCR)</b>			<b>Storm Water Permits:</b>	<b>Wastewater Permits:</b>
Columbia	Green	Richland	WDNR SCR Headquarters Attn: Storm Water Program 3911 Fish Hatchery Rd Fitchburg, WI 53711 608-275-3266	WDNR SCR Headquarters Attn: Wastewater GP Program 3911 Fish Hatchery Rd Fitchburg, WI 53711 608-275-3266
Dane	Iowa	Rock		
Dodge	Jefferson	Sauk		
Grant	LaFayette			
<b>Southeast Region (SER)</b>			<b>Storm Water Permits:</b>	<b>Wastewater Permits:</b>
Kenosha	Sheboygan		WDNR Waukesha Service Center Attn: Storm Water Program 141 N.W. Barstow St, Rm 180 Waukesha, WI 53188 262-574-2100	WDNR SER Headquarters Attn: Wastewater GP Program 2300 N Dr. Martin Luther King Jr. Dr Milwaukee, WI 53212 414-263-8500
Milwaukee	Walworth			
Ozaukee	Washington			
Racine	Waukesha			

# Site Information - Complete

## Site Map

**Choose the best map option for your project** . The mapped location of your project is required as part of the application and will be used to screen for potential impacts to sensitive resources, so be sure the map accurately represents the project location(s).

(Single project sites only)

(Delete the map to select new map or map type)

Site Map SG5333-FormerRRExcavatingsite

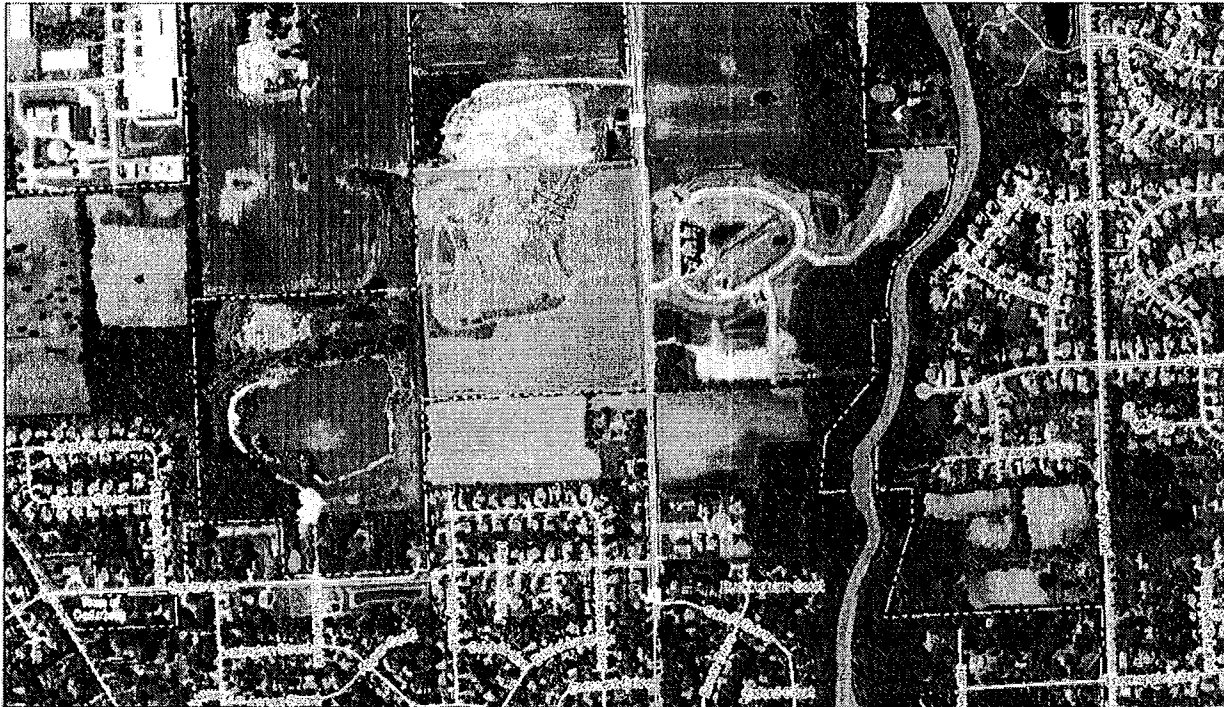

October 8, 2019

ImgService



Green: Green



Elite: Blue



Red: Red

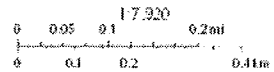

**Water Resources Application for Project Permits**

**Notice:** Pursuant to chs. 30 and 31, Wis. Stats., ch. 281, Wis. Stats., and s. 283.33, Wis. Stats., this form is used to apply for coverage under the state construction site storm water runoff general permit, and to apply for a state or federal permit or certification for waterway and wetland projects or dam projects. This form and any required attachments constitute the permit application. Failure to complete and submit this application form may result in a fine and/or imprisonment or forfeiture under the provisions of applicable laws including s. 283.91, Wis. Stats. Personal information collected will be used for administrative purposes and may be provided to requesters to the extent required by Wisconsin's Public Records Laws (ss. 19.31-19.39, Wis. Stats.). This form is required for U.S. Army Corps of Engineers (ACOE) regulatory purposes pursuant to 33 CF 325.

Read all instructions provided before completing

**Section 1: Landowner Information**

Landowner Name (Organization, Name, Entity etc.) Charmoli Holdings, LLC	Authorized Representative (Last Name , First Name) Frieseke , Rick		
Mailing Address 6635 North Sidney Place	City Milwaukee	State WI	Zip Code 53209
Email rfrieseke@fecinc.us	Phone Number (xxx-xxx-xxxx) 414-731-9875	Alternative Phone Number	

**Section 2: Applicant/Information**  Select if same as landowner

Organization / Applicant Name Friess Environmental Consulting	Contact Person (Last Name , First Name) Frieseke , Rick		
Mailing Address 6635 North Sidney Place	City Milwaukee	State WI	Zip Code 53209
Email rfrieseke@fecinc.us	Phone Number(xxx-xxx-xxxx) 414-731-9875	Alternative Phone Number	

**Section 3: Primary Project Contact**  Select if same as landowner

Consultant or Plan Preparer  Contractor  Agent  Other - specify: \_\_\_\_\_

Name (Organization or Entity) Friess Environmental Consulting	Contact Person (Last Name, First Name) Frieseke , Rick		
Mailing Address 6635 North Sidney Place	City Milwaukee	State WI	Zip Code 53209
Email rfrieseke@fecinc.us	Phone Number (xxx-xxx-xxxx) 414-731-9875	Alternative Phone Number	

**Section 4: Project or Site Location:**

Project Name Former R&R Excavating site	County Ozaukee	<input type="radio"/> City <input checked="" type="radio"/> Township <input type="radio"/> Village of CEDARBURG, WI
Location Address / Description SE ¼ of the NE ¼, Section 22, Township 10 N, Range 21 E		
<b>Public Land Survey System (PLSS)</b> – (PLSS and Lat/Long will be populated from the map disturbed area)		
SE ¼	of NE ¼	of Section (xx) 22
	Township (xx) 10	Range (xx) 21
	Direction N	E
	Latitude 43.317431625	Longitude -87.987272683
If this site is not wholly contained in the quarter-quarter section, more description: SENE2210N21E;		
<b>Waterways:</b> Provide the name(s) of closest water bodies Cedar Creek		

**Section 5: Pre-Application Resource Screening**

If a wetland is present at a project site and permit approvals are sought through the waterway and wetland program, storm water program, or concentrated animal feeding operations (CAFO) program, the department requires that a wetland delineation that accurately shows the location of a wetland is submitted with an application. A wetland delineation needs to be verified/concurred with before the application can be submitted or be considered a complete application. See the department Wetland screening and delineation procedures for more information.

Is a wetland present in the project area?  Yes  No

If yes, select all sources of information used and attach supporting report or documentation

- a. A copy of your wetland delineation report and a Wetland Confirmation Service concurrence letter (wetland boundary verification service offered for a fee from the department)
- b. An assured delineator's wetland delineation report
- c. A copy of your wetland delineation and an Army Corps of Engineers concurrence letter
- d. A copy of your correspondence with a WDNR Water Management Specialist, WDNR Office of Energy Water Management Specialist or WDNR Transportation Liaison regarding your wetland review/ concurrence.

If no, please select one of the following items showing that a wetland is not present within the project boundaries:

- a. A copy of your wetland determination and a letter from the department's Wetland Identification Program stating wetlands are not present or the activity proposed in the wetland is exempt under NR 103.06(4)
- b. A letter from an assured delineator stating wetlands are not present
- c. Documentation showing that each of these resources were reviewed for wetland absence on the Surface Water Data Viewer:
  - i. Surface Water Data Viewer- Wisconsin Wetland Inventory
  - ii. Surface Water Data Viewer- Wisconsin Indicator layer
  - iii. Surface Water Data Viewer- Digital Topographic map layer or aerial photo indicating if waterways, drainage ways, ditches, depressions, or standing water are within project boundary
- d. Show that the project limits are entirely in existing paved, graveled, or concrete areas.
- e. A copy of your correspondence with a WDNR Water Management Specialist, WDNR Office of Energy Water Management Specialist or WDNR Transportation Liaison regarding your wetland review/concurrence

( Please note that if the information provided is incorrect or incomplete, the overall permit application may be considered incomplete and may be returned to the applicant.)

**Section 6: Endangered or Threatened Resources**

Has the presence of endangered or threatened resources been evaluated according to protocols developed by the DNR Bureau of National Heritage Conservation (BNHC) <http://dnr.wi.gov/topic/ERRReview>  Yes  No

If Yes, select how the evaluation was completed and attach supporting report or documentation:

- a. Broad Incidental Take Permit /Authorization -specify (e.g. No / Low Impact Activities, Grassland & Savanna Management, etc.): \_\_\_\_\_
- b. Endangered Resources Preliminary Assessment from the Natural Heritage Inventory Public Portal
- c. Standard Endangered Resources Review Letter from Endangered Resources Review Program:  
ERR - (example ERR-YY-### with YY = Year and ### the number)
- d. Certified Endangered Resources Review Letter - specify:  
ERR- (example ERR-YY-### with YY = Year and ### the number)

**Section 7: Project Information (Attach additional sheets as necessary)**

Anticipated Project Start Date : 10/28/2019	Projected Project End Date 10/30/2020
Photos: Provide photographs of the "before" condition.	Date of Photographs:

**Site Location**

Total Area of Project Site:   
(acres)

Total Estimated Disturbed Area: 38.281  
(acres)

Latitude:

Longitude:

Quarter: SE

of Quarter: NE

Section:  (Valid Sections: 01 - 36)

Township:  N (Valid Townships 01 - 53)

Range:  (Valid Ranges 01 - 30)

Direction:  East  West

**Form 3500-53C Checklist (R12/15)**

Type of Development:  Residential  Commercial/Industrial  
 Transportation  Utility  Agricultural

Project Type:  In-fill  Redevelopment  New  
Development

Impervious Area Before Construction: %  
(as percent of total land disturbance)

Impervious Area After Construction: %  
(as percent of total land disturbance)

**Site Screening Questions (check Yes or No )**

Is the proposed disturbed area within 300 feet from a mapped or delineated wetland?  Yes  No

Is the proposed disturbed area within 500 feet from a water body?  Yes  No

Prior to commencing land disturbing construction activities, is there any area within the project boundaries with a slope length of more than 50 feet at a steepness of greater than 20%?  Yes  No

During land disturbing construction activities, will there be any area within the project boundaries with a slope length of more than 50 feet at a steepness of greater than 20%?  Yes  No

Is the project exempt from the post-construction performance standards in NR151.121(2) or s. NR 151.241(2), Wis. Adm. Code.?  Yes  No



## Required Attachments and Supplemental Information - *Complete*

Please recognize that you are responsible for obtaining all necessary local (e.g. city, town, village or county) and U.S. Army Corps of Engineer permits or approvals in addition to any applicable state permits prior to commencing any work at the project site.

The information below is checklist is necessary for a complete application. A complete submittal with detailed drawings will help us make a decision about your permit application. Any applicable statutory review times do not begin until the application is received by the Department and is determined to be complete.

To help us make a decision in the shortest amount of time possible, the following information must be submitted:

### New Land Disturbing Construction Activity

- Review related web site and instructions for [Storm Water - Notice of Intent \[Exit Form\]](#)
- Review guidance for [soil loss or sediment discharge calculations \[Exit Form\]](#)
- Complete all required forms and upload required attachments
- Pay fee online
- Sign and Submit form

Upload Required Attachments (15 MB per file limit) - [Help reduce file size and trouble shoot file uploads](#)

\* indicates completion of this item is required

Note: To replace an existing file, use the 'Click here to attach file ' link. To delete a selected item press Ctrl D or the icon.

### Erosion Control Plan Narrative and Storm Water Management

 File Attachment [DewateringNotes.pdf](#)

### Erosion Control Map (Construction Plans)

 File Attachment [DewateringPermit.pdf](#)

### Site Evaluation for Storm Water Infiltration

 File Attachment

### Modeling

 File Attachment [LS-3350-12-4FinalGradingPlan-20130405.pdf](#)

### Long Term Maintenance Agreement

 File Attachment [LS-3350-12-2Survey-20130405.pdf](#)

### Best Management Practices (BMP) Permission Letter

 File Attachment

## Soil Loss/Sediment Discharge Calculations

 File Attachment

[SoilLossCalcs.pdf](#)

## Section 5 - Wetland Assessment Method (Required June 1, 2016)

Paved Graveled or Concrete area map

 File Attachment

[LS-3350-12-5InterimGradingPlan-20130405.pdf](#)

Indicate the sources of the information used to assess for the presence of wetlands and attach the supporting report or documentation. If a wetland is present at a project site, the Department requires that a wetland delineation accurately showing the location of a wetland is submitted with an application. Starting June 1, 2016, a wetland delineation needs to be either performed by an assured wetland delineator, or confirmation by the Department or Army Corps of Engineers before the application can be considered complete.

Department Wetland Assessment Resources

[Locating Wetlands Information](#)

[Assured Wetland Delineator](#)

[Wetland Identification Program](#) (Department confirmation program)

[Wetland Screening and Delineation Procedures](#) (effective June 1, 2016)

## Section 6 - Endangered Species or Threatened Resources

### Site Photos

 File Attachment

[20180516\\_084628.jpg](#)

### Other Items (Select Type)

Select Type.....

 File Attachment

(Click insert to add additional Other Items or Site Photos. Use your cursor to hover over the file name field. When the drop down arrow appears, select insert or remove item)

## Submit Payment

Wisconsin Department of Natural Resources Invoice Number: WP-00020421

**Total Due:** 350

Important:

- Closing this page without saving will cause the loss of your payment history.
- A 2.5% convenience fee is added for credit card payments.
- Follow all three steps below and sign and submit your permit.

### STEP 1 Completed Payment

### STEP 2 Enter Confirmation Number

WS2WT3003989411

Upon completing payment in STEP 1, you will receive an email confirmation from DNRFINANCEEPMNT with a DNR-Water Div Volume Permits subject line. Enter 15 digit transaction number into the box above.

### STEP 3

Please note that payment is considered successful when your financial institution renders payment for this transaction. Failure of US Bank to collect and transfer funds from the permit applicant to the DNR, does not release the applicant of financial responsibility and the DNR reserves the right to collect unpaid fees.

All payments are collected by US Bank which is an external website contracted by the Wisconsin Department of Natural Resources for the sole purpose of collecting payments over the web.

## Fee Exempt Project Information

Please describe the project that qualifies for the payment exemption:

I certify that this project qualifies as exempt from permit application fees.

Please enter the contact information in case additional information is required:

Name:

Contact Type: Select...

Phone Number (Include Area Code)

Contact Email:

## Sign and Submit

### Steps to Complete the signature process

1. Check who is electronically signing the eNOI
2. Read and Accept the Terms and Conditions
3. Press the Initiate Signature Process button
4. Open the confirmation email for a one time confirmation code and instructions to complete the signature process.
5. You will receive a final acknowledgement email upon completing these steps

NOTE: For security purposes all email correspondence will be sent to the address you used when registering your WAMS ID. This may be a different email than that provided in the application. For information on your WAMS account click [HERE](#).

### Terms and Conditions

**Certification:** I hereby certify that I am the owner or authorized representative of the owner of the property which is the subject of this Permit Application. I certify that the information contained in this form and attachments is true and accurate. I certify that the project will be in compliance with all permit conditions. I understand that failure to comply with any or all of the provisions of the permit may result in permit revocation and a fine and/or imprisonment or forfeiture under the provisions of applicable laws.

**Permission:** I hereby give the Department permission to enter and inspect the property at reasonable times, to evaluate this notice and application, and to determine compliance with any resulting permit coverage.

Signee (must check current role prior to accepting terms and conditions)

- Landowner using WAMS ID
- Delegation of Signature Authority ( Form 3500-220 ) for agent signing on the behalf or the landowner
- Agent seeking to share permit application with Landowner (Land owner must get WAMS id and complete signature)

### Delegation of Signature Authority

 File Attachment

[Click to view attachment](#)

Submission of this form constitutes notice by the landowner that the person electronically signing the eNOI is authorized to do so the landowner. Please [download form 3500-220](#) and sign and attach it above.

Name: Rick Frieseke

Title: Consultant

Authorized Signature.

I accept the above terms and conditions.

I confirm WAMS email for correspondence

Signed by : i:0#.f|wamsmembership|rfrieseke12345 on 2019-10-08T09:31:14

You have already signed and submitted this application to the DNR. Please [contact the Wisconsin DNR](#) for assistance.

After providing the final authorized signature, the system will send an email to the authorized party and any agents. This email will include a copy to the final read only version of this application

# Storm Water Construction General Permit Application

Applications are completed in a series of steps, identified by the tabs below (e.g. Application, Attachments, etc.) Click on a tab, follow the instructions and complete the following steps:

**Complete** all sections, **Save** your work, **Move** between tabs, **Pay** online by credit card or e-check, (You must use this system to pay all application fees), **Include** your digital signature, **Submit** the Application to the DNR.

NOTE: Missing or incomplete fields are highlighted at the bottom of each page. You may save, close and return to your draft permit as often as necessary to complete your application. If you do not complete the draft in 120 days, your draft is deleted.

## Basic Permit Information

**Project Name**

Former R&R Excavating site

You must enter a project name and select an activity to begin an application.

- Storm Water Notice of Intent (NOI) - New land disturbing construction activity
- Storm Water NOI - Renewal Construction

## Application Information

The information below is checklist is necessary for a complete application. A complete submittal with detailed drawings will help us make a decision about your permit application. Any applicable statutory review times do not begin until the application is received by the Department and is determined to be complete.

To help us make a decision in the shortest amount of time possible, the following information must be submitted:

### New Land Disturbing Construction Activity

- Review related web site and instructions for [Storm Water - Notice of Intent](#) [Exit Form]
- Review guidance for [soil loss or sediment discharge](#) calculations [Exit Form]
- Complete all required forms and upload required attachments
- Pay fee online
- Sign and Submit form



# Soil Loss & Sediment Discharge Calculation Tool

for use on Construction Sites in the State of Wisconsin

WDNR Version 2.0 (06-29-2017)



**YEAR 1**

Developer: Friess Environmental Consulting, Inc.  
 Project: Former R&R Excavating site  
 Date: 10/08/19  
 County: Ozaukee

Version 1.0

Activity (1)	Begin Date (2)	End Date (3)	Period % R (4)	Annual R Factor (5)	Sub Soil Texture (6)	Soil Erodibility K Factor (7)	Slope (%) (8)	Slope Length (ft) (9)	LS Factor (10)	Land Cover C Factor (11)	Soil loss A (tons/acre) (12)	SDF (13)	Sediment Control Practice (14)	Sediment Discharge (t/ac) (15)
Bare Ground	10/28/19	----	3.7%	120	Clay Loam	0.37	1.0%	100	0.13	1.00	0.2	0.881		0.2
		----	----	----	-----	----	1.0%	100	0.13	----	----	0.000		0.0
		----	----	----	-----	----	1.0%	100	0.13	----	----	0.000		0.0
		----	----	----	-----	----	1.0%	100	0.13	----	----	0.000		0.0
		----	----	----	-----	----	1.0%	0	----	----	----	0.000		0.0
		----	----	----	-----	----	0.0%	0	----	----	----	0.000		0.0
<b>TOTAL</b>											<b>0.2</b>		<b>TOTAL</b>	<b>0.2</b>
													<b>% Reduction Required</b>	<b>NONE</b>

**Notes:**

See Help Page for further descriptions of variables and items in drop-down boxes.  
 The last land disturbing activity on each sheet must be 'End'. This is either 12 months from the start of construction or final stabilization.  
 For periods of construction that exceed 12 months, please demonstrate that 5 tons/acre/year is not exceeded in any given 12 month period.

NOTE: THIS TOOL ONLY ADDRESSED SOIL EROSION DUE TO SHEET FLOW. MEASURES TO CONTROL CHANNEL EROSION MAY ALSO BE REQUIRED TO MEET SEDIMENT DISCHARGE REQUIREMENTS.

**Recommended Permanent Seeding Dates:**

4/15-6/1 and 8/1-8/21 Turf, introduced grasses and legumes  
 Thaw-6/30 Native Grasses, forbs, and legumes

Designed By:	RWF
Date	10/7/2019



# Soil Loss & Sediment Discharge Calculation Tool

for use on Construction Sites in the State of Wisconsin



WDNR Version 2.0 (06-29-2017)

**YEAR 2**

Developer: Friess Environmental Consulting, Inc.  
 Project: Former R&R Excavating site  
 Date: 10/8/2019  
 County: Ozaukee

Version 1.0

Activity (1)	Begin Date (2)	End Date (3)	Period % R (4)	Annual R Factor (5)	Sub Soil Texture (6)	Soil Erodibility K Factor (7)	Slope (%) (8)	Slope Length (ft) (9)	LS Factor (10)	Land Cover C Factor (11)	Soil loss A (tons/acre) (12)	SDF (13)	Sediment Control Practice (14)	Sediment Discharge (t/ac) (15)
Bare Ground	10/28/19	----	3.7%	120	Clay Loam	0.37	1.0%	100	0.13	1.00	0.2	0.881		0.2
		----	----	----	-----	----	1.0%	100	0.13	----	----	0.000		0.0
		----	----	----	-----	----	1.0%	100	0.13	----	----	0.000		0.0
		----	----	----	-----	----	1.0%	100	0.13	----	----	0.000		0.0
		----	----	----	-----	----	1.0%	0	----	----	----	0.000		0.0
		----	----	----	-----	----	0.0%	0	----	----	----	0.000		0.0
<b>TOTAL</b>											<b>0.2</b>		<b>TOTAL</b>	<b>0.2</b>
													<b>% Reduction Required</b>	<b>NONE</b>

**Notes:**

See Help Page for further descriptions of variables and items in drop-down boxes.  
 The last land disturbing activity on each sheet must be 'End'. This is either 12 months from the start of construction or final stabilization.  
 For periods of construction that exceed 12 months, please demonstrate that 5 tons/acre/year is not exceeded in any given 12 month period.

NOTE: THIS TOOL ONLY ADDRESSED SOIL EROSION DUE TO SHEET FLOW. MEASURES TO CONTROL CHANNEL EROSION MAY ALSO BE REQUIRED TO MEET SEDIMENT DISCHARGE REQUIREMENTS.

**Recommended Permanent Seeding Dates:**

4/15-6/1 and 8/1-8/21 Turf, introduced grasses and legumes  
 Thaw-6/30 Native Grasses, forbs, and legumes

Designed By:	RWF
Date	10/7/2019

## Stormwater Management Notes

***Friess Environmental Consulting, Inc. (FEC)*** is assisting the Owner of the former R&R Excavating Site with reclamation of their quarry. The Reclamation plan was submitted and reviewed by the Ozaukee County Resource Board and the Wisconsin Department of Natural Resources in April 2013. The plan was subsequently approved in June 2013. The reclamation plan includes management of stormwater as part of the approved plan. As such, FEC submits this permit application as part of the approved plan. Below outlines the protocol that for the proposed dewatering management activities.

- Hours of Operation: The hours of operation for the filling will be consistent with the current hours of operation proscribed by the Town of Cedarburg, which are 7:00 am to 5:00 pm Monday through Friday.
- Site Availability: The CDS Owner will establish if soils can be disposed of at the CDS in the event of inclement weather, availability of Owners equipment and personnel and capability to accept fill. Stormwater will be pumped on an as needed Schedule based on the accumulation of stormwater. Stormwater will not be pumped within 24 hours following a storm event of 0.5 inches or greater. Filling and stormwater management operations will be dependent on FEC's ability to continue to utilize the CDS as a soil disposal site.
- Site Approval: The Ozaukee County Resource Board and the Wisconsin Department of Natural Resources (DNR) have reviewed and approved the CDS per their location criteria to accept clean and exempt fill soils.
- Materials Approval: Materials that will be used will include clean exempt fill, fill soils considered to be a low hazard exempt (LHE) waste and soils approved under an NR 718.12 exemption.
- Wetlands: No designated wetland are located on the reclamation site nor is the proposed stormwater discharge proposed into a wetland area.
- Stormwater Retention: The main stormwater retention area is in the northeast portion of the site.
- Stormwater Discharge: Stormwater will be pumped from the retention area and discharged into a drainage ditch which is located along the northeastern property border. Silt fence will be installed at three locations within the drainage trench to remove sediment that may be generated during dewatering. Additional best management practices such as strainer, filters, settling area, and hay bales may be used, if needed.
- The stormwater dewatering will be conducted in accordance with the WDNR Technical Standard De-watering #1061.
- Stormwater Conveyance: Stormwater is conveyed from the site via the drainage ditch which is located along the northeastern property border. A culvert conveys stormwater from the site to a drainage ditch on the east side of CTH I. Stormwater is subsequently discharged eastward through



the drainage ditch into Cedar Creek which is located approximately 1000 feet east of the site.

- FEC will conduct site inspections weekly during dewatering activities and within 24 hours of a rain event of 0.5 inches or greater when discharge activities will occur. FEC will keep inspection record and have them available upon request.

The above represents a list of conditions that are proposed as part of the dewatering operations. If you have any questions regarding the conditions, please call *FEC* at (414) 228-9815.



**A. GENERAL NOTES**

1. All required reclamation work operations shall conform to the requirements of the following.
  - a. Town of Cedarburg and Ozaukee County Codes and Ordinances.
  - b. Wisconsin Administrative Code - NR 135
  - c. Wisconsin D.O.T. 2012 Standard Specifications for Highway and Structure Construction
  - d. Wisconsin D.N.R. Technical Standards
2. The Owner and/or Operator shall be responsible for permit acquisitions and related costs thereon.
3. The Contractor shall install and maintain the following temporary B.M.P.'s in accordance with current Wisconsin D.N.R. Technical Standards.
  - a. Silt fencing per WDMR Tech. Std. 1055
  - b. Gravel access road shall serve as tracking pad
  - c. Seeding per WDMR Tech. Std. 1056 for Construction Sites
4. Grading and establishment work operations of fill materials shall be in accordance with Section 207 of the State D.O.T. Specifications.
5. Placement of approved fill materials shall be in 12-inch to 15-inch lifts. Compaction may be completed with grading equipment and truck traffic. Proof rolling shall be completed by loaded dump trucks.
  - a. All filling below the D.N.R. established and agreed upon ground water elevation of 810.0 shall be CLEAN FILL ONLY.
  7. Topsoil shall be placed across the grading area to a minimum depth of 12-inches and in accordance with NR 135.10 and NR 135.11. Topsoil materials shall conform to Section 625 of State D.O.T. Specifications.
  8. Soil cap shall be placed across the grading area, directly below the top soil layer to a minimum depth of 24-inches and shall consist of soils comparable or in like kind with Hochheim Loam, as referenced in the United States Department of Agriculture Soil Conservation Service report dated September, 1970.
  9. Re-vegetation shall be in accordance with Sections 625, 627, and 630 of Wisconsin DOT 2012 Standard Specifications for Highway and Structure Construction
  10. Safety fencing shall be installed as shown on Sheets 3 and 4 of the plans. Fencing shall be 6' high chainlink with "KEEP OUT" signs posted every 50' along the length of the fence and maintained throughout reclamation of the quarry.
  11. On site water testing was performed on 6-7-2012. Please reference reports dated 6-8-2012 and 6-12-2012, prepared by Synergy Environmental Lab, Inc. (See report included with reclamation plan)
  12. Storm water runoff shall be maintained and directed to the Southeast corner of the site. This area will be utilized to store surface water throughout the filling operations. Surface water mitigation will be accomplished through evaporation and infiltration. At such time that the filling operation nears completion and a dewatering becomes necessary, a set of plans, designed by a Licensed Engineer, shall be provided to Ozaukee County Land and Water Management & the Wisconsin Department of Natural Resources for their approval.

**B. RECLAMATION MEASURES**

1. The reclamation measures and plan shall conform to the requirements of NR 135.19.
  2. Proposed earthwork and reclamation shall be as follows and as shown on Plan Sheets 4 and 5 of the Plans.
    - a. High walls will be eliminated with the proposed earthwork.
    - b. Finished slope angles generally vary from 1% to 2%, with slopes of drainage swales at 2 1/2% to 4%. The interim reclamation grading plan as shown on Sheet 5 of the Plans has 3:1 side slopes at the northern limits of the reclamation area. These 3:1 slopes are existing to blend the final grading contours with existing post-mining lands.
    - c. Existing safety/screening berms shall be used as part of the fill for this reclamation plan at such point in the filling process that they are no longer needed for safety measures.
    - d. Prior to the placement of topsoil, all graded surfaces will be scarified for effective topsoil adhesion.
    - e. Rough and final grading will be completed such that ponding of water will be eliminated on the reclaimed surface.
    - f. All topsoil will be placed to match the proposed finished grades and contours of the grading plans.
    - g. Reference: February 16, 2009 Memorandum as prepared by Environmental & Development Solutions and as approved by the Town of Cedarburg and R & R Excavating & Bulldozing representative. The Memorandum of Understanding outlines the protocol for filling operations at the site. (See memorandum included with reclamation plan)
    - h. Slopes shall not exceed 3:1 for this reclamation plan
  3. Topsoil construction shall be as follows.
    - a. Erosion and sedimentation Best Management Practices (B.M.P.) shall be installed and constructed prior to topsoil removal/stockpiling.
    - b. The Contractor shall remove all topsoil and store topsoil materials onsite and as directed by the project Inspector.
    - c. All topsoil storage piles shall receive erosion control protection measures as required. Additional protection shall include re-vegetation seeding and mulching. Seeding shall be restricted to natural prairie seed mixtures.
    - d. Topsoil will be redistributed onto the graded site in accordance with Section 625 of the D.O.T. Standard Specifications.
  4. The re-vegetation plan shall be completed as follows.
    - a. All graded areas shall be re-vegetated and stabilized as soon as possible after site grading operations.
    - b. Seed materials shall be nursery grade and free of contamination by weed species.
    - c. Seed mixtures shall be as follows.
      - 1.) Seed Mixture #3 per A Guide to Developing Reclamation Plans for Nonmetallic Mining Sites in Wisconsin Appendix C for wildlife and passive recreation. Seed rate application shall be as recommended in said reference or suppliers recommendations based on site conditions.
      - 2.) Seed Mixture #2 & #3 per A Guide to Developing Reclamation Plans for Nonmetallic Mining Sites in Wisconsin Appendix C for stabilization, wildlife, grazing, and passive reclamation. Seed rate application shall be as recommended in said reference or suppliers recommendations based on site conditions.
      - 3.) It is estimated that successful reclamation shall take 2-3 growing years to reach the success standard of 70% uniform vegetative growth as described below.
    - d. Seed application shall take place anytime during the growing season pending suitable soil conditions. Seed application shall not take place between July 1 and August 15; immediately after a rainfall event; during windy conditions; or when ground conditions are dry.
    - e. Seeding applications shall conform to the requirements of said reference material or suppliers recommendations based on site conditions.
    - f. For the 3:1 slopes in the interim reclamation grading, hydroseeding, may be used. This procedure shall conform to the requirements of Section 627 of the D.O.T. Specifications. (Slope stabilization shall include the installation of jute mat/mulch per Section 628 of the D.O.T. Specifications.)
    - g. Mulching of all seeded areas shall be applied at a rate of between 1.0 and 1.5 tons per acre. All mulching materials and construction methods shall conform to the requirements of Section 627 D.O.T. Standard Specifications.
  5. Standards for re-vegetation shall be as follows.
    - a. Re-vegetation success shall be determined based on the percent vegetative cover. Methods and Standard for said success shall consist of a 1 meter square or equivalent plot with a uniform vegetative cover of no less than 70% of said plot.
    - b. Inspections onsite by County personnel and Owner representative shall take place.
    - c. Reports that include quantifiable data on re-vegetation shall be provided by the Owner or Owner's agent to the County.
  6. The following erosion control plan shall be implemented as part of the reclamation plan.
    - a. After topsoil removal and stock piling, each area/stockpile shall have a perimeter silt fence installation with appropriate temporary seed mixture application.
    - b. Silt fencing shall be installed as shown on Sheets 3 and 4 of the Plans and at such time that the filling operations have raised the grade enough to require the need for runoff protection.
    - c. Seeding and mulching operations shall be completed as soon as possible after grading operations.
    - d. The reclamation site shall be monitored, inspected, and maintained until vegetative cover is fully established.

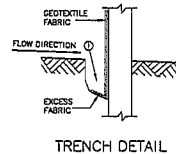
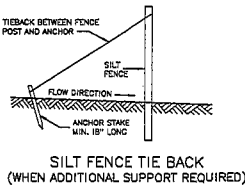

**GENERAL NOTES - SILT FENCE**

1. TRENCH SHALL BE A MINIMUM OF 4" WIDE & 6" DEEP TO BURY AND ANCHOR THE GEOTEXTILE FABRIC. FOLD MATERIAL TO FIT TRENCH AND BACKFILL & COMPACT TRENCH WITH EXCAVATED SOIL.
2. WOOD POSTS SHALL BE A MINIMUM SIZE OF 1 1/8" X 1 1/8" OF OAK OR HICKORY.
3. CONSTRUCT SILT FENCE FROM A CONTINUOUS ROLL. IF POSSIBLE BY CUTTING LENGTHS TO AVOID JOINTS. IF A JOINT IS NECESSARY USE ONE OF THE FOLLOWING TWO METHODS: A) OVERLAP THE END POSTS AND TWIST, OR ROTATE, AT LEAST 180 DEGREES, B) HOOK THE END OF EACH SILT FENCE LENGTH.

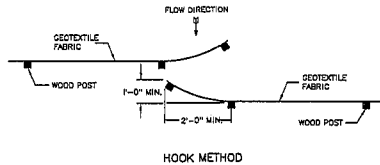
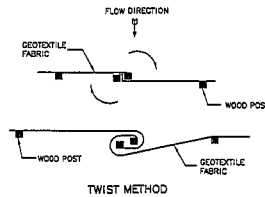

JOINING TWO LENGTHS OF SILT FENCE

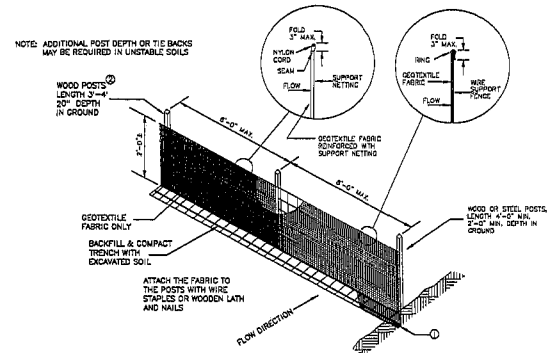

\* NOTE: 6\"/>

**SILT FENCE**

**Erosion Control Maintenance Plan**

1. Install and maintain temporary B.M.P.'s during the duration of the project. Remove silt fencing only after vegetation is established onsite and after final Town approval of all onsite reclamation. Final stabilization is defined as an established uniform perennial vegetative cover with an overall site density of at least 90%.
2. All temporary and permanent B.M.P.'s shall be inspected for conformance and proper operation after all rainfall events of 0.5 inches or greater within a 24 hour period. The owners representative shall repair and/or replace said B.M.P.'s as soon as possible where necessary.
3. All B.M.P.'s shall be inspected and maintained in accordance with current DNR Technical Standards.
4. Any sediment tracked onto a public road should be removed by mechanical means, not blasting, before the end of each working day.



<b>TOWN OF CEDARBURG</b>	
OZAUKEE COUNTY	WISCONSIN
<b>R. &amp; R. QUARRY - C.T.H. "I"</b>	
<b>Site Reclamation Details</b>	
DESIGNED: J.W.H.	CHECKED: D.E.O.
DATE: 7-10-2012	SCALE: -----
PROJECT: LS-3350	SHEET <b>8</b> OF <b>8</b>

NO.	DATE	BY	REVISION	CHKD.
1	3-28-13	J.C.S.	VARIOUS REVISIONS	J.W.H.
2	4-9-13	J.C.S.	CLEAN FILL NOTE	J.W.H.

**NSE NORTH SHORE ENGINEERING, INC.**  
 Consulting Engineers & Land Surveyors  
 11488 N. Post Wisconsin Rd., Menasha, Wisconsin, 54952  
 (920) 841-8400 • FAX: (920) 841-8337



THIS CERTIFIES THAT A

# NON-METALLIC RECLAMATION PERMIT

Has Been Issued To:

Owner: R & R EXCAVATING & BULLDOZING, INC.

Non-Metallic Mining Operator: SAME

Site Location: WEST SIDE OF HWY I (SHEBOYGAN ROAD)

Legal Description:

Part of the SE 1/4 of NE 1/4 of Section 22 In The Township 10 N-Range 21 E, Town of CEDARBURG; Parcel Identification Number 03-022-04-000.00 Date of Issue JUNE 28, 2013

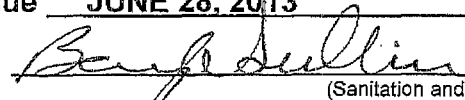
  
(Sanitation and Health Specialist)

Any changes of planned project or change in ownership must be reported to the Ozaukee County Department of Land and Water Management or this permit may be revoked.

## POST ON PREMISES IN PLAIN VIEW

121 W. MAIN STREET, P.O. BOX 994, PORT WASHINGTON, WI 53074-0994  
Phone: (262) 284 8313 Metro: (262) 238-8313 Fax: (262) 284-8367 Metro Fax: (262) 238-8367



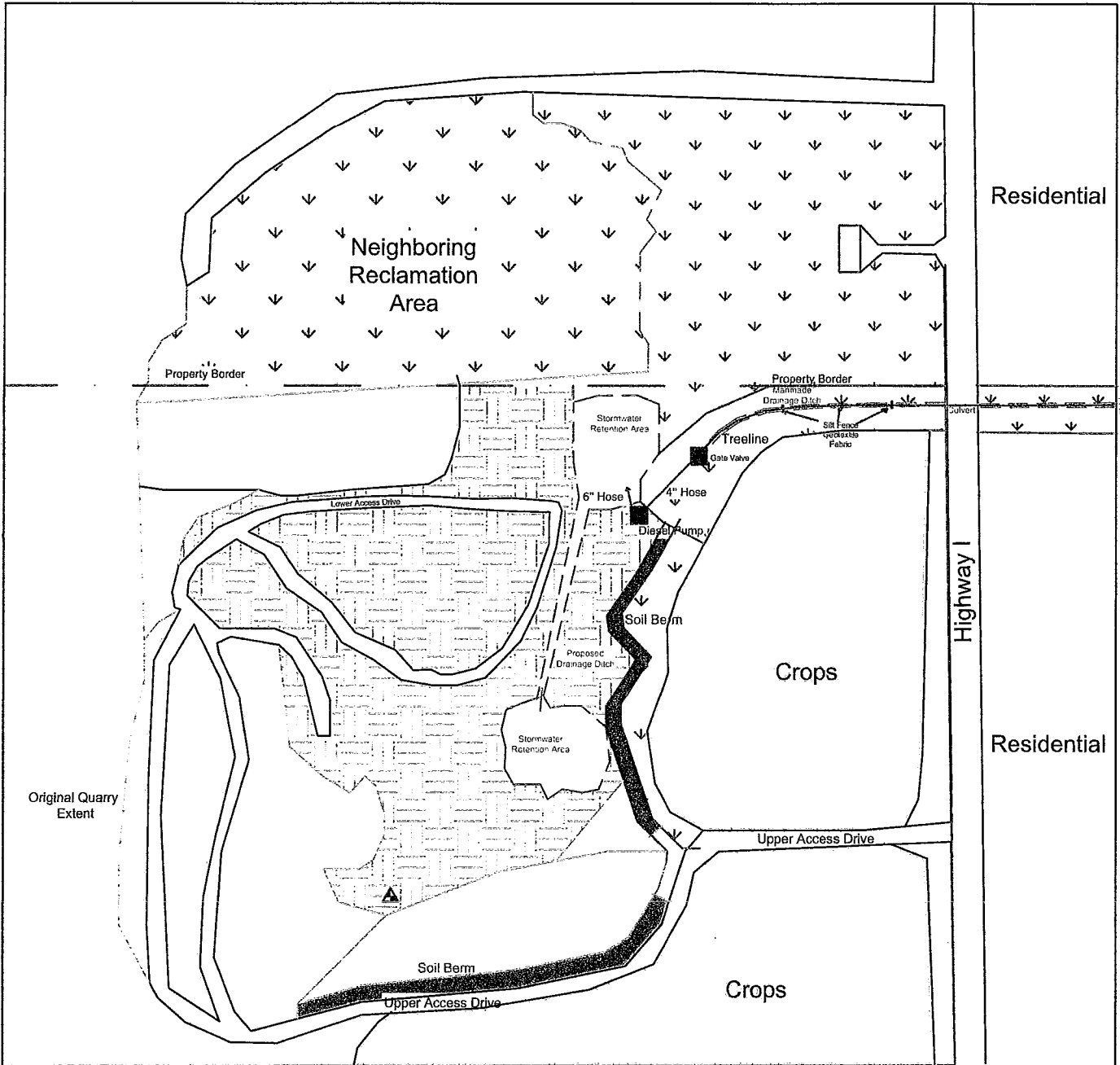

**KEY**

- ▲ = SI monitoring well
- = Filled Area
- ▨ = Area to be filled

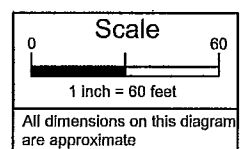
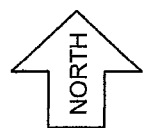

File No.: 041101a  
 DWG Date: 9-30-19  
 Rev Date: 10-2-19  
 Drawn By: BRF  
 Checked By (PM): TJO

**Site Features Diagram**  
 R&R Excavating Site  
 Milwaukee, Wisconsin

**Figure**  
 2

State of Wisconsin  
DEPARTMENT OF NATURAL RESOURCES  
Sturtevant Service Center  
9531 Rayne Road  
Sturtevant, WI 53177-1833

Tony Evers, Governor  
Preston D. Cole, Secretary  
Telephone (262) 884-2300  
Toll Free 1-888-936-7463  
TTY Access via relay - 711



October 17, 2019

Rick Frieseke  
Charmoli Holdings, LLC  
6635 North Sidney Place  
Milwaukee WI 53209  
Via email: rfrieseke@fecinc.us

SUBJECT: Coverage Under WPDES General Permit No. WI-S067831-05: Construction Site Storm Water Runoff  
Permittee Name: Charmoli Holdings, LLC  
Site Name: Former R&R Excavating site  
FIN: 68853

Dear Permittee:

The Wisconsin Department of Natural Resources received your Water Resources Application for Project Permits or Notice of Intent, on October 08, 2019, for the Former R&R Excavating site and has evaluated the information provided regarding storm water discharges from your construction site. We have determined that your construction site activities will be regulated under ch. 283, Wis. Stats., ch. NR 216, Wis. Adm. Code, and in accordance with Wisconsin Pollutant Discharge Elimination System (WPDES) General Permit No. WI-S067831-05, Construction Site Storm Water Runoff. All erosion control and storm water management activities undertaken at the site must be done in accordance with the terms and conditions of the general permit.

The **Start Date** of permit coverage for this site is October 17, 2019. The maximum period of permit coverage for this site is limited to 3 years from the **Start Date**. Therefore, permit coverage automatically expires and terminates 3 years from the Start Date and storm water discharges are no longer authorized unless another Notice of Intent and application fee to retain coverage under this permit or a reissued version of this permit is submitted to the Department 14 working days prior to expiration.

A copy of the general permit along with extensive storm water information including technical standards, forms, guidance and other documents is accessible on the Department's storm water program Internet site. To obtain a copy of the general permit, please download it and the associated documents listed below from the following Department Internet site:

<http://dnr.wi.gov/topic/stormwater/construction/forms.html>

- Construction Site Storm Water Runoff WPDES general permit No. WI-S067831-05
- Construction site inspection report form
- Notice of Termination form

If, for any reason, you are unable to access these documents over the Internet, please contact me and I will send them to you.

To ensure compliance with the general permit, please read it carefully and be sure you understand its contents. Please take special note of the following requirements (This is not a complete list of the terms and conditions of the general permit.):

1. The Construction Site Erosion Control Plan and Storm Water Management Plan that you completed prior to submitting your permit application must be implemented and maintained throughout construction. Failure to do so may result in enforcement action by the Department.

2. The general permit requires that erosion and sediment controls be routinely inspected at least every 7 days, and within 24 hours after a rainfall event of 0.5 inches or greater. Weekly written reports of all inspections must be maintained. The reports must contain the following information:

- a. Date, time, and exact place of inspection;
- b. Name(s) of individual(s) performing inspection;
- c. An assessment of the condition of erosion and sediment controls;
- d. A description of any erosion and sediment control implementation and maintenance performed;
- e. A description of the site's present phase of construction.

3. A **Certificate of Permit Coverage** must be posted in a conspicuous place on the construction site. The Certificate of Permit Coverage (WDNR Publication # WT-813) is enclosed for your use.

4. When construction activities have ceased and the site has undergone final stabilization, a Notice of Termination (NOT) of coverage under the general permit must be submitted to the Department.

It is important that you read and understand the terms and conditions of the general permit because they have the force of law and apply to you. Your project may lose its permit coverage if you do not comply with its terms and conditions. The Department may also withdraw your project from coverage under the general permit and require that you obtain an individual WPDES permit instead, based on the Department's own motion, upon the filing of a written petition by any person, or upon your request.

If you believe that you have a right to challenge this decision to grant permit coverage, you should know that the Wisconsin statutes and administrative rules establish time periods within which requests to review Department decisions must be filed. For judicial review of a decision pursuant to ss. 227.52 and 227.53, Wis. Stats., you have 30 days after the decision is mailed, or otherwise served by the Department, to file your petition with the appropriate circuit court and serve the petition on the Department. Such a petition for judicial review must name the Department of Natural Resources as the respondent.

To request a contested case hearing pursuant to s. 227.42, Wis. Stats., you have 30 days after the decision is mailed, or otherwise served by the Department, to serve a petition for hearing on the Secretary of the Department of Natural Resources. All requests for contested case hearings must be made in accordance with s. NR 2.05(5), Wis. Adm. Code, and served on the Secretary in accordance with s. NR 2.03, Wis. Adm. Code. The filing of a request for a contested case hearing is not a prerequisite for judicial review and does not extend the 30-day period for filing a petition for judicial review.

Thank you for your cooperation with the Construction Site Storm Water Discharge Permit Program. If you have any questions concerning the contents of this letter or the general permit, please contact Peter Wood, P.E. at (262) 884-2360.

Sincerely,

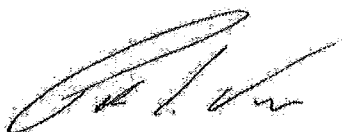

Peter Wood, P.E.  
Southeast Region  
Water Resources Engineer

ENCLOSURE: Certificate of Permit Coverage





# CERTIFICATE OF PERMIT COVERAGE

UNDER THE  
WPDES CONSTRUCTION SITE STORM WATER RUNOFF PERMIT  
Permit No. WI-S067831-05

Under s. NR 216.455(2), Wis. Adm. Code, landowners of construction sites with storm water discharges regulated by the Wisconsin Department of Natural Resources (WDNR) Storm Water Permit Program are required to post this certificate in a conspicuous place at the construction site. This certifies that the site has been granted WDNR storm water permit coverage. The landowner must implement and maintain erosion control practices to limit sediment-contaminated runoff to waters of the state in accordance with the permit.

## EROSION CONTROL COMPLAINTS

should be reported to the WDNR Tip Line at  
**1-800-TIP-WDNR (1-800-847-9367)**

Please provide the following information to the Tip Line:

WDNR Site No. (FIN): 68853

Site Name: Former R&R Excavating site

Address/Location: SE  $\frac{1}{4}$  of the NE  $\frac{1}{4}$ , Section 22, Township 10 N, Range 21 E Town of CEDARBURG

Additional Information:

Landowner: Charmoli Holdings, LLC

Landowner's Contact Person: Rick Frieseke

Contact Telephone Number: (414) 731-9875

Permit Start Date: October 17, 2019

By:  \_\_\_\_\_

WDNR Publication # WT-813 (10/11)