

24-Hour Emergency Hotline Number: 1-800-943-0003

Date & Military Time Of Incident: 04/02/2004, 02:50AM		Date & Military Time Reported: 04/02/2004, 04:30AM		Spill File # NOR04022004_01 <i>04-16-526925</i>	
Person Reporting: Mark Sitek		Representing: Enbridge Energy Co		Phone # (715-394-1410) Fax # ()	
Responsible Party (RP) / Spiller: <i>Enbridge Energy</i>		RP Decision Based On: <i>Facility owner</i>		Phone # () Fax # ()	
RP Address: 119 North 25th St East		City Superior		State WI	
RP Contact Name & Title: Mark Sitek		Phone # (715-394-1410) Fax # ()		Zip Code 54880	
Substance Involved: Crude Oil		Amount & Units Released: 2 Barrels		Amount & Units Recovered: unk	
<input type="checkbox"/> Solid <input type="checkbox"/> Semisolid <input checked="" type="checkbox"/> Liquid <input type="checkbox"/> Gas		Color:		Odor:	
Exact Location Of Incident: (including street name, bldg. #, mileage, etc.) 2800 East 21st St, Superior <i>Northeast of Tank #8</i>				Facility Name / Property Owner: <i>Enbridge Energy</i>	
<input checked="" type="checkbox"/> City <input type="checkbox"/> Village <input type="checkbox"/> Township Superior		County Douglas		Latitude/Longitude	
DNR Region: NOR		NW 1/4 NW 1/4 Sec 31 T 49N R 13 <input type="checkbox"/> E <input checked="" type="checkbox"/> W		Weather Conditions: 20°F, clear	
Cause Of Incident: "Caller reported that while performing maintenance on a pipeline a vapor plug let go and released 2 Barrels of crude oil onto the ground. There was also a small flash and smoke. The material released into the excavation pit which was made to access the pipeline."					
Spilled Substance Impact To: (check X all that apply)		Spill Cause/Site:		Action Taken By Spiller:	
<input type="checkbox"/> Air <input type="checkbox"/> Potential <input type="checkbox"/> Concrete/Asphalt <input type="checkbox"/> Potential <input type="checkbox"/> Contained/Recovered <input type="checkbox"/> Groundwater <input type="checkbox"/> Potential <input type="checkbox"/> Private Well <input type="checkbox"/> Potential <input type="checkbox"/> Sanitary Sewer <input type="checkbox"/> Potential <input checked="" type="checkbox"/> Soil <input checked="" type="checkbox"/> Potential <input type="checkbox"/> Storm Sewer <input type="checkbox"/> Potential <input type="checkbox"/> Surface Water <input type="checkbox"/> Potential Name: <input type="checkbox"/> Other:		<input type="checkbox"/> Ag Coop/Food Factory <input type="checkbox"/> Airport Facility <input type="checkbox"/> Railroad Facility <input type="checkbox"/> Construction, Excavation, Wrecking, Quarry, Mine <input type="checkbox"/> Gas/Service Station/Garage/Auto Dealer/Repair Shop <input type="checkbox"/> Hydraulic Line Break <input type="checkbox"/> Industrial Facility <input type="checkbox"/> Paper Mill <input type="checkbox"/> Chemical Co. <input checked="" type="checkbox"/> Pipeline/Terminal/Tank Farm/Oil Jobber/Wholesaler <input type="checkbox"/> Private Property (home/farm) <input type="checkbox"/> Public Property (city, state, church, school, etc.) <input type="checkbox"/> Transportation Accident, Fuel Tank Spill <input type="checkbox"/> Transportation Accident, Load Spill <input type="checkbox"/> Utility Co. Power Generating/Transfer Facility <input type="checkbox"/> Other:		<input type="checkbox"/> Cleanup Method: <input type="checkbox"/> Absorbent <input checked="" type="checkbox"/> Excavation <i>15 cu. yds</i> <input checked="" type="checkbox"/> Vacuum <input type="checkbox"/> Containment <input type="checkbox"/> Contractor Hired Name: <input type="checkbox"/> Monitor <input type="checkbox"/> No Action Needed <input type="checkbox"/> No Action Taken <input checked="" type="checkbox"/> Waste Destination: <i>Timberline Trac</i> <input type="checkbox"/> Other:	
Injuries? <input type="checkbox"/> Yes <input checked="" type="checkbox"/> No If yes how many?		Has An Evacuation Occurred? <input type="checkbox"/> Yes <input checked="" type="checkbox"/> No		Potential? <input type="checkbox"/> Yes <input checked="" type="checkbox"/> No	
Are There Any Resource Damages? <input type="checkbox"/> Yes <input checked="" type="checkbox"/> No <input type="checkbox"/> Potential What Kind?					
Other Agencies Notified: (check first column, if notified; check both columns, if on the scene)				Incident Commander:	
<input type="checkbox"/> Fire Department <input type="checkbox"/> Local Law Enforcement <input type="checkbox"/> LEPC or Local Emer. Mgt. <input type="checkbox"/> Level A/Level B Team		<input checked="" type="checkbox"/> Local DNR <input type="checkbox"/> Div. Emerg. Mgt. <input type="checkbox"/> Coast Guard <input type="checkbox"/> DHFS 608-258-0099		<input type="checkbox"/> EPA <input type="checkbox"/> Nat'l Resp Ctr 800-442-8802 <input type="checkbox"/> Chemtrec 800-424-9300 <input type="checkbox"/> Other:	
Prepared By: Katy Edwards		Phone # 608-267-7450		Date: 04/02/2004	
Person Notified: John Krull/C174		Phone # 715-392-7992		Date: 04/02/2004	
Investigated By:		Sign:		Date:	
Spill Coordinator Signoff: <i>Norman Dunbar</i>		Date: <i>6/1/04</i>		Incident Closed? <input checked="" type="checkbox"/> Yes <input type="checkbox"/> No Date: <i>6/1/04</i> NFA Letter Sent? <input type="checkbox"/> Yes <input checked="" type="checkbox"/> No Spill Packet Sent? <input type="checkbox"/> Yes <input checked="" type="checkbox"/> No To:	
<input type="checkbox"/> See Additional Comments On Reverse Please, print page 2 of 2					

State of Wisconsin Substance Release Report (Cont'd)
Form 4401-91 Rev 12-01

Date and Military Time Of Incident: 04/02/2004, 02:50 AM

Responsible Party:

Additional Comments : From an NRC Fax. Have not recieved a phone call regarding this incident. A fire was involved and extinguished. Remedial actions: Vac truck on site will be used to recover product, will remediate soil as necessary.

Case Activity Report: Yes No CAR#:

(Please, attach copy of all CAR and other documentation)

Enforcement Action: Yes No (Explain Below)

Enbridge Pipelines (Lakehead) L.L.C.
119 N. 25th Street East
Superior, WI 54880
Tel 715 394 1400
Fax 715 394 1570
www.enbridgepartners.com

Scott W. Lounsbury Supervisor, Environment
William VonSee Environmental Analyst
Kris H. Benson Environmental Analyst II
Paul R. Meneghini, P.E. Environmental Analyst II



May 26, 2004

Mr. Norm Dunbar
Wisconsin Department of Natural Resources
Northern Region
107 Sutliff Avenue
Rhineland, WI 54501

Re: Enbridge Superior Terminal
April 2, 2004 Leak
26" Piping Near Tank 8 – Hydrotest related

Dear Mr. Dunbar:

As a follow-up to our earlier conversations, I have prepared this letter to summarize Enbridge Energy Company (Enbridge) leak response activities concerning the above-referenced leak.

The leak occurred northeast of Tank #8. The location is identified on the attached figure. During hydrotest preparatory work on a 26" pipe, a vapor plug failed during welding operations, resulting in a flash. Approximately 2 barrels of oil were released from the pipe into the excavation. Sumps running in the excavation transported a small amount of oil into the adjacent terminal ditch. This oil was quickly contained with a berm and boom to about 50 feet of ditch.

The PLM crew quickly vacuumed up any free oil and scraped the excavation bottom and adjacent ditch until all visually stained soil was removed. A total of approximately 20.27 tons (15 cubic yards) of impacted soil was generated and temporarily stockpiled on-site. This soil was later hauled and disposed of at Waste Management's Timberline Trail Landfill in Weyerhaeuser, Wisconsin. A manifest and weight ticket is attached as documentation.

Based on the response activities completed, we are requesting closure of this release. If you agree, please forward written closure documentation for our records. Otherwise, please contact me if you require further documentation.

Sincerely,

A handwritten signature in blue ink, appearing to read 'Paul Meneghini', is written over the word 'Sincerely,'.

Paul Meneghini, P.E.
Environmental Analyst II

Attachments

TIMBERLINE TRAIL
RECYCLING & DISPOSAL FACILITY
BIOSITESM



A Waste Management Company

BILL TO: Enbridge Energy

TRANSPORTER: Foster Trucking

GENERATOR: Enbridge Energy

GENERATORS SIGNATURE: [Signature] Date 4/23/04

WASTE DESCRIPTION: Used Oil Impure Sol

PROFILE # TLT489370

ACCEPTED BY: [Signature] Date 4/23/04

DRIVERS SIGNATURE: [Signature] Date 4/23/04

42602 Vapor Plug Leak

TRUCK NO. 007 5027 TONS/YARDS

WHITE & YELLOW - TRANSPORTER COPY / PINK - DISPOSAL SITE COPY

DCE-018-96TT 7/02

REFERENCE NO.
781943

DRIVER SIGN HERE
LOCATION: 04/23/2004
ST Pet
WI 100%

DATE: 04/23/2004
TIME: 07:42 AM
TIME: 10:15 AM
NET: 20.870
TIMBERLINE TRAIL RDF
WASTE MANAGEMENT
P.O. BOX 160
BRUCE, WI 54819
COMMENTS: 504-1067

PROFILE NO.
MANIFEST NO. TLT489370
PERMIT NO.

CUSTOMER NO. TRUCK NO.
CUSTOMER: 0000346 291
LAKEHEAD PIPELINE

LOAD DESCRIPTION	LOAD QUANTITY	AMOUNT
Generator tax/fee	15.00	
Landfill seal	15.00	

159370

[Signature]

CUSTOMER COPY

LEGEND

- A-CONTROL BUILDING
- B-MANIFOLD BUILDING #1
- C-MANIFOLD BUILDING #2
- D-PUMPHOUSE (LOADING)
- E-UTILITY BUILDING
- F-SUBSTATION
- G-LINES 1,5,6, & AMOCO METER CONTROL BUILDING
- H-LINE 5 & AMOCO METERING AREA
- I-STA. #5 SWITCHGEAR BUILDING
- J-STA. #5 PUMPHOUSE
- K-STA. #5 PCV ENCLOSURE
- L-RECEIVING MANIFOLD CONTROL BUILDING
- M-MURPHY BOOSTER PUMPS
- N-STA. #6 PUMPHOUSE
- O-STA. #6 PCV ENCLOSURE

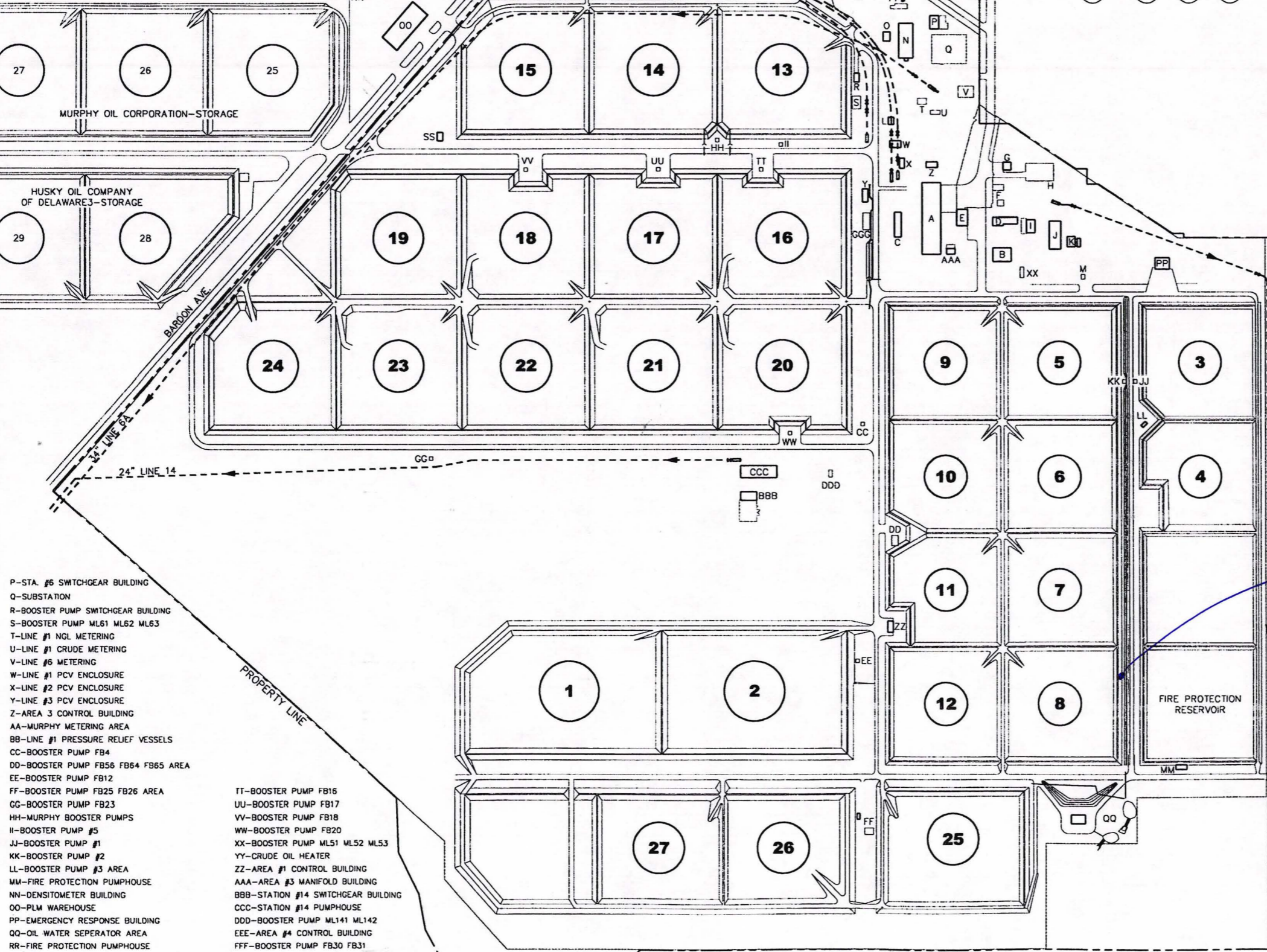

- P-STA. #6 SWITCHGEAR BUILDING
- Q-SUBSTATION
- R-BOOSTER PUMP SWITCHGEAR BUILDING
- S-BOOSTER PUMP ML61 ML62 ML63
- T-LINE #1 NGL METERING
- U-LINE #1 CRUDE METERING
- V-LINE #6 METERING
- W-LINE #1 PCV ENCLOSURE
- X-LINE #2 PCV ENCLOSURE
- Y-LINE #3 PCV ENCLOSURE
- Z-AREA 3 CONTROL BUILDING
- AA-MURPHY METERING AREA
- BB-LINE #1 PRESSURE RELIEF VESSELS
- CC-BOOSTER PUMP FB4
- DD-BOOSTER PUMP FB56 FB64 FB65 AREA
- EE-BOOSTER PUMP FB12
- FF-BOOSTER PUMP FB25 FB26 AREA
- GG-BOOSTER PUMP FB23
- HH-MURPHY BOOSTER PUMPS
- II-BOOSTER PUMP #5
- JJ-BOOSTER PUMP #1
- KK-BOOSTER PUMP #2
- LL-BOOSTER PUMP #3 AREA
- MM-FIRE PROTECTION PUMPHOUSE
- NN-DENSITOMETER BUILDING
- OO-PLM WAREHOUSE
- PP-EMERGENCY RESPONSE BUILDING
- QQ-OIL WATER SEPARATOR AREA
- RR-FIRE PROTECTION PUMPHOUSE
- SS-AREA #2 CONTROL SWITCHGEAR BUILDING
- TT-BOOSTER PUMP FB16
- UU-BOOSTER PUMP FB17
- VV-BOOSTER PUMP FB18
- WW-BOOSTER PUMP FB20
- XX-BOOSTER PUMP ML51 ML52 ML53
- YY-CRUDE OIL HEATER
- ZZ-AREA #1 CONTROL BUILDING
- AAA-AREA #3 MANIFOLD BUILDING
- BBB-STATION #14 SWITCHGEAR BUILDING
- CCC-STATION #14 PUMPHOUSE
- DDD-BOOSTER PUMP ML141 ML142
- EEE-AREA #4 CONTROL BUILDING
- FFF-BOOSTER PUMP FB30 FB31
- GGG-#3 MANIFOLD AREA

- V3
 - V2
 - V1
 - V4
 - V5
 - V6
- DOME PETROLEUM CORP.-STORAGE

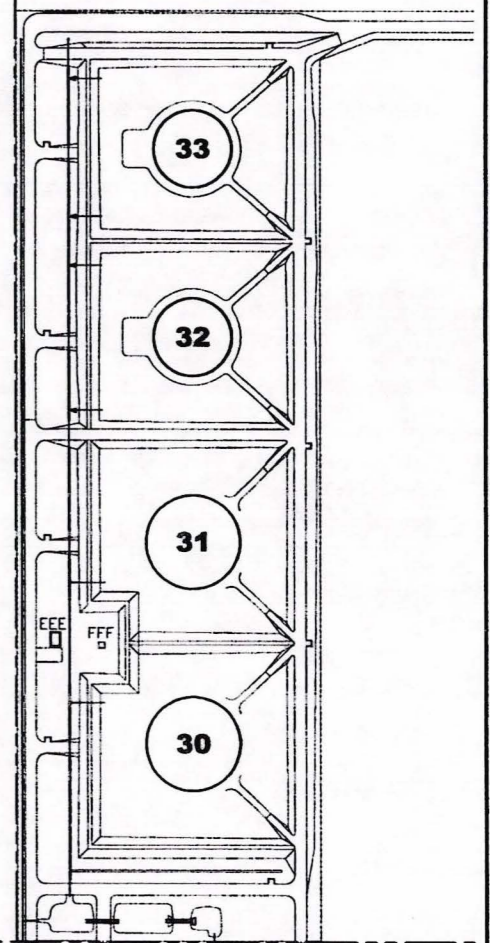
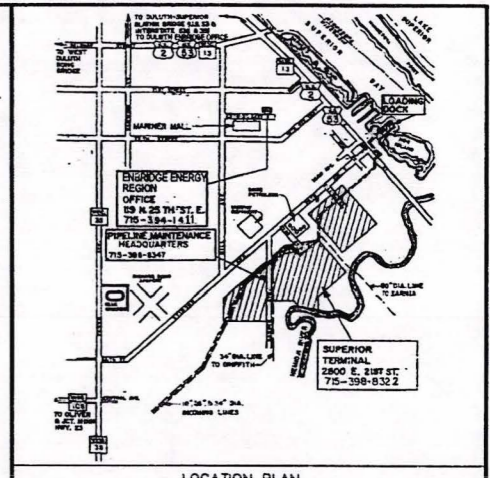

Location of 4/12/02 Leak

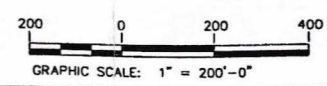

1	REVISED PER TERRACE III	JT	10/23/03	PJB
NO	REVISION	BY	DATE	APPR

ENBRIDGE Enbridge Energy, Limited Partnership

SUPERIOR (WI) TERMINAL

ADMINISTRATIVE PLOT PLAN

PROJECT: D-1.2-472-1-130

SCALE: 1" = 200'-0" DATE: 10/23/03 DRAWN: JT

CHECK: PJB APPR: DAC DATE: 10/23/03

APPR: [Signature]