



October 7, 2019

Mr. Nathan Willis
Wisconsin Department of Natural Resources
PO Box 7921
Madison, WI 53707-7921

Subject: Supplemental PFAS Sampling for WPDES Permit # WI 0048747-04-0 Renewal Application

Dear Mr. Willis:

The Dane County Regional Airport (Airport) is submitting the attached supplemental sampling data for select PFAS compounds as requested by the Wisconsin Department of Natural Resources as part of the Wisconsin Pollution Discharge Elimination System (WPDES) permit application. **Table 1** summarizes the supplemental sampling the Airport conducted for PFAS compounds.

Table 1. PFAS Sampling Summary

Sample Date	Precipitation	Outfalls Sampled
April 9, 2019	0.0	003, 032
April 10, 2019	0.32 (melting snow)	001, 003, 032, 034, 102
May 14, 2019	0.0	001, 003, 032, 101
June 4, 2019	0.53	003, 032, 101, 102

The location of the outfalls and their drainage areas are shown in **Attachment A**. The drainage area for outfalls 001, 002, and 034 is the same and includes the west ramp and the two deicing pads located adjacent to the south ramp. Outfall 001 is for stormwater runoff during the non-deicing season (typically mid-May to mid-October) and for runoff during the deicing season that meets the discharge requirements of the WPDES permit. Water that does not meet the discharge requirements of the WPDES permit, is discharged to outfall 002 (a sanitary sewer) after being pumped to underground storage tanks. Runoff that is pumped to the underground storage tanks and then found to meet the WPDES permit discharge requirements, can be discharge to outfall 034. Outfall 003 drains an area north and east of the west ramp. The Outfall 003 drainage area includes taxiways, runways, and infield areas. Outfall 032 drains an area east of the west ramp and includes the east ramp, the south ramp, part of the Truax Field Wisconsin Air National Guard (WI ANG) base, taxiways, runways, and infield areas. The Outfall 101 drainage area includes the containment areas for the WI ANG fuel tanks and fuel transfer areas. The Outfall 102 drainage area includes the containment area for the Wisconsin Army National Guard base fueling truck parking area.

Samples were collected by Mead & Hunt, Inc. and Airport personnel following sampling procedures in the Interstate Technology Regulatory Council's Site Characterization Considerations, Sampling Precautions, and Laboratory Analytical Methods for Per- and Polyfluoroalkyl Substances. Samples were sent to Vista Analytical Laboratory for PFAS analysis using the Modified EPA Method 537. The laboratory reports from the testing are presented in **Attachment B**. A summary of the laboratory results is presented in **Attachment C**.

Please contact me with any questions or comments on this information.

Sincerely,

Dane County Regional Airport

Michael J Kirchner, PE
Director of Engineering

Attachments

cc: Lt. Col. Dan Statz, 115 FW WI ANG
Tim Astfalk, Mead & Hunt, Inc.

These documents shall not be used for any purpose or project for which it is not intended. Mead & Hunt shall be indemnified by the client and held harmless from all claims, damages, liabilities, losses, and expenses, including attorneys' fees and costs, arising out of such misuse or reuse of the documents. In addition, unauthorized reproduction of these documents, in part or as a whole, is prohibited.

DANE COUNTY REGIONAL AIRPORT

MADISON, WISCONSIN









ISSUED

NOT FOR CONSTRUCTION

M&H NO.: 2309936-171981.01
DATE: July 8, 2019
DESIGNED BY: TJA
DRAWN BY: TJR
CHECKED BY: TJA
DO NOT SCALE DRAWINGS

SHEET CONTENTS
DRAINAGE AREA
BASEMAP -
ATTACHMENT A

SHEET NO. 1 of 1

- LEGEND**
-  DRAINAGE AREA
 -  DRAINAGE AREA FOR OUTFALLS 001/002/034
 -  DRAINAGE AREA FOR OUTFALL 032
 -  DRAINAGE AREA FOR OUTFALL 003
 -  DRAINAGE AREA FOR OUTFALL 101
 -  DRAINAGE AREA FOR OUTFALL 102
 -  FLOW DIRECTION
 -  IMPERVIOUS SURFACE

NOTE:
THIS DRAWING DEPICTS APPROXIMATE
LOCATIONS OF STORM SEWERS FROM
EXISTING DRAWINGS. STORM SEWER SITES &
LOCATIONS SHOULD BE FIELD VERIFIED PRIOR
TO DESIGN OR CONSTRUCTION.

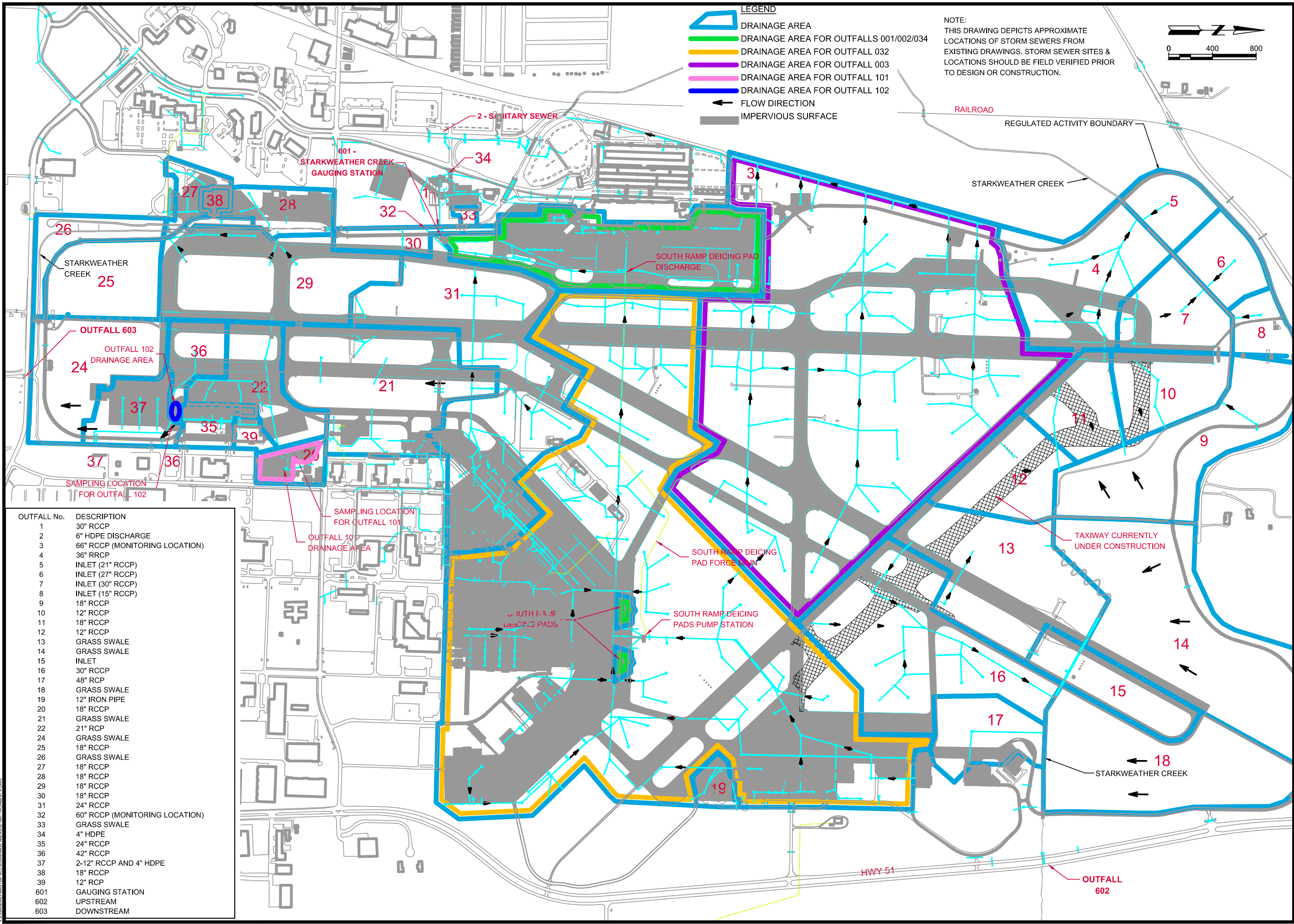

OUTFALL No.	DESCRIPTION
1	30" RCCP
2	6" HDPE DISCHARGE
3	66" RCCP (MONITORING LOCATION)
4	36" RRCP
5	INLET (21" RCCP)
6	INLET (27" RCCP)
7	INLET (30" RCCP)
8	INLET (15" RCCP)
9	18" RCCP
10	12" RCCP
11	18" RCCP
12	12" RCCP
13	GRASS SWALE
14	GRASS SWALE
15	INLET
16	30" RCCP
17	48" RCP
18	GRASS SWALE
19	12" IRON PIPE
20	18" RCCP
21	GRASS SWALE
22	21" RCP
24	GRASS SWALE
25	18" RCCP
26	GRASS SWALE
27	18" RCCP
28	18" RCCP
29	18" RCCP
30	18" RCCP
31	24" RCCP
32	60" RCCP (MONITORING LOCATION)
33	GRASS SWALE
34	4" HDPE
35	24" RCCP
36	42" RCCP
37	2-12" RCCP AND 4" HDPE
38	18" RCCP
39	12" RCP
601	GAUGING STATION
602	UPSTREAM
603	DOWNSTREAM

PROJECT: 2309936-171981.01
 DATE: 7/8/2019
 DRAWING: DRAINAGE AREA BASEMAP - ATTACHMENT A.DWG

