

US Army Corps
of Engineers®
Omaha District

TRUAX FIELD ANGB, WISCONSIN FIGHTER ALERT SHELTERS PN XGFG189004 (FY20)

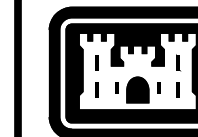

US Army Corps
of Engineers®

MARK	DESCRIPTION	DATE

DESIGNED BY: L. CRAIG	ISSUE DATE: OCTOBER 2019
DRAWN BY: C. CRAIG	SOLICITATION NO.:
CHECKED BY: L. CRAIG	CONTRACT NO.:
SUBMITTED BY: L. CRAIG	FILE NUMBER: F113-40-01
ANSI D:	FILENAME: TX05G-001.dgn
U.S. ARMY CORPS OF ENGINEERS OMAHA DISTRICT 1616 CAPITOL AVE OMAHA, NE 68102	

SOLICITATION NO.:
CONTRACT NO.:
ISSUE DATE: OCTOBER 2019

THIS PROJECT WAS DESIGNED BY THE OMAHA DISTRICT OF THE US ARMY CORPS OF ENGINEERS. THE INITIALS OR SIGNATURES AND REGISTRATION DESIGNATIONS OF INDIVIDUALS APPEAR ON THESE PROJECT DOCUMENTS WITHIN THE SCOPE OF THEIR EMPLOYMENT AS REQUIRED BY ER 1110-1-8152

SIGNATURES AFFIXED BELOW INDICATE OFFICIAL RECOMMENDATION AND APPROVAL OF DRAWINGS IN THIS SET.

CHIEF, GEOTECHNICAL ENGINEERING & SCIENCES BRANCH	DATE	SUBMITTED BY:	RA	SECTION
CHIEF, DAM SAFETY PROD. CENTER	DATE	SUBMITTED BY:	PE	SECTION
CHIEF, DESIGN BRANCH	DATE	SUBMITTED BY:	PE	SECTION
CHIEF, HYDROLOGIC ENGINEERING BRANCH	DATE	SUBMITTED BY:	PE	SECTION
CHIEF, ENGINEERING DIVISION, P.E.	DATE	SUBMITTED BY:	CADD	PROJECT COORD.

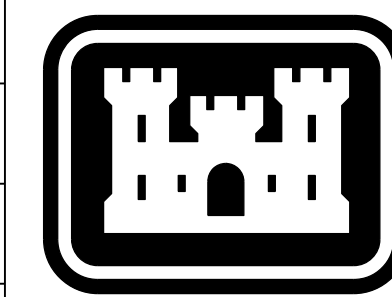

US Army Corps
of Engineers
Omaha District

TRUAX FIELD ANGB, WISCONSIN
FIGHTER ALERT SHELTERS
PN XGFG189004 (FY20)

COVER SHEET

SHEET ID
G-001

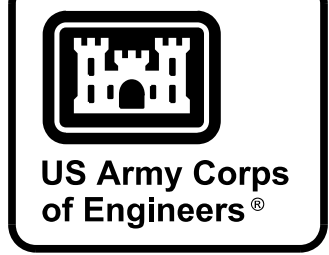
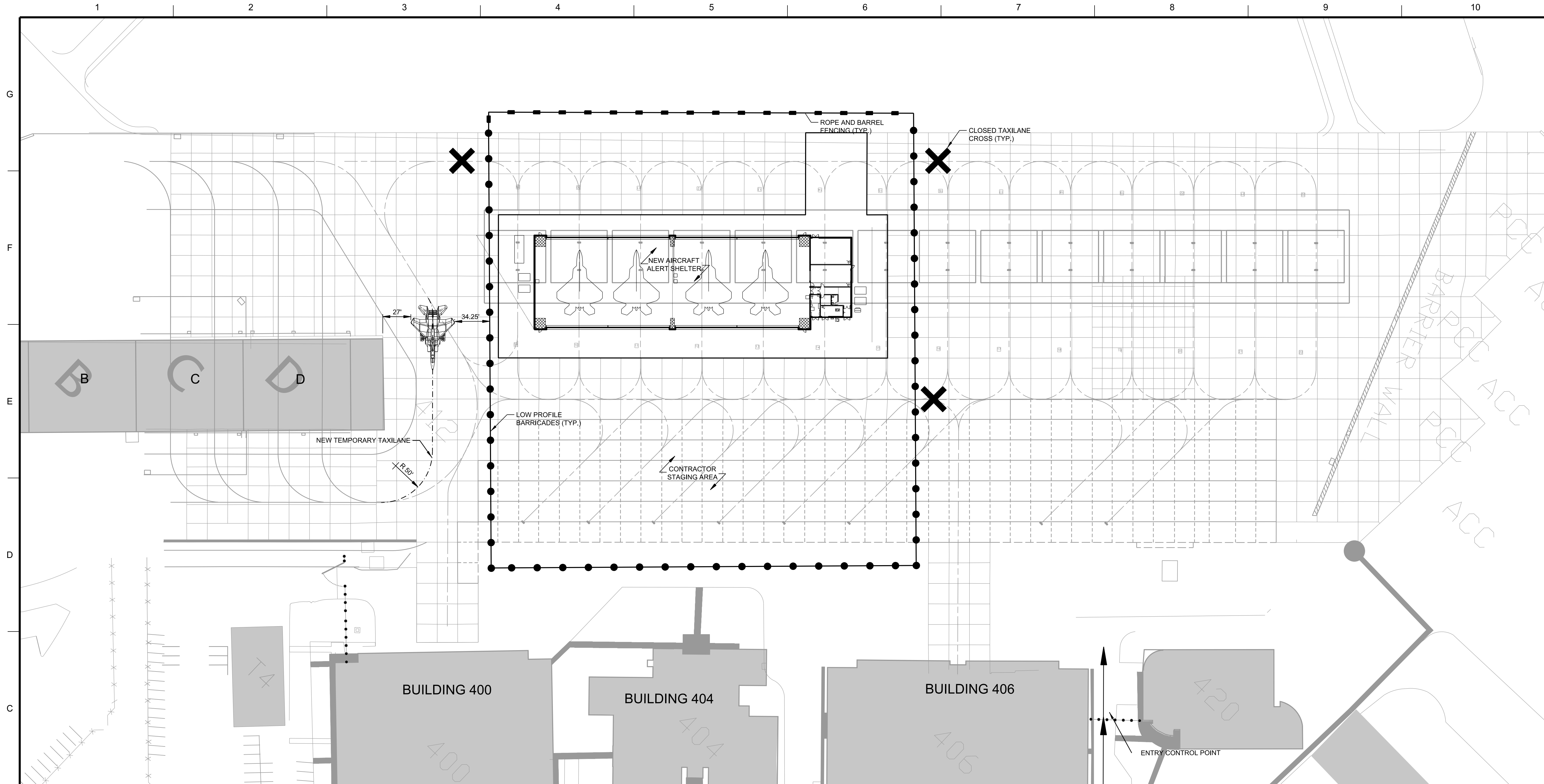

DESIGNED BY: B. GOLBER	ISSUE DATE: 10/02/2019	MARK	DATE
DRAWN BY: B. GOLBER	SOLICITATION NO.:		
CHECKED BY: M. HUCKLE	CONTRACT NO.:		
SUBMITTED BY: B. FLERE	FILE NUMBER: F113-40-01		
SIZE: ANSI D	FILENAME: TX05CB101.dwg		

DESIGNED BY: B. GOLBER	ISSUE DATE: 10/02/2019	MARK	DATE
DRAWN BY: B. GOLBER	SOLICITATION NO.:		
CHECKED BY: M. HUCKLE	CONTRACT NO.:		
SUBMITTED BY: B. FLERE	FILE NUMBER: F113-40-01		
SIZE: ANSI D	FILENAME: TX05CB101.dwg		

U.S. ARMY CORPS OF ENGINEERS
OMAHA DISTRICT
1616 CAPITOL AVE
OMAHA, NE 68102

TRIAUX FIELD ANGB, WISCONSIN
FIGHTER ALERT SHELTERS
PN XGFG189004 (FY20)

PHASING PLAN

SHEET ID
CB101

NOTES:

- SEE SHEET CB100 FOR CONTRACTOR STAGING / STORAGE / BATCH PLANT / TRAILER AREA AND HAUL ROUTE REQUIREMENTS.
- SEE SHEET CB102 FOR LOW PROFILE BARRICADE AND ROPE AND BARREL FENCE DETAILS.
- CONTRACTOR FREE ZONE TO BE DELINEATED BY A COMBINATION OF LOW PROFILE BARRICADES AND ROPE AND BARREL FENCING. INSTALL LOW PROFILE BARRICADES AT ALL LOCATIONS WHERE FREE ZONE LIMITS CROSS PAVED AIRFIELD PAVEMENTS INCLUDING SHOULDER PAVEMENT. INSTALL ROPE AND BARREL FENCE AT ALL LOCATIONS WHERE FREE ZONE LIMITS CROSS NON-PAVED (TURFED) AREAS.

CONSTRUCTION PHASING NOTES
PHASING PROVIDED HEREIN IS ESTABLISHED TO MAINTAIN AIRCRAFT OPERATIONAL CAPABILITY AND CONTINUAL ACCESS TO ANGB FACILITIES DURING CONSTRUCTION. THE CONTRACTOR SHALL BE ALLOWED ACCESS TO A LIMITED NUMBER OF CONSTRUCTION AREA ZONES (CAZ) AT ANY ONE TIME. DO NOT INITIATE WORK UNTIL THE CONTRACTOR'S SCHEDULE DEMONSTRATES THE ABILITY TO COMPLETE THIS WORK WITHIN THE TIME FRAME REQUIRED AND IS APPROVED BY THE CONTRACTING OFFICER. PROVIDE A TWENTY-ONE DAY WRITTEN NOTICE IN ADVANCE, THROUGH THE CONTRACTING OFFICER, COORDINATING WORK WITHIN EACH CONSTRUCTION AREA ZONE.

1. WORK AREA & ACCESS LIMITATIONS

A. ESTABLISH ACCESS TO THE SITE PRIOR TO INITIATING ANY WORK. COORDINATE ACCESS WITH AND OBTAIN APPROVAL BY THE AIRFIELD MANAGER, THROUGH THE CONTRACTING OFFICER. ACCESS TO AND FROM WORK AT THE SITE IS LIMITED TO DAYLIGHT HOURS UNLESS ADDITIONAL HOURS ARE REQUESTED BY THE CONTRACTOR AND APPROVED BY THE CONTRACTING OFFICER. ALL AREAS WITHIN THE AIRFIELD SECURITY FENCE AND ALL HAUL ROUTES SHOWN ON SHEET G-002 ARE CONSIDERED A FREE ZONE, I.E. A GOVERNMENT ESCORT IS NOT REQUIRED.

B. NOTIFY THE AIRFIELD MANAGER, THROUGH THE CONTRACTING OFFICER'S REPRESENTATIVE, 30 DAYS IN ADVANCE OF INSTALLING TEMPORARY PAVEMENT MARKINGS.

C. INSTALL THE TEMPORARY TAXILANE, AS SHOWN ON THIS SHEET, PRIOR TO BEGINNING ANY WORK ON THE APRON. ALL WORK REQUIRED TO INSTALL THE TEMPORARY TAXILANE WILL OCCUR OUTSIDE OF THE CONSTRUCTION AREA FREE ZONE SHOWN ON THIS SHEET. OBTAIN A GOVERNMENT ESCORT FOR WORK OUTSIDE OF THE CONSTRUCTION AREA FREE ZONE.

D. AT THE COMPLETION OF THE PROJECT, REMOVE THE TEMPORARY PAVEMENT MARKINGS AND INSTALL ALL NEW PAVEMENT MARKINGS AS SHOWN ON SHEET CS101.

2. CONSTRUCTION PHASING

A. NO DEMOLITION OF EXISTING AIRFIELD PAVEMENT UNTIL THE CONTRACTOR HAS AN APPROVED CONCRETE MIX DESIGN CONFORMING TO SPECIFICATION 32 13 14.13 CONCRETE PAVEMENTS FOR AIRFIELDS AND OTHER HEAVY DUTY PAVEMENTS.

B. RE-ESTABLISH EXISTING PAVEMENT MARKINGS AND ALL EXISTING UTILITIES REMOVED OR DAMAGED BY THE CONTRACTOR TO MATCH EXISTING CONDITION PRIOR TO CONSTRUCTION.

3. GENERAL REQUIREMENTS

A. ALL VEHICLES REQUIRE COMPANY MARKINGS, FLASHING BEACONS, AND FLIGHT LINE PASSES DISPLAYED. INSPECT ALL ACTIVE AIRFIELD PAVEMENTS TRAFFICKED BY THE CONTRACTOR'S CONSTRUCTION EQUIPMENT HOURLY BY THE CONTRACTOR TO DETERMINE IF FOREIGN OBJECT DEBRIS (FOD) IS PRESENT. REMOVE ALL FOD FOUND ON AIRFIELD PAVEMENTS WITHIN 1-HOUR OF DISCOVERY. PROVIDE A SELF-CONTAINED PAVEMENT VACUUMING TRUCK WHICH IS SPECIFICALLY MANUFACTURED TO CLEAN AIRFIELD PAVEMENTS. OPERATE THE VACUUM TRUCK CONTINUOUSLY DURING CONTRACTOR HAULING OPERATIONS.

B. AN ESCORT WILL BE REQUIRED FOR ALL PERSONNEL INSTALLING THE TEMPORARY PARKING POSITION AND TAXILANE MARKINGS. AN ESCORT WILL BE REQUIRED FOR ALL PERSONNEL IN CHARGE OF ESTABLISHING THE CONSTRUCTION FREE ZONES AS SHOWN ON THIS SHEET. AFTER THE CONSTRUCTION FREE ZONE HAS BEEN ESTABLISHED THE CONTRACTOR WILL NOT BE REQUIRED TO BE ESCORTED TO THE CONSTRUCTION AREA ZONES.

3. GENERAL REQUIREMENTS (CONT)

C. CONTINUOUSLY VACUUM SWEEP ALL HAUL ROUTES AND CONSTRUCTION AREA FREE ZONES.

D. RESTORE ALL HAUL ROUTES BACK TO ORIGINAL CONDITION BY REPAIRING POTHOLES, RUTS AND SOFT YIELDING SPOTS.

E. THE HAUL ROUTES WILL BE USED BY THE SECURITY POLICE AND OTHER PERSONNEL DURING CONSTRUCTION.

F. MAINTAIN ALL HAUL ROUTES SO THEY REMAIN PASSABLE AT ALL TIMES.

G. HAVE A PERSON AVAILABLE 24 HOURS A DAY FOR EMERGENCY MAINTENANCE OF LOW PROFILE BARRICADES AND HAZARD LIGHTS AND ROPE AND BARREL FENCING. INITIATE AND COMPLETE REPAIRS OF LOW PROFILE BARRICADES AND HAZARD LIGHTS AND ROPE AND BARREL FENCING WITHIN ONE HOUR OF BEING NOTIFIED BY THE CONTRACTING OFFICER'S REPRESENTATIVE.

H. COORDINATE ALL WORK ON THE AIRFIELD WITH THE AIRFIELD MANAGER AND ANGB BASE OPERATIONS AND THE CONTRACTING OFFICER.

I. ALL CONTRACTOR VEHICLES AND EQUIPMENT WILL BE INSPECTED BY GOVERNMENT SECURITY FORCES PRIOR TO ACCESS TO WISCONSIN ANGB. ONLY ONE SET OF GOVERNMENT SECURITY FORCES WILL BE INSPECTING VEHICLES ONE VEHICLE AT A TIME. THEREFORE, STRATEGICALLY SCHEDULE PERSONNEL ACCESS AND MATERIAL DELIVERIES TO AVOID DELAYS. THE ENTRY CONTROL POINT (ECP), WHICH SHALL BE USED AS THE CONTRACTOR'S ACCESS POINT TO THE CONSTRUCTION SITE, WILL BE MANNED BY GOVERNMENT SECURITY FORCES. THE ECP WILL BE MANNED THE SAME HOURS AS THE MAIN GATE. SEE HAUL ROUTE NOTE 7 ON SHEET G-002 FOR GATE HOURS. FOURTEEN DAYS IN ADVANCE, THE CONTRACTOR MAY REQUEST EXTENDED HOURS OF GATE ACCESS THROUGH THE CONTRACTING OFFICER. GATE HOURS ARE SUBJECT TO CHANGE.

J. DO NOT OPERATE STEEL BUCKET OR BLADE EQUIPMENT WITH THE BUCKET OR BLADE IN DIRECT CONTACT WITH ANY PAVEMENT TO REMAIN AT ANY TIME. STEEL BUCKET OR BLADE EQUIPMENT MAY BE USED TO REMOVE/REPLACE EXISTING BASE AND SUBGRADE MATERIALS.

3. GENERAL REQUIREMENTS (CONT)

K. STOCKPILING OF BASE COURSE AND SUBGRADE MATERIALS WILL NOT BE ALLOWED ON THE APRON DURING CONSTRUCTION.

L. MAXIMUM EQUIPMENT HEIGHT ALLOWABLE ON THE APRON SHALL NOT EXCEED 20'.

M. COMPLY WITH ALL ASPECTS OF UFC 3-260-01, SECTION 14 CONSTRUCTION PHASING PLAN AND OPERATIONAL SAFETY ON AIRFIELDS DURING CONSTRUCTION AND FAA AC 150 5370-2f OPERATIONAL SAFETY ON AIRPORTS DURING CONSTRUCTION. PROVIDE THE AIRFIELD MANAGER ALL INFORMATION REQUIRED FOR HIM TO SUBMIT FAA FORM 7460-1 PRIOR TO CONSTRUCTION.

N. PROTECT ALL EXISTING AIRFIELD LIGHTS AND/OR NAVAIDS DURING CONSTRUCTION. IF AN EXISTING AIRFIELD LIGHTS AND/OR NAVAIDS IS DAMAGED BY THE CONTRACTOR, IMMEDIATELY NOTIFY THE CONTRACTING OFFICER. REPAIR OR REPLACE THE DAMAGED AIRFIELD LIGHTS AND/OR NAVAIDS AT NO ADDITIONAL COST TO THE GOVERNMENT. REPAIR ALL DAMAGES TO THE CONTRACTING OFFICER'S SATISFACTION.

4. SPECIAL REQUIREMENTS

1. COORDINATE AIRCRAFT MOVEMENTS WITH THE AIRFIELD MANAGER, OPERATIONS PERSONNEL AND THE CONTRACTING OFFICER WEEKLY.

LEGEND:

- LOW PROFILE BARRICADES - SEE NOTE 2
- ROPE AND BARREL FENCING - SEE NOTE 2
- ➔➔➔➔➔➔ CONTRACTOR HAUL ROUTE

SCALE: 1" = 50' - 0"

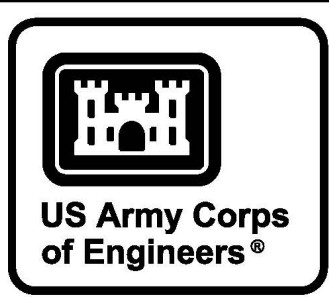
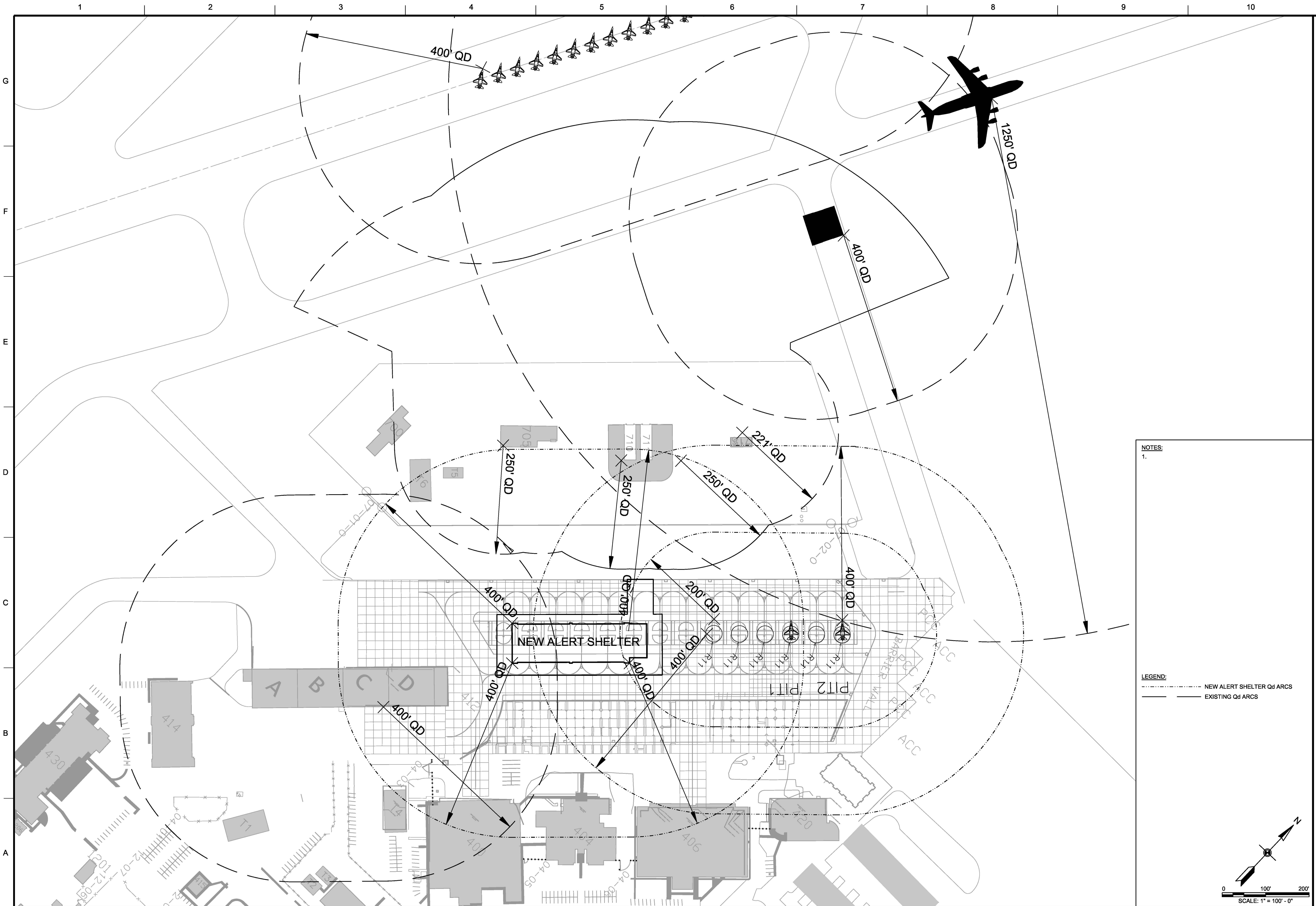

MARK	DESCRIPTION	DATE

DESIGNED BY: B. GOLBER	ISSUE DATE: 10/15/2019
DRAWN BY: B. GOLBER	SOLICITATION NO.:
CHECKED BY: M. HUCKLE	CONTRACT NO.:
SUBMITTED BY: B. FLERE	FILE NUMBER: F113-40-01
SIZE: ANSI D	FILENAME: TX05CS100.dwg

U.S. ARMY CORPS OF ENGINEERS
OMAHA DISTRICT
1616 CAPITOL AVE
OMAHA, NE 68102

TRUAX FIELD ANGB, WISCONSIN
FIGHTER ALERT SHELTERS
PN XGFG189004 (FY20)

OVERALL SITE PLAN

SHEET ID
CS100

NOTES:
1.

LEGEND:
 - - - - - NEW ALERT SHELTER Qd ARCS
 ———— EXISTING Qd ARCS

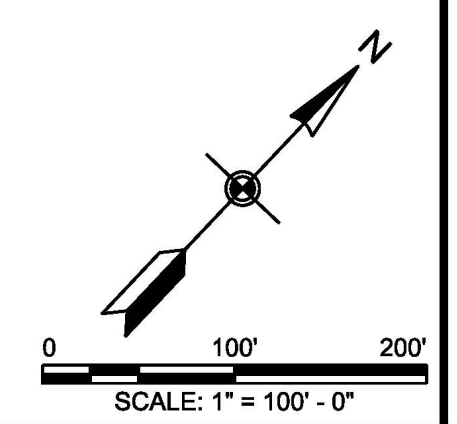

1 2 3 4 5 6 7 8 9 10

G
F
E
D
C
B
A

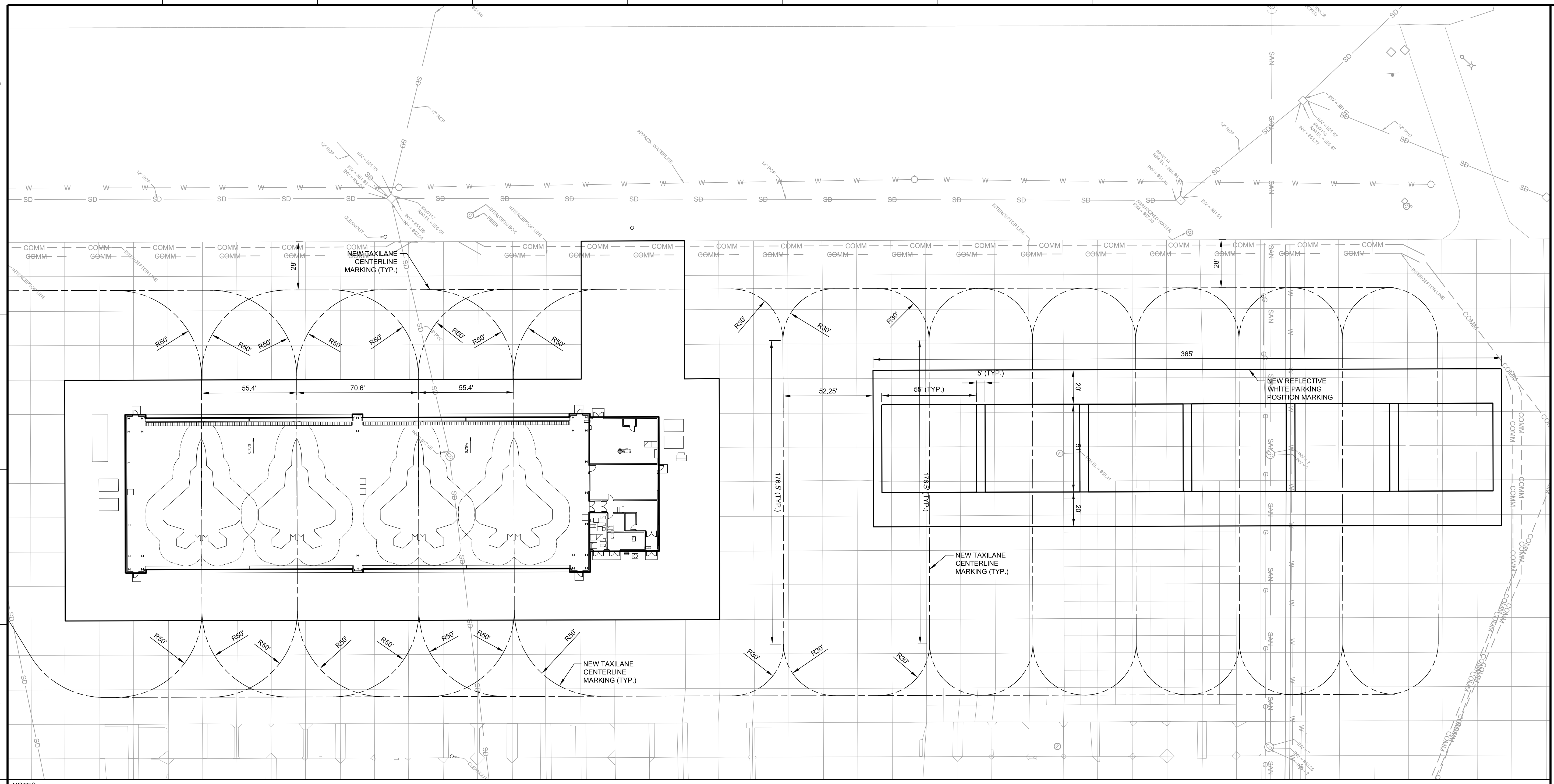

NOTES:

- 1. SEE SHEET CS501 FOR PAVEMENT MARKING DETAILS.
- 2. EXISTING PAVEMENT MARKINGS NOT WITHIN THE PAVEMENT REMOVAL AREA, OR INDICATED TO BE REMOVED, THAT ARE MARRED OR REMOVED BY THE CONTRACTOR'S OPERATIONS SHALL BE ENTIRELY REMOVED AND REPLACED BY THE CONTRACTOR AT HIS OWN EXPENSE.

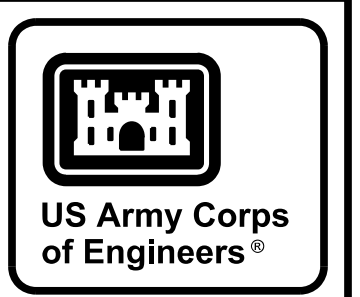

MARK	DESCRIPTION	DATE

ISSUE DATE: 10/15/2019	SOLICITATION NO.:
DESIGNED BY: B. GOLBER	CONTRACT NO.:
CHECKED BY: M. HUCKLE	FILE NUMBER: F113-40-01
SUBMITTED BY: B. FLERE	FILENAME: TX05CS101.dwg
SIZE:	

U.S. ARMY CORPS OF ENGINEERS
OMAHA DISTRICT
1616 CAPITOL AVE
OMAHA, NE 68102

SITE PLAN

TRUAX FIELD ANGE, WISCONSIN
FIGHTER ALERT SHELTERS
PN XGFG189004 (FY20)

SHEET ID
CS101

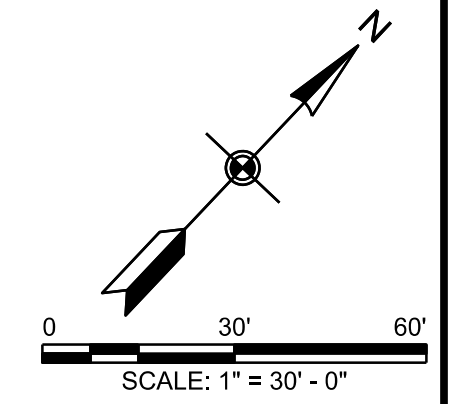

1 2 3 4 5 6 7 8 9 10

G
F
E
D
C
B
A

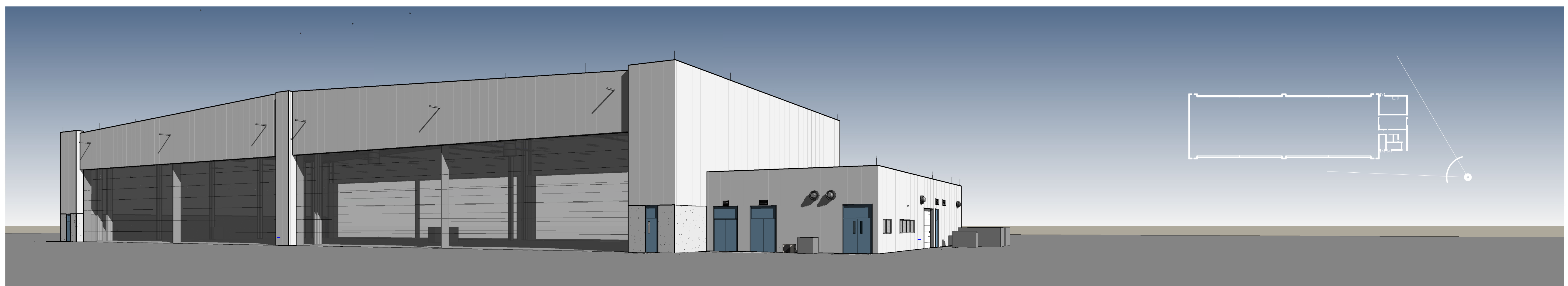

1 PERSPECTIVE - PLAN SOUTHEAST CORNER

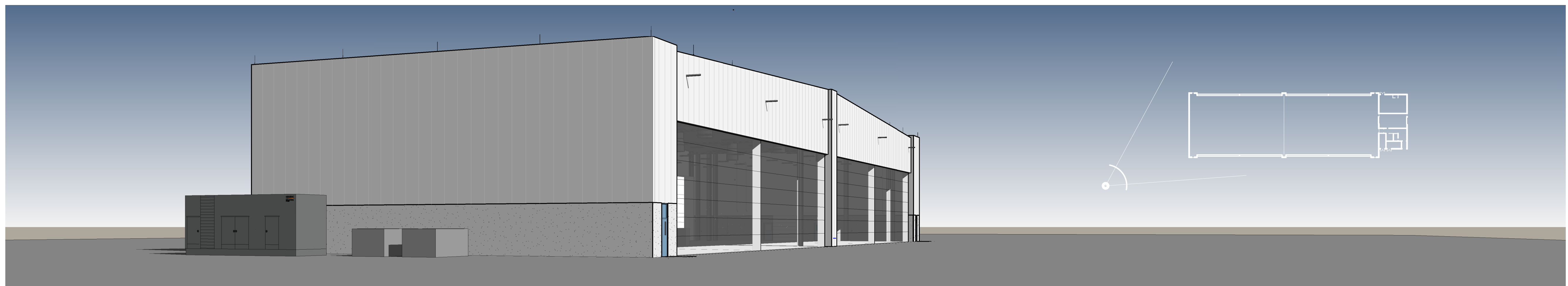

2 PERSPECTIVE - PLAN SOUTHWEST CORNER

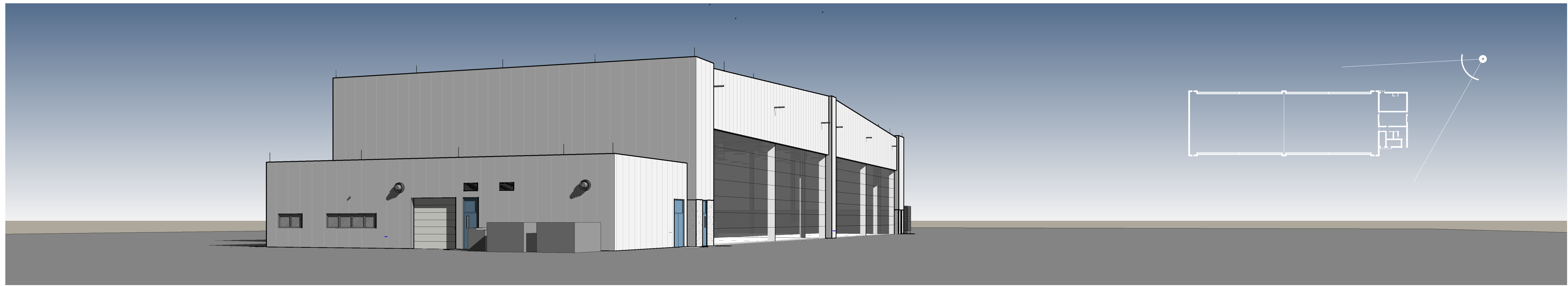

3 PERSPECTIVE - PLAN NORTHEAST CORNER



US Army Corps of Engineers ©

MARK	DESCRIPTION	DATE

DESIGNED BY: R. AHLERS	ISSUE DATE: 10-04-2019
DRAWN BY: Checker	SOLICITATION NO.:
CHECKED BY: Checker	CONTRACT NO.:
SUBMITTED BY:	FILE NUMBER F113-40-01
FILE NAME TX05 ALRT-SHLTRV1	SIZE ANSI D

US ARMY CORPS OF ENGINEERS
 OMAHA DISTRICT
 1616 CAPITOL AVENUE
 OMAHA, NE 68102

TRUXAV FIELD ANGB, WISCONSIN
 FIGHTER ALERT SHELTERS
 PN XGFG189004 (FY20)

BUILDING PERSPECTIVE

SHEET ID
 A-900

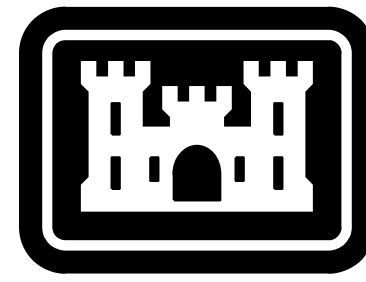

**US Army Corps
of Engineers®**
OMAHA DISTRICT

TRUAX FIELD ANGB, WISCONSIN REPAIR APRON PN XGFG182005

SOLICITATION NO.: W9128F-R-20-XXXX
CONTRACT NO.: W9128F-C-20-XXXX
ISSUE DATE: FEBRUARY 2020

DESIGN FILE	FILE NUMBER	SHEET NO.	DESCRIPTION
GENERAL			
TX07_G-001.DWG		G-001	COVER SHEET
TX07_G-002.DWG		G-002	PROJECT LOCATION PLAN
TX07_C-001.DWG		C-001	PHASING PLAN & NOTES
TX07_C-002.DWG		C-002	LOW PROFILE BARRICADE & ROPE AND BARREL FENCE DETAILS
GEOTECHNICAL			
TX07_B-101.DWG		B-101	BORING LOCATION PLAN
TX07_B-301.DWG		B-301	BORING LOGS
EXISTING CONDITIONS			
TX07_VF101.DWG		VF101	EXISTING CONDITIONS PLAN
CIVIL			
TX07_CD101.DWG		CD101	REMOVAL PLAN
TX07_CD201.DWG		CD201	PAVEMENT REMOVAL SECTIONS
TX07_CP100.DWG		CP100	GEOMETRIC CONTROL PLAN
TX07_CP101.DWG		CP101	PAVING PLAN
TX07_CP201.DWG		CP201	PAVEMENT REPLACEMENT SECTIONS
TX07_CP401.DWG		CP401	JOINT LAYOUT PLAN
TX07_CP501.DWG		CP501	JOINT DETAILS
TX07_CP502.DWG		CP502	JOINT SEALANT DETAILS
TX07_CP503.DWG		CP503	REINFORCEMENT DETAILS
TX07_CP504.DWG		CP504	GROUNDING POINT DETAILS
TX07_CP701.DWG		CP701	PAVEMENT MARKING PLAN
TX07_CP801.DWG		CP801	PAVEMENT MARKING DETAILS
TX07_CG101.DWG		CG101	GRADING PLAN
TX07_CG401.DWG		CG401	SPOT ELEVATION PLAN
ELECTRICAL			
TX07_ED101.DWG		ED101	ELECTRICAL REMOVAL PLAN
TX07_ES101.DWG		ES101	ELECTRICAL SITE PLAN
TX07_ES501.DWG		ES501	BURIED SENSOR LINE (BSL) TYPICAL DETAILS
TX07_ES502.DWG		ES502	BURIED SENSOR LINE (BSL) TYPICAL DETAILS
TX07_ES503.DWG		ES503	BURIED SENSOR LINE (BSL) SITE DETAILS
TX07_ES504.DWG		ES504	BURIED SENSOR LINE (BSL) SITE DETAILS

INDEX

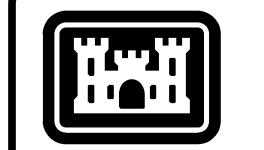

US Army Corps
of Engineers®

DATE	DESCRIPTION	MARK

DESIGNED BY: B. GOLBER	ISSUE DATE: FEBRUARY 2020
DRAWN BY: B. GOLBER	PROJECT NO.: W9128F-R-20-XXXX
CHECKED BY: M. HUCKLE	CONTRACT NO.: W9128F-C-20-XXXX
SUBMITTED BY: B. FLERE	FILE NUMBER: F113-10-01
FILE NAME: ANSID	FILE SIZE: TX07_G-001.dwg

U.S. ARMY CORPS OF ENGINEERS
OMAHA DISTRICT
1616 CAPITOL AVENUE
OMAHA, NE 68102

TRUAX FIELD ANGB, WISCONSIN
REPAIR APRON
PN XGFG182005

COVER SHEET

SHEET ID
G-001

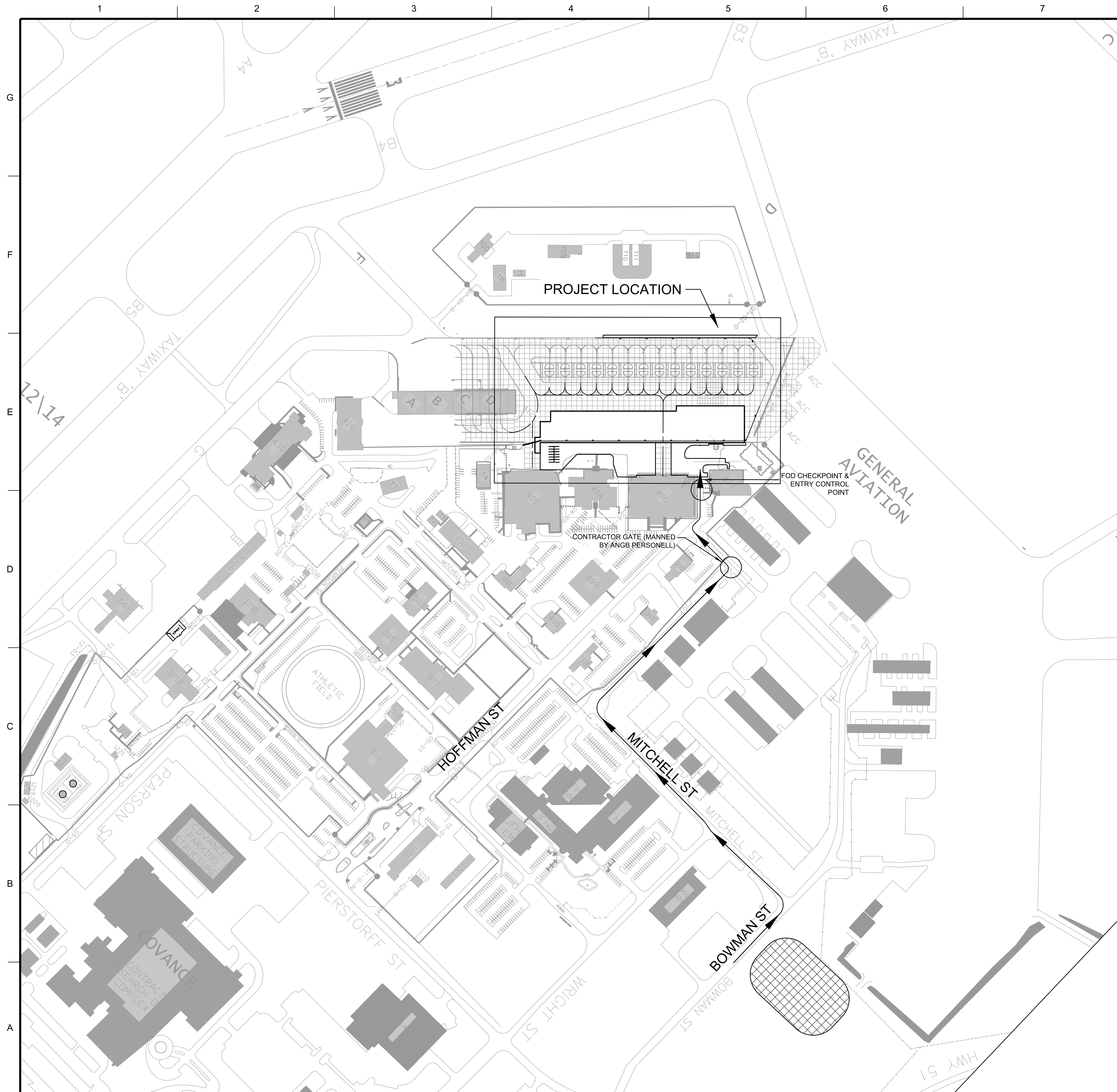

BATCH PLANT NOTES:

1. LOCATE THE CONCRETE BATCH PLANT / CONTRACTOR STAGING AREA AT THE LOCATION SHOWN ON THIS SHEET.
2. PERFORM A SITE SURVEY PRIOR TO IMPROVING THE BATCH PLANT / STAGING AREA. INSPECT THE BATCH PLANT / STAGING AREA WITH THE CONTRACTING OFFICER'S REPRESENTATIVE AND WISCONSIN ANGB CIVIL ENGINEERING REPRESENTATIVE TO ESTABLISH THE EXISTING CONDITION. LEVEL THE BATCH PLANT / STAGING AREA IMPROVEMENTS AND GRADE THE SITE TO MATCH THE EXISTING GRADE OUTSIDE OF THE BATCH PLANT / STAGING AREA AT THE COMPLETION OF THE PROJECT. TOPSOIL WITH 4" OF TOPSOIL AND SEED ALL DISTURBED AREAS.
3. IMPROVE THE BATCH PLANT AREA TO MEET THE CONTRACTOR'S NEEDS. IMPROVEMENTS INCLUDE BUT ARE NOT LIMITED TO GRADING, INSTALLING DRAINAGE SYSTEMS, INSTALLING STORM WATER BEST MANAGEMENT PRACTICES AND IMPORTING AGGREGATE MATERIALS TO PROVIDE A STABLE WORKING PLATFORM.
4. THE CONTRACTOR MAY ELECT TO INSTALL A CHAIN LINK SECURITY FENCE WITH LOCKING GATE AROUND THE PERIMETER OF THE BATCH PLANT AREA FOR SECURITY; NO SECURITY MEASURES ARE PROVIDED BY THE GOVERNMENT. REMOVE THE CHAIN LINK FENCE PRIOR TO CONTRACT COMPLETION.
5. PROVIDE OBSTRUCTION LIGHT FIXTURES (AVIATION RED INCANDESCENT STEADY BURNING FAA AC 150/5345-43, TYPE L-810) FOR THE BATCH PLANT. LED TYPE OBSTRUCTION LIGHT FIXTURES ARE NOT ACCEPTABLE.
6. POWER AVAILABLE FOR CONTRACTOR USE WITHIN THE BATCH PLANT LOCATION SHOWN. CONTRACTOR SHALL INSTALL A METER AND REIMBURSE THE ELECTRICAL UTILITY COMPANY FOR ALL ELECTRICITY USED. COORDINATE WITH MG & E (MADISON GAS AND ELECTRIC). CONTRACTOR TO PROVIDE AND CONNECT HIS OWN STEP-DOWN TRANSFORMER TO PROVIDE USABLE POWER FOR THE BATCH PLANT AND OTHER FACILITIES. JACK-AND-BORE THE POWER LINE UNDER ANY ROADS. NOTIFY WISCONSIN ANGB CES, THROUGH THE CONTRACTING OFFICER, 14 DAYS IN ADVANCE OF CONNECTING TO THE POWER SOURCE.
7. WATER AVAILABLE FOR CONTRACTOR USE WITHIN THE BATCH PLANT LOCATION SHOWN. CONTRACTOR TO PROVIDE AND INSTALL A BACKFLOW PREVENTER AND WATER METER DOWNSTREAM OF THE WATER SUPPLY. CONTRACTOR SHALL REIMBURSE THE CITY OF MADISON FOR ALL WATER USED. CONTRACTOR SHALL COORDINATE WITH THE CITY OF MADISON FOR PAYMENT AND METERING REQUIREMENTS. CONTRACTOR TO PROVIDE OWN CONNECTION AND MEANS OF CONVEYING WATER TO THE BATCH PLANT. NOTIFY WISCONSIN ANGB CES, THROUGH THE CONTRACTING OFFICER, 14 DAYS IN ADVANCE OF CONNECTING TO THE WATER SUPPLY.

HAUL ROUTE NOTES:

1. CONDUCT A SITE SURVEY FOR ALL HAUL ROUTES AND SURROUNDING AREAS PRIOR TO BEGINNING ANY WORK. INSPECT THE HAUL ROUTES PRIOR TO CONTRACTOR TRAFFIC TO ESTABLISH THE EXISTING HAUL ROUTE CONDITION WITH THE CONTRACTOR, CONTRACTING OFFICER'S REPRESENTATIVE AND WISCONSIN ANGB CIVIL ENGINEERING REPRESENTATIVE. RESTORE ALL HAUL ROUTES BACK TO THE ORIGINAL CONDITION BY REPAIRING POTHoles, RUTS AND SOFT YIELDING SPOTS. DOCUMENT THE INSPECTION WITH A DETAILED REPORT AND EITHER VIDEO OR PHOTOGRAPHS AND SUBMITTED TO THE CONTRACTING OFFICER REPRESENTATIVE AS A FORMAL SUBMITTAL. UPON COMPLETION OF THE PROJECT, RESTORE ALL ROADS TO ORIGINAL OR BETTER CONDITION.
2. MAKE ALL ROAD IMPROVEMENTS NECESSARY TO PROVIDE A USEABLE SURFACE FOR CONSTRUCTION TRAFFIC. MAINTAIN ALL ROADS WHILE WORKING ON THE PROJECT. RESTORE THE ROADS TO ORIGINAL PRE-PROJECT CONDITION UPON COMPLETION OF ALL HAULING ACTIVITIES.
3. IMPLEMENT A DUST CONTROL PLAN FOR ALL HAUL ROUTES DURING HAULING OPERATIONS FOR THE ENTIRE DURATION OF THE CONTRACT.
4. MAINTAIN THE HAUL ROUTES SO THEY REMAIN PASSABLE AT ALL TIMES. MAINTAIN THE HAUL ROUTES SO THAT MUD AND/OR OTHER DEBRIS IS NOT PICKED UP BY TRUCK TIRES AND TRAFFICKED ON ANY AIRFIELD PAVEMENTS. SEE SHEET C-001 FOR DAILY FOD CONTROL REQUIREMENTS.
5. SEE SHEET C-001 FOR ADDITIONAL ACCESS, GENERAL NOTES, AND RESTORATION NOTES.
6. ALL CONTRACTOR DELIVERIES AND CONTRACTOR PERSONNEL ARE REQUIRED TO ACCESS THE WISCONSIN ANGB THROUGH THE CONTRACTOR'S ACCESS GATE. ACCESS THE WORK SITE THROUGH THE ENTRY CONTROL POINT SHOWN ON SHEET C-001.
7. ALL CONTRACTOR VEHICLES AND EQUIPMENT WILL BE INSPECTED BY GOVERNMENT SECURITY FORCES PRIOR TO ACCESS TO WISCONSIN ANGB. THEREFORE, STRATEGICALLY SCHEDULE PERSONNEL ACCESS AND MATERIAL DELIVERIES TO AVOID ACCESS DELAYS. THE CONTRACTOR ACCESS GATE WILL BE MANNED BY GOVERNMENT PERSONNEL DURING THE HOURS LISTED HERE:
 MONDAY - FRIDAY: 0630 THRU 1630
 SATURDAY, SUNDAY AND GOVERNMENT HOLIDAYS: CLOSED
 FOURTEEN DAYS IN ADVANCE, THROUGH THE CONTRACTING OFFICER, THE CONTRACTOR MAY REQUEST EXTENDED HOURS OF GATE ACCESS.

GENERAL NOTE:

1. SEE SHEET C-001 FOR THE LOCATION OF THE CONSTRUCTION FREE ZONE.

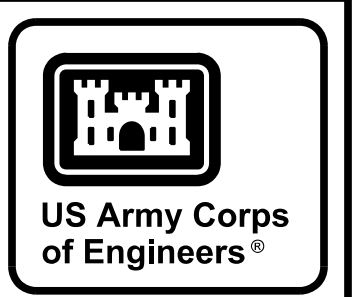
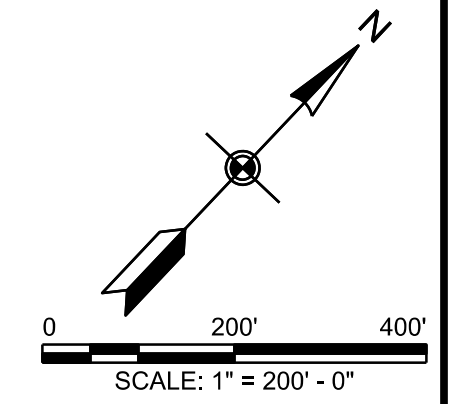
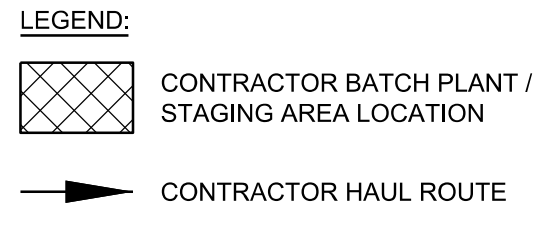

MARK	DESCRIPTION	DATE

DESIGNED BY: B. GOLBER	ISSUE DATE: FEBRUARY 2020
CHECKED BY: M. HUCKLE	PROJECT NO. / CONTRACT NO. / FILE NUMBER: W9128F-C-20-XXXX / F113-10-01
U.S. ARMY CORPS OF ENGINEERS OMAHA DISTRICT 1616 CAPITOL AVENUE OMAHA, NE 68102	TX07_G-002.dwg

TRUAX FIELD ANGB, WISCONSIN
REPAIR APRON
PN XGFG162005

PROJECT LOCATION PLAN

SHEET ID
G-002

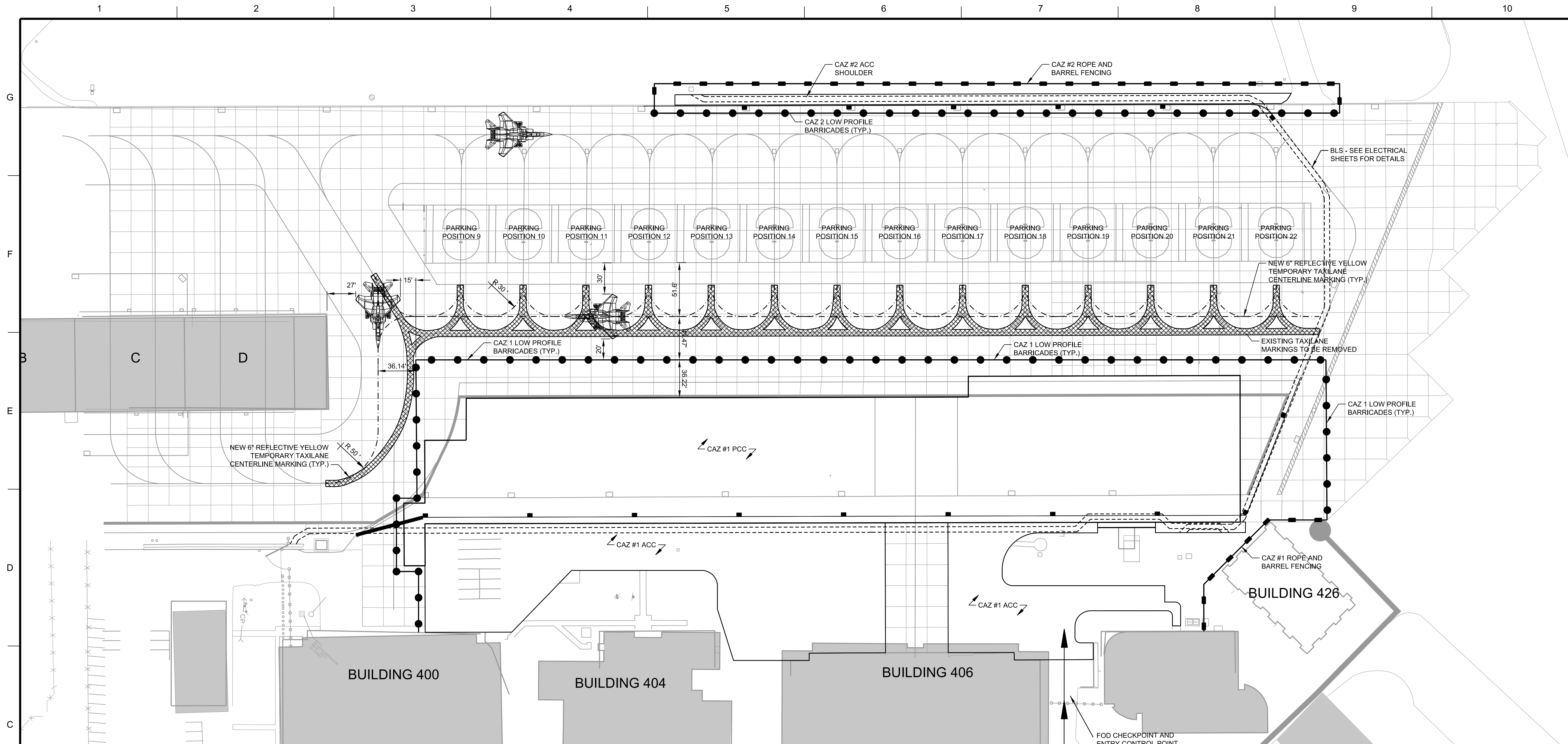

NOTES:

- SEE SHEET G-002 FOR CONTRACTOR STAGING / STORAGE / BATCH PLANT / TRAILER AREA AND HAUL ROUTE REQUIREMENTS.
- SEE SHEET C-102 FOR LOW PROFILE BARRICADE AND ROPE AND BARREL FENCE DETAILS.
- CONTRACTOR FREE ZONE TO BE DELINEATED BY A COMBINATION OF LOW PROFILE BARRICADES AND ROPE AND BARREL FENCING. INSTALL LOW PROFILE BARRICADES AT ALL LOCATIONS WHERE FREE ZONE LIMITS CROSS PAVED AIRFIELD PAVEMENTS INCLUDING SHOULDER PAVEMENT. INSTALL ROPE AND BARREL FENCE AT ALL LOCATIONS WHERE FREE ZONE LIMITS CROSS NON-PAVED (TURFED) AREAS.

CONSTRUCTION PHASING NOTES

PHASING, PROVIDED HEREIN, IS ESTABLISHED TO MAINTAIN AIRCRAFT OPERATIONAL CAPABILITY AND CONTINUAL ACCESS TO ANGB FACILITIES DURING CONSTRUCTION. THE CONTRACTOR SHALL BE ALLOWED ACCESS TO A LIMITED NUMBER OF CONSTRUCTION AREA ZONES (CAZ) AT ANY ONE TIME. DO NOT INITIATE WORK UNTIL THE CONTRACTOR'S SCHEDULE DEMONSTRATES THE ABILITY TO COMPLETE THIS WORK WITHIN THE TIME FRAME REQUIRED AND IS APPROVED BY THE CONTRACTING OFFICER. PROVIDE A TWENTY-ONE DAY WRITTEN NOTICE IN ADVANCE, THROUGH THE CONTRACTING OFFICER, COORDINATING WORK WITHIN EACH CONSTRUCTION AREA ZONE.

1. WORK AREA & ACCESS LIMITATIONS

- ESTABLISH ACCESS TO THE SITE PRIOR TO INITIATING ANY WORK. COORDINATE ACCESS WITH AND OBTAIN APPROVAL BY THE AIRFIELD MANAGER, THROUGH THE CONTRACTING OFFICER. ACCESS TO AND FROM WORK AT THE SITE IS LIMITED TO DAYLIGHT HOURS UNLESS ADDITIONAL HOURS ARE REQUESTED BY THE CONTRACTOR AND APPROVED BY THE CONTRACTING OFFICER. ALL AREAS WITHIN THE AIRFIELD SECURITY FENCE AND ALL HAUL ROUTES SHOWN ON SHEET G-002 ARE CONSIDERED A FREE ZONE, I.E. A GOVERNMENT ESCORT IS NOT REQUIRED.
- NOTIFY THE AIRFIELD MANAGER, THROUGH THE CONTRACTING OFFICER'S REEPRESENTATIVE, 30 DAYS IN ADVANCE OF INSTALLING TEMPORARY PAVEMENT MARKINGS.
- INSTALL THE TEMPORARY PARKING POSITION MARKINGS AND TEMPORARY TAXILANES, AS SHOWN ON THIS SHEET, PRIOR TO BEGINNING ANY WORK ON THE APRON. ALL WORK REQUIRED TO INSTALL THE TEMPORARY PAVEMENT MARKINGS WILL OCCUR OUTSIDE OF THE CONSTRUCTION AREA FREE ZONE SHOWN ON THIS SHEET. OBTAIN A GOVERNMENT ESCORT FOR WORK OUTSIDE OF THE CONSTRUCTION AREA FREE ZONE.
- AT THE COMPLETION OF THE PROJECT, REMOVE THE TEMPORARY PAVEMENT MARKINGS AND INSTALL ALL NEW PAVEMENT MARKINGS AS SHOWN ON SHEET CP701.

2. CONSTRUCTION PHASING

- THE CONSTRUCTION OF THE APRON WILL BE IN TWO PHASES (CAZ 1 AND CAZ 2). CAZ 1 WILL BE THE CONSTRUCTION OF THE PCC APRON AND ASSOCIATED ASPHALT. CAZ 2 WILL BE THE CONSTRUCTION OF THE ASPHALT SHOULDER AND THE INSTALLATION OF THE BURIED SENSOR LINE (BSL).
- CAZ 1 AND CAZ 2 MAY BE CONSTRUCTED CONCURRENTLY.
- ALL CONSTRUCTION OF THE ASPHALT SHOULDER PAVEMENT WITHIN CAZ 2 SHALL BE COMPLETE WITHIN 30 DAYS OF BEGINNING WORK WITHIN THE CAZ 2 AREA.
- DURING CAZ 2 APRON WORK, THE MAIN TAXILANE WILL BE CLOSED TO AIRCRAFT OPERATION. PARKING SPOTS 13 THRU 22 WILL BE AVAILABLE FOR AIRCRAFT TO USE, BUT AIRCRAFT WILL BE REQUIRED TO BE TOWED IN AND OUT OF THE PARKING SPOTS TO PREVENT JET BLAST FROM AFFECTING THE WORKERS WITHIN CAZ 2.

3. GENERAL REQUIREMENTS

- NO DEMOLITION OF EXISTING AIRFIELD PAVEMENT UNTIL THE CONTRACTOR HAS AN APPROVED CONCRETE MIX DESIGN CONFORMING TO SPECIFICATION 32 13 14.13 CONCRETE PAVEMENTS FOR AIRFIELDS AND OTHER HEAVY DUTY PAVEMENTS AND AN APPROVED HMA JOB MIX FORMULA CONFORMING TO 32 12 15.13 HOT-MIX ASPHALT AIRFIELD PAVING.
- RE-ESTABLISH EXISTING PAVEMENT MARKINGS AND ALL EXISTING UTILITIES REMOVED OR DAMAGED BY THE CONTRACTOR TO MATCH EXISTING CONDITION PRIOR TO CONSTRUCTION.
- PHASING OF THE APRON MARKING IS REQUIRED. SEE SHEETS CP700 THRU CP702 FOR APRON PAVEMENT MARKING PHASING PLANS.

3. GENERAL REQUIREMENTS (CONT)

- ALL VEHICLES REQUIRE COMPANY MARKINGS, FLASHING BEACONS, AND FLIGHT LINE PASSES DISPLAYED. INSPECT ALL ACTIVE AIRFIELD PAVEMENTS TRAFFICKED BY THE CONTRACTOR'S CONSTRUCTION EQUIPMENT HOURLY BY THE CONTRACTOR TO DETERMINE IF FOREIGN OBJECT DEBRIS (FOD) IS PRESENT. REMOVE ALL FOD FOUND ON AIRFIELD PAVEMENTS WITHIN 1-HOUR OF DISCOVERY. PROVIDE A SELF-CONTAINED PAVEMENT VACUUMING TRUCK WHICH IS SPECIFICALLY MANUFACTURED TO CLEAN AIRFIELD PAVEMENTS. OPERATE THE VACUUM TRUCK CONTINUOUSLY DURING CONTRACTOR HAULING OPERATIONS.
- AN ESCORT WILL BE REQUIRED FOR ALL PERSONNEL INSTALLING THE TEMPORARY PARKING POSITION AND TAXILANE MARKINGS. AN ESCORT WILL BE REQUIRED FOR ALL PERSONNEL IN CHARGE OF ESTABLISHING THE CONSTRUCTION FREE ZONES AS SHOWN ON THIS SHEET. AFTER THE CONSTRUCTION FREE ZONE HAS BEEN ESTABLISHED THE CONTRACTOR WILL NOT BE REQUIRED TO BE ESCORTED TO THE CONSTRUCTION AREA ZONES.

3. GENERAL REQUIREMENTS (CONT)

- CONTINUOUSLY VACUUM SWEEP ALL HAUL ROUTES AND CONSTRUCTION AREA FREE ZONES.
- RESTORE ALL HAUL ROUTES BACK TO ORIGINAL CONDITION BY REPAIRING POTHOLE, RUTS AND SOFT YIELDING SPOTS.
- THE HAUL ROUTES WILL BE USED BY THE SECURITY POLICE AND OTHER PERSONNEL DURING CONSTRUCTION.
- MAINTAIN ALL HAUL ROUTES SO THEY REMAIN PASSABLE AT ALL TIMES.
- HAVE A PERSON AVAILABLE 24 HOURS A DAY FOR EMERGENCY MAINTENANCE OF LOW PROFILE BARRICADES AND HAZARD LIGHTS AND ROPE AND BARREL FENCING. INITIATE AND COMPLETE REPAIRS OF LOW PROFILE BARRICADES AND HAZARD LIGHTS AND ROPE AND BARREL FENCING WITHIN ONE HOUR OF BEING NOTIFIED BY THE CONTRACTING OFFICER'S REPRESENTATIVE.
- COORDINATE ALL WORK ON THE AIRFIELD WITH THE AIRFIELD MANAGER AND ANGB BASE OPERATIONS AND THE CONTRACTING OFFICER.
- ALL CONTRACTOR VEHICLES AND EQUIPMENT WILL BE INSPECTED BY GOVERNMENT SECURITY FORCES PRIOR TO ACCESS TO WISCONSIN ANGB. ONLY ONE SET OF GOVERNMENT SECURITY FORCES WILL BE INSPECTING VEHICLES ONE VEHICLE AT A TIME. THEREFORE, STRATEGICALLY SCHEDULE PERSONNEL ACCESS AND MATERIAL DELIVERIES TO AVOID DELAYS. THE ENTRY CONTROL POINT (ECP), WHICH SHALL BE USED AS THE CONTRACTOR'S ACCESS POINT TO THE CONSTRUCTION SITE, WILL BE MANNED BY GOVERNMENT SECURITY FORCES. THE ECP WILL BE MANNED THE SAME HOURS AS THE MAIN GATE. SEE HAUL ROUTE NOTE 7 ON SHEET G-002 FOR GATE HOURS. FOURTEEN DAYS IN ADVANCE, THE CONTRACTOR MAY REQUEST EXTENDED HOURS OF GATE ACCESS THROUGH THE CONTRACTING OFFICER. GATE HOURS ARE SUBJECT TO CHANGE.
- DO NOT OPERATE STEEL BUCKET OR BLADE EQUIPMENT WITH THE BUCKET OR BLADE IN DIRECT CONTACT WITH ANY PAVEMENT TO REMAIN AT ANY TIME. STEEL BUCKET OR BLADE EQUIPMENT MAY BE USED TO REMOVE/REPLACE EXISTING BASE AND SUBGRADE MATERIALS.
- STOCKPILING OF BASE COURSE AND SUBGRADE MATERIALS WILL NOT BE ALLOWED ON THE APRON DURING CONSTRUCTION.
- MAXIMUM EQUIPMENT HEIGHT ALLOWABLE ON THE APRON SHALL NOT EXCEED 20'.

3. GENERAL REQUIREMENTS (CONT)

- COMPLY WITH ALL ASPECTS OF UFC 3-260-01, SECTION 14 CONSTRUCTION PHASING PLAN AND OPERATIONAL SAFETY ON AIRFIELDS DURING CONSTRUCTION AND FAA AC 150 5370-2f OPERATIONAL SAFETY ON AIRPORTS DURING CONSTRUCTION. PROVIDE THE AIRFIELD MANAGER ALL INFORMATION REQUIRED FOR HIM TO SUBMIT FAA FROM 7460-1 SIXTY (60) DAYS PRIOR TO BEGINNING ANY CONSTRUCTION ACTIVITIES.
- PROTECT ALL EXISTING AIRFIELD LIGHTS AND/OR NAVAIDS DURING CONSTRUCTION. IF AN EXISTING AIRFIELD LIGHTS AND/OR NAVAIDS IS DAMAGED BY THE CONTRACTOR, IMMEDIATELY NOTIFY THE CONTRACTING OFFICER. REPAIR OR REPLACE THE DAMAGED AIRFIELD LIGHTS AND/OR NAVAIDS AT NO ADDITIONAL COST TO THE GOVERNMENT. REPAIR ALL DAMAGES TO THE CONTRACTING OFFICER'S SATISFACTION.

4. SPECIAL REQUIREMENTS

- CONTRACTOR AND AIRCRAFT OPERATIONS SHALL COORDINATE AIRCRAFT ACCESS TO BUILDING 400. WHEN AIRCRAFT MUST ACCESS BUILDING 400, THE CONTRACTOR SHALL VACUUM THE ACCESS APRON WITH THE SELF-CONTAINED VACUUMING TRUCK AND MOVE EQUIPMENT, AS REQUIRED, TO ALLOW SAFE PASSAGE OF AIRCRAFT FROM THE PARKING APRON TO THE BUILDINGS.
- CONTRACTOR AND AIRCRAFT OPERATIONS SHALL COORDINATE AIRCRAFT ACCESS TO BUILDING 426. BASE PERSONNEL WILL REQUIRE DAILY ACCESS TO BUILDING 426. COORDINATE ACCESS TO BUILDING 426 DAILY.
- COORDINATE AIRCRAFT MOVEMENTS WITH THE AIRFIELD MANAGER, OPERATIONS PERSONNEL AND THE CONTRACTING OFFICER WEEKLY.

LEGEND:

- LOW PROFILE BARRICADES - SEE NOTE 2
- ROPE AND BARREL FENCING - SEE NOTE 2
- ➔ CONTRACTOR HAUL ROUTE

US Army Corps of Engineers®

DESIGNED BY: B. GOLBER
 CHECKED BY: B. FLERE
 SUBMITTED BY: B. FLERE

FILE NAME: TX07_C-001.dwg
 FILE NUMBER: F113-10-01
 CONTRACT NO.: W9128F-C-20-XXX
 ISSUE DATE: FEBRUARY 2020

U.S. ARMY CORPS OF ENGINEERS
 OMAHA DISTRICT
 1616 CAPITOL AVENUE
 OMAHA, NE 68102

TRUXIA FIELD ANGB, WISCONSIN
 REPAIR APRON
 PN XGFG162005

PHASING PLAN & NOTES

SHEET ID
C-001

DATE: _____
 MARK: _____
 DESCRIPTION: _____

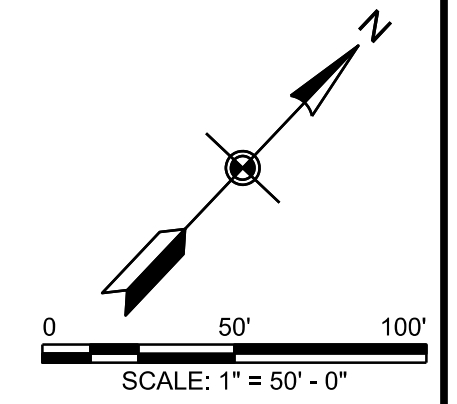

1 2 3 4 5 6 7 8 9 10

G
F
E
D
C
B
A

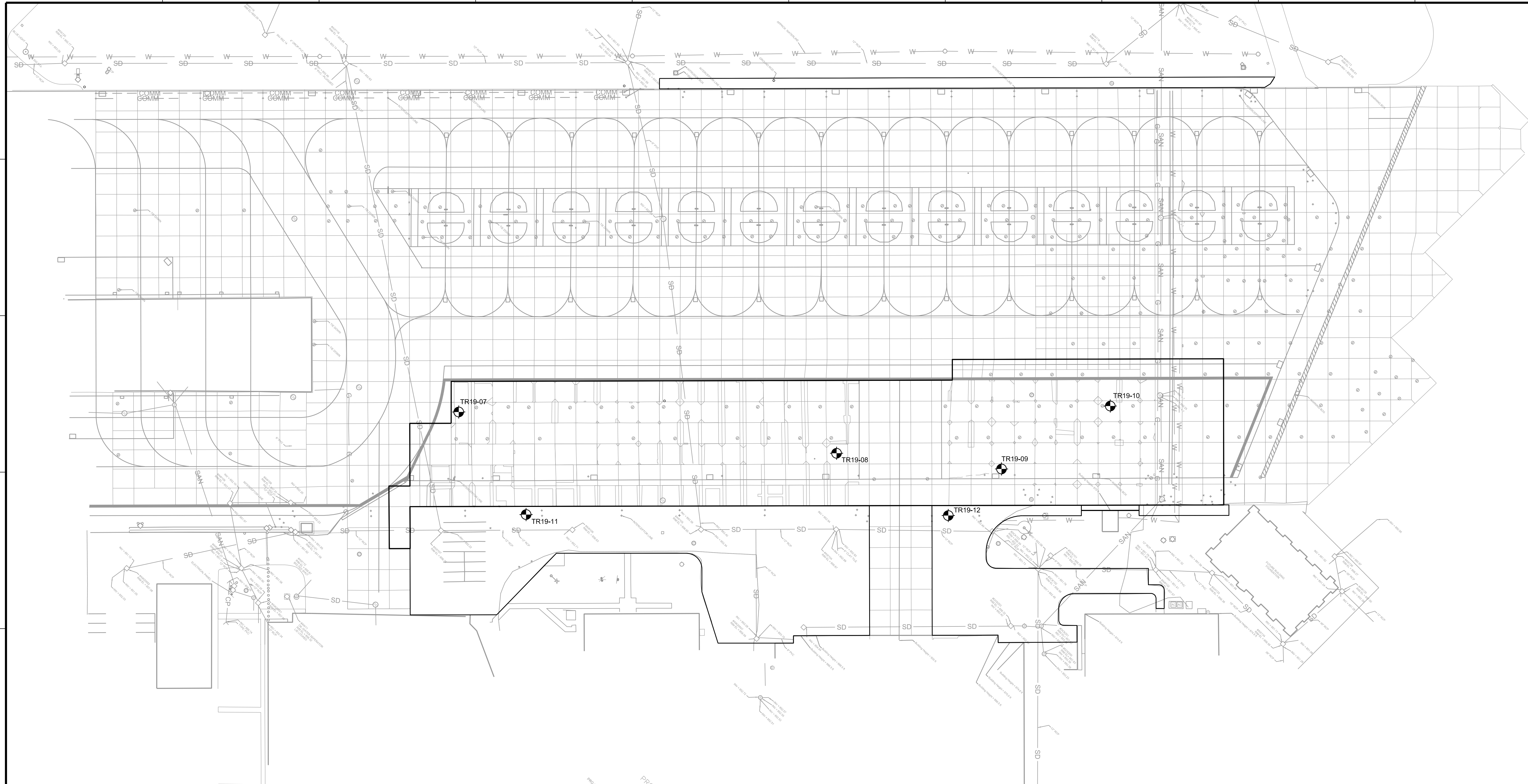

BORING	DEPTH (FT)	NORTHING	EASTING
TR19-07	10.0'	413827.07	2145850.01
TR19-08	10.0'	414046.98	2146140.28
TR19-09	10.0'	414144.57	2146265.49
TR19-10	10.0'	414260.02	2146299.80
TR19-11*	VARIES	413799.92	2145964.47
TR19-12*	VARIES	414077.09	2146259.09

COORDINATE SYSTEM: WISCONSIN SOUTH (4803)

TR 19-01 BORING LOCATION AND DESIGNATION
BORINGS MARKED WITH AN ASTERISK WERE CORED TO IDENTIFY EXISTING PAVEMENT THICKNESS AND WERE NOT ADVANCED INTO THE SUBSURFACE.

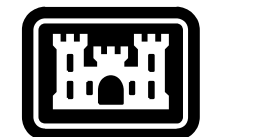
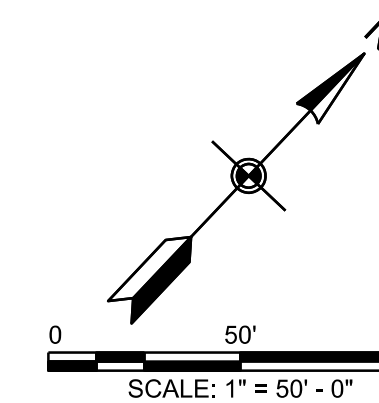

US Army Corps of Engineers®

MARK	DESCRIPTION	DATE

DESIGNED BY: L. WEIRING	ISSUE DATE: FEBRUARY 2020
DRAWN BY: T. WEIRING	PROJECT NO.: W9128E-C-20-XXX
CHECKED BY: C. FRITZCH	CONTRACT NO.: W9128E-C-20-XXX
SUBMITTED BY: B. FLERE	FILE NUMBER: F113-10-01
FILE NAME: ANSID	FILE SIZE: TX07_B-101.dwg

U.S. ARMY CORPS OF ENGINEERS
OMAHA DISTRICT
1616 CAPITOL AVENUE
OMAHA, NE 68102

TRUAX FIELD ANGE, WISCONSIN
REPAIR APRON
PN XGFG162005
BORING LOCATION PLAN

SHEET ID
B-101

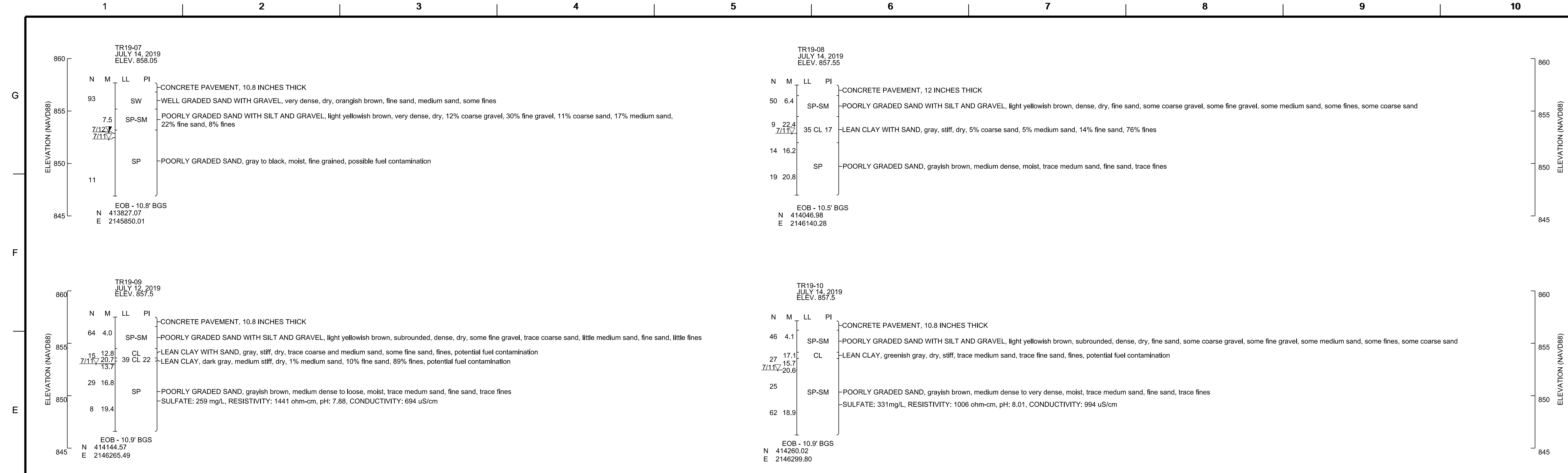

ACC CORE THICKNESS

CORE HOLE ID	NORTHING	EASTING	ACC THICKNESS (IN)
TR19-11	413799.92	2145964.47	3.84
TR19-12	414077.09	2146259.09	5.40

BORING LEGEND

TR19-01	DRILL HOLE NUMBER
JULY 12, 2019	DATE BORING COMPLETED
ELEV. 857.5	TOP OF PAVEMENT ELEVATION AT BORING LOCATION IN FEET (NAVD88)
M	NATURAL MOISTURE CONTENT IN PERCENT
LL	LIQUID LIMIT
PI	PLASTICITY INDEX
N	STANDARD PENETRATION BLOW COUNT. NUMBER OF BLOWS FOR A 140-POUND WEIGHT DROPPING 30 INCHES, TO DRIVE A 2-INCH OUTSIDE DIAMETER SAMPLER, 1 FOOT.
% fines	PERCENT OF SOIL BY DRY WEIGHT PASSING THE NO.200 SIEVE
7/01▽	GROUNDWATER DEPTH AND DATE MEASURED
7/01▼	24 HOUR GROUNDWATER DEPTH AND DATE MEASURED
G.W.T. N.E.	GROUNDWATER TABLE NOT ENCOUNTERED
FL	SOIL CLASSIFICATION BASED ON FIELD LOGS
LEAN CLAY	SOIL CLASSIFICATION BASED ON LABORATORY TESTING AND LABORATORY VISUAL DESCRIPTIONS

- BORING NOTES**
1. THE DESCRIPTIONS AT THE RIGHT OF THE LOGS ARE THE RESULTS OF FIELD AND LABORATORY DATA. THE TERMS "DRY", "MOIST", "WET", ETC., ARE FIELD DESCRIPTIONS MADE BY THE INSPECTOR IN THE FIELD AT THE TIME OF DRILLING. SEE "M" ON THE CONDENSED LOG OF BORINGS FOR LABORATORY DETERMINATION OF MOISTURE CONTENTS FOR THE SOIL. LABORATORY CLASSIFICATIONS ARE IN ACCORDANCE WITH ASTM D 2487.
 2. THE LOGS FURNISHED REPRESENT THE TYPES OF SOIL ENCOUNTERED AT THEIR RESPECTIVE LOCATIONS AND THE WATER LEVEL ENCOUNTERED AT THAT TIME. THE BORING LOGS ARE CONSIDERED REPRESENTATIVE OF THE SOILS WHICH WERE ENCOUNTERED AT THAT LOCATION; HOWEVER, THE WATER LEVEL RECORDED CAN FLUCTUATE APPRECIABLY AT DIFFERENT SEASONS OF THE YEAR OR FROM YEAR TO YEAR DEPENDING LARGELY ON CLIMATIC CONDITIONS. THE CONTRACTOR SHOULD IDENTIFY GROUND WATER CONDITIONS PRIOR TO THE TIME OF CONSTRUCTION.
 3. REFUSAL (N=60+) IS DEFINED AS A CUMULATIVE BLOW COUNT EXCEEDING 60 IN ANY SIX INCH INTERVAL OF THE STANDARD PENETRATION TEST (SPT). ONCE REFUSAL IS ENCOUNTERED, THE SPT IS DISCONTINUED.
 4. NOTE THAT BORING LOGS INDICATE THAT VERY DENSE SOILS AND SPT VALUES EXCEEDING 60 WERE ENCOUNTERED.
 5. ASPHALT (ACC) CORE THICKNESS IS EXPRESSED IN INCHES
 6. FOR SOIL BORING LOCATIONS, SEE SHEET B-101.

US Army Corps of Engineers

MARK	DESCRIPTION	DATE

DESIGNED BY: L. WEIRING	ISSUE DATE: FEBRUARY 2020	FILE NUMBER: F113-10-01	ANSID: TX07 B-301.dgn
DRAWN BY: T. WEIRING	DATE: MAY 12, 2020	FILE NAME: F113-10-01	
CHECKED BY: C. FRITZCH	CONTRACT NO.: W9128E-C-20-XXX	FILE NUMBER: F113-10-01	
SUBMITTED BY: B. FLERE	FILE NUMBER: F113-10-01		

BORING LOGS

SHEET ID

B-301

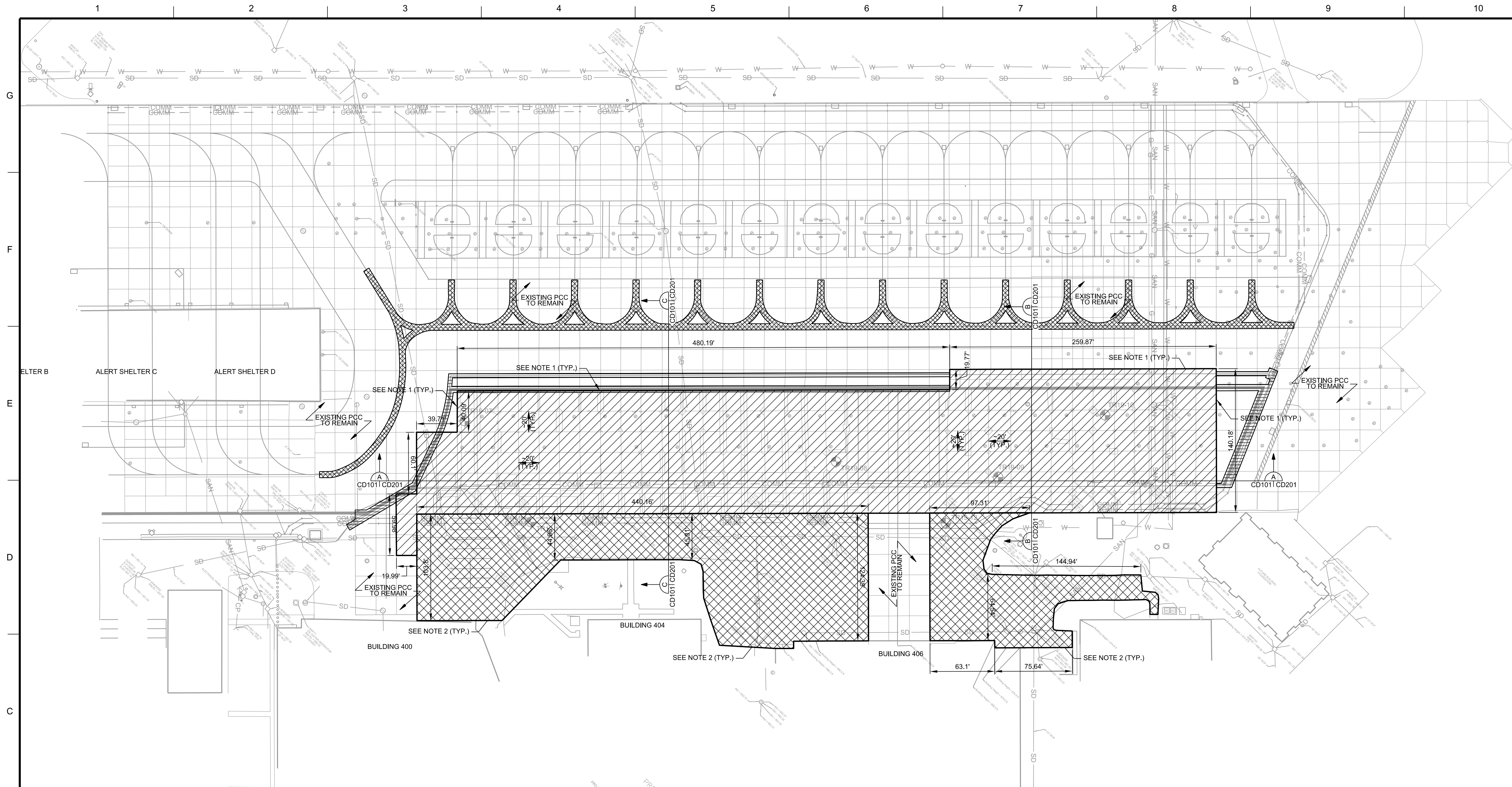

LEGEND:

	11.25" PCC / RIGID BASE COURSE AS NECESSARY TO BE REMOVED
	4" ACC / BASE COURSE AS NECESSARY TO BE REMOVED
	PAVEMENT MARKINGS TO BE REMOVED - SEE NOTE 8
	PAVEMENT MARKINGS TO BE REMOVED - SEE NOTE 9

- NOTES:**
1. ALL PCC PAVEMENT REMOVALS SHALL BE INITIATED WITH A DOUBLE FULL DEPTH OR TRIPLE FULL DEPTH, VERTICAL SAWCUT. SEE SHEET CD201 FOR DETAILS.
 2. ALL ACC PAVEMENT REMOVALS SHALL BE INITIATED WITH A SINGLE FULL DEPTH, VERTICAL SAWCUT. ALL ACC SHALL BE REMOVED OFF OF GOVERNMENT CONTROLLED LANDS.
 3. SEE SHEETS CD201 AND SHEET CP201 FOR PAVEMENT REMOVAL AND PAVEMENT REPLACEMENT SECTIONS, RESPECTIVELY.
 4. IN AREAS WHERE THE NEW PAVEMENT THICKNESS IS GREATER THAN THE EXISTING PAVEMENT REMOVED, REMOVE EXISTING SUBGRADE MATERIAL AS NECESSARY TO CONSTRUCT THE NEW PAVEMENT SECTION. IN AREAS WHERE THE NEW PAVEMENT SECTION IS LESS THAN THE EXISTING PAVEMENT SECTION REMOVED, PLACE AND COMPACT SUBBASE COURSE MATERIAL AS NECESSARY.
 5. ALL ODD-SHAPED SLABS AND SLABS WITH STRUCTURAL PENETRATIONS ARE REINFORCED WITH 0.05% STEEL DEFORMED BARS IN BOTH DIRECTIONS.
 6. EXISTING PAVEMENT MARKINGS NOT WITHIN THE PAVEMENT REMOVAL AREA, OR INDICATED TO BE REMOVED, THAT ARE MARRED OR REMOVED BY THE CONTRACTOR'S OPERATIONS SHALL BE ENTIRELY REMOVED AND REPLACED BY THE CONTRACTOR AT HIS OWN EXPENSE.
 7. AT LOCATIONS OF THICKENED EDGE EXPANSION JOINTS, THE CONTRACTOR SHALL ASSUME THAT THE PAVEMENT AT THAT LOCATION IS 1.3 TIMES THE THICKNESS OF THE SURROUNDING PAVEMENT. THE CONTRACTOR SHALL ASSUME THAT A THICKENED EDGE EXPANSION JOINT EXISTS AT THE FOLLOWING LOCATIONS:
 - THE JOINT ADJACENT TO STRUCTURES.
 - THE JOINT BETWEEN SLABS OF DIFFERENT SIZES.
 8. PRIOR TO INITIATING WORK WITHIN CAZ #1 (PHASE 1) REMOVE PAVEMENT MARKINGS AND INSTALL THE NEW TEMPORARY TAXILANE TO BE USED BY AIRCRAFT DURING CONSTRUCTION. TEMPORARY TAXILANE MARKING TO BE REMOVED PRIOR TO MARKING THE APRON THE WITH PERMANENT MARKINGS. SEE SHEET CP701 FOR THE PAVEMENT MARKING PLAN.
 9. AFTER COMPLETING ALL WORK WITHIN BOTH CAZ #1 AND CAZ #2. REMOVE PAVEMENT MARKINGS PRIOR TO INSTALLING THE PERMANENT MARKINGS. SEE SHEET CP701 FOR THE PAVEMENT MARKING PLAN.

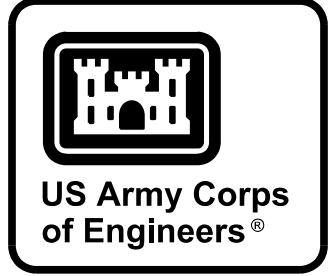
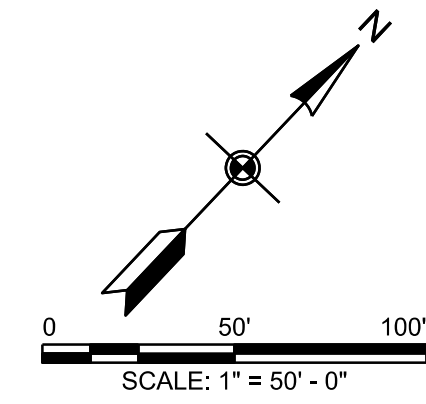

MARK	DESCRIPTION	DATE

DESIGNED BY: B. GOLBER	ISSUE DATE: FEBRUARY 2020
CHECKED BY: M. HUCKLE	CONTRACT NO.:
SUBMITTED BY: B. FLERE	FILE NUMBER: F113-10-01
FILE NAME: TX07_CD101.dwg	

U.S. ARMY CORPS OF ENGINEERS
OMAHA DISTRICT
1616 CAPITOL AVENUE
OMAHA, NE 68102

TRUAX FIELD ANGE, WISCONSIN
REPAIR APRON
PN XGFG162005
REMOVAL PLAN

SHEET ID
CD101

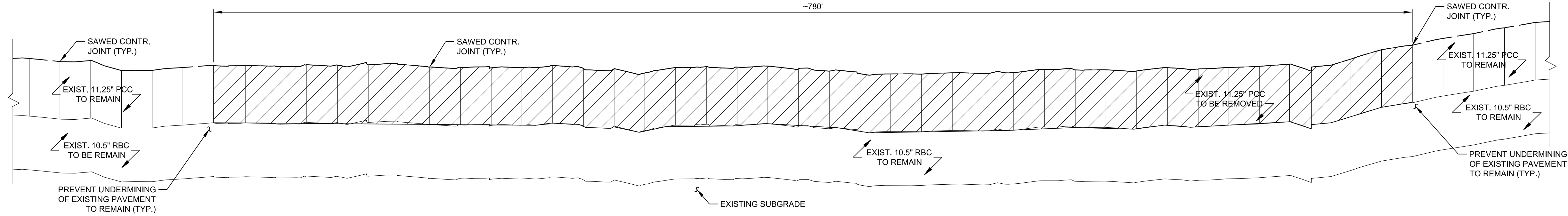

APRON REMOVAL SECTION A
NOT TO SCALE CD1011CD201

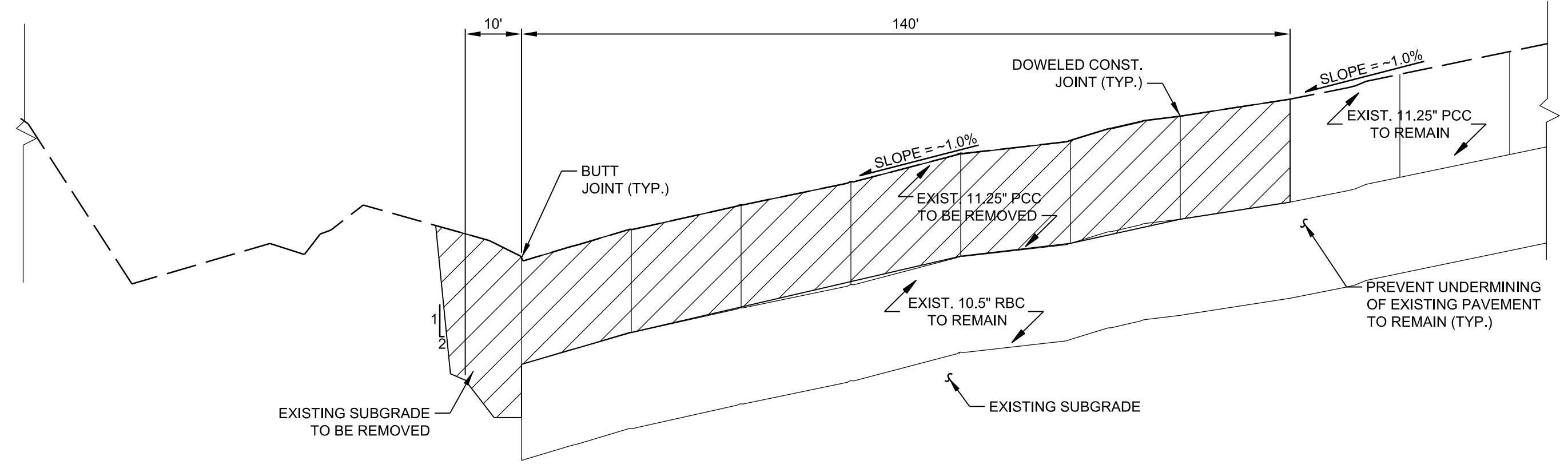

APRON REMOVAL SECTION B
NOT TO SCALE CD1011CD201

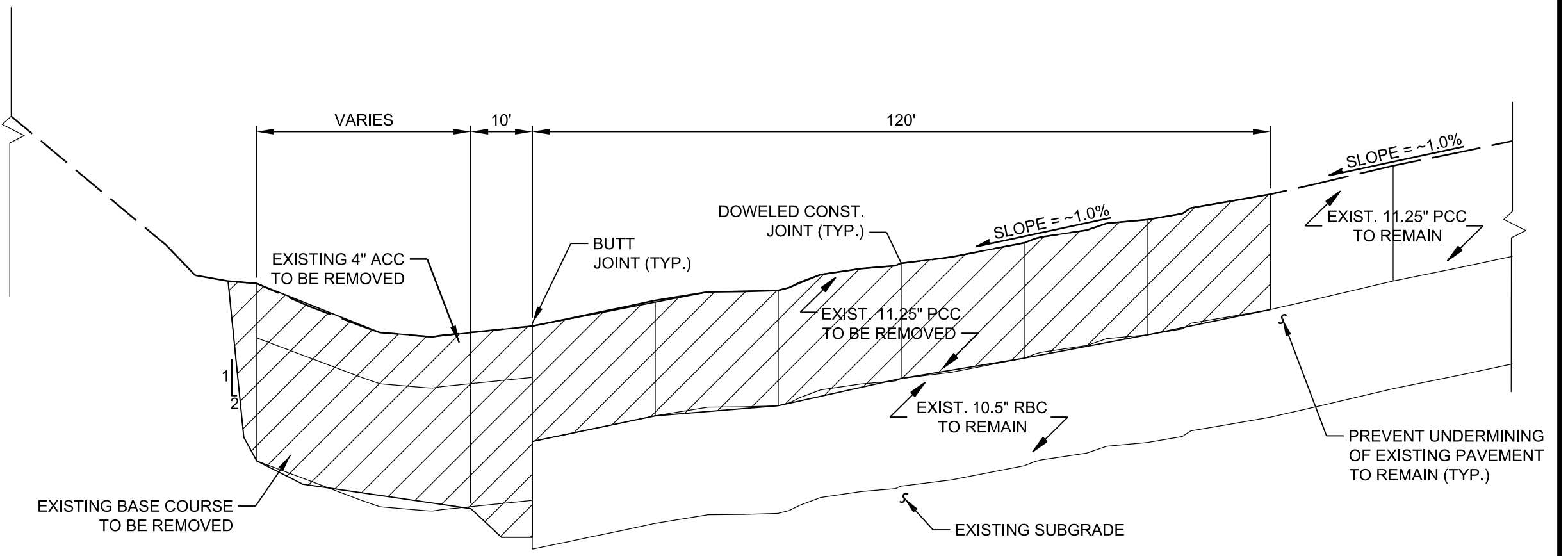

APRON REMOVAL SECTION C
NOT TO SCALE CD1011CD201

- NOTE:**
1. REMOVE EXISTING MATERIALS TO THE DEPTH NECESSARY TO INSTALL THE NEW PAVEMENT REPLACEMENT SECTION AS SHOWN ON SHEET CP201.
 2. SEE SHEET CD101 FOR EXISTING PAVEMENT THICKNESSES.
 3. IN AREAS WHERE THE NEW PAVEMENT THICKNESS IS GREATER THAN THE EXISTING PAVEMENT REMOVED, REMOVE EXISTING BASE COURSE, SUBBASE COURSE AND/OR SUBGRADE AS NECESSARY TO CONSTRUCT THE THICKER NEW PAVEMENT SECTION.
 4. IN AREAS WHERE THE NEW PAVEMENT THICKNESS IS LESS THAN THE EXISTING PAVEMENT REMOVED, PLACE AND COMPACT NEW AGGREGATE BASE COURSE MATERIAL.
 5. PREVENT UNDERMINING OF EXISTING PAVEMENT TO REMAIN.
 6. AT LOCATIONS OF THICKENED EDGE EXPANSION JOINTS, THE CONTRACTOR SHALL ASSUME THAT THE PAVEMENT AT THAT LOCATION IS 1.3 TIMES THE THICKNESS OF THE SURROUNDING PAVEMENT. THE CONTRACTOR SHALL ASSUME THAT A THICKENED EDGE EXPANSION JOINT EXISTS AT THE FOLLOWING LOCATIONS:
 - EXISTING PAVEMENT JOINTS ABUTTING EXISTING STRUCTURES.
 - THE JOINT BETWEEN SLABS OF DIFFERENT SIZES.

- LEGEND:**
- REMOVAL AREA - SEE SHEET CP201 FOR PAVEMENT REPLACEMENT SECTIONS
 - PCC PORTLAND CEMENT CONCRETE
 - ACC ASPHALT CEMENT CONCRETE

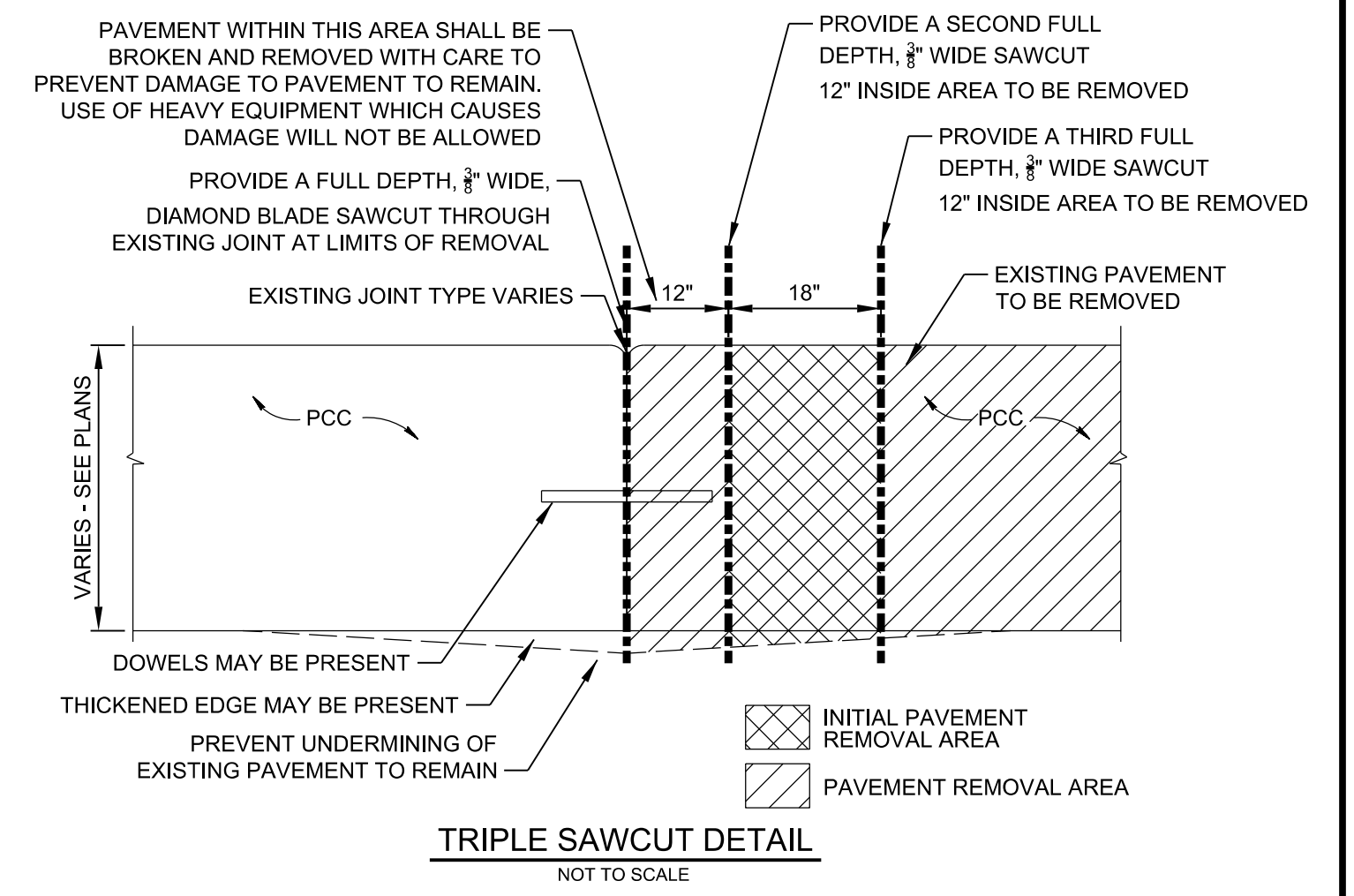
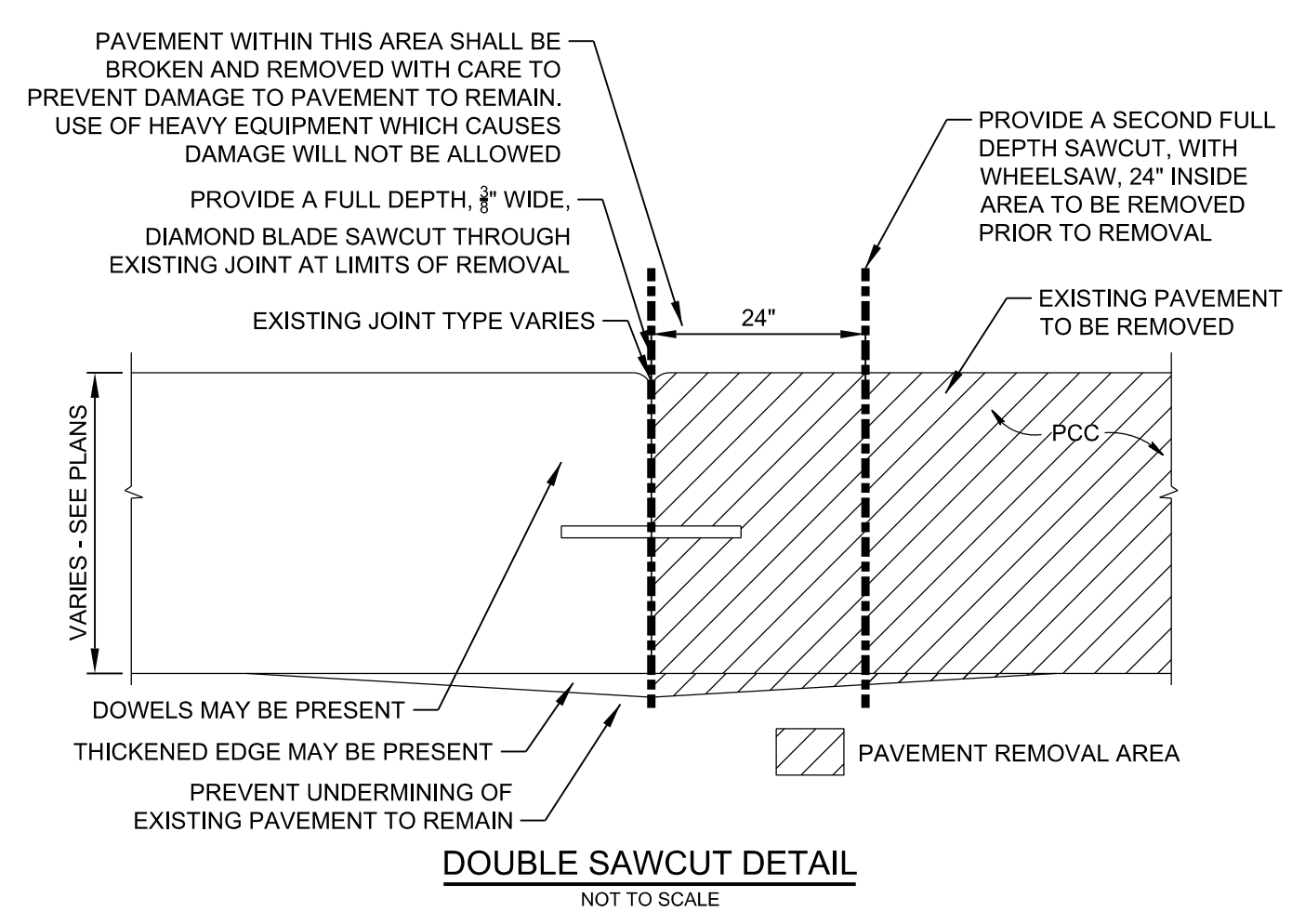

US Army Corps of Engineers

ISSUE DATE:	DATE
DESIGNED BY:	MARK
CHECKED BY:	DESCRIPTION

ISSUE DATE:	FILE NUMBER:
DESIGNED BY:	FILE NAME:
CHECKED BY:	FILE SIZE:
APPROVED BY:	FILE MARK:

U.S. ARMY CORPS OF ENGINEERS
OMAHA DISTRICT
1616 CAPITOL AVENUE
OMAHA, NE 68102

TRUEX FIELD ANGE, WISCONSIN
REPAIR APRON
PN.XGFG162005

PAVEMENT REMOVAL SECTIONS

SHEET ID
CD201

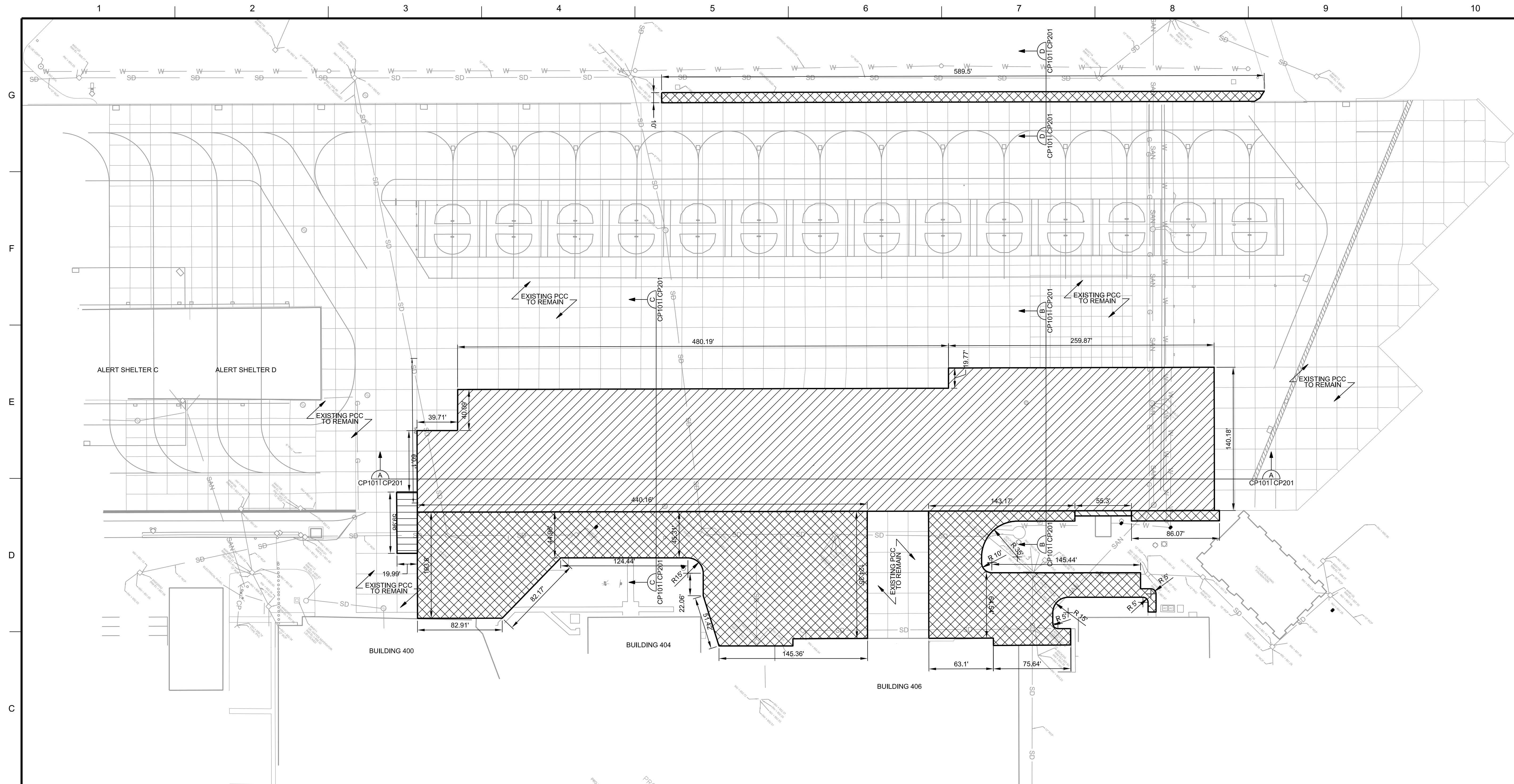

- LEGEND:**
- NEW 4" ACC / 6" AGGREGATE BASE COURSE / 6" SUBBASE COURSE
 - NEW 14" PCC / SCARIFY AND RECOMPACT 6" EXISTING BASE COURSE

NOTES:

1. SEE SHEET CP201 FOR NEW PAVEMENT SECTIONS.

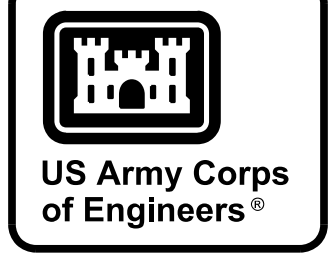

DATE	DESCRIPTION	MARK

DESIGNED BY: B. GOLBER	ISSUE DATE: FEBRUARY 2020
CHECKED BY: M. HUCKLE	PROJECT NO. / CONTRACT NO. / FILE NUMBER: W9128FC-20-XXX
SUBMITTED BY: B. FLERE	FILE NAME: TX07_CP101.dwg

U.S. ARMY CORPS OF ENGINEERS
OMAHA DISTRICT
1616 CAPITOL AVENUE
OMAHA, NE 68102

TRUAX FIELD ANGE, WISCONSIN
REPAIR APRON
PN XGFG162005

PAVING PLAN

SHEET ID
CP101

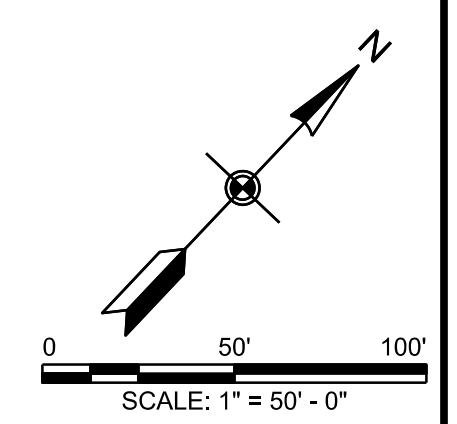

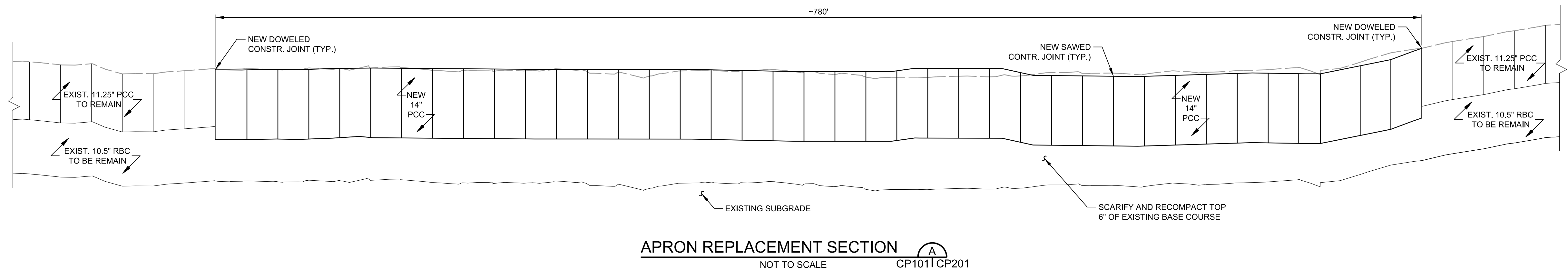

APRON REPLACEMENT SECTION A
NOT TO SCALE CP1011CP201

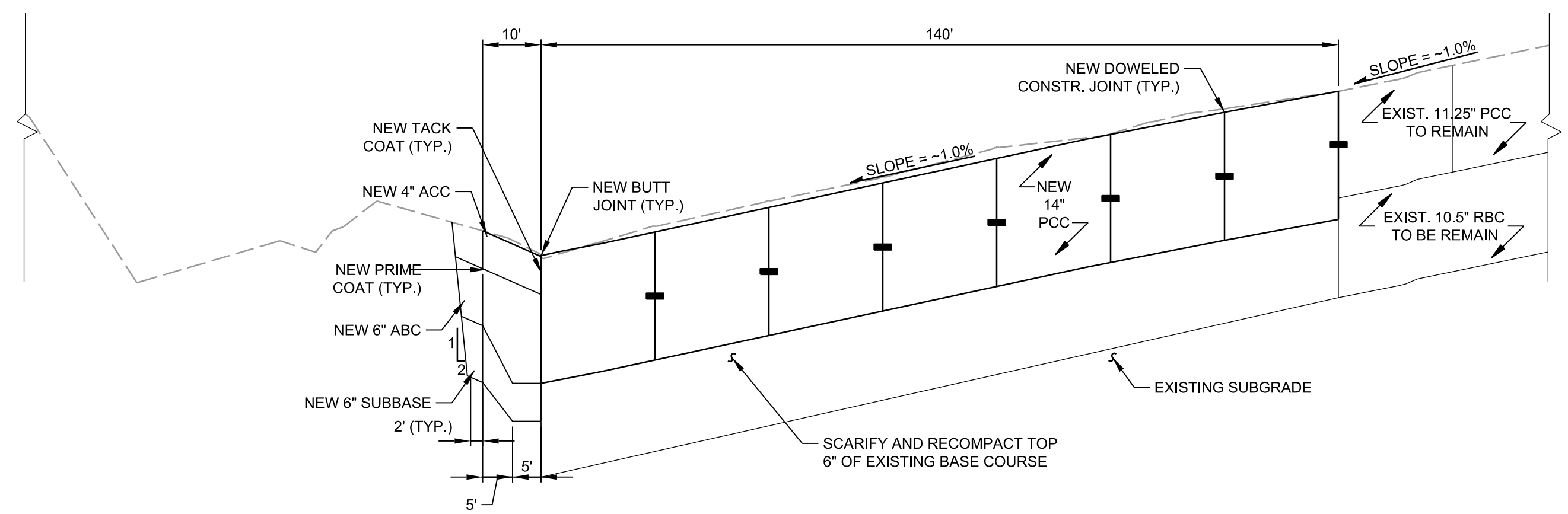

APRON REPLACEMENT SECTION B
NOT TO SCALE CP1011CP201

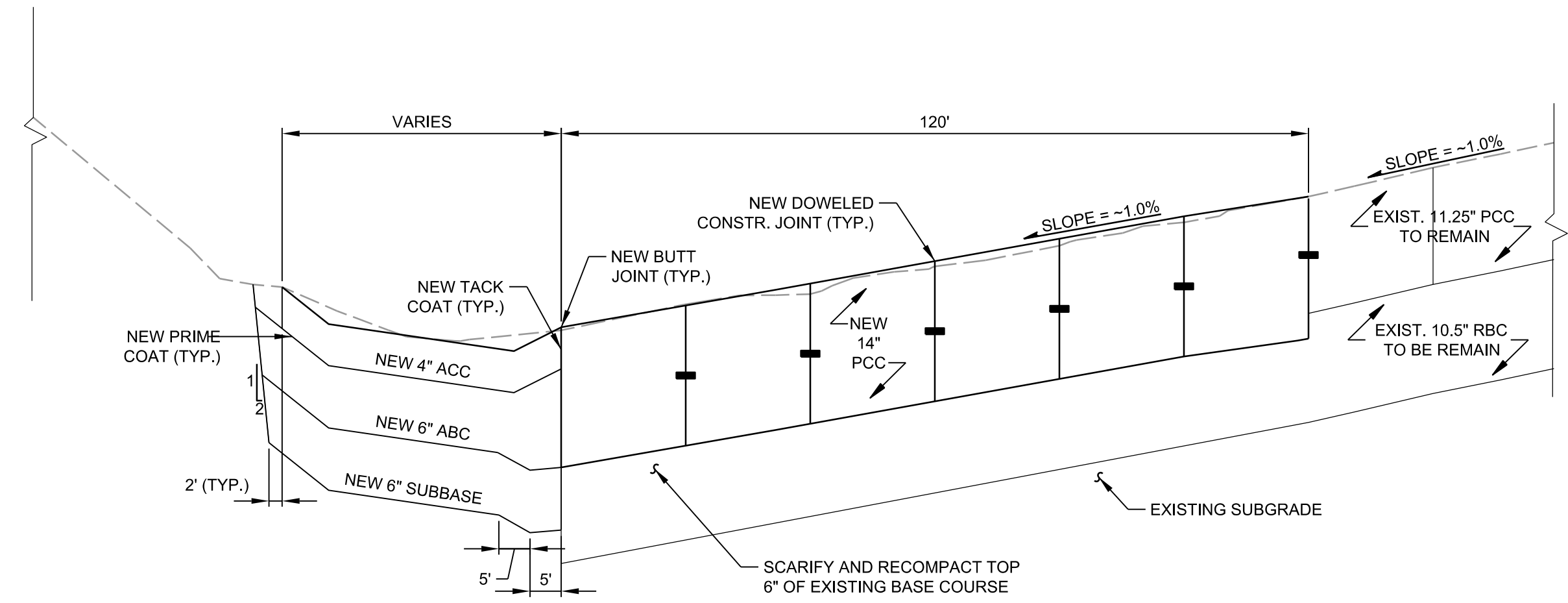

APRON REPLACEMENT SECTION C
NOT TO SCALE CP1011CP201

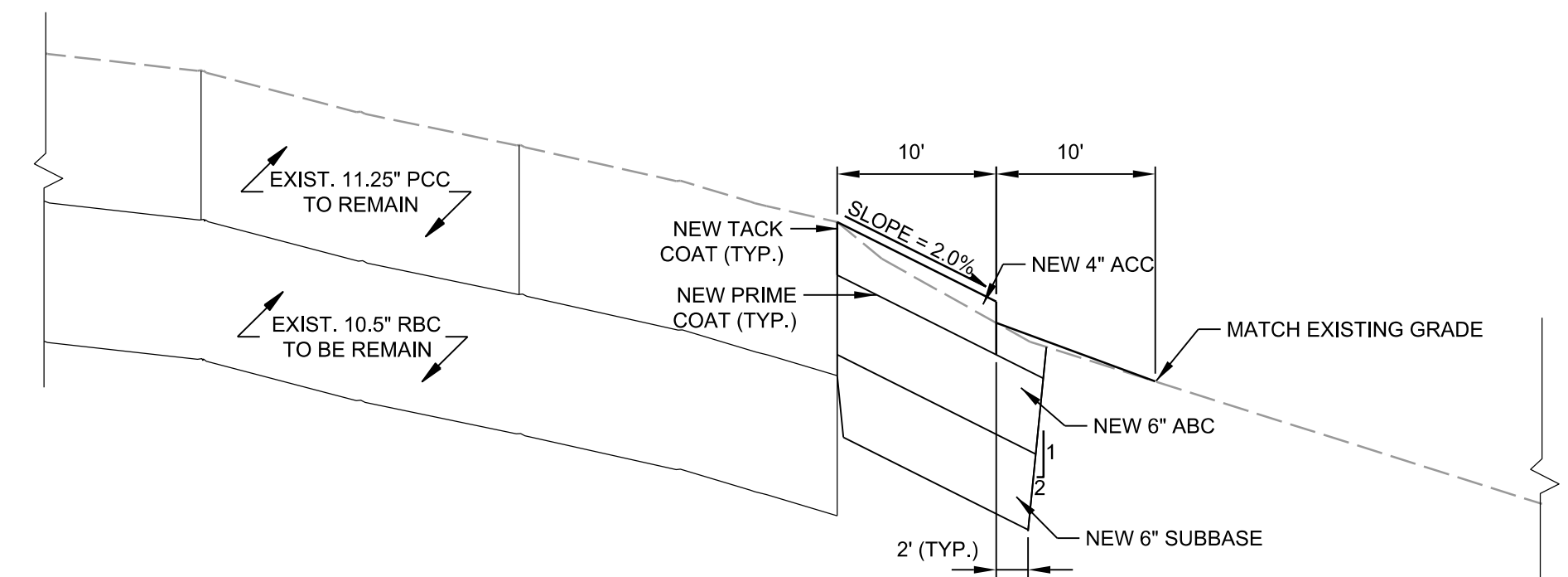

NEW ACC PAVEMENT SECTION D
NOT TO SCALE CP1011CP201

- GENERAL NOTES:**
1. IN AREAS WHERE THE NEW PAVEMENT THICKNESS IS GREATER THAN THE EXISTING PAVEMENT REMOVED, REMOVE EXISTING MATERIAL AS NECESSARY TO CONSTRUCT THE NEW PAVEMENT SECTION.
 2. IN AREAS WHERE THE NEW PAVEMENT THICKNESS IS LESS THAN THE EXISTING PAVEMENT REMOVED, PLACE AND COMPACT AGGREGATE BASE COURSE MATERIAL.
 3. ALL DISTURBED AREAS NOT TO BE PAVED, TO BE TOPSOILED WITH 4\"/>

LEGEND:
ACC ASPHALT CEMENT CONCRETE
ABC AGGREGATE BASE COURSE

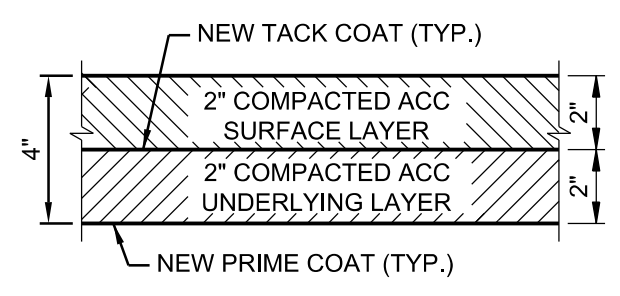

DETAIL 1

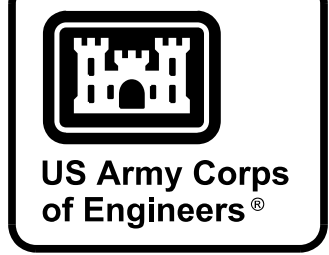

MARK	DESCRIPTION

DESIGNED BY: B. GOLBER	ISSUE DATE: FEBRUARY 2020
CHECKED BY: M. HUCKLE	PROJECT NO. NO. 19128FC-20-XXXX
CONTRACT NO. 19128FC-20-XXXX	FILE NO. F113-10-01
FILE NUMBER: F113-10-01	FILE NAME: TX07_CP201.dwg
U.S. ARMY CORPS OF ENGINEERS OMAHA DISTRICT 1616 CAPITOL AVENUE OMAHA, NE 68102	

TRUAX FIELD ANGE, WISCONSIN
REPAIR APRON
PN XGFG162005

SHEET ID
CP201