

Spill Notification for WRR Environmental Services Co., Inc.

EPA ID# WID990829475

FID# 618026530

Spill ID# 16224

ID 20210226WC18-1 – Chromium waste

Per Condition 86 of WRR Environmental Services' current Feasibility and Plan of Operations Report (FPOR), WRR is making the following spill report to the Department's designated Hazardous Waste Inspector assigned to WRR, to the Department's designated Hazardous Waste plan review staff person assigned to WRR and to the Department's designated Spills Coordinator.

This notification, required by Condition 86 of the WRR FPOR and NR 706.05(1), contains the following information to the extent practicable or applicable:

1. Name, address, and telephone number of the person reporting the discharge.

Becky Anderson – Director of Compliance
WRR Environmental Services Co., Inc.
5200 Ryder Road
Eau Claire WI 54701

2. Name, address, and telephone number of the discharger, or owner and operator of the UST system and any other potentially responsible persons.

Crystal Finishing Systems
880 South View Drive
Mosinee WI
715-355-5351

3. Date, time, and duration of the discharge.

February 26, 2021 at 2:00 pm. Time to clean up the release was 7.0 hours.

Location of the discharge including street address, county, town, city or village

WRR Environmental Services Co., Inc.
5200 Ryder Road
Eau Claire WI 54701

Town of Washington

4. Identity, physical state, and quantity of the material discharged.

~100 gallons of a flowable sludge hazardous chromium plating waste from wastewater treatment was release from a cubic yard box that was US DOT approved for solids only.

The hazardous waste codes associated with this waste are F019 and D007.

A total of eight boxes of this waste was shipped on this load. Five of the boxes contained the solids as expected and two other boxes contained the waste in a liquid form. These two boxes were repacked into DOT compliant open top drums with no further material release.

5. Physical, chemical, hazardous, and toxicological characteristics of the substance.

The release is a wastewater treatment material from chemical conversion coating of aluminum. This specific waste carries an EPA waste code F019 and a D007 for the toxic metal chromium. Normally, material from the wastewater treatment process results in a damp solid material. The material released was very fluid.

6. Cause of the discharge.

A generator packaged hazardous waste in DOT containers that were not approved for the physical state of the material.

7. Immediate actions being taken and the name of the contractor or other person performing the action.

Shovels, clay absorbent and pads were used to pick up the bulk of the release.

All cleanup activities were conducted by WRR personnel.

8. Source, speed of movement, and destination or probable destination of the discharged hazardous substance.

The release was contained to the trailer that was parked in a concrete containment area. No material impacted soil or contaminated the WRR stormwater collection area.

Included with this report is a facility map with the release location marked with a red arrow.

9. Actual or potential impacts to human health or the environment, including actual or potential impacts to drinking water supplies.

No drinking water supplies were impacted by the spill.

This waste contained no volatile constituents other than water.

10. Weather conditions existing at the scene, including presence of precipitation and wind direction and velocity.

The release occurred inside a semi-trailer. The temperature at the time of the spill was 42F with a 17 mph wind. There was no precipitation.

11. Other agencies on-scene during the discharge incident.

No agencies were on-site during the discharge or clean-up.

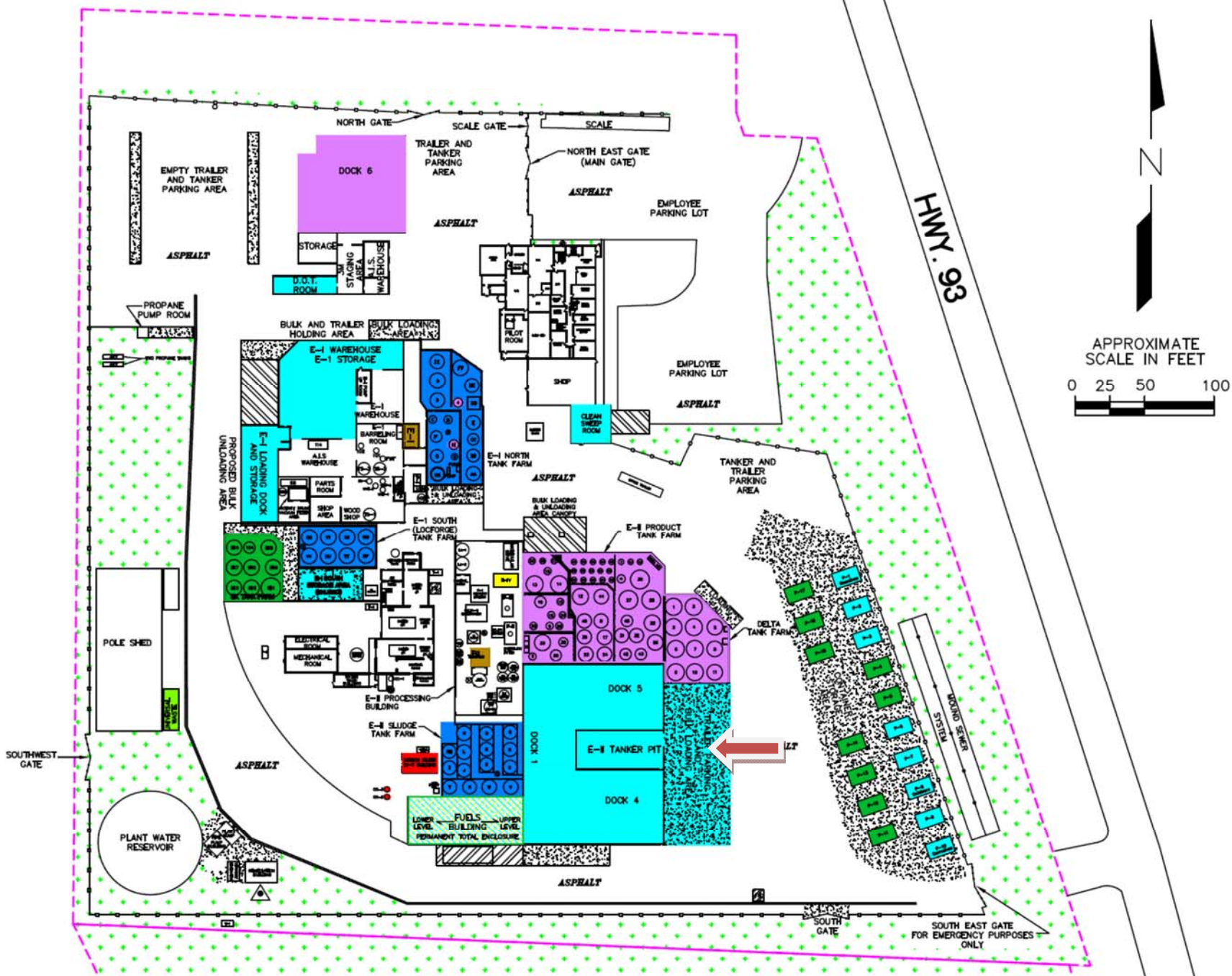



20210226WC18-1 CRYSTAL FINISHING SYSTEMS



Legend

- Open Site
- Closed Site
- Continuing Obligations Apply
- Facility-wide Site



NAD_1983_HARN_Wisconsin_TM

1: 1,980

DISCLAIMER: The information shown on these maps has been obtained from various sources, and are of varying age, reliability and resolution. These maps are not intended to be used for navigation, nor are these maps an authoritative source of information about legal land ownership or public access. No warranty, expressed or implied, is made regarding accuracy, applicability for a particular use, completeness, or legality of the information depicted on this map. For more information, see the DNR Legal Notices web page: <http://dnr.wi.gov/org/legal/>

Note: Not all sites are mapped.

Notes

CHROMIUM SLUDGE
EAU CLAIRE
EAU CLAIRE CO.