

Spill Notification for WRR Environmental Services Co., Inc.

EPA ID# WID990829475

FID# 618026530

Spill ID# 19979

ID 20231223WC18-2– Orthodichlorotoluene

Per Condition 86 of WRR Environmental Services' current Feasibility and Plan of Operations Report (FPOR), WRR is making the following spill report to the Department's designated Hazardous Waste Inspector assigned to WRR, to the Department's designated Hazardous Waste plan review staff person assigned to WRR and to the Department's designated Spills Coordinator.

This notification, required by Condition 86 of the WRR FPOR and NR 706.05(1), contains the following information to the extent practicable or applicable:

1. Name, address, and telephone number of the person reporting the discharge.

Becky Anderson – Director of Compliance
WRR Environmental Services Co., Inc.
5200 Ryder Road
Eau Claire WI 54701
715-577-7755 (Cell)

2. Name, address, and telephone number of the discharger, or owner and operator of the UST system and any other potentially responsible persons.

WRR Environmental Services
5200 Ryder Road
Eau Claire WI 54701
715-834-9624

3. Date, time, and duration of the discharge.

December 23, 2023 at 6:40 am. Time to clean up the release was 6.0 hours.

Location of the discharge including street address, county, town, city or village

WRR Environmental Services Co., Inc.
5200 Ryder Road
Eau Claire WI 54701

Town of Washington

4. Identity, physical state, and quantity of the material discharged.

~20 gallons total of Orthodichlorotoluene was released from a top manway on a tanker. The spill quantity value was changed after the material was cleaned up.

5. Physical, chemical, hazardous, and toxicological characteristics of the substance.

The release was a hot material consisting of the flammable orthodichlorotoluene. The main hazard associated with this product is its classification as a Class 3 DOT flammable material. An SDS for the material is included with this report.

6. Cause of the discharge.

The release occurred when a pump failed while pumping the hot liquid. The material was not cooled before pumping began.

7. Immediate actions being taken and the name of the contractor or other person performing the action.

The production worker closed the valve to the line feeding the pump. Then evacuated the area to put on a respirator prior to starting an cleanup operations.

All cleanup activities were conducted by WRR personnel.

8. Source, speed of movement, and destination or probable destination of the discharged hazardous substance.

The release was contained in the EII building; there are no drains in the building. No material drained to the onsite reservoir or grassy areas.

Included with this report is a facility map with the release location marked with a red arrow.

9. Actual or potential impacts to human health or the environment, including actual or potential impacts to drinking water supplies.

WRR personnel were wearing personal protective equipment during cleanup operations. No injuries were reported.

No drinking water supplies were impacted by the spill.

This waste contained to the building.

10. Weather conditions existing at the scene, including presence of precipitation and wind direction and velocity.

The release occurred inside a building – no wind and no precipitation.

11. Other agencies on-scene during the discharge incident.

No agencies were on-site during the discharge or clean-up.

SAFETY DATA SHEET

Creation Date 24-Nov-2010

Revision Date 14-Feb-2020

Revision Number 2

1. Identification

Product Name 2-Chlorotoluene

Cat No. : B23596

CAS-No 95-49-8
Synonyms 1-Chloro-2-methylbenzene; OCT

Recommended Use Laboratory chemicals.
Uses advised against Food, drug, pesticide or biocidal product use.
Details of the supplier of the safety data sheet

Company

Alfa Aesar
Thermo Fisher Scientific Chemicals, Inc.
30 Bond Street
Ward Hill, MA 01835-8099
Tel: 800-343-0660
Fax: 800-322-4757
Email: tech@alfa.com
www.alfa.com

Emergency Telephone Number

During normal business hours (Monday-Friday, 8am-7pm EST), call (800) 343-0660.
After normal business hours, call Carechem 24 at (866) 928-0789.

2. Hazard(s) identification

Classification

This chemical is considered hazardous by the 2012 OSHA Hazard Communication Standard (29 CFR 1910.1200)

Flammable liquids	Category 3
Acute Inhalation Toxicity - Vapors	Category 4
Reproductive Toxicity	Category 2

Label Elements

Signal Word

Warning

Hazard Statements

Flammable liquid and vapor
Harmful if inhaled
Suspected of damaging the unborn child

**Precautionary Statements****Prevention**

Obtain special instructions before use
 Do not handle until all safety precautions have been read and understood
 Use personal protective equipment as required
 Avoid breathing dust/fume/gas/mist/vapors/spray
 Use only outdoors or in a well-ventilated area
 Keep away from heat/sparks/open flames/hot surfaces. - No smoking
 Keep container tightly closed
 Ground/bond container and receiving equipment
 Use explosion-proof electrical/ventilating/lighting/equipment
 Use only non-sparking tools
 Take precautionary measures against static discharge

Response

IF exposed or concerned: Get medical attention/advice

Inhalation

IF INHALED: Remove victim to fresh air and keep at rest in a position comfortable for breathing

Skin

IF ON SKIN (or hair): Take off immediately all contaminated clothing. Rinse skin with water/shower

Fire

In case of fire: Use CO₂, dry chemical, or foam for extinction

Storage

Store locked up
 Store in a well-ventilated place. Keep cool

Disposal

Dispose of contents/container to an approved waste disposal plant

Hazards not otherwise classified (HNOC)

Very toxic to aquatic life with long lasting effects
 Toxic to aquatic life with long lasting effects

3. Composition/Information on Ingredients

Component	CAS-No	Weight %
o-Chlorotoluene	95-49-8	>95

4. First-aid measures

Eye Contact	Rinse immediately with plenty of water, also under the eyelids, for at least 15 minutes. Get medical attention.
Skin Contact	Wash off immediately with soap and plenty of water while removing all contaminated clothes and shoes. Get medical attention.
Inhalation	Remove from exposure, lie down. Remove to fresh air. If breathing is difficult, give oxygen. If not breathing, give artificial respiration. Get medical attention.
Ingestion	Clean mouth with water. Get medical attention.
Most important symptoms and	Difficulty in breathing. . Symptoms of overexposure may be headache, dizziness, tiredness,

effects nausea and vomiting
Notes to Physician Treat symptomatically

5. Fire-fighting measures

Suitable Extinguishing Media Water spray. Carbon dioxide (CO₂). Dry chemical. Chemical foam. Water mist may be used to cool closed containers.

Unsuitable Extinguishing Media No information available

Flash Point 49 °C / 120 °F

Method - No information available

Autoignition Temperature 450 °C / 842 °F

Explosion Limits

Upper No data available
Lower No data available
Sensitivity to Mechanical Impact No information available
Sensitivity to Static Discharge No information available

Specific Hazards Arising from the Chemical

Flammable. Containers may explode when heated. Vapors may form explosive mixtures with air. Vapors may travel to source of ignition and flash back.

Hazardous Combustion Products

Carbon monoxide (CO). Carbon dioxide (CO₂). Hydrogen chloride gas.

Protective Equipment and Precautions for Firefighters

As in any fire, wear self-contained breathing apparatus pressure-demand, MSHA/NIOSH (approved or equivalent) and full protective gear.

NFPA

Health
2

Flammability
2

Instability
0

Physical hazards
N/A

6. Accidental release measures

Personal Precautions Remove all sources of ignition. Take precautionary measures against static discharges.
Environmental Precautions Do not flush into surface water or sanitary sewer system.

Methods for Containment and Clean Up Soak up with inert absorbent material (e.g. sand, silica gel, acid binder, universal binder, sawdust). Keep in suitable, closed containers for disposal. Remove all sources of ignition. Use spark-proof tools and explosion-proof equipment. Do not let this chemical enter the environment.

7. Handling and storage

Handling Avoid contact with skin and eyes. Do not breathe mist/vapors/spray. Do not ingest. If swallowed then seek immediate medical assistance. Keep away from heat/sparks/open flames/hot surfaces. - No smoking. Use spark-proof tools and explosion-proof equipment. Use only non-sparking tools. Keep away from open flames, hot surfaces and sources of ignition. Take precautionary measures against static discharges.

Storage Keep in a dry, cool and well-ventilated place. Refer product specification and/or product label for specific storage temperature requirement. Keep container tightly closed. Keep away from heat, sparks and flame. Flammables area. Keep away from heat/sparks/open flames/hot surfaces. - No smoking. Keep container tightly closed in a dry and well-ventilated place.

8. Exposure controls / personal protection

Exposure Guidelines

Component	ACGIH TLV	OSHA PEL	NIOSH IDLH	Mexico OEL (TWA)
o-Chlorotoluene	TWA: 50 ppm	(Vacated) TWA: 50 ppm (Vacated) TWA: 250 mg/m ³	TWA: 50 ppm TWA: 250 mg/m ³ STEL: 75 ppm STEL: 375 mg/m ³	TWA: 50 ppm TWA: 250 mg/m ³ STEL: 75 ppm STEL: 375 mg/m ³

Engineering Measures Use explosion-proof electrical/ventilating/lighting/equipment. Ensure adequate ventilation, especially in confined areas.

Personal Protective Equipment

- Eye/face Protection** Wear appropriate protective eyeglasses or chemical safety goggles as described by OSHA's eye and face protection regulations in 29 CFR 1910.133 or European Standard EN166.
- Skin and body protection** Wear appropriate protective gloves and clothing to prevent skin exposure.
- Respiratory Protection** No protective equipment is needed under normal use conditions.
- Hygiene Measures** Handle in accordance with good industrial hygiene and safety practice.

9. Physical and chemical properties

Physical State	Liquid
Appearance	Colorless
Odor	aromatic
Odor Threshold	No information available
pH	No information available
Melting Point/Range	-36 °C / -32.8 °F
Boiling Point/Range	157 - 159 °C / 314.6 - 318.2 °F @ 760 mmHg
Flash Point	49 °C / 120 °F
Evaporation Rate	No information available
Flammability (solid,gas)	Not applicable
Flammability or explosive limits	
Upper	No data available
Lower	No data available
Vapor Pressure	3.5 mbar @ 20 °C
Vapor Density	4.38
Specific Gravity	1.080
Solubility	Slightly soluble in water
Partition coefficient; n-octanol/water	No data available
Autoignition Temperature	450 °C / 842 °F
Decomposition Temperature	No information available
Viscosity	No information available
Molecular Formula	C7 H7 Cl
Molecular Weight	126.59

10. Stability and reactivity

- Reactive Hazard** None known, based on information available
- Stability** Stable under recommended storage conditions.
- Conditions to Avoid** Keep away from open flames, hot surfaces and sources of ignition. Incompatible products.

Incompatible Materials	Strong oxidizing agents
Hazardous Decomposition Products	Carbon monoxide (CO), Carbon dioxide (CO ₂), Hydrogen chloride gas
Hazardous Polymerization	No information available.
Hazardous Reactions	None under normal processing.

11. Toxicological information

Acute Toxicity

Product Information Component Information

Component	LD50 Oral	LD50 Dermal	LC50 Inhalation
o-Chlorotoluene	3227 mg/kg (Rat)	> 5000 g/kg (Rat)	Not listed

Toxicologically Synergistic Products No information available

Delayed and immediate effects as well as chronic effects from short and long-term exposure

Irritation	No information available
Sensitization	No information available
Carcinogenicity	The table below indicates whether each agency has listed any ingredient as a carcinogen.

Component	CAS-No	IARC	NTP	ACGIH	OSHA	Mexico
o-Chlorotoluene	95-49-8	Not listed	Not listed	Not listed	Not listed	Not listed

Mutagenic Effects No information available

Reproductive Effects No information available.

Developmental Effects No information available.

Teratogenicity No information available.

STOT - single exposure None known

STOT - repeated exposure None known

Aspiration hazard No information available

Symptoms / effects, both acute and delayed Symptoms of overexposure may be headache, dizziness, tiredness, nausea and vomiting

Endocrine Disruptor Information No information available

Other Adverse Effects See actual entry in RTECS for complete information.

12. Ecological information

Ecotoxicity

Very toxic to aquatic organisms, may cause long-term adverse effects in the aquatic environment. The product contains following substances which are hazardous for the environment.

Component	Freshwater Algae	Freshwater Fish	Microtox	Water Flea
o-Chlorotoluene	Not listed	LC50 = 7.7 mg/L 96 h	EC50 = 2.90 mg/L 5 min EC50 = 3.33 mg/L 15 min EC50 = 4.70 mg/L 30 min	EC50 = 0.7 mg/L 48 h

Persistence and Degradability May persist based on information available.

Bioaccumulation/ Accumulation No information available.

Mobility . Is not likely mobile in the environment due its low water solubility.

Component	log Pow
o-Chlorotoluene	3.42

13. Disposal considerations

Waste Disposal Methods Chemical waste generators must determine whether a discarded chemical is classified as a hazardous waste. Chemical waste generators must also consult local, regional, and national hazardous waste regulations to ensure complete and accurate classification.

14. Transport information

DOT

UN-No UN2238
 Proper Shipping Name CHLOROTOLUENES
 Hazard Class 3
 Packing Group III

TDG

UN-No UN2238
 Proper Shipping Name CHLOROTOLUENES
 Hazard Class 3
 Packing Group III

IATA

UN-No UN2238
 Proper Shipping Name CHLOROTOLUENES
 Hazard Class 3
 Packing Group III

IMDG/IMO

UN-No UN2238
 Proper Shipping Name CHLOROTOLUENES
 Hazard Class 3
 Packing Group III

15. Regulatory information

United States of America Inventory

Component	CAS-No	TSCA	TSCA Inventory notification - Active/Inactive	TSCA - EPA Regulatory Flags
o-Chlorotoluene	95-49-8	X	ACTIVE	-

Legend:

TSCA - Toxic Substances Control Act, (40 CFR Part 710)

X - Listed

'-' - Not Listed

TSCA 12(b) - Notices of Export Not applicable

International Inventories

Canada (DSL/NDSL), Europe (EINECS/ELINCS/NLP), Philippines (PICCS), Japan (ENCS), Australia (AICS), China (IECSC), Korea (ECL).

Component	CAS-No	DSL	NDSL	EINECS	PICCS	ENCS	AICS	IECSC	KECL
o-Chlorotoluene	95-49-8	X	-	202-424-3	X	X	X	X	X

U.S. Federal Regulations

SARA 313 Not applicable

SARA 311/312 Hazard Categories See section 2 for more information

CWA (Clean Water Act)	Not applicable
Clean Air Act	Not applicable
OSHA - Occupational Safety and Health Administration	Not applicable
CERCLA	Not applicable
California Proposition 65	This product does not contain any Proposition 65 chemicals.

U.S. State Right-to-Know Regulations

Component	Massachusetts	New Jersey	Pennsylvania	Illinois	Rhode Island
o-Chlorotoluene	X	X	X	-	X

U.S. Department of Transportation

Reportable Quantity (RQ):	N
DOT Marine Pollutant	N
DOT Severe Marine Pollutant	N

U.S. Department of Homeland Security This product does not contain any DHS chemicals.

Other International Regulations

Mexico - Grade No information available

16. Other information

Prepared By	Health, Safety and Environmental Department Email: tech@alfa.com www.alfa.com
Creation Date	24-Nov-2010
Revision Date	14-Feb-2020
Print Date	14-Feb-2020
Revision Summary	SDS authoring systems update, replaces ChemGes SDS No. 95-49-8/2.

Disclaimer

The information provided in this Safety Data Sheet is correct to the best of our knowledge, information and belief at the date of its publication. The information given is designed only as a guidance for safe handling, use, processing, storage, transportation, disposal and release and is not to be considered a warranty or quality specification. The information relates only to the specific material designated and may not be valid for such material used in combination with any other materials or in any process, unless specified in the text

End of SDS

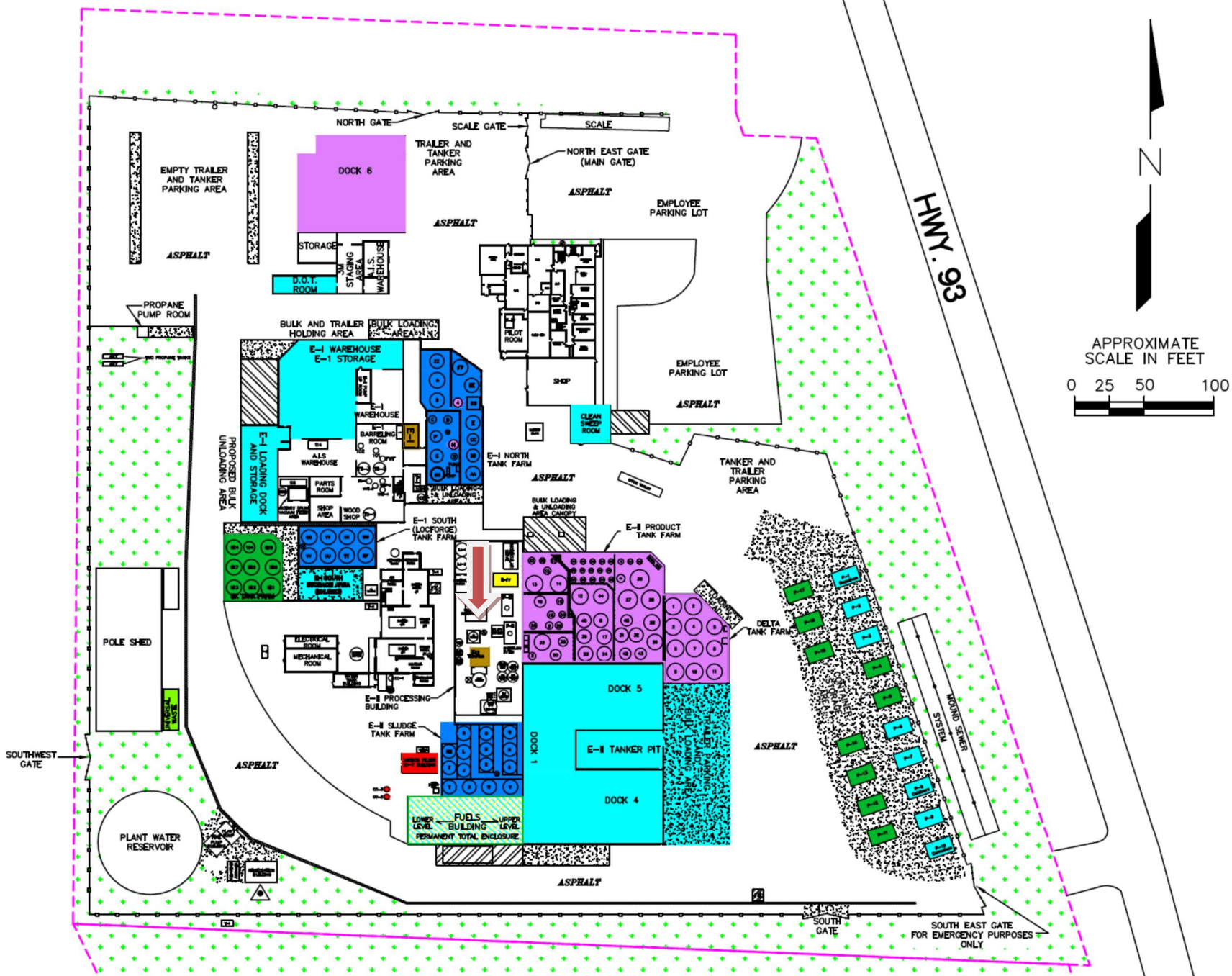

WRR Environmental Services Co Inc.
5200 Ryder Road
Eau Claire WI 54701
FID ID# 618026530
EPA ID# WID990829475

Condition 86 – DNR Spill Hotline Report

I certify under penalty of law that this document and all attachments were prepared under my direction or supervision according to a system designed to assure that qualified personnel properly gather and evaluate the information submitted. Based on my inquiry of the person or persons who manage the system, or those persons directly responsible for gathering the information, the information submitted is, to the best of my knowledge and belief, true, accurate and complete. I am aware that there are significant penalties for submitting false information, including the possibility of fine and imprisonment for knowing violations.



James L Hager
President/CEO

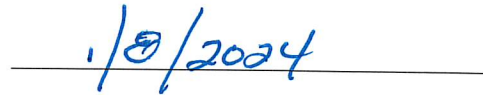

Date