

June 30, 2020
File No. 25216050.01

Mr. John Hnat
Wisconsin Department of Natural Resources
2300 N. Dr. Martin Luther King, Jr. Drive
Milwaukee, WI 53212-3128

Subject: June 2020 Groundwater Monitoring Results
PSK Investments, 9922 W. Capital Drive, Milwaukee, WI
BRRTS: 03-41-546764 Phillips 66 Station

Dear Mr. Hnat:

SCS Engineers is providing the following groundwater monitoring report for the above-noted PSK Investments case. Groundwater sampling was performed on June 11 and 15, 2020. The sampling was performed as planned with the following exceptions:

- The sump well could not be accessed for sampling on June 11 due to a stuck slip cap. The cap was removed and the sump was subsequently sampled on June 15.
- A water level measurement was not taken for monitoring well MW6 as the property owner (Grace Christian Fellowship) had not granted permission to access the well prior to our fieldwork.

Methods

Per the approved October 5, 2018 Change Order Request, water levels were measured at each well and wells MW1, MW2, MW3, MW5, MW7, MW20, MW21, and the groundwater sump were sampled for petroleum volatile organic compounds (PVOCs) plus naphthalene. Samples were collected using bailers after purging four well volumes or until the well went dry. A grab sample was collected from the sump without purging. Purge water was contained on site in a 55-gallon drum for future disposal.

Samples were containerized and properly preserved using laboratory-supplied containers. All samples were submitted under chain of custody to Eurofins TestAmerica of University Park, Illinois, for analysis. Laboratory analytical reports are provided in **Appendix A**, and groundwater analytical results are summarized in **Table 1**. Water level measurements are summarized in **Table 2**, and a groundwater flow map is provided as **Figure 1**.

Findings

Groundwater analytical results for the June 2020 sampling event confirm a continued decrease in groundwater contaminant concentrations. PVOCs and/or naphthalene exceeded enforcement standards in samples collected from wells MW3, MW20, and MW21. Based on sampling results to date, contaminants are not present at the remaining 11 wells at concentrations in excess of preventive action limits.



Mr. John Hnat
June 30, 2020
Page 2

In general, groundwater levels measured in June 2020 were approximately 1 foot higher than measured during prior sampling in March 2016, but within range of historic levels. The groundwater flow direction for June 2020 was predominantly northeast, which is consistent with prior flow information for the site.

Based on continued decreases in groundwater contaminant concentrations, SCS Engineers recommends that the soil vapor extraction (SVE) system be turned off per our June 24 SVE letter, and that the site be assessed for closure.

Sincerely,



Robert Langdon
Senior Project Manager
SCS Engineers

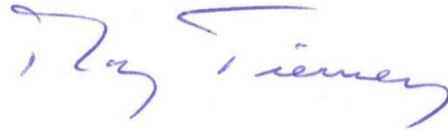

Ray Tierney, PG
Vice President
SCS Engineers

REL/lmh/RT

cc: J. Singh – PSK Investments
Thomas A Cabush – Cabush, Kasdorf, Lewis & Swietlik, SC
David G. Peterson – Reinhart, Boerner, Van Deuren, SC

Encl. Table 1 – Groundwater Analytical Results Summary – VOCs
Table 2 – Summary of Depth to Groundwater and Groundwater Elevation
Figure 1 – Water Table Map – June 2020
Appendix A – Groundwater Laboratory Reports

I:\25216050.01\Deliverables\June 2020 GW Monitoring Report\200630_Hnat_June 2020 Groundwater Monitoring Report_Final.docx

Table 1. Groundwater Analytical Results Summary - VOCs
 PSK Investments, LLC (Former KJG Investments Property) 9922 W Capitol Drive, Milwaukee, WI / (OM Job #2096) SCS Engineers Project #25211336.90 / #25216050.01
 (Results are in µg/L)

Sample	Date	Benzene	Ethylbenzene	Toluene	Xylenes	TMBs	MTBE	Naphthalene	Cumene	n-Propylbenzene	sec-Butylbenzene	Lead	Notes
MW-1	10/24/2006	560	120	4.1	24	10.2	7	<u>14</u>	--	--	--	--	On-site (NE), Active, Approx. 13 ft
	6/2/2007	34	22.7	<0.46	3.3	<1.57	0.6	NT	--	--	--	--	E of MW-2R & 6 ft W of Church
	9/13/2007	250	10	2.8	9.6	2.81	<3.5	--	--	--	--	--	
	12/20/2007	<0.22	<0.44	<0.26	<1.12	<0.67	0.96	--	--	--	--	--	
	2/11/2008	14	0.69	<0.36	1.1	<0.79	0.94	--	--	--	--	--	Shaw Environmental Sampling
	2/11/2008	12.1	0.82	<0.46	<1.85	<1.42	<0.62	--	--	--	--	--	OM Sampling (Duplicate)
	3/20/2008	10.5	1.11	<0.46	<1.85	<1.42	<0.62	--	--	--	--	--	
	6/24/2008	14.1	3.07	1.11	<1.85	<1.42	<0.62	--	--	--	--	--	
	9/30/2008	32	<0.68	0.93	<1.85	<1.42	<0.62	--	--	--	--	--	
	3/16/2009	<0.45	<0.76	<0.43	<1.58	<1.13	<0.42	--	--	--	--	--	
	6/4/2009	<u>1.4</u>	0.93 J	<0.36	<1.10	<0.79	N/A	--	--	--	--	--	Shaw
	8/24/2009	68.5	29.4	1.1	2.1	<0.79	0.86 J	--	--	--	--	--	Shaw
	8/24/2009	37	13.9	<0.51	<2.13	<2.6	1.92	--	--	--	--	--	OM/Bailer
	8/24/2009	70	26.8	0.72 J	<0.53	<2.6	1.04 J	--	--	--	--	--	Split from Shaw
	11/11/2009	5.9	2.19 J	<0.53	0.91 J	0.53 J	<0.42	--	--	--	--	--	Split from Shaw
	7/19/2010	<u>0.74</u> J	<0.65	<0.86	<2.15	<1.49	<0.49	<1.2	--	--	--	--	
	10/17/2010	58	21.3	3.4	3.01 J	0.85 J	2.15	--	--	--	--	--	
	1/15/2011	<0.5	<0.78	<0.53	<1.9	<1.54	2.57	--	--	--	--	--	
	4/16/2011	23	3.9	1.57 J	<3.2	<2.7	<0.47	--	--	--	--	--	
	7/17/2011	27.2	7.4	1.08 J	<3.2	<2.7	<0.47	--	--	--	--	--	
10/15/2011	9.3	1.5 J	<0.53	<1.9	<1.54	<0.8	--	--	--	--	--		
1/22/2012	<u>0.53</u> J	<0.98	<0.89	<3.2	<2.7	1.1 J	--	--	--	--	--	On-site (NE), Active, Approx. 13 ft	
4/21/2012	<u>3.8</u>	<0.78	<0.53	<1.9	<1.54	<0.80	--	--	--	--	--	E of MW-2R & 6 ft W of Church	
3/15/2016	<0.36	<0.37	<0.33	<0.58	<0.60	<0.24	--	--	--	--	--		
6/11/2020	<0.15	<0.18	<0.15	<0.22	<0.61	<0.39	<0.34	--	--	--	--		
MW-2	9/30/2006	120	65	11	76	1,022	< 2.0	<u>95</u>	--	--	--	--	On-site (NW), Active, Approx.
	6/2/2007	113	28.5	< 4.6	72.3	<u>400</u>	< 5.2	NT	--	--	--	--	11 ft NE of Premium Tank Sump
	9/13/2007	<u>2.7</u>	1.2	0.36	1.8	11	< 0.23	--	--	--	--	--	
	12/20/2007	265	52	16.8	47.8	591.8	< 5.3	--	--	--	--	--	
	3/20/2008	108	12.2	6.8	< 1.85	<u>268</u>	< 6.2	--	--	--	--	--	
	6/24/2008	8.8	2.93	1.57	3.4	37	< 0.62	--	--	--	--	--	
	9/30/2008	173	8.3	81	65.8	<u>114.7</u>	< 0.62	--	--	--	--	--	
	3/16/2009	161	14.9	9	22.2	<u>224.9</u>	< 0.42	--	--	--	--	--	
	8/24/2009	77	9.6 J	7.1 J	3.15 J	17.5	< 2.5	--	--	--	--	--	
	11/11/2009	195	20.1	4.5	10.63	84.9	< 0.42	--	--	--	--	--	Split from Shaw
	7/19/2010	80	2.47	7.2	5.06 J	4	< 0.49	1.53 J	--	--	--	--	
	10/17/2010	157	29	6.1	18.2	2.15 J	< 0.49	--	--	--	--	--	

Table 1. Groundwater Analytical Results Summary - VOCs
 PSK Investments, LLC (Former KJG Investments Property) 9922 W Capitol Drive, Milwaukee, WI / (OM Job #2096) SCS Engineers Project #25211336.90 / #25216050.01
 (Results are in µg/L)

Sample	Date	Benzene	Ethylbenzene	Toluene	Xylenes	TMBs	MTBE	Naphthalene	Cumene	n-Propylbenzene	sec-Butylbenzene	Lead	Notes
MW-2 (cont.)	1/15/2011	54	4.2	< 0.53	1.1 J	22.5	< 0.8	--	--	--	--	--	
	4/16/2011	< 0.49	< 0.98	< 0.89	< 3.2	< 2.7	< 0.47	--	--	--	--	--	
	7/17/2011	< 0.49	< 0.98	< 0.89	< 3.2	< 2.7	< 0.47	--	--	--	--	--	
	10/15/2011	127	< 0.78	< 0.53	< 1.9	< 1.54	< 0.8	--	--	--	--	--	
	1/22/2012	6	< 0.98	< 0.89	< 3.2	< 2.7	< 0.47	--	--	--	--	--	
	4/21/2012	< 0.5	< 0.78	< 0.53	< 1.9	< 1.54	< 0.80	--	--	--	--	--	
	3/15/2016	< 0.36	< 0.37	< 0.33	< 0.58	< 0.60	< 0.24	--	--	--	--	--	
	6/11/2020	< 0.15	< 0.18	< 0.15	< 0.22	< 0.61	< 0.39	< 0.34	--	--	--	--	
MW-3	9/30/2006	2,600	2,500	70	<u>1,600</u>	1,100	<u>34</u>	420	--	--	--	--	On-site (NW), Active, Approx. 3 ft
	6/2/2007	2,490	2,690	75	<u>1,104</u>	748	<u>27</u>	NT	--	--	--	--	E of W Lot Line, and 6 ft S of
	9/13/2007	1,800	1,700	57	<u>680</u>	480	< 0.23	--	--	--	--	--	N Lot Line
	12/20/2007	2,280	2,340	81	<u>1,065</u>	565	< 53	--	--	--	--	--	
	3/20/2008	1,950	1,880	54	<u>566</u>	<u>249</u>	< 31	--	--	--	--	--	
	6/24/2008	2,070	2,130	86	<u>1,217</u>	677	<u>15</u>	--	--	--	--	--	
	9/30/2008	1,780	2,320	81	<u>1,270</u>	670	< 0.62	--	--	--	--	--	
	3/16/2009	1,150	1,710	62	<u>851</u>	<u>475</u>	5.7	--	--	--	--	--	
	8/24/2009	1,670	2,250	53	<u>957</u>	<u>421</u>	8.7 J	--	--	--	--	--	
	11/11/2009	1,390	1,880	57 J	<u>935</u>	<u>426</u>	< 21	--	--	--	--	--	Split from Shaw
	7/19/2010	1,740	2,180	106	<u>1,251</u>	1,147	< 9.8	630	--	--	--	--	
	10/17/2010	1,420	2,190	99	<u>967</u>	<u>456</u>	< 9.8	--	--	--	--	--	
	1/15/2011	1,140	2,020	38 J	<u>540</u>	<u>152</u>	< 40	--	--	--	--	--	
	4/16/2011	1,180	1,710	46 J	<u>640</u>	<u>279</u>	< 23.5	--	--	--	--	--	
	7/17/2011	1,320	1,590	51	<u>453</u>	<u>276</u>	< 4.7	--	--	--	--	--	
	10/15/2011	1,460	1,900	32 J	<u>540</u>	<u>182</u>	< 40	--	--	--	--	--	
	1/22/2012	1,070	2,050	41 J	<u>630</u>	<u>227</u>	< 9.4	--	--	--	--	--	
	4/21/2012	980	2,310	44 J	<u>930</u>	714	< 28.5	--	--	--	--	--	On-site, NW Corner of Property
3/15/2016	680	2,200	54	<u>540</u>	<u>350</u>	2.5 J1	--	--	--	--	--		
6/11/2020	300	990	9.4	80	11.7	< 0.39	100 B	--	--	--	--		
6/11/2020 Dup	300	950	11	92	12.1	< 0.39	<u>98</u>	--	--	--	--		
MW-4	9/30/2006	< 0.20	< 0.50	< 0.20	< 0.50	< 0.40	< 0.50	0.37	--	--	--	--	On-site (SE) Active, Approximately
	6/2/2007	< 0.47	< 0.38	< 0.46	< 0.99	< 1.57	< 0.52	NT	--	--	--	--	11 ft W of Church west wall
	9/13/2007	<u>0.56</u>	1	< 0.11	0.99	0.84	< 0.23	--	--	--	--	--	Approx. 8 ft N of Capitol Dr ROW
	12/20/2007	< 0.22	< 0.44	< 0.26	< 1.21	< 0.67	< 0.53	--	--	--	--	--	
	3/20/2008	< 0.49	< 0.68	< 0.46	< 1.85	< 1.42	< 0.62	--	--	--	--	--	
	6/24/2008	< 0.49	< 0.68	< 0.46	< 1.85	< 1.42	< 0.62	--	--	--	--	--	
	9/30/2008	< 0.49	< 0.68	< 0.46	< 1.85	< 1.42	< 0.62	--	--	--	--	--	
	3/16/2009	< 0.45	< 0.76	< 0.53	< 1.58	< 1.13	< 0.42	--	--	--	--	--	

Table 1. Groundwater Analytical Results Summary - VOCs
 PSK Investments, LLC (Former KJG Investments Property) 9922 W Capitol Drive, Milwaukee, WI / (OM Job #2096) SCS Engineers Project #25211336.90 / #25216050.01
 (Results are in µg/L)

Sample	Date	Benzene	Ethylbenzene	Toluene	Xylenes	TMBs	MTBE	Naphthalene	Cumene	n-Propylbenzene	sec-Butylbenzene	Lead	Notes
MW-4 (cont.)	8/24/2009	< 0.41	< 0.87	< 0.51	< 2.13	< 2.6	< 0.5	--	--	--	--	--	
	11/11/2009	< 0.41	< 0.87	< 0.51	< 2.13	< 2.6	< 0.50	--	--	--	--	--	Split from Shaw
	7/19/2010	< 0.40	< 0.65	< 0.86	< 2.15	< 1.49	< 0.49	< 1.2	--	--	--	--	
	10/17/2010	< 0.40	< 0.65	< 0.86	< 2.15	< 1.49	< 0.49	--	--	--	--	--	
	1/15/2011	< 0.5	< 0.78	< 0.53	< 1.9	< 1.54	< 0.8	--	--	--	--	--	
	4/15/2011	< 0.49	< 0.98	< 0.89	< 3.2	< 2.7	< 0.47	--	--	--	--	--	
	7/17/2011	< 0.49	< 0.98	< 0.89	< 3.2	< 2.7	< 0.47	--	--	--	--	--	
	10/15/2011	< 0.5	< 0.78	< 0.53	< 1.9	< 1.54	< 0.8	--	--	--	--	--	
	1/22/2012	< 0.49	< 0.98	< 0.98	< 3.2	< 2.7	< 0.47	--	--	--	--	--	
	4/21/2012	< 0.5	< 0.78	< 0.53	< 1.9	< 1.54	< 0.80	--	--	--	--	--	
	3/15/2016	< 0.36	< 0.37	< 0.33	< 0.58	< 0.60	< 0.24	--	--	--	--	--	
MW-5	9/30/2006	19	0.8	< 0.20	0.86	0.47	< 0.50	0.56	--	--	--	--	On-site (along west lot line)
	6/2/2007	13.3	< 0.38	< 0.46	< 0.99	< 1.57	< 0.52	NT	--	--	--	--	Approx. 3.1 ft SW of MW-1R
	9/13/2007	18	0.58	< 0.11	0.57	0.41	< 0.23	--	--	--	--	--	
	12/20/2007	4.5	< 0.44	0.27	< 1.21	< 0.67	6	--	--	--	--	--	
	3/20/2008	5.5	< 0.68	0.82	< 1.85	< 1.42	2.17	--	--	--	--	--	
	6/24/2008	2.42	< 0.68	0.59	< 1.85	< 1.42	1.56	--	--	--	--	--	
	9/30/2008	10	< 0.68	1.79	< 1.85	< 1.42	< 0.62	--	--	--	--	--	
	3/16/2009	5.1	< 0.76	< 0.53	< 1.58	< 1.13	5.2	--	--	--	--	--	
	8/24/2009	2.03	< 0.87	< 0.51	< 2.13	< 2.6	< 0.5	--	--	--	--	--	
	11/11/2009	3.02	< 0.76	1.31 J	0.93 J	0.56 J	5	--	--	--	--	--	Split from Shaw
	7/19/2010	2.27	< 0.65	2.63 J	< 2.15	< 1.49	< 0.49	< 1.2	--	--	--	--	
	10/17/2010	6.2	0.86 J	4.8	< 2.15	< 1.49	< 0.49	--	--	--	--	--	
	1/15/2011	2.25	< 0.78	< 0.53	< 1.9	< 1.54	2.01 J	--	--	--	--	--	
	4/15/2011	2.31	< 0.98	1.42 J	< 3.2	< 2.7	4	--	--	--	--	--	
	7/17/2011	1.85	1.17 J	1.28 J	< 3.2	< 2.7	< 0.47	--	--	--	--	--	
	10/15/2011	0.69 J	< 0.78	< 0.53	< 1.9	< 1.54	< 0.8	--	--	--	--	--	
	1/22/2012	12.7	< 0.98	1.15 J	< 3.2	< 2.7	< 0.47	--	--	--	--	--	
	4/21/2012	10.6	0.55 J	< 0.48	< 1.45	< 1.57	< 0.57	--	--	--	--	--	
	3/15/2016	3.7	< 0.37	0.43 J1	< 0.58	< 0.60	6.8	--	--	--	--	--	
3/15/2016 Dup	3.6	< 0.37	0.53	< 0.58	< 0.60	6.7	--	--	--	--	--		
6/11/2020	< 0.15	< 0.18	< 0.15	< 0.22	< 0.61	< 0.39	< 0.34	--	--	--	--	--	
MW-6	9/30/2006	< 0.20	< 0.50	< 0.20	< 0.50	< 0.40	< 0.50	< 0.25	--	--	--	--	NE of Church Building
	6/2/2007	< 0.47	< 0.38	< 0.46	< 0.99	< 1.57	< 0.52	NT	--	--	--	--	
	8/12/2009	< 0.23	< 0.40	< 0.36	< 1.10	< 0.79	< 0.36	--	--	--	--	--	Shaw
	8/24/2009	< 0.23	< 0.40	< 0.36	< 1.10	< 0.79	< 0.36	--	--	--	--	--	Shaw
	8/24/2009	< 0.41	< 0.87	< 0.51	< 2.13	< 2.6	< 0.50	--	--	--	--	--	OM

Table 1. Groundwater Analytical Results Summary - VOCs
 PSK Investments, LLC (Former KJG Investments Property) 9922 W Capitol Drive, Milwaukee, WI / (OM Job #2096) SCS Engineers Project #25211336.90 / #25216050.01
 (Results are in µg/L)

Sample	Date	Benzene	Ethylbenzene	Toluene	Xylenes	TMBs	MTBE	Naphthalene	Cumene	n-Propylbenzene	sec-Butylbenzene	Lead	Notes
MW-6 (cont.)	11/11/2009	< 0.45	< 0.76	< 0.53	< 1.58	< 1.13	< 0.42	--	--	--	--	--	Split from Shaw
	7/19/2010	< 0.4	< 0.65	< 0.86	< 2.15	< 1.49	< 0.49	< 1.2	--	--	--	--	
	10/19/2010	< 0.4	< 0.65	< 0.86	< 2.15	< 1.49	< 0.49	--	--	--	--	--	
	1/14/2011	< 0.5	< 0.78	< 0.53	< 1.9	< 1.54	< 0.8	--	--	--	--	--	
	4/15/2011	< 0.49	< 0.98	< 0.89	< 3.2	< 2.7	< 0.47	--	--	--	--	--	
	7/15/2011	< 0.49	< 0.98	< 0.89	< 3.2	< 2.7	< 0.47	--	--	--	--	--	
	10/28/2011	< 0.5	< 0.78	< 0.53	< 1.9	< 1.54	< 0.8	--	--	--	--	--	
	1/20/2012	< 0.49	< 0.98	< 0.98	< 3.2	< 2.7	< 0.47	--	--	--	--	--	
	4/20/2012	< 0.5	< 0.78	< 0.53	< 1.9	< 1.54	< 0.8	--	--	--	--	--	
	3/15/2016	< 0.36	< 0.37	< 0.33	< 0.58	< 0.60	< 0.24	--	--	--	--	--	
MW-7	4/10/2010	303	<i>400</i>	< 7.2	44	29.8	< 2.5	<i>35</i> J	--	--	--	--	NE Corner of Carwash Bldg.
	7/19/2010	500	<i>340</i>	6.1	17.3	6.1	< 0.49	5.8	--	--	--	--	
	10/16/2010	112	<i>340</i>	< 7.2	< 16.2	12	< 2.5	--	--	--	--	--	
	1/14/2011	130	<i>300</i>	< 5.3	41	29.7	< 8	--	--	--	--	--	
	4/14/2011	90	129	< 8.9	< 32	< 27	< 4.7	--	--	--	--	--	
	7/15/2011	23	< 0.98	< 0.89	< 3.2	< 2.7	< 0.47	--	--	--	--	--	
	10/14/2011	21.7	< 0.78	< 0.53	< 1.9	< 1.54	< 0.8	--	--	--	--	--	
	1/21/2012	11.6	1.03 J	< 0.89	< 3.2	< 2.7	< 0.47	--	--	--	--	--	
	4/20/2012	4	< 0.78	< 0.53	< 1.9	< 1.54	< 0.8	--	--	--	--	--	
	3/15/2016	2	1.4	0.69	0.78 J1	< 0.60	< 0.24	--	--	--	--	--	
6/11/2020	< 0.15	0.23 J1	< 0.15	< 0.22	< 0.61	< 0.39	0.48 J1 B	--	--	--	--		
MW-8	4/10/2010	< 0.38	< 0.55	< 0.72	< 1.62	< 1.20	< 0.25	< 2.4	--	--	--	--	North ROW of W Sarasota Pl.
	7/19/2010	< 0.40	< 0.65	< 0.86	< 2.15	< 1.49	< 0.49	< 1.2	--	--	--	--	
	10/16/2010	< 0.38	< 0.55	0.78 J	< 1.62	1.03 J	< 0.25	--	--	--	--	--	
	1/14/2011	< 0.5	< 0.78	< 0.53	< 1.9	< 1.54	< 0.8	--	--	--	--	--	
	4/14/2011	< 0.49	< 0.98	< 0.89	< 3.2	< 2.7	< 0.47	--	--	--	--	--	
	7/15/2011	< 0.49	< 0.98	< 0.89	< 3.2	< 2.7	< 0.47	--	--	--	--	--	
	10/14/2011	< 0.5	< 0.78	< 0.53	< 1.9	< 1.54	< 0.8	--	--	--	--	--	
	1/21/2012	< 0.49	< 0.98	< 0.98	< 3.2	< 2.7	< 0.47	--	--	--	--	--	
	4/20/2012	< 0.5	< 0.78	< 0.53	< 1.9	< 1.54	< 0.8	--	--	--	--	--	
	3/15/2016	< 0.36	< 0.37	< 0.33	< 0.58	< 0.60	< 0.24	--	--	--	--	--	
MW-9	4/10/2010	< 0.38	< 0.55	< 0.72	< 1.62	< 1.20	< 0.25	< 2.4	--	--	--	--	East ROW of W Sarasota Pl.
	7/19/2010	< 0.40	< 0.65	< 0.86	< 2.15	< 1.49	< 0.49	< 1.2	--	--	--	--	
	10/16/2010	< 0.38	< 0.55	< 0.72	< 1.62	< 1.20	< 0.25	--	--	--	--	--	
	1/14/2011	< 0.5	< 0.78	< 0.53	< 1.9	< 1.54	< 0.8	--	--	--	--	--	
	4/14/2011	< 0.49	< 0.98	< 0.89	< 3.2	< 2.7	< 0.47	--	--	--	--	--	
	7/15/2011	< 0.49	< 0.98	< 0.89	< 3.2	< 2.7	< 0.47	--	--	--	--	--	

Table 1. Groundwater Analytical Results Summary - VOCs
 PSK Investments, LLC (Former KJG Investments Property) 9922 W Capitol Drive, Milwaukee, WI / (OM Job #2096) SCS Engineers Project #25211336.90 / #25216050.01
 (Results are in µg/L)

Sample	Date	Benzene	Ethylbenzene	Toluene	Xylenes	TMBs	MTBE	Naphthalene	Cumene	n-Propylbenzene	sec-Butylbenzene	Lead	Notes
MW-9 (cont.)	10/14/2011	< 0.5	< 0.78	< 0.53	< 1.9	< 1.54	< 0.8	--	--	--	--	--	
	1/21/2012	< 0.49	< 0.98	< 0.98	< 3.2	< 2.7	< 0.47	--	--	--	--	--	East ROW of W Sarasota Pl.
	4/20/2012	< 0.5	< 0.78	< 0.53	< 1.9	< 1.54	< 0.8	--	--	--	--	--	
	3/15/2016	<0.36	<0.37	<0.33	<0.58	<0.60	<0.24	--	--	--	--	--	
MW-10	4/10/2010	< 0.38	< 0.55	< 0.72	< 1.62	< 1.20	0.59 J	< 2.4	--	--	--	--	Alley
	7/19/2010	< 0.40	< 0.65	< 0.86	< 2.15	< 1.49	0.53 J	< 1.2	--	--	--	--	
	10/16/2010	< 0.38	< 0.55	< 1.20	< 1.62	< 1.20	< 0.25	--	--	--	--	--	
	1/14/2011	< 0.5	< 0.78	< 0.53	< 1.9	< 1.54	< 0.8	--	--	--	--	--	
	4/14/2011	< 0.49	< 0.98	< 0.89	< 3.2	< 2.7	< 0.47	--	--	--	--	--	
	7/15/2011	< 0.49	< 0.98	< 0.89	< 3.2	< 2.7	< 0.47	--	--	--	--	--	
	10/14/2011	< 0.5	< 0.78	< 0.53	< 1.9	< 1.54	< 0.8	--	--	--	--	--	
	1/27/2012	< 0.49	< 0.98	< 0.98	< 3.2	< 2.7	< 0.47	--	--	--	--	--	
	4/20/2012	< 0.5	< 0.78	< 0.53	< 1.9	< 1.54	< 0.8	--	--	--	--	--	
MW-11	1/21/2012	< 0.5	< 0.78	< 0.53	< 1.9	< 1.54	< 0.8	--	--	--	--	--	ROW of N 100th Street, OM
	4/20/2012	< 0.5	< 0.78	< 0.53	< 1.9	< 1.54	< 0.8	--	--	--	--	--	
	3/15/2016	<0.36	<0.37	<0.33	<0.58	<0.60	<0.24	--	--	--	--	--	
MW-20	8/24/2010	702	1,340	54.7	<u>1,903</u>	1,297	< 6.1	332	55.3	191	9.7 J	--	Shaw
	8/24/2010	640	920	42 J	<u>1,320</u>	844	< 12.5	272 J	41 J	112	< 29.5	--	OM
	10/16/2010	730	1,790	46	<u>1,107.5</u>	800	< 2.5	--	--	--	--	--	OM
	1/14/2011	990	1,780	42	<u>510</u>	<u>285</u>	< 16	--	--	--	--	--	
	4/14/2011	850	1,990	80	<u>1,898</u>	1,409	< 9.4	--	--	--	--	--	
	7/15/2011	490	29.8 J	120	<u>1,236</u>	740	< 9.4	--	--	--	--	--	
	10/14/2011	26.2	66	5.9 J	52	46	< 8	--	--	--	--	--	
	1/21/2012	570	1,640	55	<u>1,298</u>	1,086	< 4.7	--	--	--	--	--	
	4/20/2012	43	<u>560</u>	11.9 J	<u>1,220</u>	1,032	< 8	--	--	--	--	--	
	3/15/2016	550	2,200	60	<u>640</u>	81	< 2.4	--	--	--	--	--	
6/11/2020	78	1,300	6.6	100	8 J1	< 2.0	320 B	--	--	--	--		
MW-21	8/24/2010	1,970	705	118	<u>718</u>	44.5	< 15.20	2,100	15 J	43.2	--	--	Shaw
	8/24/2010	2,310	860	136	<u>714</u>	<u>190</u>	< 12.5	2,650	< 35.5	60 J	< 29.5	--	OM
	10/16/2010	1,440	<u>440</u>	< 36	308	<u>122</u>	< 12.5	--	--	--	--	--	OM
	1/14/2011	2,870	1,280	62	<u>420</u>	<u>113</u>	< 16	--	--	--	--	--	Off-site/NW of Carwash
	4/14/2011	2,060	810	65	309	<u>114</u>	< 9.4	--	--	--	--	--	
	7/15/2011	2,370	1,270	70	<u>510</u>	<u>122</u>	< 9.4	--	--	--	--	--	
	10/14/2011	2,050	970	83	<u>438</u>	74	< 8	--	--	--	--	--	
	1/21/2012	2,100	1,190	106	<u>555</u>	<u>320</u>	< 9.4	--	--	--	--	--	
	4/20/2012	2,100	1,360	101	336	<u>112 J</u>	< 40	--	--	--	--	--	

Table 1. Groundwater Analytical Results Summary - VOCs
 PSK Investments, LLC (Former KJG Investments Property) 9922 W Capitol Drive, Milwaukee, WI / (OM Job #2096) SCS Engineers Project #25211336.90 / #25216050.01
 (Results are in µg/L)

Sample	Date	Benzene	Ethylbenzene	Toluene	Xylenes	TMBs	MTBE	Naphthalene	Cumene	n-Propylbenzene	sec-Butylbenzene	Lead	Notes	
MW-21 (cont.)	3/15/2016	<u>1,200</u>	<u>600</u>	42	180	34	<2.4	--	--	--	--	--		
	6/11/2020	<u>230</u>	44	3.1	15	4.4	<0.39	<u>150</u> B	--	--	--	--		
Excavation Sump	4/29/2006	<u>5,700</u>	<u>970</u>	<u>11,000</u>	<u>5,900</u>	<u>1,070</u>	< 100	<u>570</u>	--	--	--	--	OM Sampling	
	4/29/2006	<u>520</u>	35	17	190	N/A	<u>17</u>	N/A	--	--	--	--	Shaw Table 1 of 12/29/09 Report	
	9/30/2006	<u>890</u>	19	58	<u>1200</u>	<u>302</u>	<u>19</u>	NT	--	--	--	--		
	6/2/2007	<u>1,010</u>	<u>174</u>	< 23	221	<u>268</u>	< 26	NT	--	--	--	--	On-site (along east lot line)	
	9/13/2007	<u>1,200</u>	<u>190</u>	110	380	<u>328</u>	< 0.23	--	--	--	--	--	Active, approx. 32 ft S from NW	
	12/20/2007	< 0.22	0.79	0.29	4.63	1.58	1.17	--	--	--	--	--	Corner of Church wall	
	1/30/2008	<u>600</u>	120	6.6	129	<u>150</u>	<u>15</u>	--	--	--	--	--		
	2/11/2008	<u>780</u>	<u>150</u>	9.8	176	<u>190</u>	<u>19</u>	--	--	--	--	--	Shaw Environmental Sampling	
	2/11/2008 Dup	<u>740</u>	137	11.8	170	<u>170</u>	<u>15.30</u>	--	--	--	--	--	OM Sampling (Duplicate)	
	3/20/2008	<u>157</u>	37	< 4.6	63	53	< 6.2	--	--	--	--	--		
	6/24/2008	<u>500</u>	116	9.8	88.9	<u>132</u>	<u>15.10</u>	--	--	--	--	--		
	9/3/2008	<u>388</u>	77.6	18.4	46	<u>133.6</u>	7	--	--	--	--	--	Shaw Table 1 of 12/29/09 Report	
	9/30/2008	<u>309</u>	80	22	71.7	<u>133</u>	< 6.2	--	--	--	--	--		
	3/16/2009	< 0.45	< 0.76	< 0.53	< 1.58	< 1.13	0.57	--	--	--	--	--	--	
	6/4/2009	<u>79.4</u>	16	1.6	4.2	18.7	N/A	--	--	--	--	--	--	Shaw
	8/24/2009	<u>78.8</u>	13.1	1.9	3.8	3.9	2	--	--	--	--	--	--	Shaw
	8/24/2009	<u>65</u>	12.7	1.75	4.1	3.9	2.46	--	--	--	--	--	--	OM
	8/24/2009	<u>56</u>	< 17.4	< 10.2	< 42.6	< 52	< 10	--	--	--	--	--	--	Split from Shaw/Slow Flow GWS
	11/11/2009	<u>107</u>	13.7 J	< 5.3	8.6 J	< 11.3	< 4.2	--	--	--	--	--	--	Split from Shaw
	7/19/2010	<u>72</u>	9.8	2.13 J	1.84 J	0.74 J	3.80	2.42 J	--	--	--	--	--	
	10/17/2010	<u>267</u>	18	24.3	23.6	11.8	5.90	--	--	--	--	--	--	
	1/15/2011	<u>0.77</u> J	< 0.78	< 0.53	< 1.90	< 1.54	< 0.80	--	--	--	--	--	--	
	4/16/2011	<u>150</u>	9.2	3.7	6.91	3.5 J	3.04	--	--	--	--	--	--	
	7/17/2011	<u>101</u>	4.8	2.56 J	2.93 J	< 2.7	3.10	--	--	--	--	--	--	
	10/15/2011	<u>138</u>	5.3	4.3	5.35 J	2.65	2.40 J	--	--	--	--	--	--	
	1/22/2012	<u>1.87</u>	< 0.98	< 0.89	< 3.2	< 2.7	< 0.47	--	--	--	--	--	--	
4/21/2012	<u>34</u>	0.8 J	< 0.48	< 1.45	< 1.57	1.36 J	--	--	--	--	--	--		
3/15/2016	< 0.36	< 0.37	0.36 J1	< 0.58	< 0.60	< 0.24	--	--	--	--	--	--		
6/15/2020	< 0.15	< 0.18	< 0.15	< 0.22	< 0.61	< 0.39	< 0.34	--	--	--	--	--		
Church Sump	6/23/1997*	<u>520</u>	35	17	190	72	<u>17</u>	NT	--	--	--	--	Basement	
	4/27/2006	<u>940</u>	<u>1,600</u>	<u>6,000</u>	<u>9,700</u>	<u>5,790</u>	< 80	<u>1,800</u>	--	--	--	--		
	8/22/2006	0.35	< 0.22	0.16	2.3	3.05	0.40	NT	--	--	--	--		
	2/9/2007	< 0.14	< 0.40	< 0.36	< 1.10	< 0.79	< 0.36	--	--	--	--	--	Shaw Environmental (Exhibit # 13)	
	8/12/2009	< 0.23	< 0.40	< 0.36	< 1.10	< 0.79	< 0.36	--	--	--	--	--	Shaw	

Table 1. Groundwater Analytical Results Summary - VOCs
 PSK Investments, LLC (Former KJG Investments Property) 9922 W Capitol Drive, Milwaukee, WI / (OM Job #2096) SCS Engineers Project #25211336.90 / #25216050.01
 (Results are in µg/L)

Sample	Date	Benzene	Ethylbenzene	Toluene	Xylenes	TMBs	MTBE	Naphthalene	Cumene	n-Propylbenzene	sec-Butylbenzene	Lead	Notes
Church Sump (cont.)	8/24/2009	< 0.23	< 0.40	< 0.36	< 1.10	< 0.79	< 0.36	--	--	--	--	--	Shaw
	8/24/2009	< 0.41	< 0.87	< 0.51	< 2.13	< 2.6	< 0.50	--	--	--	--	--	OM
	11/11/2009	< 0.45	< 0.76	< 0.53	< 1.58	< 1.13	< 0.42	--	--	--	--	--	Split from Shaw
	7/19/2010	< 0.40	< 0.65	< 0.86	< 2.15	< 1.49	< 0.49	< 1.2	--	--	--	--	
	10/19/2010	< 0.40	< 0.55	1.13 J	< 1.62	< 1.20	< 0.25	--	--	--	--	--	
	1/14/2011	< 0.50	< 0.78	< 0.53	< 1.9	< 1.54	2.57	--	--	--	--	--	
	4/15/2011	< 0.49	< 0.98	< 0.89	< 3.2	< 2.7	< 0.47	--	--	--	--	--	
	7/15/2011	< 0.49	< 0.98	< 0.89	< 3.2	< 2.7	< 0.47	--	--	--	--	--	
	10/28/2011	< 0.5	< 0.78	< 0.53	< 1.9	< 1.54	< 0.8	--	--	--	--	--	
	1/20/2012	< 0.49	< 0.98	< 0.98	< 3.2	< 2.7	< 0.47	--	--	--	--	--	
	4/20/2012	< 0.5	< 0.78	< 0.53	< 1.9	< 1.54	< 0.8	--	--	--	--	--	
3/15/2016	<0.36	<0.37	<0.33	<0.58	<0.60	<0.24	--	--	--	--	--		
TB	6/11/2020	<0.15	<0.18	<0.15	<0.22	<0.61	<0.39	0.57 J1 B	--	--	--	--	
	6/15/2020	<0.15	<0.18	0.41 J1	<0.22	<0.61	<0.39	<0.34	--	--	--	--	
NR 140 Enforcement Standards (ESS)		5	700	800	2,000	480	60	100	NE	NE	NE	15	
NR 140 Preventive Action Limits (PALs)		0.5	140	160	400	96	12	10	NE	NE	NE	1.5	

Abbreviations:

µg/L = micrograms per liter or parts per billion (ppb)
 MTBE = Methyl-tert-butyl ether
 -- = Not Applicable

VOCs = Volatile Organic Compounds
 Dup = Duplicate Sample

TMBs = 1,2,4- and 1,3,5-trimethylbenzenes
 NE = No Standard Established

Notes:

NR 140 ESS - Wisconsin Administrative Code (WAC), Chapter NR 140.10 Table 1 - Public Health Groundwater Quality Standards from January 2020

NR 140 PALs - WAC, Chapter NR 140.10 Table 1 - Public Health Groundwater Quality Standards from January 2020

Bold+underlined values meet or exceed NR 140 enforcement standards.

Italic+underlined values meet or exceed NR 140 preventive action limits.

This table is adapted from previous reports by OM Enterprises. SCS Engineers results are for the 3/15/16 and later results (if present)

Laboratory Notes/Qualifiers:

B = Compound was found in the blank and sample.

J = Denotes concentration between Limit of Detection (LOD) and Limit of Quantification (LOQ)

J1 = Result is less than the Reporting Limit (RL) but greater than or equal to the Method Detection Limit (MDL) and the concentration is an approximate value.

Created by:	<u>AV</u>	Date:	<u>3/29/2016</u>
Last revision by:	<u>JSN</u>	Date:	<u>6/23/2020</u>
Checked by:	<u>AJR</u>	Date:	<u>6/23/2020</u>
Proj Mgr QA/QC:	<u>RT</u>	Date:	<u>6/29/2020</u>

I:\25216050.01\Deliverables\June 2020 GW Monitoring Report\[Table 1_GWVOCs.xls]GW VOCs

Table 2. Summary of Depth to Groundwater and Groundwater Elevation
PSK Investments, LLC (Former KJG Investments Property) 9922 W Capitol Drive, Milwaukee, WI / OM Job #2096
SCS Project #25216050.01

Well ID	Well Location	Well Depth (feet)	Screen Length (feet)	Internal Diameter (inch)	Surface Elevation (feet)	PVC Elevation (feet, MSL)	Date	Depth to Water (feet)	Groundwater Elevation (feet, MSL)
MW-1	Gas Station	20.00	10.00	4.00	722.81	722.05	10/24/06	13.80	708.25
							6/2/07	13.55	708.50
							9/13/07	13.30	708.75
							12/20/07	15.50	706.55
							2/11/08	14.75	707.30
							3/20/08	13.00	709.05
							6/24/08	12.99	709.06
							9/30/08	13.56	708.49
							3/16/09	12.84	709.21
							8/24/09	14.05	708.00
							11/11/09	14.00	708.05
							7/19/10	12.60	709.45
							8/23/10	13.05	709.00
							8/24/10	13.11	708.94
							10/17/10	14.65	707.40
							1/15/11	17.05	705.00
							4/16/11	12.50	709.55
							4/23/11	11.30	710.75
							7/17/11	13.25	708.80
							10/15/11	14.20	707.85
1/22/12	16.45	705.60							
1/27/12	15.27	706.78							
4/20/12	14.05	708.00							
3/15/16	14.05	708.00							
6/11/20	13.18	708.87							
Average								13.84	708.21

Table 2. Summary of Depth to Groundwater and Groundwater Elevation
PSK Investments, LLC (Former KJG Investments Property) 9922 W Capitol Drive, Milwaukee, WI / OM Job #2096
SCS Project #25216050.01

Well ID	Well Location	Well Depth (feet)	Screen Length (feet)	Internal Diameter (inch)	Surface Elevation (feet)	PVC Elevation (feet, MSL)	Date	Depth to Water (feet)	Groundwater Elevation (feet, MSL)
MW-2	Gas Station	15.50	10.00	4.00	722.73	722.25	8/16/06	7.52	714.73
							6/2/07	6.30	715.95
							9/13/07	5.50	716.75
							12/20/07	7.45	714.80
							3/20/08	6.39	715.86
							6/24/08	5.10	717.15
							9/30/08	6.30	715.95
							3/16/09	6.17	716.08
							8/24/09	6.80	715.45
							11/11/09	6.28	715.97
							7/19/10	5.20	717.05
							8/23/10	5.43	716.82
							8/24/10	5.47	716.78
							10/17/10	6.88	715.37
							1/15/11	7.85	714.40
							4/16/11	5.95	716.30
							4/23/11	5.19	717.06
							7/17/11	6.23	716.02
							10/15/11	6.20	716.05
							1/22/12	6.70	715.55
1/27/12	7.74	714.51							
4/20/12	6.35	715.90							
3/15/16	6.15	716.10							
6/11/20	5.20	717.05							
Average								6.26	715.99

Table 2. Summary of Depth to Groundwater and Groundwater Elevation
PSK Investments, LLC (Former KJG Investments Property) 9922 W Capitol Drive, Milwaukee, WI / OM Job #2096
SCS Project #25216050.01

Well ID	Well Location	Well Depth (feet)	Screen Length (feet)	Internal Diameter (inch)	Surface Elevation (feet)	PVC Elevation (feet, MSL)	Date	Depth to Water (feet)	Groundwater Elevation (feet, MSL)
MW-3	Gas Station	15.00	10.00	2.00	722.80	722.10	8/16/06	8.50	713.60
							6/2/07	7.70	714.40
							9/13/07	6.89	715.21
							12/20/07	8.85	713.25
							3/20/08	7.84	714.26
							6/24/08	6.66	715.44
							9/30/08	8.10	714.00
							3/16/09	7.80	714.30
							8/24/09	8.38	713.72
							11/11/09	7.95	714.15
							7/19/10	6.74	715.36
							8/23/10	7.13	714.97
							8/24/10	7.11	714.99
							10/17/10	8.40	713.70
							1/15/11	9.40	712.70
							4/16/11	7.30	714.80
							4/23/11	6.35	715.75
							7/17/11	7.60	714.50
							7/15/11	7.70	714.40
							1/22/12	8.15	713.95
1/27/12	8.30	713.80							
4/20/12	7.85	714.25							
3/15/16	7.68	714.42							
6/11/20	6.62	715.48							
Average								7.71	714.39

Table 2. Summary of Depth to Groundwater and Groundwater Elevation
PSK Investments, LLC (Former KJG Investments Property) 9922 W Capitol Drive, Milwaukee, WI / OM Job #2096
SCS Project #25216050.01

Well ID	Well Location	Well Depth (feet)	Screen Length (feet)	Internal Diameter (inch)	Surface Elevation (feet)	PVC Elevation (feet, MSL)	Date	Depth to Water (feet)	Groundwater Elevation (feet, MSL)
MW-4	Gas Station	15.00	10.00	2.00	721.47	720.55	8/16/06	7.36	713.19
							6/2/07	6.52	714.03
							9/13/07	6.84	713.71
							12/20/07	8.18	712.37
							3/20/08	6.59	713.96
							6/24/08	5.98	714.57
							9/30/08	7.90	712.65
							3/16/09	7.06	713.49
							8/24/09	7.62	712.93
							11/11/09	7.30	713.25
							7/19/10	7.14	713.41
							8/23/10	6.70	713.85
							8/24/10	6.75	713.80
							10/17/10	8.75	711.80
							1/15/11	9.59	710.96
							4/15/11	5.85	714.70
							4/23/11	7.13	713.42
							7/17/11	6.61	713.94
							10/15/11	8.40	712.15
							1/22/12	7.70	712.85
1/27/12	7.44	713.11							
4/20/12	7.65	712.90							
3/15/16	5.70	714.85							
6/11/20	5.39	715.16							
Average								7.17	713.38

Table 2. Summary of Depth to Groundwater and Groundwater Elevation
PSK Investments, LLC (Former KJG Investments Property) 9922 W Capitol Drive, Milwaukee, WI / OM Job #2096
SCS Project #25216050.01

Well ID	Well Location	Well Depth (feet)	Screen Length (feet)	Internal Diameter (inch)	Surface Elevation (feet)	PVC Elevation (feet, MSL)	Date	Depth to Water (feet)	Groundwater Elevation (feet, MSL)
MW-5	Gas Station	15.00	10.00	2.00	724.54	723.84	8/16/06	11.99	711.85
							6/2/07	11.42	712.42
							9/13/07	11.05	712.79
							12/20/07	11.58	712.26
							3/20/08	10.50	713.34
							6/24/08	10.10	713.74
							9/30/08	11.57	712.27
							3/16/09	10.80	713.04
							8/24/09	12.41	711.43
							11/11/09	11.55	712.29
							7/19/10	10.25	713.59
							8/23/10	11.24	712.60
							8/24/10	11.26	712.58
							10/17/10	12.38	711.46
							1/15/11	12.83	711.01
							4/15/11	9.95	713.89
							4/23/11	9.95	713.89
							7/17/11	11.57	712.27
							10/15/11	11.90	711.94
							1/22/12	12.02	711.82
1/27/12	11.73	712.11							
4/20/12	11.25	712.59							
3/15/16	10.31	713.53							
6/11/20	9.90	713.94							
Average								11.23	712.61

Table 2. Summary of Depth to Groundwater and Groundwater Elevation
PSK Investments, LLC (Former KJG Investments Property) 9922 W Capitol Drive, Milwaukee, WI / OM Job #2096
SCS Project #25216050.01

Well ID	Well Location	Well Depth (feet)	Screen Length (feet)	Internal Diameter (inch)	Surface Elevation (feet)	PVC Elevation (feet, MSL)	Date	Depth to Water (feet)	Groundwater Elevation (feet, MSL)
MW-6	Church	20.00	15.00	2.00	718.91	718.32	8/16/06	15.10	703.22
							6/2/07	15.70	702.62
							8/24/09	16.38	701.94
							11/11/09	16.08	702.24
							7/19/10	14.06	704.26
							8/24/10	13.88	704.44
							10/19/10	15.95	702.37
							1/14/11	16.26	702.06
							4/14/11	14.40	703.92
							7/15/11	15.33	702.99
							10/28/11	15.87	702.45
							1/20/12	15.79	702.53
							4/20/12	14.58	703.74
							3/15/16	14.07	704.25
6/11/20	NM	NM							
Average	15.25	703.07							

Table 2. Summary of Depth to Groundwater and Groundwater Elevation
PSK Investments, LLC (Former KJG Investments Property) 9922 W Capitol Drive, Milwaukee, WI / OM Job #2096
SCS Project #25216050.01

Well ID	Well Location	Well Depth (feet)	Screen Length (feet)	Internal Diameter (inch)	Surface Elevation (feet)	PVC Elevation (feet, MSL)	Date	Depth to Water (feet)	Groundwater Elevation (feet, MSL)
Excavation Sump Shaw	Gas Station	15.00	10.00	6.00	722.86	722.58	4/28/06	14.00	708.58
							6/2/07	14.25	708.33
							9/13/07	14.30	708.28
							12/20/07	14.30	708.28
							2/11/08	14.32	708.26
							6/24/08	14.30	708.28
							9/30/08	14.34	708.24
							3/16/09	14.30	708.28
							8/24/09	14.30	708.28
							11/11/09	14.29	708.29
							7/19/10	14.25	708.33
							8/23/10	14.29	708.29
							8/24/10	14.28	708.30
							10/17/10	14.30	708.28
							1/15/11	13.35	709.23
							4/16/11	14.25	708.33
							4/23/11	14.28	708.30
							7/17/11	14.29	708.29
							10/15/11	14.28	708.30
							1/22/12	14.30	708.28
1/27/12	14.27	708.31							
4/20/12	14.28	708.30							
3/15/16	14.25	708.33							
6/11/20	NM	NM							
6/15/20	14.21	708.37							
Average								14.23	708.35

**Table 2. Summary of Depth to Groundwater and Groundwater Elevation
 PSK Investments, LLC (Former KJG Investments Property) 9922 W Capitol Drive, Milwaukee, WI / OM Job #2096
 SCS Project #25216050.01**

Well ID	Well Location	Well Depth (feet)	Screen Length (feet)	Internal Diameter (inch)	Surface Elevation (feet)	PVC Elevation (feet, MSL)	Date	Depth to Water (feet)	Groundwater Elevation (feet, MSL)
MW-7	Off-site	21.00	15.00	2.00	722.29	721.47	4/8/10	10.30	711.17
							4/10/10	10.45	711.02
							7/19/10	10.06	711.41
							8/23/10	10.45	711.02
							8/24/10	10.49	710.98
							10/16/10	11.94	709.53
							1/14/11	10.40	711.07
							4/14/11	9.94	711.53
							4/23/11	9.46	712.01
							7/15/11	10.29	711.18
							10/14/11	10.91	710.56
							1/21/12	10.40	711.07
							1/27/12	10.55	710.92
							4/20/12	10.73	710.74
							3/15/16	10.16	711.31
6/11/20	10.27	711.20							
							Average	10.43	711.05
MW-8	Off-site	21.00	15.00	2.00	721.98	721.38	4/8/10	15.34	706.04
							4/10/10	15.45	705.93
							7/19/10	13.20	708.18
							8/23/10	12.20	709.18
							8/24/10	12.28	709.10
							10/16/10	14.26	707.12
							1/14/11	14.45	706.93
							4/14/11	11.40	709.98
							4/23/11	8.71	712.67
							7/15/11	12.53	708.85
							10/14/11	13.25	708.13
							1/21/12	13.51	707.87
							1/27/12	13.30	708.08
							4/20/12	13.05	708.33
							3/15/16	12.65	708.73
6/11/20	11.22	710.16							
							Average	12.93	708.46

**Table 2. Summary of Depth to Groundwater and Groundwater Elevation
 PSK Investments, LLC (Former KJG Investments Property) 9922 W Capitol Drive, Milwaukee, WI / OM Job #2096
 SCS Project #25216050.01**

Well ID	Well Location	Well Depth (feet)	Screen Length (feet)	Internal Diameter (inch)	Surface Elevation (feet)	PVC Elevation (feet, MSL)	Date	Depth to Water (feet)	Groundwater Elevation (feet, MSL)
MW-9	Off-site	21.00	15.00	2.00	722.55	721.50	4/8/10	13.43	708.07
							4/10/10	13.50	708.00
							7/19/10	12.48	709.02
							8/23/10	14.00	707.50
							8/24/2010	14.04	707.46
							10/16/10	14.89	706.61
							1/14/11	14.90	706.60
							4/14/11	13.25	708.25
							4/23/11	11.55	709.95
							7/15/11	14.33	707.17
							10/14/11	14.56	706.94
							1/21/12	14.40	707.10
							1/27/12	14.57	706.93
							4/20/12	13.84	707.66
							3/15/16	13.70	707.80
6/11/20	13.41	708.09							
							Average	13.80	707.70
MW-10	Off-site	21.00	15.00	2.00	719.16	718.92	4/8/10	15.85	703.07
							4/10/10	15.75	703.17
							7/19/10	14.88	704.04
							8/23/10	15.64	703.28
							8/24/10	15.60	703.32
							10/16/10	16.57	702.35
							1/14/11	17.10	701.82
							4/14/11	16.20	702.72
							4/23/11	13.90	705.02
							7/15/11	16.25	702.67
							10/14/11	16.09	702.83
							1/21/12	Under Ice	
							1/27/12	16.05	702.87
							4/20/12	15.14	703.78
							3/15/16	13.77	705.15
6/11/20	14.05	704.87							
							Average	15.52	703.40

**Table 2. Summary of Depth to Groundwater and Groundwater Elevation
 PSK Investments, LLC (Former KJG Investments Property) 9922 W Capitol Drive, Milwaukee, WI / OM Job #2096
 SCS Project #25216050.01**

Well ID	Well Location	Well Depth (feet)	Screen Length (feet)	Internal Diameter (inch)	Surface Elevation (feet)	PVC Elevation (feet, MSL)	Date	Depth to Water (feet)	Groundwater Elevation (feet, MSL)
MW-11	Off-site	15.00	10.00	2.00			1/19/12	10.50	
							1/21/12	11.15	
							1/27/12	11.10	
							4/20/12	8.83	
							3/15/16	8.22	
							6/10/20	NM	
							6/15/20	4.92	
							Average	9.12	
MW-20	Off-site	20.00	15.00	2.00	722.09	721.54	8/12/10	5.05	716.49
							8/24/10	5.38	716.16
							10/16/10	6.69	714.85
							1/14/11	7.74	713.80
							4/14/11	7.90	713.64
							4/23/11	5.36	716.18
							7/15/11	6.05	715.49
							10/14/11	6.15	715.39
							1/21/12	6.55	714.99
							1/27/12	6.57	714.97
							4/20/12	6.13	715.41
							3/15/16	6.16	715.38
							6/11/20	5.36	716.18
Average	6.24	715.30							

**Table 2. Summary of Depth to Groundwater and Groundwater Elevation
 PSK Investments, LLC (Former KJG Investments Property) 9922 W Capitol Drive, Milwaukee, WI / OM Job #2096
 SCS Project #25216050.01**

Well ID	Well Location	Well Depth (feet)	Screen Length (feet)	Internal Diameter (inch)	Surface Elevation (feet)	PVC Elevation (feet, MSL)	Date	Depth to Water (feet)	Groundwater Elevation (feet, MSL)
MW-21	Off-site	15.00	10.00	2.00	722.19	721.92	8/12/10	7.05	714.87
							8/24/10	7.44	714.48
							10/16/10	8.38	713.54
							1/14/11	9.13	712.79
							4/14/11	6.00	715.92
							4/23/11	7.18	714.74
							7/15/11	7.52	714.40
							10/14/11	7.83	714.09
							1/21/12	8.23	713.69
							1/27/12	8.18	713.74
							4/20/12	7.75	714.17
							3/15/16	7.72	714.20
							6/11/20	4.91	717.01
Average							7.49	714.43	

Note: This table is adapted from previous reports by OM Enterprises.

Abbreviation:

NM = Not Measured

Note:

A 6/11/20 water level could not be measured at MW-6 because access to the well was denied by Grace Christian Fellowship.

Created by:	<u>OM Enterprises</u>	Date:	<u>2010</u>
Last revision by:	<u>LMH</u>	Date:	<u>6/17/2020</u>
Checked by:	<u>AJR</u>	Date:	<u>6/17/2020</u>
Proj Mgr QA/QC:	<u>RT</u>	Date:	<u>6/23/2020</u>

I:\25216050.01\Deliverables\June 2020 GW Monitoring Report\[Table 2_GW Elevation_PSK Investments.xlsx]GW Elevation

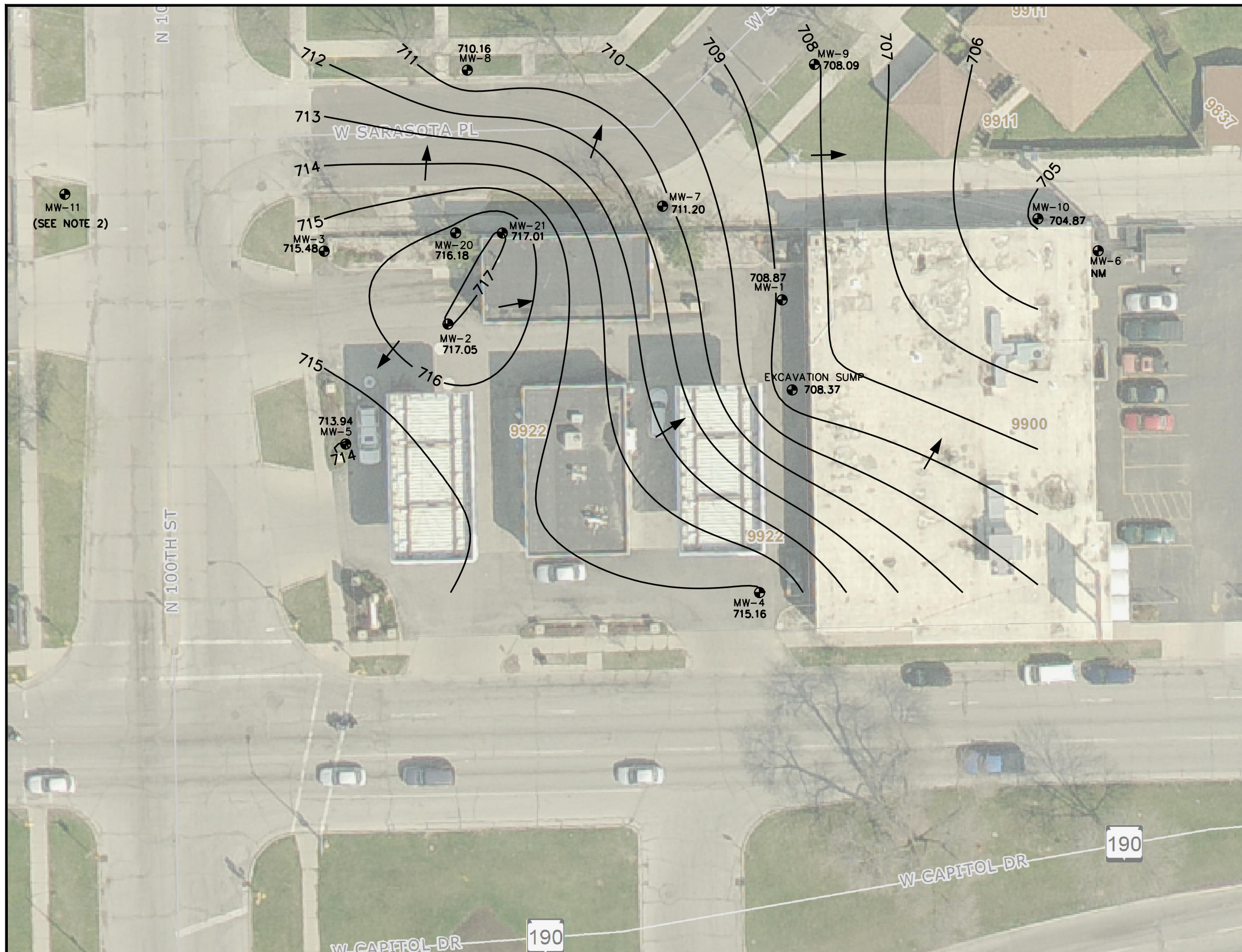

LEGEND

	MONITORING WELL LOCATION
704.87	WATER TABLE ELEVATION MEASURED JUNE 11-15, 2020
	WATER TABLE CONTOUR
	APPROXIMATE GROUNDWATER FLOW DIRECTION

- NOTES:
1. MONITORING WELL LOCATIONS ARE APPROXIMATE.
 2. A WATER TABLE ELEVATION WAS NOT CALCULATED FOR WELL MW-11 BECAUSE THE TOP OF CASING HAS NOT BEEN SURVEYED.
 3. MW-6 WAS NOT MEASURED DURING THE JUNE 2020 MONITORING EVENT.
 4. AERIAL IMAGE AND BASE MAP DOWNLOADED FROM THE MILWAUKEE COUNTY LAND INFORMATION OFFICE'S INTERACTIVE MAPPING SERVICE PUBLIC VIEWER.

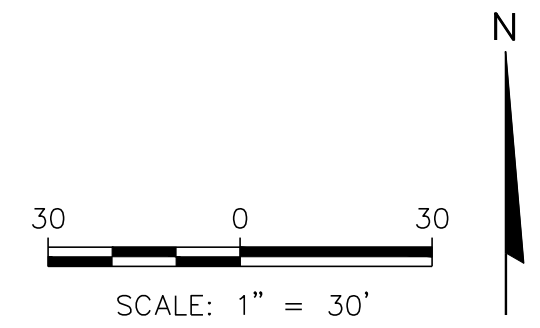

PROJECT NO. 25216050.01	DRAWN BY: BSS	 2830 DAIRY DRIVE MADISON, WI 53718-6751 PHONE: (608) 224-2830	CLIENT PSK INVESTMENTS, LLC	SITE PSK INVESTMENTS & GRACE CHRISTIAN FELLOWSHIP 9922 & 9900 WEST CAPITOL DRIVE MILWAUKEE, WISCONSIN	WATER TABLE MAP JUNE 2020	FIGURE
DRAWN: 06/29/2020	CHECKED BY: RL					1
REVISED: 06/29/2020	APPROVED BY: RL 06/29/2020					



Appendix A
Groundwater Laboratory Reports

ANALYTICAL REPORT

Eurofins TestAmerica, Chicago
2417 Bond Street
University Park, IL 60484
Tel: (708)534-5200

Laboratory Job ID: 500-183436-1

Client Project/Site: PSK Investments - 25216050.01

For:

SCS Engineers
2830 Dairy Dr
Madison, Wisconsin 53718

Attn: Mr. Robert Langdon



*Authorized for release by:
6/19/2020 3:02:15 PM*

Sandie Fredrick, Project Manager II
(920)261-1660
sandie.fredrick@testamericainc.com

LINKS

Review your project
results through
TotalAccess

Have a Question?



Visit us at:

www.eurofinsus.com/Env

The test results in this report meet all 2003 NELAC, 2009 TNI, and 2016 TNI requirements for accredited parameters, exceptions are noted in this report. This report may not be reproduced except in full, and with written approval from the laboratory. For questions please contact the Project Manager at the e-mail address or telephone number listed on this page.

This report has been electronically signed and authorized by the signatory. Electronic signature is intended to be the legally binding equivalent of a traditionally handwritten signature.

Results relate only to the items tested and the sample(s) as received by the laboratory.



Table of Contents

Cover Page	1
Table of Contents	2
Case Narrative	3
Detection Summary	4
Method Summary	6
Sample Summary	7
Client Sample Results	8
Definitions	17
QC Association	18
Surrogate Summary	19
QC Sample Results	20
Chronicle	23
Certification Summary	25
Chain of Custody	26
Receipt Checklists	28

Case Narrative

Client: SCS Engineers
Project/Site: PSK Investments - 25216050.01

Job ID: 500-183436-1

Job ID: 500-183436-1

Laboratory: Eurofins TestAmerica, Chicago

Narrative

Job Narrative
500-183436-1

Comments

No additional comments.

Receipt

The samples were received on 6/12/2020 10:15 AM; the samples arrived in good condition, and where required, properly preserved and on ice. The temperature of the cooler at receipt was 3.1° C.

Receipt Exceptions

Received 2 VOA vials broken for sample 3.

GC/MS VOA

Method 8260B: The following sample was diluted to bring the concentration of target analytes within the calibration range: MW20 (500-183436-6). Elevated reporting limits (RLs) are provided.

No additional analytical or quality issues were noted, other than those described above or in the Definitions/Glossary page.

1

2

3

4

5

6

7

8

9

10

11

12

13

14

15

Detection Summary

Client: SCS Engineers
Project/Site: PSK Investments - 25216050.01

Job ID: 500-183436-1

Client Sample ID: MW1

Lab Sample ID: 500-183436-1

No Detections.

Client Sample ID: MW2

Lab Sample ID: 500-183436-2

No Detections.

Client Sample ID: MW3

Lab Sample ID: 500-183436-3

Analyte	Result	Qualifier	RL	MDL	Unit	Dil Fac	D	Method	Prep Type
Naphthalene	100	B	1.0	0.34	ug/L	1		8260B	Total/NA
Toluene	9.4		0.50	0.15	ug/L	1		8260B	Total/NA
1,2,4-Trimethylbenzene	3.4		1.0	0.36	ug/L	1		8260B	Total/NA
1,3,5-Trimethylbenzene	8.3		1.0	0.25	ug/L	1		8260B	Total/NA
Xylenes, Total	80		1.0	0.22	ug/L	1		8260B	Total/NA
Benzene - DL	300		5.0	1.5	ug/L	10		8260B	Total/NA
Ethylbenzene - DL	990		5.0	1.8	ug/L	10		8260B	Total/NA

Client Sample ID: MW5

Lab Sample ID: 500-183436-4

No Detections.

Client Sample ID: MW7

Lab Sample ID: 500-183436-5

Analyte	Result	Qualifier	RL	MDL	Unit	Dil Fac	D	Method	Prep Type
Ethylbenzene	0.23	J	0.50	0.18	ug/L	1		8260B	Total/NA
Naphthalene	0.48	J B	1.0	0.34	ug/L	1		8260B	Total/NA

Client Sample ID: MW20

Lab Sample ID: 500-183436-6

Analyte	Result	Qualifier	RL	MDL	Unit	Dil Fac	D	Method	Prep Type
Benzene	78		2.5	0.73	ug/L	5		8260B	Total/NA
Naphthalene	320	B	5.0	1.7	ug/L	5		8260B	Total/NA
Toluene	6.6		2.5	0.76	ug/L	5		8260B	Total/NA
1,2,4-Trimethylbenzene	2.3	J	5.0	1.8	ug/L	5		8260B	Total/NA
1,3,5-Trimethylbenzene	5.7		5.0	1.3	ug/L	5		8260B	Total/NA
Xylenes, Total	100		5.0	1.1	ug/L	5		8260B	Total/NA
Ethylbenzene - DL	1300		25	9.2	ug/L	50		8260B	Total/NA

Client Sample ID: MW21

Lab Sample ID: 500-183436-7

Analyte	Result	Qualifier	RL	MDL	Unit	Dil Fac	D	Method	Prep Type
Ethylbenzene	44		0.50	0.18	ug/L	1		8260B	Total/NA
Naphthalene	150	B	1.0	0.34	ug/L	1		8260B	Total/NA
Toluene	3.1		0.50	0.15	ug/L	1		8260B	Total/NA
1,2,4-Trimethylbenzene	3.3		1.0	0.36	ug/L	1		8260B	Total/NA
1,3,5-Trimethylbenzene	1.1		1.0	0.25	ug/L	1		8260B	Total/NA
Xylenes, Total	15		1.0	0.22	ug/L	1		8260B	Total/NA
Benzene - DL	230		5.0	1.5	ug/L	10		8260B	Total/NA

Client Sample ID: MW3 DUP

Lab Sample ID: 500-183436-8

Analyte	Result	Qualifier	RL	MDL	Unit	Dil Fac	D	Method	Prep Type
Naphthalene	98		1.0	0.34	ug/L	1		8260B	Total/NA
Toluene	11		0.50	0.15	ug/L	1		8260B	Total/NA
1,2,4-Trimethylbenzene	3.7		1.0	0.36	ug/L	1		8260B	Total/NA
1,3,5-Trimethylbenzene	8.4		1.0	0.25	ug/L	1		8260B	Total/NA

This Detection Summary does not include radiochemical test results.

Eurofins TestAmerica, Chicago

Detection Summary

Client: SCS Engineers
Project/Site: PSK Investments - 25216050.01

Job ID: 500-183436-1

Client Sample ID: MW3 DUP (Continued)

Lab Sample ID: 500-183436-8

Analyte	Result	Qualifier	RL	MDL	Unit	Dil Fac	D	Method	Prep Type
Xylenes, Total	92		1.0	0.22	ug/L	1		8260B	Total/NA
Benzene - DL	300		2.5	0.73	ug/L	5		8260B	Total/NA
Ethylbenzene - DL	950		2.5	0.92	ug/L	5		8260B	Total/NA

Client Sample ID: TB

Lab Sample ID: 500-183436-9

Analyte	Result	Qualifier	RL	MDL	Unit	Dil Fac	D	Method	Prep Type
Naphthalene	0.57	J B	1.0	0.34	ug/L	1		8260B	Total/NA

This Detection Summary does not include radiochemical test results.

Eurofins TestAmerica, Chicago

Method Summary

Client: SCS Engineers
Project/Site: PSK Investments - 25216050.01

Job ID: 500-183436-1

Method	Method Description	Protocol	Laboratory
8260B	Volatile Organic Compounds (GC/MS)	SW846	TAL CHI
5030B	Purge and Trap	SW846	TAL CHI

Protocol References:

SW846 = "Test Methods For Evaluating Solid Waste, Physical/Chemical Methods", Third Edition, November 1986 And Its Updates.

Laboratory References:

TAL CHI = Eurofins TestAmerica, Chicago, 2417 Bond Street, University Park, IL 60484, TEL (708)534-5200

- 1
- 2
- 3
- 4
- 5
- 6
- 7
- 8
- 9
- 10
- 11
- 12
- 13
- 14
- 15

Sample Summary

Client: SCS Engineers
Project/Site: PSK Investments - 25216050.01

Job ID: 500-183436-1

Lab Sample ID	Client Sample ID	Matrix	Collected	Received	Asset ID
500-183436-1	MW1	Water	06/11/20 14:00	06/12/20 10:15	
500-183436-2	MW2	Water	06/11/20 14:30	06/12/20 10:15	
500-183436-3	MW3	Water	06/11/20 12:50	06/12/20 10:15	
500-183436-4	MW5	Water	06/11/20 13:10	06/12/20 10:15	
500-183436-5	MW7	Water	06/11/20 13:00	06/12/20 10:15	
500-183436-6	MW20	Water	06/11/20 12:40	06/12/20 10:15	
500-183436-7	MW21	Water	06/11/20 12:30	06/12/20 10:15	
500-183436-8	MW3 DUP	Water	06/11/20 12:55	06/12/20 10:15	
500-183436-9	TB	Water	06/11/20 00:00	06/12/20 10:15	

Client Sample Results

Client: SCS Engineers
 Project/Site: PSK Investments - 25216050.01

Job ID: 500-183436-1

Client Sample ID: MW1

Lab Sample ID: 500-183436-1

Date Collected: 06/11/20 14:00

Matrix: Water

Date Received: 06/12/20 10:15

Method: 8260B - Volatile Organic Compounds (GC/MS)

Analyte	Result	Qualifier	RL	MDL	Unit	D	Prepared	Analyzed	Dil Fac
Benzene	<0.15		0.50	0.15	ug/L			06/16/20 13:36	1
Ethylbenzene	<0.18		0.50	0.18	ug/L			06/16/20 13:36	1
Methyl tert-butyl ether	<0.39		1.0	0.39	ug/L			06/16/20 13:36	1
Naphthalene	<0.34		1.0	0.34	ug/L			06/16/20 13:36	1
Toluene	<0.15		0.50	0.15	ug/L			06/16/20 13:36	1
1,2,4-Trimethylbenzene	<0.36		1.0	0.36	ug/L			06/16/20 13:36	1
1,3,5-Trimethylbenzene	<0.25		1.0	0.25	ug/L			06/16/20 13:36	1
Xylenes, Total	<0.22		1.0	0.22	ug/L			06/16/20 13:36	1
Surrogate	%Recovery	Qualifier	Limits				Prepared	Analyzed	Dil Fac
4-Bromofluorobenzene (Surr)	109		72 - 124					06/16/20 13:36	1
Dibromofluoromethane	108		75 - 120					06/16/20 13:36	1
1,2-Dichloroethane-d4 (Surr)	97		75 - 126					06/16/20 13:36	1
Toluene-d8 (Surr)	86		75 - 120					06/16/20 13:36	1

Client Sample Results

Client: SCS Engineers
 Project/Site: PSK Investments - 25216050.01

Job ID: 500-183436-1

Client Sample ID: MW2

Lab Sample ID: 500-183436-2

Date Collected: 06/11/20 14:30

Matrix: Water

Date Received: 06/12/20 10:15

Method: 8260B - Volatile Organic Compounds (GC/MS)

Analyte	Result	Qualifier	RL	MDL	Unit	D	Prepared	Analyzed	Dil Fac
Benzene	<0.15		0.50	0.15	ug/L			06/16/20 14:04	1
Ethylbenzene	<0.18		0.50	0.18	ug/L			06/16/20 14:04	1
Methyl tert-butyl ether	<0.39		1.0	0.39	ug/L			06/16/20 14:04	1
Naphthalene	<0.34		1.0	0.34	ug/L			06/16/20 14:04	1
Toluene	<0.15		0.50	0.15	ug/L			06/16/20 14:04	1
1,2,4-Trimethylbenzene	<0.36		1.0	0.36	ug/L			06/16/20 14:04	1
1,3,5-Trimethylbenzene	<0.25		1.0	0.25	ug/L			06/16/20 14:04	1
Xylenes, Total	<0.22		1.0	0.22	ug/L			06/16/20 14:04	1
Surrogate	%Recovery	Qualifier	Limits				Prepared	Analyzed	Dil Fac
4-Bromofluorobenzene (Surr)	107		72 - 124					06/16/20 14:04	1
Dibromofluoromethane	107		75 - 120					06/16/20 14:04	1
1,2-Dichloroethane-d4 (Surr)	98		75 - 126					06/16/20 14:04	1
Toluene-d8 (Surr)	85		75 - 120					06/16/20 14:04	1

Client Sample Results

Client: SCS Engineers
Project/Site: PSK Investments - 25216050.01

Job ID: 500-183436-1

Client Sample ID: MW3

Lab Sample ID: 500-183436-3

Date Collected: 06/11/20 12:50

Matrix: Water

Date Received: 06/12/20 10:15

Method: 8260B - Volatile Organic Compounds (GC/MS)

Analyte	Result	Qualifier	RL	MDL	Unit	D	Prepared	Analyzed	Dil Fac
Methyl tert-butyl ether	<0.39		1.0	0.39	ug/L			06/16/20 14:32	1
Naphthalene	100	B	1.0	0.34	ug/L			06/16/20 14:32	1
Toluene	9.4		0.50	0.15	ug/L			06/16/20 14:32	1
1,2,4-Trimethylbenzene	3.4		1.0	0.36	ug/L			06/16/20 14:32	1
1,3,5-Trimethylbenzene	8.3		1.0	0.25	ug/L			06/16/20 14:32	1
Xylenes, Total	80		1.0	0.22	ug/L			06/16/20 14:32	1

Surrogate	%Recovery	Qualifier	Limits	Prepared	Analyzed	Dil Fac
4-Bromofluorobenzene (Surr)	109		72 - 124		06/16/20 14:32	1
Dibromofluoromethane	101		75 - 120		06/16/20 14:32	1
1,2-Dichloroethane-d4 (Surr)	92		75 - 126		06/16/20 14:32	1
Toluene-d8 (Surr)	85		75 - 120		06/16/20 14:32	1

Method: 8260B - Volatile Organic Compounds (GC/MS) - DL

Analyte	Result	Qualifier	RL	MDL	Unit	D	Prepared	Analyzed	Dil Fac
Benzene	300		5.0	1.5	ug/L			06/17/20 14:01	10
Ethylbenzene	990		5.0	1.8	ug/L			06/17/20 14:01	10

Surrogate	%Recovery	Qualifier	Limits	Prepared	Analyzed	Dil Fac
4-Bromofluorobenzene (Surr)	94		72 - 124		06/17/20 14:01	10
Dibromofluoromethane	103		75 - 120		06/17/20 14:01	10
1,2-Dichloroethane-d4 (Surr)	100		75 - 126		06/17/20 14:01	10
Toluene-d8 (Surr)	101		75 - 120		06/17/20 14:01	10

Client Sample Results

Client: SCS Engineers
 Project/Site: PSK Investments - 25216050.01

Job ID: 500-183436-1

Client Sample ID: MW5
Date Collected: 06/11/20 13:10
Date Received: 06/12/20 10:15

Lab Sample ID: 500-183436-4
Matrix: Water

Method: 8260B - Volatile Organic Compounds (GC/MS)

Analyte	Result	Qualifier	RL	MDL	Unit	D	Prepared	Analyzed	Dil Fac
Benzene	<0.15		0.50	0.15	ug/L			06/17/20 14:25	1
Ethylbenzene	<0.18		0.50	0.18	ug/L			06/17/20 14:25	1
Methyl tert-butyl ether	<0.39		1.0	0.39	ug/L			06/17/20 14:25	1
Naphthalene	<0.34		1.0	0.34	ug/L			06/17/20 14:25	1
Toluene	<0.15		0.50	0.15	ug/L			06/17/20 14:25	1
1,2,4-Trimethylbenzene	<0.36		1.0	0.36	ug/L			06/17/20 14:25	1
1,3,5-Trimethylbenzene	<0.25		1.0	0.25	ug/L			06/17/20 14:25	1
Xylenes, Total	<0.22		1.0	0.22	ug/L			06/17/20 14:25	1
Surrogate	%Recovery	Qualifier	Limits				Prepared	Analyzed	Dil Fac
4-Bromofluorobenzene (Surr)	91		72 - 124					06/17/20 14:25	1
Dibromofluoromethane	98		75 - 120					06/17/20 14:25	1
1,2-Dichloroethane-d4 (Surr)	100		75 - 126					06/17/20 14:25	1
Toluene-d8 (Surr)	97		75 - 120					06/17/20 14:25	1

Client Sample Results

Client: SCS Engineers
 Project/Site: PSK Investments - 25216050.01

Job ID: 500-183436-1

Client Sample ID: MW7

Lab Sample ID: 500-183436-5

Date Collected: 06/11/20 13:00

Matrix: Water

Date Received: 06/12/20 10:15

Method: 8260B - Volatile Organic Compounds (GC/MS)

Analyte	Result	Qualifier	RL	MDL	Unit	D	Prepared	Analyzed	Dil Fac
Benzene	<0.15		0.50	0.15	ug/L			06/16/20 15:29	1
Ethylbenzene	0.23	J	0.50	0.18	ug/L			06/16/20 15:29	1
Methyl tert-butyl ether	<0.39		1.0	0.39	ug/L			06/16/20 15:29	1
Naphthalene	0.48	J B	1.0	0.34	ug/L			06/16/20 15:29	1
Toluene	<0.15		0.50	0.15	ug/L			06/16/20 15:29	1
1,2,4-Trimethylbenzene	<0.36		1.0	0.36	ug/L			06/16/20 15:29	1
1,3,5-Trimethylbenzene	<0.25		1.0	0.25	ug/L			06/16/20 15:29	1
Xylenes, Total	<0.22		1.0	0.22	ug/L			06/16/20 15:29	1

Surrogate	%Recovery	Qualifier	Limits	Prepared	Analyzed	Dil Fac
4-Bromofluorobenzene (Surr)	109		72 - 124		06/16/20 15:29	1
Dibromofluoromethane	105		75 - 120		06/16/20 15:29	1
1,2-Dichloroethane-d4 (Surr)	95		75 - 126		06/16/20 15:29	1
Toluene-d8 (Surr)	86		75 - 120		06/16/20 15:29	1

Client Sample Results

Client: SCS Engineers
Project/Site: PSK Investments - 25216050.01

Job ID: 500-183436-1

Client Sample ID: MW20

Lab Sample ID: 500-183436-6

Date Collected: 06/11/20 12:40

Matrix: Water

Date Received: 06/12/20 10:15

Method: 8260B - Volatile Organic Compounds (GC/MS)

Analyte	Result	Qualifier	RL	MDL	Unit	D	Prepared	Analyzed	Dil Fac
Benzene	78		2.5	0.73	ug/L			06/16/20 15:57	5
Methyl tert-butyl ether	<2.0		5.0	2.0	ug/L			06/16/20 15:57	5
Naphthalene	320	B	5.0	1.7	ug/L			06/16/20 15:57	5
Toluene	6.6		2.5	0.76	ug/L			06/16/20 15:57	5
1,2,4-Trimethylbenzene	2.3	J	5.0	1.8	ug/L			06/16/20 15:57	5
1,3,5-Trimethylbenzene	5.7		5.0	1.3	ug/L			06/16/20 15:57	5
Xylenes, Total	100		5.0	1.1	ug/L			06/16/20 15:57	5

Surrogate	%Recovery	Qualifier	Limits	Prepared	Analyzed	Dil Fac
4-Bromofluorobenzene (Surr)	108		72 - 124		06/16/20 15:57	5
Dibromofluoromethane	103		75 - 120		06/16/20 15:57	5
1,2-Dichloroethane-d4 (Surr)	93		75 - 126		06/16/20 15:57	5
Toluene-d8 (Surr)	85		75 - 120		06/16/20 15:57	5

Method: 8260B - Volatile Organic Compounds (GC/MS) - DL

Analyte	Result	Qualifier	RL	MDL	Unit	D	Prepared	Analyzed	Dil Fac
Ethylbenzene	1300		25	9.2	ug/L			06/16/20 16:26	50

Surrogate	%Recovery	Qualifier	Limits	Prepared	Analyzed	Dil Fac
4-Bromofluorobenzene (Surr)	110		72 - 124		06/16/20 16:26	50
Dibromofluoromethane	106		75 - 120		06/16/20 16:26	50
1,2-Dichloroethane-d4 (Surr)	97		75 - 126		06/16/20 16:26	50
Toluene-d8 (Surr)	85		75 - 120		06/16/20 16:26	50

Client Sample Results

Client: SCS Engineers
Project/Site: PSK Investments - 25216050.01

Job ID: 500-183436-1

Client Sample ID: MW21
Date Collected: 06/11/20 12:30
Date Received: 06/12/20 10:15

Lab Sample ID: 500-183436-7
Matrix: Water

Method: 8260B - Volatile Organic Compounds (GC/MS)

Analyte	Result	Qualifier	RL	MDL	Unit	D	Prepared	Analyzed	Dil Fac
Ethylbenzene	44		0.50	0.18	ug/L			06/16/20 16:54	1
Methyl tert-butyl ether	<0.39		1.0	0.39	ug/L			06/16/20 16:54	1
Naphthalene	150	B	1.0	0.34	ug/L			06/16/20 16:54	1
Toluene	3.1		0.50	0.15	ug/L			06/16/20 16:54	1
1,2,4-Trimethylbenzene	3.3		1.0	0.36	ug/L			06/16/20 16:54	1
1,3,5-Trimethylbenzene	1.1		1.0	0.25	ug/L			06/16/20 16:54	1
Xylenes, Total	15		1.0	0.22	ug/L			06/16/20 16:54	1

Surrogate	%Recovery	Qualifier	Limits	Prepared	Analyzed	Dil Fac
4-Bromofluorobenzene (Surr)	109		72 - 124		06/16/20 16:54	1
Dibromofluoromethane	104		75 - 120		06/16/20 16:54	1
1,2-Dichloroethane-d4 (Surr)	95		75 - 126		06/16/20 16:54	1
Toluene-d8 (Surr)	86		75 - 120		06/16/20 16:54	1

Method: 8260B - Volatile Organic Compounds (GC/MS) - DL

Analyte	Result	Qualifier	RL	MDL	Unit	D	Prepared	Analyzed	Dil Fac
Benzene	230		5.0	1.5	ug/L			06/18/20 15:26	10

Surrogate	%Recovery	Qualifier	Limits	Prepared	Analyzed	Dil Fac
4-Bromofluorobenzene (Surr)	85		72 - 124		06/18/20 15:26	10
Dibromofluoromethane	88		75 - 120		06/18/20 15:26	10
1,2-Dichloroethane-d4 (Surr)	114		75 - 126		06/18/20 15:26	10
Toluene-d8 (Surr)	102		75 - 120		06/18/20 15:26	10

Client Sample Results

Client: SCS Engineers
 Project/Site: PSK Investments - 25216050.01

Job ID: 500-183436-1

Client Sample ID: MW3 DUP

Lab Sample ID: 500-183436-8

Date Collected: 06/11/20 12:55

Matrix: Water

Date Received: 06/12/20 10:15

Method: 8260B - Volatile Organic Compounds (GC/MS)

Analyte	Result	Qualifier	RL	MDL	Unit	D	Prepared	Analyzed	Dil Fac
Methyl tert-butyl ether	<0.39		1.0	0.39	ug/L			06/17/20 14:49	1
Naphthalene	98		1.0	0.34	ug/L			06/17/20 14:49	1
Toluene	11		0.50	0.15	ug/L			06/17/20 14:49	1
1,2,4-Trimethylbenzene	3.7		1.0	0.36	ug/L			06/17/20 14:49	1
1,3,5-Trimethylbenzene	8.4		1.0	0.25	ug/L			06/17/20 14:49	1
Xylenes, Total	92		1.0	0.22	ug/L			06/17/20 14:49	1

Surrogate	%Recovery	Qualifier	Limits	Prepared	Analyzed	Dil Fac
4-Bromofluorobenzene (Surr)	91		72 - 124		06/17/20 14:49	1
Dibromofluoromethane	103		75 - 120		06/17/20 14:49	1
1,2-Dichloroethane-d4 (Surr)	99		75 - 126		06/17/20 14:49	1
Toluene-d8 (Surr)	110		75 - 120		06/17/20 14:49	1

Method: 8260B - Volatile Organic Compounds (GC/MS) - DL

Analyte	Result	Qualifier	RL	MDL	Unit	D	Prepared	Analyzed	Dil Fac
Benzene	300		2.5	0.73	ug/L			06/16/20 17:22	5
Ethylbenzene	950		2.5	0.92	ug/L			06/16/20 17:22	5

Surrogate	%Recovery	Qualifier	Limits	Prepared	Analyzed	Dil Fac
4-Bromofluorobenzene (Surr)	112		72 - 124		06/16/20 17:22	5
Dibromofluoromethane	103		75 - 120		06/16/20 17:22	5
1,2-Dichloroethane-d4 (Surr)	95		75 - 126		06/16/20 17:22	5
Toluene-d8 (Surr)	84		75 - 120		06/16/20 17:22	5

Client Sample Results

Client: SCS Engineers
Project/Site: PSK Investments - 25216050.01

Job ID: 500-183436-1

Client Sample ID: TB

Lab Sample ID: 500-183436-9

Date Collected: 06/11/20 00:00

Matrix: Water

Date Received: 06/12/20 10:15

Method: 8260B - Volatile Organic Compounds (GC/MS)

Analyte	Result	Qualifier	RL	MDL	Unit	D	Prepared	Analyzed	Dil Fac
Benzene	<0.15		0.50	0.15	ug/L			06/16/20 18:19	1
Ethylbenzene	<0.18		0.50	0.18	ug/L			06/16/20 18:19	1
Methyl tert-butyl ether	<0.39		1.0	0.39	ug/L			06/16/20 18:19	1
Naphthalene	0.57	J B	1.0	0.34	ug/L			06/16/20 18:19	1
Toluene	<0.15		0.50	0.15	ug/L			06/16/20 18:19	1
1,2,4-Trimethylbenzene	<0.36		1.0	0.36	ug/L			06/16/20 18:19	1
1,3,5-Trimethylbenzene	<0.25		1.0	0.25	ug/L			06/16/20 18:19	1
Xylenes, Total	<0.22		1.0	0.22	ug/L			06/16/20 18:19	1

Surrogate	%Recovery	Qualifier	Limits	Prepared	Analyzed	Dil Fac
4-Bromofluorobenzene (Surr)	108		72 - 124		06/16/20 18:19	1
Dibromofluoromethane	106		75 - 120		06/16/20 18:19	1
1,2-Dichloroethane-d4 (Surr)	97		75 - 126		06/16/20 18:19	1
Toluene-d8 (Surr)	85		75 - 120		06/16/20 18:19	1

Definitions/Glossary

Client: SCS Engineers
Project/Site: PSK Investments - 25216050.01

Job ID: 500-183436-1

Qualifiers

GC/MS VOA

Qualifier	Qualifier Description
B	Compound was found in the blank and sample.
J	Result is less than the RL but greater than or equal to the MDL and the concentration is an approximate value.

Glossary

Abbreviation	These commonly used abbreviations may or may not be present in this report.
α	Listed under the "D" column to designate that the result is reported on a dry weight basis
%R	Percent Recovery
CFL	Contains Free Liquid
CFU	Colony Forming Unit
CNF	Contains No Free Liquid
DER	Duplicate Error Ratio (normalized absolute difference)
Dil Fac	Dilution Factor
DL	Detection Limit (DoD/DOE)
DL, RA, RE, IN	Indicates a Dilution, Re-analysis, Re-extraction, or additional Initial metals/anion analysis of the sample
DLC	Decision Level Concentration (Radiochemistry)
EDL	Estimated Detection Limit (Dioxin)
LOD	Limit of Detection (DoD/DOE)
LOQ	Limit of Quantitation (DoD/DOE)
MCL	EPA recommended "Maximum Contaminant Level"
MDA	Minimum Detectable Activity (Radiochemistry)
MDC	Minimum Detectable Concentration (Radiochemistry)
MDL	Method Detection Limit
ML	Minimum Level (Dioxin)
MPN	Most Probable Number
MQL	Method Quantitation Limit
NC	Not Calculated
ND	Not Detected at the reporting limit (or MDL or EDL if shown)
NEG	Negative / Absent
POS	Positive / Present
PQL	Practical Quantitation Limit
PRES	Presumptive
QC	Quality Control
RER	Relative Error Ratio (Radiochemistry)
RL	Reporting Limit or Requested Limit (Radiochemistry)
RPD	Relative Percent Difference, a measure of the relative difference between two points
TEF	Toxicity Equivalent Factor (Dioxin)
TEQ	Toxicity Equivalent Quotient (Dioxin)
TNTC	Too Numerous To Count

QC Association Summary

Client: SCS Engineers
Project/Site: PSK Investments - 25216050.01

Job ID: 500-183436-1

GC/MS VOA

Analysis Batch: 547749

Lab Sample ID	Client Sample ID	Prep Type	Matrix	Method	Prep Batch
500-183436-1	MW1	Total/NA	Water	8260B	
500-183436-2	MW2	Total/NA	Water	8260B	
500-183436-3	MW3	Total/NA	Water	8260B	
500-183436-5	MW7	Total/NA	Water	8260B	
500-183436-6	MW20	Total/NA	Water	8260B	
500-183436-6 - DL	MW20	Total/NA	Water	8260B	
500-183436-7	MW21	Total/NA	Water	8260B	
500-183436-8 - DL	MW3 DUP	Total/NA	Water	8260B	
500-183436-9	TB	Total/NA	Water	8260B	
MB 500-547749/6	Method Blank	Total/NA	Water	8260B	
LCS 500-547749/4	Lab Control Sample	Total/NA	Water	8260B	

Analysis Batch: 547914

Lab Sample ID	Client Sample ID	Prep Type	Matrix	Method	Prep Batch
500-183436-3 - DL	MW3	Total/NA	Water	8260B	
500-183436-4	MW5	Total/NA	Water	8260B	
500-183436-8	MW3 DUP	Total/NA	Water	8260B	
MB 500-547914/6	Method Blank	Total/NA	Water	8260B	
LCS 500-547914/4	Lab Control Sample	Total/NA	Water	8260B	

Analysis Batch: 548128

Lab Sample ID	Client Sample ID	Prep Type	Matrix	Method	Prep Batch
500-183436-7 - DL	MW21	Total/NA	Water	8260B	
MB 500-548128/6	Method Blank	Total/NA	Water	8260B	
LCS 500-548128/4	Lab Control Sample	Total/NA	Water	8260B	

Surrogate Summary

Client: SCS Engineers
 Project/Site: PSK Investments - 25216050.01

Job ID: 500-183436-1

Method: 8260B - Volatile Organic Compounds (GC/MS)

Matrix: Water

Prep Type: Total/NA

Percent Surrogate Recovery (Acceptance Limits)

Lab Sample ID	Client Sample ID	BFB	DBFM	DCA	TOL
		(72-124)	(75-120)	(75-126)	(75-120)
500-183436-1	MW1	109	108	97	86
500-183436-2	MW2	107	107	98	85
500-183436-3	MW3	109	101	92	85
500-183436-3 - DL	MW3	94	103	100	101
500-183436-4	MW5	91	98	100	97
500-183436-5	MW7	109	105	95	86
500-183436-6	MW20	108	103	93	85
500-183436-6 - DL	MW20	110	106	97	85
500-183436-7	MW21	109	104	95	86
500-183436-7 - DL	MW21	85	88	114	102
500-183436-8 - DL	MW3 DUP	112	103	95	84
500-183436-8	MW3 DUP	91	103	99	110
500-183436-9	TB	108	106	97	85
LCS 500-547749/4	Lab Control Sample	108	102	93	87
LCS 500-547914/4	Lab Control Sample	95	109	96	109
LCS 500-548128/4	Lab Control Sample	96	90	97	94
MB 500-547749/6	Method Blank	112	107	98	87
MB 500-547914/6	Method Blank	87	107	109	99
MB 500-548128/6	Method Blank	91	98	100	84

Surrogate Legend

BFB = 4-Bromofluorobenzene (Surr)
 DBFM = Dibromofluoromethane
 DCA = 1,2-Dichloroethane-d4 (Surr)
 TOL = Toluene-d8 (Surr)

QC Sample Results

Client: SCS Engineers
Project/Site: PSK Investments - 25216050.01

Job ID: 500-183436-1

Method: 8260B - Volatile Organic Compounds (GC/MS)

Lab Sample ID: MB 500-547749/6
Matrix: Water
Analysis Batch: 547749

Client Sample ID: Method Blank
Prep Type: Total/NA

Analyte	MB	MB	RL	MDL	Unit	D	Prepared	Analyzed	Dil Fac
	Result	Qualifier							
Benzene	<0.15		0.50	0.15	ug/L			06/16/20 13:07	1
Ethylbenzene	<0.18		0.50	0.18	ug/L			06/16/20 13:07	1
Methyl tert-butyl ether	<0.39		1.0	0.39	ug/L			06/16/20 13:07	1
Naphthalene	0.513	J	1.0	0.34	ug/L			06/16/20 13:07	1
Toluene	<0.15		0.50	0.15	ug/L			06/16/20 13:07	1
1,2,4-Trimethylbenzene	<0.36		1.0	0.36	ug/L			06/16/20 13:07	1
1,3,5-Trimethylbenzene	<0.25		1.0	0.25	ug/L			06/16/20 13:07	1
Xylenes, Total	<0.22		1.0	0.22	ug/L			06/16/20 13:07	1

Surrogate	MB	MB	Limits	Prepared	Analyzed	Dil Fac
	%Recovery	Qualifier				
4-Bromofluorobenzene (Surr)	112		72 - 124		06/16/20 13:07	1
Dibromofluoromethane	107		75 - 120		06/16/20 13:07	1
1,2-Dichloroethane-d4 (Surr)	98		75 - 126		06/16/20 13:07	1
Toluene-d8 (Surr)	87		75 - 120		06/16/20 13:07	1

Lab Sample ID: LCS 500-547749/4
Matrix: Water
Analysis Batch: 547749

Client Sample ID: Lab Control Sample
Prep Type: Total/NA

Analyte	Spike Added	LCS	LCS	Unit	D	%Rec	%Rec. Limits
		Result	Qualifier				
Benzene	50.0	47.7		ug/L		95	70 - 120
Ethylbenzene	50.0	47.4		ug/L		95	70 - 123
Methyl tert-butyl ether	50.0	41.9		ug/L		84	55 - 123
Naphthalene	50.0	54.3		ug/L		109	53 - 144
Toluene	50.0	47.3		ug/L		95	70 - 125
1,2,4-Trimethylbenzene	50.0	51.6		ug/L		103	70 - 123
1,3,5-Trimethylbenzene	50.0	52.3		ug/L		105	70 - 123
Xylenes, Total	100	91.5		ug/L		92	70 - 125

Surrogate	LCS	LCS	Limits
	%Recovery	Qualifier	
4-Bromofluorobenzene (Surr)	108		72 - 124
Dibromofluoromethane	102		75 - 120
1,2-Dichloroethane-d4 (Surr)	93		75 - 126
Toluene-d8 (Surr)	87		75 - 120

Lab Sample ID: MB 500-547914/6
Matrix: Water
Analysis Batch: 547914

Client Sample ID: Method Blank
Prep Type: Total/NA

Analyte	MB	MB	RL	MDL	Unit	D	Prepared	Analyzed	Dil Fac
	Result	Qualifier							
Benzene	<0.15		0.50	0.15	ug/L			06/17/20 10:26	1
Ethylbenzene	<0.18		0.50	0.18	ug/L			06/17/20 10:26	1
Methyl tert-butyl ether	<0.39		1.0	0.39	ug/L			06/17/20 10:26	1
Naphthalene	<0.34		1.0	0.34	ug/L			06/17/20 10:26	1
Toluene	<0.15		0.50	0.15	ug/L			06/17/20 10:26	1
1,2,4-Trimethylbenzene	<0.36		1.0	0.36	ug/L			06/17/20 10:26	1
1,3,5-Trimethylbenzene	<0.25		1.0	0.25	ug/L			06/17/20 10:26	1
Xylenes, Total	<0.22		1.0	0.22	ug/L			06/17/20 10:26	1

Eurofins TestAmerica, Chicago

QC Sample Results

Client: SCS Engineers
Project/Site: PSK Investments - 25216050.01

Job ID: 500-183436-1

Method: 8260B - Volatile Organic Compounds (GC/MS) (Continued)

Surrogate	MB %Recovery	MB Qualifier	Limits	Prepared	Analyzed	Dil Fac
4-Bromofluorobenzene (Surr)	87		72 - 124		06/17/20 10:26	1
Dibromofluoromethane	107		75 - 120		06/17/20 10:26	1
1,2-Dichloroethane-d4 (Surr)	109		75 - 126		06/17/20 10:26	1
Toluene-d8 (Surr)	99		75 - 120		06/17/20 10:26	1

Lab Sample ID: LCS 500-547914/4
Matrix: Water
Analysis Batch: 547914

Client Sample ID: Lab Control Sample
Prep Type: Total/NA

Analyte	Spike Added	LCS Result	LCS Qualifier	Unit	D	%Rec	%Rec. Limits
Benzene	50.0	50.2		ug/L		100	70 - 120
Ethylbenzene	50.0	53.3		ug/L		107	70 - 123
Methyl tert-butyl ether	50.0	47.6		ug/L		95	55 - 123
Naphthalene	50.0	47.8		ug/L		96	53 - 144
Toluene	50.0	51.7		ug/L		103	70 - 125
1,2,4-Trimethylbenzene	50.0	48.0		ug/L		96	70 - 123
1,3,5-Trimethylbenzene	50.0	48.7		ug/L		97	70 - 123
Xylenes, Total	100	102		ug/L		102	70 - 125

Surrogate	LCS %Recovery	LCS Qualifier	Limits
4-Bromofluorobenzene (Surr)	95		72 - 124
Dibromofluoromethane	109		75 - 120
1,2-Dichloroethane-d4 (Surr)	96		75 - 126
Toluene-d8 (Surr)	109		75 - 120

Lab Sample ID: MB 500-548128/6
Matrix: Water
Analysis Batch: 548128

Client Sample ID: Method Blank
Prep Type: Total/NA

Analyte	MB Result	MB Qualifier	RL	MDL	Unit	D	Prepared	Analyzed	Dil Fac
Benzene	<0.15		0.50	0.15	ug/L			06/18/20 10:50	1
Ethylbenzene	<0.18		0.50	0.18	ug/L			06/18/20 10:50	1
Methyl tert-butyl ether	<0.39		1.0	0.39	ug/L			06/18/20 10:50	1
Naphthalene	<0.34		1.0	0.34	ug/L			06/18/20 10:50	1
Toluene	<0.15		0.50	0.15	ug/L			06/18/20 10:50	1
1,2,4-Trimethylbenzene	<0.36		1.0	0.36	ug/L			06/18/20 10:50	1
1,3,5-Trimethylbenzene	<0.25		1.0	0.25	ug/L			06/18/20 10:50	1
Xylenes, Total	<0.22		1.0	0.22	ug/L			06/18/20 10:50	1

Surrogate	MB %Recovery	MB Qualifier	Limits	Prepared	Analyzed	Dil Fac
4-Bromofluorobenzene (Surr)	91		72 - 124		06/18/20 10:50	1
Dibromofluoromethane	98		75 - 120		06/18/20 10:50	1
1,2-Dichloroethane-d4 (Surr)	100		75 - 126		06/18/20 10:50	1
Toluene-d8 (Surr)	84		75 - 120		06/18/20 10:50	1

Lab Sample ID: LCS 500-548128/4
Matrix: Water
Analysis Batch: 548128

Client Sample ID: Lab Control Sample
Prep Type: Total/NA

Analyte	Spike Added	LCS Result	LCS Qualifier	Unit	D	%Rec	%Rec. Limits
Benzene	50.0	49.5		ug/L		99	70 - 120

Eurofins TestAmerica, Chicago

QC Sample Results

Client: SCS Engineers
 Project/Site: PSK Investments - 25216050.01

Job ID: 500-183436-1

Method: 8260B - Volatile Organic Compounds (GC/MS) (Continued)

Lab Sample ID: LCS 500-548128/4

Matrix: Water

Analysis Batch: 548128

Client Sample ID: Lab Control Sample

Prep Type: Total/NA

Analyte	Spike Added	LCS Result	LCS Qualifier	Unit	D	%Rec	%Rec. Limits
Ethylbenzene	50.0	53.4		ug/L		107	70 - 123
Methyl tert-butyl ether	50.0	52.2		ug/L		104	55 - 123
Naphthalene	50.0	42.6		ug/L		85	53 - 144
Toluene	50.0	50.8		ug/L		102	70 - 125
1,2,4-Trimethylbenzene	50.0	46.7		ug/L		93	70 - 123
1,3,5-Trimethylbenzene	50.0	48.5		ug/L		97	70 - 123
Xylenes, Total	100	110		ug/L		110	70 - 125

Surrogate	LCS %Recovery	LCS Qualifier	Limits
4-Bromofluorobenzene (Surr)	96		72 - 124
Dibromofluoromethane	90		75 - 120
1,2-Dichloroethane-d4 (Surr)	97		75 - 126
Toluene-d8 (Surr)	94		75 - 120



Lab Chronicle

Client: SCS Engineers
Project/Site: PSK Investments - 25216050.01

Job ID: 500-183436-1

Client Sample ID: MW1

Date Collected: 06/11/20 14:00

Date Received: 06/12/20 10:15

Lab Sample ID: 500-183436-1

Matrix: Water

Prep Type	Batch Type	Batch Method	Run	Dilution Factor	Batch Number	Prepared or Analyzed	Analyst	Lab
Total/NA	Analysis	8260B		1	547749	06/16/20 13:36	JDD	TAL CHI

Client Sample ID: MW2

Date Collected: 06/11/20 14:30

Date Received: 06/12/20 10:15

Lab Sample ID: 500-183436-2

Matrix: Water

Prep Type	Batch Type	Batch Method	Run	Dilution Factor	Batch Number	Prepared or Analyzed	Analyst	Lab
Total/NA	Analysis	8260B		1	547749	06/16/20 14:04	JDD	TAL CHI

Client Sample ID: MW3

Date Collected: 06/11/20 12:50

Date Received: 06/12/20 10:15

Lab Sample ID: 500-183436-3

Matrix: Water

Prep Type	Batch Type	Batch Method	Run	Dilution Factor	Batch Number	Prepared or Analyzed	Analyst	Lab
Total/NA	Analysis	8260B	DL	10	547914	06/17/20 14:01	JDD	TAL CHI
Total/NA	Analysis	8260B		1	547749	06/16/20 14:32	JDD	TAL CHI

Client Sample ID: MW5

Date Collected: 06/11/20 13:10

Date Received: 06/12/20 10:15

Lab Sample ID: 500-183436-4

Matrix: Water

Prep Type	Batch Type	Batch Method	Run	Dilution Factor	Batch Number	Prepared or Analyzed	Analyst	Lab
Total/NA	Analysis	8260B		1	547914	06/17/20 14:25	JDD	TAL CHI

Client Sample ID: MW7

Date Collected: 06/11/20 13:00

Date Received: 06/12/20 10:15

Lab Sample ID: 500-183436-5

Matrix: Water

Prep Type	Batch Type	Batch Method	Run	Dilution Factor	Batch Number	Prepared or Analyzed	Analyst	Lab
Total/NA	Analysis	8260B		1	547749	06/16/20 15:29	JDD	TAL CHI

Client Sample ID: MW20

Date Collected: 06/11/20 12:40

Date Received: 06/12/20 10:15

Lab Sample ID: 500-183436-6

Matrix: Water

Prep Type	Batch Type	Batch Method	Run	Dilution Factor	Batch Number	Prepared or Analyzed	Analyst	Lab
Total/NA	Analysis	8260B		5	547749	06/16/20 15:57	JDD	TAL CHI
Total/NA	Analysis	8260B	DL	50	547749	06/16/20 16:26	JDD	TAL CHI

Client Sample ID: MW21

Date Collected: 06/11/20 12:30

Date Received: 06/12/20 10:15

Lab Sample ID: 500-183436-7

Matrix: Water

Prep Type	Batch Type	Batch Method	Run	Dilution Factor	Batch Number	Prepared or Analyzed	Analyst	Lab
Total/NA	Analysis	8260B	DL	10	548128	06/18/20 15:26	JDD	TAL CHI
Total/NA	Analysis	8260B		1	547749	06/16/20 16:54	JDD	TAL CHI

Eurofins TestAmerica, Chicago

Lab Chronicle

Client: SCS Engineers
Project/Site: PSK Investments - 25216050.01

Job ID: 500-183436-1

Client Sample ID: MW3 DUP

Date Collected: 06/11/20 12:55

Date Received: 06/12/20 10:15

Lab Sample ID: 500-183436-8

Matrix: Water

Prep Type	Batch Type	Batch Method	Run	Dilution Factor	Batch Number	Prepared or Analyzed	Analyst	Lab
Total/NA	Analysis	8260B		1	547914	06/17/20 14:49	JDD	TAL CHI
Total/NA	Analysis	8260B	DL	5	547749	06/16/20 17:22	JDD	TAL CHI

Client Sample ID: TB

Date Collected: 06/11/20 00:00

Date Received: 06/12/20 10:15

Lab Sample ID: 500-183436-9

Matrix: Water

Prep Type	Batch Type	Batch Method	Run	Dilution Factor	Batch Number	Prepared or Analyzed	Analyst	Lab
Total/NA	Analysis	8260B		1	547749	06/16/20 18:19	JDD	TAL CHI

Laboratory References:

TAL CHI = Eurofins TestAmerica, Chicago, 2417 Bond Street, University Park, IL 60484, TEL (708)534-5200

Accreditation/Certification Summary

Client: SCS Engineers
Project/Site: PSK Investments - 25216050.01

Job ID: 500-183436-1

Laboratory: Eurofins TestAmerica, Chicago

The accreditations/certifications listed below are applicable to this report.

Authority	Program	Identification Number	Expiration Date
Wisconsin	State	999580010	08-31-20

- 1
- 2
- 3
- 4
- 5
- 6
- 7
- 8
- 9
- 10
- 11
- 12
- 13
- 14
- 15

Eurofins TestAmerica, Chicago

2417 Bond Street
 University Park, IL 60484
 Phone: 708-534-5200 Fax: 708-534-5211

Chain of Custody Record

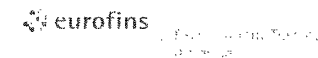

Client Information			Sampler		Lab PM, Fredrick, Sandie		Carrier Tracking Notes		CCC No 500-82378-37640.1		
Client Contact Mr. Robert Langdon			Phone		E-Mail: sandie.fredrick@testamericainc.com				Page: Page 1 of 2		
Company SCS Engineers			Analysis Requested								
Address 2830 Dairy Dr			Due Date Requested:						Job # 500-183436		
City Madison			TAT Requested (days): 5 day turn around!						Preservation Codes:		
State, Zip WI 53718			PO # 25216050.01						A - HCL M - Hexane B - NaOH N - None C - Zn Acetate O - AsNaO2 D - Nitric Acid P - Na2O4S E - NaHSO4 Q - Na2SO3 F - MeOH R - Na2S2O3 G - Amchlor S - H2SO4 H - Ascorbic Acid T - TSP Dodecahydrate I - Ice U - Acetone J - DI Water V - MCAA K - EDTA W - pH 4-C L - EDA Z - other (specify)		
Phone: 500-183436 COC			W/O #						Other:		
Email: rlangdon@scsengineers.com			Project # 50006561								
Project Name: PSK Investments 25216050.01			SSGW#								
Site											
Sample Identification		Sample Date	Sample Time	Sample Type (C=comp, G=grab)	Matrix (W=water, S=solid, O=waste/soil, BT=Tissue, A=Air)	Field Filtered Sample (Yes or No)	Perform Analysis (Yes or No)	8260B - PIOC-NAP	Total Number of Containers	Special Instructions/Note:	
MW1		6-11-20	1400	G	Water	X	X	A		5 day turn around	
MW2			1430		Water						
MW3			1250		Water						
MW5			1310		Water						
MW7			1300		Water						
MW20			1240		Water						
MW21			1230		Water						
MW3 DUP			1255		Water						
TB					Water						
					Water						
					Water						
					Water						
Possible Hazard Identification					Sample Disposal (A fee may be assessed if samples are retained longer than 1 month)						
<input type="checkbox"/> Non-Hazard <input type="checkbox"/> Flammable <input type="checkbox"/> Skin Irritant <input type="checkbox"/> Poison B <input type="checkbox"/> Unknown <input type="checkbox"/> Radiological					<input type="checkbox"/> Return To Client <input type="checkbox"/> Disposal By Lab <input type="checkbox"/> Archive For _____ Months						
Deliverable Requested: I, II, III, IV, Other (specify)					Special Instructions/QC Requirements:						
Empty Kit Relinquished by:			Date:	Time:	Method of Shipment:						
Relinquished by: <i>Zach Watson</i>		Date/Time: 6-11-20 1500	Company: SCS	Received by: <i>[Signature]</i>		Date/Time: 6-16-20 1500	Company: TA				
Relinquished by: <i>[Signature]</i>		Date/Time: 6-11-20 1700	Company: TA	Received by: <i>[Signature]</i>		Date/Time: 6/2/20 10/5	Company: TA-CH				
Relinquished by:		Date/Time:	Company:	Received by:		Date/Time:	Company:				
Custody Seals Intact: <input type="checkbox"/> Yes <input type="checkbox"/> No		Custody Seal No.:		Cooler Temperature(s) °C and Other Remarks:		3.1					

1
2
3
4
5
6
7
8
9

1
2
3
4
5
6
7
8
9
10
11
12
13
14
15

ORIGIN ID:RRLA (262) 202-5955
SHIPPING
TESTAMERICA
4125 N 124TH ST
BROOKFIELD, WI 53005
UNITED STATES US

SHIP DATE: 11JUN20
ACTWGT: 32.65 LB
CAD: 525155/CAFE3211

BILL RECIPIENT

TO **SAMPLE RECEIPT**
TESTAMERICA LABS
2417 BOND STREET



UNIVERSITY PARK IL 60484

500-183436 Waybill

(708) 634-8200

REF:

DEPT:

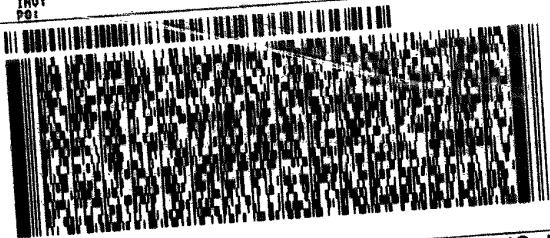

FedEx
Express



J181118060710

FRI - 12 JUN 10:30A
PRIORITY OVERNIGHT

2 of 2
MPS# 7125 4942 7358
0263
Metr# 7125 4942 7347

0201

79 JOTA

60484
IL-US ORD



28qt.

- 1
- 2
- 3
- 4
- 5
- 6
- 7
- 8
- 9
- 10
- 11
- 12
- 13
- 14
- 15

Login Sample Receipt Checklist

Client: SCS Engineers

Job Number: 500-183436-1

Login Number: 183436

List Source: Eurofins TestAmerica, Chicago

List Number: 1

Creator: Scott, Sherri L

Question	Answer	Comment
Radioactivity wasn't checked or is \leq background as measured by a survey meter.	True	
The cooler's custody seal, if present, is intact.	True	
Sample custody seals, if present, are intact.	True	
The cooler or samples do not appear to have been compromised or tampered with.	True	
Samples were received on ice.	True	
Cooler Temperature is acceptable.	True	
Cooler Temperature is recorded.	True	
COC is present.	True	
COC is filled out in ink and legible.	True	
COC is filled out with all pertinent information.	True	
Is the Field Sampler's name present on COC?	True	
There are no discrepancies between the containers received and the COC.	True	
Samples are received within Holding Time (excluding tests with immediate HTs)	True	
Sample containers have legible labels.	True	
Containers are not broken or leaking.	False	
Sample collection date/times are provided.	True	
Appropriate sample containers are used.	True	
Sample bottles are completely filled.	True	
Sample Preservation Verified.	True	
There is sufficient vol. for all requested analyses, incl. any requested MS/MSDs	True	
Containers requiring zero headspace have no headspace or bubble is <math><6\text{mm}</math> (1/4").	True	
Multiphasic samples are not present.	True	
Samples do not require splitting or compositing.	True	
Residual Chlorine Checked.	N/A	



ANALYTICAL REPORT

Eurofins TestAmerica, Chicago
2417 Bond Street
University Park, IL 60484
Tel: (708)534-5200

Laboratory Job ID: 500-183570-1

Client Project/Site: PSK Investments - 25216050.01

For:

SCS Engineers
2830 Dairy Dr
Madison, Wisconsin 53718

Attn: Mr. Robert Langdon



*Authorized for release by:
6/22/2020 2:44:31 PM*

Sandie Fredrick, Project Manager II
(920)261-1660
sandie.fredrick@testamericainc.com

LINKS

Review your project
results through
TotalAccess

Have a Question?



Visit us at:

www.eurofinsus.com/Env

The test results in this report meet all 2003 NELAC, 2009 TNI, and 2016 TNI requirements for accredited parameters, exceptions are noted in this report. This report may not be reproduced except in full, and with written approval from the laboratory. For questions please contact the Project Manager at the e-mail address or telephone number listed on this page.

This report has been electronically signed and authorized by the signatory. Electronic signature is intended to be the legally binding equivalent of a traditionally handwritten signature.

Results relate only to the items tested and the sample(s) as received by the laboratory.



Table of Contents

Cover Page	1
Table of Contents	2
Case Narrative	3
Detection Summary	4
Method Summary	5
Sample Summary	6
Client Sample Results	7
Definitions	9
QC Association	10
Surrogate Summary	11
QC Sample Results	12
Chronicle	13
Certification Summary	14
Chain of Custody	15
Receipt Checklists	17

Case Narrative

Client: SCS Engineers
Project/Site: PSK Investments - 25216050.01

Job ID: 500-183570-1

Job ID: 500-183570-1

Laboratory: Eurofins TestAmerica, Chicago

Narrative

Job Narrative 500-183570-1

Comments

No additional comments.

Receipt

The samples were received on 6/16/2020 10:00 AM; the samples arrived in good condition, and where required, properly preserved and on ice. The temperature of the cooler at receipt was 1.8° C.

GC/MS VOA

No analytical or quality issues were noted, other than those described in the Definitions/Glossary page.

- 1
- 2
- 3
- 4
- 5
- 6
- 7
- 8
- 9
- 10
- 11
- 12
- 13
- 14
- 15

Detection Summary

Client: SCS Engineers
Project/Site: PSK Investments - 25216050.01

Job ID: 500-183570-1

Client Sample ID: Sump

Lab Sample ID: 500-183570-1

No Detections.

Client Sample ID: TB

Lab Sample ID: 500-183570-2

Analyte	Result	Qualifier	RL	MDL	Unit	Dil Fac	D	Method	Prep Type
Toluene	0.41	J	0.50	0.15	ug/L	1		8260B	Total/NA

This Detection Summary does not include radiochemical test results.

Eurofins TestAmerica, Chicago



Method Summary

Client: SCS Engineers
Project/Site: PSK Investments - 25216050.01

Job ID: 500-183570-1

Method	Method Description	Protocol	Laboratory
8260B	Volatile Organic Compounds (GC/MS)	SW846	TAL CHI
5030B	Purge and Trap	SW846	TAL CHI

Protocol References:

SW846 = "Test Methods For Evaluating Solid Waste, Physical/Chemical Methods", Third Edition, November 1986 And Its Updates.

Laboratory References:

TAL CHI = Eurofins TestAmerica, Chicago, 2417 Bond Street, University Park, IL 60484, TEL (708)534-5200



Sample Summary

Client: SCS Engineers
Project/Site: PSK Investments - 25216050.01

Job ID: 500-183570-1

Lab Sample ID	Client Sample ID	Matrix	Collected	Received	Asset ID
500-183570-1	Sump	Water	06/15/20 10:00	06/16/20 10:00	
500-183570-2	TB	Water	06/15/20 00:00	06/16/20 10:00	

1

2

3

4

5

6

7

8

9

10

11

12

13

14

15

Client Sample Results

Client: SCS Engineers
 Project/Site: PSK Investments - 25216050.01

Job ID: 500-183570-1

Client Sample ID: Sump
Date Collected: 06/15/20 10:00
Date Received: 06/16/20 10:00

Lab Sample ID: 500-183570-1
Matrix: Water

Method: 8260B - Volatile Organic Compounds (GC/MS)

Analyte	Result	Qualifier	RL	MDL	Unit	D	Prepared	Analyzed	Dil Fac
Benzene	<0.15		0.50	0.15	ug/L			06/19/20 15:12	1
Ethylbenzene	<0.18		0.50	0.18	ug/L			06/19/20 15:12	1
Methyl tert-butyl ether	<0.39		1.0	0.39	ug/L			06/19/20 15:12	1
Naphthalene	<0.34		1.0	0.34	ug/L			06/19/20 15:12	1
Toluene	<0.15		0.50	0.15	ug/L			06/19/20 15:12	1
1,2,4-Trimethylbenzene	<0.36		1.0	0.36	ug/L			06/19/20 15:12	1
1,3,5-Trimethylbenzene	<0.25		1.0	0.25	ug/L			06/19/20 15:12	1
Xylenes, Total	<0.22		1.0	0.22	ug/L			06/19/20 15:12	1
Surrogate	%Recovery	Qualifier	Limits				Prepared	Analyzed	Dil Fac
4-Bromofluorobenzene (Surr)	98		72 - 124					06/19/20 15:12	1
Dibromofluoromethane	110		75 - 120					06/19/20 15:12	1
1,2-Dichloroethane-d4 (Surr)	113		75 - 126					06/19/20 15:12	1
Toluene-d8 (Surr)	99		75 - 120					06/19/20 15:12	1

Client Sample Results

Client: SCS Engineers
 Project/Site: PSK Investments - 25216050.01

Job ID: 500-183570-1

Client Sample ID: TB

Lab Sample ID: 500-183570-2

Date Collected: 06/15/20 00:00

Matrix: Water

Date Received: 06/16/20 10:00

Method: 8260B - Volatile Organic Compounds (GC/MS)

Analyte	Result	Qualifier	RL	MDL	Unit	D	Prepared	Analyzed	Dil Fac
Benzene	<0.15		0.50	0.15	ug/L			06/19/20 15:39	1
Ethylbenzene	<0.18		0.50	0.18	ug/L			06/19/20 15:39	1
Methyl tert-butyl ether	<0.39		1.0	0.39	ug/L			06/19/20 15:39	1
Naphthalene	<0.34		1.0	0.34	ug/L			06/19/20 15:39	1
Toluene	0.41	J	0.50	0.15	ug/L			06/19/20 15:39	1
1,2,4-Trimethylbenzene	<0.36		1.0	0.36	ug/L			06/19/20 15:39	1
1,3,5-Trimethylbenzene	<0.25		1.0	0.25	ug/L			06/19/20 15:39	1
Xylenes, Total	<0.22		1.0	0.22	ug/L			06/19/20 15:39	1
Surrogate	%Recovery	Qualifier	Limits				Prepared	Analyzed	Dil Fac
4-Bromofluorobenzene (Surr)	103		72 - 124					06/19/20 15:39	1
Dibromofluoromethane	106		75 - 120					06/19/20 15:39	1
1,2-Dichloroethane-d4 (Surr)	113		75 - 126					06/19/20 15:39	1
Toluene-d8 (Surr)	100		75 - 120					06/19/20 15:39	1

Definitions/Glossary

Client: SCS Engineers
Project/Site: PSK Investments - 25216050.01

Job ID: 500-183570-1

Qualifiers

GC/MS VOA

Qualifier	Qualifier Description
J	Result is less than the RL but greater than or equal to the MDL and the concentration is an approximate value.

Glossary

Abbreviation	These commonly used abbreviations may or may not be present in this report.
α	Listed under the "D" column to designate that the result is reported on a dry weight basis
%R	Percent Recovery
CFL	Contains Free Liquid
CFU	Colony Forming Unit
CNF	Contains No Free Liquid
DER	Duplicate Error Ratio (normalized absolute difference)
Dil Fac	Dilution Factor
DL	Detection Limit (DoD/DOE)
DL, RA, RE, IN	Indicates a Dilution, Re-analysis, Re-extraction, or additional Initial metals/anion analysis of the sample
DLC	Decision Level Concentration (Radiochemistry)
EDL	Estimated Detection Limit (Dioxin)
LOD	Limit of Detection (DoD/DOE)
LOQ	Limit of Quantitation (DoD/DOE)
MCL	EPA recommended "Maximum Contaminant Level"
MDA	Minimum Detectable Activity (Radiochemistry)
MDC	Minimum Detectable Concentration (Radiochemistry)
MDL	Method Detection Limit
ML	Minimum Level (Dioxin)
MPN	Most Probable Number
MQL	Method Quantitation Limit
NC	Not Calculated
ND	Not Detected at the reporting limit (or MDL or EDL if shown)
NEG	Negative / Absent
POS	Positive / Present
PQL	Practical Quantitation Limit
PRES	Presumptive
QC	Quality Control
RER	Relative Error Ratio (Radiochemistry)
RL	Reporting Limit or Requested Limit (Radiochemistry)
RPD	Relative Percent Difference, a measure of the relative difference between two points
TEF	Toxicity Equivalent Factor (Dioxin)
TEQ	Toxicity Equivalent Quotient (Dioxin)
TNTC	Too Numerous To Count

QC Association Summary

Client: SCS Engineers
Project/Site: PSK Investments - 25216050.01

Job ID: 500-183570-1

GC/MS VOA

Analysis Batch: 548339

Lab Sample ID	Client Sample ID	Prep Type	Matrix	Method	Prep Batch
500-183570-1	Sump	Total/NA	Water	8260B	
500-183570-2	TB	Total/NA	Water	8260B	
MB 500-548339/6	Method Blank	Total/NA	Water	8260B	
LCS 500-548339/4	Lab Control Sample	Total/NA	Water	8260B	

1

2

3

4

5

6

7

8

9

10

11

12

13

14

15

Surrogate Summary

Client: SCS Engineers
Project/Site: PSK Investments - 25216050.01

Job ID: 500-183570-1

Method: 8260B - Volatile Organic Compounds (GC/MS)

Matrix: Water

Prep Type: Total/NA

Percent Surrogate Recovery (Acceptance Limits)

Lab Sample ID	Client Sample ID	BFB	DBFM	DCA	TOL
		(72-124)	(75-120)	(75-126)	(75-120)
500-183570-1	Sump	98	110	113	99
500-183570-2	TB	103	106	113	100
LCS 500-548339/4	Lab Control Sample	101	104	119	99
MB 500-548339/6	Method Blank	102	105	124	99

Surrogate Legend

BFB = 4-Bromofluorobenzene (Surr)

DBFM = Dibromofluoromethane

DCA = 1,2-Dichloroethane-d4 (Surr)

TOL = Toluene-d8 (Surr)

QC Sample Results

Client: SCS Engineers
 Project/Site: PSK Investments - 25216050.01

Job ID: 500-183570-1

Method: 8260B - Volatile Organic Compounds (GC/MS)

Lab Sample ID: MB 500-548339/6
Matrix: Water
Analysis Batch: 548339

Client Sample ID: Method Blank
Prep Type: Total/NA

Analyte	MB Result	MB Qualifier	RL	MDL	Unit	D	Prepared	Analyzed	Dil Fac
Benzene	<0.15		0.50	0.15	ug/L			06/19/20 10:18	1
Ethylbenzene	<0.18		0.50	0.18	ug/L			06/19/20 10:18	1
Methyl tert-butyl ether	<0.39		1.0	0.39	ug/L			06/19/20 10:18	1
Naphthalene	<0.34		1.0	0.34	ug/L			06/19/20 10:18	1
Toluene	<0.15		0.50	0.15	ug/L			06/19/20 10:18	1
1,2,4-Trimethylbenzene	<0.36		1.0	0.36	ug/L			06/19/20 10:18	1
1,3,5-Trimethylbenzene	<0.25		1.0	0.25	ug/L			06/19/20 10:18	1
Xylenes, Total	<0.22		1.0	0.22	ug/L			06/19/20 10:18	1

Surrogate	MB %Recovery	MB Qualifier	Limits	Prepared	Analyzed	Dil Fac
4-Bromofluorobenzene (Surr)	102		72 - 124		06/19/20 10:18	1
Dibromofluoromethane	105		75 - 120		06/19/20 10:18	1
1,2-Dichloroethane-d4 (Surr)	124		75 - 126		06/19/20 10:18	1
Toluene-d8 (Surr)	99		75 - 120		06/19/20 10:18	1

Lab Sample ID: LCS 500-548339/4
Matrix: Water
Analysis Batch: 548339

Client Sample ID: Lab Control Sample
Prep Type: Total/NA

Analyte	Spike Added	LCS Result	LCS Qualifier	Unit	D	%Rec	%Rec. Limits
Benzene	50.0	42.3		ug/L		85	70 - 120
Ethylbenzene	50.0	42.1		ug/L		84	70 - 123
Methyl tert-butyl ether	50.0	49.6		ug/L		99	55 - 123
Naphthalene	50.0	51.7		ug/L		103	53 - 144
Toluene	50.0	42.3		ug/L		85	70 - 125
1,2,4-Trimethylbenzene	50.0	39.6		ug/L		79	70 - 123
1,3,5-Trimethylbenzene	50.0	40.2		ug/L		80	70 - 123
Xylenes, Total	100	81.8		ug/L		82	70 - 125

Surrogate	LCS %Recovery	LCS Qualifier	Limits
4-Bromofluorobenzene (Surr)	101		72 - 124
Dibromofluoromethane	104		75 - 120
1,2-Dichloroethane-d4 (Surr)	119		75 - 126
Toluene-d8 (Surr)	99		75 - 120

Lab Chronicle

Client: SCS Engineers
Project/Site: PSK Investments - 25216050.01

Job ID: 500-183570-1

Client Sample ID: Sump

Date Collected: 06/15/20 10:00

Date Received: 06/16/20 10:00

Lab Sample ID: 500-183570-1

Matrix: Water

Prep Type	Batch Type	Batch Method	Run	Dilution Factor	Batch Number	Prepared or Analyzed	Analyst	Lab
Total/NA	Analysis	8260B		1	548339	06/19/20 15:12	JDD	TAL CHI

Client Sample ID: TB

Date Collected: 06/15/20 00:00

Date Received: 06/16/20 10:00

Lab Sample ID: 500-183570-2

Matrix: Water

Prep Type	Batch Type	Batch Method	Run	Dilution Factor	Batch Number	Prepared or Analyzed	Analyst	Lab
Total/NA	Analysis	8260B		1	548339	06/19/20 15:39	JDD	TAL CHI

Laboratory References:

TAL CHI = Eurofins TestAmerica, Chicago, 2417 Bond Street, University Park, IL 60484, TEL (708)534-5200

Accreditation/Certification Summary

Client: SCS Engineers
Project/Site: PSK Investments - 25216050.01

Job ID: 500-183570-1

Laboratory: Eurofins TestAmerica, Chicago

The accreditations/certifications listed below are applicable to this report.

Authority	Program	Identification Number	Expiration Date
Wisconsin	State	999580010	08-31-20

1

2

3

4

5

6

7

8

9

10

11

12

13

14

15

Eurofins TestAmerica, Chicago

2417 Bond Street
University Park, IL 60484
Phone 708-534-5200 Fax: 708-534-5211

Chain of Custody Record



Environmental Testing
Laboratory

Client Information		Sample ID: Zach Watson		Lab PM: Fredrick, Sandie	Camera Tracking Note(s)		COC No: 500-82378-37640.2
Client Contact: Mr. Robert Langdon		Phone: 262 518 4782		E-Mail: sandie.fredrick@testamericainc.com			Page: Page 2 of 2
Company: SCS Engineers		Due Date Requested:		Analysis Requested			Job #: 500-183570
Address: 2830 Dairy Dr		TAT Requested (days): 5 day turn around		Field Filtered Sample (Yes or No) Performs Methods (Yes or No) 8260B - PVC-HAP			Total Number of Containers:
City: Madison		PO #: 25216050.01					
State, Zip: WI, 53718		WFO #:					
Phone:		Project #: 50006561					
Email: rlangdon@scsengineers.com		SSOW#:		Preservation Codes:			Other:
Project Name: PSK Investments 25216050.01		Site:		A - HCL B - NaOH C - Zn Acetate D - Nitric Acid E - NaHSO4 F - MeOH G - Amchlor H - Ascorbic Acid I - Ice J - DI Water K - EDTA L - EDA			M - Hexane N - None O - AsNaO2 P - Na2O4S Q - Na2S2O3 R - Na2S2O3 S - H2SO4 T - TSP Dodecahydrate U - Acetone V - MCAA W - pH 4-5 Z - other (specify)
Sample Identification		Sample Date	Sample Time	Sample Type (C=comp, G=grab)	Matrix (W=water, S=solid, O=wastefl)	Preservation Code:	Special Instructions/Note:
Sump TB		6/15/20	1000	G	Water	A	5 day Turn around
					Water		
					Water		
					Water		
Possible Hazard Identification				Sample Disposal (A fee may be assessed if samples are retained longer than 1 month)			
<input type="checkbox"/> Non-Hazard <input type="checkbox"/> Flammable <input type="checkbox"/> Skin Irritant <input type="checkbox"/> Poison B <input type="checkbox"/> Unknown <input type="checkbox"/> Radiological				<input type="checkbox"/> Return To Client <input type="checkbox"/> Disposal By Lab <input type="checkbox"/> Archive For _____ Months			
Deliverable Requested: I, II, III, IV, Other (specify)				Special Instructions/QC Requirements:			
Empty Kit Relinquished by:		Date:		Time:		Method of Shipment	
Relinquished by: Zach Watson		Date/Time: 6/15/20 10:30		Company: SCS		Received by: [Signature]	
Relinquished by: [Signature]		Date/Time: 6-15-20 17:00		Company: TA		Date/Time: 6/16/20 1000	
Relinquished by:		Date/Time:		Company:		Received by: [Signature]	
Custody Seals Intact: <input type="checkbox"/> Yes <input type="checkbox"/> No		Custody Seal No.:		Cooler Temperature(s) °C and Other Remarks: 0.8 → 1.8			

- 1
- 2
- 3
- 4
- 5
- 6
- 7
- 8
- 9
- 10
- 11
- 12
- 13
- 14
- 15



500-183570 Waybill

ORIGIN ID:RRLA (262) 202-5955
SHIPPING
TESTAMERICA
4125 N. 124TH ST

BROOKFIELD, WI 53005
UNITED STATES US

SHIP DATE: 15JUN20
ACTWGT: 34.50 LB
CAD: 525155/CAFE3211

BILL RECIPIENT

TO **SAMPLE RECEIPT**
TESTAMERICA LABS
2417 BOND STREET

UNIVERSITY PARK IL 60484

(708) 634-5200

REF:

INVT:
PD:

DEPT:

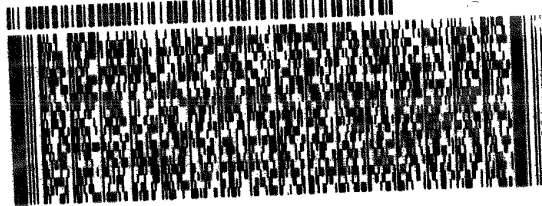

519
31
5
10:30
7
06



TRK# 7125 4942 7564
0201

TUE - 16 JUN 10:30A
PRIORITY OVERNIGHT

79 JOTA

60484
DD



- 1
- 2
- 3
- 4
- 5
- 6
- 7
- 8
- 9
- 10
- 11
- 12
- 13
- 14
- 15

Login Sample Receipt Checklist

Client: SCS Engineers

Job Number: 500-183570-1

Login Number: 183570

List Source: Eurofins TestAmerica, Chicago

List Number: 1

Creator: Scott, Sherri L

Question	Answer	Comment
Radioactivity wasn't checked or is \leq background as measured by a survey meter.	True	
The cooler's custody seal, if present, is intact.	True	
Sample custody seals, if present, are intact.	True	
The cooler or samples do not appear to have been compromised or tampered with.	True	
Samples were received on ice.	True	
Cooler Temperature is acceptable.	True	
Cooler Temperature is recorded.	True	1.8
COC is present.	True	
COC is filled out in ink and legible.	True	
COC is filled out with all pertinent information.	True	
Is the Field Sampler's name present on COC?	True	
There are no discrepancies between the containers received and the COC.	True	
Samples are received within Holding Time (excluding tests with immediate HTs)	True	
Sample containers have legible labels.	True	
Containers are not broken or leaking.	True	
Sample collection date/times are provided.	True	
Appropriate sample containers are used.	True	
Sample bottles are completely filled.	True	
Sample Preservation Verified.	True	
There is sufficient vol. for all requested analyses, incl. any requested MS/MSDs	True	
Containers requiring zero headspace have no headspace or bubble is <math><6\text{mm}</math> (1/4").	True	
Multiphasic samples are not present.	True	
Samples do not require splitting or compositing.	True	
Residual Chlorine Checked.	N/A	

