



April 26, 2018

Navistar, Inc.
Ferdinand Alido
2701 Navistar Dr.
Lisle, IL 60532

Subject: Review of "Interim Soil and Groundwater/Surface Water Data Summary" and "Additional Site Investigation Scope"
Renaissance Manufacturing Group, (Former Navistar Facility)
1401 Perkins Avenue, Waukesha, WI
WDNR BRRTS Activity # 02-68-098404, WDNR FID # 268005430

Dear Mr. Alido:

The Wisconsin Department of Natural Resources (DNR) received the above "Interim Soil and Groundwater/Surface Water Data Summary", dated March 2, 2018 from KPRG on March 5, 2018. In addition, DNR received the above "Additional Site Investigation Scope" dated April 12, 2018 from KPRG. The DNR reviews environmental investigation and remediation cases for compliance with state statutes and rules to maintain consistency in the investigation and remediation of these cases.

After careful review of the above reports, the DNR is providing the following comments:

1. Continue with the proposed soil investigation by installing borings GP-55 and GP-56.
2. Continue the groundwater investigation by installing monitoring wells MW -26, MW-38, MW-39, MW-40, MW-41, MW-42 and MW-43. If possible, relocate MW 26 southeast to the empty lot which is located north of MW-11.
3. Continue to collect groundwater samples from the existing and proposed monitoring wells to document contaminant levels on and off site.
4. Continue with the vapor intrusion investigation by sampling the additional homes located to the south of the facility as indicated on the attached Figure 1 dated April 4, 2018. In addition, finalize the vapor intrusion investigation approved by the DNR on June 21, 2017. Report all sampling results to the department and to the property owner within 10 business days of receiving the sample results as required in NR 716.14(2).
5. Provide the DNR with contact information for the adjacent property owners that denied access to collect vapor intrusion samples.
6. Complete sampling of the floor drains inside the facility.
7. Tabulate soil and groundwater data from previous and current site investigations together.

Please respond in writing if the proposed schedule on Figure 12 of the above report cannot be met. Follow the timeframes established in the NR 700 Wis. Adm. Code rule series (see publication "NR 700 Site Investigation Process and Timeline flowchart, RR-967, for timeframes). Until the site investigation and closure requirements have been met, your site will remain "open" and you also will need to continue to submit the semi-annual progress reports, as required by s. NR 711(1), Wis. Adm. Code.

The DNR reserves the right to require additional investigation based on additional information provided.

The DNR appreciates the cooperation with the investigation of this site. If you have any questions regarding this letter, please contact me at 262-574-2146 or by e-mail at mark.drews@wisconsin.gov.

Sincerely,

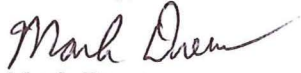

Mark Drews

Remediation & Redevelopment Program

Attachment:

"Proposed Additional Boring and Monitoring Well Locations", Figure 1, KPRG

c: KPRG, Rich Gnat, 14665 W. Lisbon Rd., Suite 2B, Brookfield, WI 53005
Renaissance Manufacturing Group, 1401 Perkins Ave., Waukesha, WI 53186
SER File

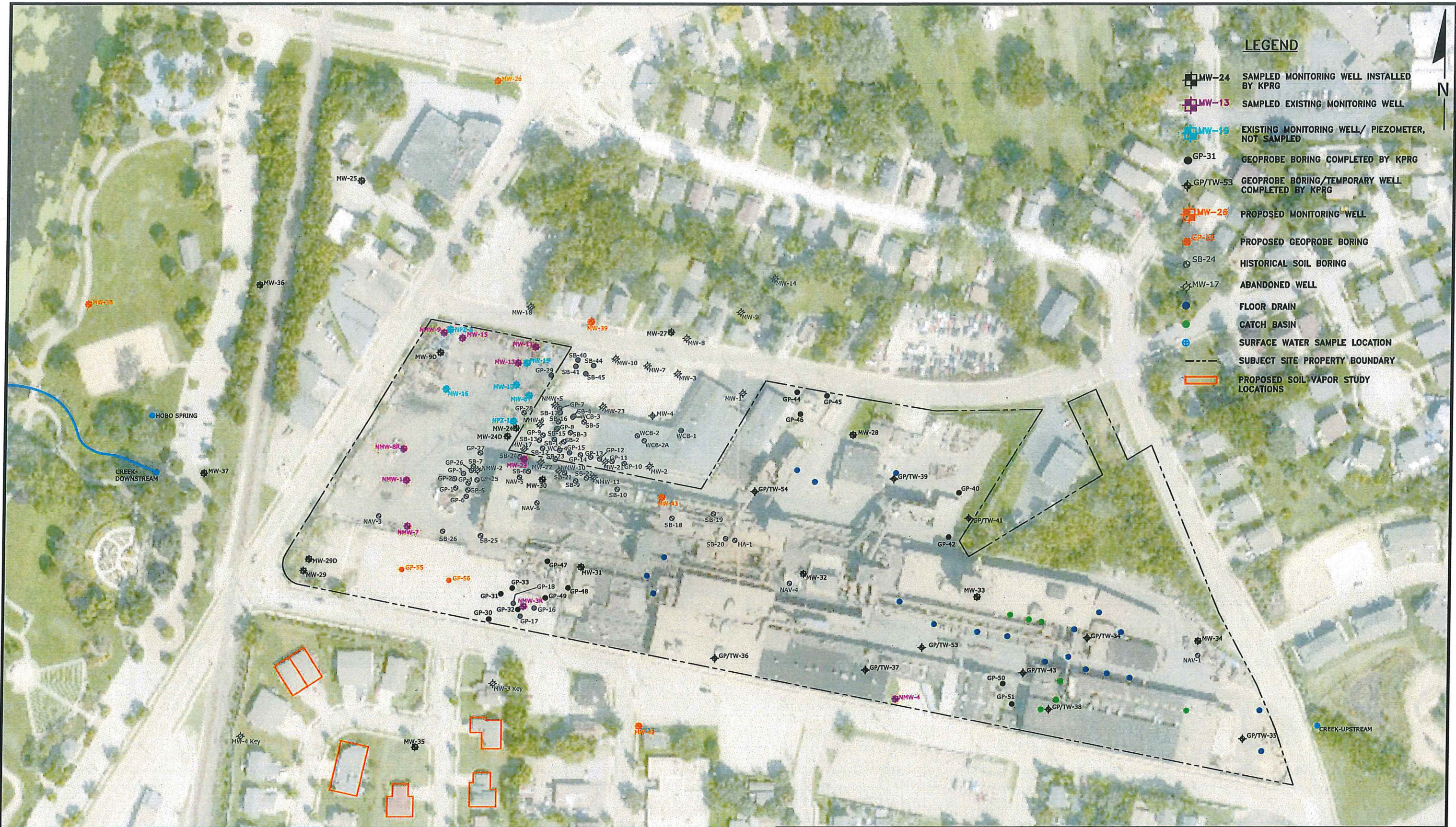

LEGEND

- MW-24 SAMPLED MONITORING WELL INSTALLED BY KPRG
- MW-13 SAMPLED EXISTING MONITORING WELL
- MW-19 EXISTING MONITORING WELL/ PIEZOMETER, NOT SAMPLED
- GP-31 GEOPROBE BORING COMPLETED BY KPRG
- GP/TW-53 GEOPROBE BORING/TEMPORARY WELL COMPLETED BY KPRG
- MW-26 PROPOSED MONITORING WELL
- GP-53 PROPOSED GEOPROBE BORING
- SB-24 HISTORICAL SOIL BORING
- MW-17 ABANDONED WELL
- FLOOR DRAIN
- CATCH BASIN
- SURFACE WATER SAMPLE LOCATION
- SUBJECT SITE PROPERTY BOUNDARY
- PROPOSED SOIL VAPOR STUDY LOCATIONS



0 150'
APPROXIMATE SCALE

ENVIRONMENTAL CONSULTATION & REMEDIATION

K P R G KPRG and Associates, Inc.

14665 West Usbon Road, Suite 28 Brookfield, Wisconsin 53005 Telephone 262-781-0475 Facsimile 262-781-0478
414 Plaza Drive, Suite 106 Westmont, Illinois 60559 Telephone 630-325-1300 Facsimile 630-325-1593

PROPOSED ADDITIONAL BORING AND MONITORING WELL LOCATIONS

RMG WAUKESHA FOUNDRY
1401 PERKINS AVE, WAUKESHA, WI

Scale: 1" = 150' Date: April 4, 2018

KPRG Project No. 11717 FIGURE 1

T:\Projects\11717\11717_0418\11717_0418.dwg