

State of Wisconsin Substance Release Notification Form
Department of Natural Resources Form 4400-91 (Rev. 12-04, e-form)
24-Hour Emergency Hotline Number: 1-800-943-0003

Page 1 of 2

04-71-542882

Date & Military Time Of Incident: 01/14/2005 0830hrs		Date & Military Time Reported: 01/14/2005 845hrs		Spill File # <u>BRRTS #</u>	
Person Reporting: Bill Hartman		Representing: PH Glatfelter		Phone # (920) 209-2016 Fax # ()	
Responsible Party (RP) / Spiller: Quality Carriers		RP Decision Based On: Driver Doug McLellan		Phone # (877) 718-9851 Fax # ()	
RP Address: 3802 Cor PorDEX Park Drive				City <u>Midland</u> State <u>MI</u> Zip Code <u>Tampa FL 33614</u>	
RP Contact Name & Title: (Driver Doug McLellan)				Phone # (706) 539-2301 Fax # ()	
Substance Involved: Latex 638 NA		Amount & Units Released: 75-100 gallons		Amount & Units Recovered: Same 75-100 gallons	
<input type="checkbox"/> Solid <input type="checkbox"/> Semisolid <input checked="" type="checkbox"/> Liquid <input type="checkbox"/> Gas Color: White Odor:					
Exact Location Of Incident: (including street name, bldg. #, mileage, etc.) W. Wisconsin Ave/Main St in front of PH Glatfelter at 225 W. Wisconsin Ave, Neenah				Facility Name / Property Owner: City of Neenah--Main St	
<input checked="" type="checkbox"/> City <input type="checkbox"/> Village <input type="checkbox"/> Township Neenah		County Winnebago		Latitude/Longitude deg. ' " , deg. ' "	
DNR Region: NER		1/4 1/4 Sec T N R <input type="checkbox"/> E <input type="checkbox"/> W		Weather Conditions: Sunny, 0'sF, West wind	
Cause of Incident: Truck Driver had hose attached to back of tank trailer to unload latex into PH Glatfelter. Hose started to leak a few feet from attachment to trailer. Latex substance leaked down side of road. <i>Quality Carriers truck. PH Glatfelter hose-hose split</i>					
Spilled Substance Impact To: (check X all that apply) <input type="checkbox"/> Air <input type="checkbox"/> Potential <input checked="" type="checkbox"/> Concrete/Asphalt <input type="checkbox"/> Potential <input type="checkbox"/> Contained/Recovered <input type="checkbox"/> Groundwater <input type="checkbox"/> Potential <input type="checkbox"/> Private Well <input type="checkbox"/> Potential <input type="checkbox"/> Sanitary Sewer <input type="checkbox"/> Potential <input type="checkbox"/> Soil <input type="checkbox"/> Potential <input checked="" type="checkbox"/> Storm Sewer <input type="checkbox"/> Potential <input type="checkbox"/> Surface Water <input type="checkbox"/> Potential Name: <input type="checkbox"/> Other:		Spill Cause and/or Site: <input type="checkbox"/> Ag Coop/Food Factory <input type="checkbox"/> Airport Facility <input type="checkbox"/> Railroad Facility <input type="checkbox"/> Construction, Excavation, Wrecking, Quarry, Mine <input type="checkbox"/> Gas/Service Station/Garage/Auto Dealer/Repair Shop <input type="checkbox"/> Hydraulic Line Break <input checked="" type="checkbox"/> Industrial Facility <input checked="" type="checkbox"/> Paper Mill <input type="checkbox"/> Chemical Co. <input type="checkbox"/> Pipeline/Terminal/Tank Farm/Oil Jobber/Wholesaler <input type="checkbox"/> Private Property (home/farm) <input checked="" type="checkbox"/> Public Property (city, state, church, school, etc.) <input type="checkbox"/> Transportation Accident, Fuel Tank Spill <input type="checkbox"/> Transportation Accident, Load Spill <input type="checkbox"/> Utility Co. Power Generating/Transfer Facility <input type="checkbox"/> Other:		Action Taken By Spiller: <input checked="" type="checkbox"/> Cleanup Method: <input checked="" type="checkbox"/> Absorbent <input type="checkbox"/> Excavation <input checked="" type="checkbox"/> tractor/bucket <input type="checkbox"/> Containment <input type="checkbox"/> Contractor Hired Name: <i>1200 under Pressure City of Neenah</i> <input type="checkbox"/> Monitor <input type="checkbox"/> No Action Needed <input type="checkbox"/> No Action Taken <input checked="" type="checkbox"/> Waste Destination: Sludge pile to Minergy <input checked="" type="checkbox"/> Other: <i>Make on Storm Sewer</i>	
Injuries? <input type="checkbox"/> Yes <input checked="" type="checkbox"/> No If yes how many?		Has An Evacuation Occurred? <input type="checkbox"/> Yes <input checked="" type="checkbox"/> No Potential? <input type="checkbox"/> Yes <input checked="" type="checkbox"/> No			
Are There Any Resource Damages? <input type="checkbox"/> Yes <input checked="" type="checkbox"/> No <input type="checkbox"/> Potential What Kind?					
Other Agencies Notified: (check first column, if notified; check both columns, if on the scene) <input type="checkbox"/> Fire Department <input checked="" type="checkbox"/> Local DNR <input type="checkbox"/> EPA <input type="checkbox"/> Local Law Enforcement <input type="checkbox"/> Div. Emerg. Mgt. <input type="checkbox"/> Nat'l Resp Ctr 800-442-8802 <input type="checkbox"/> LEPC or Local Emer. Mgt. <input type="checkbox"/> Coast Guard <input type="checkbox"/> Chemtrec 800-424-9300 <input type="checkbox"/> Level A/Level B Team <input type="checkbox"/> DHFS 608-258-0099 <input type="checkbox"/> Other:					Incident Commander: Phone # ()
Prepared By: Amie Egstad	Phone # (920) 832-2745	Date: 01/14/2005	Rpt'd To DATCP? <input type="checkbox"/> Yes <input checked="" type="checkbox"/> No Date: Transferred to DATCP <input type="checkbox"/> Yes <input type="checkbox"/> No Date:		
Person Notified: Jim Savinski	Phone # (920) 424-4013	Date: 01/14/2005	Spill Packet Sent? <input type="checkbox"/> Yes <input checked="" type="checkbox"/> No Date: To:		
Investigated By: 01/14/2005	Sign:	Date:	Transferred to ERP <input type="checkbox"/> Yes <input checked="" type="checkbox"/> No Date: Case #		
Spill Coordinator Signoff:		Date:	NFA Letter Sent? <input type="checkbox"/> Yes <input checked="" type="checkbox"/> No Date: Incident Closed? <input checked="" type="checkbox"/> Yes <input type="checkbox"/> No Date:		
<input checked="" type="checkbox"/> See Additional Comments On Reverse (Please, print page 2 of 2)					

Date and Military Time Of Incident: 01/14/2005
0830hrs

Responsible Party: Quality Carriers

Additional Comments : Warden Egstad responded to scene and observed spilled area of latex along Main St. PH Glatfelter staff had placed a yellow storm sewer plastic cover on one of the inlets that had the latex flow over it. Farther west along Main St, they had placed another cover over a storm sewer, but it did not flow that far due to freezing/hardening of latex. The driver gave information of Tractor #Q10128, Trailer #701022, Terminal #568 out of Midland, Michigan. PH Glatfelter planned to use either tractor with a bucket attached or call the City of Neenah to use theirs where they would scrape/scoop up the frozen latex off the street. They planned to put the latex on their sludge pile that is taken to Minergy.

1-19-05 Chronovert message for Bill Hartman

11:05 Hartman

Private Contractor - froze immed. - Scraped up large portion city block Rd off. until Tues (1-18-05) Tues - City Grader Scraped to Rd surface. Storm sewer cover, but 2 gallons into storm. Able to recover latex out of H₂O under pressure - vacuum out storm - to waste treatment.

~~Robert Lohan~~

R Lohan @ Glatfelter.com
Robert Lohan -

Case Activity Report: ☐ Yes ☐ No CAR#:

(Please, attach copy of all CAR and other documentation)

Enforcement Action: ☐ Yes ☐ No (Explain Below)



G L A T F E L T E R
Beyond Paper

January 24, 2005

Roxanne Nelezen Chronert
Spills Coordinator
P.O. Box 10448
Green Bay, WI 54307-0448



RE: Latex Spill

Dear Roxanne,

On Friday January 14, at approximately 8:30 am, there was a release of Latex 638CP at 225 W. Wisconsin Avenue. This occurred while a tank truck was unloading the latex in front of the Glatfelter Neenah Facility. At this time a pipe split, releasing approximately 75 to 100 gallons of the liquid latex unto the street. The spill traveled west along the side of the road staying in the far right lane. As soon as the driver became aware of the leak he closed the unloading valve on the truck, preventing any more liquid from being released onto the road. Glatfelter employees immediately placed Drain Blocker mats over the two storm drains that are located along the path the latex was traveling.

As soon as I was informed of the release I notified Jim Savinski at the DNR and provided him with details of the spill. Jim Savinski asked local DNR employee, Amie Egstadt, to come to the mill. Once she arrived she was given a quick tour of the spill area and a copy of the MSDS. I also contacted Gerry Kaiser from the City of Neenah. A city employee came to the mill to investigate the release.

With temperatures around 0 °F when the release occurred, the material froze to the concrete almost immediately. Mill employees attempted to chip up the material with hand scrapers, but had little success. A local contractor, Calnin and Goss, was called in to use a bobcat, which was able to remove most of the material. The weather forecast was for the temperatures to remain around 0 °F for the weekend so it was decided to barricade the area and attempt to remove the rest of the latex on Monday.

On Monday, January 17, we requested that personnel from the City of Neenah bring out their road grader to assist in removing the remainder of the latex from the road. They were able to come out on Tuesday morning and grade the area of the spill. The grader was able to remove almost all of the remaining latex. H2O Under Pressure, which operates a vacuum service, was also onsite while the City of

Neenah graded the road. They vacuumed up the debris as the grader removed it from the concrete. Once the majority of the latex was removed City personnel spread gravel across the area and removed the barricades.

The Drain Blockers were removed after the City graded the street. At this time it was discovered that a small amount of latex had entered the catch basin. Since the elevation of liquid in the basin is much lower than the lowest elevation of the storm water pipe, no latex entered the storm water system. The small amount of latex in the catch basin was vacuumed out by H2O Under Pressure.

On the afternoon of Wednesday, January 19th the temperatures began to rise causing the small amount of latex remaining around the curb to melt. This left a white film against the curb so H2O Under Pressure was once again called. H2O Under Pressure personnel were able to pressure wash and vacuum the entire area removing the last of the latex.

All of the latex that was recovered throughout the cleanup process was disposed of through Glatfelter's onsite waste treatment process.

The trucking company is Quality Carriers, 3802 Corpordex Park Drive, Tampa Florida, 33619. They may be reached at (706) 539-2301 and the driver was Doug McMillian, number DM003.

If you have any questions please feel free to contact me at (920) 727-2606.

Sincerely,

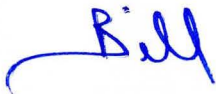

William Hartman
Environmental Director
Glatfelter

Cc: RT Rohan
KJ Clusman
KR Firchow
CL Missimer
PA Zaepfel
Jim Savinski - DNR

Attachments

Attachment 1- MSDS
Attachment 2- Site Plot

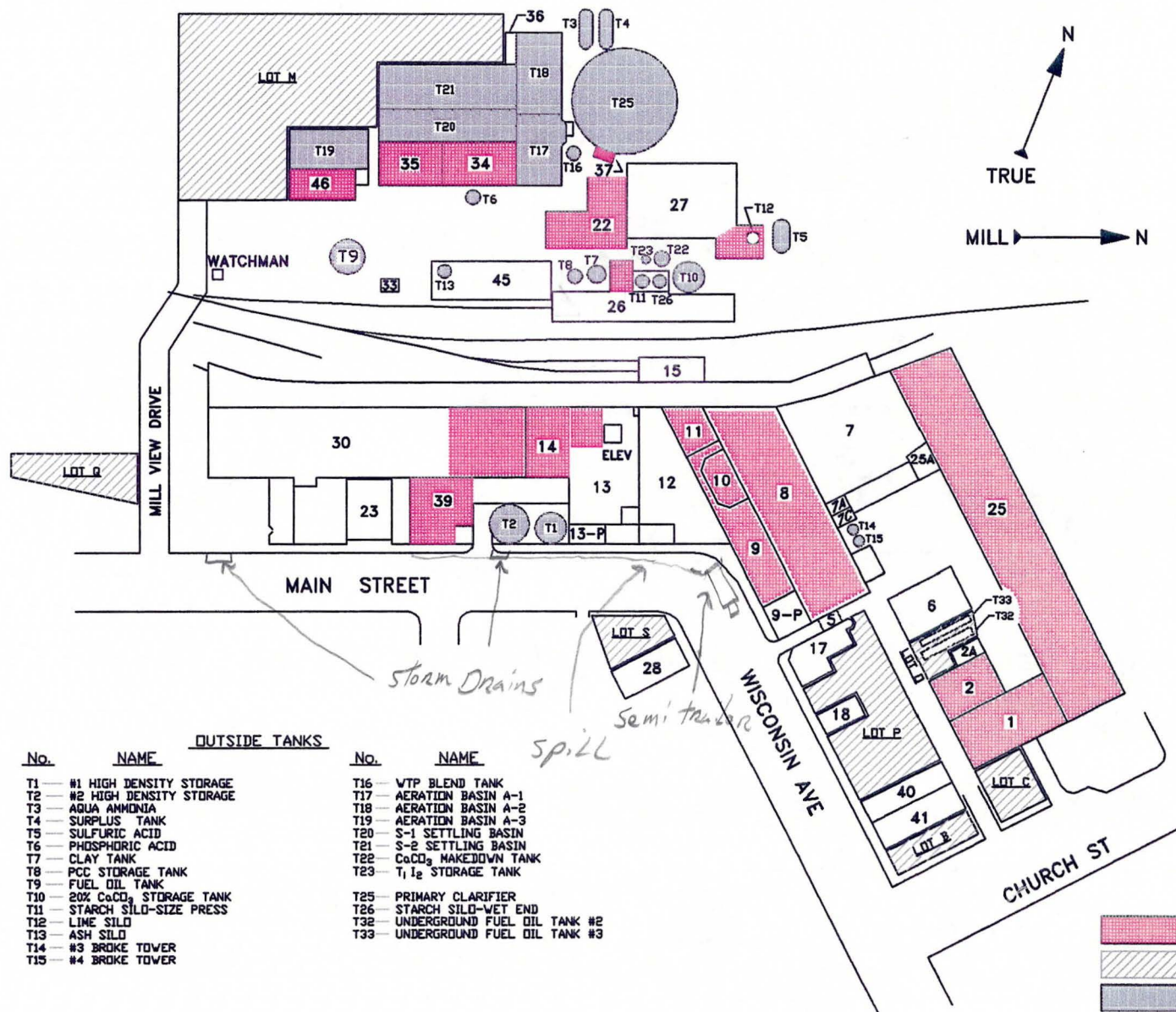

BUILDINGS	
No.	NAME
1	BOILER HOUSE
2	GENERATOR ROOM
2A	CHEMICAL ROOM
5	FIRE PUMP HOUSE
6	TECHNICAL & LAB
7	ROLL WRAP & STORAGE
7A	STORAGE ROOM
7C	PRINT TESTING
8	#3 & #4 MACHINE ROOM
9	BEATER ROOM & ADDITIVES
10	HPS PULPER
11	WASHING
12	WAREHOUSE & MAINT. SHOPS
13	WAREHOUSE & MAINT. OFFICES
14	SCREEN ROOM & HYPOWASHER
15	CAUSTIC STORAGE
17	MAIN OFFICE
18	BLACKSMITH SHOP
22	WASTE DISPOSAL PLANT
23	TRUCK & TOW MOTOR SHOP
25	#5 MACHINE ROOM
25A	LOADING DOCK
26	BULK UNLOADING
27	WATER TREATMENT
28	ENGINEERING DEPARTMENT
30	RECEIVING WAREHOUSE
33	OIL PUMP HOUSE
34	DAF/GBT
35	TRUCK STORAGE
36	PUMP ROOM
37	SAMPLER BLDG.
39	BLEACHERY
40	RENTAL STORE
41	TRAINING CENTER
45	SLUDGE COMBUSTOR BLDG.
46	A-3 AERATION BUILDING

No.	NAME
T1	#1 HIGH DENSITY STORAGE
T2	#2 HIGH DENSITY STORAGE
T3	AQUA AMMONIA
T4	SURPLUS TANK
T5	SULFURIC ACID
T6	PHOSPHORIC ACID
T7	CLAY TANK
T8	PCC STORAGE TANK
T9	FUEL OIL TANK
T10	20% CaCO ₃ STORAGE TANK
T11	STARCH SILO-SIZE PRESS
T12	LINE SILO
T13	ASH SILO
T14	#3 BROKE TOWER
T15	#4 BROKE TOWER

No.	NAME
T16	WTP BLEND TANK
T17	AERATION BASIN A-1
T18	AERATION BASIN A-2
T19	AERATION BASIN A-3
T20	S-1 SETTLING BASIN
T21	S-2 SETTLING BASIN
T22	CaCO ₃ MAKE/DOWN TANK
T23	T ₁ I ₂ STORAGE TANK
T25	PRIMARY CLARIFIER
T26	STARCH SILO-WET END
T32	UNDERGROUND FUEL OIL TANK #2
T33	UNDERGROUND FUEL OIL TANK #3

	HEARING PROTECTION REQUIRED
	PARKING LOTS
	OUTDOOR TANKS

5
ADDED THE FOLLOWING BUILDINGS TO HEARING PROTECTION REQUIRED AREAS:
35, 37 and PARTS OF 13 & 30.
KRF/NAS 2-14-02

4
REMOVED LP TANK (T-24).
ADDED WET END STARCH SILO (T-26).
REMOVED NORTH & SOUTH QUALITY PRINT BLDGS. (43 & 44).
VBC/NAS 8-29-01

3
REVISED TANK NAMES:
T8 WAS SPARE.
T23 WAS ANATESE.
RRR/NAS 11-1-00

2
REVISED PARKING LOTS M & N PER MINERGY INSTALLATION.
REMOVED SITE SECURITY POST No. 8.
KRF/NAS 12-22-98

1
REDRAWN ON CAD.
GENERAL UPDATE.
TRC 3-31-94

REVISIONS



NEENAH FACILITY
APPROVED BY:
DATE:
APPROVED BY:
DATE:
CADD FILE NO.: 1A20204A

BUILDINGS REQUIRING HEARING PROTECTION			
SCALE:	DATE:	DATE:	DATE:
NONE	TRC	3-31-94	
DRAWING NUMBER:	1-A-20204-A (Sheet 2)		REVISIONS: 5