

**From:** [Symons, Brian D](#)  
**To:** [Sager, John E - DNR](#)  
**Cc:** [Gregory Prom \(MP\)](#); [Jamie Mehle \(SWLP\)](#); [Hughes, Erin](#); [Laszewski, Steve](#); [Saari, Christopher A - DNR](#)  
**Subject:** RE: [EXTERNAL MAIL] SWL&P 100% Design  
**Date:** Wednesday, December 28, 2022 5:16:49 PM  
**Attachments:** [Attachments.html](#)

---

**CAUTION: This email originated from outside the organization.  
Do not click links or open attachments unless you recognize the sender and know the content is safe.**

In the 90% Upland RAD comments, DNR requested nested piezometers with monitoring wells MW-3R and MW-4R and an additional monitoring well located near the City of Superior building in the area of SLIF-33. This e-mail is a response to DNR's e-mail dated December 27, 2022 regarding the nested monitoring wells and MW-29.

The Upland 100% Design included the wells noted above, namely nested wells MW-3A/3B and MW-4A/4B and MW-29. As shown on Drawings A-8, B-5, and B-6, MW-3R and MW-4R were relabeled as MW-3A and MW-4A, respectively. MW-3B and MW-4B are the requested piezometers. MW-3B and MW-4B were screened immediately beneath the excavations in the 100% Upland RAD submitted October 2022. DNR has requested:

- the screened interval for MW-3B and MW-4B to be installed at approximately 596 to 601ft MSL adjusted to intersect sand layers, if present, and
- the location of MW-29 to be located further west near SLIF-33.

Foth has revised the drawings to show:

- the cross-sections for MW-3B or MW-4B screened between 596 and 601 ft MSL (i.e., Drawings B-5 and B-6 in the RAD, ECSWMP, and OM&M Plan) and
- the location for B-29 near SLIF-33 (i.e., Drawing A-8 in the RAD, ECSWMP, and OM&M Plan; FSP Figure 4-1; and AMP Figure 2-1).

The revised drawings are attached along with the Appendix B-1 drawing that shows the location of B-33 near the new location of MW-29.

#### Citrix Attachments

Expires January 27, 2023

---

22-12-28 AMP Figure 2-1 Air Monitoring St...ons.pdf	1.2 MB
22-12-28 Drawing A-8 MW-29 Moved.pdf	1.2 MB
22-12-28 Drawing B-5 MW-3B Revised Screen.pdf	301.6 KB
22-12-28 Drawing B-6 MW-4B Revised Screen.pdf	324 KB
22-12-28 FSP Figure 4-1 Long Term Ground...ork.pdf	1.1 MB

Download Attachments

**From:** Sager, John E - DNR [<mailto:John.Sager@wisconsin.gov>]  
**Sent:** Tuesday, December 27, 2022 8:14 AM  
**To:** Gregory Prom (MP) <[gprom@mnpower.com](mailto:gprom@mnpower.com)>  
**Cc:** Jamie Mehle (SWLP) <[JMehle@swlp.com](mailto:JMehle@swlp.com)>; 'Hughes, Erin' <[Erin.Hughes@foth.com](mailto:Erin.Hughes@foth.com)>; Saari, Christopher A - DNR <[Christopher.Saari@wisconsin.gov](mailto:Christopher.Saari@wisconsin.gov)>  
**Subject:** [EXTERNAL MAIL] SWL&P 100% Design

## ? Is This Email Legitimate

**[EXTERNAL EMAIL] This message was sent from someone outside the company.**

Do not click links, download attachments, or reply with personal information unless you recognize the sender and know the content is safe.

Greg,

Going through the 100% design report I noticed a comment that does not appear to have been addressed (highlighted in yellow below):

Section 2.1.5, page 19, first paragraph:

The DNR requested additional groundwater monitoring wells and piezometers be installed to provide further information on groundwater quality during and following active remedial action activities. The DNR requested piezometers, nested with monitoring wells MW-3R and MW-4R, monitoring wells directly downgradient of the Hortonsphere and gas holder excavations and an additional monitoring well located near the City of Superior building in the area of SLIF-33. This RAD does not include the requested piezometers. The DNR will not approve a final design without all the requested monitoring wells included in the RAD. DNR wants the replacement monitoring wells MW-3R and MW-4R installed as water table observation wells screened within the excavation backfill only and piezometers installed with 5-foot well screens installed at approximately 596 to 601ft MSL and adjusted to intersect any sand and gravel seams encountered near this depth. The screen and filter pack for the piezometers is not to extend into the excavation and an adequate seal placed so groundwater from the backfilled excavation does not migrate through the filter pack or well casing into the piezometer.

**Also, Foth depicts the location of an additional monitoring well MW-29, further east than the DNR would prefer. The DNR wants a well installed near the location of SLIF-33 to be nearer the active remedial action area to be able to assess groundwater quality near the active remedial action system. Install the well screen to intersect the depths of elevated LIF values.**

Figure 4-1 in Foth's Field sampling plan depicts the well in the same location as in the 90% design. Rather than delaying approval of the entire 100% design over this issue I would like written confirmation from SWL&P and Foth including a new Figure 4-1 depicting the locations

of the proposed monitoring well MW-29 in the location requested by DNR. If SWL&P and Foth would like to retain the location depicted then the DNR requests an additional monitoring well near the location of SLIF-33. If this issue is not addressed it may delay DNR issuing approval of the 100% design report.

Please let me know if you have any questions.

**We are committed to service excellence.**

Visit our survey at <http://dnr.wi.gov/customersurvey> to evaluate how I did.

John Sager

Hydrogeologist – Remediation and Redevelopment Program

Wisconsin Department of Natural Resources

1701 N. 4<sup>th</sup> St.

Superior, WI 54880

Phone: (715) 919-7239

[john.sager@wisconsin.gov](mailto:john.sager@wisconsin.gov)



[dnr.wi.gov](http://dnr.wi.gov)







P:\Projects\sw\ben\mfg\csm\foth\pwr\01\Documents\Clients\Superior\Water\Light Power\0018S024\00\CAD\Drawings\Remedial Design\100 PCT1100-Drawing B-5 Cross Sections Former MGP Gas Holder.dgn  
 10/5/2022 11:46:42 AM jpw

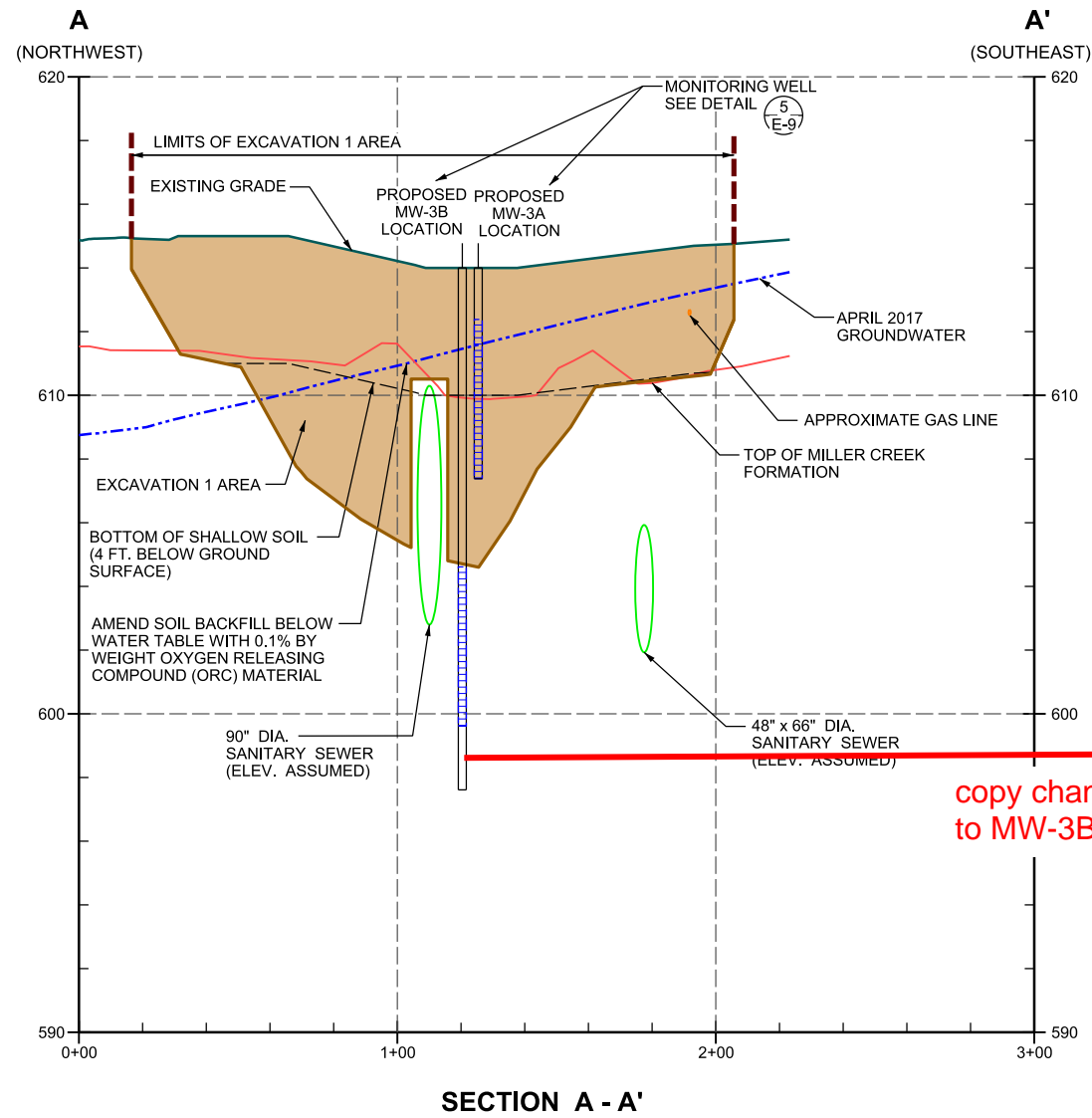

copy changes for MW-4B from B-6 to MW-3B on both sections on B-5.

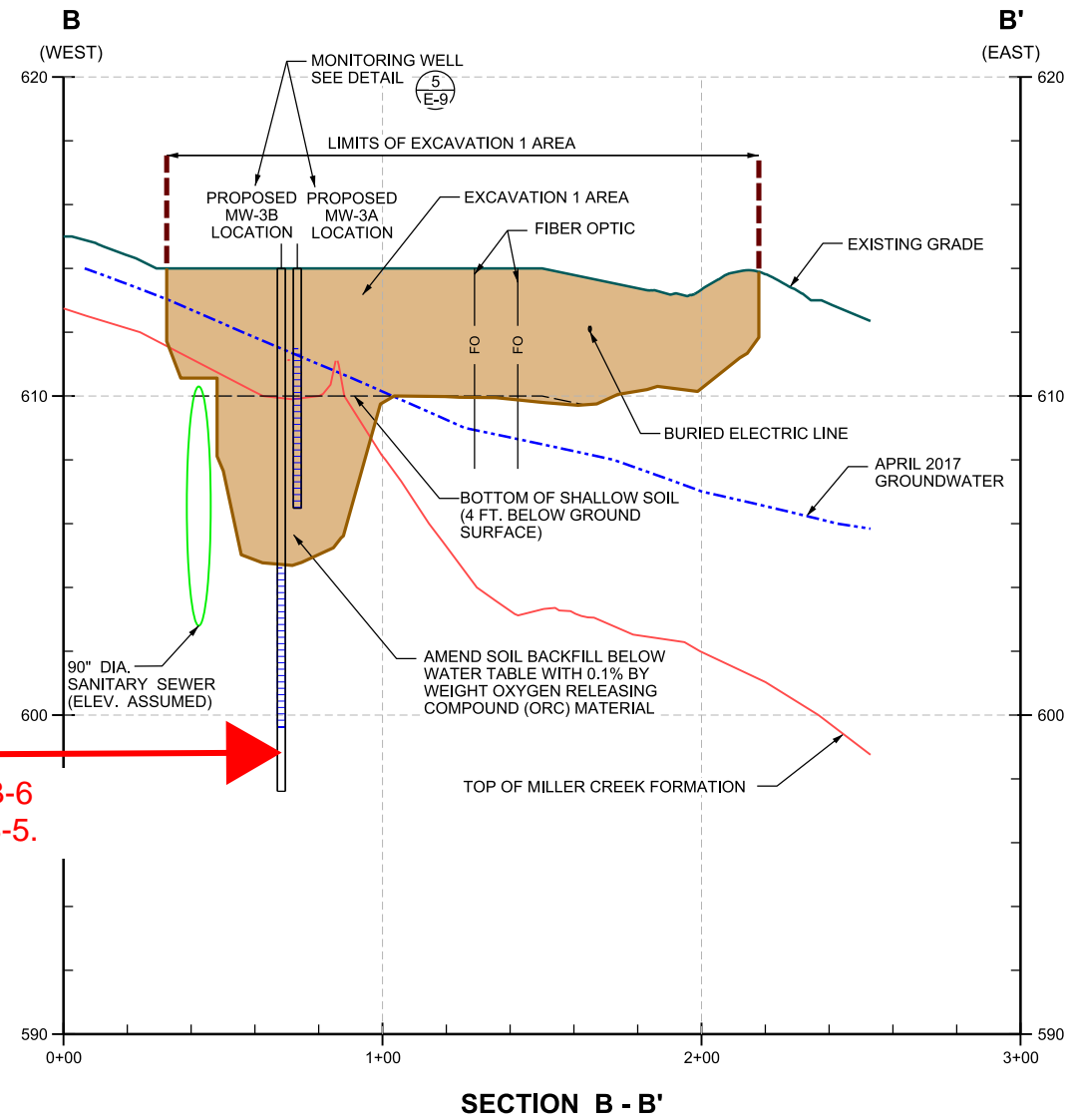

**NOTES:**

- SEE DRAWING B-1 FOR CROSS-SECTION LOCATION MAP.
- BACKFILL AND COMPACTION OF SOIL AND AGGREGATE BENEATH THE CITY OF SUPERIOR ROADWAYS WILL COMPLY WITH THE CITY OF SUPERIOR REQUIREMENTS (OR WDOT REQUIREMENTS IF NO CITY REQUIREMENTS ARE PROVIDED).

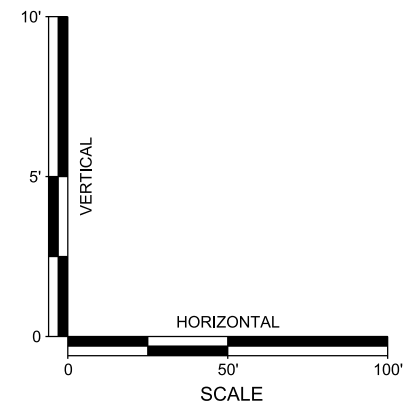

NO.	BY	DATE	DESCRIPTION
1	△		
2	△		
3	△		

RECORD DRAWING OF COMPLETED CONSTRUCTION BY: \_\_\_\_\_ DATE: \_\_\_\_\_  
 RECORD DRAWINGS OF COMPLETED CONSTRUCTION CONFORMING TO CONTRACTOR AND / OR OWNERS RECORDS. BY: \_\_\_\_\_ DATE: \_\_\_\_\_

DATE OF PREPARATION	
BY	DATE
SURVEYED	
DRAWN	JOW OCT. 2022
DESIGNED	
CHECKED	BDS1 OCT. 2022

**CROSS-SECTIONS  
 FORMER MGP  
 GAS HOLDER**

SCALE: AS SHOWN

PROJECT ID: 18S024

P:\Projects\18S024\18S024-00\CAD\Drawings\Remedial Design\100 PCT1100-Drawing B-6 Cross Sections Former Hortonsphere.dgn  
 10/2/2022 11:46:46 AM jpw

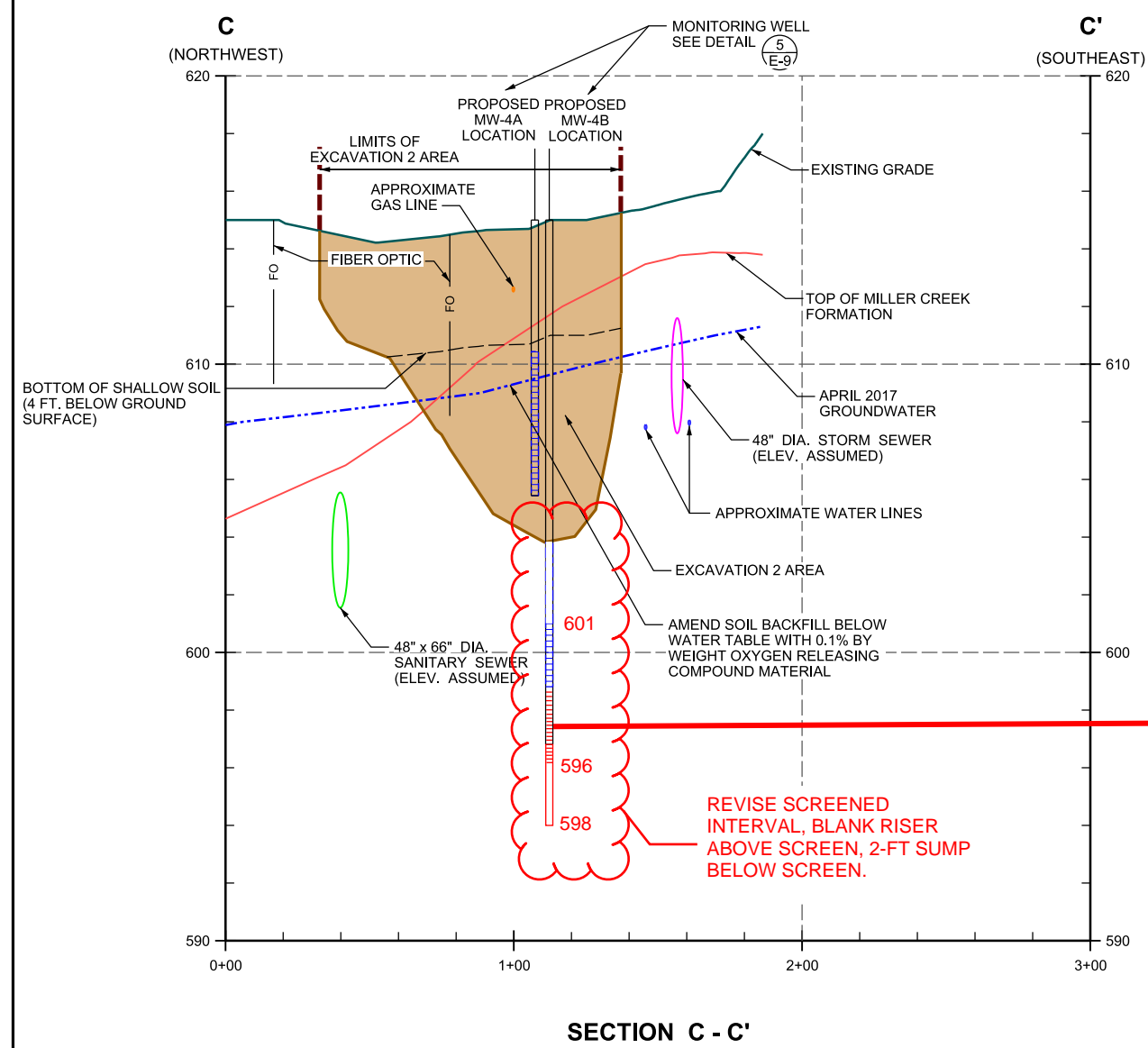

copy changes to here →

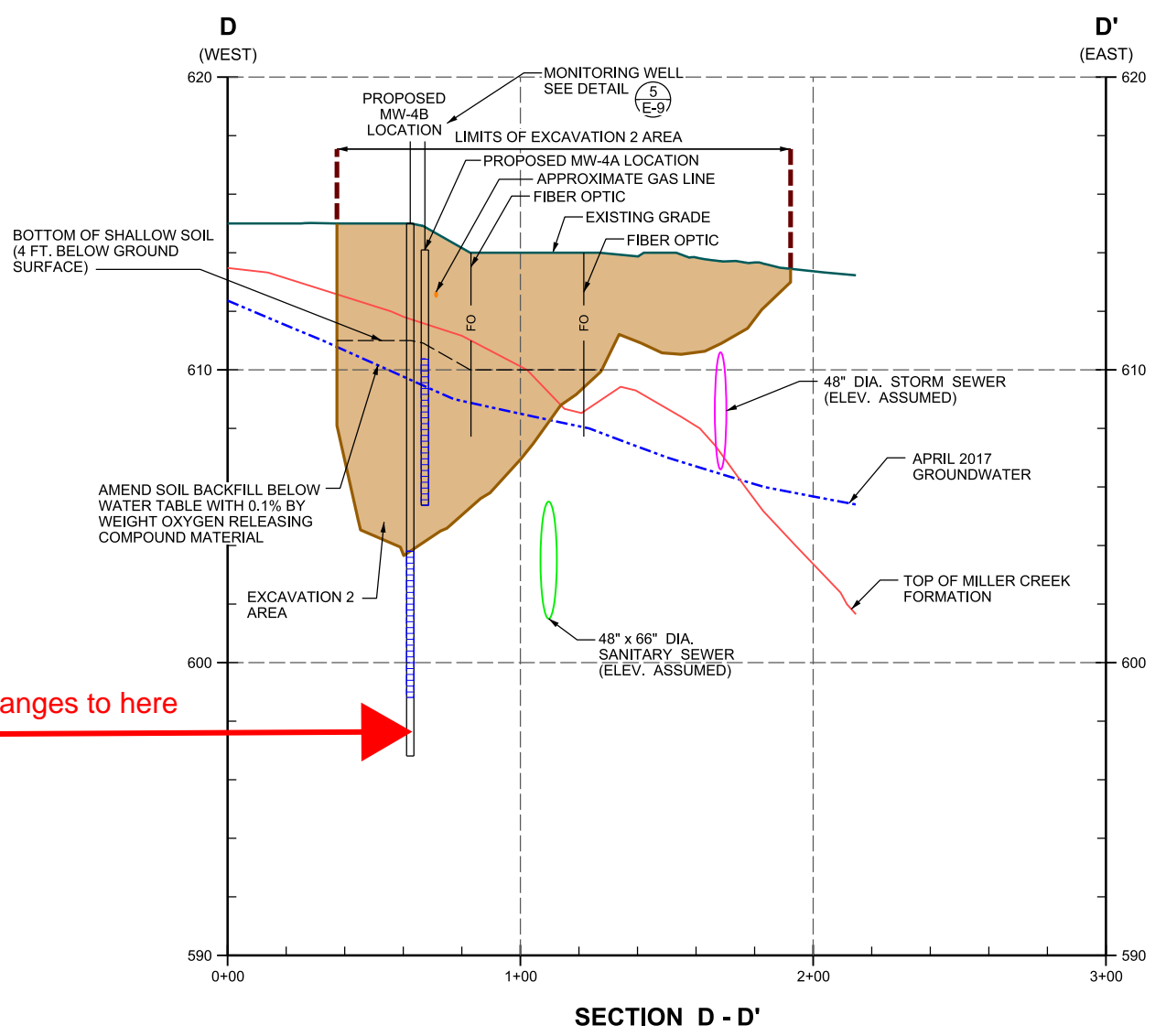

- NOTES:**
- SEE DRAWING B-1 FOR CROSS-SECTION LOCATION MAP.
  - BACKFILL AND COMPACTION OF SOIL AND AGGREGATE BENEATH THE CITY OF SUPERIOR ROADWAYS WILL COMPLY WITH THE CITY OF SUPERIOR REQUIREMENTS (OR WDOT REQUIREMENTS IF NO CITY REQUIREMENTS ARE PROVIDED).

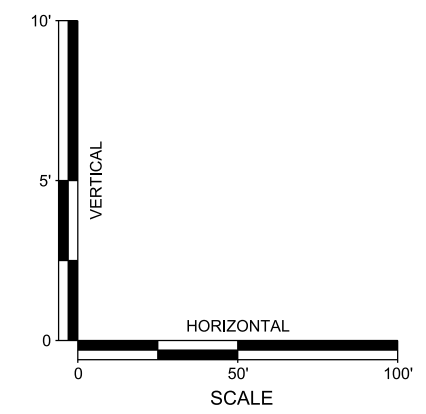

**UPLAND AREA REMEDIAL ACTION  
 DESIGN DRAWINGS  
 FOR THE  
 FORMER MGP SITE**

**SUPERIOR WATER, LIGHT & POWER**  
 WISCONSIN  
 DOUGLAS COUNTY

REVISIONS		DATE OF PREPARATION	
NO.	DESCRIPTION	BY	DATE

RECORD DRAWING OF COMPLETED CONSTRUCTION BY: \_\_\_\_\_  
 RECORD DRAWINGS OF COMPLETED CONSTRUCTION CONFORMING TO CONTRACTOR AND / OR OWNERS RECORDS. BY: \_\_\_\_\_

DATE OF PREPARATION	
BY	DATE
SURVEYED	
DRAWN	JOW OCT. 2022
DESIGNED	
CHECKED	BDS1 OCT. 2022

**CROSS-SECTIONS  
 FORMER  
 HORTONSHERE**

SCALE: AS SHOWN

PROJECT ID: 18S024

P:\Projects\sw\ben\mca\foth\pwr\18S024\Drawings\FSP\Drawing 4-1 Long Term Groundwater Monitoring Network.dgn  
 12/28/2022 4:33:33 PM

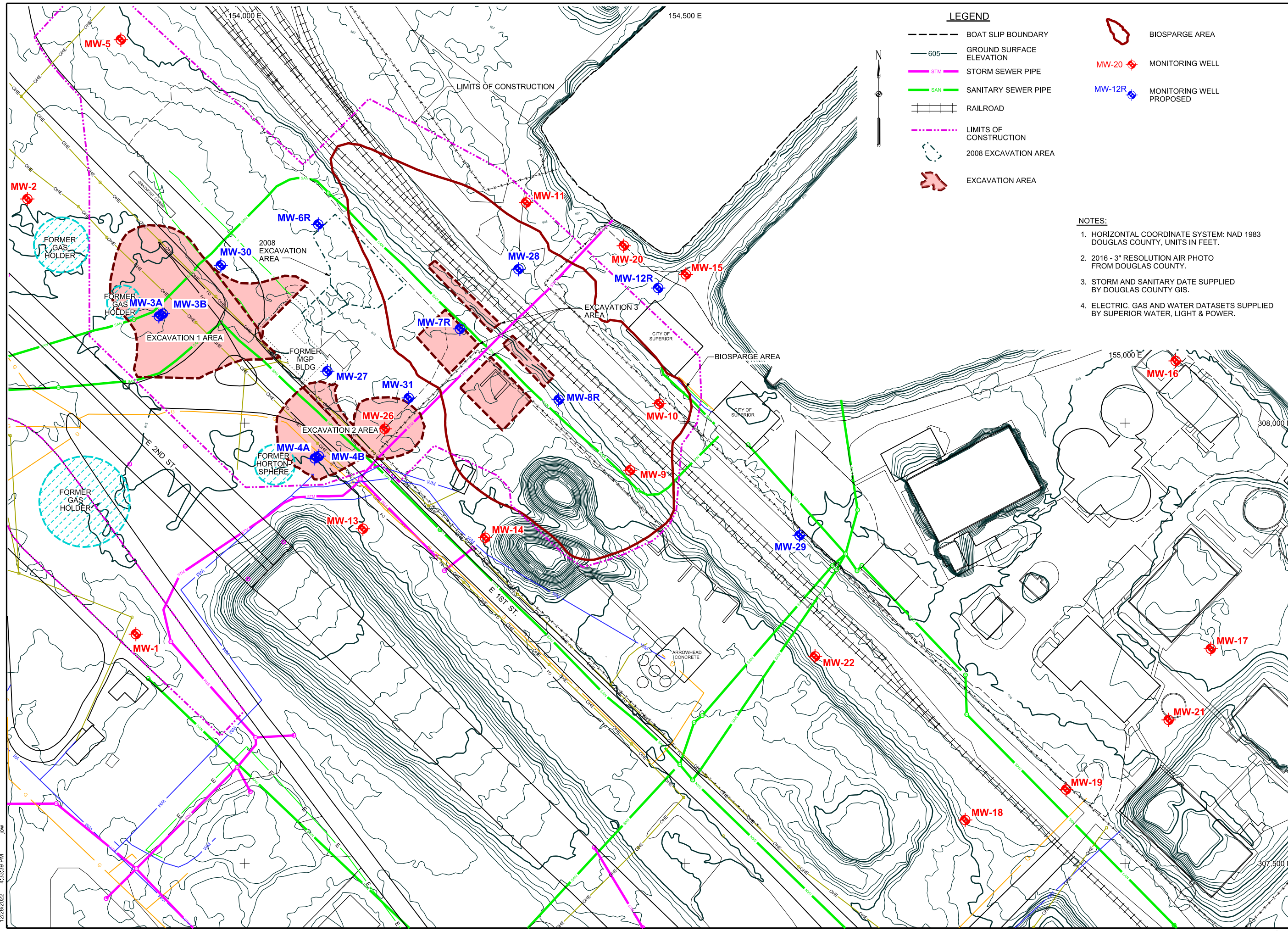

**LEGEND**

- BOAT SLIP BOUNDARY
- 605 GROUND SURFACE ELEVATION
- STM STORM SEWER PIPE
- SAN SANITARY SEWER PIPE
- RAILROAD
- LIMITS OF CONSTRUCTION
- 2008 EXCAVATION AREA
- EXCAVATION AREA
- BIOSPARGE AREA
- MW-20 MONITORING WELL
- MW-12R MONITORING WELL PROPOSED

**NOTES:**

1. HORIZONTAL COORDINATE SYSTEM: NAD 1983 DOUGLAS COUNTY, UNITS IN FEET.
2. 2016 - 3" RESOLUTION AIR PHOTO FROM DOUGLAS COUNTY.
3. STORM AND SANITARY DATE SUPPLIED BY DOUGLAS COUNTY GIS.
4. ELECTRIC, GAS AND WATER DATASETS SUPPLIED BY SUPERIOR WATER, LIGHT & POWER.

**Foth**

Foth Infrastructure & Environment, LLC  
 2121 Innovation Court, Suite 100  
 P.O. Box 5095, 4115-5126  
 Phone: 920-497-2500

REUSE OF DOCUMENTS  
 THIS DOCUMENT HAS BEEN DEVELOPED FOR A SPECIFIC APPLICATION AND NOT FOR GENERAL LISTING. IT IS THE SOLE RESPONSIBILITY OF THE UNAUTHORIZED USER.



**UPLAND AREA REMEDIAL ACTION  
 DESIGN DRAWINGS  
 FOR THE  
 FORMER MGP SITE**  
**SUPERIOR WATER, LIGHT & POWER**  
 DOUGLAS COUNTY  
 WISCONSIN

REVISIONS	
NO.	DESCRIPTION

DATE OF PREPARATION	
BY	DATE
SURVEYED	
DRAWN	JOW OCT. 2022
DESIGNED	
CHECKED	BDS1 OCT. 2022

**LONG - TERM  
 GROUNDWATER  
 MONITORING  
 NETWORK**

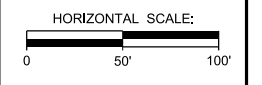

PROJECT ID: 18S024