

**MEMORANDUM**

---

DATE : July 29, 2023

TO : Shane LaFave / Roers Companies, LLC

FROM : Pratap Singh, Ph.D., PE / KSingh

SUBJECT : Testing Results for Week Ending 07/29/2023  
Community Within the Corridor - East Block

COPY TO : Que El-Amin / Scott Crawford, Inc., Robert Reineke, PE, Robert Fedorchak, PE  
Project #40441B

---

The purpose of this memorandum is to report the test results of the work performed as a part of the emergency response for the referenced project for the week ending 07/29/2023.

**Attachments**

KSingh has included the following attachments, figures and tables for reference:

- Figure 1: CWC EB Floor Plan
- Tables 1-5: Indoor Air Monitoring Results by Date
- Table 6: Comprehensive Vacuum Measurements (inches H<sub>2</sub>O)
- Table 7: Comprehensive Data Table – Indoor Air
- Table 8: Comprehensive Data Table – Sub-Slab Vapor TCE

# East Building Level 1

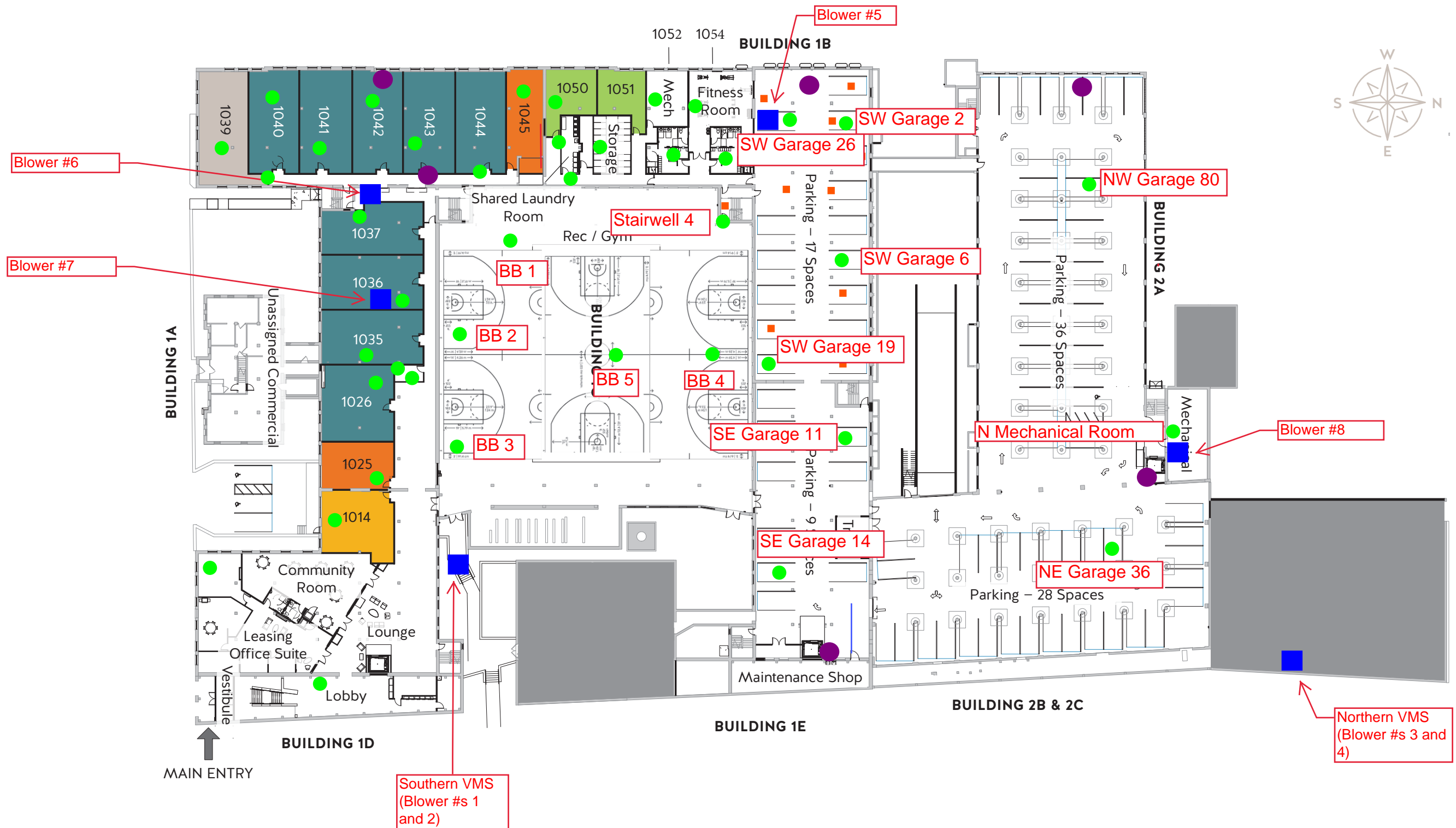

- Soil Boring Locations
- Vapor Mitigation Systems (Blowers)
- Vapor Pins
- Sumps

Figure 1. Locations of Access Points, Additional Sumps and Drains, Blowers for Vapor Mitigation System, and Vapor Pins

**Tables 1 - 5**  
Monitoring Results by Date  
On-site EPA Method TO-14 Data

Instrument: SRI 8610 Gas Chromatograph with ECD

Operator: Sameer Neve, Ph.D. ENV SP / KSingh

**Table 1: Indoor Air Monitoring Results from 07/24/2023**

\*\*GC Monitoring was conducted for the West Block

**Table 2: Indoor Air Monitoring Results from 07/25/2023**

File No.	Sample Location	Sample Time	TCE ( $\mu\text{g}/\text{m}^3$ )	PCE ( $\mu\text{g}/\text{m}^3$ )
936	Blower 1	13:49	23.4	2.89
937	Blower 2	13:57	16.7	3.93
938	Blower 6	14:04	7.81	ND
939	Blower 7	14:14	23.3	5.1
940	Blower 5	13:40	278	1.97
941	Blower 3 + 4	14:37	14.9	0.6
942	N Mech Room	15:00	2.1	ND
Reporting Limit ( $\mu\text{g}/\text{m}^3$ )			0.6	0.6
ND Indicates Not Detected at listed reporting level				

**Table 3: Indoor Air Monitoring Results from 07/26/2023**

File No.	Sample Location	Sample Time	TCE ( $\mu\text{g}/\text{m}^3$ )	PCE ( $\mu\text{g}/\text{m}^3$ )
942	1041	8:12	0.24	ND
943	1042	8:20	0	ND
944	1044	8:28	0.83	ND
945	1051	8:35	0.23	ND
946	2014	8:46	0.6	ND
947	2056	8:55	0.48	ND
948	2057	9:03	0	ND
949	2058	8:11	0	ND
950	2059	9:20	0	ND
951	3057	9:29	0	ND
952	3062	9:40	0	ND
953	Front Lobby	9:53	0.26	ND
954	NE Garage	10:00	0.26	ND
955	NE Gym	10:08	0	ND
956	Stairwell 3	10:18	0	ND
957	1st FI Hallway South	10:25	0	ND
Reporting Limit ( $\mu\text{g}/\text{m}^3$ )			0.6	0.6
ND Indicates Not Detected at listed reporting level				

**Table 4: Sub-Slab Monitoring Results from 07/27/2023**

**All samples from sub-surface taken from the vapor pins**

File No.	Sample Location	Sample Time	TCE ( $\mu\text{g}/\text{m}^3$ )	PCE ( $\mu\text{g}/\text{m}^3$ )
958	1055	8:20	8.72	ND
959	1054	8:31	2.52	ND
960	1053	8:40	13.4	ND
961	Oppo. 1054	8:50	33.6	ND
962	Stairwell 4	8:57	0.68	ND
963	1052	9:09	0.75	ND
964	1051	9:24	9.86	ND
965	1049	9:41	1.31	ND
966	1048	9:51	386	ND
967	1050	10:00	187	ND
968	Out 1050	10:24	47.2	ND
969	1045	10:31	232	3.17
970	Out 1044	10:41	275	20.8
971	1043	10:48	9.26	0.92
972	1042	10:56	5.25	ND
973	1041	11:04	7.14	ND
974	1040	11:12	11.6	ND
975	1040 - out	11:20	4.08	ND
976	1039	11:28	12.6	ND
977	1037	11:37	9.37	2.84
978	1036	11:47	2.68	ND
979	1035	11:56	1.2	ND
980	1035 - out	12:07	2.54	ND
981	1058 E	12:21	45.7	2.1
982	1058 W	12:28	6.3	ND
983	1026	12:37	7.38	ND
984	1025	12:46	3.08	ND
985	1014	13:02	57.9	5.27
986	1011	13:12	2.38	0.62
987	SE Lobby	13:20	0.79	ND
988	BB 1	13:28	421	20.8
989	BB 2	13:40	40.5	15.7
990	BB 3	13:48	4.55	2.15
991	BB 4	13:58	2.21	5.46

992	BB 5	14:14	26	5
Reporting Limit ( $\mu\text{g}/\text{m}^3$ )			0.6	0.6
ND Indicates Not Detected at listed reporting level				

**Table 5: Monitoring Results from 07/28/2023**

File No.	Sample Location	Sample Time	TCE ( $\mu\text{g}/\text{m}^3$ )	PCE ( $\mu\text{g}/\text{m}^3$ )
1003	1041	9:38	0.24	ND
1004	1042	9:52	0.26	ND
1005	1044	10:05	0.92	ND
1006	1051	10:13	0.41	ND
1007	2014	10:26	0	ND
1008	2056	10:34	0.6	ND
1009	2057	10:44	0.28	ND
1010	2058	10:54	0.24	ND
1011	2059	11:04	0.27	ND
1012	3057	11:17	0	ND
1013	3062	11:29	0	ND
1014	Front Lobby	11:42	0.37	ND
1015	NE Garage	11:52	0.23	ND
1016	NE Gym	12:14	0.23	ND
1017	Stairwell 3	12:23	0	ND
1018	1st FI Hallway South	12:30	0	ND

**All samples from sub-surface taken from the vapor pins**

File No.	Sample Location	Sample Time	TCE ( $\mu\text{g}/\text{m}^3$ )	PCE ( $\mu\text{g}/\text{m}^3$ )
994	SW Garage (2)	8:05	125	ND
995	SW Garage (26)	8:23	21.7	ND
996	SW Garage (6)	8:32	0.46	ND
997	SW Garage (19)	8:41	0.44	ND
998	SE Garage (11)	8:49	0.5	ND
999	SE Garage (14)	8:59	0.4	ND
1000	NW Garage (80)	9:09	8.6	ND
1001	NE Garage (36)	9:18	32.9	ND
1002	N Mech Room	9:26	7.36	ND
Reporting Limit ( $\mu\text{g}/\text{m}^3$ )			0.6	0.6
ND Indicates Not Detected at listed reporting level				

**Table 6: Comprehensive Vacuum Measurements (inches H<sub>2</sub>O)**

Note	Obar @ 90%					
Date	24-Jul	25-Jul	26-Jul	27-Jul	28-Jul	
Time	12:15	8:30	8:45	8:30	13:00	
Location						Average
1055	-0.466	-0.448	-0.439	-0.44	-0.443	-0.447
1054	-0.956	-0.0942	-0.959	-0.955	-0.957	-0.784
1053	-0.521	-0.514	-0.512	-0.513	-0.514	-0.515
Oppo. 1054	-0.26	-0.319	-0.322	-0.326	-0.328	-0.311
Stairwell 4	0	-0.004	0	-0.012	-0.011	-0.005
1052	-0.952	-0.934	-0.932	-0.952	-0.951	-0.944
1051	-0.245	-0.223	-0.228	-0.229	-0.228	-0.231
1049	-0.241	-0.239	-0.222	-0.221	-0.224	-0.229
1048	-0.096	-0.097	-0.097	-0.096	-0.091	-0.095
1050	-0.114	-0.108	-0.113	-0.111	-0.114	-0.112
Out 1050	-0.145	-0.151	-0.151	-0.155	-0.159	-0.152
1045	-0.056	-0.072	-0.071	-0.077	-0.078	-0.071
Out 1044	-0.187	-0.201	-0.191	-0.194	-0.199	-0.194
1043	-0.056	-0.077	-0.069	-0.064	-0.071	-0.067
1042	-0.037	-0.046	-0.049	-0.048	-0.047	-0.045
1041	-0.086	-0.094	-0.11	-0.099	-0.098	-0.097
1040	-0.086	-0.095	-0.091	-0.094	-0.099	-0.093
Out 1040	-0.132	-0.145	-0.135	-0.139	-0.131	-0.136
1039	-0.039	-0.029	-0.026	-0.025	-0.025	-0.029
1037	-0.118	-0.123	-0.113	-0.114	-0.111	-0.116
1036	-0.253	-0.265	-0.261	-0.262	-0.262	-0.261
1035	-0.142	-0.144	-0.155	-0.159	-0.153	-0.151
Out 1035	-0.044	-0.042	-0.053	-0.051	-0.053	-0.049
1058 E	-0.087	-0.085	-0.091	-0.086	-0.09	-0.088
1058 W	-0.121	-0.121	-0.133	-0.134	-0.018	-0.105
1026	-0.15	-0.155	-0.151	-0.155	-0.152	-0.153
1025	-0.063	-0.06	-0.076	-0.062	-0.068	-0.066
1014	-0.214	-0.214	-0.212	-0.219	-0.202	-0.212
1011	-0.048	-0.061	-0.054	-0.061	-0.054	-0.056

<b>SE Lobby</b>	-0.552	-0.564	-0.561	-0.605	-0.573	-0.571
<b>BB 1</b>	-0.012	-0.034	-0.011	-0.018	-0.014	-0.018
<b>BB 2</b>	-0.015	-0.013	-0.011	-0.011	-0.014	-0.013
<b>BB 3</b>	-0.043	-0.056	-0.052	-0.039	-0.045	-0.047
<b>BB 4</b>	-0.008	-0.012	-0.017	-0.012	-0.011	-0.012
<b>BB 5</b>	-0.019	-0.024	0	-0.025	-0.02	-0.018
<b>SW Garage (2)</b>	0	0	0	0	0	0.000
<b>SW Garage (26)</b>	-0.295	-0.305	-0.311	-0.305	-0.302	-0.304
<b>SW Garage (6)</b>	0	0	0	0	0	0.000
<b>SW Garage (19)</b>	0	0	0	0	0	0.000
<b>SE Garage (11)</b>	-0.01	-0.011	-0.003	-0.013	-0.016	-0.011
<b>SE Garage (14)</b>	-0.014	-0.024	-0.032	-0.041	-0.039	-0.030
<b>NW Garage (80)</b>	-0.042	-0.026	-0.033	-0.033	-0.029	-0.033
<b>NE Garage (36)</b>	-1.614	-1.625	-1.634	-1.6	-1.61	-1.617
<b>N Mech Room</b>	0	0	0	0	0	0.000
Red highlighted cells indicate values below the desired level on -0.01 inH2O						



Community Within the Corridor - East Block

Table 7 - Discrete Sampling Test Results - March/April 2023

Sample Location	30-Mar	31-Mar	1-Apr	3-Apr	4-Apr	5-Apr	6-Apr	7-Apr	10-Apr	11-Apr	12-Apr	13-Apr	14-Apr	15-Apr	17-Apr	18-Apr	19-Apr	20-Apr	21-Apr	24-Apr	25-Apr	26-Apr	27-Apr	28-Apr	
1045 Entry Floor Hole			400																						
1045 North Wall			360																						
1045 Wood Column			1500								352														
1050 South Wall Hole			8000																						
1st Floor Hallway Center	15				3.5	17.7	64	25	81.1	35		42.7	63.3	106	181	147	8.5	22.4	7.4	7.8		4.7	17.7	2.7	
1st Floor Hallway North	10																								
1st Floor Hallway South	5.2																								
2081 Hallway		0																							
2nd Floor Corridor North		0																							
2nd Floor Corridor South		0																							
2nd Floor Hallway Center	0.7											3	3.6												
2nd Floor Hallway North	0.8	0																							
2nd Floor Hallway South	0.8																								
Stairwell 2	3.2	2																			4.5			2.9	
2nd Floor Stairwell 4		0																				12.4			
2nd Floor Stairwell 8		0																							
3rd Floor Corridor			0																						
3rd Floor Hallway Center			0									3.3	2												
3rd Floor Hallway South	0																								
3rd Floor Stairwell 2	3.4					2.1																			
Stairwell 3			0.6																						
3rd Floor Stairwell 4			0.7																				11.2		
Basket Ball Court	0.3																					12			
Basket Ball Court 2	0																						7.5	6.3	
Basket Ball Court 3																									
Basket Ball Court 4																									
Elevator	0																								
Fitness Center										49.6	43.7		28.1								29.3				
Front Lobby		0																				4			
NW Garage	0.6																								
N Garage	0																						0		
SE Garage	0.8																							7.7	
Hallway Outside 3021			0																						
Hallway Outside 3035			0																						
Hallway Outside 3065			0.7																						
N Mechanical Room										6.26	2.4	5.9	14.8	7	7.3	7.2	5.3	7.9		10	7	7.2	7.8	4.5	
Men's Locker Room						60.7	123		122		428	82.9				161	131		23.7	28.3					
Women's Locker Room																									
Powerhouse																						0.7	3.2		
Unit 1002 - Postboxes																									
Unit 1006	0.3	0															4.3				1.4				
SSD Vent Pipe #1 - S - 7.5 HP			13	22	24.5	22	24.8	24	26.7	26.2	28	28	30.3	31.4	34.6	28.2	36.4	33.1	35.2	32		31.4	28.6		
SSD Vent Pipe #2 - S - 10 HP			26	30	21.9	16.4	18.7	17.2	44.4	19.5	19	47.7	29.3	57.8	20.5	17.1	19.8	21.4	20.9	20.7		20.6	28.5		
SSD Vent Pipe #3 - N - 7.5 HP					17.6	2.2	3	5	3.3	3	4.3	11.9	7.17	16.7	11.3	9.4	8.1	5.3	6.1	7.2		43.5	6.1		
SSD Vent Pipe #4 - N - 10 HP					41.2	29.5	33	39	37	38.7	39.1	29.3	44	41.9	36.8	38.2	35	42.8	43.1	46.3		5.7	44.4		
SW Garage																	11.3	21						20.3	
Stairwell 4	1.6					2.2			2.7	2.6				14.4		7									
Stairwell 6																									
Stairwell 7																									
Unit 1011																									
Unit 1014										0															
Unit 1025	0							0.96									3.6						4.8		
Unit 1026	0.3									0															
Unit 1035	0.3																								
Unit 1036	0.5																								
Unit 1037	2										0.9														
Unit 1039	4.7										11.4	8										3.4			
Unit 1040	10.3			12.7								14.5				21.2	22.6								
Unit 1041	11.6							19.9		16.8	14.4														
Unit 1042	11.4									16.2	15.2												12.6	9.3	
Unit 1043	17.6					21.6	31.3				24														
Unit 1044	56					77	95			69.7	84.5														
Unit 1045	350		293	298	287	272	267	279	28.9	230	352	236	151.5	124	336	115	283	61	127	116	112	221	51.3	26.6	
Unit 1048																									
Unit 1049																									
Unit 1050	160		137	143	110	348	280	108	135	114	706	145	60	118	142	149	110	77.8	131	138	152	113	71.7	199	
Unit 1051	19					23		25.4			45.3														

Unit 1052					72.5	88.7	96.6	95.7	128	103	88.6	51.4	38.4			70.5			57.2	70.3		72		20.2
Unit 1056					24.8																	44		
Unit 1057																								
Unit 1058																								
Unit 1079																								
Unit 2014																								
Unit 2015																								
Unit 2016			0																					
Unit 2017			0																					
Unit 2022			0																					
Unit 2025			0																					
Unit 2036			0																			0		
Unit 2037			0																					
Unit 2039			0									2.5	2.5											
Unit 2040			0					0														0		
Unit 2042			0																					
Unit 2043		0.4	0																					
Unit 2044			0																					
Unit 2045	23	18				8		9	2.9			3.7	5.2											
Unit 2049																								
Unit 2056	60	52				42.2	24.7	49.2	9.6			3.4	6.6									1.5		
Unit 2057			4.7																					
Unit 2058	3.8	4.2				8.5			3.8															
Unit 2059	0.3	0																						
Unit 2061			0																					
Unit 2062			0																					
Unit 2063																								
Unit 2064	0					1																		
Unit 2065																								
Unit 2068																								
Unit 2077	0					1.6																		
Unit 2079																								
Unit 2111			0																					
Unit 2112																								
Unit 2114																								
Unit 2116																								
Unit 3014																								
Unit 3015			0						0															
Unit 3016																								
Unit 3017																								
Unit 3020																								
Unit 3021																								
Unit 3023																								
Unit 3025																							0	
Unit 3035			0																					
Unit 3036			0																					
Unit 3037			0					2	ND															
Unit 3039			0										1.8											
Unit 3040			0																				0	
Unit 3041			0																					
Unit 3042			0																					
Unit 3043			0																					
Unit 3044			0																					
Unit 3045			6.6									2.7	2.7											
Unit 3056	6	9.6				2.4		5.13	0.9			2.4	2.4									0		
Unit 3057			0																					
Unit 3058			0																					
Unit 3059			0																					
Unit 3061			0																					
Unit 3062			0																					
Unit 3063																								
Unit 3079																								
Unit 3092																								

Community Within the Corridor - East Block

Table 7 - Discrete Sampling Test Results - May 2023

Sample Location	1-May	2-May	3-May	4-May	5-May	8-May	9-May	10-May	11-May	12-May	15-May	16-May	17-May	18-May	19-May	22-May	23-May	24-May	25-May	26-May	30-May	31-May	
1045 Entry Floor Hole																							
1045 North Wall																							
1045 Wood Column																							
1050 South Wall Hole																							
1st Floor Hallway Center		14	9	3.5	2.3		3.49							21.2	3.48	5.39				2.38	3.6		
1st Floor Hallway North																							
1st Floor Hallway South									0.947	1.92	1.96		0										
2081 Hallway																							
2nd Floor Corridor North																							
2nd Floor Corridor South																							
2nd Floor Hallway Center								4.69			4.2										2.74		
2nd Floor Hallway North																							
2nd Floor Hallway South																							
Stairwell 2								4.15															
2nd Floor Stairwell 4						7.19																	
2nd Floor Stairwell 8																							
3rd Floor Corridor																							
3rd Floor Hallway Center											1.7										1.71		
3rd Floor Hallway South																							
3rd Floor Stairwell 2				2.35																			
Stairwell 3								3.9															
3rd Floor Stairwell 4																							
Basket Ball Court														1.84			8.96						
Basket Ball Court 2		2.2		3	2.3	0.624			1.02					1.53			0						
Basket Ball Court 3														1.56			0.536						
Basket Ball Court 4														0.816			0.734						
Elevator																							
Fitness Center								29				33.8	21	21	24.5	16.6		42.5	15.1		24.2		
Front Lobby																							
NW Garage													14			0.62							
N Garage										1.78			0.607		0	0.63		0.776					
SE Garage																6.6		0.6					
Hallway Outside 3021																							
Hallway Outside 3035																							
Hallway Outside 3065																							
N Mechanical Room	13.7	11.5			10.1	10.9	11.8		6.89		10.7						0.737						
Men's Locker Room	58	31.6					53.3				52.3	7.62								21.7			
Women's Locker Room					45															25.8			
Powerhouse																							
Unit 1002 - Postboxes																						0	
Unit 1006	2.97							2.4			1.7						0.737					0	
SSD Vent Pipe #1 - S - 7.5 HP	26.1	27.9			25.7		26.2		21.9				27.01		26.7			7.04					19.6
SSD Vent Pipe #2 - S - 10 HP	1.2				20		15.7		18.7				18.2		19.3			11.1					33.8
SSD Vent Pipe #3 - N - 7.5 HP	8.6				5.9		4.97		0				3.47		3.41			1.85					4.8
SSD Vent Pipe #4 - N - 10 HP	38.3				37.7		22.4		4.83				31.1		21.9			4.7					20.2
SW Garage	25.2			26.1		23.6	25.5		21.4				0.683	1.15	0	7.84							
Stairwell 4		12											9.03										
Stairwell 6										6													
Stairwell 7																							
Unit 1011								2.61	0														
Unit 1014																						0	
Unit 1025																	1.1	0		0	0		
Unit 1026								1.67	0	0												0.7	
Unit 1035																						1.1	
Unit 1036								1.37									4.59				2.37	1.2	
Unit 1037																							3.7
Unit 1039			1.4									5.18				6.06			1.19				8.1
Unit 1040								11.2	7.37			7.25							5.29				11.5
Unit 1041				13								7.07							9.13				10.9
Unit 1042		15.5					11.9	13.1			8.22	13.6	6.61	0.53	1.42	5.16		3.88	10.1		5.3		
Unit 1043												117							12.2				11.7
Unit 1044												37.6							29.3				37.8
Unit 1045	90.3	132	121		220	38.4	33.8		17.2	14.3	22.6	9.82	60.7		14.9	24.1	46.3	13.7	38.1		103	26	

Unit 1048									86.2							45.7					
Unit 1049					142			159	96.9							66.1		21.4		30.3	
Unit 1050	231	194	186	95.5	174	67.5	297		80.2	75.7	228	77.9		103	90.7	90.9	88.5	147	170	116	78.4
Unit 1051												52.7					39.8	18.2			
Unit 1052	73.6	62.6	340		76		70.7					55.7				32		16.8			21.1
Unit 1056																					
Unit 1057																				0	
Unit 1058																1.46				0	
Unit 1079										152											
Unit 2014			48.8						0												
Unit 2015								0.77													
Unit 2016																					
Unit 2017																					
Unit 2022																					
Unit 2025																					
Unit 2036																					
Unit 2037																					
Unit 2039								0.77													
Unit 2040																					
Unit 2042				2.5																	
Unit 2043																					
Unit 2044																					
Unit 2045			19.1			1.36				0.99			1.97		2.99				11.8		
Unit 2049									1.07												
Unit 2056										1.11		5.89		11.5					66.4		
Unit 2057						1.24		0.64													
Unit 2058				2.9																	
Unit 2059																					
Unit 2061																					
Unit 2062																					
Unit 2063																					
Unit 2064						1.78															
Unit 2065																					
Unit 2068																					
Unit 2077				1.7		0.838															
Unit 2079																					
Unit 2111																		0			
Unit 2112																					
Unit 2114																					
Unit 2116																					
Unit 3014																					
Unit 3015																					
Unit 3016																					
Unit 3017																					
Unit 3020																					
Unit 3021																					
Unit 3023										0											
Unit 3025																					
Unit 3035																					
Unit 3036																					
Unit 3037																					
Unit 3039																					
Unit 3040																					
Unit 3041				2.45																	
Unit 3042																					
Unit 3043																					
Unit 3044																					
Unit 3045							0								3.75				8.11		
Unit 3056															1.21				6.99		
Unit 3057							0														
Unit 3058																					
Unit 3059																					
Unit 3061																					
Unit 3062																					
Unit 3063							0														
Unit 3079																					
Unit 3092				1.67																	

Community Within the Corridor - East Block

Table 7 - Discrete Sampling Test Results - June/July 2023

Sample Location	1-Jun	5-Jun	7-Jun	8-Jun	9-Jun	12-Jun	13-Jun	14-Jun	15-Jun	16-Jun	23-Jun	26-Jun	3-Jul	10-Jul	11-Jul	12-Jul	14-Jul	19-Jul	21-Jul	26-Jul	28-Jul	
1045 Entry Floor Hole																						
1045 North Wall																						
1045 Wood Column																						
1050 South Wall Hole																						
1st Floor Hallway Center							0.24							0.1								
1st Floor Hallway North																						
1st Floor Hallway South					0.4											0.39		0	0	0	0	
2081 Hallway																						
2nd Floor Corridor North																						
2nd Floor Corridor South																						
2nd Floor Hallway Center					0.42									0.1								
2nd Floor Hallway North																						
2nd Floor Hallway South																						
Stairwell 2																						
2nd Floor Stairwell 4																						
2nd Floor Stairwell 8																						
3rd Floor Corridor																						
3rd Floor Hallway Center						0.47								0.1								
3rd Floor Hallway South																						
3rd Floor Stairwell 2																						
Stairwell 3					0.1		0.23										0.42		0	0	0	0
3rd Floor Stairwell 4																						
Basket Ball Court					2.65							0.2										
Basket Ball Court 2																0.48	0.34	0.19		0	0.23	
Basket Ball Court 3																						
Basket Ball Court 4																						
Elevator																						
Fitness Center	16.1	4.2		0.4			0.29	0.55				0.49	0.69									
Front Lobby																	0.56	0.21	0.23	0.26	0.37	
NW Garage						0.85	0															
N Garage							0.27															
SE Garage							0.23															
Hallway Outside 3021																						
Hallway Outside 3035																						
Hallway Outside 3065																						
N Mechanical Room	1.5					7.7	3.4					2.2	2.86									
Men's Locker Room				0.5				0.2			0.56	0.47	0.6									
Women's Locker Room				0.4				0.5														
Powerhouse																						
Unit 1002 - Postboxes																						
Unit 1006							0.21															
SSD Vent Pipe #1 - S - 7.5 HP						21.7																
SSD Vent Pipe #2 - S - 10 HP						18.4																
SSD Vent Pipe #3 - N - 7.5 HP																						
SSD Vent Pipe #4 - N - 10 HP																						
SW Garage							0.3				0.33											
Stairwell 4		3		0.34		0.24					0.33	0.2										
Stairwell 6																						
Stairwell 7																						
Unit 1011																						
Unit 1014					0.21						0			0.1								
Unit 1025					0.31																	
Unit 1026														0.1								
Unit 1035					0.22						0.28	0.1		0.1								
Unit 1036					0.26						0.3											
Unit 1037			6.9		0.46						0.35	0.1		0.1								
Unit 1039				0.7	0.3						0.27	0.19		0.1								
Unit 1040					0.6							0.24										
Unit 1041					0.51											0.19	1.66	0.24	0.22	0.24	0.42	
Unit 1042		4	19.2	0.8								0.24	0.1			0.1	0.82	0.21	0	0	0	0.26
Unit 1043					0.53			0.32			0.47		1.19									

Unit 1044		65.2	11.7	1.7				1.85			3.2	1.67	1.79			1.76	2.1	1.4	0.92	0.83	0.92
Unit 1045	23.3		14.4	2.4	5.26	3.84	3.33	2.99	2.88	2.57											
Unit 1048	121	19.8	13.5	0.33				0.43			0.72	0.1	0.55								
Unit 1049	21.8	23.6		1.2				0.58			2.5	1.03									
Unit 1050	60.4	27.3	10.3	3.4	3.05	2.28	1.95	2.12	2.17	1.62											
Unit 1051	16.9				0.76			0.38								0.26	1.35	0.27	0.24	0.23	0.41
Unit 1052	14.5			0.23				0.36				0.35	0.1								
Unit 1056	14.6																				
Unit 1057																					
Unit 1058							0.21				0.34										
Unit 1079																					
Unit 2014						0.35										0.1	0.54	0	0	0.6	0
Unit 2015																					
Unit 2016													0.1								
Unit 2017													0.1								
Unit 2022														0.1							
Unit 2025																					
Unit 2036																					
Unit 2037																					
Unit 2039																					
Unit 2040														0.1							
Unit 2042														0.1							
Unit 2043																					
Unit 2044																					
Unit 2045					0.52																
Unit 2049																					
Unit 2056					1											0.1	1.23	0.41	0.5	0.48	0.6
Unit 2057																0.1	0.49	1.09	0	0	0.28
Unit 2058																0.1	1.05	0.97	0	0	0.24
Unit 2059																0.1	0.21	0.77	0	0	0.27
Unit 2061																					
Unit 2062																					
Unit 2063														0.1							
Unit 2064																					
Unit 2065														0.1							
Unit 2068														0.1							
Unit 2077														0.1							
Unit 2079														0.1							
Unit 2111																					
Unit 2112														0.1							
Unit 2114														0.1							
Unit 2116														0.1							
Unit 3014						0.35										0.1					
Unit 3015																					
Unit 3016																0.1					
Unit 3017																					
Unit 3020																0.1					
Unit 3021																0.1					
Unit 3023																					
Unit 3025																					
Unit 3035																					
Unit 3036																					
Unit 3037																					
Unit 3039																					
Unit 3040																					
Unit 3041																					
Unit 3042																					
Unit 3043																					
Unit 3044																					
Unit 3045																					
Unit 3056						0.22															
Unit 3057						0.3										0.1	0.43	0.5	0	0	0
Unit 3058																					
Unit 3059																					
Unit 3061																					

Unit 3062																0.1	0.56	0.19	0	0	0
Unit 3063																					
Unit 3079															0.1						
Unit 3092																					

Table 8: Comprehensive Data Table – Sub-Slab Vapor TCE

Green cells indicate the VRSL levels below the DNR limit of 70 ug/m <sup>3</sup>									
Location		Week of 6/3	Week of 6/17	Week of 6/24	Week of 7/1	Week of 7/8	Week of 7/15	Week of 7/22	Week of 7/29
1055	Women's Locker Room		46.5	17.3	13.5	25.8	9.89	0.36	8.72
1054	Fitness Room	596	0.8	4.8	0.483	2.6	2.23	0.44	2.52
1053	Men's Locker Room		102.3	71.31	55.7	76.2	26.5	27.3	13.4
Oppo. 1054			58.9	55.6	46.9	48.2	53.3	31.5	33.6
Stairwell 4			252.5	6.3	27.4	22.1	14.2	11.7	0.68
1052	Mechanical Room		63.9	38.1	14.9	5.96	4.97	3.1	0.75
1051			47.3	32.4	22.7	25.8	12.6	7.55	9.86
1049	Storage Room	426	2.6	3.38	1.76	2	2.25	1.01	1.31
1048	Laundry Room	322	679	572	561	637	556	538	386
1050		1443	303.4	377	265	283	275	235	187
Out 1050		971	113.1	10.1	64.1	46.3	72.8	68.1	47.2
1045		750	271.6	206	253	238	222	204	232
Out 1044		456	380.5	364	419	205	376	430	275
1043			178.5	185	7.92	14.3	10.7	7.49	9.26
1042		11.8	15.93	10.4	2.67	1.22	6.43	7.05	5.25
1041			108.7	13.2	4.48	4.24	18.8	6.52	7.14
1040		1.6	11.7	16.1	3.22	1.13	3.83	7.8	11.6
1040 - out				21.3	3.1	10.3	5	25.9	4.08
1039		23.5	62.2	4.3	15.2	23.8	16.5	4.1	12.6
1037			240.4	4.3	11.04	50.1	43.7	13.8	9.37
1036			17.2	5.5	2.85	10.2	6.13	3.06	2.68
1035			0.8	7	0.534	1.4	1.61	5.18	1.2
1035 - out			87	55.4	73.2	98.9	95.1	16.9	2.54



1058 E	Electric Room		433.8	1.5	87	307	181	117	45.7
1058 W	Electric Room		73.3	6.99	0.1	5.3	3.19	8.7	6.3
1026			16.7	6.6	7.39	20.8	14.8	10.4	7.38
1025			2.2	2.1	1.01	10.5	2.15	1.54	3.08
1014			23.9	2.2	21.2	124	44.7	38.9	57.9
1011	Conference Room		17.5	1.6	1.5	5.24	0.6	2.47	2.38
SE Lobby	Near Exit	328	0.46	0.5	0.1	0.37	0.1	2.15	0.79
BB 1	SW of the Gym			73	25.1	553	571	0.62	421
BB 2	South part of the Gym		30.8	1.5	286	65	43	18.9	40.5
BB 3	SE part of the Gym		2.2	1.6	0.733	1.05	7.5	97.9	4.55
BB 4	N of the Gym		2.6	1.9	0.569	0.77	3.37	1.22	2.21
BB 5	Center of the Gym		58.9	1.9	27.5	87	86.5	1.23	26
SW Garage (2)			227.4	63.7	300	307	317	230.7	125
SW Garage (26)						24.3	22.3	12.7	21.7
SW Garage (6)						43.9	2.7	2.11	0.46
SW Garage (19)						7.49	2.61	1.93	0.44
SE Garage (11)						49.5	17.8	1.89	0.5
SE Garage (14)			10.3	1.6	1.24	2.02	1.99	1.3	0.4
NW Garage (80)			141.5	4.7	12.7	27.2	21.2	17.4	8.6
NE Garage (36)			24.8	2.8	9.87	13	6.07	5.1	32.9
N Mech Room			60.2	147	27.07	18.7	0.98	15.3	7.36