

Department of Natural Resources Bench Mark.
Eastern-most edge of boat dock (concrete footing)
Assumed Elevation 100.00'
Water Elevation 98.25' (May 1970)

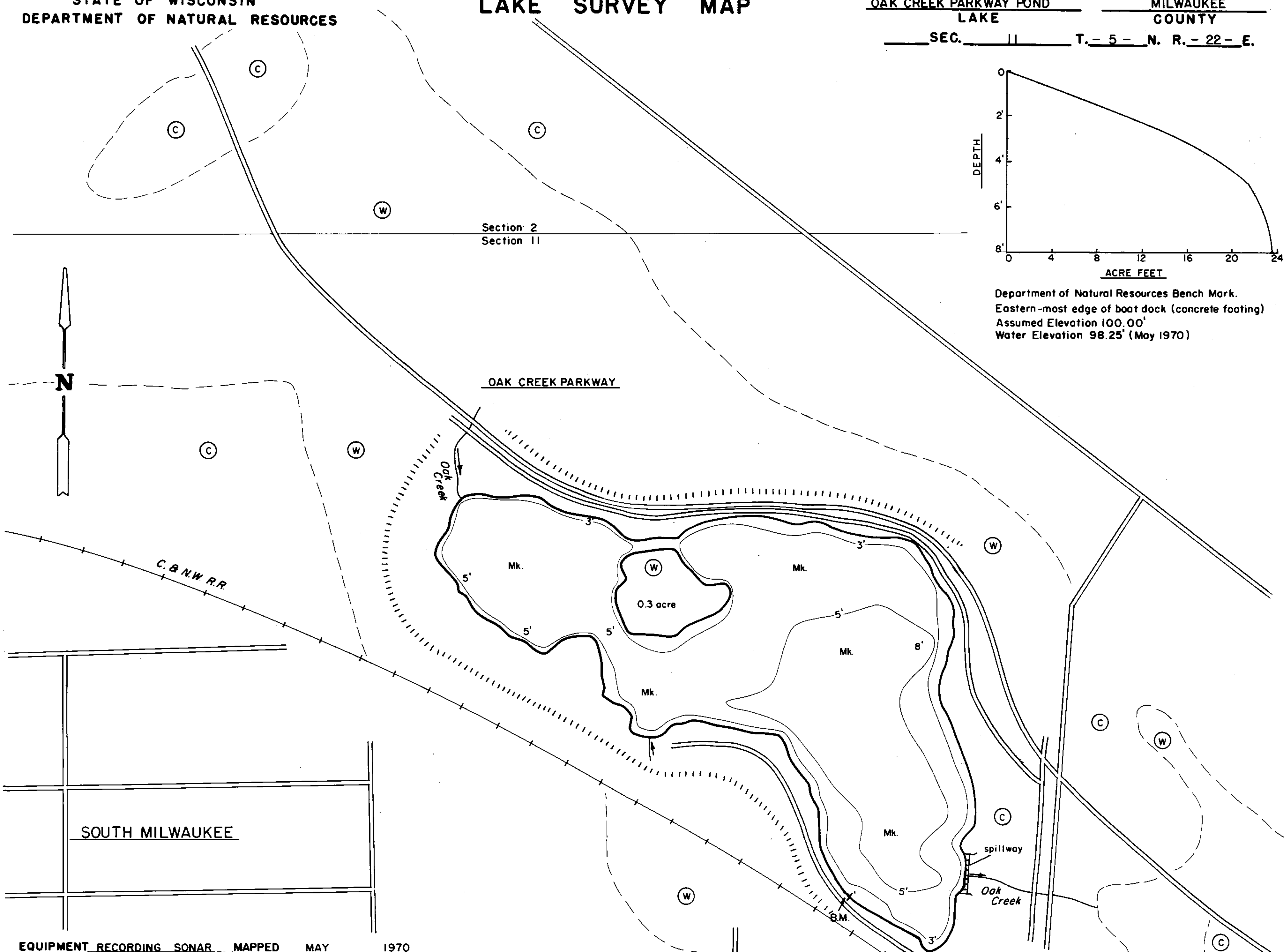

EQUIPMENT RECORDING SONAR MAPPED MAY 1970

TOPOGRAPHIC SYMBOLS		LAKE BOTTOM SYMBOLS	
(B) Brush	() Steep slope	P. Peat	B Boulders
(PW) Partially wooded	(-----) Indefinite shoreline	Mk. Muck	Stumps & Snags
(W) Wooded	(-----) Marsh	C. Clay	Rock danger to navigation
(C) Cleared	(-----) Spring	M. Marl	T Submergent vegetation
(P) Pastured	(-----) Intermittent stream	Sd. Sand	↓ Emergent vegetation
(A) Agricultural	(-----) Permanent inlet	St. Silt	↑ Floating vegetation
B.M. Bench Mark	(-----) Permanent outlet	Gr. Gravel	↕ Brush shelters
(D) Dwelling	(-----) Dam	R. Rubble	
(R) Resort	(-----) D.N.R. State owned land	Bc. Bedrock	
(C) Camp			

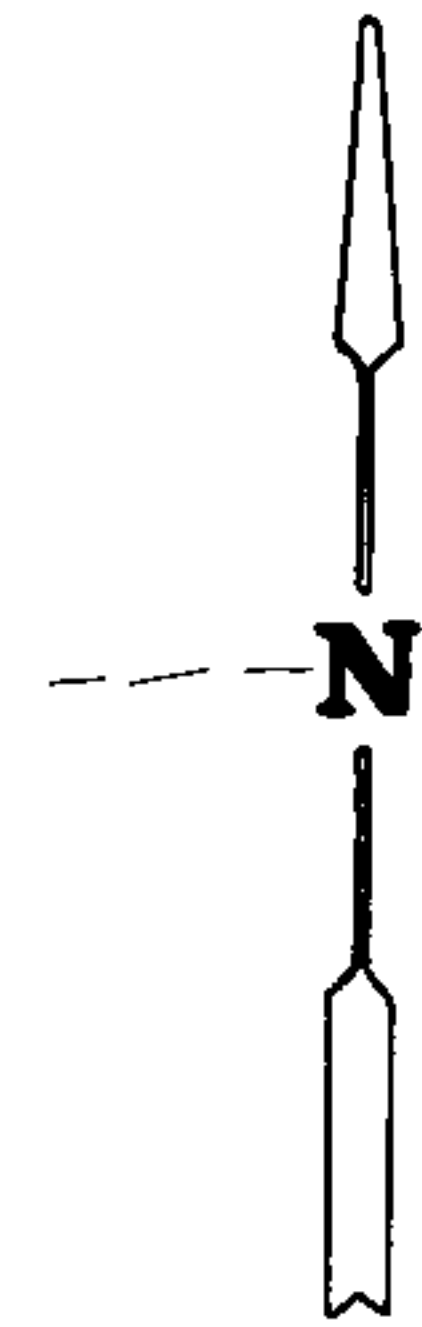

Access Access with Parking Boat Livery
 Drawn by: J. Roth
 Field work by: J. Bakken, M. Goppa

SPECIES OF FISH	Abundance		
	Abundant	Common	Present
Muskie			
N. Pike			
Walleye			
L. M. Bass			
S. M. Bass			
Panfish	X		
Trout			

WATER AREA 5.4 ACRES
 UNDER 3 FT. 13 %
 OVER 20 FT. 0 %
 MAX. DEPTH 8 FEET.
 TOTAL ALK. 264 P.P.M.
 VOLUME 23.6 ACRE FT.
 SHORELINE 0.57 MILES
 0.47 MILES OF SHORELINE
 EXCLUDING ISLAND

Source: Wisconsin Department of Natural Resources 608-266-2621
Oak Creek Parkway Pond – Milwaukee County, Wisconsin DNR Lake Map
Date – May 1970 - Historical Lake Map - Not for Navigation
A Public Document - Please Identify the Source when using it.