

LAKE SURVEY MAP

TUMA LAKE
MANITOWOC COUNTY
SEC. 17 T. 21 N. R. 23 E

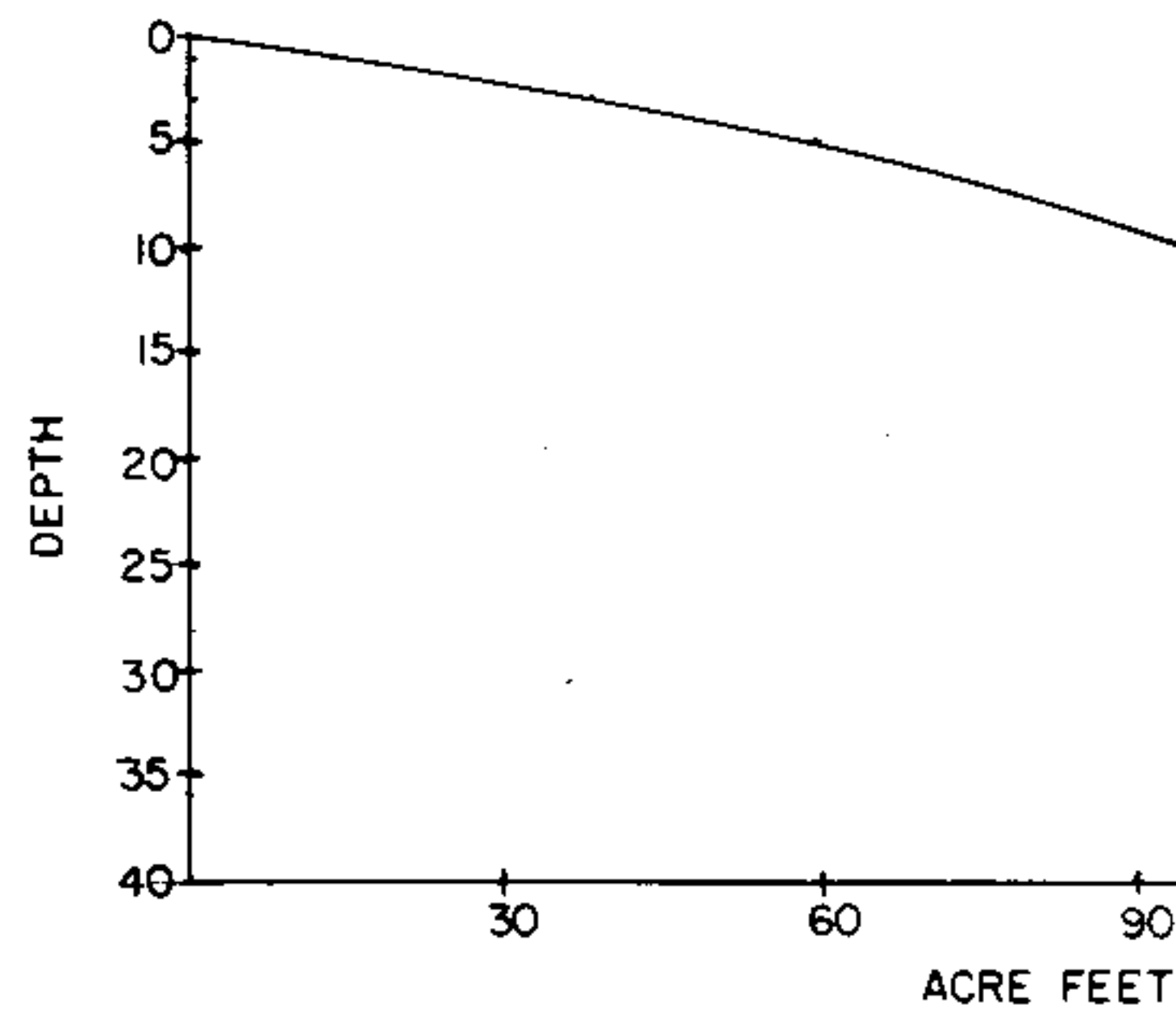
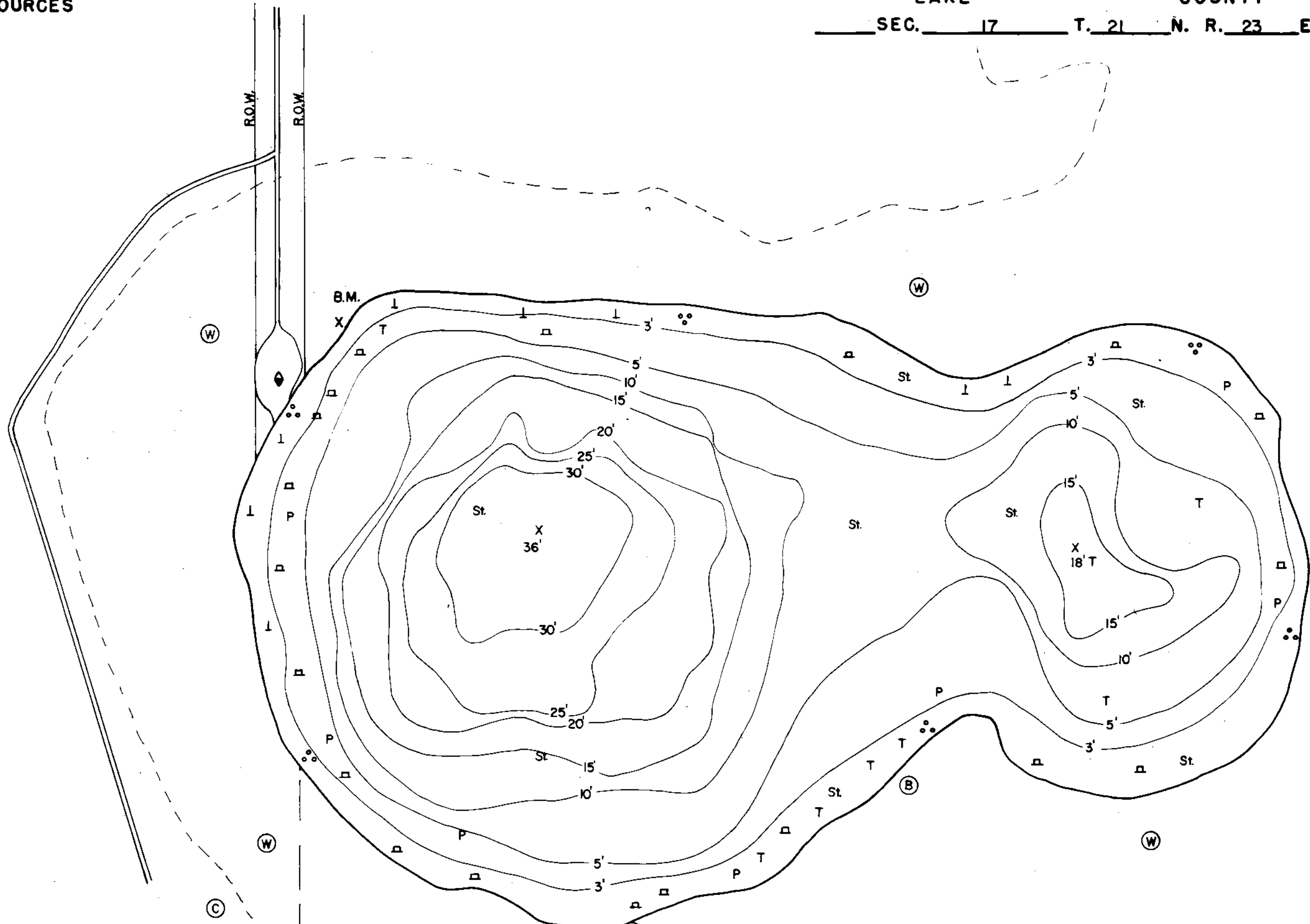

SW 1/4 Sec. 17 SE 1/4 Sec. 17
NW 1/4 Sec. 20 NE 1/4 Sec. 20

B.M. 'X' is a 1-3/4" pipe along shoreline on E. side of public landing on N.W. end of lake.
Assumed Elev. 100.00
Water Elev. 97.10

Larrabee 2 Miles

EQUIPMENT RECORDING SONAR MAPPED AUGUST 1973

TOPOGRAPHIC SYMBOLS		LAKE BOTTOM SYMBOLS	
(B) Brush	Steep slope	P. Peat	B Boulders
(PW) Partially wooded	----- Indefinite shoreline	Mk. Muck	⊙ Stumps & Snags
(W) Wooded	----- Marsh	C. Clay	⊙ Rock danger to navigation
(C) Cleared	----- Spring	M. Marl	T Submergent vegetation
(P) Pastured	----- Intermittent stream	Sd. Sand	⊥ Emergent vegetation
(A) Agricultural	----- Permanent inlet	St. Silt	⊥ Floating vegetation
B.M. Bench Mark	----- Permanent outlet	Gr. Gravel	⊥ Brush shelters
■ Dwelling	----- Dam	R. Rubble	
■ Resort	----- D.N.R. State owned land	Bc. Bedrock	
■ Camp			



Access Access with Parking Boat Livery
 Drawn by: J. Kushn
 Field work by: D. Boese, B. L. O'Brien

SPECIES OF FISH	Abundance		
	Abundant	Common	Present
Muskie			
N. Pike			X
Walleye		X	
L. M. Bass		X	
S. M. Bass		X	
Panfish	X		
Trout			

WATER AREA 13.9 ACRES
 UNDER 3 FT. 14 %
 OVER 20 FT. 14 %
 MAX. DEPTH 36 FEET.
 TOTAL ALK. 103 P.P.M.
 VOLUME 148.0 ACRE FT.
 SHORELINE 60 MILES

Source: Wisconsin Department of Natural Resources 608-266-2621
Tuma Lake – Manitowoc County, Wisconsin DNR Lake Map
Date – Aug 1973 - Historical Lake Map - Not for Navigation
A Public Document - Please Identify the Source when using it.