

LAKE CURTIS
SECTION 28
TOWNSHIP T. 18. N
RANGE R. 9. E
TOWN RICHFORD
COUNTY WAUSHARA

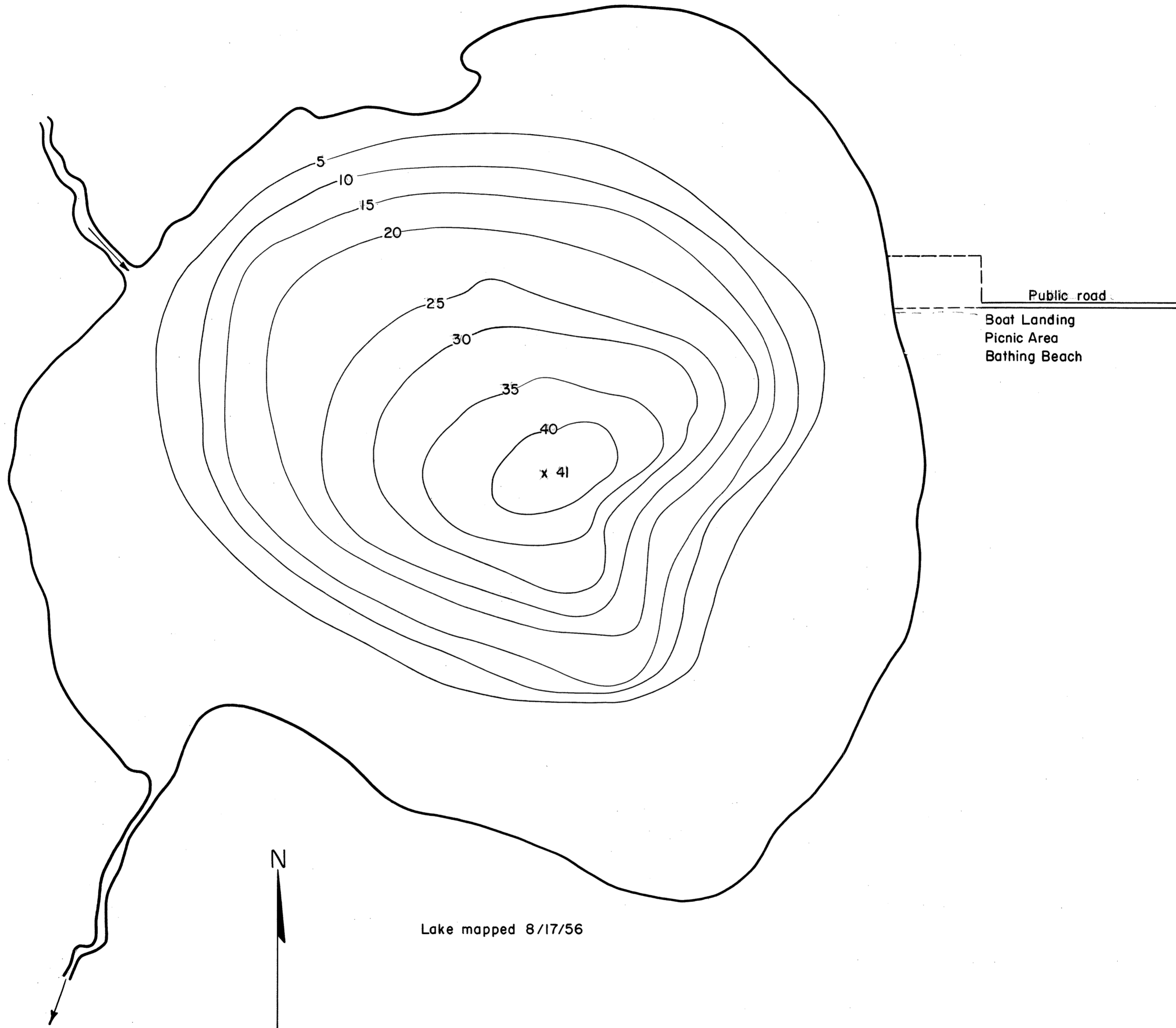

Lake mapped 8/17/56

AREA 33 Acres
TOTAL SHORELINE 0.9 Miles
MAX. DEPTH 41 Feet
SCALE: 40" = 1 Mile

Source: Wisconsin Department of Natural Resources 608-266-2621
Curtis Lake – Waushara County, Wisconsin DNR Lake Map
Date – Aug 1956 - Historical Lake Map - Not for Navigation
A Public Document - Please Identify the Source when using it.