

# LAKE SURVEY MAP

WISCONSIN CONSERVATION DEPARTMENT  
BIOLOGY DIVISION  
LAKE AND STREAM IMPROVEMENT SECTION

LAKE VIRGIN <sup>Turtle</sup> FORM FI-117  
SECTION 15  
TOWNSHIP 23 N  
RANGE 10 E  
TOWN OF AMHERST  
COUNTY PORTAGE

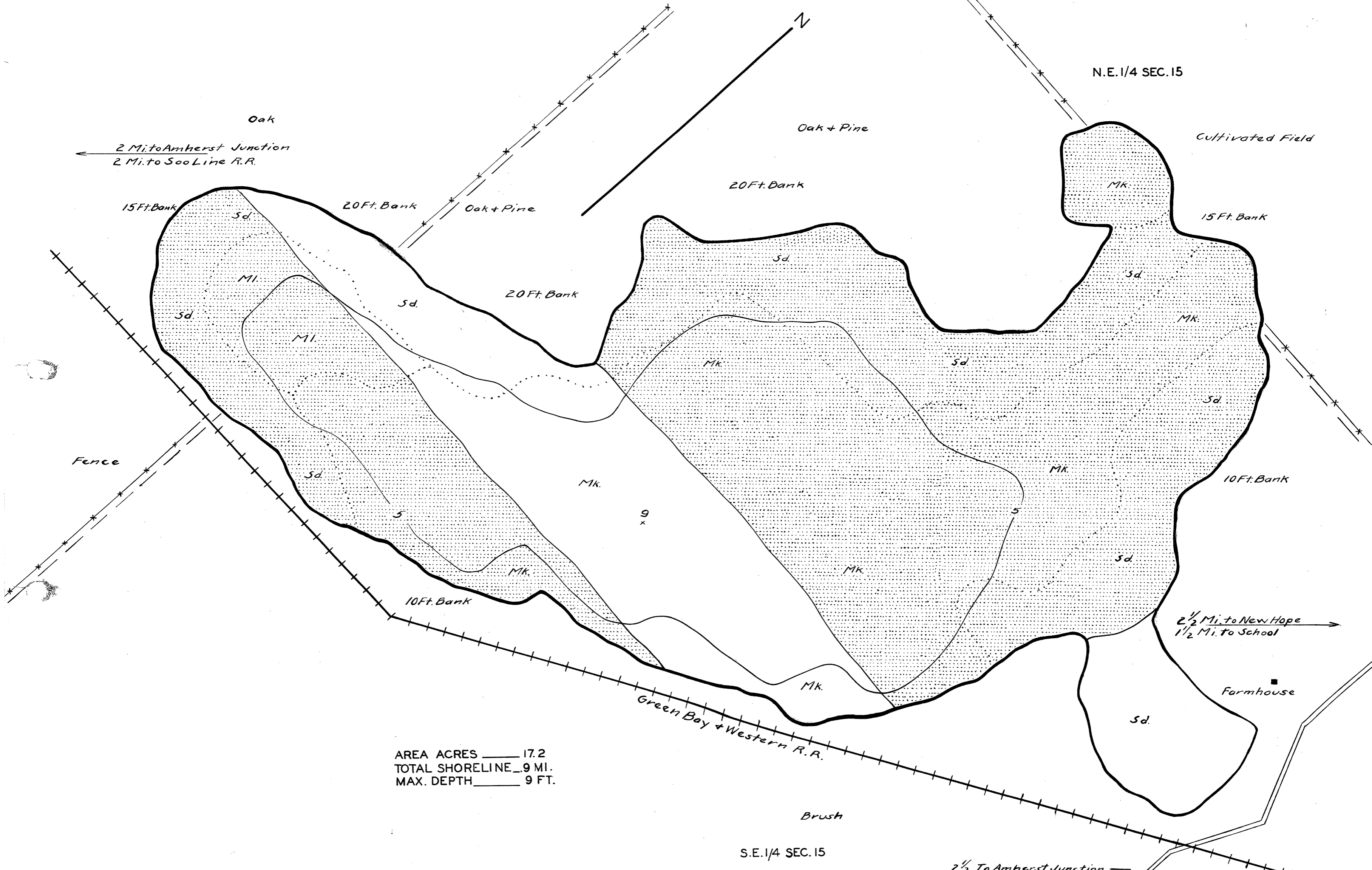

AREA ACRES 17.2  
TOTAL SHORELINE 9 MI.  
MAX. DEPTH 9 FT.

*Checked*  
*W.P.S.*  
*E.M.K.*  
*8/6/1941*

DATE July 30 1941  
COMPILED BY \_\_\_\_\_  
TRACED BY E.M.K. (W.P.A.)  
SOURCE OF INFORMATION W.P.A. Lake Survey Project  
SOUNDINGS At 100 Ft. Intervals  
DATES OF MAP REVISION \_\_\_\_\_  
WORK AGENCY W.P.A.

LAKE IMPROVEMENT RECORD	
TYPE	DATE
BRUSH REFUGES	_____
SAPLING TANGLES	_____
SPAWNING BOXES	_____
MINNOW SPAWNERS	_____
TOTAL	_____

SCALE 1 in. Equals 100 Ft.

0 50 100 200 300 Ft.

**LEGEND**

- WEED BEDS
- ROCKY SHOALS
- Sd.* SAND
- Cl.* CLAY
- Gr.* GRAVEL
- Mk.* MUCK
- DWELLING
- ABANDONED DWELLING
- RESORT
- MI.* MARL

Source: Wisconsin Department of Natural Resources 608-266-2621  
Virgin Lake (Turtle Lake) – Portage County, Wisconsin DNR Lake Map  
Date – Jul 1941 - Historical Lake Map - Not for Navigation  
A Public Document - Please Identify the Source when using it.