

# LAKE SURVEY MAP

WISCONSIN CONSERVATION DEPARTMENT  
BIOLOGY DIVISION  
LAKE AND STREAM IMPROVEMENT SECTION

LAKE RHEINHARDT  
SECTION 27-34  
TOWNSHIP 24 N  
RANGE 10 E  
TOWN OF NEW HOPE  
COUNTY PORTAGE

FORM FH17

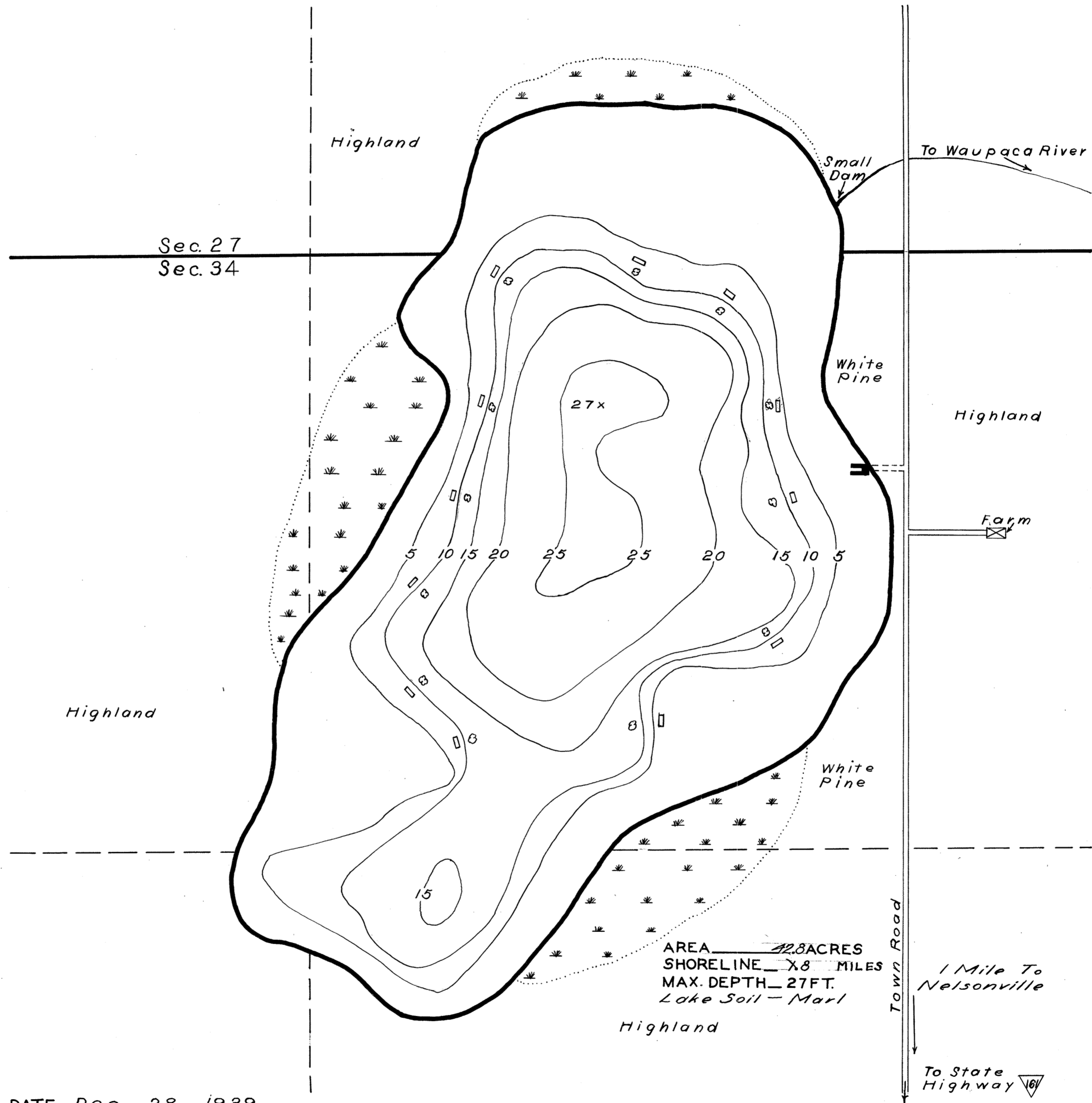

AREA 42.8 ACRES  
SHORELINE 8.8 MILES  
MAX. DEPTH 27 FT.  
Lake Soil - Marl

SCALE 1 inch Equal 200

CHECKED BY  
W.P.S.-C.E.K  
5-15-41

DATE Dec. 28 1939  
COMPILED BY C.R.  
TRACED BY R.C. (W.P.A.)  
SOURCE OF INFORMATION  
W.P.A. Lake Survey  
Mapping Project  
SOUNDINGS \_\_\_\_\_  
DATES OF MAP REVISION \_\_\_\_\_  
WORK AGENCY W.P.A.

LAKE IMPROVEMENT RECORD			
TYPE	DATE	1939	
BRUSH REFUGES		12	
SAPLING TANGLES			
SPAWNING BOXES		48	
MINNOW SPAWNERS		52	
TOTAL		112	

- LEGEND
- WEED BEDS
  - ROCKY SHOALS
  - SAND
  - CLAY
  - GRAVEL
  - MUCK
  - DWELLING
  - ABANDONED DWELLING
  - RESORT
  - DOCK

Source: Wisconsin Department of Natural Resources 608-266-2621  
Rheinhardt Lake – Portage County, Wisconsin DNR Lake Map  
Date – Dec 1939 - Historical Lake Map - Not for Navigation  
A Public Document - Please Identify the Source when using it.