

LAKE SURVEY MAP

LAKE NORTH
 SECTIONS II
 TOWNSHIP T-24-N
 RANGE R-11-E
 TOWN IOLA
 COUNTY WAUPACA

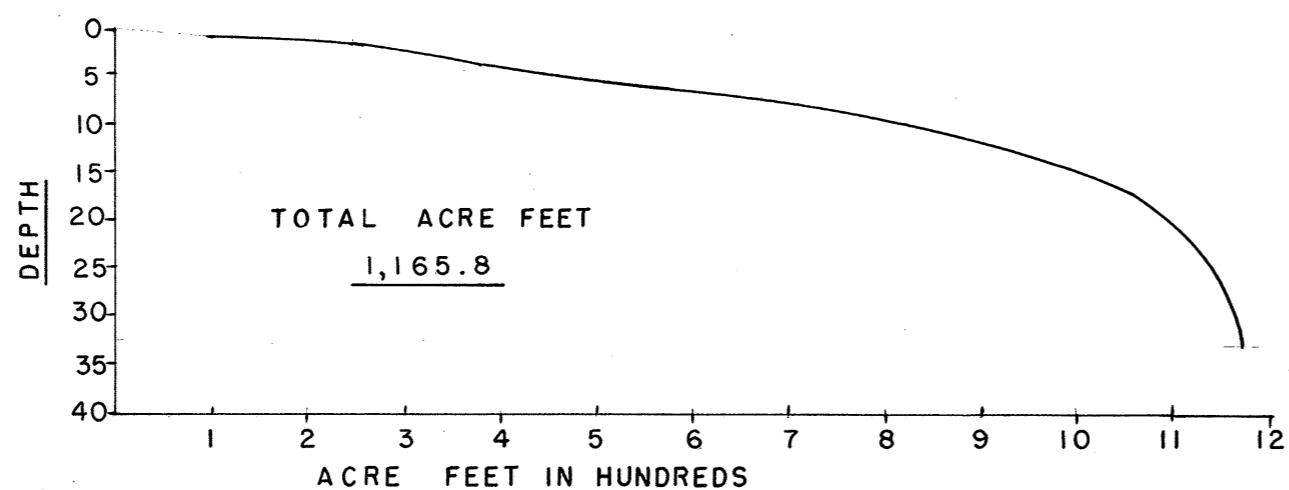

Sec. 2
 Sec. 11

Grass L.
 25 A. Approx.
 Max depth 8 Ft.

LEGEND

TOPOGRAPHIC SYMBOLS

- (B) Brush
- (PW) Partially wooded
- (W) Wooded
- (C) Cleared
- (P) Pastured
- (A) Agricultural
- B.M. Bench Mark
- Dwelling
- Resort
- ||||| Steep slope
- - - Indefinite shoreline
- Marsh symbol
- Spring symbol
- Intermittent stream symbol
- Permanent inlet symbol
- Permanent outlet symbol
- Dam symbol

LAKE BOTTOM SYMBOLS

- P. Peat
- Mk. Muck
- C. Clay
- M. Marl
- T Submergent vegetation
- ⊥ Emergent vegetation
- ▭ Floating vegetation
- Gr. Gravel
- R. Rubble
- Br. Bedrock
- Sd. Sand

SPECIES OF FISH

	Abundant	Common	Rare
Muskie			
N. Pike		X	
Walleye		X	
L. M. Bass		X	
S. M. Bass			
Panfish	X		
Trout			

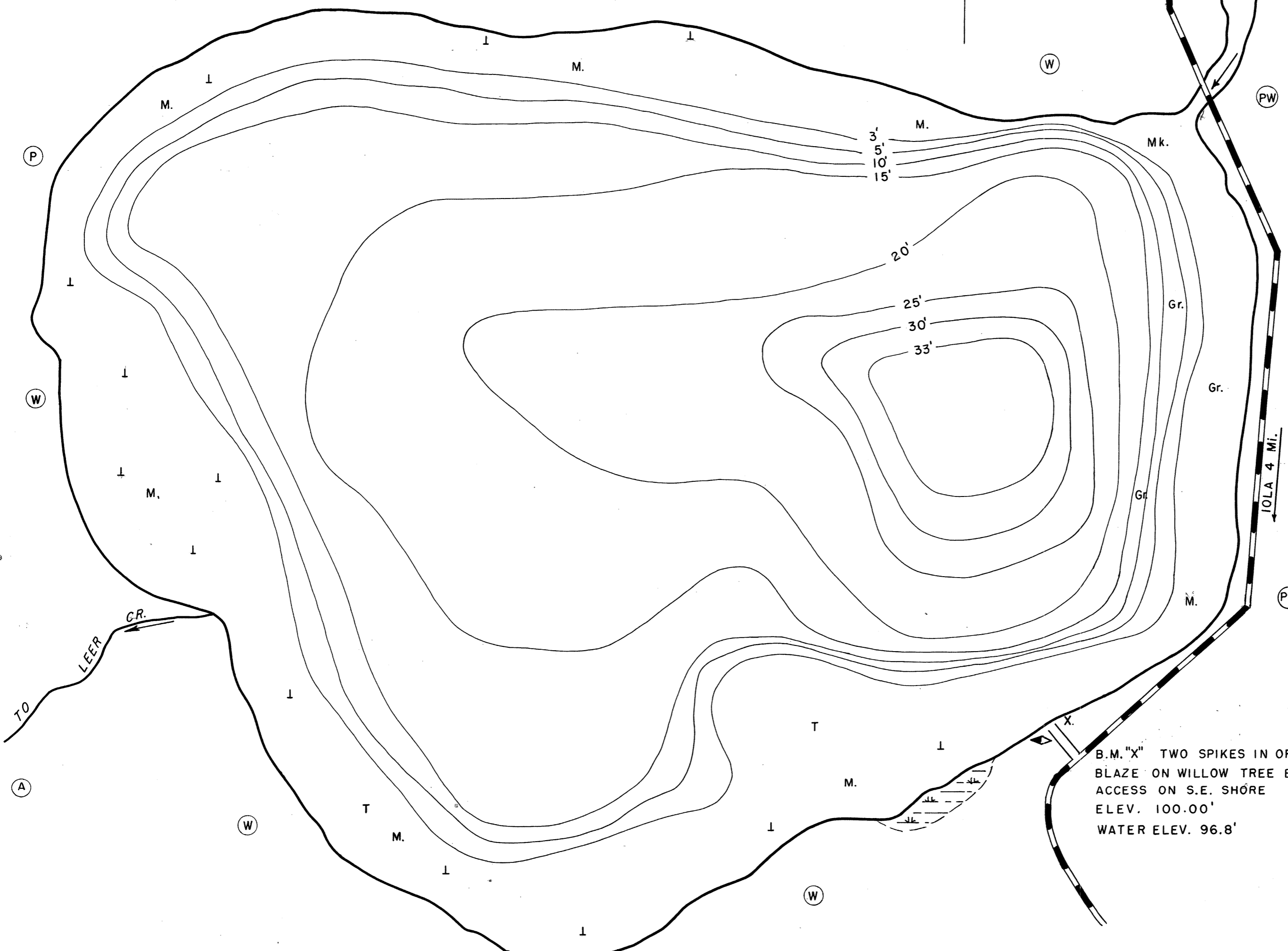

B.M. "X" TWO SPIKES IN ORANGE
 BLAZE ON WILLOW TREE E. OF
 ACCESS ON S.E. SHORE
 ELEV. 100.00'
 WATER ELEV. 96.8'

FIELD WORK BY: H. SCHMUDE
 DRAWN BY: E. EATON
 LAKE MAPPED NOVEMBER 1963
 SOURCE OF INFORMATION W. C. D.
 SOUNDINGS SONAR
 TOTAL ALK. 140 P.P.M.

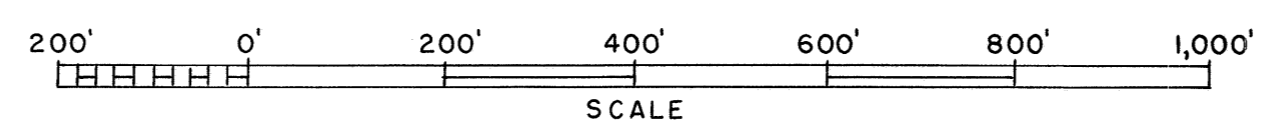

◇ ACCESS ◀ ACCESS WITH PARKING ◆ BOAT LIVERY

AREA 95.7 ACRES
 TOTAL SHORELINE 1.47 MILES
 MAX. DEPTH 33 FEET
 UNDER 3' 29% OVER 20' 20%

Source: Wisconsin Department of Natural Resources 608-266-2621
North Lake – Waupaca County, Wisconsin DNR Lake Map
Date – Nov 1963 - Historical Lake Map - Not for Navigation
A Public Document - Please Identify the Source when using it.