

LAKE SURVEY MAP

Department of Natural Resources Bench Mark.
Top of 1" steel pipe approximately 6' from water's edge.
Assumed Elevation 100.00'
Water Elevation 95.70'

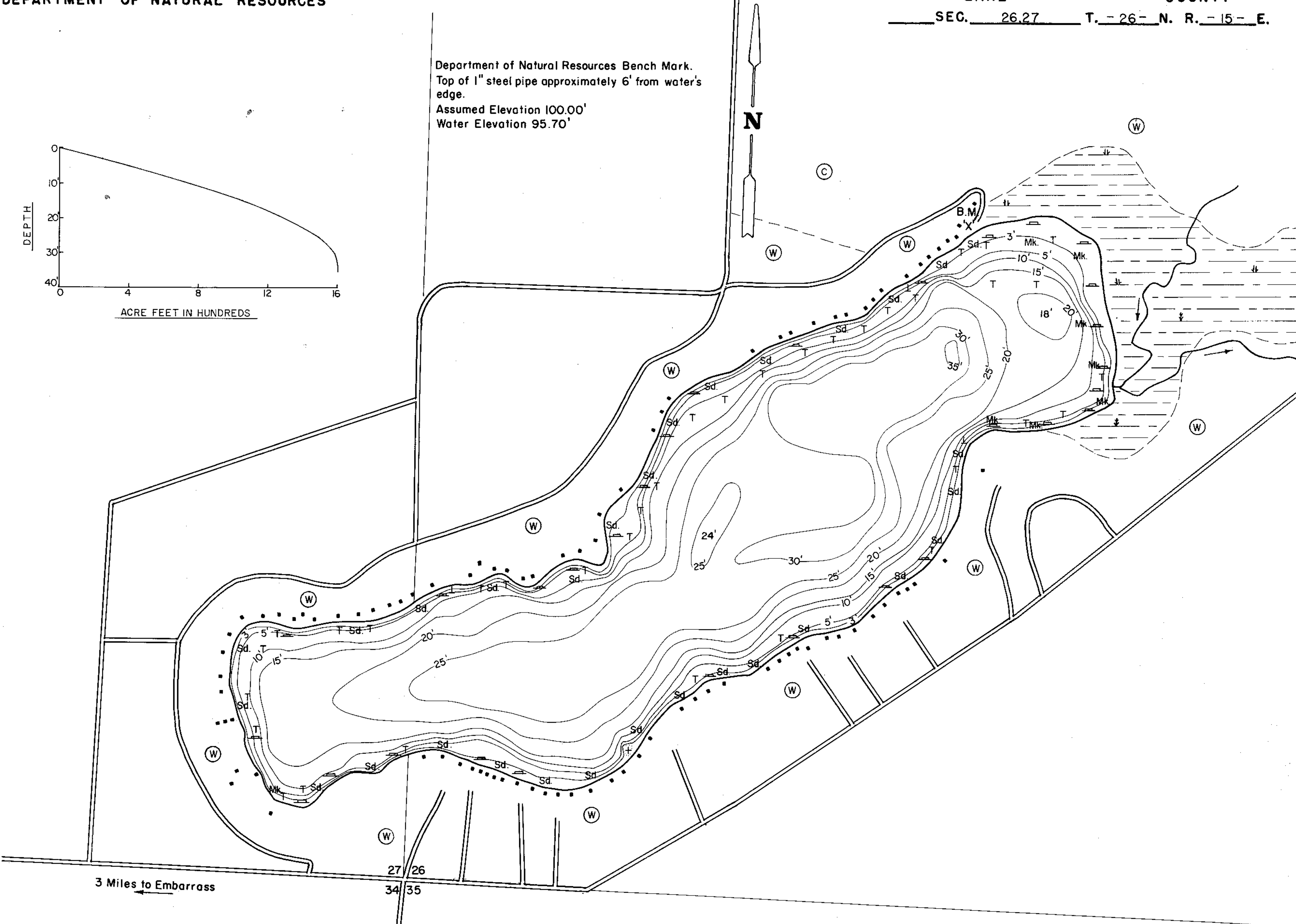
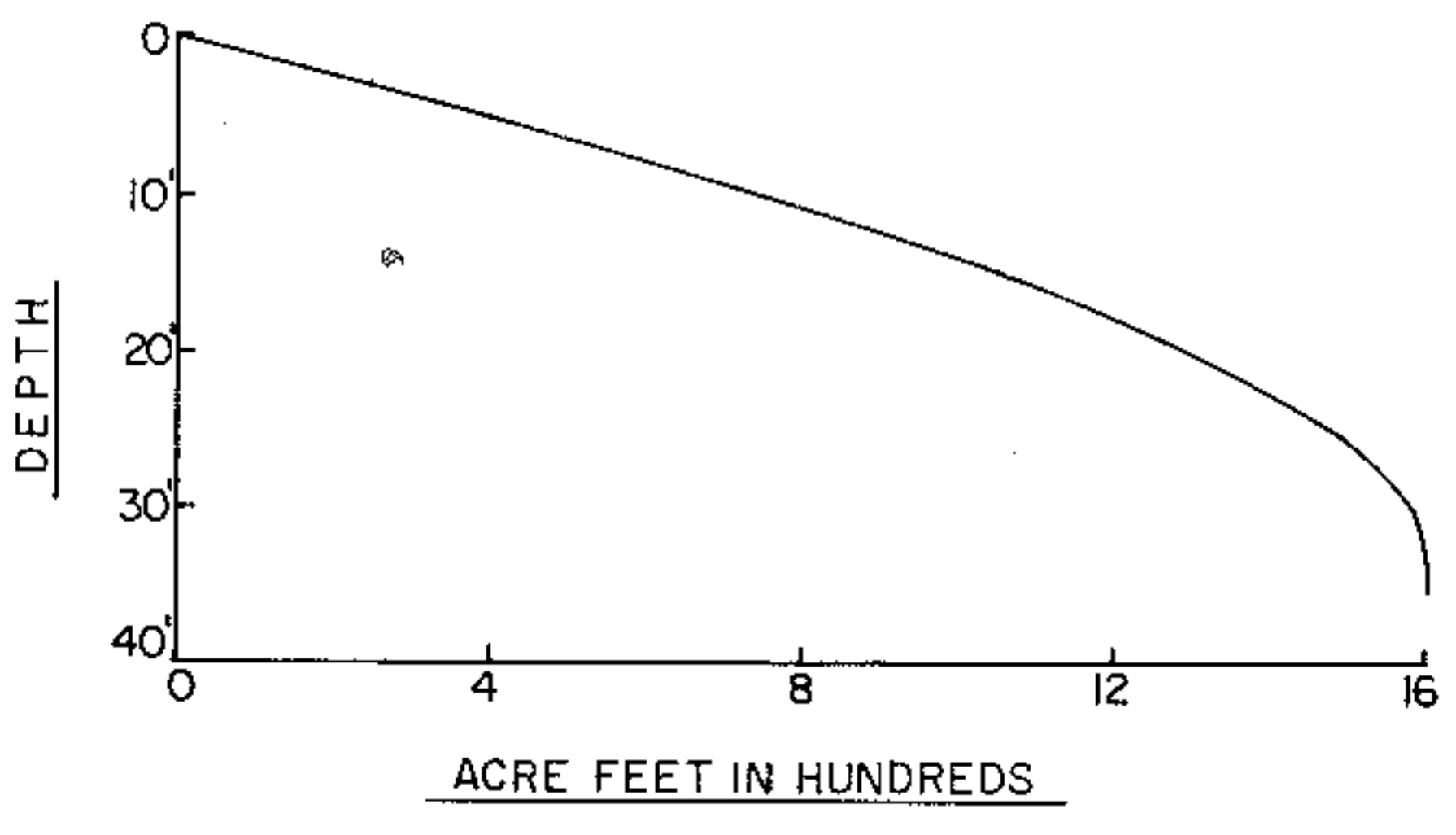

EQUIPMENT RECORDING SONAR MAPPED JULY 1969
MONTH YEAR

- TOPOGRAPHIC SYMBOLS**
- (B) Brush
 - (PW) Partially wooded
 - (W) Wooded
 - (C) Cleared
 - (P) Pastured
 - (A) Agricultural
 - B.M. Bench Mark
 - Dwelling
 - Resort
 - ⊞ Camp
 - ||||| Steep slope
 - - - Indefinite shoreline
 - Marsh
 - Spring
 - Intermittent stream
 - Permanent inlet
 - Permanent outlet
 - Dam
 - D.N.R. State owned land

- LAKE BOTTOM SYMBOLS**
- P. Peat
 - Mk. Muck
 - C. Clay
 - M. Marl
 - Sd. Sand
 - St. Silt
 - Gr. Gravel
 - R. Rubble
 - Br. Bedrock
 - B Boulders
 - Stumps & Snags
 - Rock danger to navigation
 - Submergent vegetation
 - Emergent vegetation
 - Floating vegetation
 - Brush shelters



Access Access with Parking Boat Livery
 Drawn by: J. Roth
 Field work by: J. Smith

SPECIES OF FISH	ABUNDANCE		
	Abundant	Common	Present
Muskie			
N. Pike		X	
Walleye			
L.M. Bass		X	
S.M. Bass			
Panfish	X		
Trout			

WATER AREA 85.6 ACRES
 UNDER 3 FT. 7 %
 OVER 20 FT. 49 %
 MAX. DEPTH 35 FEET.
 TOTAL ALK. 122 P.P.M.
 VOLUME 1,600.7 ACRE FT.
 SHORELINE 2.0 MILES

Source: Wisconsin Department of Natural Resources 608-266-2621
Long Lake – Shawano County, Wisconsin DNR Lake Map
Date – Jul 1969 - Historical Lake Map - Not for Navigation
A Public Document - Please Identify the Source when using it.