

# LAKE SURVEY MAP

WISCONSIN CONSERVATION DEPARTMENT  
BIOLOGY DIVISION  
LAKE AND STREAM IMPROVEMENT SECTION

LAKE DIENE  
SECTION 23  
TOWNSHIP 32 N  
RANGE 14 E-W  
TOWN OF WOLF RIVER  
COUNTY LANGLADE

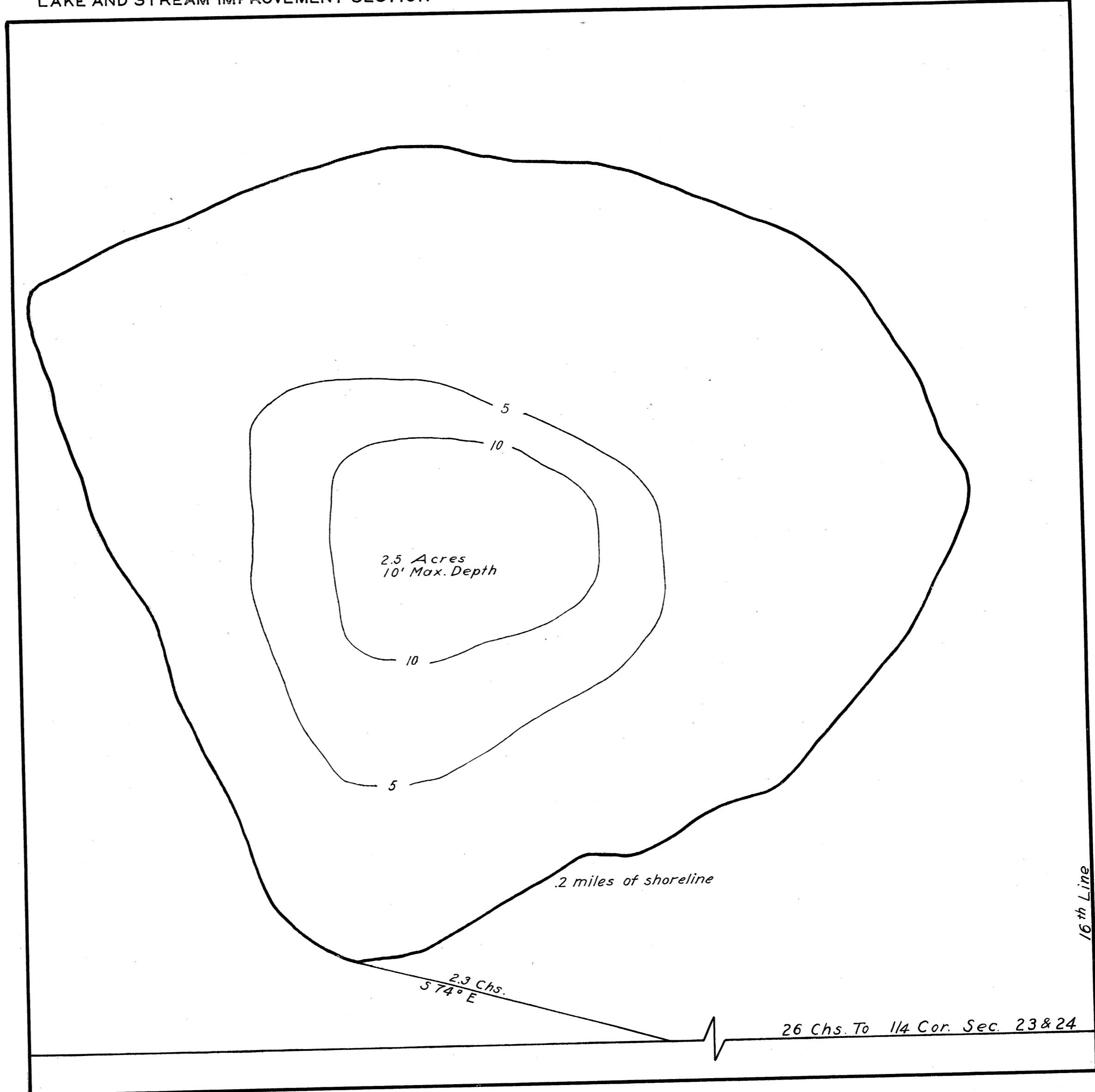

DATE Feb. 1. 1939  
 COMPILED BY WPA Dist 2  
 TRACED BY R.F.F.  
 SOURCE OF INFORMATION  
U.S. Forest Service Lake  
And Stream Survey  
 SOUNDINGS \_\_\_\_\_  
 DATES OF MAP REVISION \_\_\_\_\_  
 WORK AGENCY \_\_\_\_\_

SCALE 1 inch = 41.25 Feet

### LAKE IMPROVEMENT RECORD

TYPE	DATE	_____	_____	_____	_____
⊕ BRUSH REFUGES	_____	_____	_____	_____	_____
⊖ SAPLING TANGLES	_____	_____	_____	_____	_____
□ SPAWNING BOXES	_____	_____	_____	_____	_____
* MINNOW SPAWNERS	_____	_____	_____	_____	_____
TOTAL	_____	_____	_____	_____	_____

### LEGEND

- ⊙ WEED BEDS
- ⊙ ROCKY SHOALS
- Sd SAND
- Cl CLAY
- Gr GRAVEL
- Mk MUCK
- DWELLING
- ABANDONED DWELLING
- ⊠ RESORT

Source: Wisconsin Department of Natural Resources 608-266-2621  
Diene Lake- Langlade County, Wisconsin DNR Lake Map  
Date Feb 1939 - Historical Lake Map - Not for Navigation  
A Public Document - Please Identify the Source when using it.