

LAKE SURVEY MAP

Munger Lake
97' Acres
21' Deep

Pine Ridge Lake
46 Acres
27' Deep

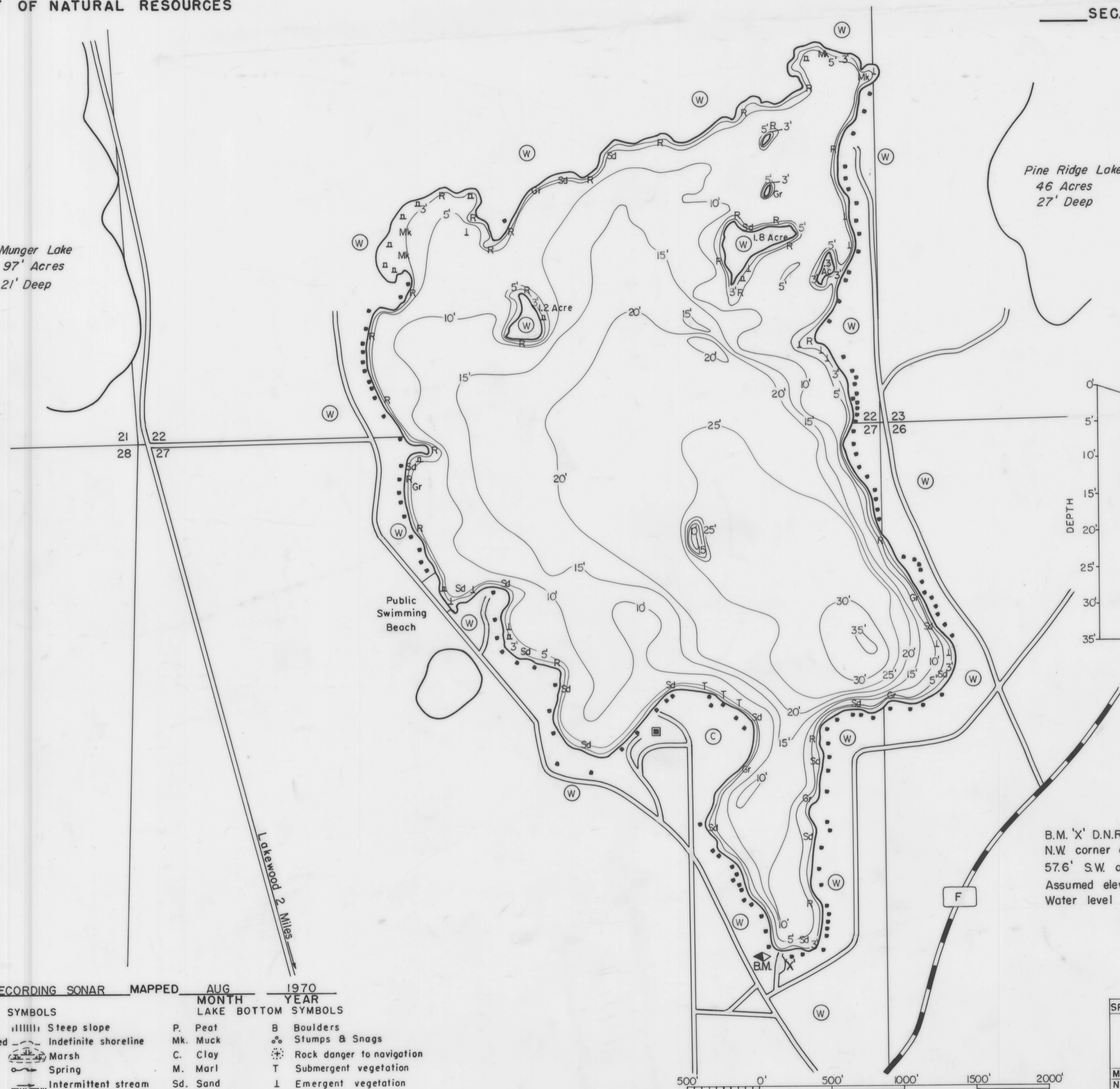
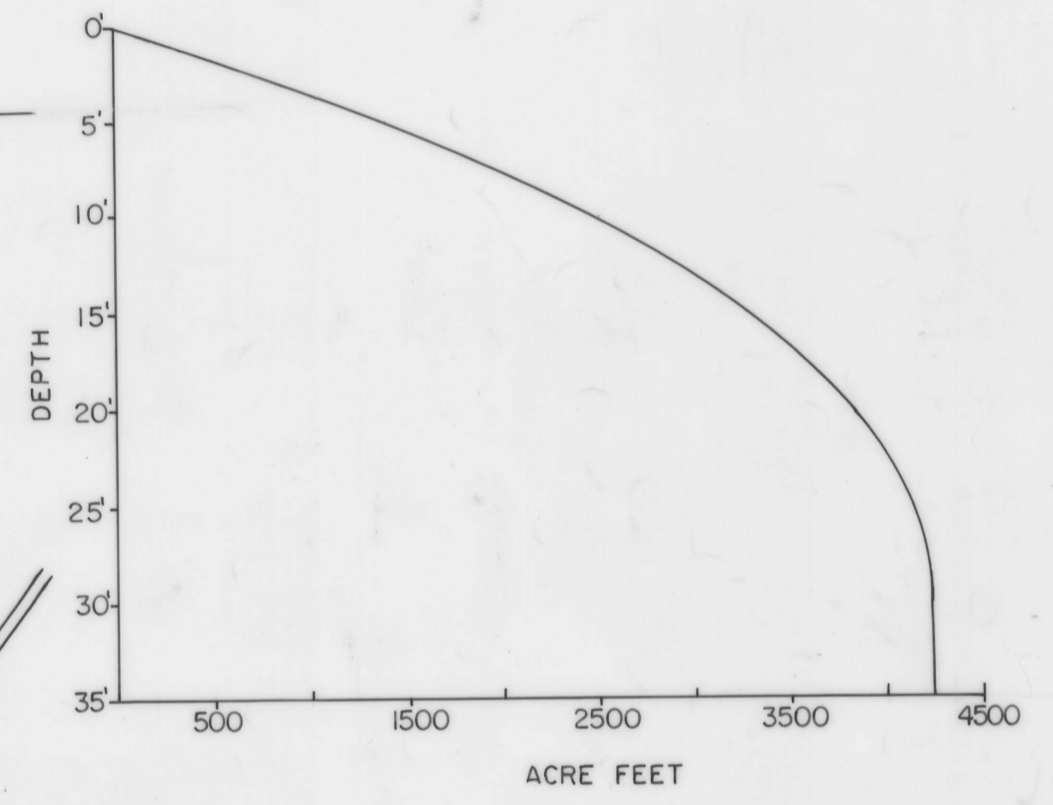

B.M. 'X' D.N.R. 1741-C 2" square cut in
N.W. corner of concrete base of water pump
57.6' S.W. of B.M. 'X' 1741-B, 52' S. of lake
Assumed elevation 100.93'
Water level 98.23'

EQUIPMENT RECORDING SONAR MAPPED		AUG 1970	
TOPOGRAPHIC SYMBOLS		LAKE BOTTOM SYMBOLS	
(B) Brush	Steep slope	P. Peat	B Boulders
(PW) Partially wooded	Indefinite shoreline	Mk. Muck	Stumps & Snags
(W) Wooded	Marsh	C. Clay	Rock danger to navigation
(C) Cleared	Spring	M. Marl	T Submergent vegetation
(P) Pastured	Intermittent stream	Sd. Sand	Emergent vegetation
(A) Agricultural	Permanent inlet	St. Silt	Floating vegetation
B.M. Bench Mark	Permanent outlet	Gr. Gravel	Brush shelters
■ Dwelling	Dam	R. Rubble	
□ Resort	D.N.R. State owned land	Br. Bedrock	
□ Camp			

500' 0' 500' 1000' 1500' 2000'

SCALE

◆ Access ◀ Access with Parking ◆ Boat Livery

Drawn by: C. Holt
Field work by: R. Crocker, J. Smith

SPECIES OF FISH	Abundance		
	Abundant	Common	Present
Muskie			
N. Pike			X
Walleye	X		
L.M. Bass	X		
S.M. Bass	X		
Panfish	X		
Trout			

WATER AREA 293.3 ACRES

UNDER 3 FT. 5 %
OVER 20 FT. 30 %

MAX. DEPTH 35 FEET.

TOTAL ALK. 78 P.P.M.

VOLUME 4251 ACRE FT.

MAIN SHORELINE 3.95 MI.
ISLAND SHORELINE .68 MI.

KEY MAP

WHEELER
LAKE

OCONTO
COUNTY

SEC. 22, 26, 27 T. 33 N. R. 16 E.

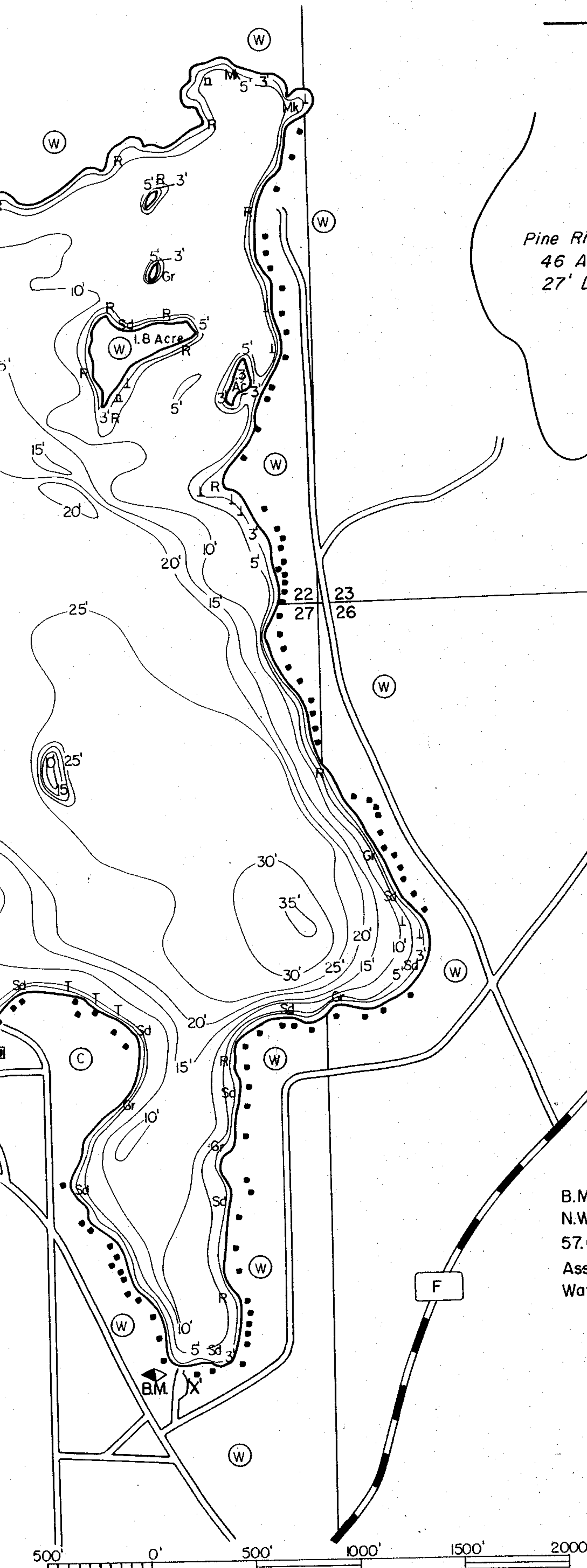

Pine Ridge Lake
46 Acres
27' Deep

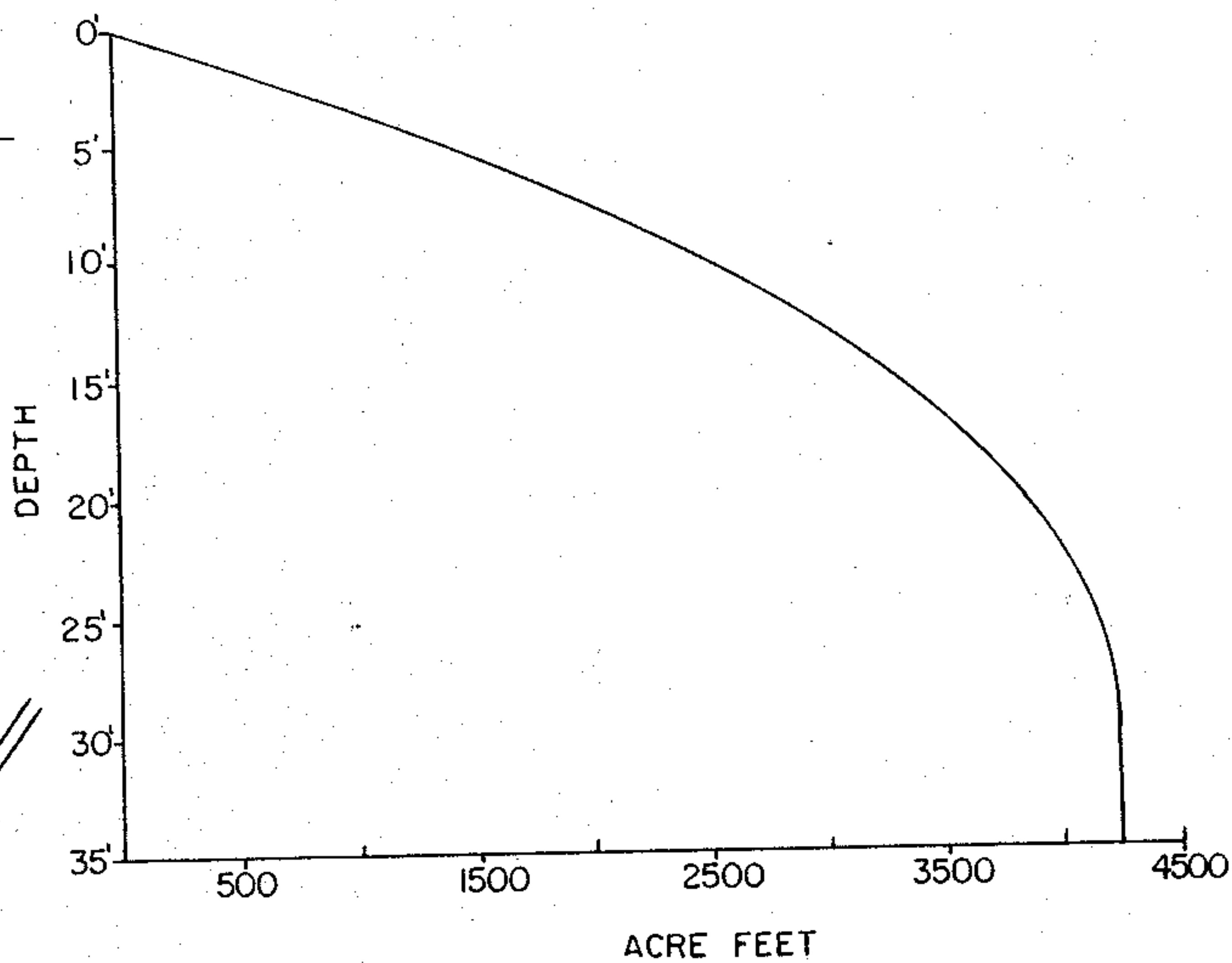

B.M. 'X' D.N.R. 1741-C 2" square cut in
N.W. corner of concrete base of water pump
57.6' S.W. of B.M. 'X' 1741-B, 52' S. of lake
Assumed elevation 100.93'
Water level 98.23'



SCALE

◆ Access ◆ Access with Parking ◆ Boat Livery

Drawn by: C. Holt
Field work by: R. Crocker, J. Smith

SPECIES OF FISH

	Abundant	Common	Present
Muskie			
N. Pike			X
Walleye	X		
L.M. Bass	X		
S.M. Bass	X		
Panfish	X		
Trout			

WATER AREA 293.3 ACRES
 UNDER 3 FT. 5 %
 OVER 20 FT. 30 %
 MAX. DEPTH 35 FEET.
 TOTAL ALK. 78 P.P.M.
 VOLUME 4251 ACRE FT.
 MAIN SHORELINE 3.95 MI.
 ISLAND SHORELINE .68 MI.

Munger Lake
97' Acres
21' Deep

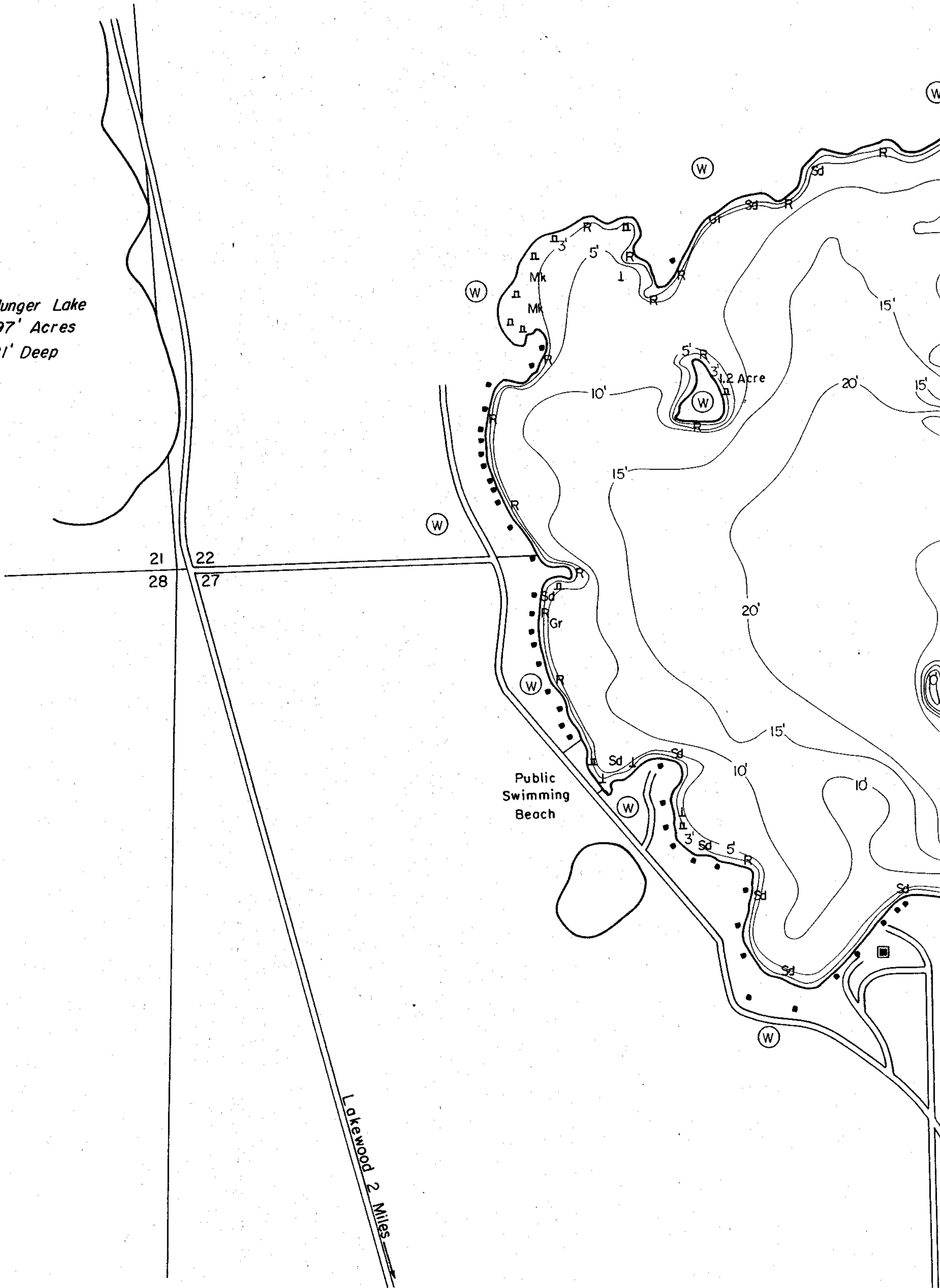

EQUIPMENT RECORDING SONAR MAPPED AUG 1970
MONTH YEAR

TOPOGRAPHIC SYMBOLS

- | | |
|-----------------------|----------------------------|
| (B) Brush | Steep slope |
| (PW) Partially wooded | - - - Indefinite shoreline |
| (W) Wooded | Marsh |
| (C) Cleared | o Spring |
| (P) Pastured | - - - Intermittent stream |
| (A) Agricultural | ==== Permanent inlet |
| B.M. Bench Mark | ==== Permanent outlet |
| ■ Dwelling | ∧ Dam |
| ▣ Resort | D.N.R. State owned land |
| □ Camp | |

LAKE BOTTOM SYMBOLS

- | | |
|-------------|-----------------------------|
| P. Peat | B Boulders |
| Mk. Muck | ⊙ Stumps & Snags |
| C. Clay | ⊕ Rock danger to navigation |
| M. Marl | T Submergent vegetation |
| Sd. Sand | ⊥ Emergent vegetation |
| St. Silt | ▭ Floating vegetation |
| Gr. Gravel | ⊕ Brush shelters |
| R. Rubble | |
| Br. Bedrock | |

500
D
F

Source: Wisconsin Department of Natural Resources 608-266-2621
Wheeler Lake – Oconto County, Wisconsin DNR Lake Map
Date - Aug 1970 - Historical Lake Map - Not for Navigation
A Public Document - Please Identify the Source when using it.