

LAKE SURVEY MAP

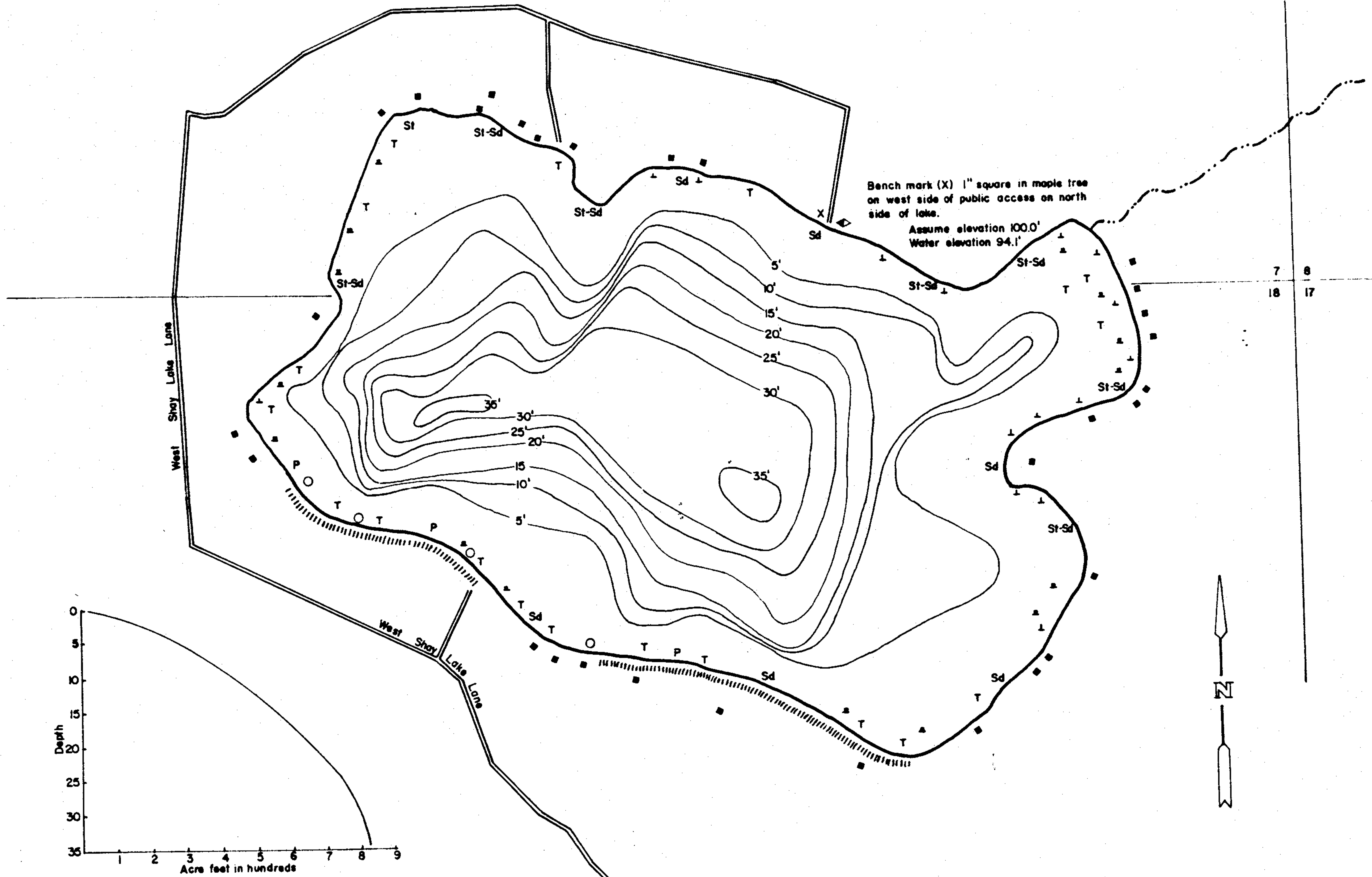

Bench mark (X) 1" square in maple tree on west side of public access on north side of lake.
Assume elevation 100.0'
Water elevation 94.1'

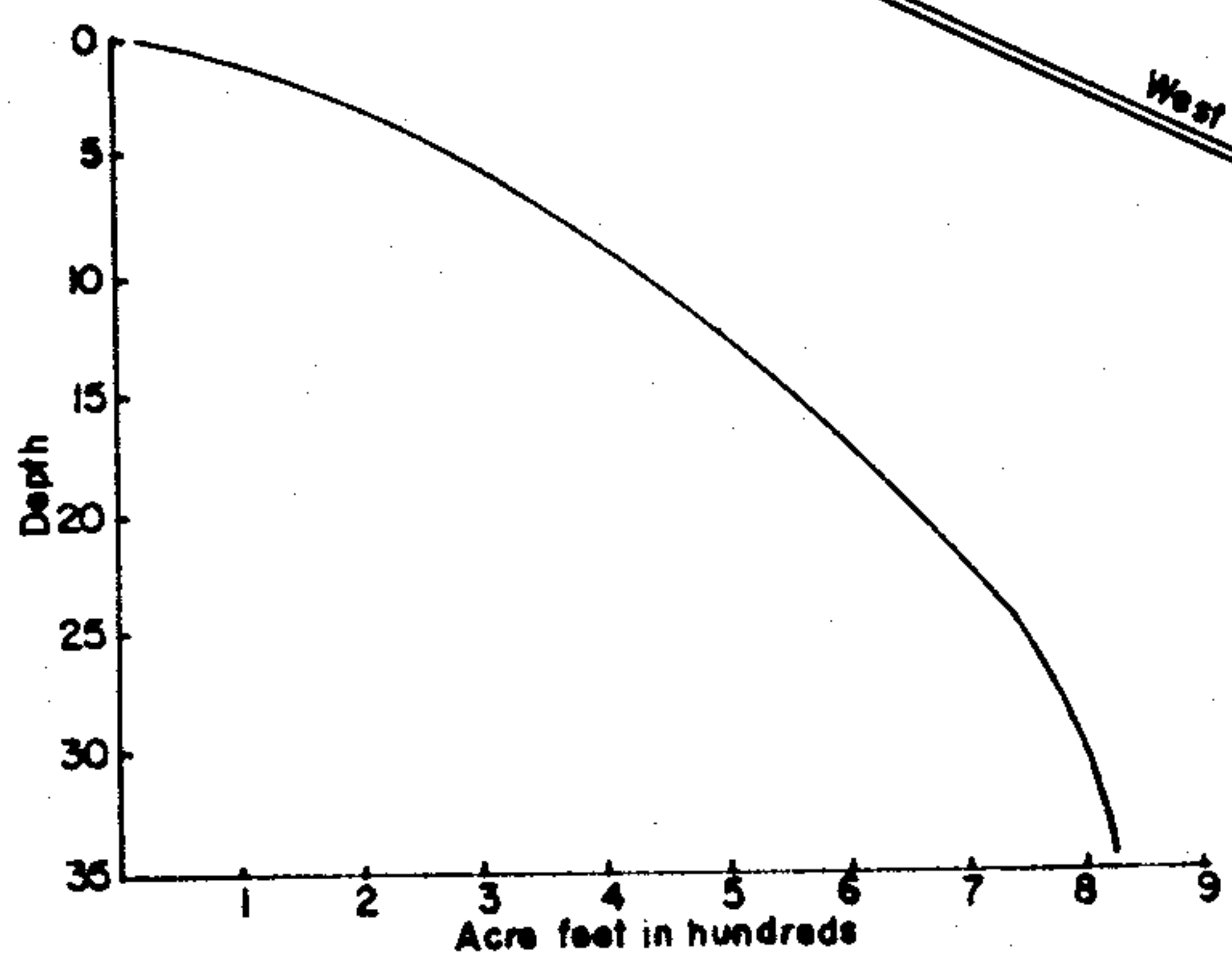

EQUIPMENT RECORDING SONAR MAPPED AUGUST 1977

TOPOGRAPHIC SYMBOLS		LAKE BOTTOM SYMBOLS	
		MONTH	YEAR
(B) Brush	Steep slope	P. Peat	B Boulders
(W) Partially wooded	~ Indefinite shoreline	Mh Muck	O Stumps & Snags
(W) Wooded	Marsh	C. Clay	Rock danger to navigation
(C) Cleared	Spring	M. Marl	T Submergent vegetation
(P) Pastured	Intermittent stream	Sd. Sand	↓ Emergent vegetation
(A) Agricultural	Permanent inlet	St. Silt	▲ Floating vegetation
B.M. Bench Mark	Permanent outlet	Gr. Gravel	↖ Brush shelters
■ Dwelling	Dem	R. Rubble	
□ Resort	D.N.R. State owned land	Bc. Bedrock	
△ Camp			

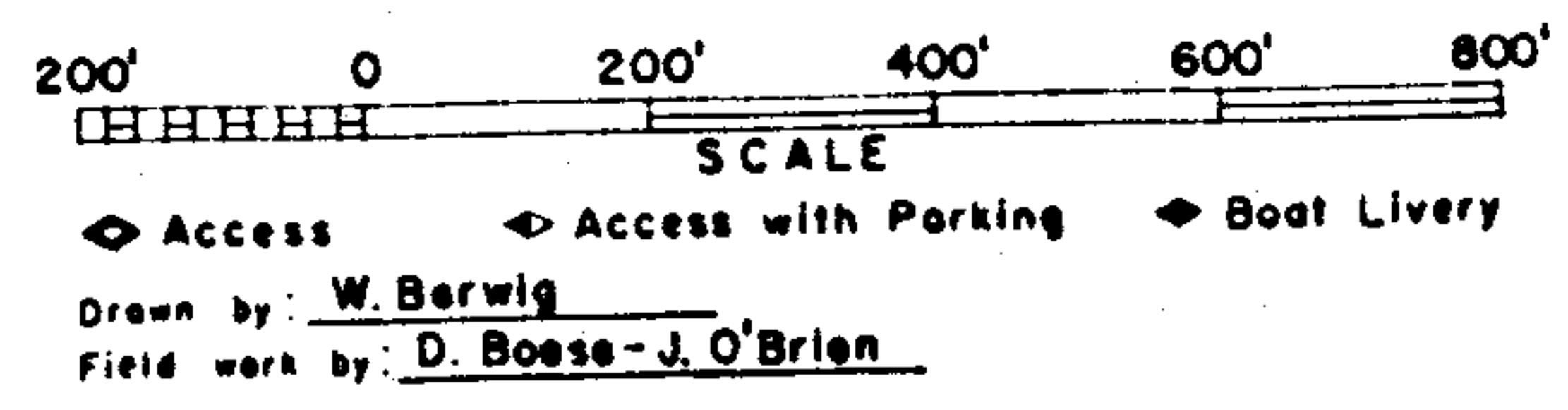

SPECIES OF FISH			
	Abundant	Common	Present
Muskie			
N. Pike			
Walleye			
L. M. Bass			X
S. M. Bass			
Panfish		X	
Trout			

WATER AREA	672	ACRES
UNDER 5 FT.	32	%
OVER 20 FT.	18	%
MAX. DEPTH	36	FEET.
TOTAL ALK.	86	P.P.M.
VOLUME	825	ACRE FT.
MAIN SHORELINE	1.5	MI.
ISLAND SHORELINE		MI.

Source: Wisconsin Department of Natural Resources 608-266-2621
Shay Lake – Oconto County, Wisconsin DNR Lake Map
Date - Aug 1977 - Historical Lake Map - Not for Navigation
A Public Document - Please Identify the Source when using it.