

# LAKE SURVEY MAP

WISCONSIN CONSERVATION DEPARTMENT  
BIOLOGY DIVISION  
LAKE AND STREAM IMPROVEMENT SECTION

LAKE            RANGE 13-18 LINE             
SECTION 13-18  
TOWNSHIP 34 N  
RANGE 14-15 E  
TOWN OF FREEDOM  
COUNTY FOREST

FORM FI-117

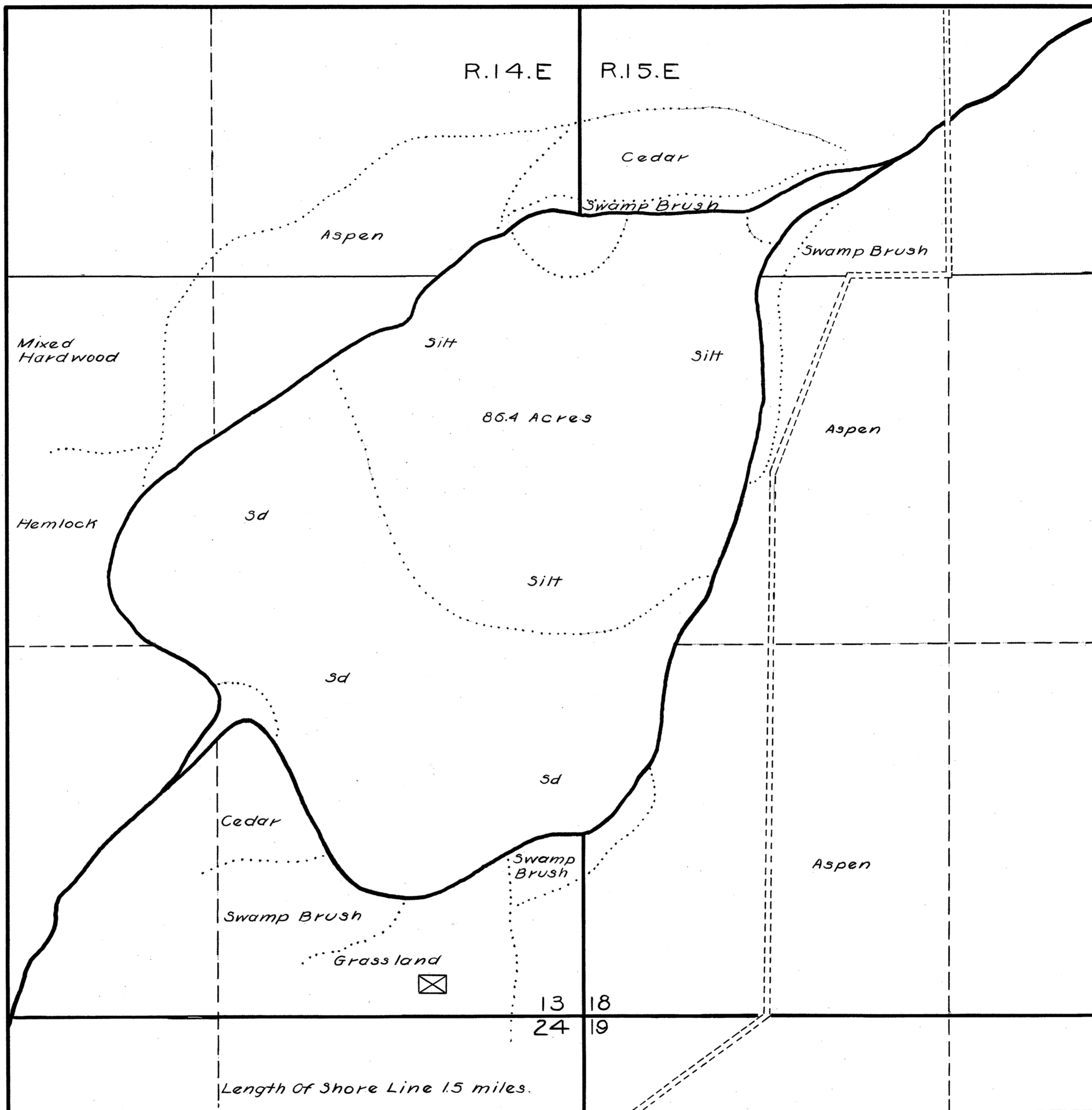

DATE April 10, 1939  
COMPILED BY             
TRACED BY W.P.S  
SOURCE OF INFORMATION  
U.S. Lake Improvement  
U.S. Forest Service Map  
SOUNDINGS             
U.S. Forest Service  
DATES OF MAP REVISION             
WORK AGENCY           

SCALE 1 inch = 330 feet

### LAKE IMPROVEMENT RECORD

TYPE	DATE			
⊙ BRUSH REFUGES	_____	_____	_____	_____
~ SAPLING TANGLES	_____	_____	_____	_____
□ SPAWNING BOXES	_____	_____	_____	_____
* MINNOW SPAWNERS	_____	_____	_____	_____
TOTAL	_____	_____	_____	_____

### LEGEND

	WEED BEDS
	ROCKY SHOALS
<i>Sd</i>	SAND
<i>Cl</i>	CLAY
<i>Gt</i>	GRAVEL
<i>Mx</i>	MUCK
■	DWELLING
□	ABANDONED DWELLING
▣	RESORT
⊠	Farm

Source: Wisconsin Department of Natural Resources 608-266-2621  
Rangeline Lake - Forest County, Wisconsin DNR Lake Map  
Date Apr 1939- Historical Lake Map - Not for Navigation  
A Public Document - Please Identify the Source when using it.