

SEC. 5  
SEC. 8

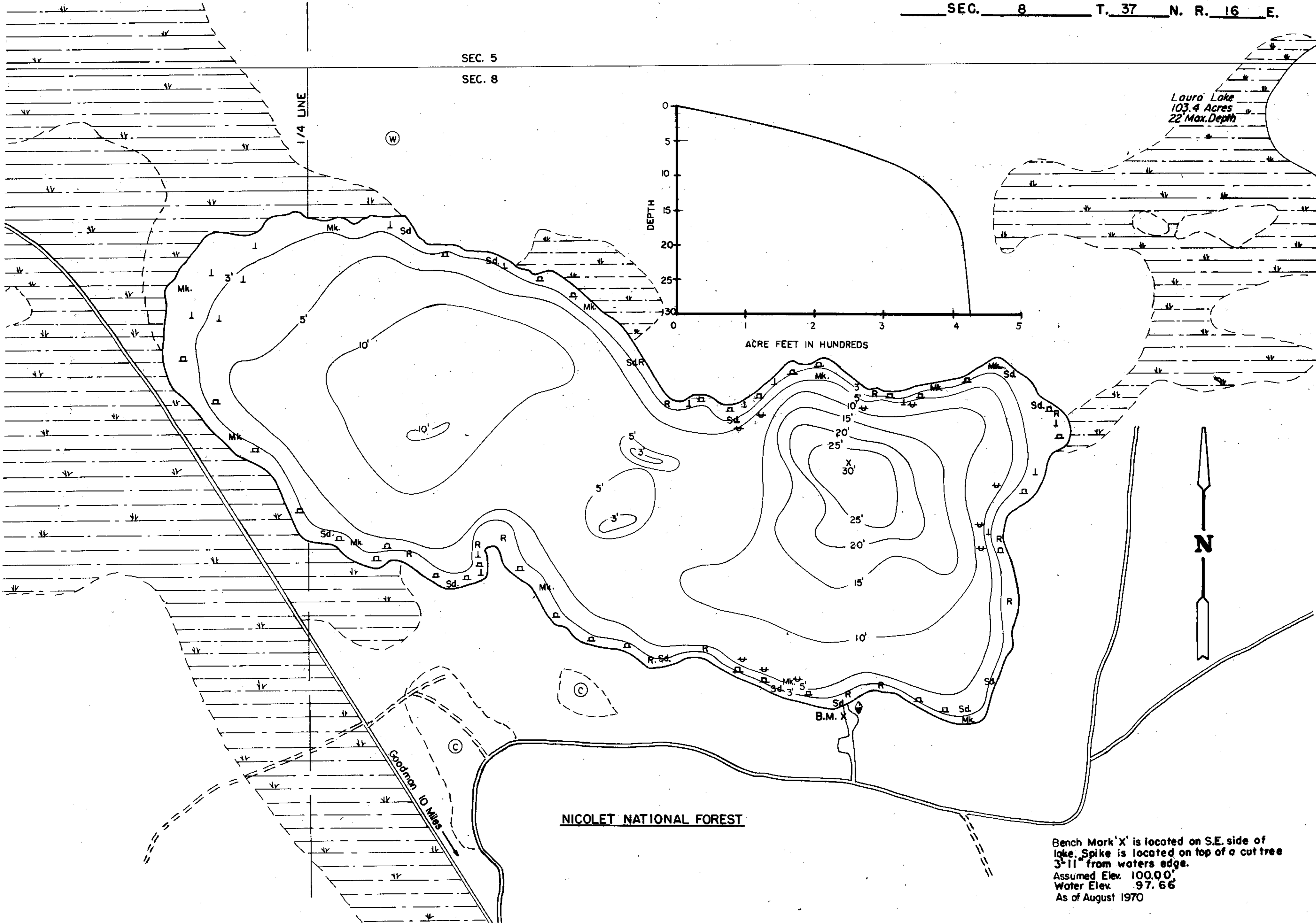

Louro Lake  
103.4 Acres  
22 Max. Depth

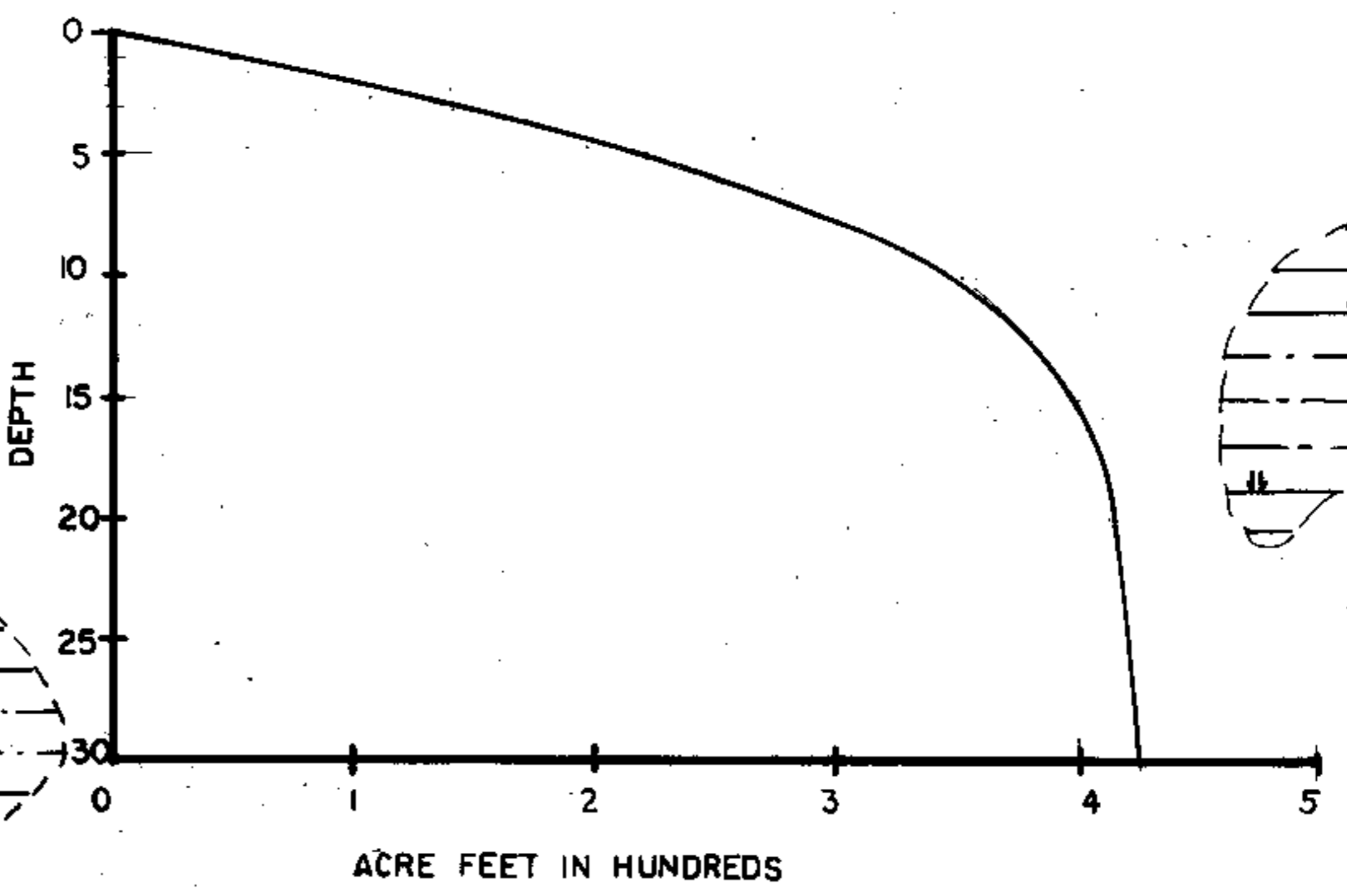

NICOLET NATIONAL FOREST

Bench Mark 'X' is located on S.E. side of lake. Spike is located on top of a cut tree 3'-11" from waters edge.  
Assumed Elev. 100.00'  
Water Elev. 97.66'  
As of August 1970

EQUIPMENT RECORDING SONAR MAPPED AUGUST 1970

- | TOPOGRAPHIC SYMBOLS   |                            | LAKE BOTTOM SYMBOLS |                             |
|-----------------------|----------------------------|---------------------|-----------------------------|
| (B) Brush             | Steep slope                | P. Peat             | B Boulders                  |
| (PW) Partially wooded | ----- Indefinite shoreline | Mk. Muck            | o Stumps & Snags            |
| (W) Wooded            | ----- Marsh                | C. Clay             | o Rock danger to navigation |
| (C) Cleared           | o Spring                   | M. Marl             | T Submergent vegetation     |
| (P) Pastured          | ----- Intermittent stream  | Sd. Sand            | L Emergent vegetation       |
| (A) Agricultural      | ----- Permanent inlet      | St. Silt            | F Floating vegetation       |
| B.M. Bench Mark       | ----- Permanent outlet     | Gr. Gravel          | + Brush shelters            |
| ■ Dwelling            | ----- Dam                  | R. Rubble           |                             |
| □ Resort              | D.N.R. State owned land    | Bc. Bedrock         |                             |
| □ Camp                |                            |                     |                             |



Access Access with Parking Boat Livery  
 Drawn by: J. Kuehn  
 Field work by: R. Crocker & J. Smith

SPECIES OF FISH	ABUNDANCE		
	Abundant	Common	Present
Muskie			
N. Pike			
Walleye			
L.M. Bass		X	
S.M. Bass			X
Panfish	X		
Trout			

WATER AREA 50.29 ACRES  
 UNDER 3 FT. 13 %  
 OVER 20 FT. 4 %  
 MAX. DEPTH 30 FEET.  
 TOTAL ALK. 1 P.P.M.  
 VOLUME 425.99 ACRE FT.  
 SHORELINE 1.39 MILES

Source: Wisconsin Department of Natural Resources 608-266-2621  
Gordon Lake – Forest County, Wisconsin DNR Lake Map  
Date – Aug 1970 - Historical Lake Map - Not for Navigation  
A Public Document - Please Identify the Source when using it.