

# LAKE SURVEY MAP

LAKE Scattered Rice  
 SECTION 25  
 TOWNSHIP 36 N  
 RANGE 14-15 E  
 TOWN OF LAONA  
 COUNTY FOREST

FORM FI-117

WISCONSIN CONSERVATION DEPARTMENT  
 BIOLOGY DIVISION  
 LAKE AND STREAM IMPROVEMENT SECTION

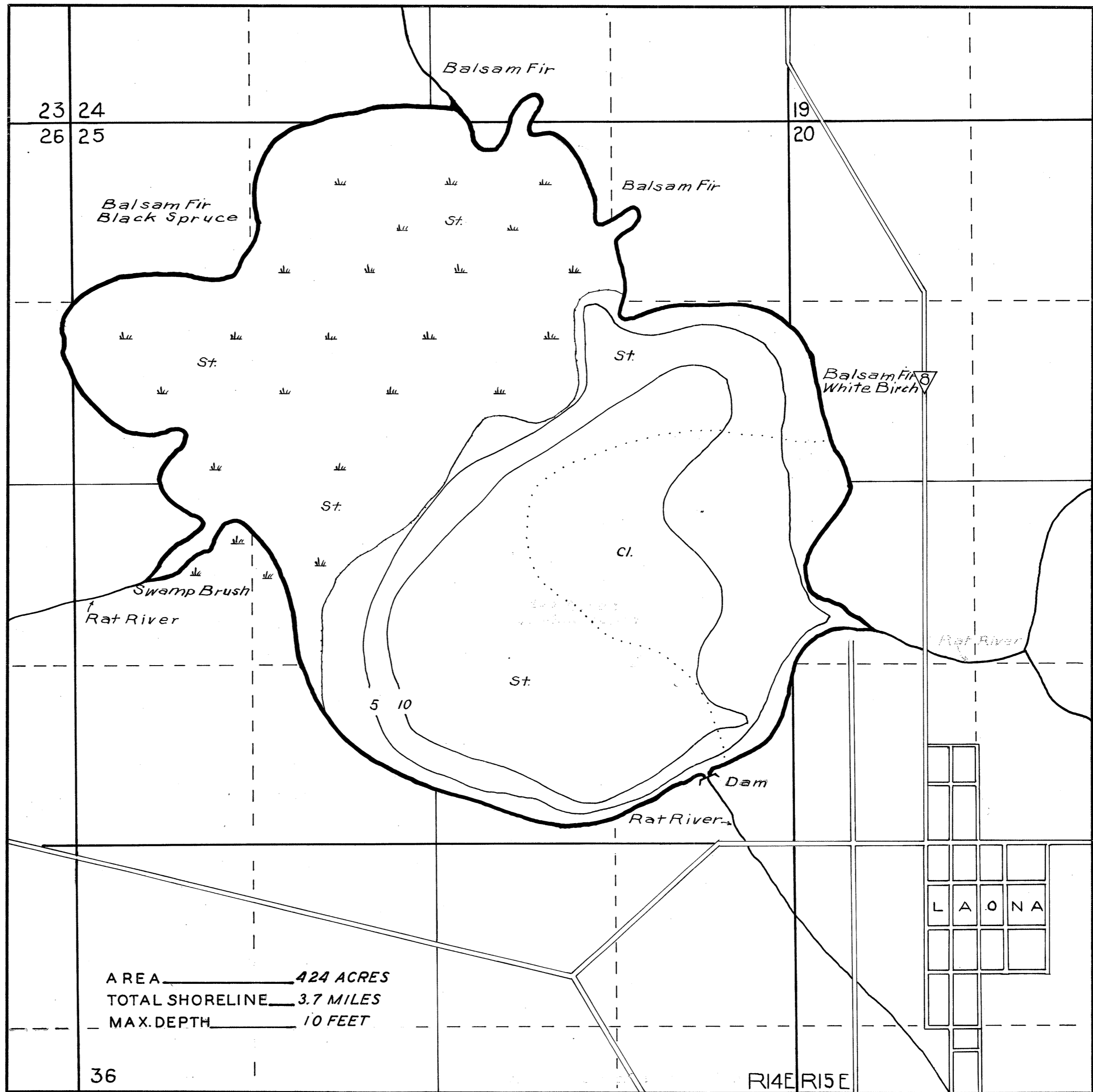

AREA 424 ACRES  
 TOTAL SHORELINE 3.7 MILES  
 MAX. DEPTH 10 FEET

DATE August 22, 1938  
 COMPILED BY.....  
 TRACED BY L. E. K.  
 SOURCE OF INFORMATION  
U.S. Forest Service  
Lake and Stream Survey  
 SOUNDINGS.....  
 DATES OF MAP REVISION.....  
 WORK AGENCY.....

## LAKE IMPROVEMENT RECORD

TYPE	DATE		
○ BRUSH REFUGES	.....	.....	.....
~ SAPLING TANGLES	.....	.....	.....
□ SPAWNING BOXES	.....	.....	.....
* MINNOW SPAWNERS	.....	.....	.....
TOTAL	.....	.....	.....

SCALE 1" = 660'

### LEGEND

- WEED BEDS
- ~ ROCKY SHOALS
- Sd SAND
- Cl. CLAY
- Gr. GRAVEL
- Mk MUCK
- DWELLING
- ABANDONED DWELLING
- ▣ RESORT
- St. SILT

Source: Wisconsin Department of Natural Resources 608-266-2621  
Scattered Rice Lake - Forest County, Wisconsin DNR Lake Map  
Date Aug 1938- Historical Lake Map - Not for Navigation  
A Public Document - Please Identify the Source when using it.