

B.M. 'X' LOCATED ON TOP OF NORTH DAM.
MARK IS THE 'O' IN WM. O. PLOTS & SONS.
ASSUMED ELEVATION 100.00'
WATER ELEVATION 95.70'

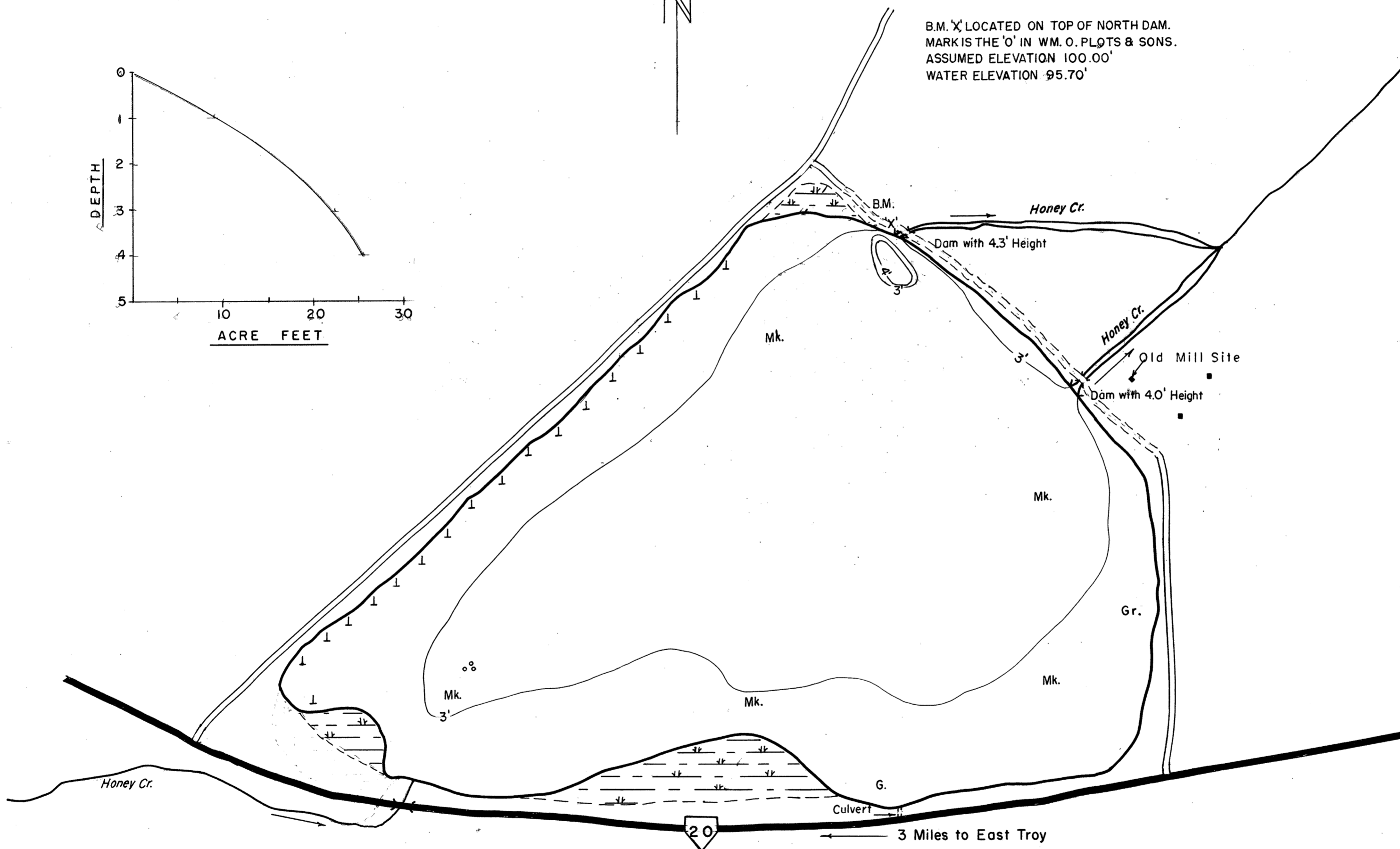

S.W. 1/4 Sec. 22
S.E. 1/4 Sec. 22

EQUIPMENT RECORDING SONAR MAPPED JUNE 1966
MO. YR.

WATER ELEV. 95.70'

- TOPOGRAPHIC SYMBOLS
- (B) Brush
 - (PW) Partially wooded
 - (W) Wooded
 - (C) Cleared
 - (P) Pastured
 - (A) Agricultural
 - B.M. Bench Mark
 - Dwelling
 - Resort
- LAKE BOTTOM SYMBOLS
- P. Peat
 - Mk. Muck
 - C. Clay
 - M. Marl
 - Sd. Sand
 - St. Silt
 - Gr. Gravel
 - R. Rubble
 - Br. Bedrock
 - T Submergent vegetation
 - ↓ Emergent vegetation
 - ⊠ Floating vegetation
 - ⊙ Stumps & Snags
- TOPOGRAPHIC SYMBOLS (continued):
- ||||| Steep slope
 - - - Indefinite shoreline
 - ⊠ Marsh
 - Spring
 - ⊠ Intermittent stream
 - ⊠ Permanent inlet
 - ⊠ Permanent outlet
 - ⊠ Dam

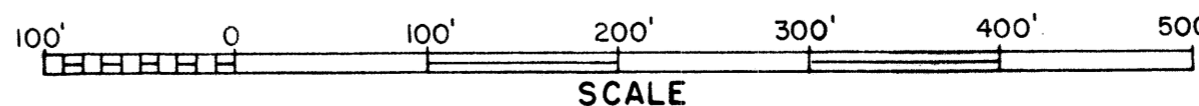

◇ Access ◇ Access with Parking ◆ Boat Livery
Field work by: H. Schwenn Drawn by: J. Roth

| SPECIES OF FISH | | |
|-----------------|----------|------|
| | Abundant | Rare |
| Muskie | | |
| N. Pike | | X |
| Walleye | | |
| L.M. Bass | | |
| S.M. Bass | | |
| Panfish | X | |
| Trout | | |

AREA 9.35 ACRES
UNDER 3 FT. 41 %
OVER 20 FT. 0 %
VOLUME 25.27 ACRE FT.
TOTAL ALK. 15.9 P.P.M.
SHORELINE .6 MILES
MAX. DEPTH 4 FEET

Source: Wisconsin Department of Natural Resources 608-266-2621
Hilburn Pond – Walworth County, Wisconsin DNR Lake Map
Date – Jun 1966 - Historical Lake Map - Not for Navigation
A Public Document - Please Identify the Source when using it.