

# LAKE SURVEY MAP

LAKE CLEAR  
 SECTION 20  
 TOWNSHIP 4-N  
 RANGE 13-E  
 TOWN MILTON  
 COUNTY ROCK

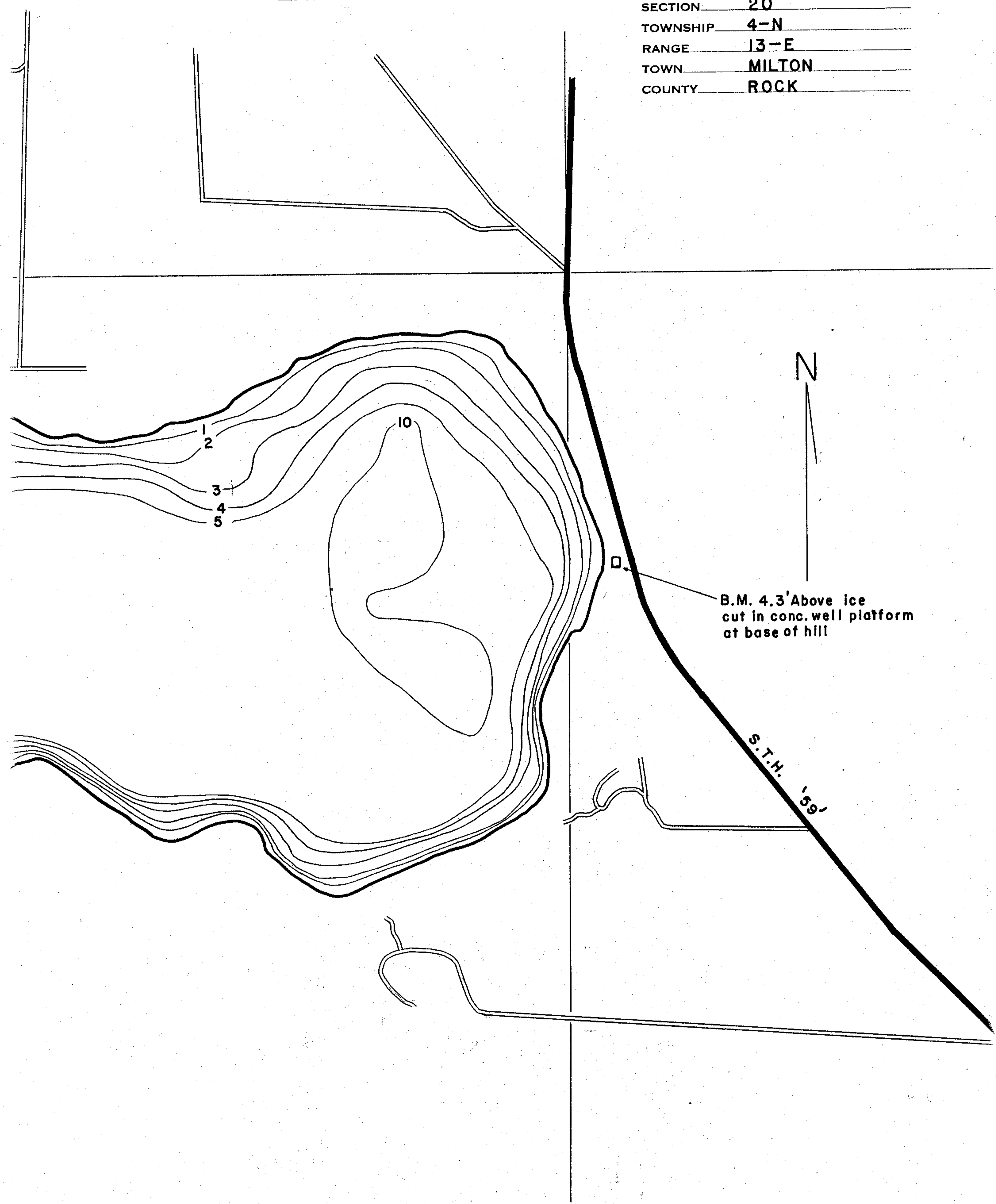

AREA 87.5 Acre's  
 TOTAL SHORELINE 1.1 Mile  
 MAX. DEPTH 12 Foot  
 SCALE: 1" = 300'

\_\_\_\_\_

\_\_\_\_\_

vey \_\_\_\_\_

\_\_\_\_\_

vals \_\_\_\_\_



DATE 1-28-54  
SOURCE OF INFORMATION W.C.D. Lake Survey  
Grids On ice  
SOUNDINGS 400' intervals

Source: Wisconsin Department of Natural Resources 608-266-2621  
Clear Lake – Rock County, Wisconsin DNR Lake Map  
Date – Jan 1954 - Historical Lake Map - Not for Navigation  
A Public Document - Please Identify the Source when using it.