

LAKE SURVEY MAP

Scupper Creek Pond

LAKE WAUKESHA COUNTY

SEC. 10 T. 6 N. R. 17 E.

Red Hardwoods

(A)

(W)
Mixed Hardwoods

T 6 N
10
R 17 E

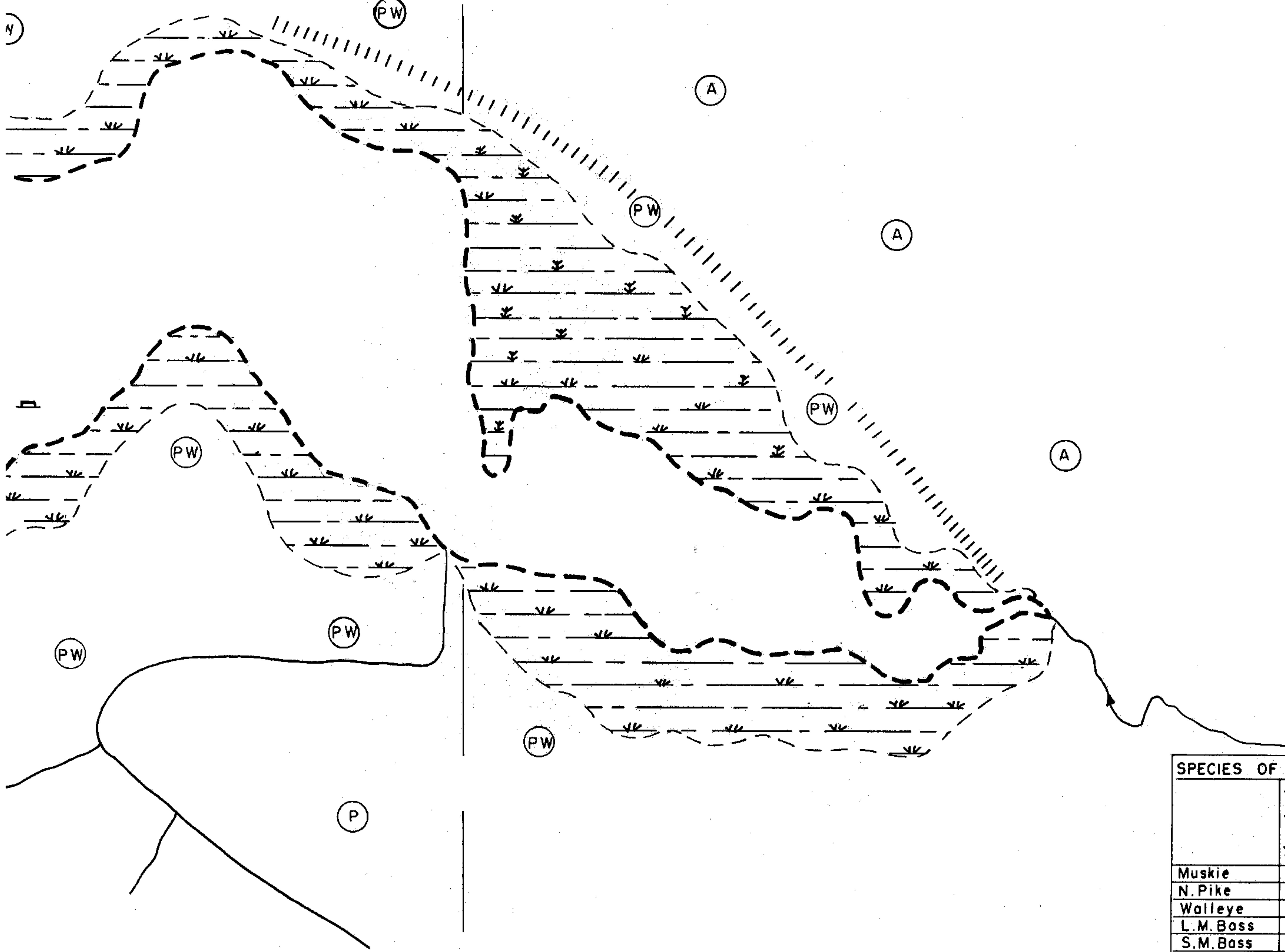
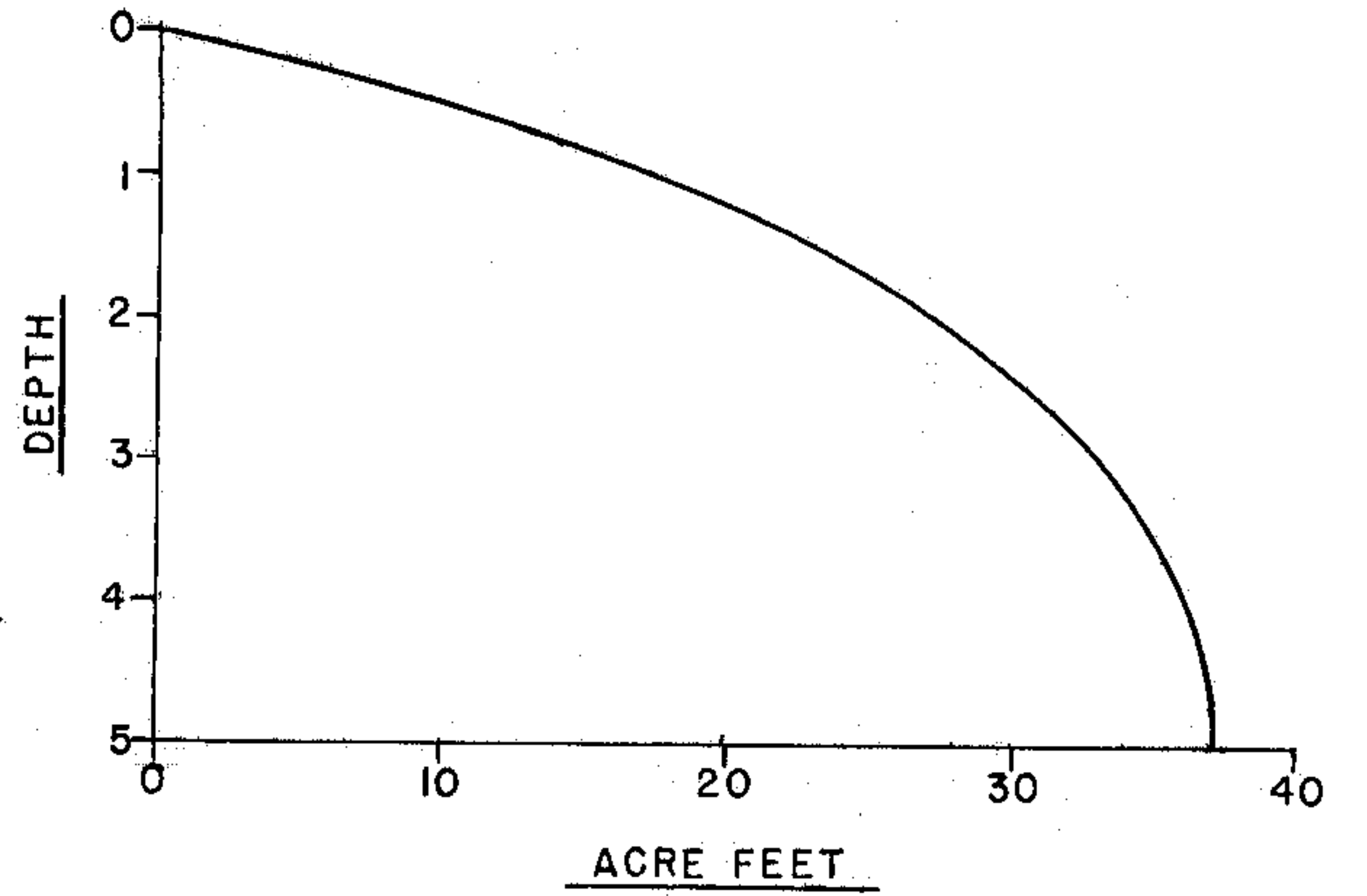

SPECIES OF FISH	Abundance		
	Abundant	Common	Rare
Muskie			
N. Pike			X
Walleye			
L.M. Bass			
S.M. Bass			
Panfish		X	
Trout			

AREA 20.38 ACRES
 UNDER 3 FT. 80 %
 OVER 20 FT. 0 %
 VOLUME 37.11 ACRE FT.
 TOTAL ALK. 310 P.P.M.
 SHORELINE 1.26 MILES
 MAX. DEPTH 5 FEET

logs



◇ Access ◀ Access with Parking ◆ Boat Livery

Mixed
Hardwoods
&
Conifers

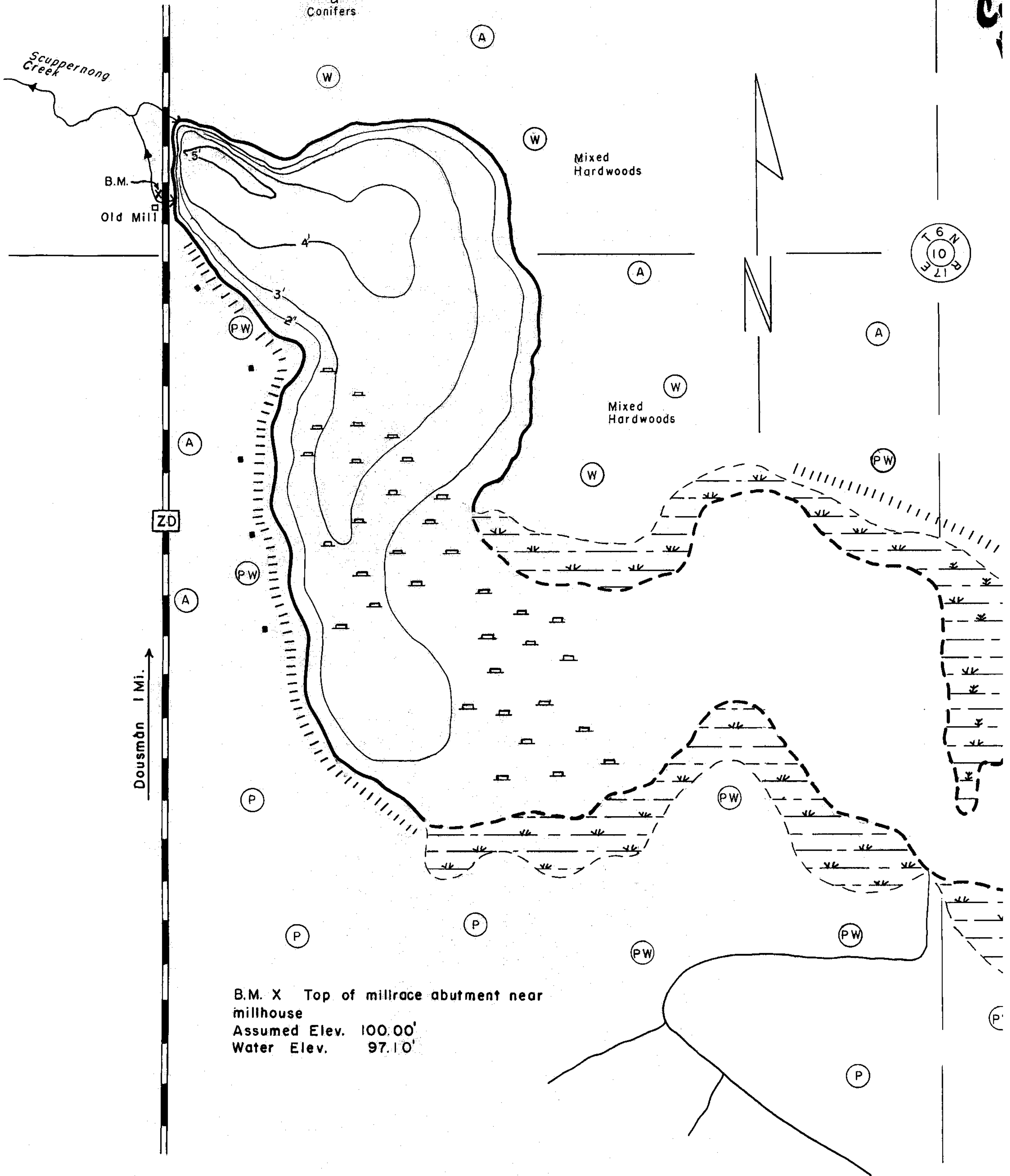

B.M. X Top of millrace abutment near millhouse
Assumed Elev. 100.00'
Water Elev. 97.10'

EQUIPMENT RANGE POLE MAPPED SEPT 1965
MO. YR.

- TOPOGRAPHIC SYMBOLS
- (B) Brush
 - (PW) Partially wooded
 - (W) Wooded
 - (C) Cleared
 - (P) Pastured
 - (A) Agricultural
 - B.M. Bench Mark
 - Dwelling
 - Resort
 - ||||| Steep slope
 - - - Indefinite shoreline
 - ⊕ Marsh
 - Spring
 - Intermittent stream
 - Permanent inlet
 - Permanent outlet
 - ⊥ Dam

- LAKE BOTTOM SYMBOLS
- P. Peat
 - Mk. Muck
 - C. Clay
 - M. Marl
 - Sd. Sand
 - St. Silt
 - Gr. Gravel
 - R. Rubble
 - Br. Bedrock
 - T Submergent vegetation
 - ↓ Emergent vegetation
 - ⊔ Floating vegetation
 - ⊙ Stumps & Snags

WATER ELEV. 97.10'

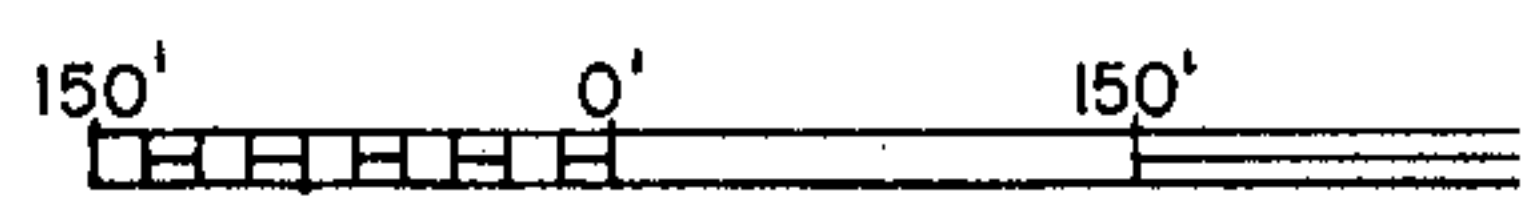

◇ Access ◀ Access with
Field work by: W. Byan

Source: Wisconsin Department of Natural Resources 608-266-2621
Scuppernong Lake – Waukesha County, Wisconsin DNR Lake Map
Date – Sep 1965 - Historical Lake Map - Not for Navigation
A Public Document - Please Identify the Source when using it.