

LAKE LOWER NEMAHBIN
 SECTION 24-25
 TOWNSHIP 7-N
 RANGE 17-E
 TOWN SUMMIT
 COUNTY WAUKESHA

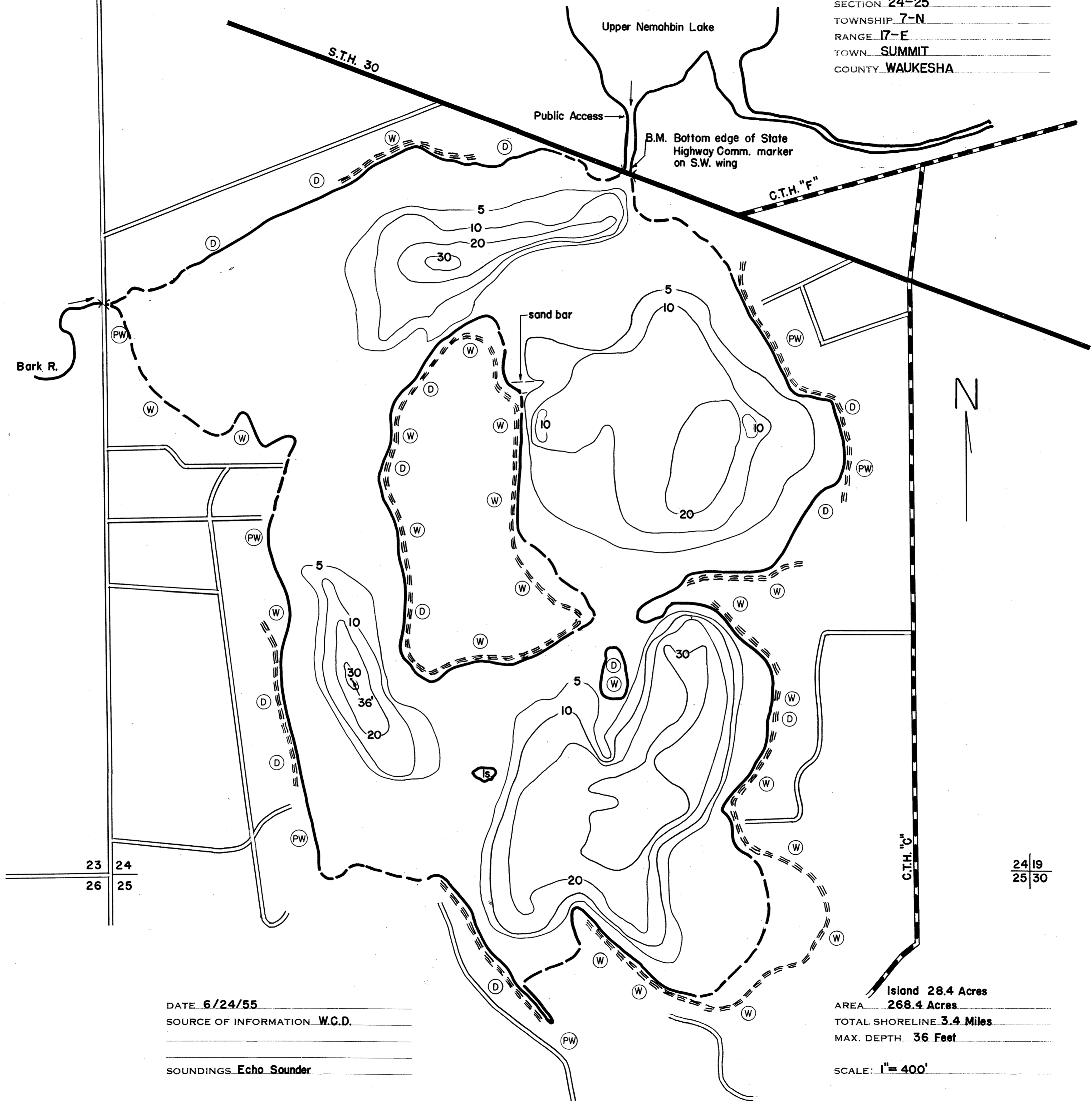

DATE 6/24/55
 SOURCE OF INFORMATION W.C.D.

 SOUNDINGS Echo Sounder

Island 28.4 Acres
 AREA 268.4 Acres
 TOTAL SHORELINE 3.4 Miles
 MAX. DEPTH 36 Feet
 SCALE: 1" = 400'

Source: Wisconsin Department of Natural Resources 608-266-2621
Lower Nemahbin Lake – Waukesha County, Wisconsin DNR Lake Map
Date – Jun 1955 - Historical Lake Map - Not for Navigation
A Public Document - Please Identify the Source when using it.