

LAKE KEESUS _____
 SECTION 11-12-13-14 _____
 TOWNSHIP 8-N _____
 RANGE 18-E _____
 TOWN MERTON _____
 COUNTY WAUKESHA _____

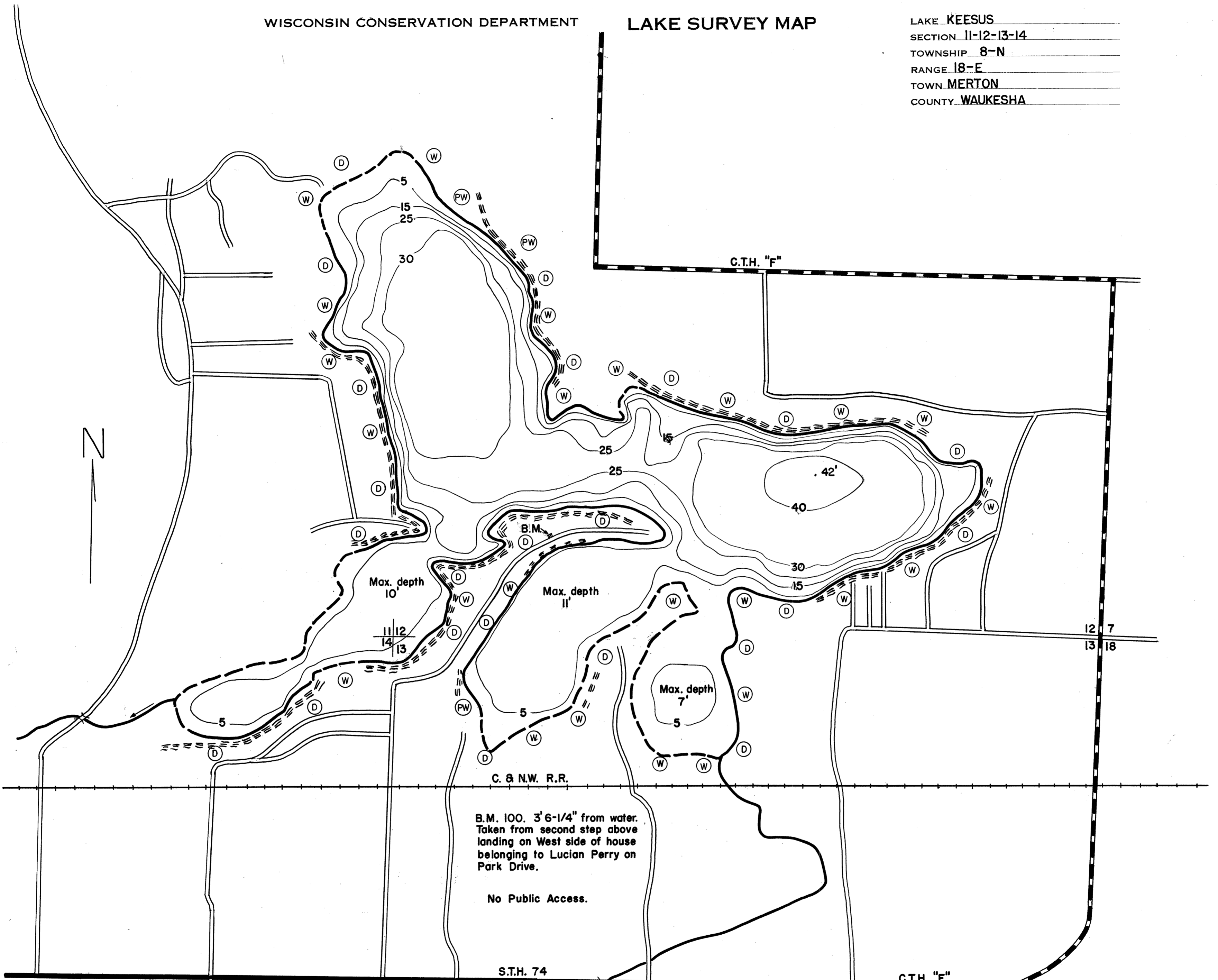

DATE 4/18/55
 SOURCE OF INFORMATION W.C.D.

 SOUNDINGS Echo Sounder

AREA 226.9 Acres
 TOTAL SHORELINE 5.3 Miles
 MAX. DEPTH 42 Feet
 SCALE: 1" = 500'

Source: Wisconsin Department of Natural Resources 608-266-2621
Keesus Lake – Waukesha County, Wisconsin DNR Lake Map
Date – Apr 1955 - Historical Lake Map - Not for Navigation
A Public Document - Please Identify the Source when using it.