

LAKE SURVEY MAP

WISCONSIN CONSERVATION DEPARTMENT
BIOLOGY DIVISION
LAKE AND STREAM IMPROVEMENT SECTION

LAKE BOLGER
SECTION 26-27
TOWNSHIP 39 N
RANGE 6 E
TOWN OF MINOCQUA
COUNTY ONEIDA

FORM FH17

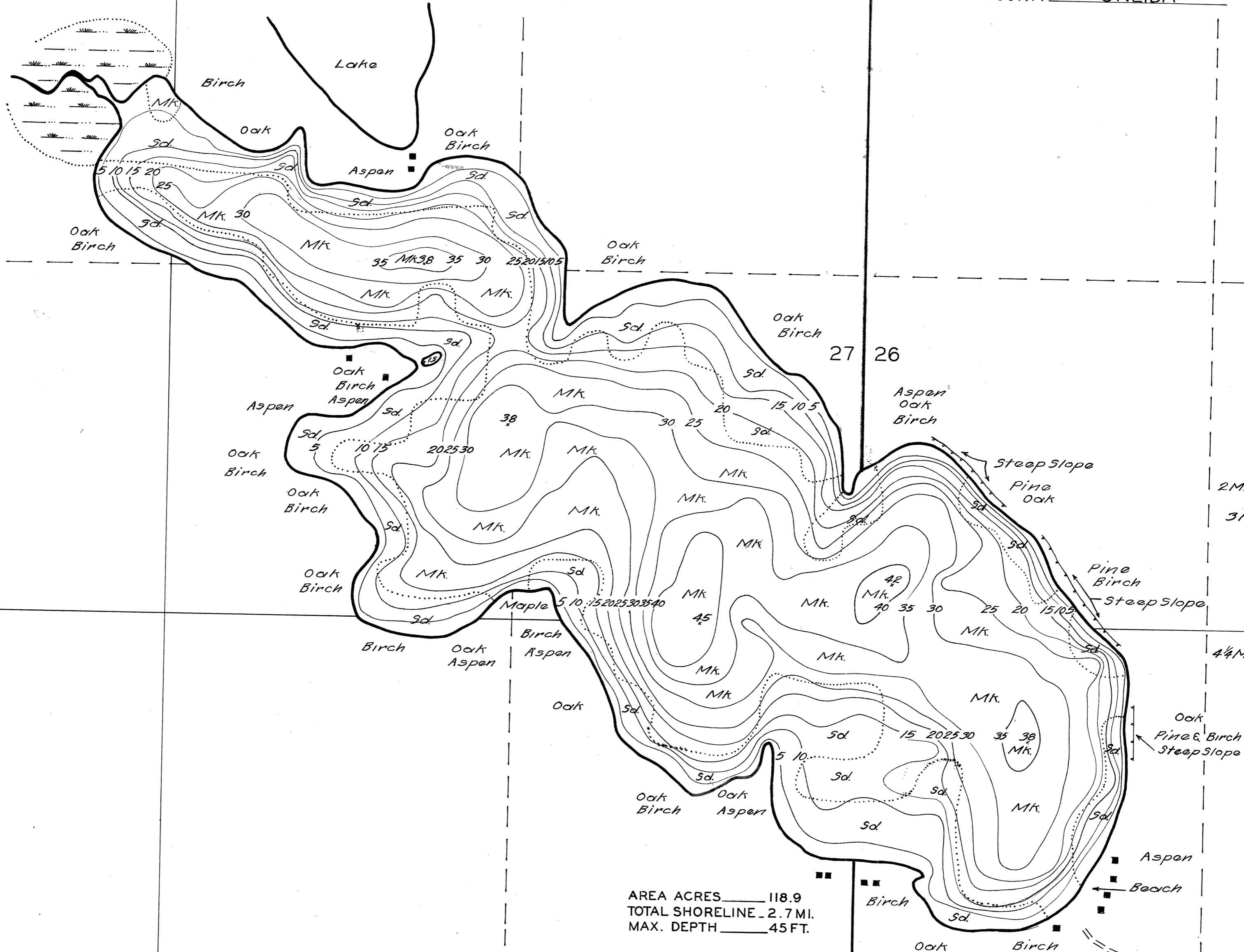

AREA ACRES 118.9
TOTAL SHORELINE 2.7 MI.
MAX. DEPTH 45 FT.

DATE SEPT 4 1941
COMPILED BY _____
TRACED BY W.T.Z. (WPA)
SOURCE OF INFORMATION _____
CAMP BLUE LAKE
LAKE SURVEY PROJECT FEB 1941
SOUNDINGS AT 150 FT. INTERVALS _____
DATES OF MAP REVISION _____
WORK AGENCY C.C.C.

LAKE IMPROVEMENT RECORD

TYPE	DATE		
○ BRUSH REFUGES	_____	_____	_____
— SAPLING TANGLES	_____	_____	_____
□ SPAWNING BOXES	_____	_____	_____
* MINNOW SPAWNERS	_____	_____	_____
TOTAL	_____	_____	_____

SCALE 1 INCH EQUALS 300 FT.
0 50 100 200 300 400 500 FT.

- #### LEGEND
- WEEDBEDS
 - ROCKY SHOALS
 - Sd. SAND
 - CLAY
 - GR. GRAVEL
 - MK. MUCK
 - DWELLING
 - ABANDONED DWELLING
 - ▣ RESORT

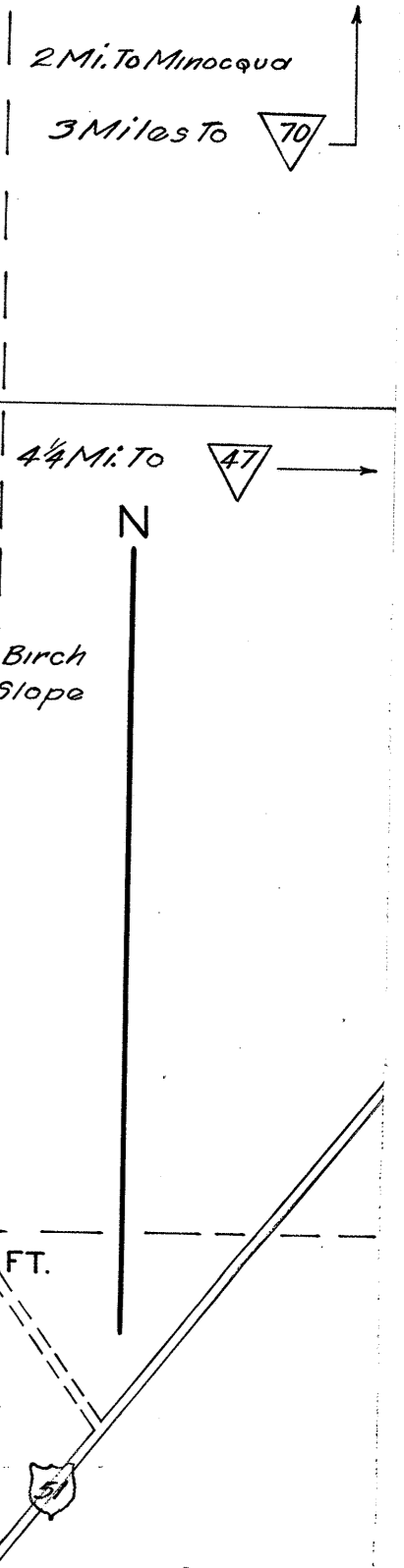

Source: Wisconsin Department of Natural Resources 608-266-2621
Bolger Lake – Oneida County, Wisconsin DNR Lake Map
Date – Sep 1941 - Historical Lake Map - Not for Navigation
A Public Document - Please Identify the Source when using it.