

B.M. X D.N.R. 1673-A Brass cap set in concrete post 40' N. of access road, III' W. of water at public boat landing on N.W. side of lake  
Assumed elevation 100.00'  
Water level 92.32'  
Taken September 11, 1972

EQUIPMENT RECORDING SONAR MAPPED JULY 1973

- TOPOGRAPHIC SYMBOLS
- (B) Brush
  - (PW) Partially wooded
  - (W) Wooded
  - (C) Cleared
  - (P) Pastured
  - (A) Agricultural
  - B.M. Bench Mark
  - Dwelling
  - Resort
  - ⊠ Camp

- LAKE BOTTOM SYMBOLS
- P. Peat
  - Mk. Muck
  - C. Clay
  - M. Marl
  - Sd. Sand
  - St. Silt
  - Gr. Gravel
  - R. Rubble
  - Br. Bedrock
  - ||||| Steep slope
  - - - Indefinite shoreline
  - Marsh
  - Spring
  - Intermittent stream
  - Permanent inlet
  - Permanent outlet
  - Dam
  - D.N.R. State owned land
  - B Boulders
  - Stumps & Snags
  - Rock danger to navigation
  - T Submergent vegetation
  - Emergent vegetation
  - Floating vegetation
  - Brush shelters

400' 0' 400' 800' 1200' 1600'

SCALE

◆ Access    ◆ Access with Parking    ◆ Boat Livery

Drawn by: C. Holt  
Field work by: J. Smith

SPECIES OF FISH	ABUNDANCE		
	Abundant	Common	Present
Muskie			X
N. Pike			X
Walleye	X		
L.M. Bass			X
S.M. Bass	X		
Panfish	X		
Trout			
Cisco			X

WATER AREA 845.8 ACRES  
UNDER 3 FT. 3 %  
OVER 20 FT. 62 %  
MAX. DEPTH 95 FEET.  
TOTAL ALK. 10 P.P.M.  
VOLUME 26,206 ACRE FT.  
SHORELINE 12.43 MILES  
SHORELINE 13.76 MILES WITH IS.

# LAKE SURVEY MAP

CLEAR LAKE ONEIDA COUNTY  
SEC. 9, 10, 15, 16, 17, 21 T. 39 N. R. 7 E.  
SHEET 2 OF 3

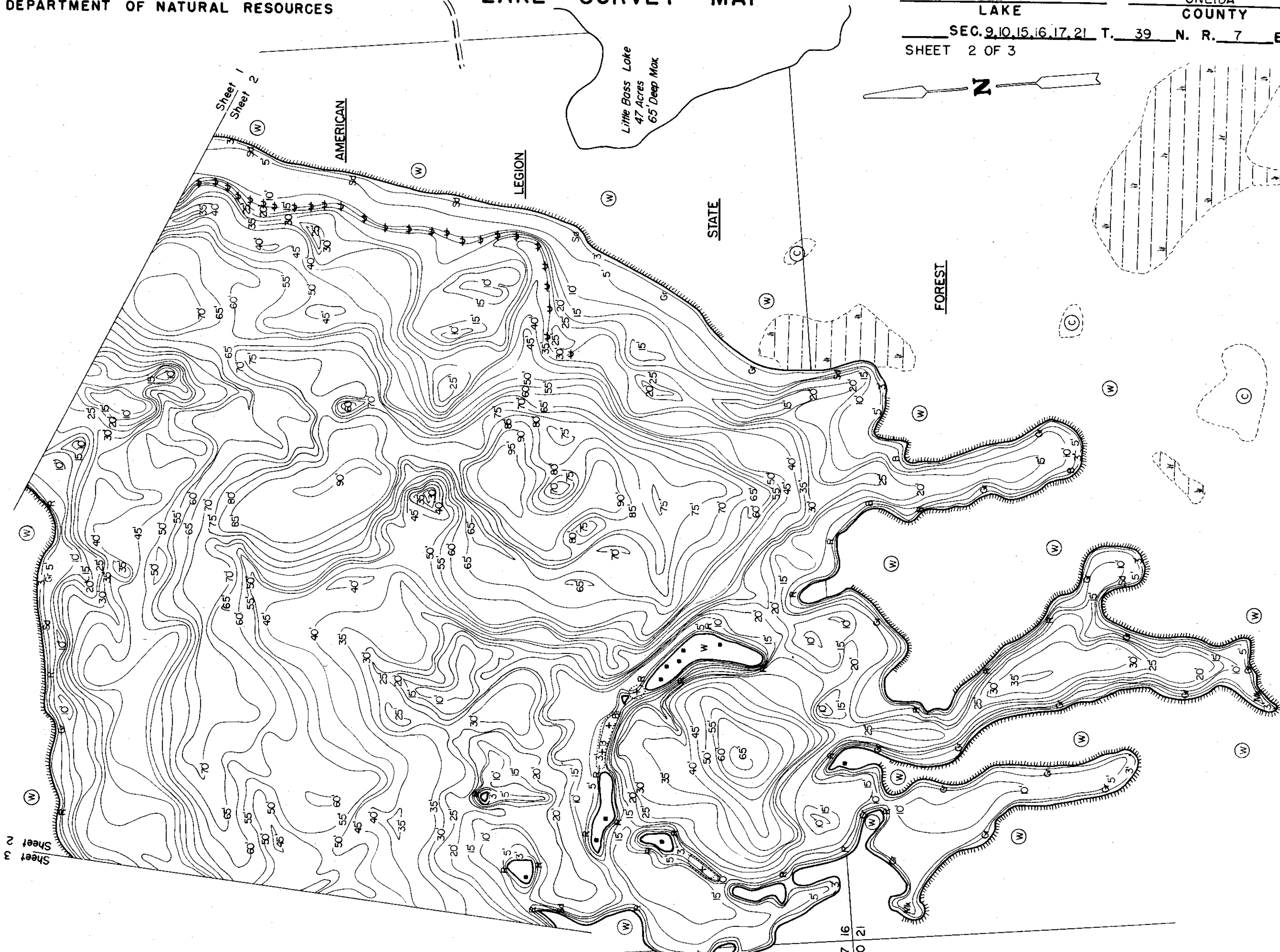
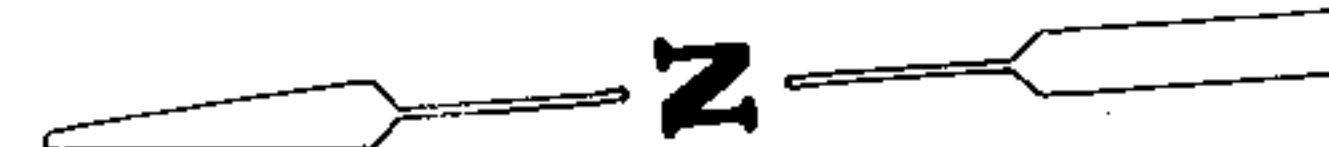

EQUIPMENT RECORDING SONAR MAPPED

JULY 1973  
MONTH YEAR  
LAKE BOTTOM SYMBOLS

- TOPOGRAPHIC SYMBOLS**
- (B) Brush
  - (PW) Partially wooded
  - (W) Wooded
  - (C) Cleared
  - (P) Pastured
  - (A) Agricultural
  - B.M. Bench Mark
  - Dwelling
  - Resort
  - ⊠ Camp
  - ||||| Steep slope
  - Indefinite shoreline
  - ⊞ Marsh
  - Spring
  - Intermittent stream
  - Permanent inlet
  - Permanent outlet
  - ⊥ Dam
  - D.N.R. State owned land

- P. Peat
- Mk. Muck
- C. Clay
- M. Marl
- Sd. Sand
- Sl. Silt
- Gr. Gravel
- R. Rubble
- Br. Bedrock
- B Boulders
- ⊙ Stumps & Snags
- ⊙ Rock danger to navigation
- T Submergent vegetation
- ⊥ Emergent vegetation
- ⊥ Floating vegetation
- ⊙ Brush shelters



◆ Access    ◆ Access with Parking    ◆ Boat Livery

Drawn by: C. Holt  
Field work by: J. Smith

SPECIES OF FISH	ABUNDANCE		
	Abundant	Common	Present
Muskie			X
N. Pike			X
Walleye	X		
L.M. Bass	X		X
S.M. Bass	X		
Panfish	X		
Trout			
Cisco			X

WATER AREA 845.8 ACRES  
 UNDER 3 FT. 3 %  
 OVER 20 FT. 26 %  
 MAX. DEPTH 95 FEET.  
 TOTAL ALK. 10 P.P.M.  
 VOLUME 26,206 ACRE FT.  
 SHORELINE 12.43 MILES  
 SHORELINE 13.76 MILES WITH IS.

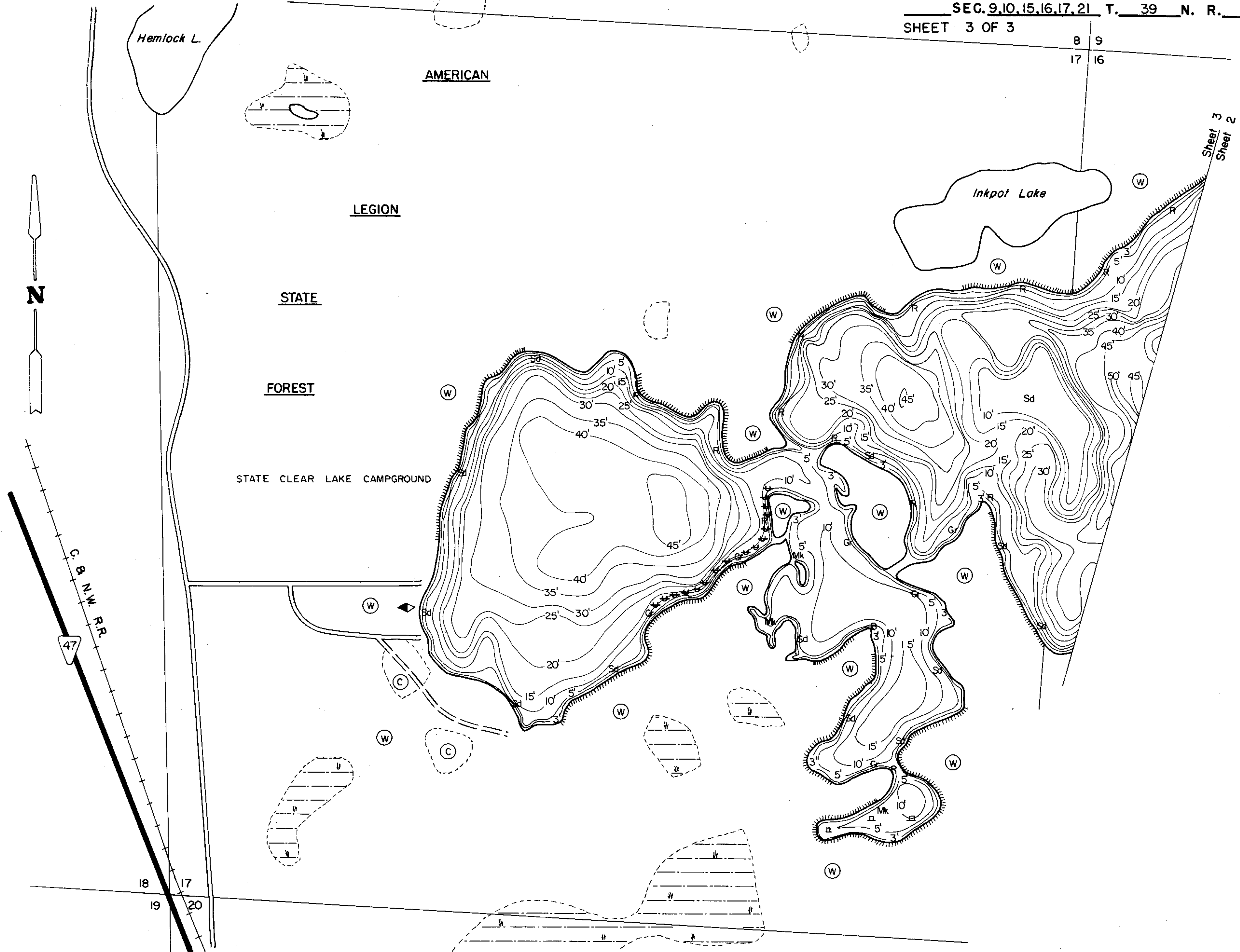

EQUIPMENT RECORDING SONAR MAPPED JULY 1973  
MONTH YEAR

- TOPOGRAPHIC SYMBOLS**
- (B) Brush
  - (PW) Partially wooded
  - (W) Wooded
  - (C) Cleared
  - (P) Pastured
  - (A) Agricultural
  - B.M. Bench Mark
  - Dwelling
  - Resort
  - Camp
  - ||||| Steep slope
  - - - Indefinite shoreline
  - Marsh
  - Spring
  - Intermittent stream
  - Permanent inlet
  - Permanent outlet
  - Dam
  - D.N.R. State owned land

- LAKE BOTTOM SYMBOLS**
- P. Peat
  - Mk. Muck
  - C. Clay
  - M. Marl
  - Sd. Sand
  - St. Silt
  - Gr. Gravel
  - R. Rubble
  - Br. Bedrock
  - B Boulders
  - Stumps & Snags
  - Rock danger to navigation
  - T Submergent vegetation
  - Emergent vegetation
  - Floating vegetation
  - Brush shelters



Access Access with Parking Boat Livery

Drawn by: C. Holt  
Field work by: J. Smith

SPECIES OF FISH	Abundant Common Present		
	Abundant	Common	Present
Muskie			X
N. Pike			
Walleye		X	
L.M. Bass		X	
S.M. Bass		X	
Panfish	X		
Trout			
Cisco			X

WATER AREA 845.8 ACRES  
 UNDER 3 FT. 3 %  
 OVER 20 FT. 62 %  
 MAX. DEPTH 95 FEET.  
 TOTAL ALK. 10 P.P.M.  
 VOLUME 26,206 ACRE FT.  
 SHORELINE 12.43 MILES  
 SHORELINE 13.76 MILES WITH IS.

Source: Wisconsin Department of Natural Resources 608-266-2621  
Clear Lake – Oneida County, Wisconsin DNR Lake Map  
Date – Jul 1973 - Historical Lake Map - Not for Navigation  
A Public Document - Please Identify the Source when using it.