

LAKE SURVEY MAP

LAKE SAND FORM FI-11
 SECTION 25 26 35 36
 TOWNSHIP 20 N
 RANGE 8 E
 TOWN OF PLAINFIELD
 COUNTY WAUSHARA

WISCONSIN CONSERVATION DEPARTMENT
 BIOLOGY DIVISION
 LAKE AND STREAM IMPROVEMENT SECTION

Oak & Jack Pine

2 Miles To Plainfield

3 Miles N. To 

1 Mile W. To 

4 Miles S To 

1/2 Mile W To MStP&SStEM

AREA ACRES 143.2
 TOTAL SHORELINE 3.3 Mi.
 MAX. DEPTH 9 Ft.

DATE July 2, 1941
 COMPILED BY _____
 TRACED BY N.L.M. (W.P.A.)
 SOURCE OF INFORMATION _____
W.P.A. Lake Survey Project
Feb. 1941
 SOUNDINGS At 100 Ft. Intervals
 DATES OF MAP REVISION _____
 WORK AGENCY W. P. A.

LAKE IMPROVEMENT RECORD

TYPE	DATE			
BRUSH REFUGES	_____	_____	_____	_____
SAPLING TANGLES	_____	_____	_____	_____
SPAWNING BOXES	_____	_____	_____	_____
MINNOW SPAWNERS	_____	_____	_____	_____
TOTAL	_____	_____	_____	_____

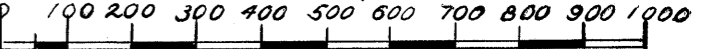
SCALE *1 inch Equals 300 Ft.*

- #### LEGEND
- WEED BEDS
 - ROCKY SHOALS
 - Sd* SAND
 - Cl* CLAY
 - Gr.* GRAVEL
 - Mk.* MUCK
 - DWELLING
 - ABANDONED DWELLING
 - RESORT

*Checked
 W.P.S.
 D.A.B.
 7/10/41*

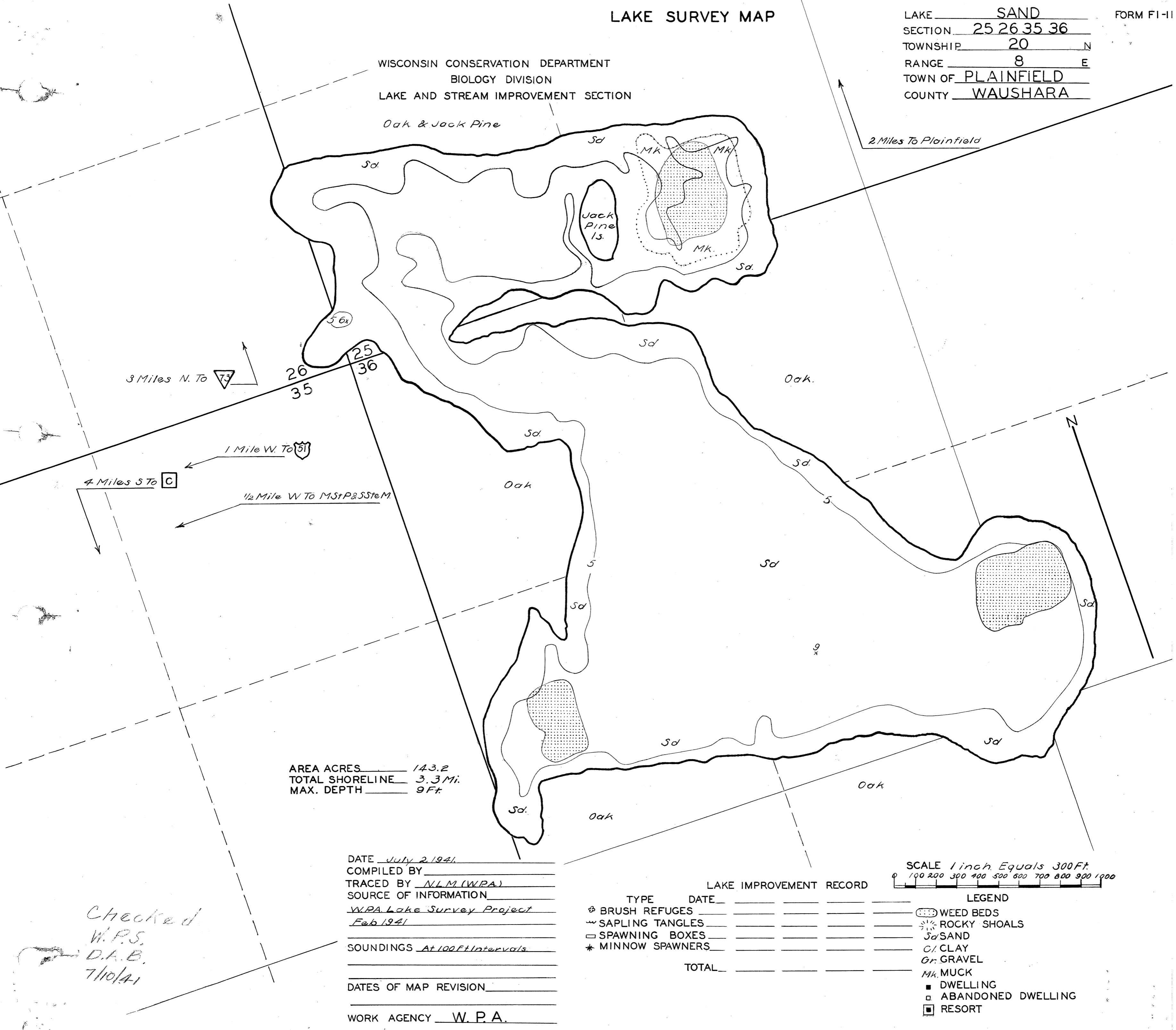

Source: Wisconsin Department of Natural Resources 608-266-2621

Sand Lake – Waushara County, Wisconsin DNR Lake Map

Date – Jul 1941 - Historical Lake Map - Not for Navigation

A Public Document - Please Identify the Source when using it.