

LAKE SURVEY MAP

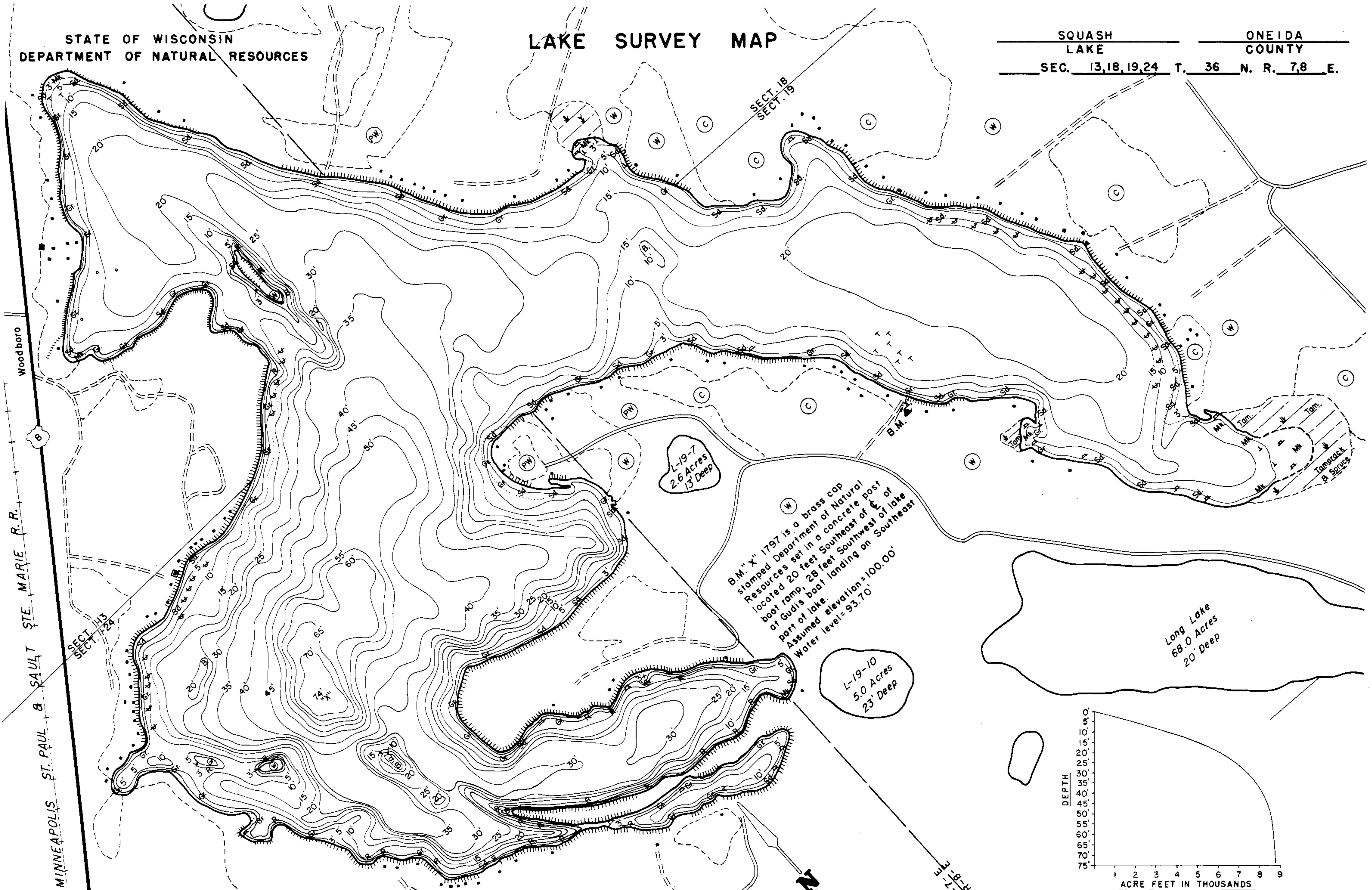

EQUIPMENT RECORDING SONAR MAPPED AUGUST 1975
MONTH YEAR

TOPOGRAPHIC SYMBOLS		LAKE BOTTOM SYMBOLS	
(B) Brush	Steep slope	P. Peat	B Boulders
(PW) Partially wooded	----- Indefinite shoreline	Mk. Muck	⊙ Stumps & Snags
(C) Wooded	⊕ Marsh	C. Clay	⊙ Rock danger to navigation
(O) Cleared	⊕ Marsh	M. Marl	T Submergent vegetation
(P) Pastured	~ Intermittent stream	Sd. Sand	⊥ Emergent vegetation
(A) Agricultural	Permanent inlet	St. Silt	⊕ Floating vegetation
B.M. Bench Mark	Permanent outlet	Gr. Gravel	⊕ Brush shelters
■ Dwelling	⊥ Dam	R. Rubble	
□ Resort	D.N.R. State owned land	Br. Bedrock	
⊕ Camp			

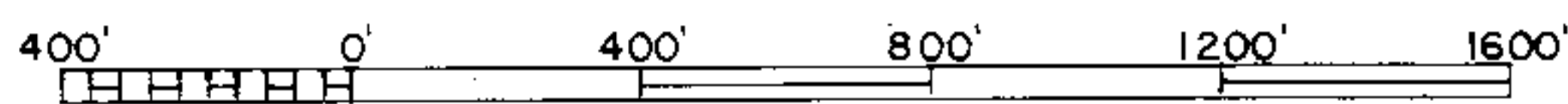

Access Access with Parking Boat Livery
 Drawn by: G. Thuesen
 Field work by: J. Smith, K. Arnold

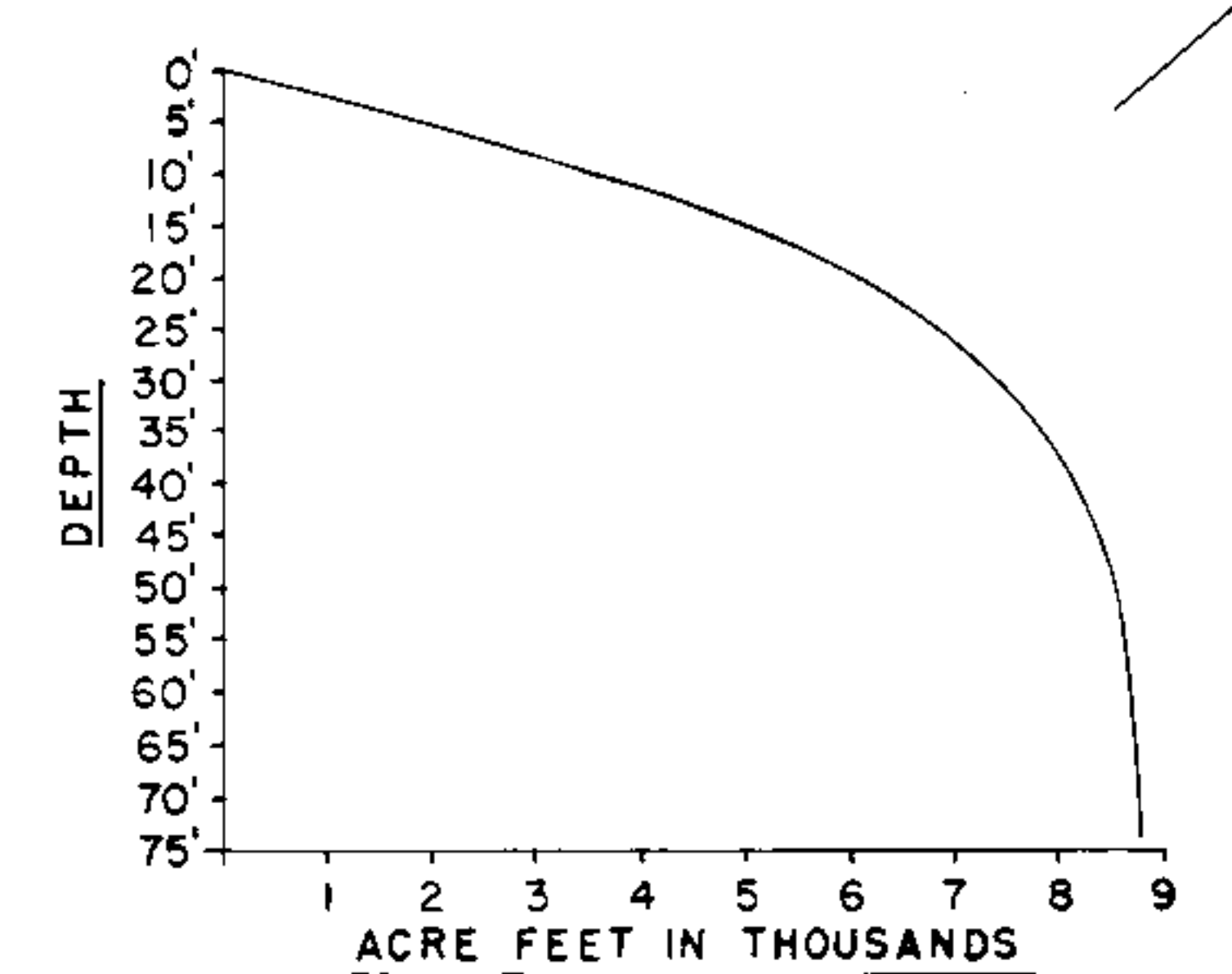

SPECIES OF FISH	Abundance	
	Abundant	Common
Muskie		
N. Pike		X
Walleye	X	
L. M. Bass		X
S. M. Bass	X	
Panfish	X	
Trout		

WATER AREA 395.8 ACRES
 UNDER 3 FT. 4.01 %
 OVER 20 FT. 49.29 %
 MAX. DEPTH 74 FEET.
 TOTAL ALK. 19 P.P.M.
 VOLUME 8748.55 ACRE FT.
 MAIN SHORELINE 7.1 MI.
 ISLAND SHORELINE .29 MI.

Source: Wisconsin Department of Natural Resources 608-266-2621
Squash Lake – Oneida County, Wisconsin DNR Lake Map
Date – Aug 1975 - Historical Lake Map - Not for Navigation
A Public Document - Please Identify the Source when using it.