

NOTE:
Hydrographic data was compiled from field work done by the College of Natural Resources, University of Wisconsin, Stevens Point, Wis.
Planimetric data compiled from U.S.G.S. Quadrangles based on Aerial Photographs
Approximate Bottom Soil Types: Sand 70%, Gravel 10%, Muck 20%

- EQUIPMENT RECORDING SONAR MAPPED SUMMER 1974
- | TOPOGRAPHIC SYMBOLS | | LAKE BOTTOM SYMBOLS | |
|-----------------------|---------------------------|---------------------|-----------------------------|
| (B) Brush | Steep slope | P. Peat | B. Boulders |
| (PW) Partially wooded | ~ Indefinite shoreline | Mk. Muck | ☼ Stumps & Snags |
| (W) Wooded | ☼ Marsh | C. Clay | ☼ Rock danger to navigation |
| (C) Cleared | ☼ Spring | M. Marl | T Submergent vegetation |
| (P) Pastured | ~ Intermittent stream | Sd. Sand | ⊥ Emergent vegetation |
| (A) Agricultural | ~ Permanent inlet | St. Silt | ☼ Floating vegetation |
| B.M. Bench Mark | ~ Permanent outlet | Gr. Gravel | ☼ Brush shelters |
| ■ Dwelling | ~ Dam | R. Rubble | |
| ■ Resort | ~ D.N.R. State owned land | Br. Bedrock | |
| ■ Camp | | | |

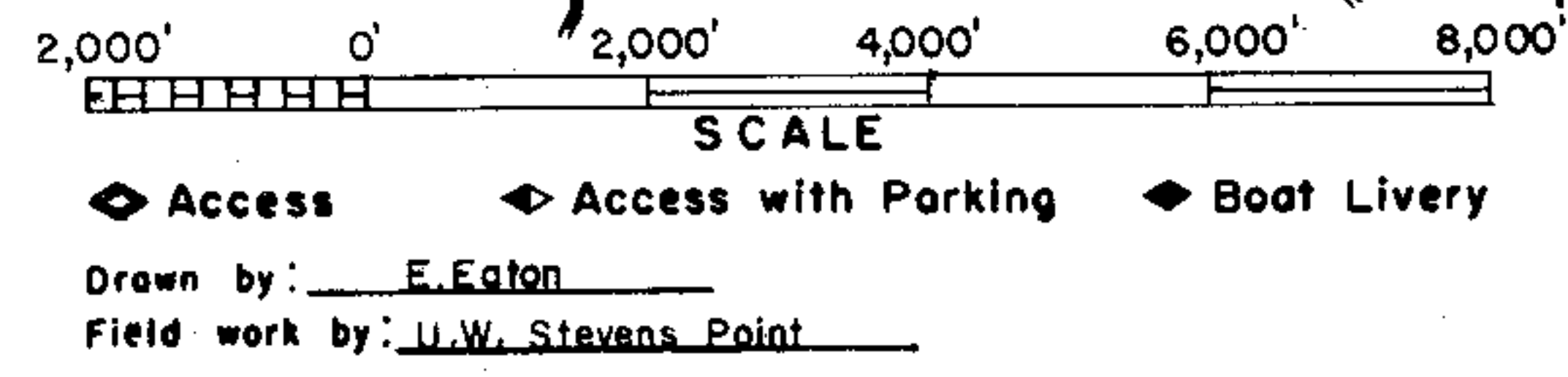
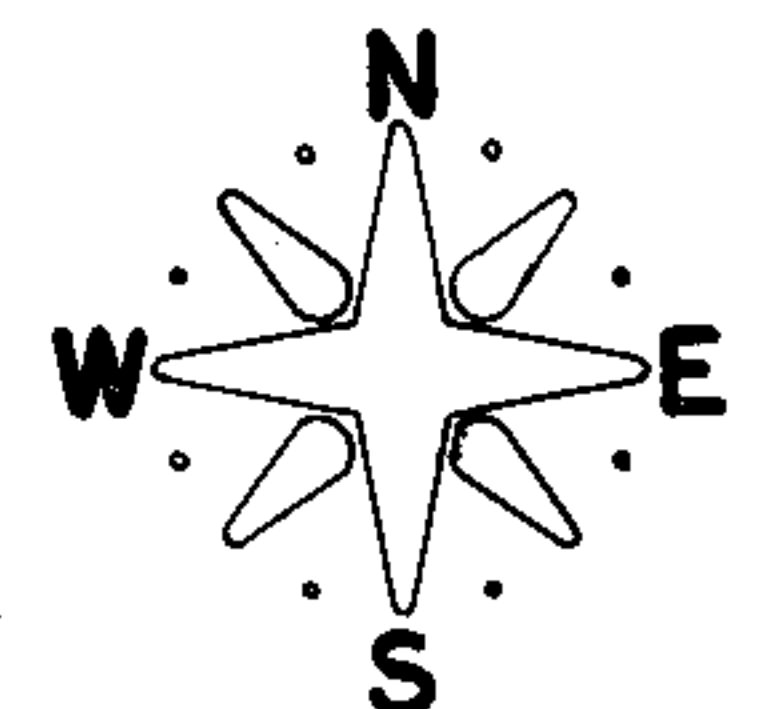

SPECIES OF FISH	Abundance		
	Abundant	Common	Present
Muskie			X
N. Pike			X
Walleye			X
L. M. Bass			X
S. M. Bass			X
Panfish	X		
Trout			

WATER AREA 13,955.3 ACRES
 UNDER 3 FT. 15 %
 OVER 20 FT. 17 %
 MAX. DEPTH 35 FEET.
 TOTAL ALK. 31 P.P.M.
 VOLUME 172,050.4 ACRE FT.
 MAIN SHORELINE 72.94 MI.
 ISLAND SHORELINE 32.12 MI.



Sheet '3'
Sheet '2'
Sheet '2'
Sheet '1'

- EQUIPMENT RECORDING SONAR MAPPED SUMMER 1974
MONTH YEAR
- TOPOGRAPHIC SYMBOLS
- (B) Brush
 - (PW) Partially wooded
 - (W) Wooded
 - (C) Cleared
 - (P) Pastured
 - (A) Agricultural
 - B.M. Bench Mark
 - Dwelling
 - Resort
 - ⊠ Camp
 - ||||| Steep slope
 - ~ Indefinite shoreline
 - Marsh
 - Spring
 - Intermittent stream
 - Permanent inlet
 - Permanent outlet
 - Dam
 - D.N.R. State owned land
- LAKE BOTTOM SYMBOLS
- P. Peat
 - Mk. Muck
 - C. Clay
 - M. Marl
 - Sd. Sand
 - St. Silt
 - Gr. Gravel
 - R. Rubble
 - Br. Bedrock
 - B Boulders
 - Stumps & Snags
 - Rock danger to navigation
 - T Submergent vegetation
 - Emergent vegetation
 - Floating vegetation
 - Brush shelters

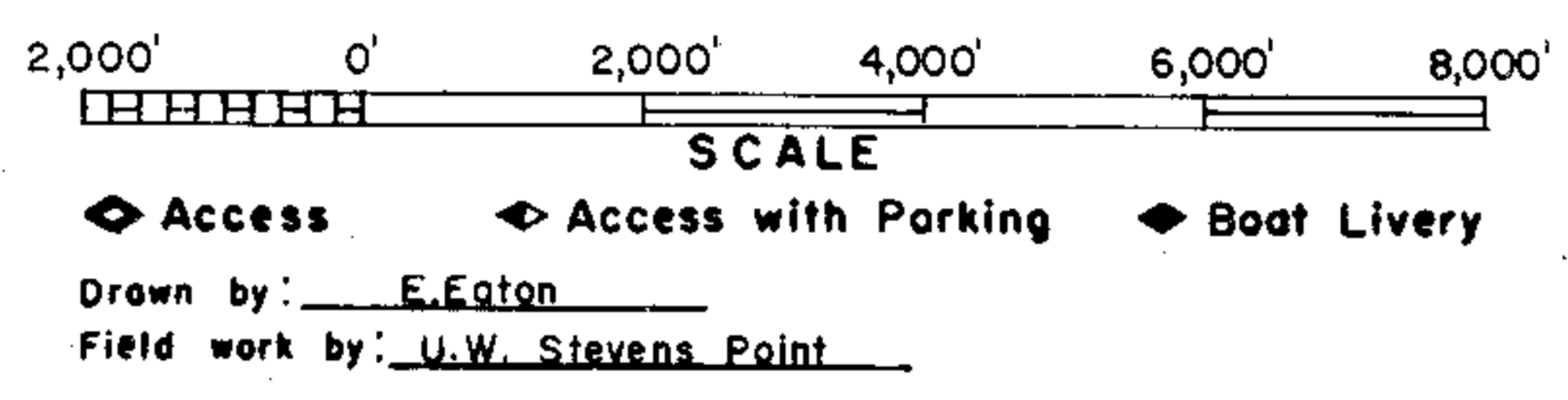
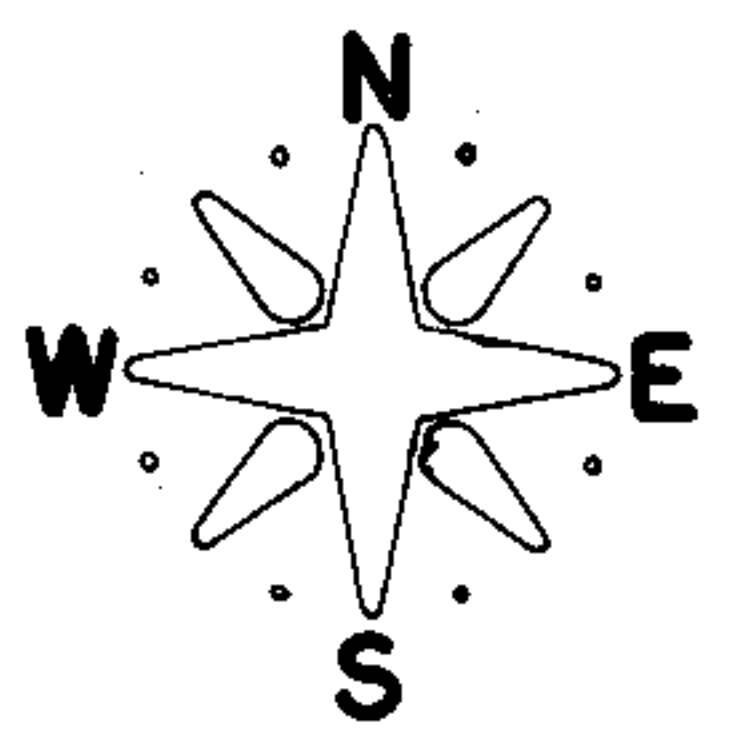

SPECIES OF FISH	Abundance		
	Abundant	Common	Present
Muskie			
N. Pike			X
Wolleye			X
L.M. Bass			X
S.M. Bass			X
Panfish	X		
Trout			

WATER AREA 13,955.3 ACRES
 UNDER 3 FT. 15 %
 OVER 20 FT. 17 %
 MAX. DEPTH 35 FEET.
 TOTAL ALK. 31 P.P.M.
 VOLUME 172,050.4 ACRE FT.
 MAIN SHORELINE 72.94 MI.
 ISLAND SHORELINE 32.12 MI.

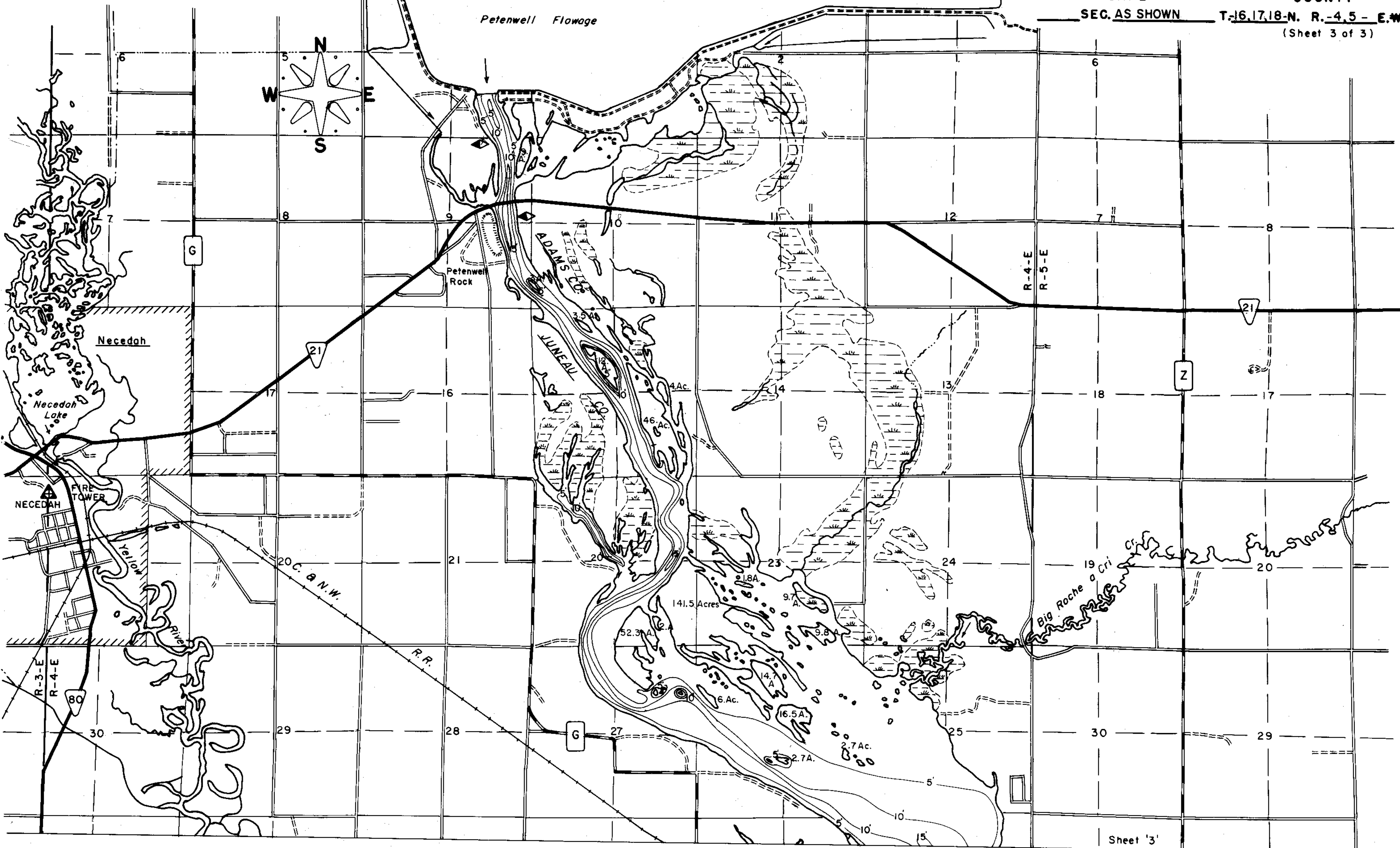

Sheet '3'
Sheet '2'

EQUIPMENT RECORDING SONAR MAPPED SUMMER 1974
MONTH YEAR
LAKE BOTTOM SYMBOLS

- | TOPOGRAPHIC SYMBOLS | | LAKE BOTTOM SYMBOLS | |
|-----------------------|----------------------------|---------------------|---------------------------|
| (B) Brush | Steep slope | P. Peat | B Boulders |
| (PW) Partially wooded | - - - Indefinite shoreline | Mk. Muck | Stumps & Snags |
| (W) Wooded | Marsh | C. Clay | Rock danger to navigation |
| (C) Cleared | Spring | M. Marl | T Submergent vegetation |
| (P) Pastured | Interrmittent stream | Sd. Sand | Emergent vegetation |
| (A) Agricultural | Permanent inlet | St. Silt | Floating vegetation |
| B.M. Bench Mark | Permanent outlet | Gr. Gravel | Brush shelters |
| ■ Dwelling | Dam | R. Rubble | |
| □ Resort | D.N.R. State owned land | Br. Bedrock | |
| □ Camp | | | |

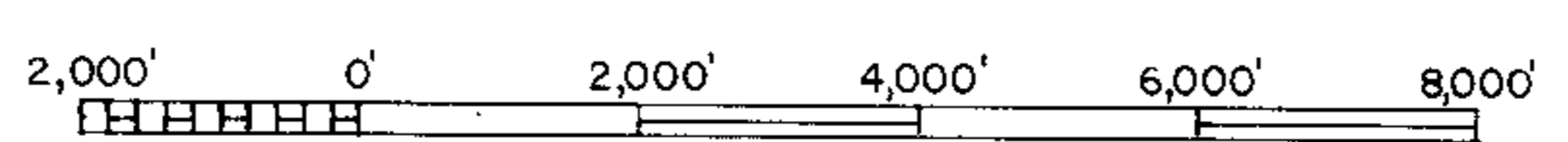

SCALE
◆ Access ◀ Access with Parking ◆ Boat Livery

Drawn by: E. Eaton
Field work by: U.W. Stevens Point

SPECIES OF FISH	Abundant		Present
	Common	Present	
Muskie			
N. Pike			X
Walleye			X
L.M. Bass			X
S.M. Bass			
Panfish	X		
Trout			

WATER AREA 13,955.3 ACRES
 UNDER 3 FT. 15 %
 OVER 20 FT. 17 %
 MAX. DEPTH 35 FEET.
 TOTAL ALK. 31 P.P.M.
 VOLUME 172,050.4 ACRE FT.
 MAIN SHORELINE 72.94 MI.
 ISLAND SHORELINE 32.12 MI.

Source: Wisconsin Department of Natural Resources 608-266-2621
Castle Rock Lake – Adams County and Juneau County, Wisconsin DNR Lake Map
Date – Summer 1974 - Historical Lake Map - Not for Navigation
A Public Document - Please Identify the Source when using it.