

LAKE SURVEY MAP

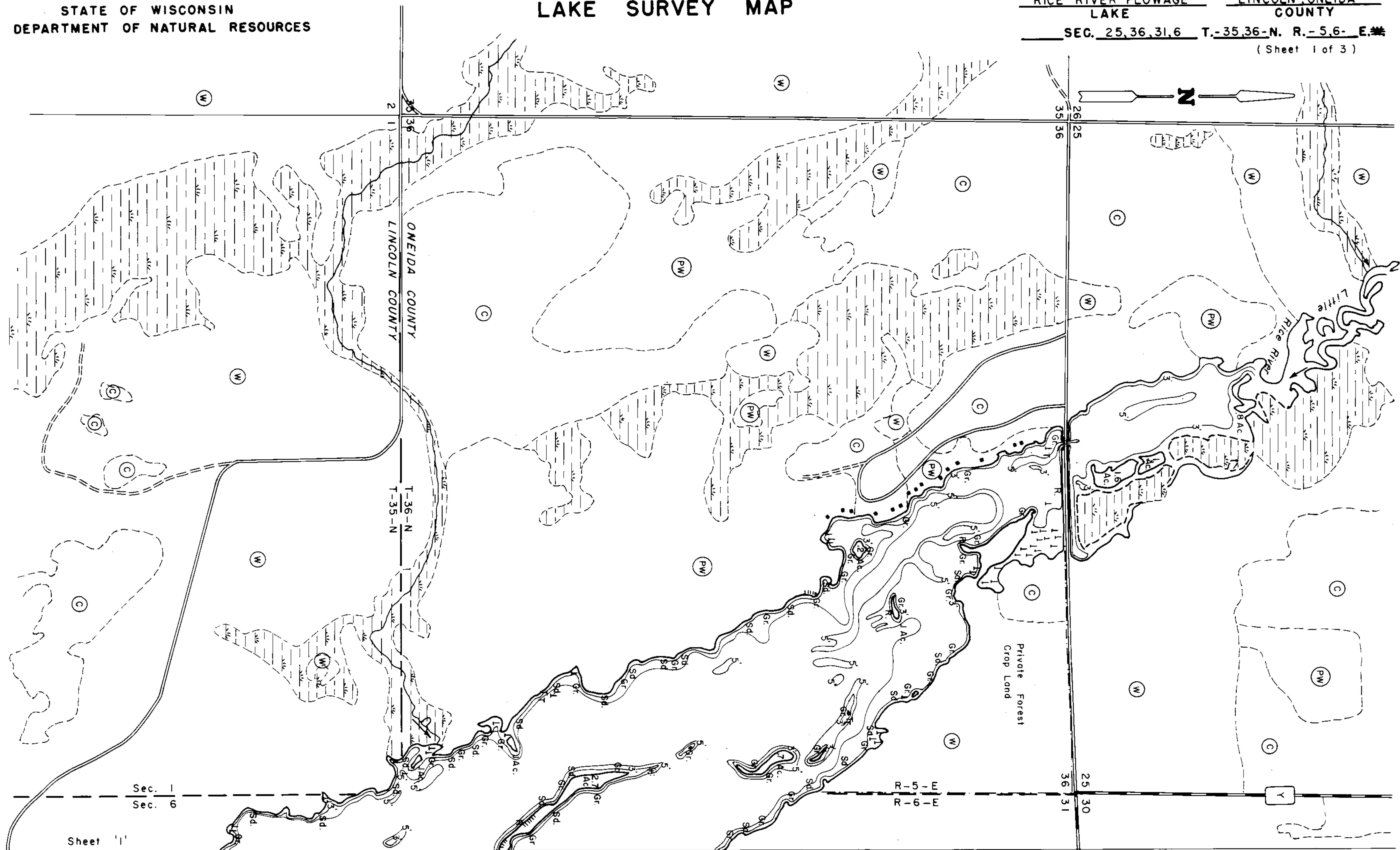

EQUIPMENT RECORDING SONAR MAPPED JUNE 1974

TOPOGRAPHIC SYMBOLS		LAKE BOTTOM SYMBOLS	
(B) Brush	() Steep slope	P. Peat	B Boulders
(PW) Partially wooded	(---) Indefinite shoreline	Mk. Muck	(*) Stumps & Snags
(W) Wooded	(---) Marsh	C. Clay	(*) Rock danger to navigation
(C) Cleared	(---) Spring	M. Marl	T Submergent vegetation
(P) Pastured	(---) Intermittent stream	Sd. Sand	⊥ Emergent vegetation
(A) Agricultural	(---) Permanent inlet	St. Silt	(---) Floating vegetation
B.M. Bench Mark	(---) Permanent outlet	Gr. Gravel	(---) Brush shelters
(■) Dwelling	(---) Dam	R. Rubble	
(■) Resort	(---) D.N.R. State owned land	Bc. Bedrock	
(■) Camp			

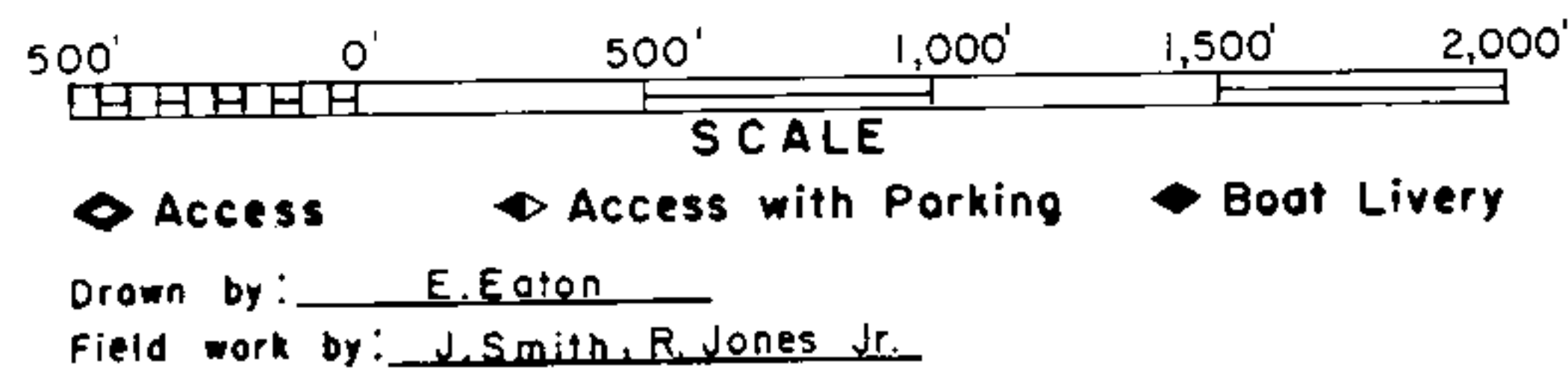

SPECIES OF FISH	Abundance		
	Abundant	Common	Present
Muskie	X		
N. Pike	X		
Walleye	X		
L.M. Bass	X		
S.M. Bass	X		
Panfish	X		
Trout			

WATER AREA 919.7 ACRES
 UNDER 3 FT. 8 %
 OVER 20 FT. 0 %
 MAX. DEPTH 26 FEET.
 TOTAL ALK. 21 P.P.M.
 VOLUME 6,957.7 ACRE FT.
 MAIN SHORELINE 13.68 MI.
 ISLAND SHORELINE 7.41 MI.

Sheet '1'
Sheet '2'

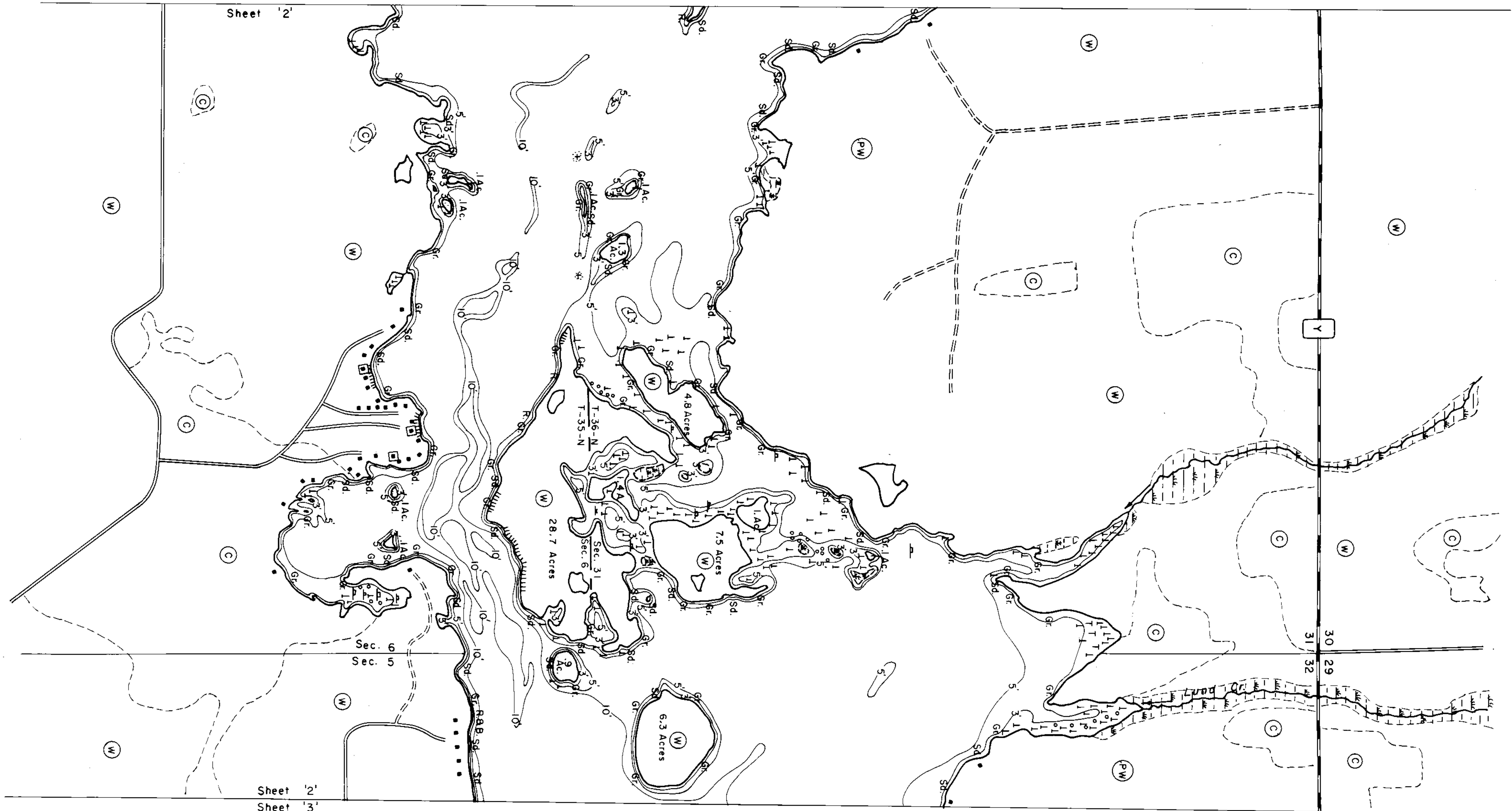
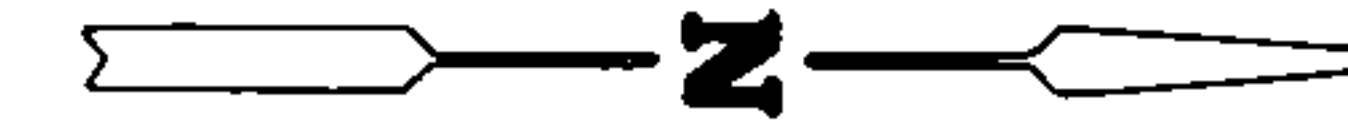

Sheet '2'
Sheet '3'

EQUIPMENT RECORDING SONAR MAPPED MONTH YEAR
JUNE 1974

- | TOPOGRAPHIC SYMBOLS | | LAKE BOTTOM SYMBOLS | |
|-----------------------|----------------------------|---------------------|-----------------------------|
| (B) Brush | Steep slope | P. Peat | B Boulders |
| (PW) Partially wooded | ----- Indefinite shoreline | Mk. Muck | ☉ Stumps & Snags |
| (W) Wooded | ----- Marsh | C. Clay | ⚠ Rock danger to navigation |
| (C) Cleared | ○ Spring | M. Marl | T Submergent vegetation |
| (P) Pastured | ----- Intermittent stream | Sd. Sand | ⌞ Emergent vegetation |
| (A) Agricultural | ----- Permanent inlet | St. Silt | ⌞ Floating vegetation |
| B.M. Bench Mark | ----- Permanent outlet | Gr. Gravel | ⌞ Brush shelters |
| ■ Dwelling | ⌞ Dam | R. Rubble | |
| □ Resort | | Bc. Bedrock | |
| □ Camp | D.N.R. State owned land | | |



◆ Access ◆ Access with Parking ◆ Boat Livery

Drawn by: E. Eaton
Field work by: J. Smith, R. Jones Jr.

SPECIES OF FISH	Abundance	
	Abundant	Common Present
Muskie	X	
N. Pike	X	
Walleye	X	
L. M. Bass	X	
S. M. Bass	X	
Panfish	X	
Trout		

WATER AREA 919.7 ACRES
UNDER 3 FT. 8 %
OVER 20 FT. 0 %
MAX. DEPTH 26 FEET.
TOTAL ALK. 21 P.P.M.
VOLUME 6,957.7 ACRE FT.
MAIN SHORELINE 13.68 MI.
ISLAND SHORELINE 7.41 MI.

Sheet '2'
Sheet '3'

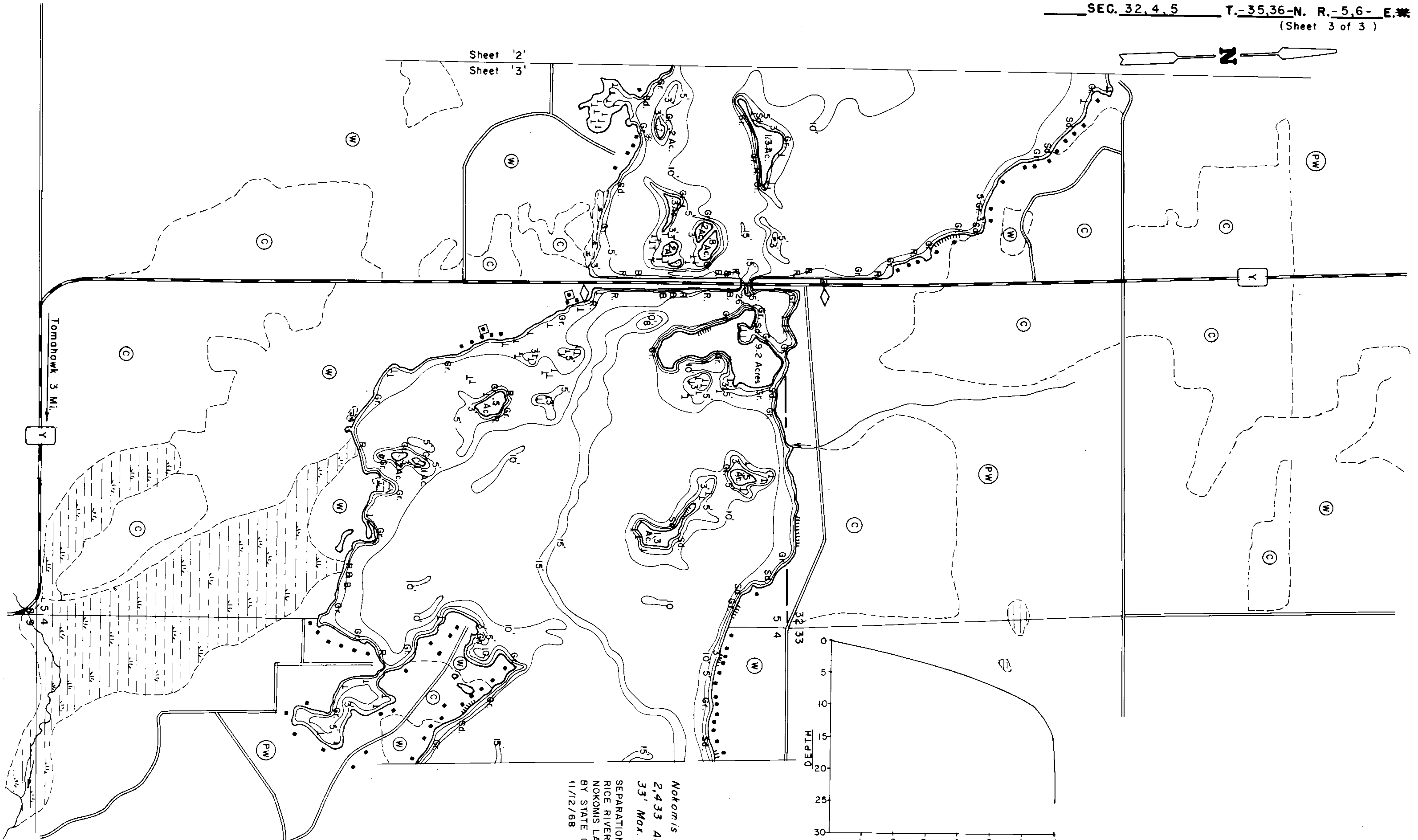

Nokomis Lake
2,433 Acres
33' Max. depth
SEPARATION LINE BETWEEN
RICE RIVER FLOWAGE AND
NOKOMIS LAKE ESTABLISHED
BY STATE GEOGRAPHIC COUNCIL
11/12/68

EQUIPMENT RECORDING SONAR MAPPED JUNE 1974

- | TOPOGRAPHIC SYMBOLS | | LAKE BOTTOM SYMBOLS | |
|-----------------------|-------------------------------|---------------------|-----------------------------|
| (B) Brush | Steep slope | P. Peat | B Boulders |
| (PW) Partially wooded | ----- Indefinite shoreline | Mk. Muck | ☼ Stumps & Snags |
| (W) Wooded | ----- Marsh | C. Clay | ☼ Rock danger to navigation |
| (C) Cleared | ----- Spring | M. Marl | T Submergent vegetation |
| (P) Pastured | ----- Intermittent stream | Sd. Sand | ↑ Emergent vegetation |
| (A) Agricultural | ----- Permanent inlet | St. Silt | ↓ Floating vegetation |
| B.M. Bench Mark | ----- Permanent outlet | Gr. Gravel | ↑ Brush shelters |
| ■ Dwelling | ----- Dam | R. Rubble | |
| ■ Resort | ----- D.N.R. State owned land | B. Bedrock | |
| ■ Camp | | | |



◆ Access ◀ Access with Parking ◆ Boat Livery

Drawn by: E. Eaton
Field work by: J. Smith, R. Jones Jr.

SPECIES OF FISH	Abundance		
	Abundant	Common	Present
Muskie		X	
N. Pike	X	X	
Walleye	X	X	
L. M. Bass	X	X	
S. M. Bass	X	X	
Panfish	X		
Trout			

WATER AREA 919.7 ACRES
UNDER 3 FT. 8 %
OVER 20 FT. 0 %
MAX. DEPTH 26 FEET.
TOTAL ALK. 21 P.P.M.
VOLUME 6,957.7 ACRE FT.
MAIN SHORELINE 13.68 MI.
ISLAND SHORELINE 7.41 MI.

Source: Wisconsin Department of Natural Resources 608-266-2621
Rice River Flowage - Lincoln County, Wisconsin DNR Lake Map
Date – Jun 1974 - Historical Lake Map - Not for Navigation
A Public Document - Please Identify the Source when using it.