

LAKE SURVEY MAP

LAKE SWAMP
 SECTION 6
 TOWNSHIP 36 N
 RANGE 6 E
 TOWN OF CASSIAN
 COUNTY ONEIDA

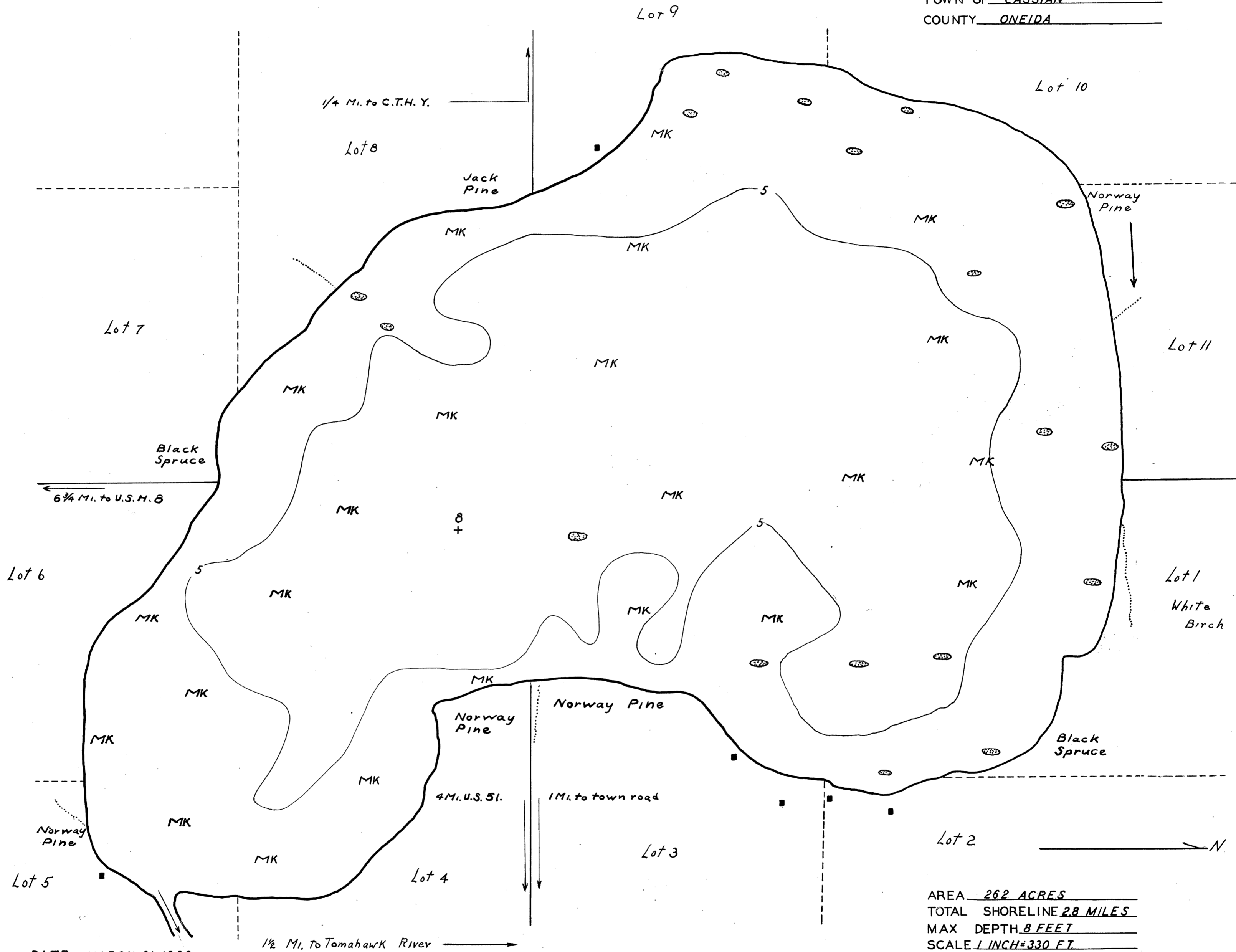

AREA 262 ACRES
 TOTAL SHORELINE 28 MILES
 MAX DEPTH 8 FEET
 SCALE 1 INCH = 330 FT.

DATE MARCH 21 1939
 COMPILED BY E.M.B.
 TRACED BY F.H.T.
 SOURCE OF INFORMATION
CAMP TOMAHAWK LAKE
SURVEY PROJECT
 SOUNDINGS _____

 DATES OF MAP REVISION
1 001 1941
 WORK AGENCY C.C.C.

LAKE IMPROVEMENT RECORD

TYPE	DATE			
⊕ BRUSH REFUGES		_____	_____	_____
∞ SAPLING TANGLES		_____	_____	_____
□ SPAWNING BOXES		_____	_____	_____
* MINNOW SPAWNERS		_____	_____	_____
TOTAL		_____	_____	_____

LEGEND

- ⊕ WEED BEDS
- * ROCKY SHOALS
- Sd SAND
- Cl CLAY
- Gv GRAVEL
- Mk MUCK
- DWELLING
- ABANDONED DWELLING
- ▣ RESORT

Source: Wisconsin Department of Natural Resources 608-266-2621
Swamp Lake T38N R7E S35– Oneida County, Wisconsin DNR Lake Map
Date – Mar 1939 - Historical Lake Map - Not for Navigation
A Public Document - Please Identify the Source when using it.