

Minocqua Lake
1,285 Acres
12' Max. Depth

A M E R I C A N

L E G I O N

S T A T E

F O R E S T

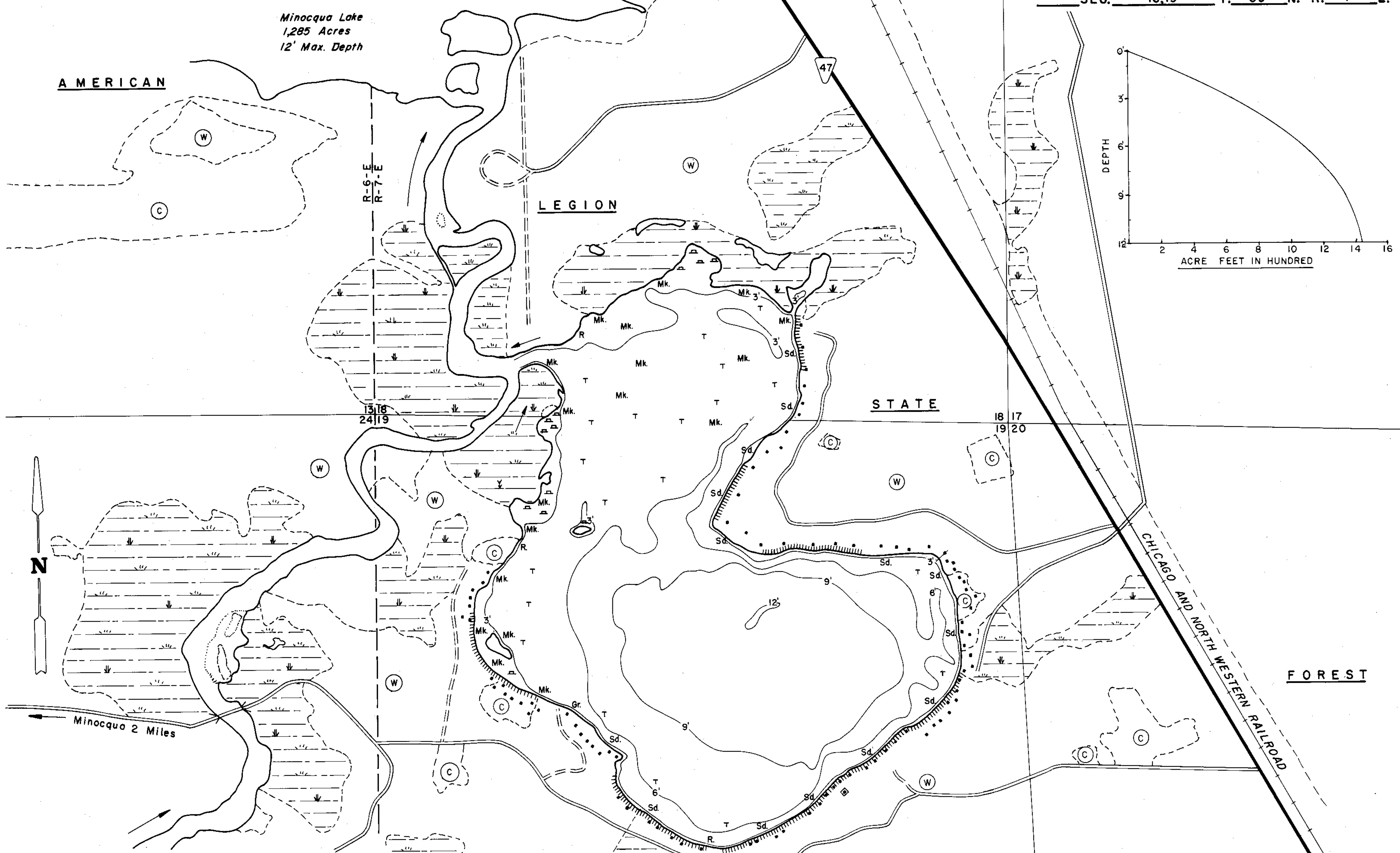
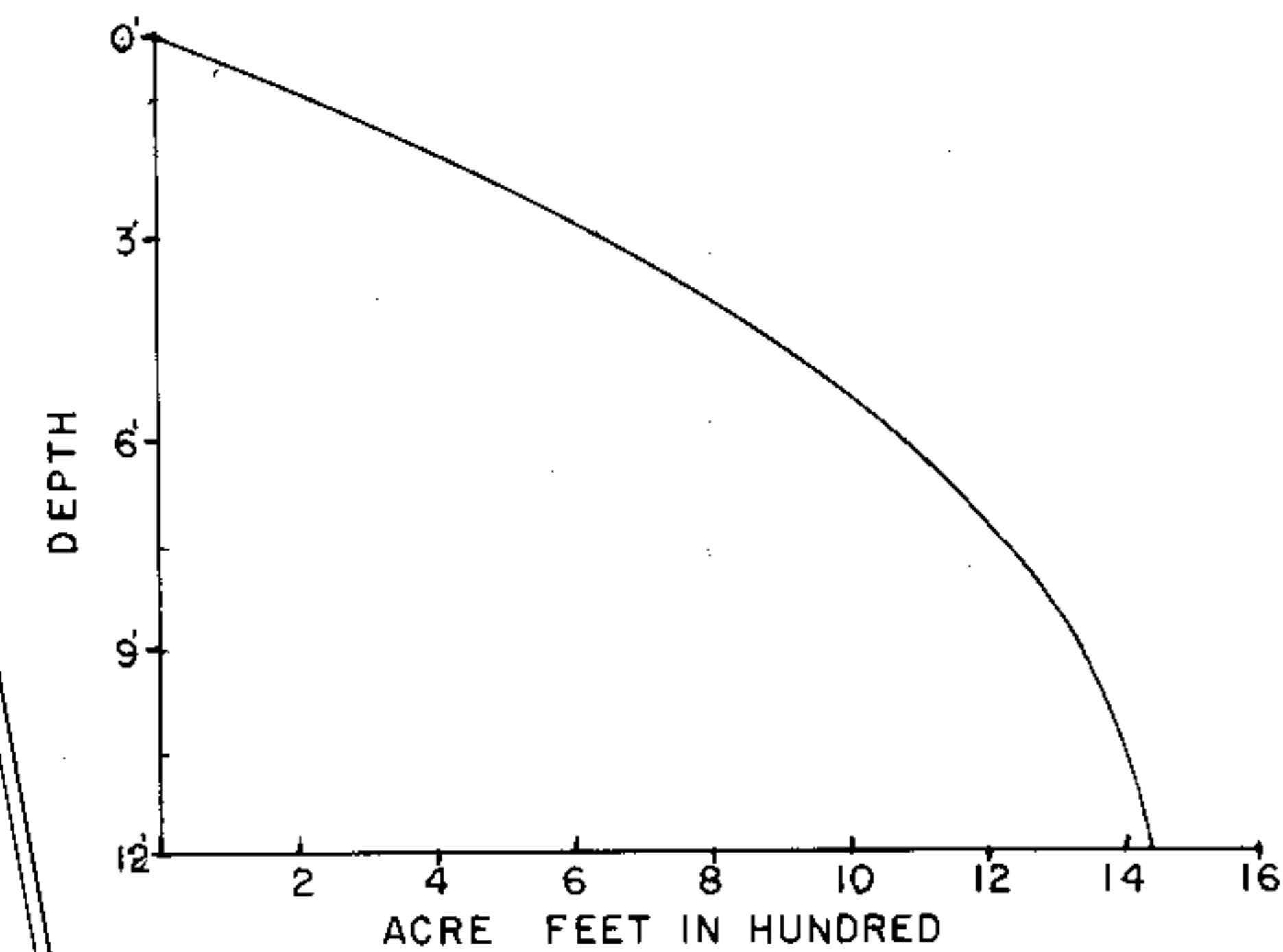

EQUIPMENT RECORDING SONAR MAPPED

JUNE 1976
MONTH YEAR

LAKE BOTTOM SYMBOLS

- | | |
|----------------------------|-----------------------------|
| TOPOGRAPHIC SYMBOLS | LAKE BOTTOM SYMBOLS |
| (B) Brush | P. Peat |
| (PW) Partially wooded | Mk. Muck |
| (W) Wooded | C. Clay |
| (C) Cleared | M. Marl |
| (P) Pastured | Sd. Sand |
| (A) Agricultural | St. Silt |
| B.M. Bench Mark | Gr. Gravel |
| (D) Dwelling | R. Rubble |
| (R) Resort | Br. Bedrock |
| (C) Camp | B Boulders |
| Steep slope | ☼ Stumps & Snags |
| - - - Indefinite shoreline | ☼ Rock danger to navigation |
| Marsh | T Submergent vegetation |
| Spring | ⊥ Emergent vegetation |
| Intermittent stream | ⊥ Floating vegetation |
| Permanent inlet | ⊥ Brush shelters |
| Permanent outlet | |
| Dam | |
| D.N.R. State owned land | |

SPECIES OF FISH	Abundance		
	Abundant	Common	Present
Muskie		X	X
N. Pike		X	X
Walleye		X	X
L.M. Bass		X	X
S.M. Bass		X	X
Panfish	X		
Trout			

WATER AREA 222.9 ACRES
 UNDER 3 FT. 10.25 %
 OVER 20 FT. 0 %
 MAX. DEPTH 12 FEET.
 TOTAL ALK. 49 P.P.M.
 VOLUME 1,430.48 ACRE FT.
 MAIN SHORELINE 3.09 MI.
 ISLAND SHORELINE 0.19 MI.

SCALE 0 500 1000 1500 2000'
 Access Access with Parking Boat Livery
 Drawn by: G.Thuesen
 Field work by: J.Smith, K.Cable

Source: Wisconsin Department of Natural Resources 608-266-2621
Mid Lake – Oneida County, Wisconsin - DNR Lake Map
Date – Jun 1976 - Historical Lake Map - Not for Navigation
A Public Document - Please Identify the Source when using it.