

# LAKE SURVEY MAP

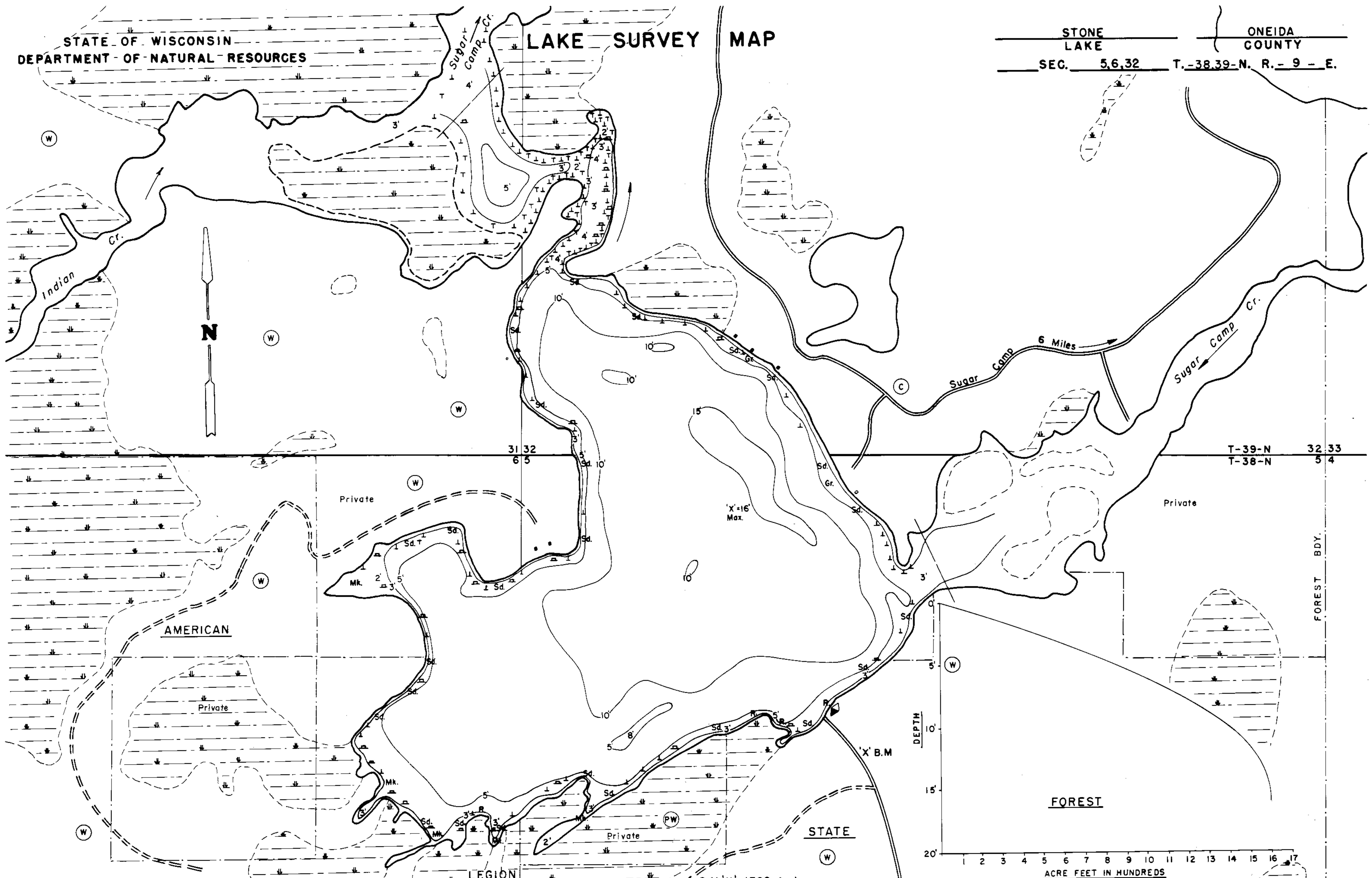

EQUIPMENT RECORDING SONAR MAPPED

JUNE 1970  
MONTH YEAR

TOPOGRAPHIC SYMBOLS

- (B) Brush
- (PW) Partially wooded
- (W) Wooded
- (C) Cleared
- (P) Pastured
- (A) Agricultural
- B.M. Bench Mark
- Dwelling
- Resort
- Camp
- ||||| Steep slope
- - - Indefinite shoreline
- Marsh
- Spring
- Intermittent stream
- Permanent inlet
- Permanent outlet
- Dam
- D.N.R. State owned land

- LAKE BOTTOM SYMBOLS
- P. Peat
  - Mk. Muck
  - C. Clay
  - M. Marl
  - Sd. Sand
  - Sl. Silt
  - Gr. Gravel
  - R. Rubble
  - Br. Bedrock
  - B Boulders
  - Stumps & Snags
  - Rock danger to navigation
  - T Submergent vegetation
  - Emergent vegetation
  - Floating vegetation
  - Brush shelters

B.M. 'X' 1709-A bronze cap set in concrete 335 feet from shore and 51 feet from center line of access road on S.E. side of lake. Assumed elevation = 100.00' Water level = 84.27'

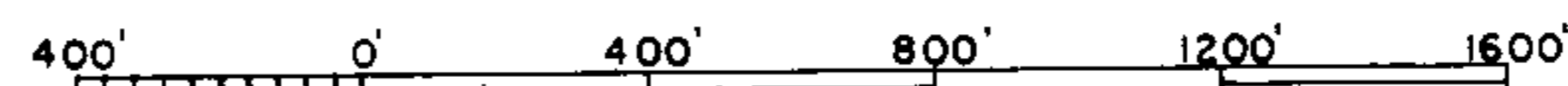

Access Access with Parking Boat Livery

Drawn by: G. Thuesen  
Field work by: J. Smith, R. Crocker

SPECIES OF FISH	Abundance		
	Abundant	Common	Present
Muskie			X
N. Pike			X
Walleye			X
L.M. Bass			X
S.M. Bass			X
Panfish	X		
Trout			

WATER AREA 187.9 ACRES  
 UNDER 3 FT. 12.5 %  
 OVER 20 FT. 0 %  
 MAX. DEPTH 16 FEET.  
 TOTAL ALK. 17 P.P.M.  
 VOLUME 1603.36 ACRE FT.  
 MAIN SHORELINE 4.07 MI.  
 ISLAND SHORELINE 0 MI.

Source: Wisconsin Department of Natural Resources 608-266-2621  
Stone Lake – Oneida County, Wisconsin - DNR Lake Map  
Date – Jun 1970 - Historical Lake Map - Not for Navigation  
A Public Document - Please Identify the Source when using it.