

LAKE SURVEY MAP

CAMP LAKE VILAS COUNTY  
SEC. 27.34 T. 41 N. R. 6 E.

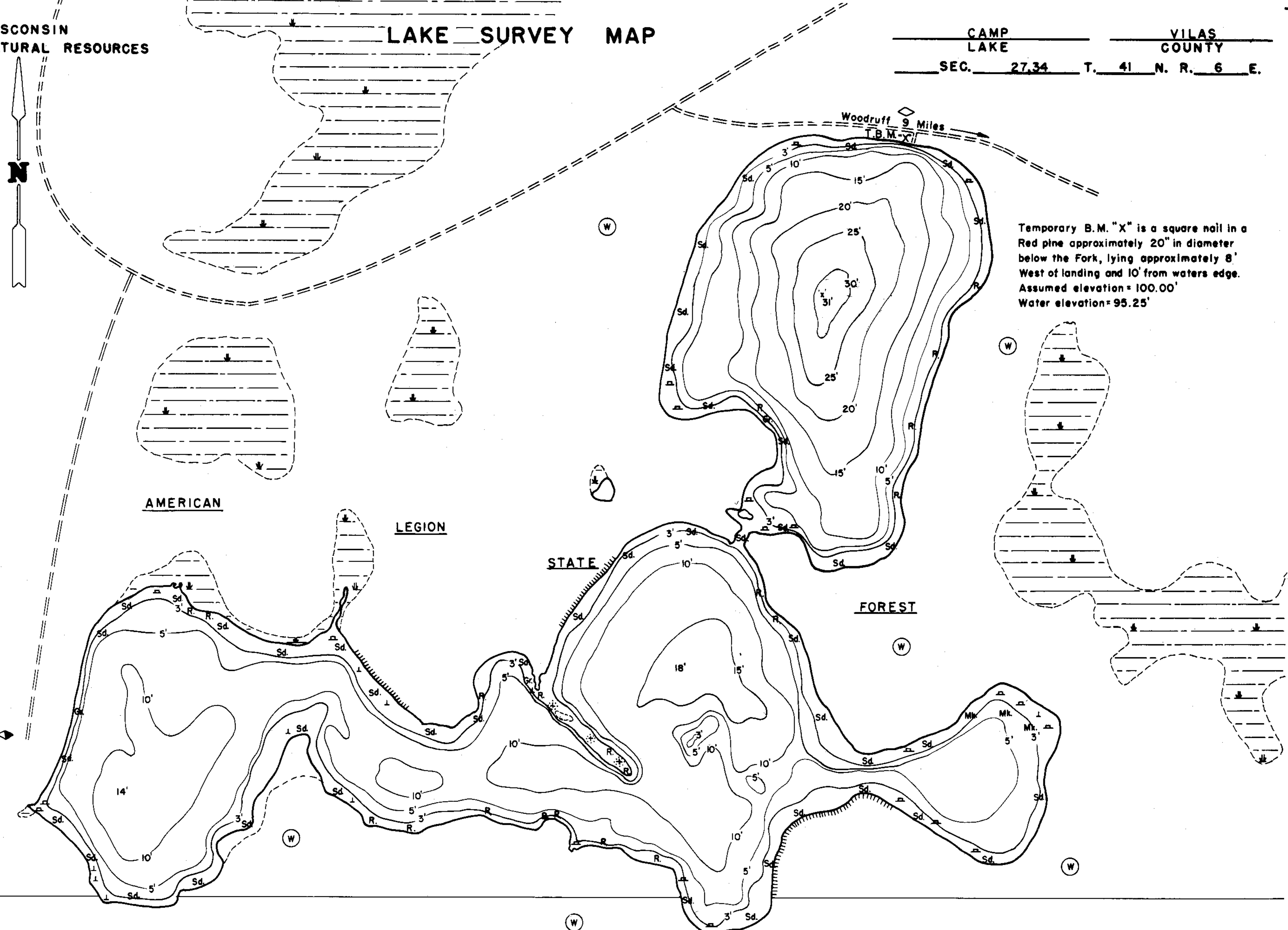

28 27  
33 34

EQUIPMENT RECORDING SONAR MAPPED JULY 1975  
MONTH YEAR  
LAKE BOTTOM SYMBOLS

- |                       |                            |                     |                             |
|-----------------------|----------------------------|---------------------|-----------------------------|
| TOPOGRAPHIC SYMBOLS   |                            | LAKE BOTTOM SYMBOLS |                             |
| (B) Brush             | Steep slope                | P. Peat             | B. Boulders                 |
| (PW) Partially wooded | - - - Indefinite shoreline | Mk. Muck            | ⊙ Stumps & Snags            |
| (W) Wooded            | ⊘ Marsh                    | C. Clay             | ⊛ Rock danger to navigation |
| (C) Cleared           | ○ Spring                   | M. Marl             | T Submergent vegetation     |
| (P) Pastured          | ~ Intermittent stream      | Sd. Sand            | ⊥ Emergent vegetation       |
| (A) Agricultural      | ≡ Permanent inlet          | St. Silt            | ⊘ Floating vegetation       |
| B.M. Bench Mark       | ≡ Permanent outlet         | Gr. Gravel          | ⊘ Brush shelters            |
| ■ Dwelling            | ⊥ Dam                      | R. Rubble           |                             |
| □ Resort              | D.N.R. State owned land    | Br. Bedrock         |                             |
| □ Camp                |                            |                     |                             |

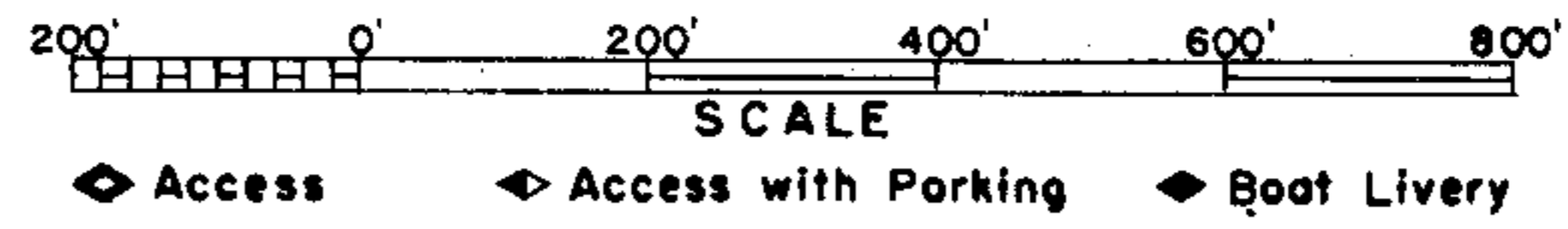

Drawn by: G. Thuesen  
Field work by: J. Smith

SPECIES OF FISH	Abundance	
	Abundant	Common
Muskie		X
N. Pike		
Walleye		
L.M. Bass	X	
S.M. Bass		
Panfish	X	
Trout		

WATER AREA 59.35 ACRES  
UNDER 3 FT. 15.65 %  
OVER 20 FT. 6.67 %  
MAX. DEPTH 31 FEET.  
TOTAL ALK. P.P.M.  
VOLUME 544.94 ACRE FT.  
MAIN SHORELINE 2.58 MI.  
ISLAND SHORELINE .04 MI.

Source: Wisconsin Department of Natural Resources 608-266-2621  
Camp Lake - Vilas County, Wisconsin DNR Lake Map  
Date – Jul 1975 - Historical Lake Map - Not for Navigation  
A Public Document - Please Identify the Source when using it.